

Mesa Ridge

LITE



LIGHTWEIGHT TRAVEL TRAILERS & FIFTH WHEELS



Highland
RIDGE RV

Own the Outdoors

FLOORPLANS

TRAVEL TRAILERS



MR2410RL



MR2804RK



MR2504BH



MR2910RL



MR2510BH



MR3110BH



MR2710RL



MR3310BH



MR2802BH

FIFTH WHEELS



MF2910RL



MF2950BH

FEATURES

STANDARDS

- » 1/2 Ton Towable (FW)
- » 100# Full Extension Drawer Guides
- » 8 Cu. Ft. Refrigerator
- » LED Lighting in Ceilings (TT)
- » Quick Recovery Gas/Electrical Water Heater (TT)
- » Residential Return Air A/C - with Race Track Ducting (FW)
- » Prepped For Observation Camera
- » Key-Alike System
- » Aluminum Tread Entry Steps
- » Power Awning(s) with LED Lighting
- » Stainless Steel Appliances
- » Stainless Steel Under Mount Sinks (Kitchen & Lav)
- » Outside Enclosed Docking Station
- » Battery Disconnect
- » Solar Prep
- » Convertible Queen Mattress (60" x 80")
- » Seamless Surf(x) Counter Tops
- » Linoleum Throughout Main Living Areas & Slides
- » Patent Flush Floor Slides with Vinyl Flooring (No Carpet)
- » PVC Roofing Membrane (12 Year Warranty/10 Year Non-Prorated)
- » Porcelain Toilet
- » Walk Around Queen Bed with Best in Class Headroom (FW)
- » Heat Registers Strategically Placed (No Registers in Floor) (FW)
- » 50 Amp Service (FW)

OPTIONS

- » 50 Amp Serv. with 2nd A/C Prep (2710, 2802, 2804) (Forced 2910, 2950, 3110, 3310)
- » A/C - 2nd A/C, 13.5k BTU Ducted (must choose 50amp option) (2710, 2802, 2804, 2910, 3110, 3310)
- » A/C - Main 15k A/C ipo Std. 13.5k A/C
- » BBQ Grill with Bumper Bracket
- » Bike Rack - LCI Jack-It Front Bike Rack (TT)
- » Power Front and Rear Stabilizer Jacks
- » Recliners ipo Std. Theater Seats (2804)
- » Table/Chairs ipo Std. Booth (N/A 2504, 2510)
- » Tri-Fold Sofa ipo Std Power Theater Seats (N/A 2910)
- » U-Lounge ipo Std. Theater Seats/Booth (2950)

SPECIFICATIONS

	MR2410RL	MR2504BH	MR2510BH	MR2710RL	MR2802BH	MR2804RK	MR2910RL	MR3110BH	MR3310BH	MR2910RL	MR2950BH
Square Feet	222	232	233	262	267	260	300	315	331	317	320
GVW	5322	5385	5385	5710	5765	5900	6483	6835	6795	7840	8270
Max Weight	502	592	555	707	510	675	822	931	900	1305	1320
GVWR	7400	7400	7400	7400	7450	7675	8600	8995	8995	9995	9995
Cargo (Gross)	2078	2015	2020	1690	1685	1775	2117	2160	2200	2155	1725
Length (Pin to Rear)	28' 5"	28' 11"	29' 3"	31' 6"	31' 9"	31' 9"	33' 5"	35' 5"	37' 5"	31' 11"	33' 11"
Ext. Height	131"	131"	131"	131"	131"	131"	131"	131"	131"	151"	151"
Ext. Width	97"	97"	97"	97"	97"	97"	97"	97"	97"	97"	97"
Ext. Width (Slides Out)	135"	135"	135"	135"	135"	135"	156"	135"	135"	156"	156"
Interior Height (Upper Deck)	-	-	-	-	-	-	-	-	-	80"	80"
Interior Height (Overall)	82"	82"	82"	82"	82"	82"	82"	82"	82"	92"	92"
Fresh Water (Gal.)	51	51	51	51	51	51	51	51	51	51	51
Gray Water (Gal.)	29	29	29	29	58	58	58	29	58	58	58
Waste Water (Gal.)	29	29	29	29	29	29	29	29	29	29	29
LP Capacity (lbs.)	60	60	60	60	60	60	60	60	60	60	60
Tire Size	15"	15"	15"	15"	15"	15"	15"	15"	15"	15"	15"
Awning Size	15'	18'	18'	20'	20'	20'	10, 11'	19'	20'	9', 11'	15'

CONSTRUCTION

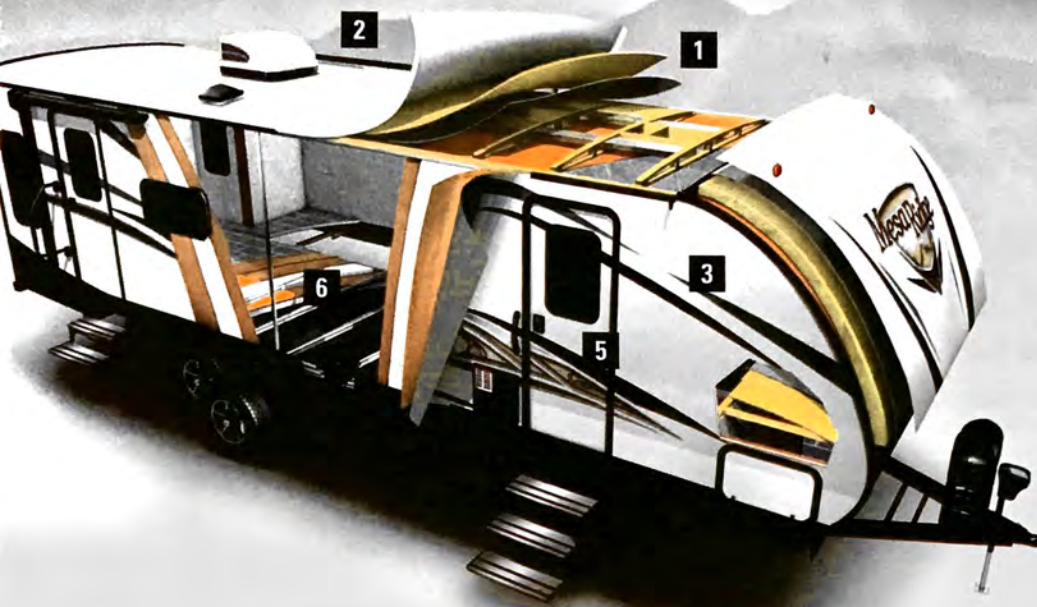

1 | ROOF

- » Double batten insulation layered with radiant foil
- » Screw-mounted plywood decking topped with premium quality PVC
- » No treatment required! Will not chalk or spot
- » Heat reflecting properties keep coach cooler in the summer

2 | SLIDE OUTS

- » Best in class slide height and depth
- » Flush floor and above floor slides
- » Accu-Slide cable system with four points of compression
- » Laminate components plus 3M flashing tape along corners to prevent leaks

3 | SIDEWALLS

- » Lightweight, double-welded aluminum walls
- » Slide roof frames laminated with rigid foam insulation

4 | MAIN BODY

- » Class-leading I-beam chassis and draw bars
- » Equa-Flex suspension system
- » Axles with self-adjusting brakes
- » Aluminum wheels with nitrogen-filled tires
- » Industry-leading unique heating system

5 | DOORS & LOCKS

- » Full-width entrance doors with built-in screen doors and integrated window shades
- » Entrance and baggage doors on secure and convenient key-alike system

6 | FLOORS

- » Double-welded framed floors
- » Insulated with rigid foam wrapped in radiant foil, anti-puncture Darco material, and strengthened with an overlapping double layer of laminate

INDUSTRY-LEADING HEATING SYSTEM

Oversize 4-inch heat ducts run from the furnace down to the fully enclosed underbelly and wrap around the tanks suspended between the chassis I-beams. Holding tanks are warmed by the forced air heat which prevents freeze-ups.

A return at the end of the tank connecting back into the coach provides the necessary air flow, eliminating the need for a pressurized system.



Your Mesa Ridge Lite Dealer:

**Highland**
RIDGE RV
Own the Outdoors

For more information visit us at:
www.HighlandRidgeRV.com

Due to continual research and advances, manufacturer reserves the right to change specifications, design, price, and equipment without notice, and assumes no responsibility for any error in the literature. Some items shown are not included as standard or optional equipment.

Mesa Ridge

LITE

CONSTRUCTION & FEATURE HIGHLIGHTS

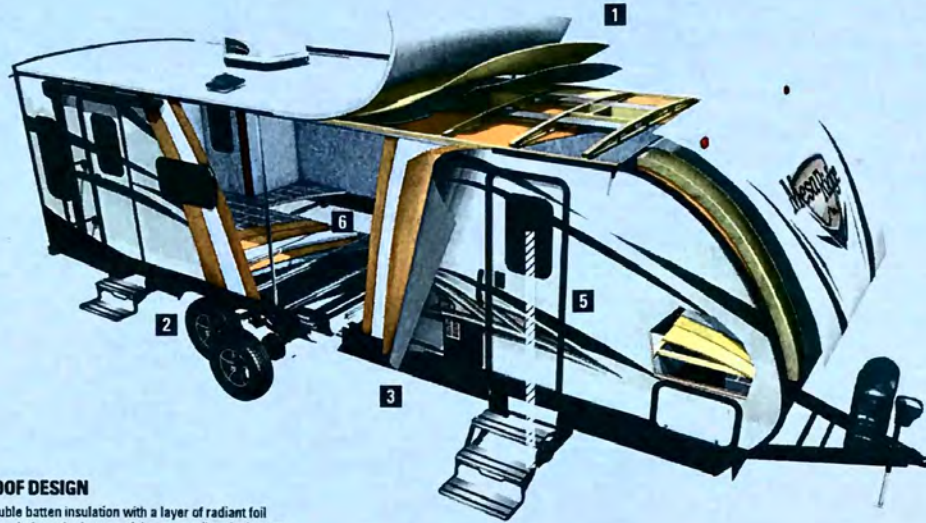

TOP FEATURES

-  LINO THROUGHOUT
-  PRESSED MEMBRANE COUNTER TOPS THROUGHOUT
-  ALUMINUM TREAD STEPS
-  13.5K A/C RESIDENTIAL RETURN AIR
-  STAINLESS STEEL APPLIANCES
-  STAINLESS UNDER-MOUNT KITCHEN AND BATHROOM SINKS
-  DOCKING STATION
-  KEYED ALIKE SYSTEM
-  TALLEST AND DEEPEST SLIDES IN CLASS
-  PVC ROOFING MEMBRANE

1 ROOF DESIGN

Double batten insulation with a layer of radiant foil extends from the bottom of the rear wall to the bottom of the front and is capped at both ends. The plywood decking is secured with screws and topped with a PVC roof that does not chalk, streak or need yearly conditioning and features heat reflecting properties that help keep your coach cooler in the summer.

2 SLIDE OUTS

Slide outs are constructed with laminated components that include 3M flashing tape along the corners to help prevent leaks. Superior wall, roof and floor construction feature added insulation and allow for best-in-class, taller and deeper slides creating a comfortable, open and spacious environment. Flush floor and above floor slides feature the Accu-Slide cable system providing four points of compression when placed in the "In and Out" positions.

3 LAMINATED SIDEWALLS

Each wall and slide roof is constructed using double-welded aluminum frames and is laminated with rigid foam insulation, providing a superior, light-weight wall.

4 MAIN BODY

The main body is built on a class-leading I-beam chassis and draw bars. It also features an Equi-Flex suspension system, axles with self-adjusting brakes, and aluminum wheels with nitrogen filled tires. The underbelly is fully enclosed and designed to prevent freeze-ups by containing the heat that is circulated around the suspended holding tanks by our industry-leading heating system.

5 DOORS & LOCKS

Full-width entrance doors include built-in screen doors and integrated window shades. Baggage and entrance doors are on the key-alike system for added convenience and security.

6 FLOORS

Double-welded framed floors are insulated with rigid foam, wrapped in radiant foil and anti-puncture Darco material and strengthened with an overlapping double layer of laminate.



HIGHLAND RIDGE PRODUCTS HAVE A UNIQUE AND INCREDIBLE HEATING SYSTEM.

It starts with a 4-inch heat duct from the furnace down the underbelly—double the size of some of our competitors. Our tanks are suspended between the underbelly I-beams and surrounded by the 4-inch heat duct. This allows us to warm the tanks by blowing forced air heat on them.

A return at the end of the tank connecting back into the coach provides the necessary air flow, eliminating the need for a pressurized system.

THE HIGHLAND ASSURANCE



We stand behind our products. At Highland Ridge RV, we are one of the few manufacturers that have a 3-Year Limited Structural Warranty.

MORE ROOM LESS WEIGHT

This is our mission at Highland Ridge RV. It drives us to innovate and revolutionize the RV industry and it's why our products are 10 - 15% lighter than the competition.



We pursue perfection through innovation and quality. Your RV experiences drive the evolution of our products in a constant state of improvement.

NAVISTAR

PROVING GROUNDS

Our products undergo a grueling 500 mile durability test. A battery of figure eights, inverted chatters, undulations, and staggered bumps will test and prove our workmanship.



START YOUR ADVENTURE AT:
WWW.HIGHLANDRIDGERV.COM

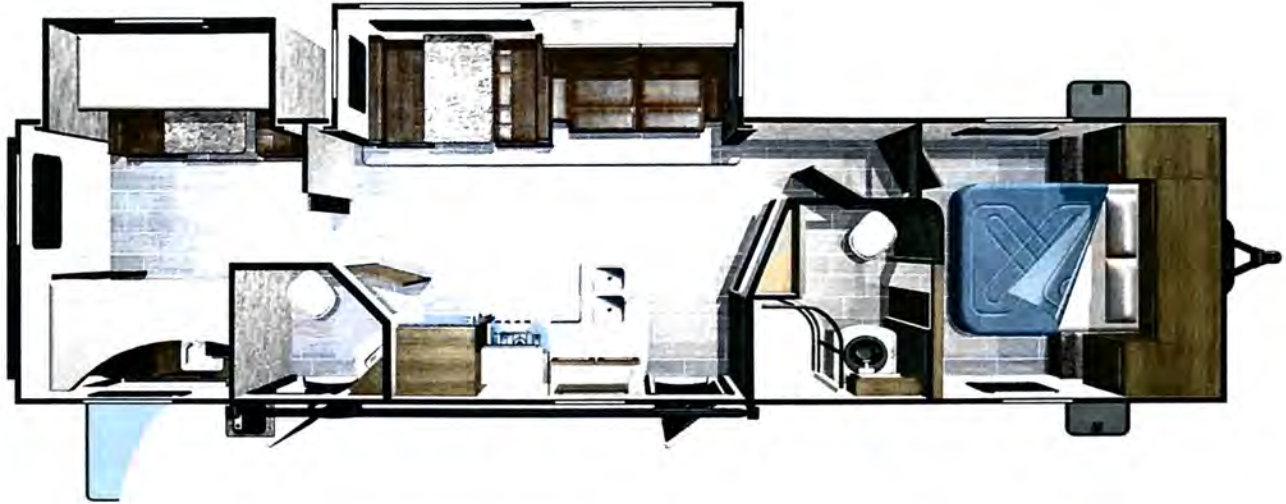

TOP FEATURES

- » Linoleum Throughout
- » Press Membrane Countertops Throughout
- » Aluminum Tread Steps
- » Dometic Blizzard 13.5k A/C with Quiet Residential Return
- » Stainless Steel Appliances
- » Stainless Steel Undermount Sinks (Kitchen & Lav)
- » Outside Enclosed Docking Station
- » Keyed Alike System
- » Sky Light(s) (Kitchen & Bath)
- » Tallest and Deepest Slides In Its Class
- » Arched Vaulted Ceilings
- » Secondary Half Bathroom
- » PVC Roofing Membrane (12 Year Warranty/10 Year Non-Prorated)
- » Large Pots and Pan Storage (Drawer)
- » 34" Radius Corner Shower with Glass Doors
- » 39" TV with Swing Arm
- » Large U-Booth Dinette
- » 8 Cu Refrigerator
- » Porcelain Toilet
- » Solar Prep
- » Outside Kitchen with Hammered Steel Top
- » Dinette in Bunk Room
- » Bunks (40"x70" & 28"x74")
- » Theatre Seats with Lights, Heat & Massage

SPECIFICATIONS

Square Feet	331
UVW	6795
Hitch Weight	985
GVWR	8995
Cargo (Gross)	1715
Exterior Length (Pin to Rear)	37' 5"
Exterior Height	131"
Exterior Width	97"
Exterior Width (Slides Out)	135"
Interior Height (Overall)	82"
Fresh Water (Gal.)	51
Gray Water (Gal.)	58
Waste Water (Gal.)	29
LP Capacity (LBS)	60
Tire Size	15"
Awning Size	20'



For up to date information visit us at:
www.HighlandRidgeRV.com

Note: Features subject to change without notice. Rev. 12/20/17



We stand behind our products. At Highland Ridge RV, we are one of the few manufacturers that have a 3-Year Limited Structural Warranty.

MORE ROOM LESS WEIGHT

This is our mission at Highland Ridge RV. It drives us to innovate and revolutionize the RV industry and it's why our products are 10 - 15% lighter than the competition.

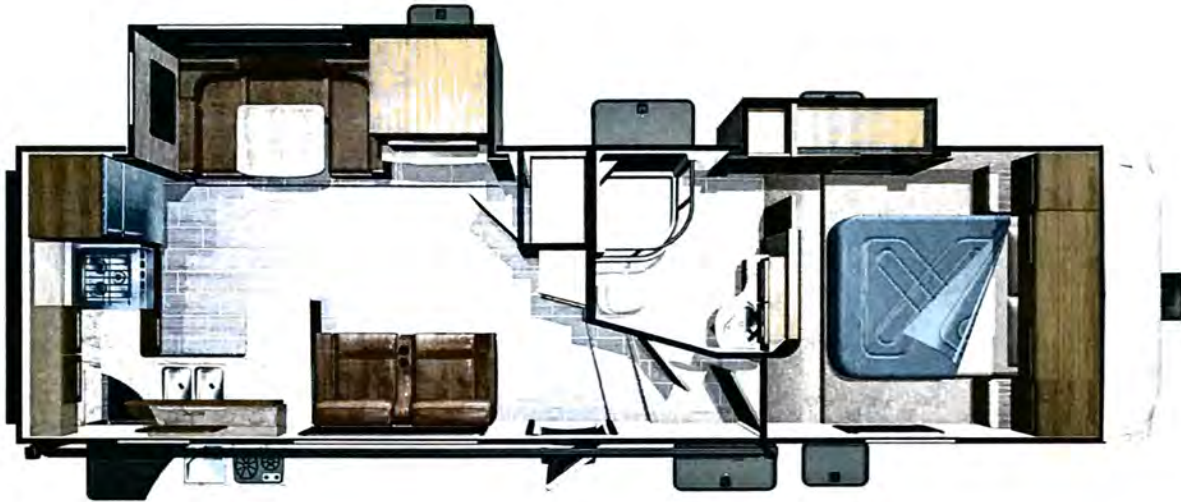

TOP FEATURES

- » Linoleum Throughout
- » Press Membrane Countertops Throughout
- » Aluminum Tread Steps
- » Dometic Blizzard 13.5k A/C with Quiet Residential Return
- » Stainless Steel Appliances
- » Stainless Steel Undermount Sinks (Kitchen & Lav)
- » Outside Enclosed Docking Station
- » Keyed Alike System
- » Sky Light(s) (Kitchen & Bath)
- » Side Aisle Bath
- » PVC Roofing Membrane (12 Year Warranty/10 Year Non-Prorated)
- » Large Pots and Pan Storage (Drawer)
- » 34" Radius Corner Shower with Glass Doors
- » 39" TV with Swing Arm
- » Large U-Booth Dinette
- » 8 Cu Refrigerator
- » Porcelain Toilet
- » Solar Prep
- » Outside Kitchen with Hammered Steel Top
- » Theatre Seats with Lights, Heat & Massage

SPECIFICATIONS

Square Feet	280
UVW	7360
Hitch Weight	1100
GVWR	9900
Cargo (Gross)	2540
Exterior Length (Pin to Rear)	29' 11"
Exterior Height	148"
Exterior Width	97"
Exterior Width (Slides Out)	135"
Interior Height (Overall)	92"
Interior Height (Upper Deck)	80"
Fresh Water (Gal.)	51
Gray Water (Gal.)	58
Waste Water (Gal.)	29
LP Capacity (LBS)	60
Tire Size	15"
Awning Size	20'



For up to date information visit us at:
www.HighlandRidgeRV.com

Note: Features subject to change without notice. Rev. 01/05/18



We stand behind our products. At Highland Ridge RV, we are one of the few manufacturers that have a 3-Year Limited Structural Warranty.

MORE ROOM LESS WEIGHT

This is our mission at Highland Ridge RV. It drives us to innovate and revolutionize the RV industry and it's why our products are 10 - 15% lighter than the competition.

MSRP

2018 Mesa Ridge Lite Travel Trailer
 *Effective Date: 7/31/17

* Units built prior to this date do not have the same features/specifications



Dealer: _____
 VIN #: _____

Available Options

X	\$1,813	Customer Convenience Package (Mandatory)
X	\$4,350	Ultra Package (Mandatory)
X	\$131	RVIA
	\$428	50 Amp Serv. w/ 2nd A/C Prep (2710,2802, 2804) (Forced 2910,3110,3310)
	\$798	A/C - 2nd A/C, 13.5k BTU Ducted (must choose 50amp option) (2710, 2802, 2804, 2910, 3110, 3310 only)
	\$399	A/C - Main 15k A/C ipo Std. 13.5k A/C
	\$283	BBQ Grill w/ Bumper Bracket
	\$269	Bike Rack - LCI Jack-It Front Bike Rack
	\$638	Power Front and Rear Stabilizer Jacks
	\$283	Q.A.I. Construction (Canadian Dealers ONLY)
	\$428	Recliners ipo Std. Theater Seats (2804)
		State Seal (NE, OR, WA)
	\$363	Table/Chairs ipo Std. Booth (n/a 2504, 2510)
	\$428	Tri-Fold Sofa ipo Std Power Theater Seats (n/a 2910)

Décor Options

Java

Model Selection Base Price

<input type="checkbox"/>	MR2410RL	\$26,093
<input type="checkbox"/>	MR2504BH	\$28,275
<input type="checkbox"/>	MR2510BH	\$28,275
<input type="checkbox"/>	MR2710RL	\$29,725
<input type="checkbox"/>	MR2802BH	\$30,305
<input type="checkbox"/>	MR2804RK	\$31,168
<input type="checkbox"/>	MR2910RL	\$34,003
<input type="checkbox"/>	MR3110BH	\$35,453
<input type="checkbox"/>	MR3310BH	\$37,330



Highland
 RIDGE RV
 Own the Outdoors

Base Price: _____ \$0
 Options: _____ \$6,294

Destination Chg: _____

TOTAL: \$6,294

Prices, features and options are subject to change without notice.

HIGHLAND RIDGE RV - 3195 N. S.R. 5, SHIPSHEWANA, INDIANA 46565 PHONE: (260) 768-7771 FAX (260) 768-7410

7/26/2017

MSRP

2018 Mesa Ridge Lite Fifth Wheel

*Effective Date: 7/31/17

* Units built prior to this date do not have the same features/specifications

Mesa Ridge LITE

Dealer: _____

VIN #: _____

Available Options

X	\$1,813	Customer Convenience Package (Mandatory)
X	\$4,350	Ultra Package (Mandatory)
X	\$131	RVIA
	\$428	50 Amp Serv. w/ 2nd A/C Prep
	\$798	A/C - 2nd A/C, 13.5k BTU Ducted (must choose 50amp option)
	\$399	A/C - Main 15k A/C ipo Std. 13.5k A/C
	\$283	BBQ Grill w/ Bumper Bracket
	\$283	Q.A.I. Construction (Canadian Dealers ONLY)
		State Seal (NE, OR, WA)
	\$363	Table/Chairs ipo Std. Booth
	\$428	Tri-Fold Sofa ipo Std Power Theater Seats (2950)
	\$428	U-Lounge ipo Std. Theater Seats/Booth (2950)

Décor Options

Java

Model Selection Base Price

<input type="checkbox"/>	MF2910RL	TBD
<input type="checkbox"/>	MF2950BH	\$39,491



Highland
RIDGE RV
Own the Outdoors

Base Price: _____ \$0

Options: _____ \$6,294

Destination Chg: _____

TOTAL: \$6,294

Prices, features and options are subject to change without notice.

HIGHLAND RIDGE RV - 3195 N. S.R. 5, SHIPSHEWANA, INDIANA 46565 PHONE (260) 768-7771 FAX (260) 768-7410

9/8/2017