

ACONIC

Toyhaulers



ECLIPSE
RECREATIONAL VEHICLES, INC.

Events

MONSTER ENERGY Supercross

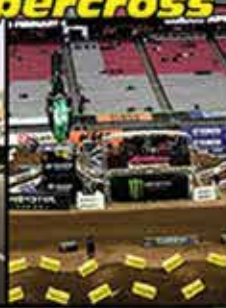

PROLINE WRAPS .COM

MONSTER JAM MonsterJam



SUR SOURCESPORTS.COM

UTV World Championship



MAD MEDIA



Camp RZR



TV UNDERGROUND.COM



DIRTY SHARK

Doonies



Make a Wish



Superior Structural Design

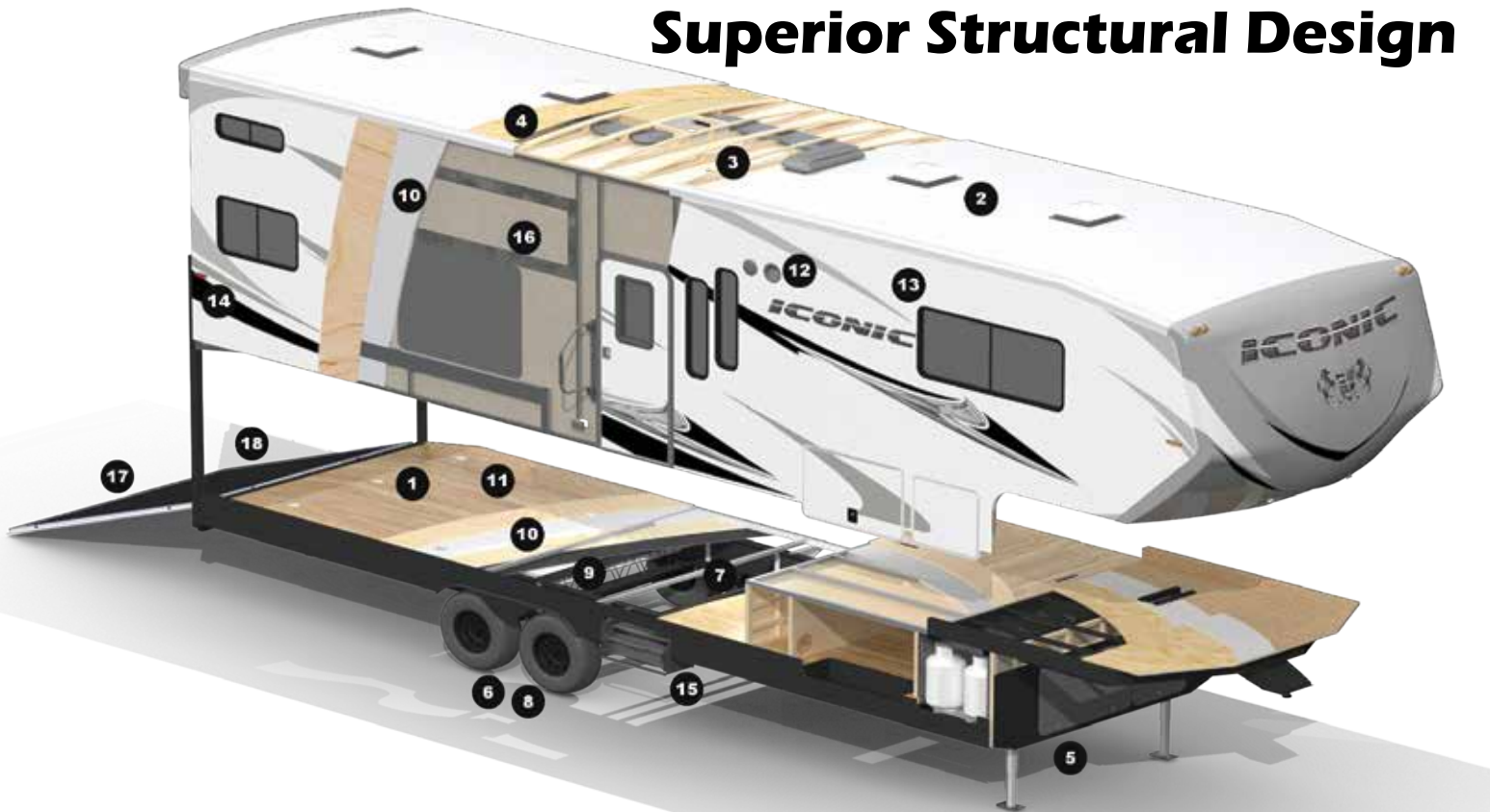

- 1. 2,500 lbs. Tie-Downs Mounted to Steel
- 2. Seamless One Piece TPO Roof
- 3. 5" Roof Trusses
- 4. Fully Decked Walk-on Roof
- 5. Wide Stance Chassis
- 6. Wide Track Axles
- 7. 12 x 2" Self Adjust Brakes
w/7,000 lbs. Stopping Capacity per Axle
- 8. Tru-Offroad Lubeable Suspension
- 9. Hi Clearance OffRoad Holding Tanks

- 10. Hi-Density Block Foam - R11 Insulation
- 11. 2 1/4" Ultra Strong Bonded Floor
- 12. Hi-Rez LED Flood Lights
- 13. Extra Large Tinted Windows
- 14. LED Running Lights
- 15. Radius Entry Steps
- 16. Lumber Core Screwed Cabinets w/ Steel Backing
- 17. 3,000 lbs. Ramp Door - Rhino Lined
- 18. Ramp Patio Ready

Bonded Floor

- Residential Grade Linoleum
- 1/2" Marine Grade Plywood Decking
- High Density EPS Foam Installation
- Quality Adhesive Developed Specifically
for Vacuum Bonded Process
- Luan Under-Decking Covered w/ Underbelly
- 1.5 x 1.5 Welded Aluminum Tube Framing Filled with
Lumber for Better Screw Retention

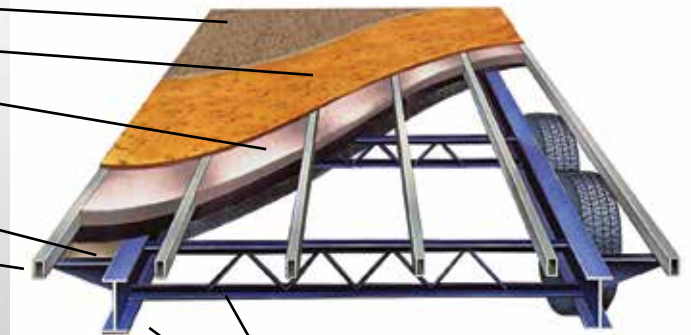

- Heavy Duty Truss Chassis Supports
- I-Beam Chassis

Bonded Wall

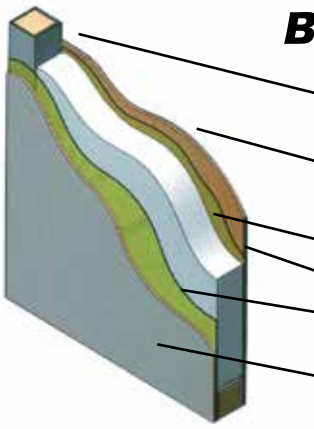

- 1.5 x 1.5 Welded Aluminum Tube
Filled with Lumber for Better Screw Retention
- Lamilux Exterior Paneling High Gloss Gel
Coated Fiberglass Surface Bonded to Luan Backing
- High Density EPS Foam Insulation
- Quality Adhesive Developed Specifically
for Lamination Process
- Vinyl Covered Luan

* Bonded Walls and Floors on all Fiberglass Coaches

Limited Edition



Standard Features - Exterior

- 6,000 LB Axles w/ Zerk Fittings and Self-Adjusting Brakes
- Awning
- Corrugated Thermal Gray Siding (1913CB-LE & 2114SF-LE ONLY)
- Fiberglass Sidewalls - Aluminum Framed (Laminated) (1913CBG-LE & 2114SFG-LE ONLY)
- Decked Walk-on Roof
- Floor - 3" Frame
- Front Laminated Fiberglass
- Fuel Station - 40 Gallon
- HD Digital Antenna w/ Park Cable Hookup
- Hi Def 3M Graphics
- Hi Rez LED Flood Lights
- LP - Dual 20 Lbs w/ LP Cover
- Powder Coated Chassis w/ Double Radius Entry Step
- Propane Stub for Quick Connect
- Ramp Door - 7' (3,000 Lbs Rating)
- Spare Tire w/ Carrier
- Stabilizer Jacks - Rear
- Steel Wheels - Mod Black 15"
- Tank Capacities - 100 Fresh, 50 Gray, 50 Black
- Windows - Extra Large Tinted

Standard Features - Interior

- 30 AMP Service
- A/C Living Room - 13.5K BTU (Ducted - 2114SF-LE & 2114SFG-LE)
- Drive-on Wheel Box
- Furnace - 18K BTU (Ducted on 2114SF-LE & 2114SFG-LE)
- I-Beam Chassis w/ Z-Style Outriggers
- Interior LED Lighting w/ Dimmer
- Stereo - AM/FM/BT w/ Exterior Speakers
- Lumber Core Screwed Cabinets
- Microwave - Range Hood - Range/Oven
- Mini-Blinds
- Porcelain Toilet
- Rapid Charge Converter
- Refrigerator - Large Double Door
- Skylight Over Shower (2114SF-LE & 2114SFG-LE ONLY)
- Single Bowl Galley Sink w/ Pull-out Faucet
- Tie Downs - 2,500 Lbs Rating
- Top Stitch Deluxe Furniture
- Water Heater - 6 Gal DSI (Quick Recovery)



ICONIC



2114SF-LE



2114SF-LE

Interior Colors

- Graystone w/ Black Stone Cherry Wood

Hi Def Exterior Graphics

- Gray

Optional Upgrades

- 2 Chairs IPO Sofa
- Corsa Furniture Trim
- CSA Canada
- Electric Bed w/ Ladder
- Generator - 3.5K Portable
- Power Tongue Jack
- Ramp Door Cable Kit
- Solar Panel - 160 Watt
- Stabilizer Jacks - Front
- TV - Living Room (28" Class)
- Winterize

Limited Package Includes

- Electric Awning - DVD - Black Tank Flush
- 12V USB Charger

Iconic Limited Edition Models:

- 1913CB-LE • 2114SF-LE
- 1913CBG-LE • 2114SFG-LE

1913CB-LE

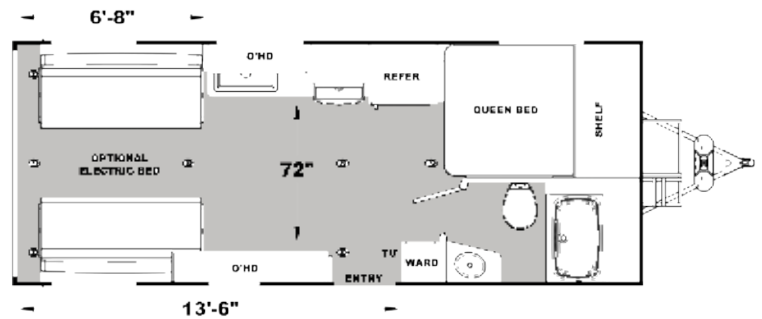

2114SF-LE

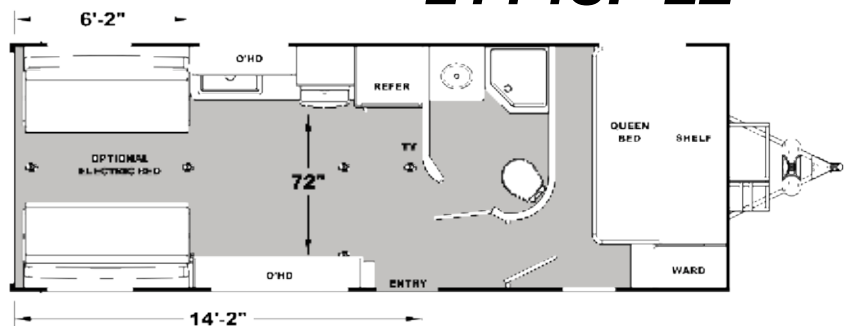

Pro Lite



Standard Features - Exterior

- 6,000 LB Axles w/ Zerk Fittings and Self-Adjusting Brakes
- Corrugated Thermal Gray Siding
- Decked Walk-on Roof
- Electric Awning w/ LED Light
- Exterior LED Light Bar
- Exterior Shower
- Floor - 3" Framed
- Front & Rear Laminated Gray Fiberglass
- Fuel Station - 40 Gallon
- HD Digital Antenna w/ Park Cable Hookup
- Hi Def 3M Graphics
- Hi Rez LED Lights - Running, Flood (DS-2, Rear-2)
- Lights - Hitch, Porch, and Step
- LP - Dual 20 Lbs w/ LP Cover
- Powder Coated Chassis w/ Double Radius Entry Step
- Ramp Door w/ Cables - 7' (3,000 lbs Rating)
- Spare Tire w/ Carrier
- Stabilizer Jacks - Front & Rear
- Steel Wheels - Mod Black 15"
- Swing-away Entry Door Assist Handle
- Tank Capacities - 100 Fresh, 50 Gray, 50 Black w/ Tank Flush

Standard Features - Interior

- 2 Chairs w/ Bay Window
- 30 AMP Service
- A/C Living Room - 13/5K BTU Ducted (Not Ducted on 2315CB)
- Drive-on Metal Wheel Well (3,000 # Rating)
- Electric Bed w/ Single Lounge and Ladder (Lounge N/A 2314SF)
- Furnace - 18K BTU Ducted (Not Ducted on 2315CB)
- Glass Enclosed Shower (2314SF, 2714SF ONLY)
- I-Beam Chassis w/ Z-Style Outriggers
- Interior LED Lights w/ Dimmer
- Lumber Core Screwed Cabinets
- Medicine Cabinet
- Microwave - Range Hood - Range/Oven
- Pillowtop Mattress w/ Bedspread
- Pleated Shades
- Porcelain Toilet
- Rapid Charge Converter
- Refrigerator - Large Double Door
- Solid Surface Galley Top - Drop Range w/ Glass Cover
- SS Single Bowl Galley Sink w/ Pull-out Faucet
- Stereo - AM/FM/BT/DVD w/ Exterior Speakers
- Top Stitch Deluxe Furniture
- USB Chargers - 12V (One in Galley & One in Bedroom)
- Water Heater - 6 Gal DSI (Quick Recovery)



ICONIC



2515AK



2715SF

Interior Colors

- Graystone w/ Black Stone Cherry Wood
- Lightning w/ Skybrush Wood

Hi Def Exterior Graphics

- Gray

Optional Upgrades

- A/C Living Room - 15K BTU
- Aluminum Wheels - Deluxe 15" Black
- Black Aluminum Fender Skirts
- Corsa Furniture Trim
- CSA Canada
- Electric Bed / Dinette (Bottom Bunk) (N/A 2314SF)
- Enclosed Tanks - Heated
- Folding Dinette IPO Chairs
- Folding Roof Ladder
- Generator - 3.5K Portable (2315CB Only)
- Generator - 4.0K Onan w/ Transfer Switch (N/A w/ 3.5 Gen)
- Living Room Slideout - Roadside (2515AK & 2715SF Only)
- LP - Dual 30 Lbs
- Power Tongue Jack
- Rear Screen Wall
- Skylight Over Shower (N/A 2315CB)
- Stainless Steel Appliances
- Solar Panel - 160 Watt
- TV - Living Room (28" Class)
- Winterize

Glass Package (Gray) Includes:

- Fiberglass Sidewalls - Aluminum Framed (Laminated)
- Ultra Strong Bonded Floor

Iconic Prolite Models:

- 2315CB • 2314SF • 2515AK • 2715SF

2315CB



2314SF

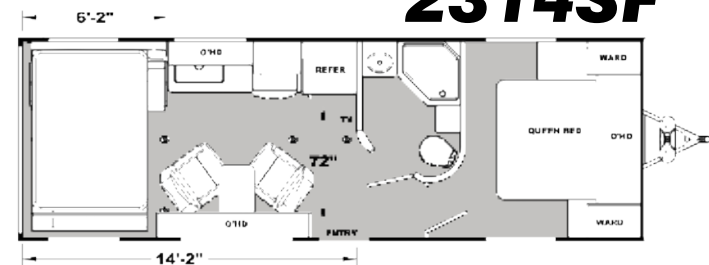

2515AK

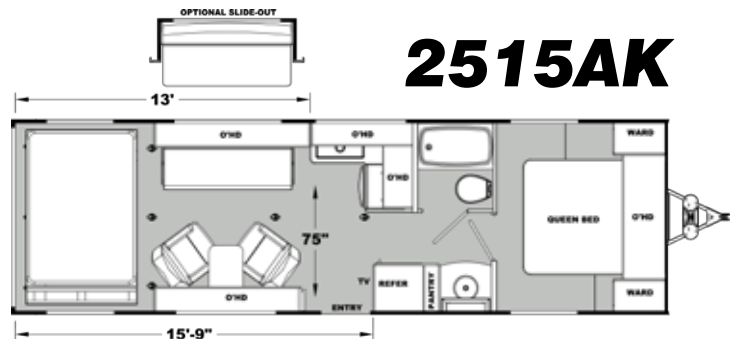

2715SF

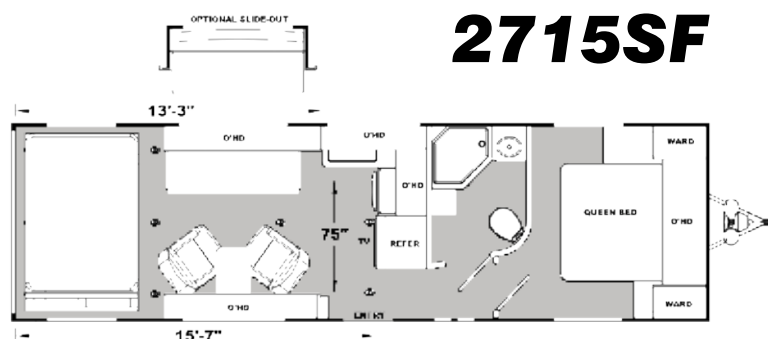

Widelite



Standard Features - Exterior

- 6,000 LB Axles w/ Zerk Fittings and Self-Adjusting Brakes (7,000 LB Axles on FW) (8,000 LB Axles on 3221CKG)
- Aluminum Wheels - Deluxe 15" Black (16" on 2816SWG) (Deluxe 16" Black w/ G-Rated Tires on FW)
- Black Aluminum Fender Skirts
- Curbside Under Glow LED Lighting
- Decked Walk-on Roof
- Electric Awning w/ LED Light
- Exterior Shower
- Fuel Station - 40 Gallon
- Generator 4.0K Onan w/ Transfer Switch
- Gray Fiberglass Caps - Front (w/ LED)
- Gray Fiberglass Sidewalls - Aluminum Framed (Laminated)
- HD Digital Antenna w/ Park Cable Hookup
- Hi Rez LED Lights - Running, Light Bar, Flood (DS-2, Rear-2)
- LP - Dual 30 Lbs (w/ Custom LP Cover on TT's)
- Powder Coated Chassis w/ Dbl Rad Entry Step (Triple on FW)
- Power Tongue Jack on TT's
- Ramp Door w/ Cables - 7' (7.5' on FW) - 3,000 Lbs Rating
- Ramp Door Cable Kit
- Spare Tire w/ Carrier
- Stabilizer Jacks - 4 (High Clearance) (2-Rear on FW)
- Swing-away Entry Door Assist Handle
- Tank Capacities - 150 Fresh, 50 Gray, 50 Black w/ Tank Flush
- Ultra Strong Bonded Floor

Standard Features - Interior

- 2 Chairs with Bay Window
- 30 AMP Service
- A/C Living Room - 15K BTU Ducted
- Drive-on Metal Wheel Well (3,000# Rating) (2816SWG & 3221CKG Only)
- Electric Bed w/ Dinette (Bottom Bunk) and Ladder
- Furnace - 30K BTU Ducted
- Glass Enclosed Shower w/ Skylight
- LED Lights w/ Dimmer
- Lighted Solid Surface Galley Top - Drop Range w/ Glass Cover
- Microwave w/ Built-in Range Hood - Range/Oven
- Pillowtop Mattress w/ Bedspread and Shams
- Pleated Shades
- Refrigerator - Large Double Door (2817CKG, 3221CKG, TT Only)
- Refrigerator - Side-by-Side (2814SG & 3016SG Only)
- Stainless Steel Single Bowl Galley Sink w/ Pull-out Faucet & Water Filter
- Stereo - AM/FM/CD/DVD/BT w/ App-Controls and Ext Speakers
- TV - Living Room (32" Class) (50" Class on 2814IK, 2814SG, 3214IKG) (50" & 32" Class on 3016IK, 3016SG)
- USB Chargers - 12V (One by Electric Bed & One in Bedroom)
- Water Heater - 6 Gal DSI (Quick Recovery)

Optional Upgrades

- 2nd A/C Bedroom - 13.5K BTU (Req's 5.5 Gen Opt)
- 6-Point Electric Auto-Leveling (FW Only)
- Aluminum Wheels - Deluxe 16" (3220SWG Only)
- Ceiling Fan - 12V
- Corsa Furniture Trim
- CSA Canada
- Enclosed Tanks - Heated
- Fantastic Fan in Bathroom
- Folding Dinette IPO Chairs (N/A 2814IK, 3016IK, 3214IKG, 2814SG, 3016SG)
- Folding Roof Ladder
- Generator - 5.5K Onan w/ Transfer Switch & 50AMP
- Inverter - 1800 Watt
- Kicker Stereo System w/ App Controls

- Living Room Slideout - Roadside (STD on 2814IK, 3016IK, 3214IKG, 2814SG, 3016SG)
- MorRyde Ramp Patio Fence
- MorRyde Ramp Patio Steps
- Rear Screen Wall
- Refrigerator - XL Double Door (N/A 2814SG, 3016SG)
- Roadside Hi Rez LED Flood Lights (2)
- Solar Panel - 160 Watt
- Stainless Steel Appliances
- TV - Bedroom (28" Class)
- Wardrobe Slideout
- Water Heater - 10 Gal DSI/Electric
- White Countertops (STD w/ Lightning Interior)
- Windows - Frameless
- Winterize

Interior Colors

- Graystone w/ Black Stone Cherry Wood
- Lightning w/ Skybrush Wood

Hi Def Exterior Graphics

- Gray

Centurion Package Includes:

- Solid Surface Lavy Top w/ Glass Bowl & Deluxe Faucet

Iconic Widelite Models:

- 2816SWG (TT) • 2814IK(TT) • 3016IK (TT)
- 3220SWG (TT) • 3214IKG (TT)
- 2817CKG (5W) • 2814SG (5W) • 3016SG (5W)
- 3221CKG (5W)

Iconic Widelite Travel Trailer Models:

2814IK



2816SWG

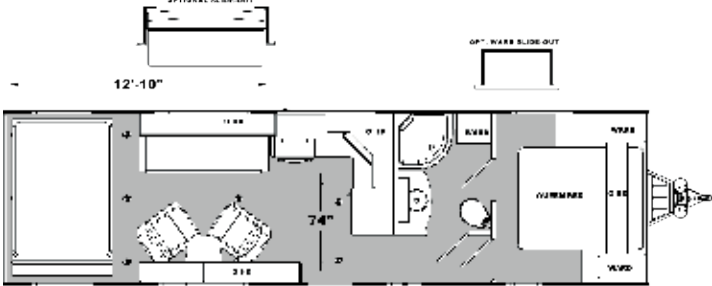

3016IK



3220SWG

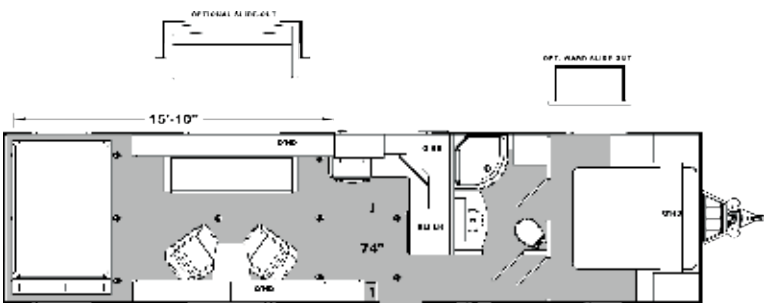

3214IKG



Iconic Widelite Fifth Wheel Models:

2817CKG

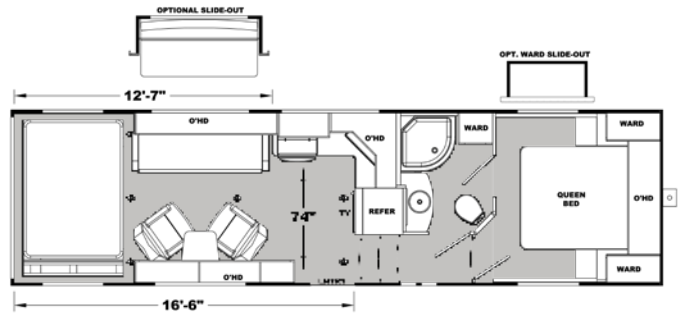

2814SG

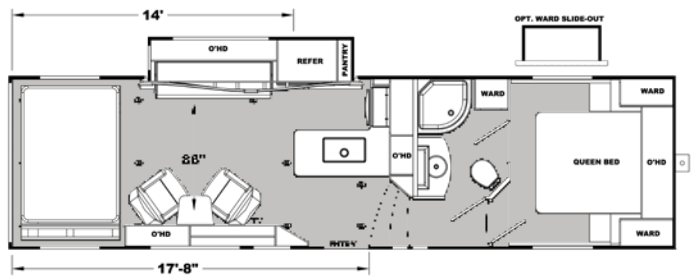

3016SG

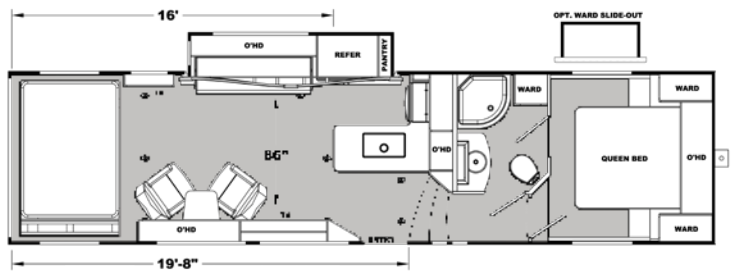

3221CKG

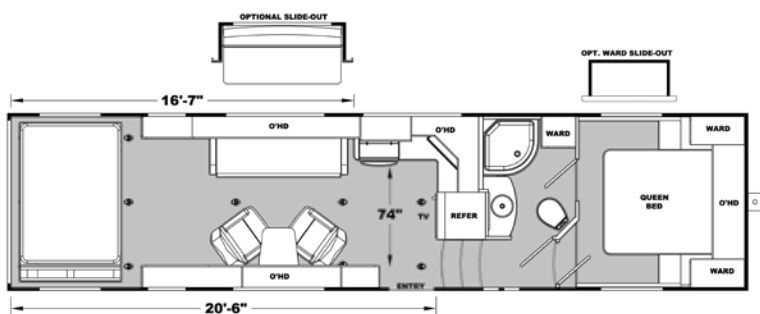

Widebody 5th Wheels



Standard Features - Exterior

- 7,000 LB Axles w/ Zerk Fittings and Self-Adjusting Brakes (8,000 LB Axles on 3117CL)
- Aluminum Wheels - Deluxe 16" Black w/ G-Rated Tires
- Backup Camera Ready
- Black Aluminum Fender Skirts
- Curbside Under Glow LED Light
- Electric Awning w/ LED Light
- Exterior 40" Class TV w/ Luggage Door (N/A 3117CL)
- Folding Roof Ladder w/ Decked Walk-on Roof
- Fuel Station - 40 Gallon
- Generator 5.5K Onan w/ Transfer Switch
- Gray Fiberglass Caps - Front (w/ LED)
Full Turning Radius 88°
- Gray Fiberglass Sidewalls - Aluminum Framed (Laminated)
- HD Digital Antenna w/ Park Cable Hookup
- Hi Rez LED Lights-Running, Light Bar, Flood (DS-2, RS-2, Rear-2)
- Lights - Hitch and Step
- LP - Dual 30 Lbs
- Powder Coated Chassis w/ Triple Radius Entry Step
- Ramp Door w/ Cables - 7.5' (3,000 lbs Rating)
- Spare Tire w/ Carrier
- Stabilizer Jacks - Rear (High Clearance)
- Swing-away Entry Door Assist Handle
- Tank capacities - 150 Fresh, 50 Gray, 50 Black w/ Tank Flush
- Ultra Strong Bonded Floor

Standard Feature - Interior

- A/C Living Room - 15K BTU Ducted
- Ceiling Fan - 12V
- Electric Bed w/ Dinette (Bottom Bunk) and Ladder
- Furnace - 30K BTU Ducted
- Glass Enclosed Shower w/ Skylight
- In-Floor Beaver Tail Storage
- LED Lights w/ Dimmer
- Lighted Solid Surface Galley Top - Drop Range w/ Glass Cover
- Microwave w/ Built-in Range Hood - Range/Oven
- Pillowtop King Mattress w/ Bedspread and Shams
- Pleated Shades
- Refrigerator - Large Double Door (N/A 3515IKG, 3518IKG)
- Refrigerator - Side-by-Side 4-Door (3515IKG, 3518IKG Only)
- Stainless Steel Galley Sink w/ Pull-out Faucet & Water Filter
- Stereo - AM/FM/CD/DVD/BT w/ App Controls and Ext Speakers
- TV - Living Room (32" Class) (50" Class on 3515IKG, 3518IKG)
- USB Chargers - 12V (One by Electric Bed & One in Bedroom)
- Water Heater - 6 Gal DSI (Quick Recovery)

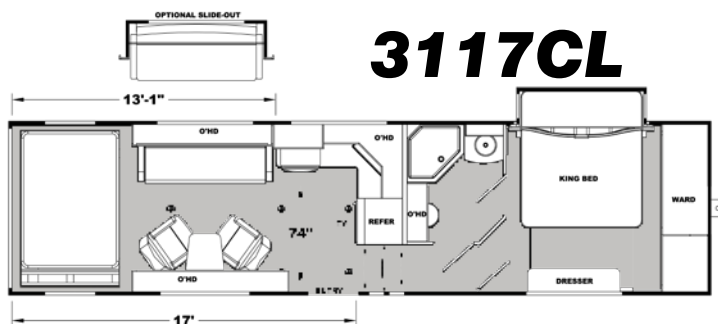

ICONIC



3515IKG



3515IKG



3515IKG

Interior Colors

- Graystone w/ Black Stone Cherry Wood
- Lightning w/ Skybrush Wood

Hi Def Exterior Graphics

- Gray

Optional Upgrades

- 2 Extra Chairs
- 2nd A/C Bedroom - 13.5K BTU
- 2nd Electric Awning w/ LED Light (35 & 39 Only)
- 6-Point Electric Auto Leveling
- 7.0KW Generator w/ Rear 13.5 A/C (3515IKG, 3926CL Only)
- Central Vacuum System
- Corsa Furniture Trim
- CSA Canada
- Enclosed Tanks - Heated
- Exterior TV Bracket & Hookups (3117CL Only)
- Extra 40 Gallon Fuel Tank (N/A 3515IKG)
- Extra 70 Gallon Fresh Water (N/A 3515IKG)
- Extra Cargo - 3' (3515IKG Only)
- Fantastic Fan in Bathroom
- Folding Dinette IPO Chairs (3117CL Only)
- Folding Dinette w/ Table (3926CL Only)
- Inverter - 1800 Watt
- Kicker Stereo System w/ App Controls
- Lighted Logo Soffit (N/A 3117CL)
- Living Room Slideout - Roadside (STD on 3515IKG & 3518IKG)
- Onan Energy Command 30 Auto-Start for Generator
- MorRyde Ramp Patio Fence
- MorRyde Ramp Patio Step
- Rear Screen Wall
- Rear TV Entertainment (50" Class) (3518 & 3926 Only)
- Refrigerator - XL Double Door (N/A 3515IKG, 3518IKG)
- Solar Panel - 160 Watt
- Stainless Steel Appliances
- TV - Bedroom (28" Class)
- Water Heater - 10 Gal DSI/Electric
- White Countertops (STD w/ Lightning Interior)
- Windows - Frameless
- Windows - Thermo Pane
- Winterize
- Wireless Backup Camera

Iconic Widebody 5th Wheels:

- 3117CL • 3422CL • 3515IKG • 3518IKG
- 3926CL

3515IKG

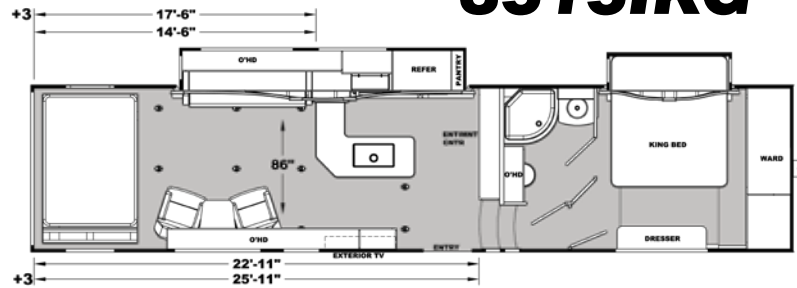

3926CL

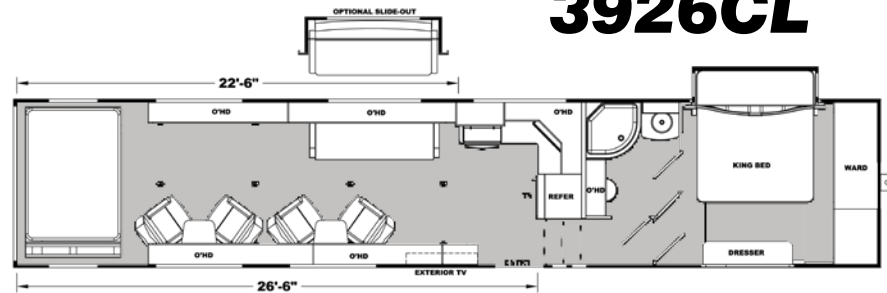

4028CL



Centurion Package Includes:

- Solid Surface Lavy Top w/ Glass Bowl & Deluxe Faucet

Garage 5th Wheels



Standard Features - Exterior

- 7,000 LB Axles w/ Zerk Fittings and Self-Adjusting Brakes
- Aluminum Wheels - Deluxe 16" Black w/ G-Rated Tires
- Backup Camera Ready
- Black Aluminum Fender Skirts
- Curbside Under Glow LED Lighting
- Electric Awning w/ LED Light
- Enclosed Tanks - Heated
- Exterior Shower
- Folding Roof Ladder w/ Decked Walk-on Roof
- Fuel Station - 40 Gallon
- Generator - 5.5K Onan w/ Transfer Switch
- Gray Fiberglass Caps - Front (w/ LED) - Full Turning Radius 88°
- Gray Fiberglass Sidewalls - Aluminum Framed (Laminated)
- HD Digital Antenna w/ Park Cable Hookup
- Hi Rez LED Lights-Running, Light Bar, Flood (DS-2, RS-2, Rear-2)
- Lights - Hitch and Step
- LP - Dual 30 lbs
- Powder Coated Chassis w/ Triple Radius Entry Step
- Ramp Door w/ Cables - 7.5' (3,000 lbs Rating)
- Spare Tire w/ Carrier
- Stabilizer Jacks - Rear (High Clearance)
- Swing-away Entry Door Assist Handle
- Tank Capacities - 150 Fresh, 80 Gray, 50 Black w/ Tank Flush
- Ultra Strong Bonded Floor
- Windows - Extra Large Tinted

Standard Features - Interior

- 50 AMP Service
- A/C Living Rom - 15K BTU Ducted, Bedroom 13.5K BTU
- Ceiling Fan - 12V
- Central Vacuum System
- Electric Bed w/ Dinette (Bottom Bunk) and Ladder
- Furnace - 30K BTU Ducted
- Glass Enclosed Shower w/ Skylight
- Heavy Duty Flooring in Garage w/ In-Floor Beaver Tail Storage
- Kicker Stereo System w/ App Controls & Outside Speakers
- LED Lights w/ Dimmer
- Lightened Solid Surface Galley Top
- Drop Range w/ Glass Cover
- Medicine Cabinet w/ Crown Molding
- Microwave w/ Built-in Range Hood
- MorRyde Ramp Door Patio Fence
- Pillowtop King Mattress w/ Bedspread and Shams
- Pleated Shades
- Rear Screen Wall
- Refrigerator - Large Double Door (2 on 3914CI)
- Refrigerator - Side-by-Side 4-Door (3613CI)
- Stainless Steel Single Bowl Galley Sink w/ Pull-out Faucet & Water Filter
- Theater Seating w/ Recliners
- TV - Living Room (50" Class)
- USB Chargers - 12V (One by Electric Bed & One in Bedroom)
- Water Heater - 10 Gal DSI/Electric (Quick Recovery)



Interior Colors

- Graystone w/ Black Stone Cherry Wood
- Lightning w/ Skybrush Wood

Hi Def Exterior Graphics

- Gray

Optional Upgrades

- 2 Extra Chairs
- 2nd Electric Awning w/ LED Light
- 7.0KW Generator w/ Rear 13.5 A/C
- Corsa Furniture Trim
- CSA Canada
- Extra 40 Gallon Fuel Tank (3616CI Only)
- Extra Cargo - 3' (N/A 3914CI)
- Fantastic Fan in Bathroom
- Fireplace - Electric
- Half Bath w/ Folding Wall
- Inverter - 1800 Watt
- Linc Pad Universal Control
- MorRyde Ramp Patio Step
- Refrigerator - XL Double Door (2) (39TSG Only)
- Solar Panel - 160 Watt
- Stainless Steel Appliances
- TV - Bedroom (28" Class)
- TV - Garage w/ Inside-Outside Bracket (28" Class)
- Washer/Dryer Ready (N/A w/ Half Bath Opt)
- White Countertops (STD w/Lightning Interior)
- Windows - Frameless
- Windows Thermo Pane
- Winterize
- Wireless Backup Camera

Centurion Package - Includes:

- Solid Surface Lavy Top w/ Glass Bowl & Dlx Faucet

Power Package - Includes:

- 6-Point Electric Auto Leveling
- Onan Energy Command 30 Auto-Start Generator

3613CI



3914CI

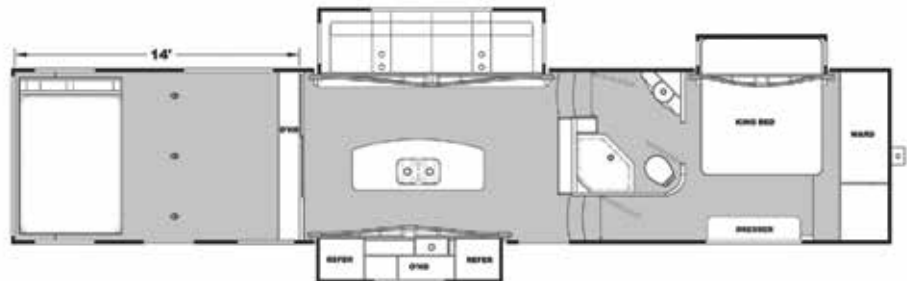

Iconic Garage

5th Wheel Models:

- 3613CI • 3616CI • 3914CI



3914Ci



3914Ci

Buy Locally

ICONIC

Eclipse Recreation Vehicles Inc. strongly encourages our retail customers to purchase from their local dealership whenever possible.

Gray Graphics



Ramp Door Patio Fence Option



What is the Hottest Toyhauler?

ICONIC

It's all about ICONIC: Iconic offers exceptional innovation, function, and design to meet your expectation for a fun-filled adventure. Whether you play in the dunes with toys, camp in the wild or enjoy the beach, the Iconic is right for you. Eclipse RV built Iconic with you in mind. We offer our customers the ultimate value. Our customers needs and desires were collectively gathered to create the best toyhauler in the industry. We offer choices, whether it be a lightweight 19-foot toyhauler or a 39-plus foot luxurious widebody. We have our customers to thank for our growing success: friends are referring friends!

Limited	GVWR	Dry Weight	Hitch Weight	Axle Weight	Exterior Height	O.A. Length	Fresh Water	Gray Water	Black Water	LP Capacity
1913CB-LE	9900	5540	660	4880	11'-8"	26'-1"	100 Gal.	50 Gal.	50 Gal.	40#
2114SF-LE	9900	6550	880	5670	11'-8"	28'-10"	100 Gal.	50 Gal.	50 Gal.	40#
Pro-Lite	GVWR	Dry Weight	Hitch Weight	Axle Weight	Exterior Height	O.A. Length	Fresh Water	Gray Water	Black Water	LP Capacity
2315CB	9900	6575	720	5855	11'-8"	30'-1"	100 Gal.	50 Gal.	50 Gal.	40#
2314SF	9900	6428	913	5515	11'-8"	29'-3"	100 Gal.	50 Gal.	50 Gal.	40#
2515AK	9900	7010	1010	6000	11'-8"	30'-8"	100 Gal.	50 Gal.	50 Gal.	40#
2715SF	9900	6940	915	6025	11'-8"	31'-9"	100 Gal.	50 Gal.	50 Gal.	40#
Wide Lite	GVWR	Dry Weight	Hitch Weight	Axle Weight	Exterior Height	O.A. Length	Fresh Water	Gray Water	Black Water	LP Capacity
2816SWG	12000	7280	1060	6220	11'-10"	34'-4"	150 Gal.	50 Gal.	50 Gal.	60#
2814IK	13000	9443	1506	7937	12'-1"	35'-4"	150 Gal.	50 Gal.	50 Gal.	60#
3016IK	13500	9340	1360	7980	12'-1"	37'-4"	150 Gal.	50 Gal.	50 Gal.	60#
3220SWG	13000	8495	1390	7105	11'-10"	37'-4"	150 Gal.	50 Gal.	50 Gal.	60#
3214IKG	13500	9390	1470	7920	12'-1"	37'-4"	150 Gal.	50 Gal.	50 Gal.	60#
Wide Lite 5th Wheel	GVWR	Dry Weight	Hitch Weight	Axle Weight	Exterior Height	O.A. Length	Fresh Water	Gray Water	Black Water	LP Capacity
2817CKG	14000	8755	2035	6720	12'-11"	31'-9"	150 Gal.	50 Gal.	50 Gal.	60#
2814SG	14000	10388	2324	8064	12'-11"	33'-0"	150 Gal.	50 Gal.	50 Gal.	60#
3016SG	14000	10933	2433	8500	12'-11"	35'-0"	150 Gal.	50 Gal.	50 Gal.	60#
3221CKG	14000	9273	2243	7030	12'-11"	35'-9"	150 Gal.	50 Gal.	50 Gal.	60#
Wide Body 5th Wheel	GVWR	Dry Weight	Hitch Weight	Axle Weight	Exterior Height	O.A. Length	Fresh Water	Gray Water	Black Water	LP Capacity
3117CL	16000	10690	2690	8000	13'-3"	34'-4"	150 Gal.	50 Gal.	50 Gal.	60#
3422CL	18000	11280	3590	7690	13'-3"	35'-10"	150 Gal.	50 Gal.	50 Gal.	60#
3515IKG	18000	12100	3120	8980	13'-3"	38'-10"	150 Gal.	50 Gal.	50 Gal.	60#
3518IKG	18000	12540	3260	9280	13'-3"	41'-10"	150 Gal.	50 Gal.	50 Gal.	60#
3926CL	18000	12400	2870	9530	13'-3"	43'-10"	150 Gal.	50 Gal.	50 Gal.	60#
Garage 5th Wheel	GVWR	Dry Weight	Hitch Weight	Axle Weight	Exterior Height	O.A. Length	Fresh Water	Gray Water	Black Water	LP Capacity
3613CI	18000	13360	2560	10800	13'-3"	39'-6"	150 Gal.	40&40 Gal.	50 Gal.	60#
3616CI	18000	13528	2883	10645	13'-3"	42'-6"	150 Gal.	40&40 Gal.	50 Gal.	60#
3914CI	18000	13980	3100	10880	13'-3"	42'-10"	150 Gal.	40&40 Gal.	50 Gal.	60#



Gray Graphics with Gray Glass



1913CB-LE Corrugated Thermal Gray



All product data, graphics and photography in this brochure were as accurate as possible at press time. Subsequent refinements during the model year may be evident in the actual product. Eclipse RV, Inc. reserves the right to change prices, colors, mater equipment and specifications without notice - as well as to add, modify or discontinue models shown in promotional materials and / or on it website. Unloaded vehicle weight and carrying capacities will vary upon optional equipment.

Manufactured by Eclipse Recreational Vehicles, Inc.
3016 Kansas Ave., #14, Riverside, CA 92507
(951) 684-6868

www.AttitudeToyhaulers.com
www.instagram.com/attituderv/

