

ZINGER

By CrossRoads



ZINGER
By CrossRoads



CrossRoads



ZT31SB Kitchen

Family Camping!

The Zinger travel trailers and fifth wheels are engineered for the camping family in mind. The Zinger is available in 15 floor plans in which 10 are bunkhouse models. Throughout the Zinger you find cherry stained cabinetry accented with brush nickel hardware. The cabinet doors and drawer fronts are backed by the manufacturer's lifetime limited warranty.

The u-shaped dinette in the 31 SB provides plenty of room for the family at meal time and it also converts into an extra sleeping area. Every Zinger passes a comprehensive 96-point inspection before it ever leaves the factory.



ZT31SB Kitchen with LCD TV

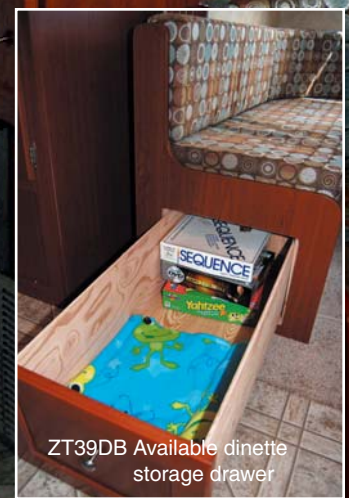

ZT39DB Available dinette storage drawer



ZT39DB

The spacious living room features overhead cherry stained cabinets and designer sofa. The entire family will enjoy the large U-shaped dinette at dinner time. For extra sleeping space the dinette converts into another bed.



ZT31SB Bathroom vanity



ZT31SB Bedroom with double wardrobe



ZT31SB Rear bunk with storage

1



2



3



The Zinger's bedroom is a place you can truly relax. It's highlighted by a queen size innerspring mattress with beautifully styled bedspread and custom designed headboard. You'll also appreciate the roomy storage space, including two wardrobe closets with deluxe mirrored doors. In the back of the 31SB, the entire family will enjoy a separate entertainment center and extra storage built into the door side bunk. On the opposite side, the fold down sofa with pull-out trundle and flip up bunk provide plenty of sleeping areas in just a couple of seconds.

ZINGER



Construction Standards

1. One-piece rubber roof with 12 year manufacturer's warranty
 2. 3/8" walkable roof decking
 3. 16" OC truss rafters with 4 1/2" crown
 4. R-7 Rated fiberglass roof insulation
 5. Rain gutters along entire roof line
 6. 13,500 Ducted A/C (ZT19RD is not ducted) *
 7. 25,000 BTU floor ducted furnace (30,000 in 32QB, 31SB and 37DB travel trailers)
 8. 16" OC stud placement in sidewalls, endwalls and slide rooms
 9. 5/8" Lightweight tongue and groove plywood floor decking
 10. R-7 Rated fiberglass sidewall insulation
 11. 16" OC 2 x 3 floor joists
 12. Steel I-beam frame (varies by model)
 13. R-7 Rated fiberglass floor insulation
 14. 1/2" Foam rubber carpet pad
 15. Residential grade carpet
 16. Maximum amount of linoleum throughout
 17. Optional bedroom carpet
 18. Tires with white spoked rims
 19. Moisture barrier wrapped floor
 20. 30" Radius entry door with screen
- Exterior Standards**
21. Radius exterior cargo doors
 22. Dual 30 lb. LP tanks
 23. Diamond plate stone guard *
 24. Lightly tinted glass windows
 25. Swing-out entry assist handle (optional)
 26. Sunchaser patio awning *
2 Exterior speakers

2 year tire manufacturer's roadside assistance



Talk about storage! This extra large cargo hold is accessible from both sides. (ZT32QB)



A separate rear door enters directly into a large bunkhouse with several bunks. (ZT31SB and ZF29BS)



This cargo area shows strong, lightweight aluminum floor joists that support fifth wheel upper decks. (ZF29BS)



An electric powered awning is available to help keep you cool on those hot summer days with a push of a button.

* Included in Convenience Package

Standards stated throughout are partial lists only. See your dealer or www.crossroadsrv.com for a complete listing.

ZINGER

FLO

FIFTH WHEELS

TRAVEL TRAILERS

ZF25BH

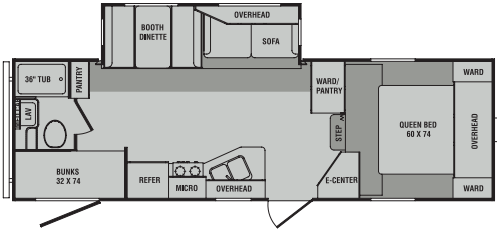

ZF29BS

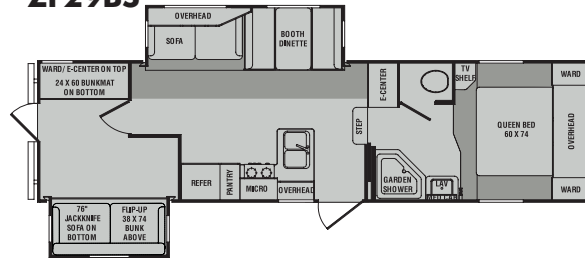

ZT19RD

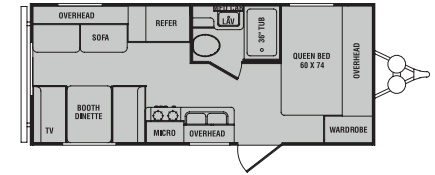

ZF27RL

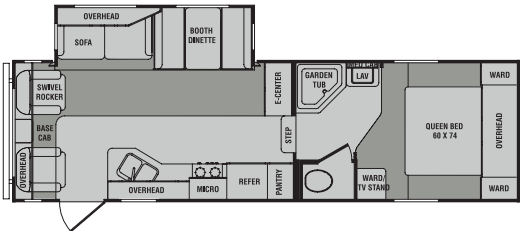

ZF30RB

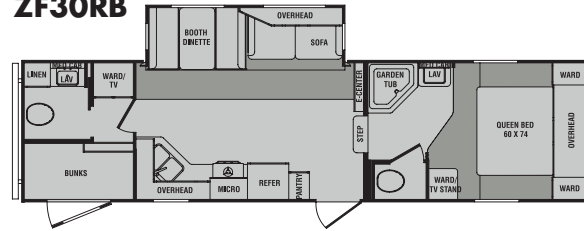

ZT25RK

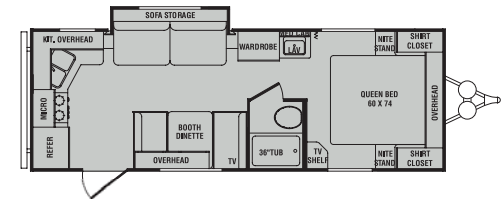

Fifth Wheel Tanks

- Fresh water capacity - 40 gallons
- Black water capacity - 40 gallons (except ZF30RB = 80 gallons)
- Grey/galley capacity - 80 gallons

Zinger Warranty

Every CrossRoads product is backed by one of the industry's best warranty plans. For details, please visit our website at www.crossroadsrv.com.



We invite you to compare our quality, value, service program, and warranty plan with those of our competition. You'll find we are unsurpassed in all four.

Specifications	ZF25BH	ZF27RL	ZF29BS	ZF30RB	ZT19RD	ZT25RK	ZT26BH	ZT26RL	ZT27BH
Dry Weight	6200	6541	7211	7550	3984	4519	5517	5597	4479
Carrying Capacity	4973	4602	3992	3758	3259	2769	2096	1866	2969
Hitch Weight	1270	1240	1300	1405	535	580	905	755	740
Awning Size	14'	18'	14'	18'	16'	16'	16'	16'	16'
Ext. Height with AC	11' 8"	11' 11"	11' 8"	12' 3"	10' 2"	10' 2"	10' 8"	10' 8"	10' 2"
Exterior Length	27' 2"	29' 3"	31' 11"	32' 11"	22' 11"	26' 9"	29' 11"	29' 11"	28' 7"
Tire Size	225/75D15	225/75D15	225/75D15	225/75D15	205/75D14	205/75D14	205/75D15	205/75D15	205/75D14

FLOOR PLANS

ZT26BH

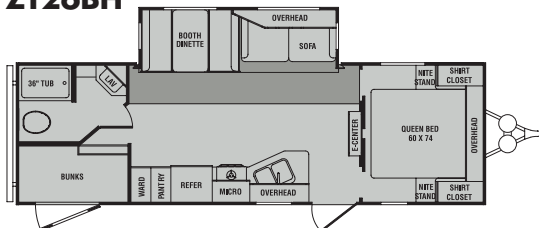

ZT29DB

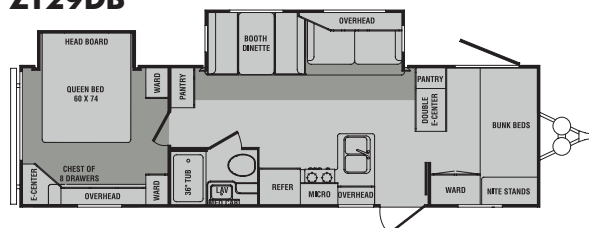

ZT32QB

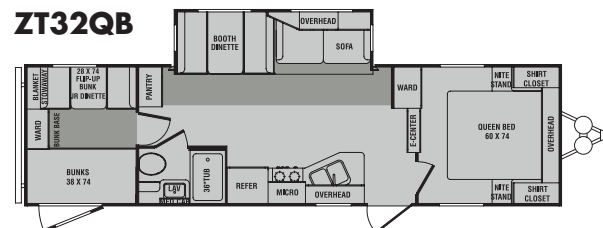

ZT26RL

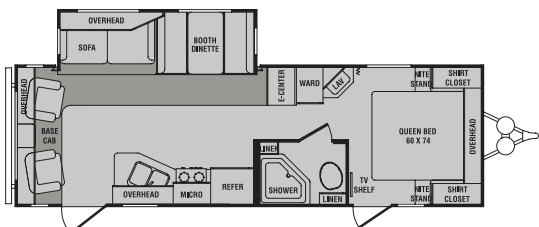

ZT29DS

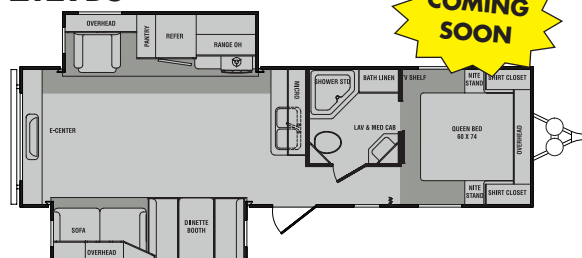

COMING SOON

ZT31SB

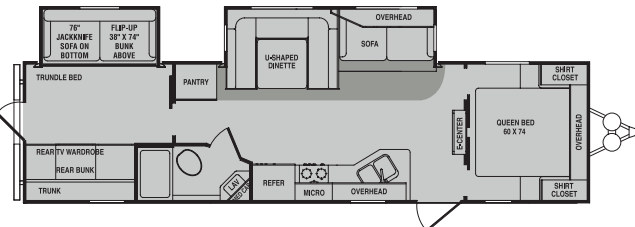

ZT27BH

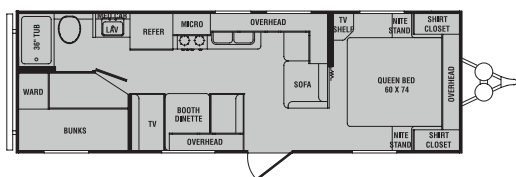

ZT30BH

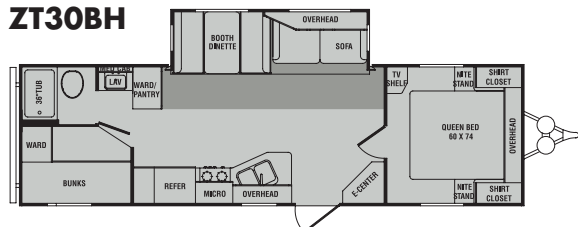

DESTINATION TRAILERS

ZT39DB

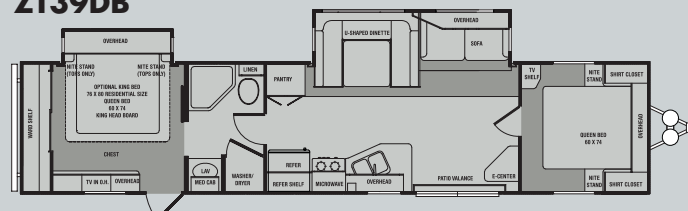

ZT39BH

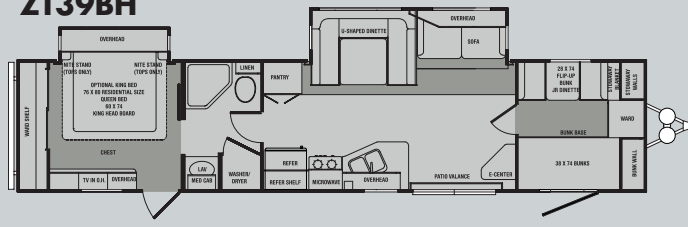

ZT29DB	ZT29DS	ZT30BH	ZT31SB	ZT32QB	ZT39DB	ZT39BH
6662	TBD	5640	7315	6000	8556	8736
4061	TBD	1933	3648	1718	4092	3912
880	TBD	865	1095	1010	1154	1250
18'	TBD	16'	18'	18'	20'	20'
10' 10"	TBD	10' 8"	10' 10"	10' 8"	11' 7"	11' 7"
32' 10"	TBD	32'	35' 6"	33' 10"	41' 6"	41' 6"
205/75D15	TBD	205/75D15	225/75D15	205/75D15	LT7.50-16	LT7.50-16

Travel Trailer Tanks

- Fresh water capacity - 40 gallons
- Black water capacity - 40 gallons
- Grey/galley capacity - 40 gallons (39DB & 39BH = 80 gallons)

Standards & Options

ZINGER

Living Room Standards

- Booth dinette
- Mini blinds (throughout)
- Wood slide-out fascia
- Jackknife sofa
- AM/FM/CD stereo system with interior & exterior speakers
- Three décor choices
- Flush floor slide-out with large dinette window
- Generous storage
- LCD TV mounting bracket

Kitchen Standards

- Mortise and tenon shaker style upper and lower cabinet doors with manufacturer's lifetime limited warranty
- Mortise and tenon shaker style draw fronts with manufacturer's lifetime limited warranty
- Cherry cabinet drawers
- Metal side roller drawer guides
- Formica countertop with T-mold edging
- Microwave oven
- 17" Range with oven
- 6 cu. ft. Double door refrigerator

Bedroom Standards

- Finished cherry headboard
- Innerspring 60" x 74" mattress
- TV shelf and hook-up
- Coordinated window treatments and bedspread
- Mirrored closet with shelves underneath

Bathroom Standards

- Large white lavatory bowl
- Spacious shower/tub & one-piece surround
- Hand flush white toilet
- Linen storage (varies by floorplan)
- Lighted, mirrored medicine cabinet

Convenience Package Standards

- 3 Burner range with oven
- TV antenna
- Tub surround
- Smoke detector
- LP detector
- Diamond plate stone guard
- 13,500 BTU A/C
- Awning
- Microwave

Popular Optional Features

- 19" LCD TV
- Chrome center caps
- Insulated enclosed underbelly
- Drawers under booth dinette
- Outside shower
- Skylight over tub
- 8 cu. ft. Refrigerator
- Power vent in bath
- Swing-out assist rail
- Air mattress hide-a-bed
- Bi-fold range cover
- 15,000 BTU A/C
- 6 gallon gas/electric DSI water heater
- Safety glass
- 2 sink covers
- Electric Awning
- Rear ladder
- Range cover
- Carpet in bedroom

Your Local Dealer

Beautiful accents on the fascia enhance the interior of the Zinger



The countertops are finished off with a T-molding for a solid surface look



Brushed nickel hardware complements the cherry cabinetry



CrossRoads



888-226-7496
www.crossroadsrv.com

THOR
INDUSTRIES, INC.

Thor Industries' strong financial position and industry leadership are your assurance that we will be here to serve you for years to come.