

# MPG Ultra-Lite

Memories Per Gallon



## CRUISER RV

Great American Trailers.



# MPG Ultra-Lite

## Memories Per Gallon

We know the feeling. You want to get out there and explore this great country, but you don't want to leave a big environmental footprint behind. The MPG was engineered with you (and the planet) in mind. Like all Cruiser RV products, it's lightweight yet built to last. And it tows easily behind your fuel-efficient, half-ton vehicle. Mile for mile, it's packed with value, too. The MPG features comfy homelike furnishings, king beds, taller ceilings, outside kitchens and several great floorplans with either single or double slides and sleeping options aplenty. If you want a trailer that's built for value and fuel efficiency, the name says it all.



### Strong Foundation

- Oversized I-beam frame
- Heavy-duty axles
- Heavy-duty tires with aluminum rims
- 5/8" tongue and groove plywood flooring



### Ultra-lite Construction

- Lightweight but strong
- Azdel composite wall panels
- High-density block foam insulation
- Fully walkable roof



### Cruiser Comforts

- King bed slide system (patent pending)
- Dual ducted A/C system
- Industry-leading ceiling heights
- Extended Season RVing Package



### Camping Conveniences

- Industry-leading pass-through storage
- Full Belly Storage (patent pending)
- More drawers, cabinets and cubbies
- Power stabilizer jacks
- Wide entry door



### Cruiser Care

- Employee pride
- 100% pre-delivery testing
- State-of-the-art production & warehouse facilities
- 1-year limited factory warranty
- 3-year limited structural warranty
- Multi-year supplier warranties



### Top 5 Exterior Features

1. Azdel Composite Laminated Walls
2. Patent Pending Full Belly Storage
3. 6' 11" Barrel Roof
4. Fully Molded, Fiberglass Cap
5. 5-Sided Aluminum Construction

### Top 5 Interior Features

1. Patent Pending King Bed Slide System
2. Plywood Flooring
3. Four Speaker Soundbar System
4. Seamless Kitchen Countertops
5. Hardwood Residential Cabinets with Hidden Hinges



For more information and full technical specifications, visit our website at [cruiserrv.com](http://cruiserrv.com)



# MPG

ULTRA-LITE

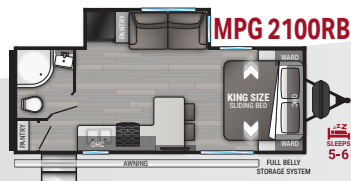

**MPG 2100RB**  
Length 25' 11"  
Height 11' 1"  
Dry 5502 lbs.  
Hitch 716 lbs.

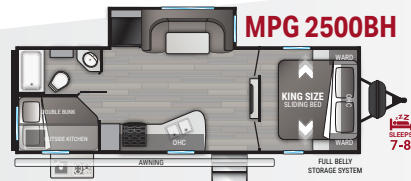

**MPG 2500BH**  
Length 29' 11"  
Height 11' 1"  
Dry 5828 lbs.  
Hitch 832 lbs.

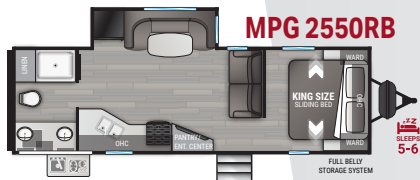

**MPG 2550RB**  
Length 30' 11"  
Height 11' 1"  
Dry 6062 lbs.  
Hitch 714 lbs.

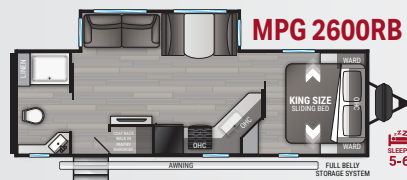

**MPG 2600RB**  
Length 30' 8"  
Height 11' 3"  
Dry 6274 lbs.  
Hitch 970 lbs.

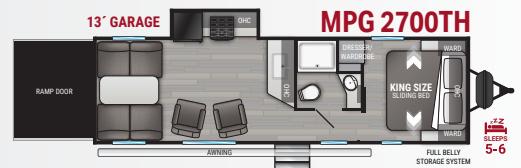

**MPG 2700TH**  
Length 31' 11"  
Height 11' 3"  
Dry 6202 lbs.  
Hitch 832 lbs.

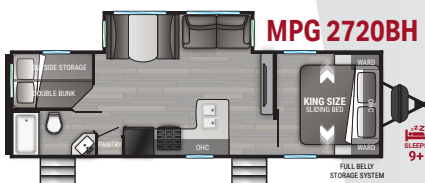

**MPG 2720BH**  
Length 31' 11"  
Height 11' 3"  
Dry 6198 lbs.  
Hitch 918 lbs.

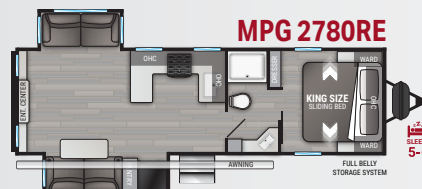

**MPG 2780RE**  
Length 31' 11"  
Height 11' 3"  
Dry 6482 lbs.  
Hitch 672 lbs.



**MPG 2800QB**  
Length 33' 4"  
Height 11' 3"  
Dry 6240 lbs.  
Hitch 740 lbs.

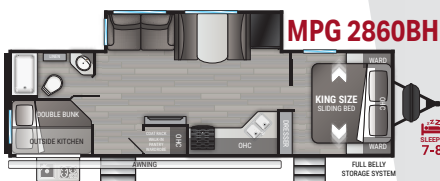

**MPG 2860BH**  
Length 32' 11"  
Height 11' 3"  
Dry 6724 lbs.  
Hitch 860 lbs.

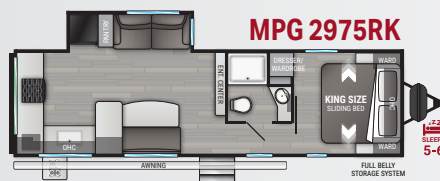

**MPG 2975RK**  
Length 33' 5"  
Height 11' 3"  
Dry 6634 lbs.  
Hitch 706 lbs.

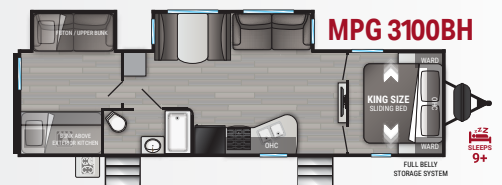

**MPG 3100BH**  
Length 36' 5"  
Height 11' 5"  
Dry 7031 lbs.  
Hitch 855 lbs.



## A Great American Trailer Company.

Since 1988, Cruiser RV has built lightweight, high-quality trailers for people who love the great outdoors. Here at Cruiser, we take the time to construct solid, hard-working trailers and toy haulers that *last*. These are the towables that help you feel safe, comfortable and free to enjoy the great American RV lifestyle. Ultra lightweight, easy to tow, and loaded with the kind of luxury and high-end features our customers expect, Cruiser RVs are easily the best value on the road. No matter what new adventure lies ahead, you'll find freedom at every turn with a Cruiser RV.

Your Local Cruiser RV Dealer:



## WE'RE BEHIND YOU ALL THE WAY.

With state-of-the-art factory service facilities and more than 400 dealers across the U.S. and Canada, you're never far from an authorized Cruiser RV dealer.



**CRUISER**RV  
Great American Trailers.



**CRUISERRV.com**

7805 North SR 9 • Howe, IN 46746 • 866-277-5630

**MADE IN THE U.S.A.**

Product information is as accurate as possible as of the date of publication of this brochure. Due to Cruiser's commitment to continuous product improvement, floorplans, materials, components, features, measurements, specifications, options, etc. are subject to change at any time without notice or obligation. In certain conditions some additional equipment may be needed. Photos may show optional equipment or props used for photography purposes only. Cruiser has listed the approximate base weight of the trailer without the optional equipment included. Optional equipment will impact the weight of the trailer. Please locate the weight sticker attached to the trailer you are considering for the most accurate trailer weight. Tow Vehicle Caution: Owners of Cruiser recreational vehicles are solely responsible for the selection and proper use of tow vehicles. All customers should consult with the motor vehicle manufacturer or their dealer concerning the purchase and use of suitable tow vehicles for Cruiser products. Cruiser disclaims any liability or damages suffered as a result of the selection, operation, use or misuse of a tow vehicle. Cruiser's limited warranty does not cover damage to the recreational vehicle or the tow vehicle as a result of the selection of the tow vehicle. Overall length for a Fifth Wheels is defined as the body length of the trailer excluding hitch meaning bumper to cap. The overall length for a Travel Trailer is defined as the body length of the trailer including hitch, meaning bumper to hitch/pin) It does not include rear ladder of spare tire. Optional pin boxes will affect overall length.