

FREELANDER

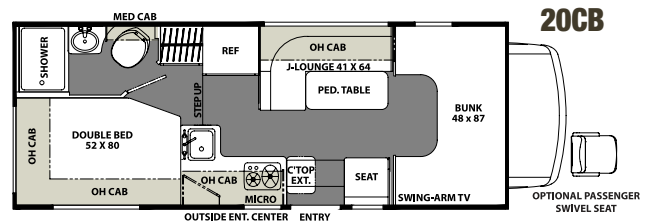

PREMIER

VALUE LEADER

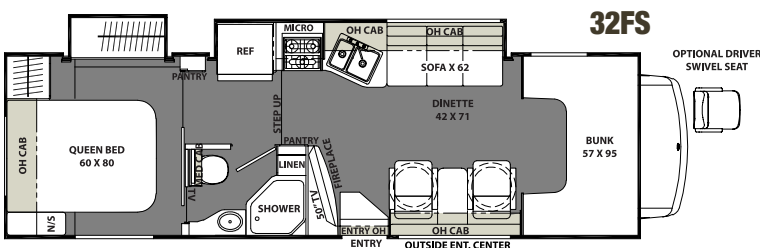
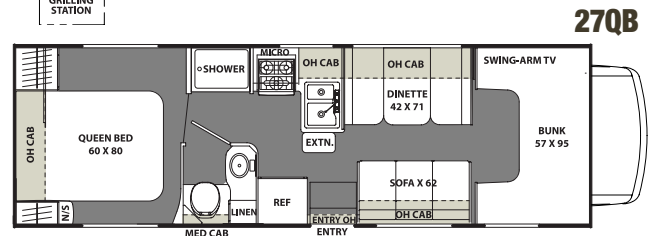
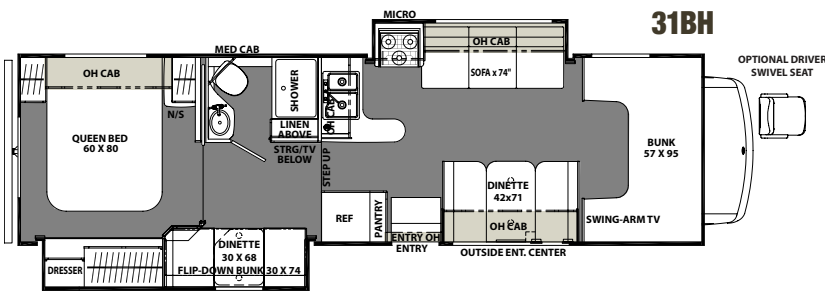
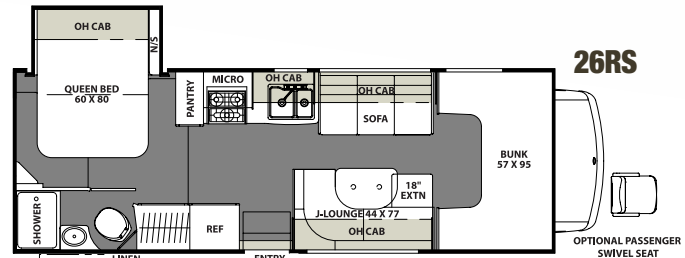
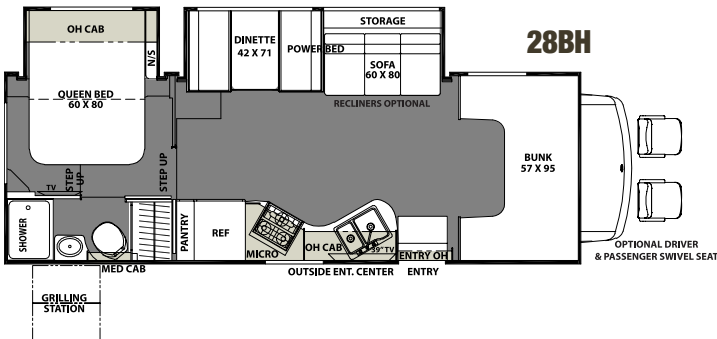
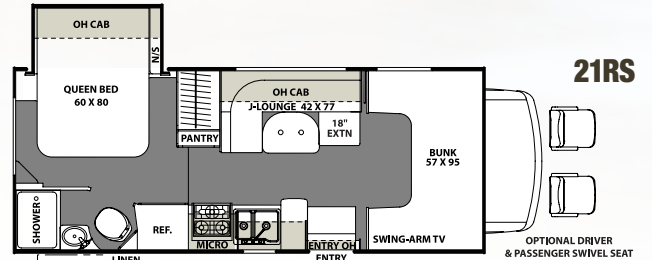
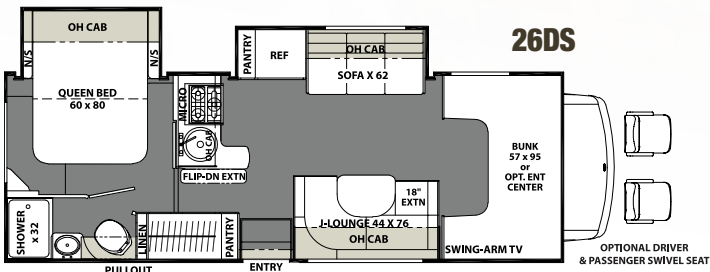
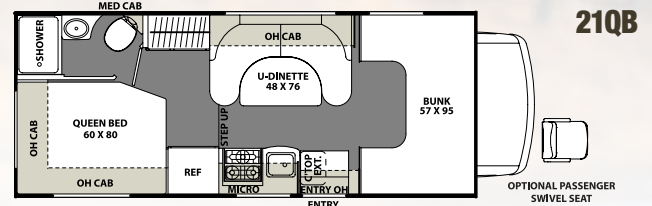
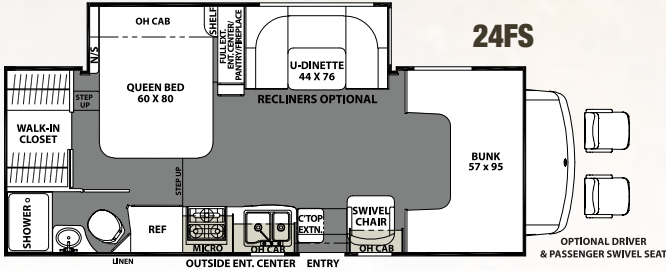

Coachmen
Leader to the Great Outdoors.

423 N. Main Street • P.O. Box 30
Middlebury, IN 46540

To learn more about Coachmen RV and our products and see how Coachmen is making the easy life easier, call us toll free at (800) 353-7383, or visit www.coachmenrv.com

SPECIFICATIONS

PREMIER

VALUE LEADER

MODEL	24FS	26DS	28BH	31BH	32FS	21QB	21RS	26RS	27QB	20CB
Chassis	4500-CHEVY / E450 FORD	4500-CHEVY / E450 FORD	450 FORD	450 FORD	450 FORD	4500-CHEVY / E350 FORD	4500-CHEVY / E350 FORD	4500-CHEVY / E350 FORD	4500-CHEVY / E350 FORD	FORD T350 TRANSIT
Engine	V8-6.0L / V10-6.8L	V8-6.0L / V10-6.8L	V8-6.0L / V10-6.8L	V10-6.8L	V10-6.8L	V8-6.0L / V10-6.8L	V8-6.0L / V10-6.8L	V8-6.0L / V10-6.8L	V8-6.0L / V10-6.8L	V6-3.7L
Horse Power	324 / 305	324 / 305	324 / 305	305	305	324 / 305	324 / 305	324 / 305	324 / 305	275
Torque	373 / 420	373 / 420	373 / 420	420	420	373 / 420	373 / 420	373 / 420	373 / 420	260
Wheel Base	183" / 182"	191" / 190"	198"	223"	208"	159" / 158"	159" / 158"	191" / 190"	191" / 190"	156"
GVWR (lbs.)	14,200 / 14,500	14,200 / 14,500	14,500	14,500	14,500	14,200 / 12,500	14,200 / 12,500	14,200 / 12,500	14,200 / 12,500	10,360
GCWR (lbs.)	20,000 / 22,000	20,000 / 22,000	22,000	22,000	22,000	20,000 / 18,500	20,000 / 18,500	20,000 / 18,500	20,000 / 18,500	12,125
UVW (approx. lbs.)	TBD	TBD / 11,487	11,580	12,307	12,088	9,478 / 9,498	10,168 / 10,156	10,888 / 10,788	10,316 / 10,294	7,824
CCC (approx. lbs.)	TBD	TBD / 3,013	2,920	2,193	2,412	4,722 / 3,002	4,032 / 2,344	3,312 / 1,712	3,884 / 2,206	2,536
GAWR Front (lbs.)	4,600 / 5,000	4,600 / 5,000	5,000	5,000	5,000	4,600 / 5,000	4,600 / 5,000	4,600 / 5,000	5,000	4,130
GAWR Rear (lbs.)	9,600	9,600	9,600	9,600	9,600	9,600 / 8,500	9,600 / 8,500	9,600 / 8,500	9,600 / 8,500	7,275
Interior Height	6' 11"	6' 11"	6' 11"	6' 11"	6' 11"	6' 10"	6' 11"	6' 11"	6' 11"	6' 9"
Exterior Width	8' 4"	8' 4"	8' 4"	8' 4"	8' 4"	8' 4"	8' 4"	8' 4"	8' 4"	7' 7"
Exterior Height (with A/C)	10' 11"	10' 11"	10' 11"	10' 11"	10' 11"	10' 10"	10' 11"	10' 11"	10' 11"	10' 6"
Exterior Length (with Hitch)	26' 9" / 26' 3"	27' 11" / 27' 5"	28' 5"	32' 11"	31' 7"	24' 6" / 24' 0"	24' 9" / 24' 3"	27' 11" / 27' 5"	30' 0" / 29' 6"	23' 9"
Hitch Weight (lbs.)	5,000 / 7,500	5,000 / 7,500	7,500	7,500	7,500	5,000	5,000	5,000	5,000	2,000
Fuel Capacity (gal.)	57 / 55	57 / 55	55	55	55	57 / 55	57 / 55	57 / 55	57 / 55	25
LP Capacity (lbs.)	68	68	68	68	68	68	68	68	40	40
Fresh Water Capacity (gal.)	50	50	43	50	50	50	50	50	40	38
Water Heater Capacity (gal.)	6	6	6	6	6	6	6	6	6	6
Grey Tank Capacity (gal.)	28	31	31	34	32	28	28	31	31	26
Black Tank Capacity (gal.)	31	31	31	31	25	22	31	31	31	21
Exterior Storage (cu. ft.)	55	60	83	77	101	92	67	60	77	60
Awning Length	17'	18'	19'	11'	21'	15'	15'	18'	20'	14'

FREELANDER MICRO



DÉCOR OPTIONS

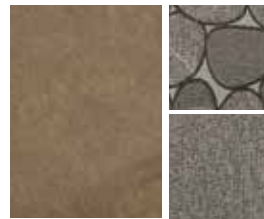

CHESTNUT



STONE MIST



Learn More
Scan this barcode using a QR Reader on your smart phone to learn more about Forest River.



A Berkshire Hathaway company.

All information contained in this brochure is believed to be accurate at the time of publication. However, during the model year, it may be necessary to make revisions and Coachmen reserves the right to make all such changes without notice, including prices, colors, materials, equipment and specifications as well as the addition of new models and the discontinuance of models shown in this brochure. Therefore, please consult with your Coachmen dealer and confirm the existence of any materials, design or specifications that are material to your purchase decision. 4/18

©Copyright 2018 Coachmen RV a Division of Forest River Inc – All Rights Reserved.

GVWR (Gross Vehicle Weight Rating) is the maximum permissible weight of the unit when fully loaded. It includes all weights, inclusive of all fluids, occupants, cargo, optional equipment and accessories. For safety and product performance do NOT exceed the GVWR.

GCWR (Gross Combined Weight Rating) is the maximum permissible loaded weight of your motor home and any towed trailer or towed vehicle. Actual GCWR of this vehicle may be limited by the sum of the GVWR and the installed hitch receiver maximum capacity rating; see hitch rating label for detail.

GAWR (Gross Axle Weight Rating) is the maximum permissible weight, including cargo, fluids, optional equipment and accessories that can be safely supported by each axle.

UVW (Unloaded Vehicle Weight) * is the typical weight of the unit as manufactured at the factory. It includes all weight at the unit's axle(s), including full fuel, all fluids and LP Gas. The UVW does not include cargo, fresh potable water, additional optional equipment or dealer installed accessories.

*Estimated Average based on standard build optional equipment.

CCC (Cargo Carrying Capacity) ** is the amount of weight available for fresh potable water, cargo, passengers, additional optional equipment and accessories. CCC is equal to GVWR minus UVW. Available CCC should accommodate fresh potable water (8.3 lbs per gallon). Before filling the fresh water tank, empty the black and gray tanks to provide for more cargo capacity.

** Estimated average based on standard build optional equipment

Each Coachmen motorhome is weighed at the manufacturing facility prior to shipping. A label identifying the unloaded vehicle weight of the actual unit and the cargo carrying capacity is applied to every Coachmen motorhome prior to leaving our facilities.

The load capacity of your unit is designated by weight, not by volume, so you cannot necessarily use all available space when loading your unit.

Actual towing capacity is dependent upon your particular loading and towing circumstances, which includes the GVWR, GAWR and GCWR as well as adequate trailer brakes. Please refer to the Operator's Manual of your vehicle for further towing information.

CUSTOMER SATISFACTION



www.ForestRiverBuyLocal.com

Your **FREELANDER** Dealer