



TRAVEL TRAILERS



Illuminating Your Next Adventure.





Each new day brings wonderment. The opportunity to discover something new. To pursue your dreams and fill your soul. This is the Soul of RVing.



COLEMAN LANTERN

MORE STANDARD FEATURES MORE VALUE

Everything we put into our innovative floorplans are designed to maximize storage and comfort. We don't stop there, to ensure peace of mind after the purchase we have the industry's best RV warranty, 100% pre-delivery inspection, and the leader in parts and service. While other manufacturers offer features as options, we prefer to make those same features standard.

We've built a reputation for bringing RV owners more standard features for less money for over 35 years, and it's a reputation we plan to keep.



100% Pre-Delivery Inspection

At Dutchmen, quality is standard. Every single RV that comes off the line receives its own pre-delivery inspection—a thorough 253-point check to ensure accurate measurements, as well as fully-functional electronics and components.



The Industry's Best RV Warranty

Our industry-best 3 Year Warranty means you don't have to wrangle over the details. We deliver value by clearly outlining the major components we back for the first three years.



The Leader In Parts & Service

Replacement parts. Routine checkups. Expert advice. We've got it all covered. When only the best RV services will suffice, our industry-leading parts and service department is ready to help you get back on the road—and stay there longer than ever before.

Tow Vehicle Disclaimer. CAUTION: Owners of Dutchmen recreational vehicles are solely responsible for the selection and proper use of tow vehicles. All customers should consult with a motor vehicle manufacturer or their dealer concerning the purchase and use of suitable tow vehicles for Dutchmen products. Dutchmen disclaims any liability or damages suffered as a result of the selection, operation, use or misuse of a tow vehicle. DUTCHMEN'S LIMITED WARRANTY DOES NOT COVER DAMAGE TO THE RECREATIONAL VEHICLE OR THE TOW VEHICLE AS A RESULT OF THE SELECTION, OPERATION, USE OR MISUSE OF THE TOW VEHICLE. REFERENCE DUTCHMEN MANUFACTURING OWNERS MANUAL FOR LIMITED WARRANTY DETAILS. © 2022 Dutchmen 11-2022-Coleman-Lantern



Dutchmen®

35TH ANNIVERSARY

Dutchmen began in 1988, this model year we are celebrating our 35th Anniversary. Our long term success comes from never losing focus on our core mission “We work for the customer”.

At Dutchmen we build a variety of floorplans to meet the needs of your family and lifestyle. More people than ever before are embracing the RV lifestyle, whether they are full timers, weekend warriors or just want to take the road less traveled and boondock.

Everything we put into our Coleman is designed not only to help you hit the road in comfort and style, but to also help you make memories with family, friends, and fellow travelers along the way.

You will have peace of mind knowing we have OVER 300 Strong Nationwide Dealer Network across North America and our industry-leading service center in Goshen, Indiana. So rest assured no matter where your travels take you, the best-resourced RV manufacturing company in the world is behind you all the way.

As each new day unfolds and limitless adventure awaits, Rving is about immersing yourself in laughter and storytelling with family and friends around the campfire. For 35 years Dutchmen has been in the business of making memories. This is the Soul of the RV.



COLEMAN LANTERN



CONNECTION



COLEMAN LANTERN



Destination: Coleman Lantern. No matter where you travel, there's always something to be found, so why not get the most out of ever camping experience. Coleman branded floorplans are loaded with added value and innovative features yet light on weight.

- **Power Plus Package** - an all around easy-to-use system that make setting up and tearing down a breeze with a power awning w/ LED lights, power stabilizer jacks and a power tongue jack.
- **Upgraded Kitchen Package** - residential appliances, high rise faucet, stainless steel farm style sink, pull out kitchen trash can (select models).
- **Solid Entry Step** - stability you need when coming and going from your Coleman. Easy to expand and store away, these aluminum steps deliver a sound platform.



To see more features,
visit [dutchmen.com](https://www.dutchmen.com)

35 YEARS ANNIVERSARY PACKAGE

SOLO

Standard on ALL Floorplans

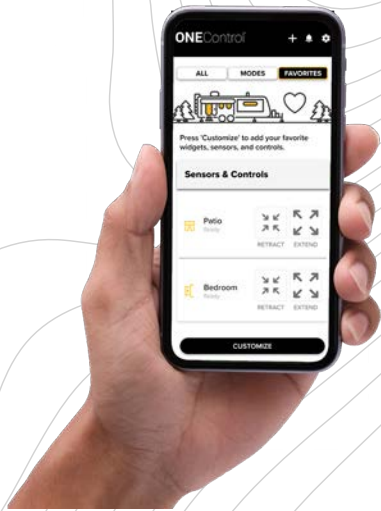

The SOLO ONE Control allows complete control over many of your RV's most important functions through a mobile app. From awnings and lighting, water tanks, and more with just a touch of a button.



SAFETY

Receive custom notifications regarding your RV maintenance reminders and system status.



CONTROL

Conveniently control your lighting, slide-outs, and awnings from the palm of your hand.



ALERTS

Receive system status, low battery voltage, and tank levels.

ON-DEMAND TANKLESS WATER HEATER



Standard features in every floor plan.



Power Stabilizer Jacks



Power Tongue Jack



Power Awning



Outside Shower



Premium Steps



USB Ports



Prepped for WIFI 4G LTE



Dual 20lb Propane Tanks

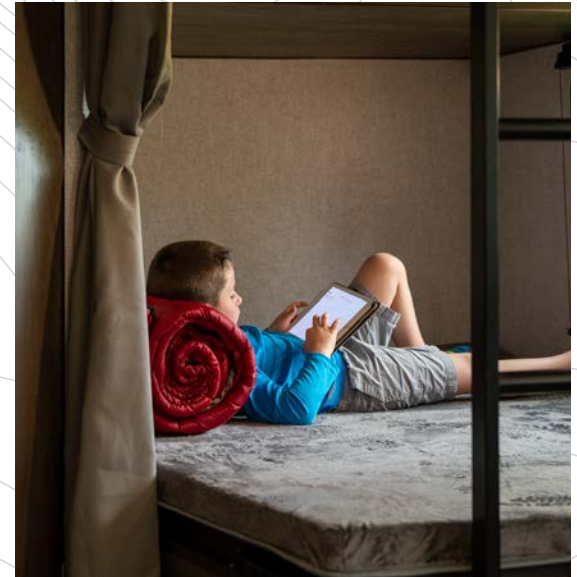

To see more features, visit dutchmen.com



FEEL AT HOME FROM THE FIRST MOMENT.



Interior Features:

With spacious floor plans and all the amenities of home,

- 60"x 74" Queen Bed
- Upgraded Beauflor Lino
- Dual Row LED Interior Lighting
- Foot Flush Toilet
- 3 Burner Range w/ Glass Cover & 17" Oven
- Large Single Bowl Farm Sink w/ High Rise Faucet
- Range Hood w/ Light & Exhaust Fan
- Seamless Countertops
- Pleated Night Shades in Living Area & Bedroom
- AM/FM/CD/AUX Stereo 2 Zone Stereo w/ USB
- Fireplace w/ 5K BTU Heater
- Bedroom Pocket Doors (Floorplan Specific)
- High Output Furnace
- Upgraded Kitchen Window
- On-Demand Tankless Water Heater



Boulder



Flooring



Woodgrain



Countertop

Choose how your next adventure unfolds.



COLEMAN LANTER 242BH
 Length: 28' 11" Weight: 5,865 lbs. Sleeps: 4-6
 Hitch: 684 lbs. Height: 11' 3"



COLEMAN LANTER 251TQ
 Length: 29' 11" Weight: 5,677 lbs. Sleeps: 4-8
 Hitch: 845 lbs. Height: 11' 5"



COLEMAN LANTER 263BH
 Length: 30' 8" Weight: 6,168 lbs. Sleeps: 4-6
 Hitch: 822 lbs. Height: 11' 1"



COLEMAN LANTER 264RL
 Length: 30' 11" Weight: 6,285 lbs. Sleeps: 2-4
 Hitch: 769 lbs. Height: 11' 3"

*Length is defined as the distance from the centerline of hitch pin/coupler to rear bumper of trailer.

**Our weights represent how most units are built, inclusive of many commonly-ordered options.

***Fresh water capacity includes water heater capacity.

DISCLAIMER: Product information is as accurate as possible as of the date of brochure publication. All features, floor plans and specifications in this brochure are subject to change without notice. Please consult Dutchmen's website at www.Dutchmen.com for current product information and specifications.

i All info & specs are for units manufactured after 01/3/2022



COLEMAN LANTERN

Choose how your next adventure unfolds.



COLEMAN LANTER 270TQ
Length: 31' 6" Weight: 6,241 lbs. Sleeps: 4-8
Hitch: 945 lbs. Height: 11' 4"



COLEMAN LANTER 285BH
Length: 28' 7" Weight: 4,736 lbs. Sleeps: 4-8
Hitch: 616 lbs. Height: 10' 4"



COLEMAN LANTER 286RK
Length: 32' 11" Weight: 6,726 lbs. Sleeps: 2-4
Hitch: 745 lbs. Height: 11' 3"



COLEMAN LANTER 295QB
Length: 32' 8" Weight: 6,528 lbs. Sleeps: 4-8
Hitch: 853 lbs. Height: 11' 4"

*Length is defined as the distance from the centerline of hitch pin/coupler to rear bumper of trailer.

**Our weights represent how most units are built, inclusive of many commonly-ordered options.

***Fresh water capacity includes water heater capacity.

DISCLAIMER: Product information is as accurate as possible as of the date of brochure publication. All features, floor plans and specifications in this brochure are subject to change without notice. Please consult Dutchmen's website at www.Dutchmen.com for current product information and specifications.



All info & specs are for units manufactured after 11/3/2022



COLEMAN LANTERN

Choose how your next adventure unfolds.



COLEMAN LANTER 300TQ

Length: 34' 11" Weight: 6,878 lbs. Sleeps: 4-8
Hitch: 1,012 lbs. Height: 12' 4"



COLEMAN LANTER 334BH

Length: 37' 3" Weight: 7,826 lbs. Sleeps: 4-8
Hitch: 1,047 lbs. Height: 11' 4"



COLEMAN LANTER 337

Length: 37' 11" Weight: 8,548 lbs. Sleeps: 4-8
Hitch: 1,098 lbs. Height: 11' 4"

*Length is defined as the distance from the centerline of hitch pin/coupler to rear bumper of trailer.

**Our weights represent how most units are built, inclusive of many commonly-ordered options.

***Fresh water capacity includes water heater capacity.

DISCLAIMER: Product information is as accurate as possible as of the date of brochure publication. All features, floor plans and specifications in this brochure are subject to change without notice. Please consult Dutchmen's website at www.Dutchmen.com for current product information and specifications.



All info & specs are for units manufactured after 11/3/2022



COLEMAN LANTERN

Coleman Lantern Specifications

Floorplan	Weights (lbs)			Tanks (Gallons)			Dimensions	
	Shipping Weight	Hitch Weight	Carrying Capacity	Fresh Water Capacity	Waste Water Capacity	Gray Water Capacity	Exterior Length	Exterior Height
242BH	5,865	684	1,735	60	42	84	28' 11"	11' 3"
251TQ	5,677	845	4,003	60	42	42	29' 11"	11' 5"
263BH	6,168	822	1,432	60	42	42	30' 7"	11' 1"
264RL	6,285	769	1,315	60	42	42	30' 11"	11' 3"
270TQ	6,241	945	3,439	60	42	42	31' 6"	11' 4"
285BH	6,611	869	2,189	60	42	42	32' 9"	11' 2"
286RL	6,726	745	2,074	60	42	42	32' 11"	11' 3"
295QB	6,528	853	2,272	60	42	42	32' 8"	11' 4"
300TQ	6,878	1,012	2,802	60	42	42	34' 11"	12' 4"
334BH	7,780	1,041	1,900	60	42	42	37' 3"	11' 4"
337BH	8,548	1,098	2,628	60	42	84	37' 11"	11' 4"

*Length is defined as the distance from the centerline of hitch pin/coupler to rear bumper of trailer.

**Our weights represent how most units are built, inclusive of many commonly-ordered options.

***Fresh water capacity includes water heater capacity.

DISCLAIMER: Product information is as accurate as possible as of the date of brochure publication. All features, floor plans and specifications in this brochure are subject to change without notice. Please consult Dutchmen's website at www.Dutchmen.com for current product information and specifications.



All info & specs are for units manufactured after 11/3/2022



COLEMAN LANTERN

Choose how your next adventure unfolds.



COLEMAN LANTER 242RDWE
Length: 28' 11" Weight: 5,915 lbs. Sleeps: 4-6
Hitch: 608 lbs. Height: 11' 3"



COLEMAN LANTER 263BHWE
Length: 30' 7" Weight: 6,132 lbs. Sleeps: 4-6
Hitch: 855 lbs. Height: 11' 1"



COLEMAN LANTER 264RLWE
Length: 30' 11" Weight: 6,209 lbs. Sleeps: 2-4
Hitch: 771 lbs. Height: 11' 3"

*Length is defined as the distance from the centerline of hitch pin/coupler to rear bumper of trailer.

**Our weights represent how most units are built, inclusive of many commonly-ordered options.

***Fresh water capacity includes water heater capacity.

DISCLAIMER: Product information is as accurate as possible as of the date of brochure publication. All features, floor plans and specifications in this brochure are subject to change without notice. Please consult Dutchmen's website at www.Dutchmen.com for current product information and specifications.



All info & specs are for units manufactured after 11/3/2022



COLEMAN LANTERN

Choose how your next adventure unfolds.



COLEMAN LANTER 285BHWE
Length: 32' 9" Weight: 6,606 lbs. Sleeps: 4-8
Hitch: 893 lbs. Height: 11' 2"



COLEMAN LANTER 286RKWE
Length: 32' 11" Weight: 6,570 lbs. Sleeps: 2-4
Hitch: 657 lbs. Height: 11' 3"



COLEMAN LANTER 295QBWE
Length: 32' 8" Weight: 6,512 lbs. Sleeps: 4-8
Hitch: 851 lbs. Height: 11' 4"

*Length is defined as the distance from the centerline of hitch pin/coupler to rear bumper of trailer.

**Our weights represent how most units are built, inclusive of many commonly-ordered options.

***Fresh water capacity includes water heater capacity.

DISCLAIMER: Product information is as accurate as possible as of the date of brochure publication. All features, floor plans and specifications in this brochure are subject to change without notice. Please consult Dutchmen's website at www.Dutchmen.com for current product information and specifications.



All info & specs are for units manufactured after 11/3/2022

Coleman Lantern West Coast Specifications

Floorplan	Weights (lbs)			Tanks (Gallons)			Dimensions	
	Shipping Weight	Hitch Weight	Carrying Capacity	Fresh Water Capacity	Waste Water Capacity	Gray Water Capacity	Exterior Length	Exterior Height
242BHWE	5,915	608	1,685	52	38	76	28' 11"	11' 3"
263BHWE	6,132	855	1,468	60	38	38	30' 7"	11' 1"
264RLWE	6,209	771	1,391	60	38	38	30' 11"	11' 3"
285BHWE	6,606	893	3,074	60	38	38	32' 9"	11' 2"
286EKWE	6,570	657	3,110	60	38	38	32' 11"	11' 3"
295QBWE	6,512	851	2,572	60	38	38	32' 8"	11' 4"

*Length is defined as the distance from the centerline of hitch pin/coupler to rear bumper of trailer.

**Our weights represent how most units are built, inclusive of many commonly-ordered options.

***Fresh water capacity includes water heater capacity.

DISCLAIMER: Product information is as accurate as possible as of the date of brochure publication. All features, floor plans and specifications in this brochure are subject to change without notice. Please consult Dutchmen's website at www.Dutchmen.com for current product information and specifications.



All info & specs are for units manufactured after 11/3/2022



Coleman

CRAFTED FOR YOUR LIFESTYLE



COLEMAN LANTERN



*SELECT MODELS

Exterior Features:

- Power Awning w/ LED Lights
- Power Tongue Jack
- Power Stabilizer Jacks
- Diamond Plate Rock Guard
- Mega Pass Thru Storage Compartment w/ Magnetic Catches
- Backup Camera
- Solar Panel Prep
- Friction Hinge Entry Door
- Exterior Spray Port
- 30 Amp Power Cord
- 50 Amp Power Cord (Select Models)
- 13,500 BTU Aire Conditioner
- Black Tank Flush
- Solid Entry Step
- Exterior Command Center
- Enclosed Underbelly (Select Models)



To see more features, visit dutchmen.com

See the DUTCHMEN® Construction Advantage.

We put a great amount of thought into every RV we design and build. From strong frames, to sturdy walls and insulation, we build every RV to take you on many adventures to come.

Insulated Structure

- 1 Metal Exterior Panel
- 2 Wood Frame with R7 Thermal Insulation
- 3 Lauan Interior Panel

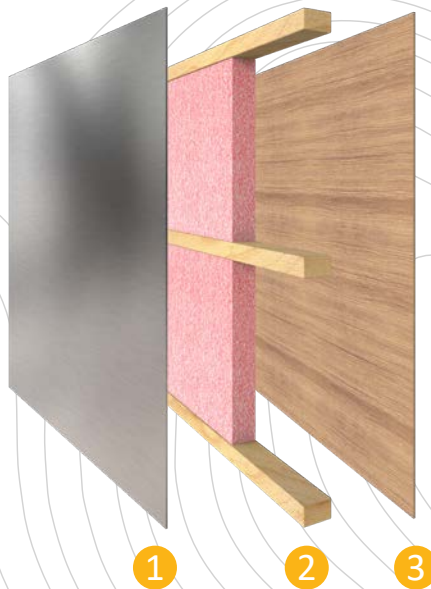

Floor Structure

- 1 Linoleum Flooring
- 2 Dynaspan Floor Decking
- 3 Aluminum Frame with Block Foam Insulation and Heat Duct
- 4 Lauan Panel
- 5 Darco Moisture Barrier
- 6 Steel Powder-Coated Main I-Beam Frame
- 7 Fully Enclosed Underbelly

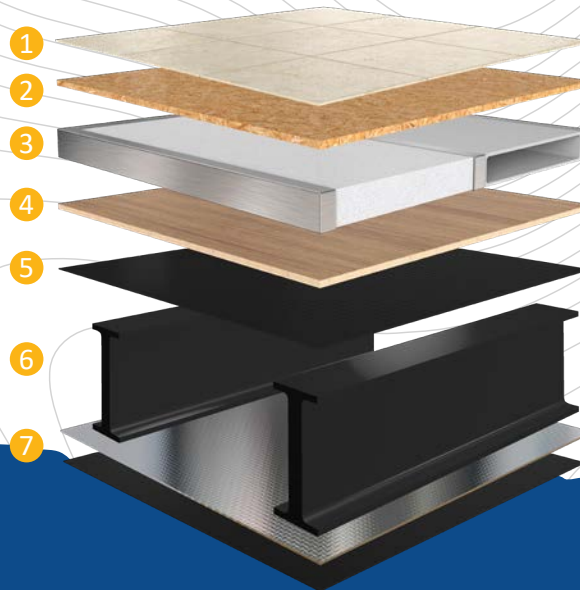

Durable Roof Structure

- 1 TPO Roof
- 2 3/8" Decking
- 3 Fiberglass Insulation
- 4 Lauan Interior Panel

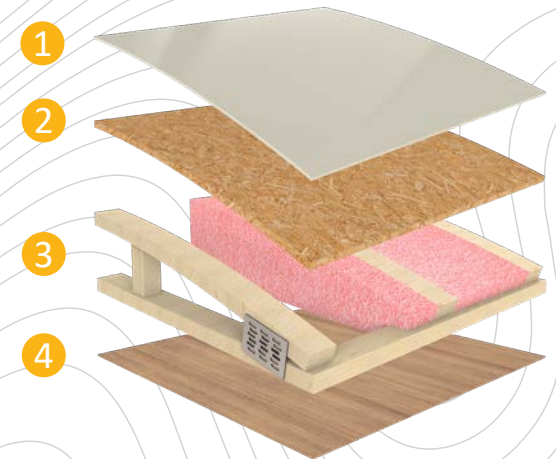

 To see more features, visit dutchmen.com



Make the DUTCHMEN® Connection.

Connect with other RVers in the Dutchmen community. Sharing adventures is a great way to get inspired and get on the road. Gather 'round our social media campfires with us—and be sure to follow us so we can share with you!

dutchmen.com



Visit us online to see all the Dutchmen brands, innovative models, and spacious floor plans.

CONTACT SALES: 574.537.0600

PO BOX 2000 | 2164 CARAGANA COURT | GOSHEN, IN 46527