

CHEERS TO THE
NEXT 50 YEARS



PROWLER

 BROUGHT TO YOU BY
HEARTLAND®

TOP 5 EXTERIOR FEATURES

- 1** **MEGA Bright Pass-Thru Storage** - Unmatched Storage with 52 cu. ft. of storage, mega sized access doors, LED lights on both sides and finished on the inside for protection.
- 2** **Easy Button Set Up** - Camping Made Easy with power stabilizer jacks, adjustable power awning, and power lighted tongue jack (optional).
- 3** **Secure Access System** - Secure fold out main entry step with adjustable legs, extra large top step and oversized fold out grab handle.
- 4** **Performastructure Aluminum Front Wall** - Superior Aero Performance for better wind and water deflection plus an aluminum front which is 60% thicker than most competitors.
- 5** **Tailgate Package** - LP Quick disconnect for your grill and TV hookup with exterior speakers.



DINETTE LIGHT NOT INCLUDED

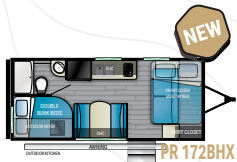

LENGTH: 22'5 3/4" | **HEIGHT:** 9'-10"
HITCH: 610 | **DRY:** 3820
GVWR: 5010 LBS.
SLEEP CAPACITY: 7-8

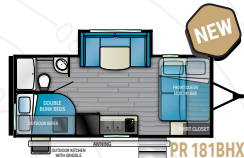

LENGTH: 22'-5-3/4" | **HEIGHT:** 9'-10"
HITCH: 530 LBS. | **DRY:** 4279 LBS.
GVWR: 5630 LBS.
SLEEP CAPACITY: 7-8

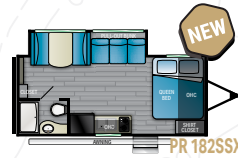

LENGTH: 22'9" | **HEIGHT:** 9'10"
HITCH: 490 LBS. | **DRY:** 4110 LBS.
GVWR: 4890 LBS.
SLEEP CAPACITY: 5-6

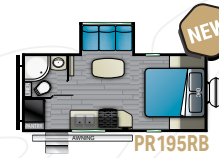

LENGTH: 21'10" | **HEIGHT:** 11'0"
HITCH: 530 LBS. | **DRY:** 4780 LBS.
GVWR: 7530 LBS.
SLEEP CAPACITY: 3-4

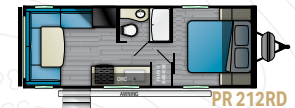

LENGTH: 25'11" | **HEIGHT:** 11'2"
HITCH: 570 LBS. | **DRY:** 4650 LBS.
GVWR: 7570 LBS.
SLEEP CAPACITY: 3-4

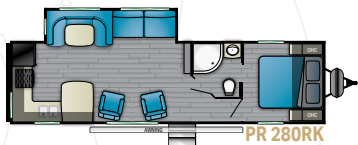

LENGTH: 33'11" | **HEIGHT:** 11'2" | **HITCH:** 820 LBS.
DRY: 6840 LBS. | **GVWR:** 9000 LBS.
SLEEP CAPACITY: 5-6

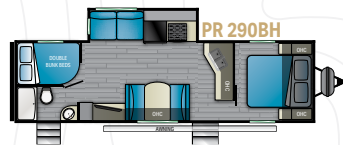

LENGTH: 33'8" | **HEIGHT:** 11'2" | **HITCH:** 820 LBS.
DRY: 6840 LBS. | **GVWR:** 9000 LBS.
SLEEP CAPACITY: 7-8

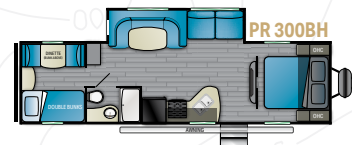

LENGTH: 34'7" | **HEIGHT:** 11'2" | **HITCH:** 875 LBS.
DRY: 6785 LBS. | **GVWR:** 9000 LBS.
SLEEP CAPACITY: 7-8

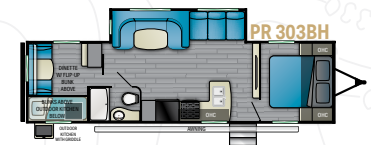

LENGTH: 35'5" | **HEIGHT:** 11'2" | **HITCH:** 750 LBS.
DRY: 6970 LBS. | **GVWR:** 9000 LBS.
SLEEP CAPACITY: 7-8

TOP 5 INTERIOR FEATURES

- 1 | H Blast AC** - Unmatched Cooling Performance up to 50% more A/C ducts for better and more efficient air circulation.
- 2 | Prowler Super Den** - Full size residential queen bed, full length dual wardrobes, integrated lighting, USB charging and CPAP storage.
- 3 | EZ Clean Interior** - No carpet, full linoleum on main floor and woven flooring in slideouts.
- 4 | Panoramic Windows** - Oversized Windows that open for maximum ventilation and view.
- 5 | At Home Kitchen** - Extra large residential refrigerator with 10 cu. ft. of storage, Duralast countertops, and stainless steel bowl undermount sink.



PR 240RB
LENGTH: 28' 5 1/8" | **HEIGHT:** 11'2"
HITCH: 610 LBS. | **DRY:** 5000 LBS.
GVWR: 6900 LBS.
SLEEP CAPACITY: 3-4

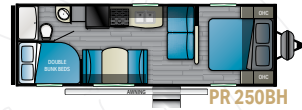

PR 250BH
LENGTH: 29'6 1/2" | **HEIGHT:** 11'2"
HITCH: 528 LBS. | **DRY:** 4814 LBS.
GVWR: 6900 LBS.
SLEEP CAPACITY: 7-8

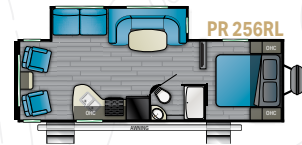

PR 256RL
LENGTH: 30' | **HEIGHT:** 11'2"
HITCH: 620 LBS. | **DRY:** 6134 LBS.
GVWR: 7600 LBS.
SLEEP CAPACITY: 5-6

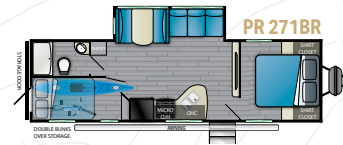

PR 271BR
LENGTH: 31'10" | **HEIGHT:** 11'2"
HITCH: 880 LBS. | **DRY:** 6570 LBS.
GVWR: 7880 LBS.
SLEEP CAPACITY: 7-8

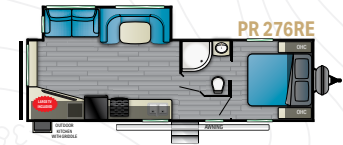

PR 276RE
LENGTH: 32' | **HEIGHT:** 11'2"
HITCH: 480 LBS. | **DRY:** 6360 LBS.
GVWR: 7700 LBS.
SLEEP CAPACITY: 7-8

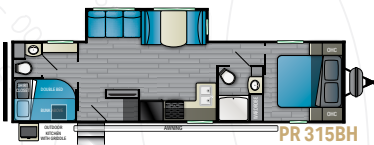

PR 315BH
LENGTH: 36'11" | **HEIGHT:** 11'4" | **HITCH:** 810 LBS.
DRY: 7240 LBS. | **GVWR:** 9600 LBS.
SLEEP CAPACITY: 7-8

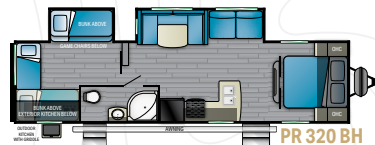

PR 320BH
LENGTH: 36'9" | **HEIGHT:** 11'4" | **HITCH:** 940 LBS.
DRY: 7980 LBS. | **GVWR:** 9600 LBS.
SLEEP CAPACITY: 7-8

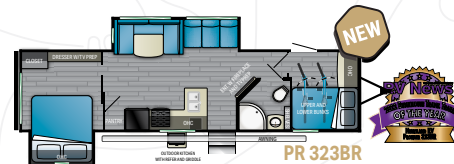

PR 323BR
LENGTH: 36'11" | **HEIGHT:** 11'2" | **HITCH:** TBD
DRY: TBD | **GVWR:** TBD
SLEEP CAPACITY: 7-8

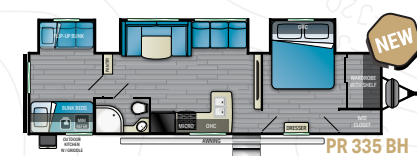

PR 335BH
LENGTH: 37' 7 3/4" | **HEIGHT:** 11'2" | **HITCH:** 1170 LBS.
DRY: 9070 LBS. | **GVWR:** 11370 LBS.
SLEEP CAPACITY: 7-8

SPECIAL FEATURES

PROWLER VALUE PACKAGE:

- Duralast Kitchen Counter Tops
- Carpet Free Flush Floor Slides
- MAX Lino throughout
- Residential Queen Size Bed
- CPAP Bedroom Storage
- USB charging ports throughout
- Pleated Night Shades in Living area and bedroom
- LED Interior Lights
- EZ-Lube Axles
- Radial Tires
- Ext Speakers
- Undermount Stainless Steel Kitchen Sink
- Stainless Steel Appliance
- Microwave
- HDMI/AM/FM/USB/Bluetooth Media Player
- Indoor/Outdoor Cable TV Hook-Up
- 13.5K BTU Dual H-Ducted A/C

PROWLER CONVENIENCE PACKAGE:

- Power Stabilizer Jacks (2 Pair)
- Power Awning w/ LED Lights
- Heated & Enclosed Underbelly
- Oven
- Black Tank Flush
- Spare Tire & Carrier
- Exterior Shower

- 30K BTU Furnace
- ABS Tub/Shower Surround
- XL Full Size Baggage Doors
- Lighted pass-through storage
- Gas/Elec DSI Water Heater
- Safety Glass Windows
- Dual 20# LP Bottles
- Finished Pass Through Storage
- XL Entry Grab Handle
- Diamond Plate Stone Guard
- Electric Rack & Pinion S/O Systems
- Solar Prep
- Backup Camera Prep
- LP Quick Disconnect
- Shower Skylight

HEATING AND COOLING UPGRADES:

- 15,000 A/C BTU IPO 13,500 A/C
- 50 AMP Service w/ 2nd A/C Prep (STD 335BH & 323BR) (N/A 212RD, 240RB, 250BH, 256RL, 271BR)
- 2nd A/C - (N/A 212RD, 240RB, 250BH, 256RL, 271BR)

EXTERIOR OPTIONS:

- Power Tongue Jack

INTERIOR UPGRADES:

- 8 Cu. Ft. Gas/Electric Refer IPO 10.7 Cu. Ft 12V Refer (N/A 290BH)



Mega Pass-Thru Storage



Outdoor Griddle

VISIT US ONLINE



For more information and to take a virtual walk-through, visit www.heartlandrvs.com

Your authorized Heartland dealer:

