

DISCOVER THE WORLD OUTSIDE

Surveyor



STRONG, DURABLE LAMINATED FIBERGLASS WITH ALL ALUMINUM CAGE CONSTRUCTION



CADET



SPORT



SELECT



FIFTH WHEEL



Cadet

As with every series designed by Surveyor, a premium is placed on superior craftsmanship and unmatched value. By combining lightweight floorplans with residential features, the Cadet series surpasses other products in its class.



SC224T TUSCANY



SURVEYOR CADET

FLOORPLANS AND SPECIFICATIONS

ST=Storage PT= Pass Thru Storage OHD= Overhead Cabinet



CADET SC191T

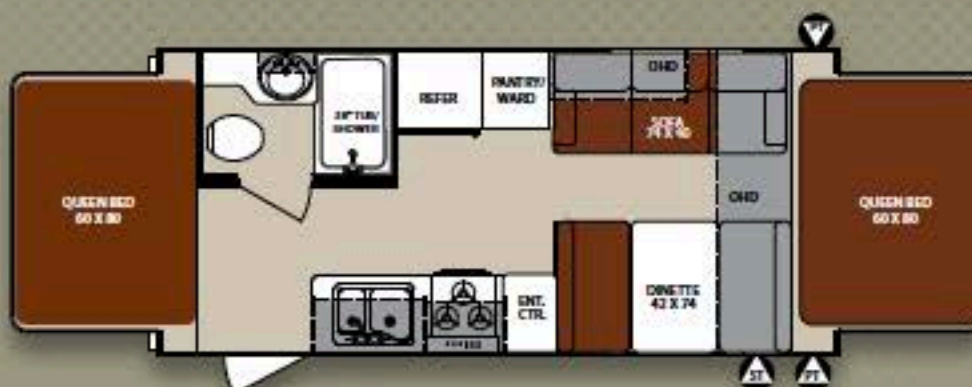

CADET SC192T



CADET SC224T

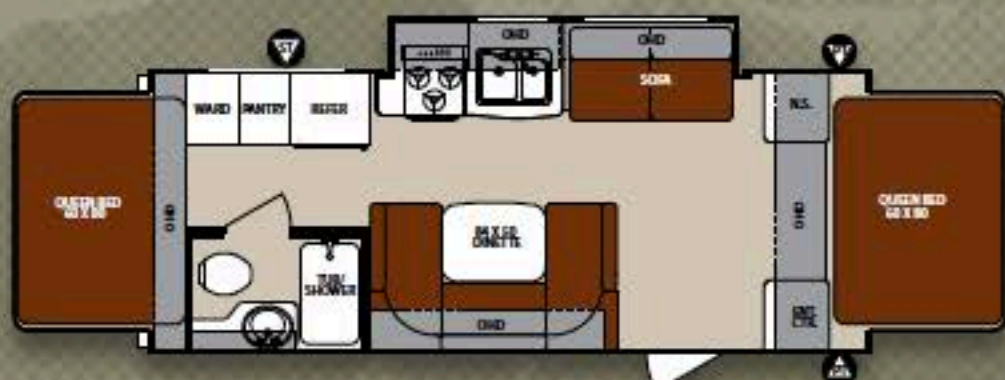

CADET SC225T



CADET SC186

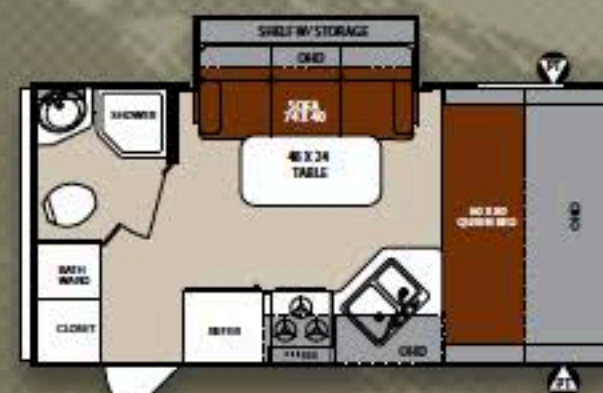

CADET SC189



CADET SC226



CADET SC280BH

| MODEL | SC191T | SC192T | SC224T | SC225T | SC186 | SC189 | SC226 | SC280BH |
|---------------------|--------|--------|--------|--------|--------|-------|-------|---------|
| TOTAL DRY WEIGHT | 3358 | 3642 | 3988 | 4173 | 3611 | 3760 | TBD | 4729 |
| LOAD CAPACITY | 1478 | 3730 | 3428 | 3252 | 3752 | 3622 | TBD | 2775 |
| HITCH WEIGHT | 436 | 372 | 416 | 425 | 363 | 382 | TBD | 504 |
| OVERALL LENGTH | 20'4" | 21'11" | 24'7" | 24'7" | 20'10" | 21'2" | 25'7" | 30'7" |
| EXT. WIDTH | 8'0" | 8'0" | 8'0" | 8'0" | 8'0" | 8'0" | 8'0" | 8'0" |
| EXT. HEIGHT (W/ AC) | 9'11" | 9'11" | 9'11" | 9'11" | 9'11" | 9'11" | 9'11" | 9'11" |
| FRESH WATER (GAL) | 36 | 36 | 36 | 36 | 36 | 36 | 36 | 36 |
| GREY WATER (GAL) | 30 | 30 | 30 | 30 | 30 | 30 | 30 | 30 |
| BLACK WATER (GAL) | 30 | 30 | 30 | 30 | 30 | 30 | 30 | 30 |
| AWNING SIZE | 12' | 9' | 13' | 16' | 11' | 12' | 17' | 17' |

*We know weights and dimensions are an important part of your buying decision. Surveyor weighs every model to ensure accuracy, although refinements to the product can create variations to weights and dimensions. Review a current model at your nearest authorized Surveyor Dealer today.

Sport

There's no need to give up space or amenities with the Surveyor Sport. Our queen 60 X 80 beds provide for a spacious slumber while the lightweight design makes towing a breeze. Rich in features the Surveyor Sport is a smart choice for those who choose to travel well but light!



SP220 ESPRESSO



SP220 ESPRESSO



SP296 ISLAND KITCHEN
Feel right at home in our Island Kitchen models, spacious countertops provide you with room you need for all your food preparations.



SP296 HARVEST



SP3021 HARVEST

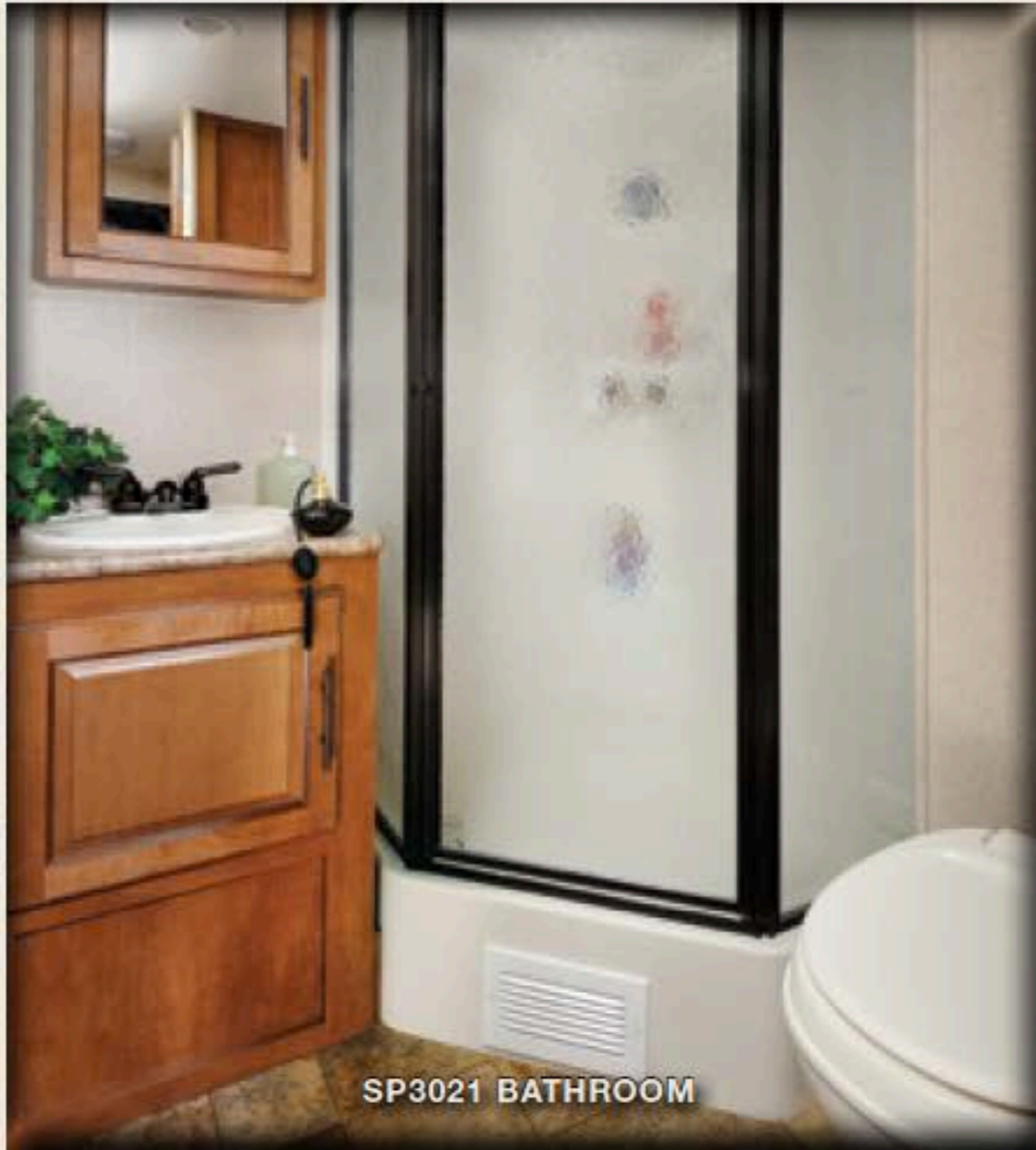

SP3021 BATHROOM



SP3021 HARVEST

Sport

Surveyor Sport delivers affordable luxury combined with top-selling floorplans in a value-packed travel trailer built for the lighter weight towing needs of today's RVers.

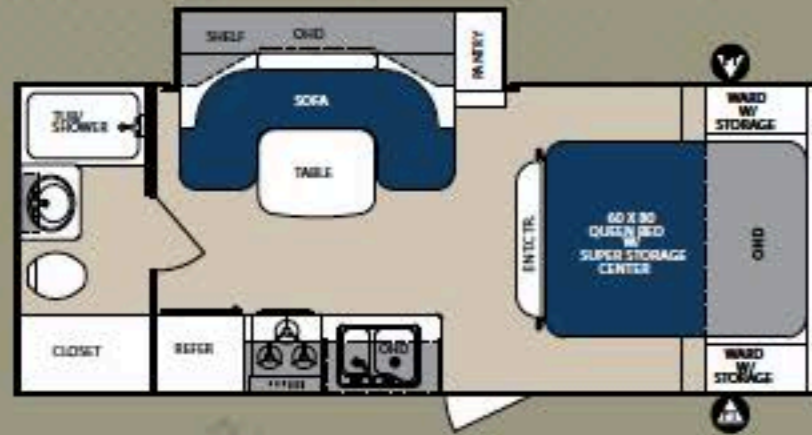

SPORT SP220

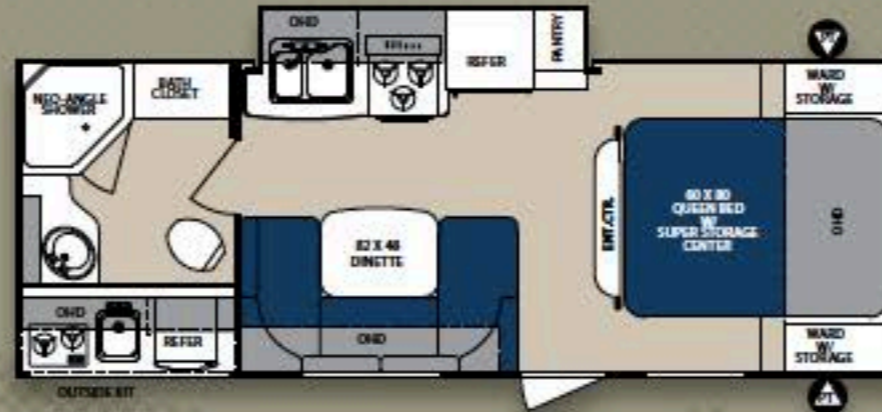

SPORT SP240

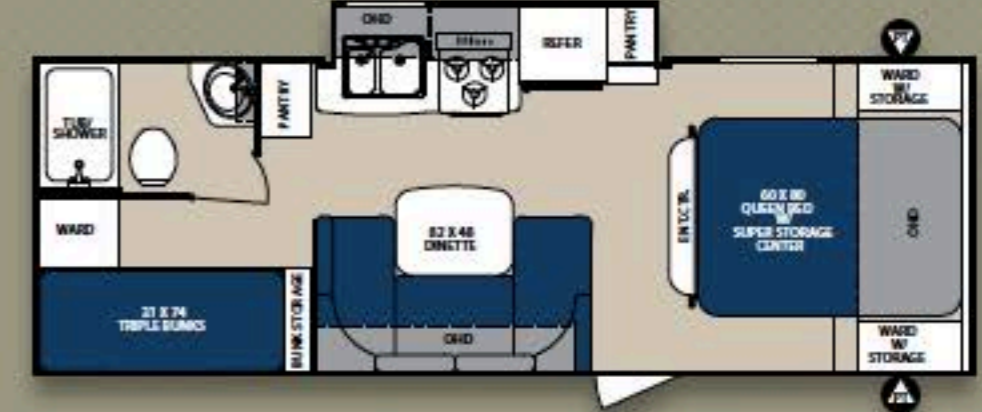

SPORT SP260

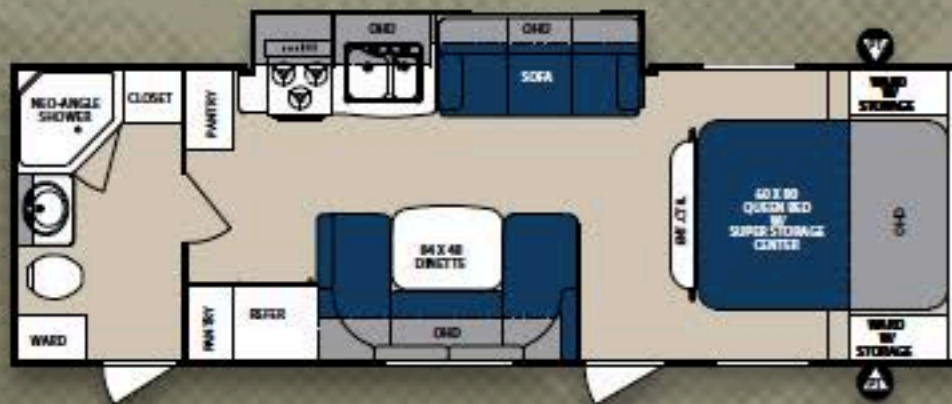

SPORT SP275

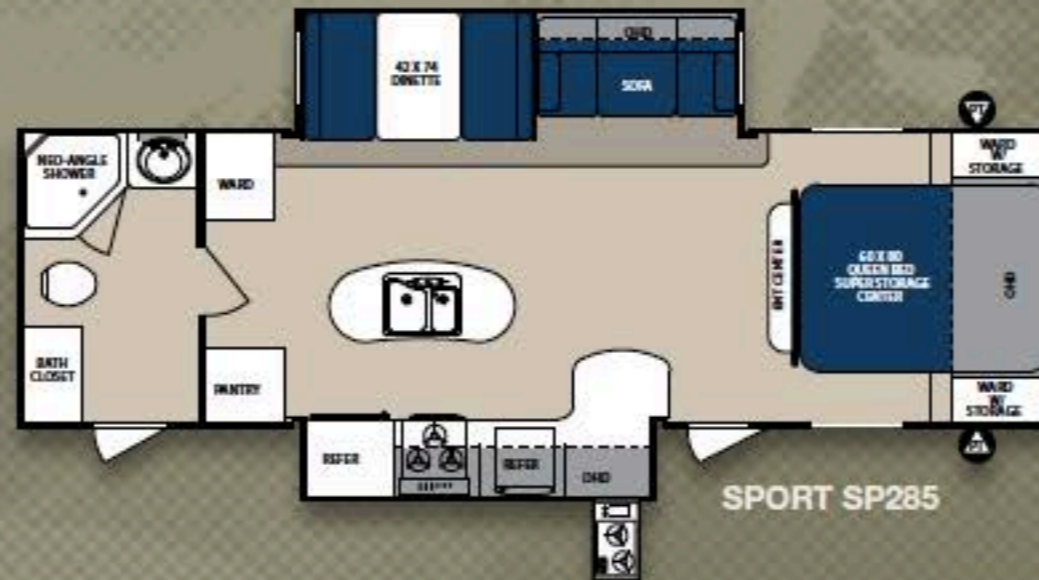

SPORT SP285



SPORT SP291



SPORT SP295

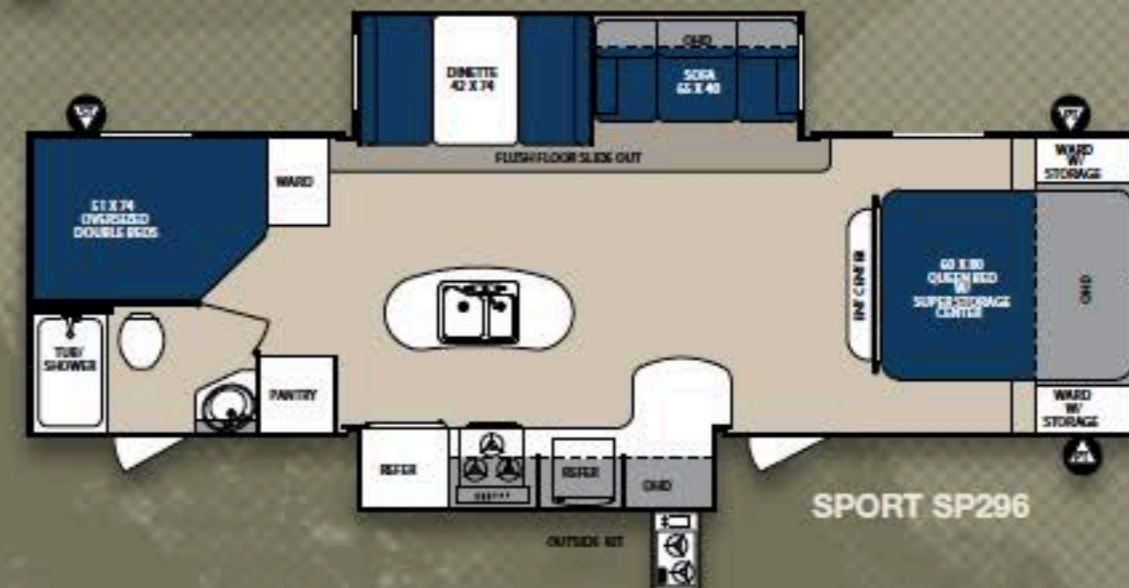

SPORT SP296



SURVEYOR SPORT

FLOORPLANS AND SPECIFICATIONS

ST=STORAGE PT= PASS THRU STORAGE OHD= OVERHEAD CABINET

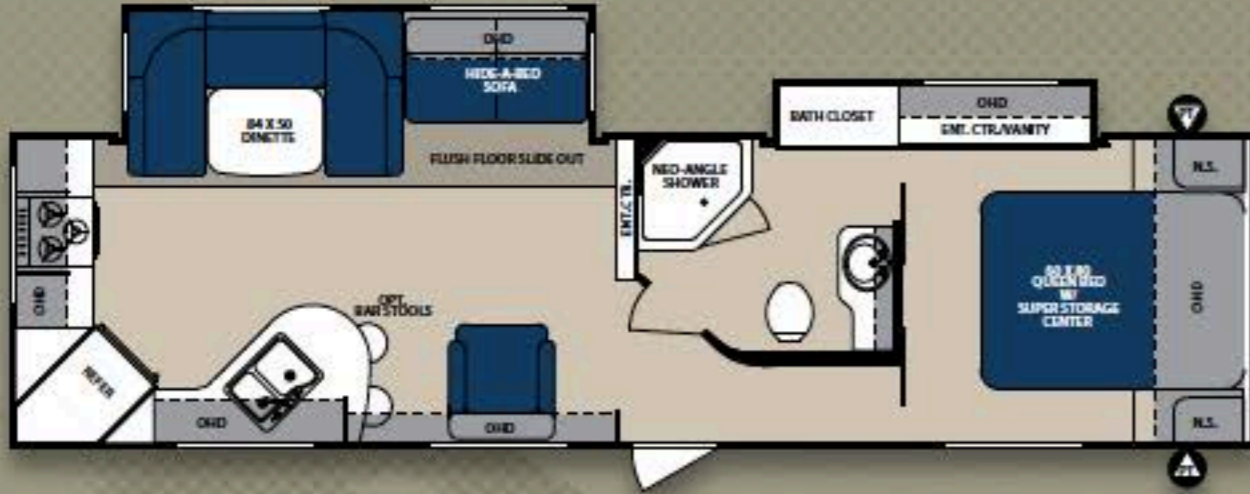
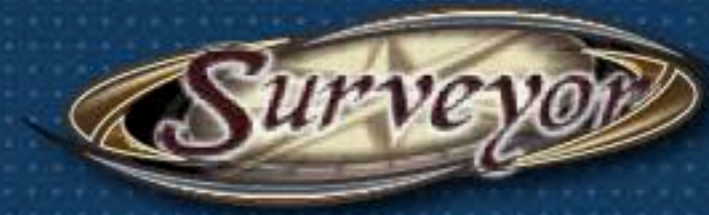

SPORT SP3011

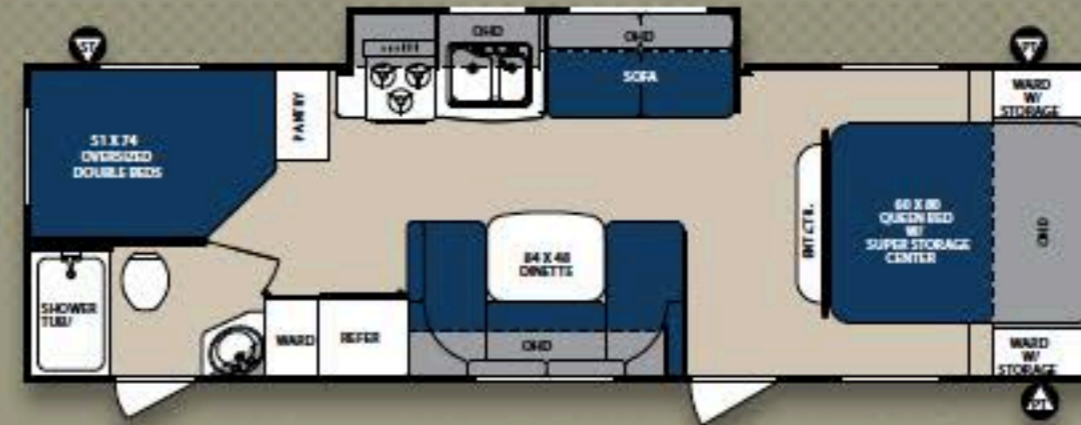

SPORT SP3021

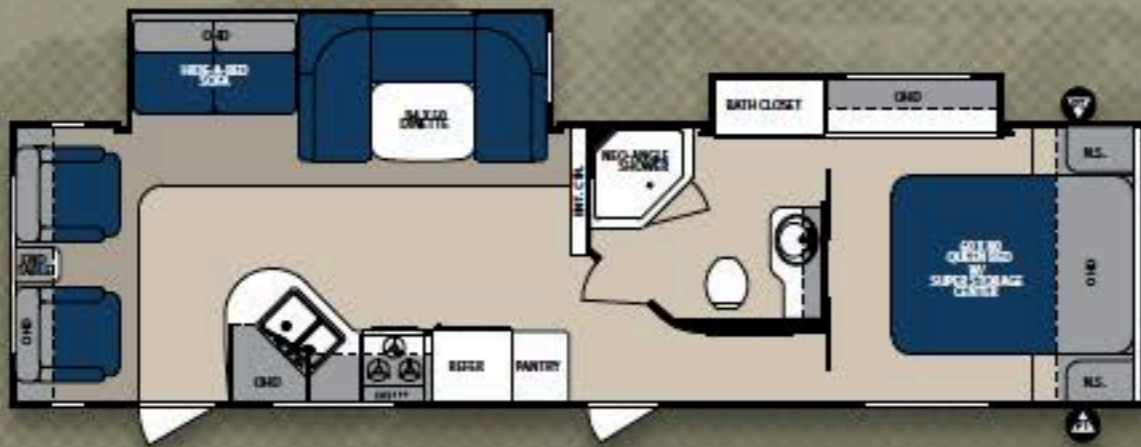

SPORT SP3031

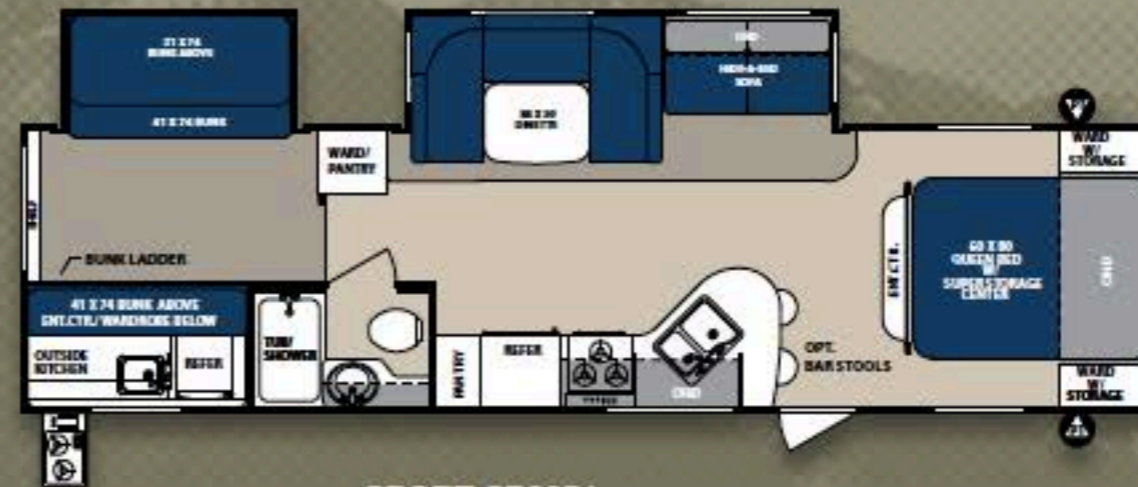

SPORT SP3051

Sport

| MODEL | SP220 | SP240 | SP260 | SP275 | SP285 | SP291 | SP295 | SP296 | SP3011 | SP3021 | SP3031 | SP3051 |
|---------------------|--------|-------|-------|-------|-------|-------|--------|-------|--------|--------|--------|--------|
| *TOTAL DRY WEIGHT | 4415 | 4759 | 4850 | 4973 | 6513 | TBD | 5644 | 6680 | 7084 | 6311 | 7147 | 7405 |
| LOAD CAPACITY | 3038 | 2829 | 2667 | 2532 | 4405 | TBD | 1931 | 4155 | 3932 | 4531 | 3875 | 3503 |
| HITCH WEIGHT | 453 | 588 | 517 | 505 | 758 | TBD | 575 | 675 | 836 | 682 | 862 | 748 |
| OVERALL LENGTH | 25' 5" | 27'3" | 28'9" | 30'3" | 32'7" | 32'2" | 33'11" | 34'3" | 36'4" | 34'11" | 36'9" | 36'4" |
| EXT. WIDTH | 8' 0" | 8'0" | 8'0" | 8'0" | 8'0" | 8'0" | 8'0" | 8'0" | 8'0" | 8'0" | 8'0" | 8'0" |
| EXT. HEIGHT (W/ AC) | 9' 11" | 9'11" | 10'0" | 10'0" | 10'9" | 9'11" | 10'0" | 10'9" | 10'9" | 10'9" | 10'9" | 10'9" |
| FRESH WATER (GAL) | 36 | 36 | 36 | 36 | 36 | 36 | 36 | 36 | 36 | 36 | 36 | 36 |
| GREY WATER (GAL) | 30 | 30 | 30 | 30 | 30 | 30 | 30 | 30 | 60 | 30 | 30 | 30 |
| BLACK WATER (GAL) | 30 | 30 | 30 | 30 | 30 | 30 | 30 | 30 | 30 | 30 | 30 | 30 |
| AWNING SIZE | 15' | 13' | 16' | 20' | 18' | 18' | 18' | 20' | 20' | 20' | 20' | 20' |

*We know weights and dimensions are an important part of your buying decision. Surveyor weighs every model to ensure accuracy, although refinements to the product can create variations to weights and dimensions. Review a current model at your nearest authorized Surveyor Dealer today.

Select

The Surveyor Select series with gel coated fiberglass has many outstanding features to enhance your camping experience. The open floor plans and generous storage space allows extra room for those extra things you want to bring along. And sleeping on the comfortable 60 X 80 bed, you'll forget you were in the great outdoors. The spacious interiors and picturesque view through the many windows enable you to experience your surroundings in the comfort of your Surveyor travel trailer.



SV301 ESPRESSO



SV301 ESPRESSO



SV305 TUSCANY



SV305 TUSCANY



SV301 ESPRESSO



OUTSIDE KITCHEN



SURVEYOR SELECT

FLOORPLANS AND SPECIFICATIONS

ST=STORAGE PT= PASS THRU STORAGE OHD= OVERHEAD CABINET

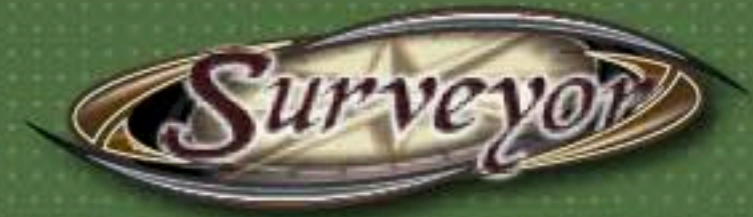

SELECT SV264

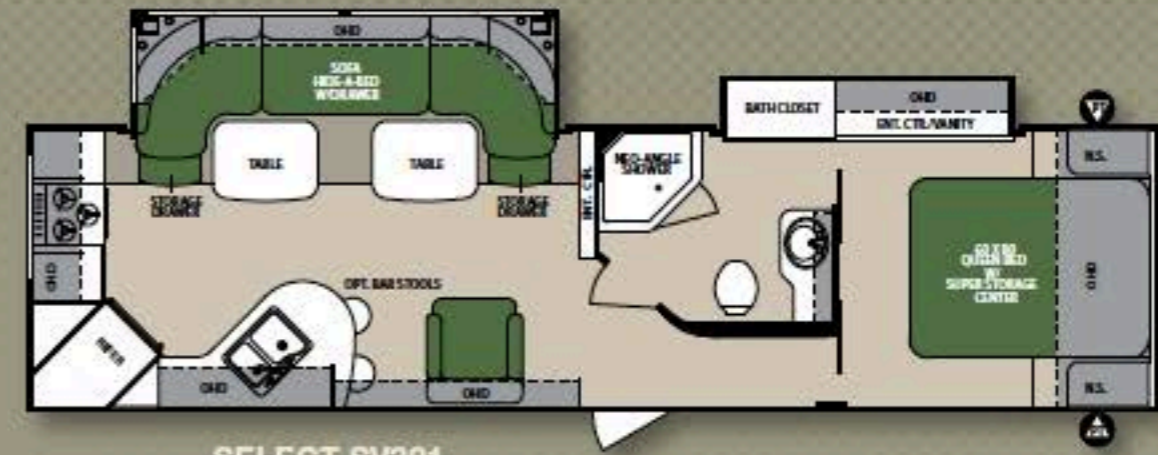

SELECT SV301

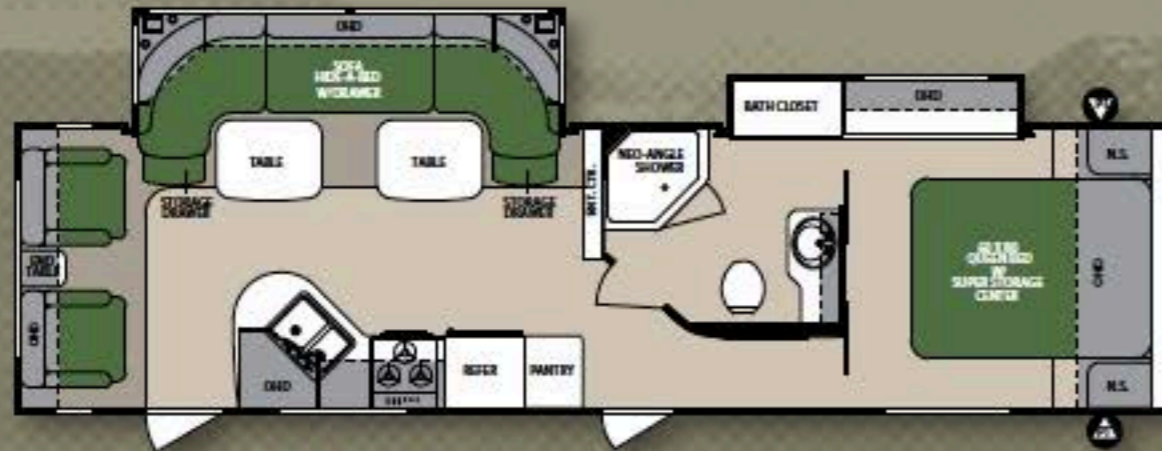

SELECT SV303

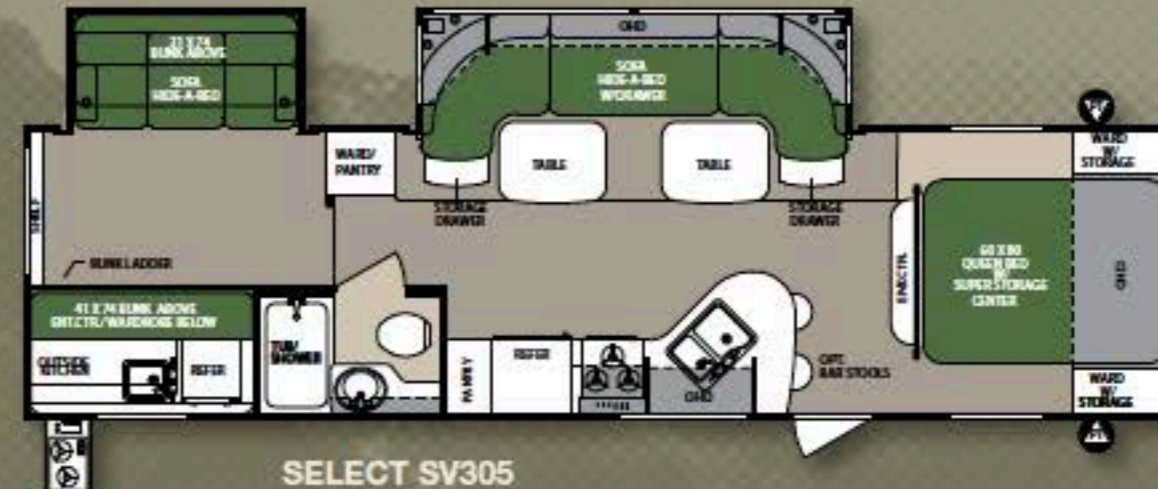

SELECT SV305



SV305 TUSCANY

| MODEL | SV264 | SV301 | SV303 | SV305 |
|-----------------------|-------|-------|-------|-------|
| TOTAL DRY WEIGHT | 5124 | 7365 | 7487 | 7782 |
| LOAD CAPACITY | 2499 | 3793 | 3565 | 3241 |
| HITCH WEIGHT | 623 | 998 | 892 | 883 |
| OVERALL LENGTH (open) | 29'9" | 36'4" | 36'9" | 36'4" |
| EXT. WIDTH | 8'0" | 8'0" | 8'0" | 8'0" |
| EXT. HEIGHT (w/ AC) | 9'11" | 10'9" | 10'9" | 10'9" |
| FRESH WATER (GAL) | 36 | 36 | 36 | 36 |
| GREY WATER (GAL) | 60 | 60 | 30 | 30 |
| BLACK WATER (GAL) | 30 | 30 | 30 | 30 |
| AWNING SIZE | 20' | 20' | 20' | 20' |

*We know weights and dimensions are an important part of your buying decision. Surveyor weighs every model to ensure accuracy, although refinements to the product can create variations to weights and dimensions. Review a current model at your nearest authorized Surveyor Dealer today.

FIFTH WHEELS

At Surveyor we think you should get the most for your money, so we have taken the space that other RV manufacturers have left empty and filled it with features that you are sure to enjoy.



SVF293 ESPRESSO

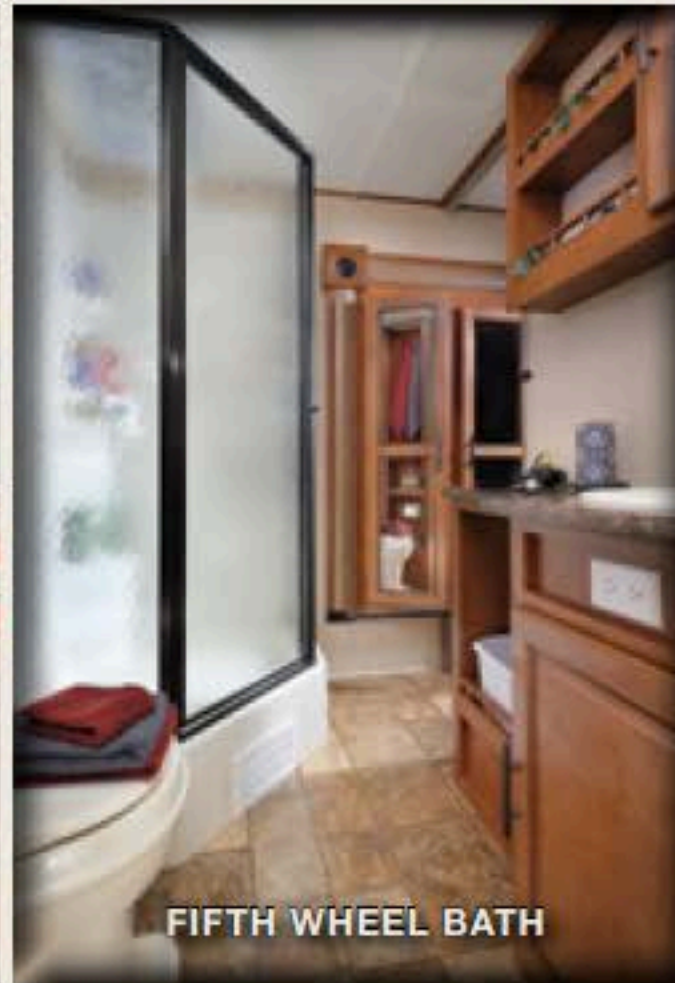

FIFTH WHEEL BATH



DYSON CLOSET



SVF293 ESPRESSO



SVF324 ESPRESSO

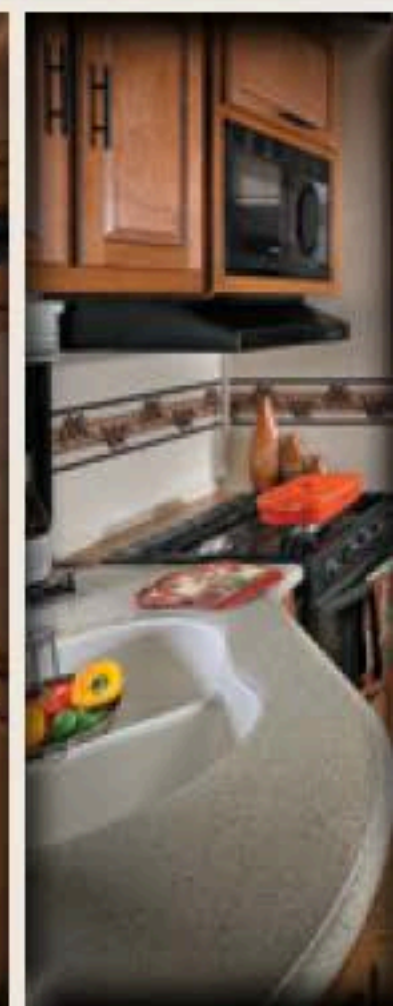



SURVEYOR FIFTH WHEELS

FLOORPLANS AND SPECIFICATIONS

ST=Storage PT= Pass Thru Storage OHD= Overhead Cabinet



SVF324 ESPRESSO



SVF324 ESPRESSO



SVF276 RL



SVF278 RL



SVF292 RK

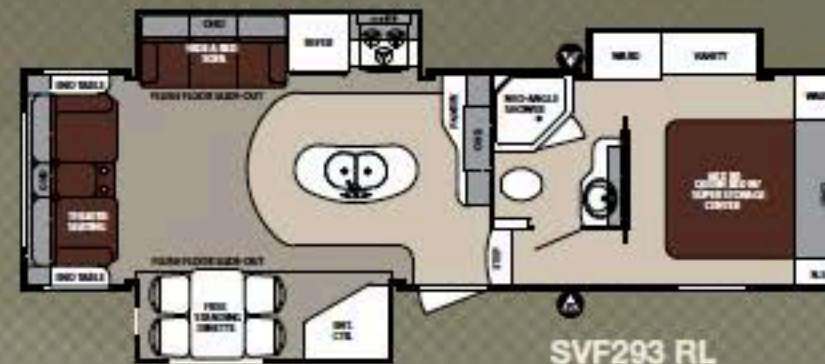

SVF293 RL



SVF324 BH



PASS-THRU STORAGE WITH UTILITY CENTER



ALUMINUM WHEELS/EQUA FLEX SUSPENSION

| MODEL | SVF276 RL | SVF278 RL | SVF292 RK | SVF293 RL | SVF324 BH |
|---------------------|-----------|-----------|-----------|-----------|-----------|
| *TOTAL DRY WEIGHT | 7619 | 7679 | 8340 | 8483 | 8989 |
| LOAD CAPACITY | 2511 | 2509 | 3601 | 3358 | 3141 |
| HITCH WEIGHT | 1330 | 1388 | 1781 | 1681 | 1970 |
| OVERALL LENGTH | 29'7" | 29'7" | 32'10" | 32'10" | 35'8" |
| EXT. WIDTH | 8'0" | 8'0" | 8'0" | 8'0" | 8'0" |
| EXT. HEIGHT (W/ AC) | 12' 5" | 12' 5" | 12'3" | 11'6" | 11'6" |
| FRESH WATER (gal.) | 47 | 47 | 47 | 47 | 47 |
| GREY WATER (gal.) | 75 | 75 | 75 | 75 | 75 |
| BLACK WATER (gal.) | 35 | 35 | 35 | 35 | 35 |
| AWNING SIZE | 20' | 17' | 20' | 20' | 20' |

*We know weights and dimensions are an important part of your buying decision. Surveyor weighs every model to ensure accuracy, although refinements to the product can create variations to weights and dimensions. Review a current model at your nearest authorized Surveyor Dealer today.

FEATURES

Luxury is well within your reach in this extraordinary Surveyor travel trailer. Beautiful residential style cabinetry and kitchen raised panel cabinet doors, spacious pantry, plus the large entertainment center makes this a great choice for affordable elegance.



POWER STABILIZER JACKS (OPTIONAL) Set up is a breeze with Surveyors push button electric stabilizer jacks. (N/A Cadets)

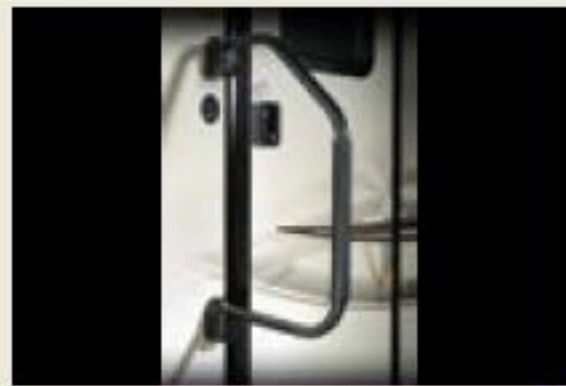

FOLDING ASSIST HANDLE This oversized assist handle allows for safe entry and exit from your coach. (Optional Cadets)



SUPERIOR CONSTRUCTION Surveyor is one of the strongest light weight trailers because of our lamination process. High quality materials, 100% glue coverage and fully framed aluminum floor, roof, walls, fronts and backs provide you a structure for peace of mind.



EXTERIOR SPEAKERS Outside speakers let you listen to your favorite music or sport channel outside.



EXTERIOR SHOWER Hot and cold controls make clean-up simple and easy.



BLACK TANK FLUSH Tank clean out made simple with this standard and convenient feature.



POWDER COATED FRAMES Our all steel I-Beam frames provide you with the most superior foundation.



HEATED AND ENCLOSED UNDERBELLY Surveyor's aerodynamic underbelly is heated and enclosed. The entire underbelly is warmed by radiant heat from the heat duct allowing you to use the coach in colder weather environments. This unique construction method opens up storage space above the floor, while lowering the units' center of gravity for towing ease and stability. (Standard Selects and Fifth Wheels Enclosed Only Sports, Optional Enclosed Cadets)



SUPERIOR CONSTRUCTION Surveyor is one of the strongest light weight trailers because of our lamination process. High quality materials, 100% glue coverage and fully framed aluminum floor, roof, walls, fronts and backs provide you a structure for peace of mind.

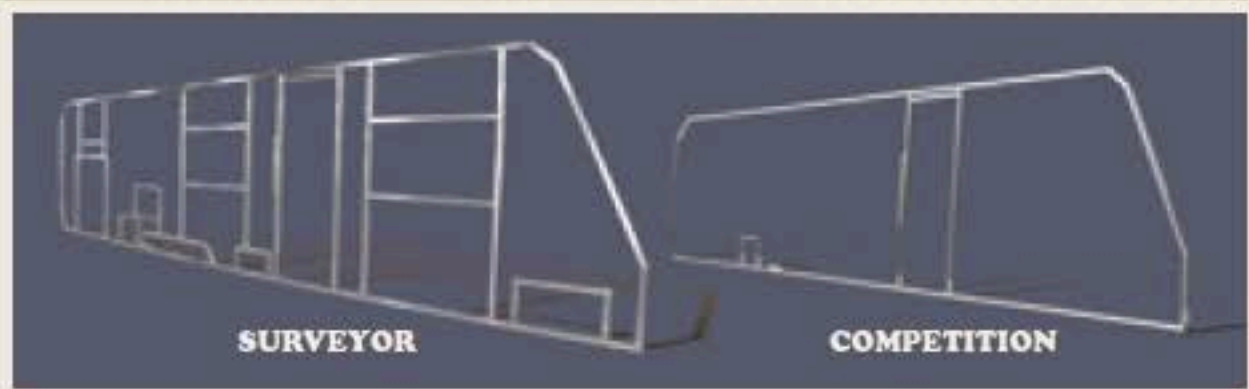

SURVEYOR

COMPETITION



SPOKED ALUMINUM RIMS

Designer black split spoke rims add a stylish look to the exterior of every Surveyor Travel Trailer! (Optional Sports and Cadets)



SLAM LATCH BAGGAGE DOORS

These bus style latches make opening and closing your baggage doors convenient and easy. (N/A Sports and Cadets)



DRIP RAIL AND EXTENDED DOWN SPOUT

Keep the exterior of your coach in pristine condition with this great feature, it keeps rain water from streaking the side of your coach.

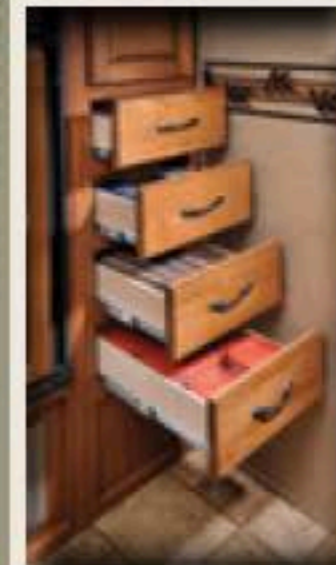

METAL DRAWER GLIDES

Ball bearing drawer glides allow you to access the whole drawer, and will provide you with years of trouble free service.



PLEATED SHADES (OPTIONAL)

Designer styled valances and optional Day/Nite shades provide all the privacy you need. (Standard on Fifth Wheels)



SERTA MATTRESS (OPTIONAL)

Stretch out and sleep in on this Forest River Exclusive.



SPACIOUS PANTRIES

Surveyor's unique use of adjustable shelves and residential recessed spring loaded hidden hinges offer you the freedom to store all your camping necessities.



FOLD UP BIKE RACK WITH TOY LOCK

Standard on Sports, Selects and Fifth Wheels. (N/A Cadets)



FANTASTIC FAN (OPTIONAL)

Fantastic Fans are standard in all Surveyor Select baths. This 12" 10-blade bath fan significantly increases air circulation and the removal of condensation as compared to the industry's standard smaller bath vent. (N/A Sports)

DECORS, STANDARDS AND OPTIONS



HARVEST



ESPRESSO



TUSCANY

| | CADET | SPORT | SELECT | FW'S |
|---|-------|-------|--------|------|
| APPLIANCES/EQUIPMENT | | | | |
| Dometic, G/E Flush-Mount Refrigerator | X | X | X | X |
| Power Range Hood w/ Light | X | X | X | X |
| Six Gallon G/E DSI Water Heater w/ Quick Recovery | X | X | X | X |
| Three Burner Range Top | X | X | X | X |
| Gas Oven with Piezo Ignition | X | X | X | X |
| Microwave Oven | X | X | X | X |
| 20,000 BTU Furnace (Ducted 23'-26') | X | X | X | N/A |
| 30,000 BTU Ducted Furnace (27' and Above) | X | X | X | X |
| 13.5K Air Conditioning (Ducted ALL MODELS) | X | X | X | N/A |
| 15K Air Conditioning (Ducted ALL MODELS) | N/A | O | O | X |
| Digital Wall Thermostat | X | X | X | X |
| Stereo CD/DVD with MP3/SD Card/USB Ports and Remote Control | X | X | X | X |
| Samsung 5.1 Dolby Digital AM/FM/DVD | N/A | N/A | N/A | X |
| BATH | | | | |
| Fiberglass Tub/Shower | X | X | X | X |
| Adjustable Shower Head/Faucet | X | X | X | X |
| Lavatory Sink and Faucet | X | X | X | X |
| Wood Medicine Cabinet w/ Mirror | X | X | X | X |
| Thetford Commode with Foot Flush | X | X | X | X |
| Skylight in Tub/Shower | X | X | X | X |
| Monitor Panel | X | X | X | X |
| CONSTRUCTION | | | | |
| Full Aluminum Cage Construction | X | X | X | X |
| Full Walk on Roof | X | X | X | X |
| Barreled Roof w/ Aluminum Trusses 16" on Center | X | X | X | X |
| 3/8" Decking | X | X | X | X |
| 2" Laminated Sidewall (R9) | N/A | N/A | X | X |
| 1-1/2" Laminated Sidewall (R7) | X | X | N/A | N/A |
| 2" Laminated Floor (R9) | X | X | X | X |
| Electric Powered Slide-Out Mechanism w/ Manual Override | X | X | X | X |
| ELECTRICAL | | | | |
| Detachable 28' 30-amp Power Cord | X | X | X | NA |
| Outside TV Bracket | N/A | X | X | X |
| Cable Connection on Door Side | X | X | X | X |
| 55 amp Converter with Charger | X | X | X | X |
| Exterior 120 volt Recept | X | X | X | X |
| Patio Light with Amber Lens | X | X | X | X |
| Hitch Light | X | X | X | X |
| Pass Thru Storage Light | X | X | X | X |
| 12-volt Interior Lighting | X | X | X | X |
| 120-volt GFI Protected Circuit Safety | X | X | X | X |
| Decorative Globe Light (some models) | N/A | X | X | X |
| Cable & Satellite Ready | X | X | X | X |
| EXPANDABLE BEDS | | | | |
| Attached Vinyl Weathershield Tent(s) | X | N/A | N/A | N/A |
| Automotive Rubber Gasket and Compression Latches | X | N/A | N/A | N/A |
| Quilted Bunk Cushions | X | N/A | N/A | N/A |
| Radius Door w/ Hinge | X | N/A | N/A | N/A |
| 1,000# Capacity | X | N/A | N/A | N/A |
| SAFETY | | | | |
| Break-Away Switch | X | X | X | X |
| Fire Extinguisher | X | X | X | X |
| LP Detector | X | X | X | X |

| | CADET | SPORT | SELECT | FW'S |
|---|-------|-------|--------|------|
| Smoke Detector | X | X | X | X |
| Ground Fault Protected Electrical Circuit(s) | X | X | X | X |
| Dead-Bolt Door Lock | X | X | X | X |
| Safety Chains | X | X | X | N/A |
| CO ² Detector | X | X | X | X |
| Tinted Safety Glass | X | X | X | X |
| EXTERIOR | | | | |
| One Piece Roof Membrane w/ 12 Year Warranty | X | X | X | X |
| Lamilux Super 4000 "Cool Vanilla" Gel coat Fiberglass Skin w/ 2 Year Warranty | N/A | N/A | X | N/A |
| Lamilux Super 1000 Fiberglass Skin w/ 2 Year Warranty | X | X | N/A | X |
| Radius Corner Windows | X | X | X | X |
| Flush Mount Outside Storage Compartment(s) w/ Rubber D-Seal | X | X | X | X |
| Flush Mount "Slam Latch" Outside Storage Compartment(s) w/ Rubber D-Seal | N/A | N/A | X | X |
| Self-Storing Double Entrance Step(s) | X | X | X | N/A |
| Self-Storing Triple Entrance Steps (some models) | N/A | X | X | X |
| Butyl Tape Sealant on Seams | X | X | X | X |
| Combination Entrance/Screen Door w/ Dead-Bolt Lock | X | X | X | X |
| Designer Exterior Graphics | X | X | X | X |
| 20# LP tanks w/ Molded Cover | X | N/A | N/A | N/A |
| 30# LP tanks w/ Molded Cover | N/A | X | X | X |
| Enclosed Underbelly | O | X | N/A | N/A |
| Heated Enclosed Underbelly (select models sport) | N/A | X | X | X |
| Extended Drip Rail and Down Spout | X | X | X | X |
| Electric Awning w/ Adjustable Rain Dump | O | X | X | X |
| Manual Awning | X | N/A | N/A | N/A |
| LED Awning Light | X | X | X | X |
| Heavy Duty Scissor Jacks | X | X | X | N/A |
| Omni-Directional TV Antenna | X | X | X | X |
| Dual Battery Rack | X | X | X | X |
| 4" Square Bumper w/ Sewer Hose Storage | X | X | X | X |
| Outside Shower | X | X | X | X |
| Spare Tire w/ Carrier | X | X | X | X |
| INTERIOR | | | | |
| Deep Double-Bowl Kitchen Sink w/ High Rise Faucet | X | X | X | X |
| Knife Block Behind Stove | X | X | X | X |
| Panoramic Galley Window | X | X | X | X |
| Valances with Mini-Blinds | X | X | X | N/A |
| Designer Carefree [®] Flooring | X | X | X | X |
| Solid Lumber Core Cabinet Fronts Assembled w/Screws | X | X | X | X |
| Residential Style Cabinet Doors w/ Concealed Hinges | X | X | X | X |
| Power Range Hood with Light | X | X | X | X |
| Residential Style Wood Drawers w/ Ball Bearing Glides | X | X | X | X |
| In-Floor Heat Ducts (Where Available) | N/A | X | X | X |
| 82" Interior Height | X | X | X | X |
| 80# Gas Bed Struts (Queen Beds) | X | X | X | X |
| Adjustable Shelves in Pantry (Where Applicable) | X | X | X | X |
| E-Z Glide Dinette Table | N/A | X | X | X |
| Ceiling Light Switch at Entrance Door | X | X | X | X |
| 60x80 Queen Beds | X | X | X | X |
| Screwed & Glued Cabinetry | X | X | X | X |
| Sink Covers | O | O | X | X |
| Stove Cover | O | O | X | X |
| Shaw [®] r2x Stain and Soil Resistant Carpet | N/A | X | X | X |

ADVANTAGES



PLUMBING

| | | | | |
|---------------------------------------|---|---|---|---|
| Black Tank Flush | X | X | X | X |
| Color-Coded Water Lines | X | X | X | X |
| Copper Gas Lines, Double Flared | X | X | X | X |
| Rotocast Holding Tanks, Underfloor | X | X | X | X |
| Rotocast Fresh Water Tank, Underfloor | X | X | X | X |
| Demand Waterpump, 12-volt | X | X | X | X |
| City Water Fill | X | X | X | X |
| Gravity Water Fill | X | X | X | X |
| Water Heater Bypass Kit | X | X | X | X |
| Winterization Kit | X | X | X | X |

RUNNING GEAR

| | | | | |
|---|---|---|---|-----|
| Super-Lube Hubs | X | X | X | X |
| Galvanized Steel Wheel Wells | X | X | X | X |
| Equa-Flex Suspension System (N/A SC-191T) | X | X | X | X |
| Leaf Spring Axle(s) | X | X | X | X |
| Radial Trailer Tires | X | X | X | X |
| Nav-R-Adjust [®] Electric Brakes, All Wheels | X | X | X | X |
| Tough Powder Coated Frame | X | X | X | X |
| 2-5/16" Coupler | X | X | X | N/A |
| 205/75/R14C Tires (Model Specific) | X | X | X | N/A |
| 225/75/R15D Tires (Model Specific) | X | X | X | X |

SURVEYOR OPTIONS

| | | | | |
|--|-----|-----|-----|-----|
| Diamond Package | X | X | X | X |
| Interior Luxury Package | X | X | X | X |
| Exterior Luxury Package | X | X | X | X |
| 15K Air Conditioner IPO 13.5 BTU A/C | N/A | O | O | X |
| Serta [®] "Dreamscape" Mattress | O | O | O | O |
| Pleated shades | O | O | O | X |
| Roof Ladder (N/A SC192T, SC225T SC224T) | O | O | O | O |
| Outside gas grill (STD. SP240, SP285, SP296 SP295, SP3051 & SV305) | O | O | O | O |
| Raised panel refer door inserts | O | O | O | O |
| Power tongue jack | O | O | O | N/A |
| Slide-Out Awning topper | O | O | O | O |
| CO ² detector (Required in all models) | X | X | X | X |
| Power Stabilizer Jacks | N/A | O | O | X |
| Fantastic Fan | O | O | O | O |
| Two (2) Bar stools (SV301, SV305, SP3011 & SP3051, SVF276, SVF278, SVF324BH) | N/A | O | O | O |
| 8' cu. ft. Refer | N/A | N/A | N/A | X |
| Wood Planked Vinyl Flooring | O | O | O | O |
| Aluminum Wheels | O | O | X | X |
| Fireplace | N/A | N/A | N/A | X |
| Detachable 28' 50-amp Power Cord | N/A | N/A | N/A | X |
| Dyson Cordless Vacuum | O | O | O | X |

X = STANDARD EQUIPMENT, O = OPTIONAL, N/A = NOT APPLICABLE

SURVEYOR WARRANTY INFORMATION

For Details on Surveyor's complete warranty program, see your Surveyor dealer. Surveyor offers the following additional limited warranties to the original purchasers. Consult written warranty for details.

1. Twelve year roof membrane warranty
2. Two year fiberglass warranty
3. Two year axle warranty
4. One year bumper to bumper warranty
5. Available second-year warranty

CADET

INTERIOR LUXURY PACKAGE: RAISED PANEL CABINET DOORS W/ RESIDENTIAL HIDDEN HINGES, AM/FM/CD/DVD STEREO SYSTEM WITH REMOTE CONTROL, BALL BEARING DRAWER GUIDES, 6 GAL. G/E DSI WATER HEATER, CONGOLEUM "CAREFREE" LINOLEUM, DUCTED AIR CONDITIONING WITH "QUICK COOL" FEATURE, 3 BURNER STOVE TOP WITH OVEN, DOUBLE DOOR REFRIGERATOR AND SKYLIGHT OVER TUB/SHOWER.

EXTERIOR LUXURY PACKAGE: 20# LP BOTTLES WITH COVER, DOUBLE ENTRY DOOR STEP, OMNI DIRECTIONAL HD TV ANTENNA WITH CABLE/SATELLITE HOOK-UP, DETACHABLE 30 AMP POWER CORD, WELDED ALUMINUM CAGE CONSTRUCTION, DUAL BATTERY RACK, BLACK TANK FLUSH, OUTSIDE SHOWER, FOUR SCISSOR STABILIZING JACKS AND SPARE TIRE WITH COVER.

DIAMOND PACKAGE: LED AWNING LIGHT, QUILTED TENT MATTRESSES, EQUA-FLEX SUSPENSION SYSTEM (N/A SC191T) AND OUTSIDE STEREO SPEAKERS.

SPORT

INTERIOR LUXURY PACKAGE: RAISED PANEL CABINET DOORS W/ RESIDENTIAL HIDDEN HINGES, SKYLIGHT OVER TUB/SHOWER, AM/FM/CD/DVD STEREO SYSTEM WITH REMOTE CONTROL, BALL BEARING DRAWER GUIDES, E-Z GLIDE DINETTE TABLE, 6 GAL. G/E DSI WATER HEATER AND CONGOLEUM CAREFREE LINOLEUM.

EXTERIOR LUXURY PACKAGE: ELECTRIC AWNING, 30# LP BOTTLES WITH COVER, DETACHABLE 30 AMP POWER CORD, OMNI DIRECTIONAL HD TV ANTENNA WITH CABLE/SATELITE HOOK-UP AND EXTERIOR TV BRACKET, OUTSIDE STEREO SPEAKERS, ASSIST GRAB HANDLE, FULLY ENCLOSED UNDERBELLY (HEATED SOME MODELS), BLACK TANK FLUSH AND OUTSIDE SHOWER.

DIAMOND PACKAGE: LED AWNING LIGHT, EQUA-FLEX SUSPENSION SYSTEM, FOLD DOWN BIKE RACK, TOY LOCK, 26" LED FLAT SCREEN TV, QUILTED BUNK MATTS AND RADIUS SHOWER CURTAIN WITH TRACK (WHERE APPLICABLE).

SELECT

INTERIOR LUXURY PACKAGE: RAISED PANEL CABINET DOORS W /RESIDENTIAL HIDDEN HINGES, SKYLIGHT OVER TUB/SHOWER, AM/FM/CD/DVD STEREO SYSTEM WITH REMOTE CONTROL, BALL BEARING DRAWER GUIDES, E-Z GLIDE DINETTE TABLE, 6 GAL. G/E DSI WATER HEATER, STOVE AND SINK COVER, CONGOLEUM CAREFREE LINOLEUM AND DECORATIVE BEDROOM PILLOWS.

EXTERIOR LUXURY PACKAGE: ELECTRIC AWNING, 30# LP BOTTLES WITH COVER, DETACHABLE 30 AMP POWER CORD, OMNI DIRECTIONAL HD TV ANTENNA WITH CABLE/SATELLITE HOOK-UP AND EXTERIOR TV BRACKET, OUTSIDE STEREO SPEAKERS, ASSIST GRAB HANDLE, FULLY ENCLOSED HEATED UNDERBELLY, BLACK TANK FLUSH, OUTSIDE SHOWER, ALUMINUM SPLIT SPOKE RIMS, SLAM LATCH BAGGAGE DOORS AND LAMILUX 4000 COOL VANILLA GEL-COATED FIBERGLASS.

DIAMOND PACKAGE: LED AWNING LIGHT, EQUA-FLEX SUSPENSION SYSTEM, FOLD DOWN BIKE RACK, TOY LOCK, 26" LED FLAT SCREEN TV, QUILTED BUNK MATTS AND RADIUS SHOWER CURTAIN WITH TRACK (WHERE APPLICABLE).

FIFTH WHEEL

INTERIOR LUXURY PACKAGE: SOLID SURFACE KITCHEN COUNTERTOPS WITH UNDER MOUNT SINK AND COVERS, STOVE COVER, RAISED PANEL CABINET DOORS W/ RESIDENTIAL HIDDEN HINGES, SKYLIGHT OVER SHOWER, 6 GAL. G/E DSI WATER HEATER, PLEATED SHADES, FIREPLACE, 8 CU. FT. REFRIGERATOR AND 2ND AM/ FM CD/DVD STEREO IN BEDROOM, HIDE A BED SOFA (SELECT MODELS ONLY).

EXTERIOR LUXURY PACKAGE: 15K AIR CONDITIONER, ELECTRIC AWNING, ELECTRIC FRONT LANDING GEAR WITH SNAP PINS, OMNI 360 DIRECTIONAL HD TV ANTENNA WITH CABLE/SATELLITE HOOK-UP AND EXTERIOR TV BRACKET, OUTSIDE SPEAKERS, LARGE FOLDING ASSIST HANDLE, 12V BATTERY DISCONNECT SWITCH, BLACK TANK FLUSH, OUTSIDE SHOWER WITH 15' SPRAYER HOSE, FULLY ENCLOSED UNDERBELLY, BUILT IN UTILITY CENTER, SLAM LATCH BAGGAGE DOORS, ALUMINUM WHEELS, DETACHABLE 50 AMP POWER CORD LED DOCKING LIGHTS AND ELECTRIC REAR STABILIZER JACKS.

DIAMOND PACKAGE: LED AWNING LIGHT, EQUA-FLEX SUSPENSION SYSTEM, FOLD DOWN BIKE RACK, TOY LOCK, 32" LED FLAT SCREEN TV, SAMSUNG 5.1 1000 WATT HOME THEATER SYSTEM, QUILTED BUNK MATS (WHERE APPLICABLE).

Surveyor



24/7 EMERGENCY ROADSIDE ASSISTANCE

For a worry-free ownership experience Forest River includes one

Coach-Net[®]

RV Technical & Roadside Assistance

year of Coach-Net RV Technical & Roadside Assistance with each RV purchase. Whether new to the RV lifestyle or an experienced RV enthusiast, Forest River owners have 24/7 access to technical, operational and emergency road service coverage throughout the US & Canada. Coach-Net's fast, dependable service is just a phone call away.



Forest River, Inc. encourages our customers to purchase their Forest River products from a local dealership whenever possible for the following reasons:

It is the goal of Forest River, Inc. that all of our RV owners fully enjoy the RV experience and that customer satisfaction meets or exceeds their expectations!

- 1) Forest River, Inc. dealers are independently owned and operated businesses so priority service and scheduling is at their discretion and is often provided to customers that purchased their unit at that dealership.
- 2) Purchasing locally allows customers to establish meaningful relationships with a dealer, enhancing the RV experience through assistance with product questions, user tips or RV regulations for your state or country, and much more!
- 3) Canadian customers must meet requirements to bring an RV purchased out of the country to their home. These requirements may involve additional inspections and certifications, taxes and fees. Your local Canadian Dealer is a professional at meeting these requirements.
- 4) Scheduling timely warranty repairs and adjustments through a local dealership provides far greater flexibility and convenience to you, the customer!



PRE-DELIVERY INSPECTION FACILITY

20,000 square feet of quality assurance. The bare essentials for a premium product. This state-of-the-art facility gives immediate daily feedback to production for quality assurance in every unit built.

As Surveyor constantly strives to improve our product, all specifications listed in this informative brochure are subject to change without notice or obligation. Photos may show optional equipment which is not included in the purchase price of the unit.

Review a current model on your dealer's lot today. FRSV115



Learn More

Scan this barcode using a QR Reader on your smart phone to learn more about Forest River.



A Berkshire Hathaway company.

Forest River, Inc.
2405 Century Dr.
Goshen, IN 46528
(574) 642-3119
www.forestriverinc.com/surveyor
www.forestriveraccessories.com

FREE MEMBERSHIP
to Forest River Owners' Group

www.forestriverfrog.com

