

# PROVIDENCE<sup>®</sup>

CLASS A DIESEL

IF THE WORLD IS YOUR OYSTER,  
YOU'VE JUST FOUND YOUR PEARL.



2008 PROVIDENCE

 FLEETWOOD<sup>®</sup>



# FOR THOSE WHO CONSIDER LUXURY A NECESSITY.

Some people have a keen appreciation for the finer things in life. And Providence is definitely one of the finer things. With its heightened sense of style and luxury touches, Providence makes every trip an indulgence. It features lush fabrics, natural grained wood cabinetry and crown molding throughout the coach, just like the finest homes. In fact, our new 40X model boasts a 40" Samsung® LCD HDTV in the center of the coach, providing a home theater experience. The halogen lights feature dimmers to set the right mood. These are just a few of the features that make Providence one of the most breathtaking coaches on the road.

## Quality



There's no cutting corners. Skilled craftsmen build every Fleetwood RV for maximum durability and longevity.



The Loveseat provides cozy seating for two to watch a romantic movie. Or, invite friends over and share a drink. The loveseat faces the sofa, creating a nice conversation area (select models). For extra indulgence, opt for the loveseat covered in rich Ultraleather™



The Front Entertainment Center lets you enjoy The History Channel after a day touring the Smithsonian. The system includes a 26" Samsung® LCD HDTV (optional for the 40X model), DVD player and Dolby® 5.1 theater sound system with front, rear and center speakers, and a subwoofer. And you can enjoy home movies or video games with the RCA TV jacks.

## Why Buy Providence?



### Impressive Exterior

Providence makes a striking first impression with its commanding size, sparkling paint and obvious attention to detail.





Providence 39R shown in Raven interior décor with Plantation Cherry wood cabinetry.

### Cummins® 360HP Diesel Engine

As one of the finest performing diesel engines in the world, the Cummins® ISC 8.3L engine provides mighty power underfoot.

### Sophisticated Décor

Travel surrounded by sumptuous elegance, where everything delights the eye. Providence elevates adventure to a new level of luxury.

### Top-Of-The-Line Components

Providence is equipped with high-end brand names that carry the prestige and quality you expect. The appliances, electronics and furnishings are top-notch.

### Upscale Conveniences

To make life more comfortable, Providence contains step-saving features at every turn. It's as if we anticipated your every need.

### Wide Variety of Floor Plans

When the living space feels right, you know it instinctively. With six different floor plans, one will be right for you.



## THE CRÈME DE LA CRÈME OF GALLEYS.

The galley in Providence challenges the finest kitchens. Its brand name appliances, top-of-the-line components and sheer beauty place it in a distinct league. The exquisite cabinetry features solid wood doors and adjustable shelving, highlighted by solid surface countertops that are non-porous and easy to clean. In the galley, your good taste is on display.

### Trust



More people trust Fleetwood. After all, we've spent over 50 years perfecting RVs, earning the loyalty of generations of RVers.



PROVIDENCE



The Dinette is situated next to a big picture window. Add an elegant meal and a sunset, and enjoy a romantic dinner date.



The Pantry holds the ingredients for gourmet meals and light snacks. Select models feature pull-out baskets that make packing faster. Simply fill them inside your kitchen at home, then slide into Providence's pantry.

Fully Extending Drawers allow you to store things at the very back.

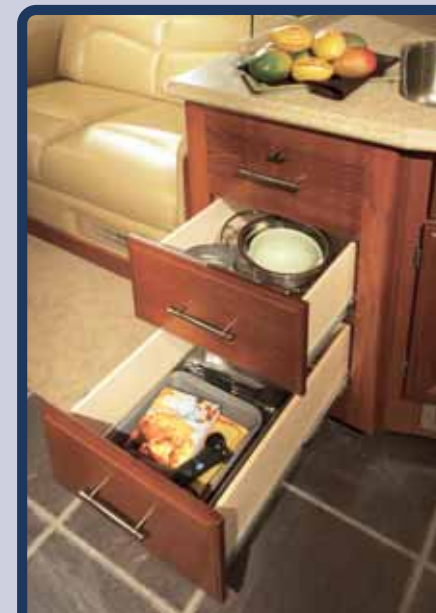





The Pull-Out Galley Extension gives you an instant island, a perfect place for appetizer trays. When the soirée is over, just roll the extension back underneath the cabinet and it's out of the way.



The Residential Grade Sink and Faucet features a Blanco™ stainless steel double sink with a cool, contemporary look. The artful wand faucet features single-lever control, with dispensers for soap and hand lotion.



The Under Counter TV with DVD Player (optional) is sure to be the chef's favorite toy. You can flip down the 10' LCD TV, swivel it to the best view, and make a recipe along with your favorite cooking show. The system also includes a CD player and AM/FM radio.



The Galley features a Norcold® 12 cu. foot refrigerator in a four-door model with ice maker to cool your drinks. The sleek stainless door has a water dispenser too. In addition to the 3-burner stove, the GE® convection microwave cooks and bakes food in a fraction of the time of an oven. And to keep these appliances running flawlessly, we've added a 2000 watt pure sine inverter to deliver clean, pure AC power.

# WIDE-OPEN SPACES.

Step into the bedroom and you'll be amazed at the amount of room you have to relax. While many expect you to sleep in cramped quarters, Providence offers a wealth of space thanks to the new 30" slide (not offered on 39L model). Most competitors offer just a 19" slide. In fact, Providence is available with full-wall, triple and quad slide-out options. And when you're lying in your spacious bed, you can appreciate the tall ceilings too. Sweet dreams.

## Passion



We're truly passionate about the RV lifestyle. Fleetwood was founded by RV enthusiasts, and that tradition continues today.



PROVIDENCE



The Bathroom Vanity is a lavish setting to get ready for the day. The mirrored cabinetry holds your cosmetics and grooming supplies, with vanity lighting to help you look your best. A sparkling Moen® faucet graces the solid surface countertop.



The Shower turns your daily routine into an indulgence. Try a water massage from the adjustable showerhead, bathed in light from the shower's skylight.







The Bedroom Suite beckons with acres of cushiony real estate, thanks to the Restonic® queen-size pillowtop innerspring mattress. An optional air mattress lets you customize the firmness on each side independently. When you get out of bed in the morning, your feet will appreciate that first step on plush Fabrica™ carpeting – it feels as good as it looks. And hidden away behind handsome cabinetry is the optional Washer/Dryer Combo.



The Lounge Area (models 39R and 39V) is like your private den, complete with a comfortable chair. After you put your clean linens in the dresser, sit back and enjoy the entertainment center, featuring a 19" Samsung® LCD HDTV.

The Cedar Lined Wardrobe keeps your clothing well organized and wrinkle-free. Before you head out for an evening at the theater, review your outfit in the full-length mirror. Then give yourself a standing ovation!

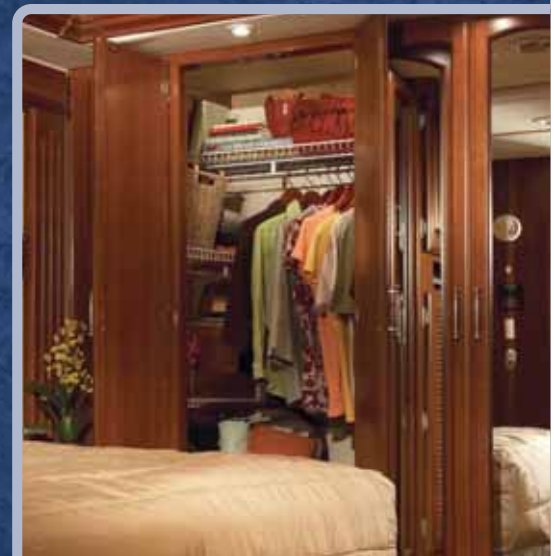

# BEHIND THE WHEEL, YOU'RE ON TOP OF THE WORLD.

You're rolling down the road, free as a bird, sunlight glinting off the dazzling paint of your Providence. Passengers in the next lane gaze wistfully your way — it's yet another case of "Providence Envy." Be sure to wave from behind your expansive one-piece windshield, which provides an uninterrupted view of the horizon.

 PROVIDENCE



The Color Back-Up Monitor lets you see what's behind you. The rear camera allows you to check your towed vehicle and view behind it.



The Ultraleather™ Driver and Passenger Seats feature sleek lines and designer style with supple Ultraleather™ covering. But their real beauty is inside. They've been engineered to reduce fatigue during those long hours on the road with a Flexsteel® frame and adjustable armrests. The seats are heated to keep you cozy in the cold, and the passenger seat includes a power footrest.





The 360HP Cummins® ISC 8.3L Engine powerfully pushes you over hills and through valleys with 1050 foot pounds of torque. It also has the muscle to tow a vehicle behind you for touring the nearby town.

The Ergonomically Designed Instrument Panel places all the controls at your fingertips. The large, backlit gauges are easy to read at a glance, even at night. And the Information Center continuously monitors your coach's performance on the road.



The Cockpit Area wraps around you to deliver a superior driving experience. Even the steering wheel tilts and telescopes to suit your frame. The drive flies by with an AM/FM radio with CD player and it's Sirius Satellite Radio® ready.



Keyless Remote Entry lets you lock and unlock your Providence with the push of a button. It also turns a light on in the coach to help you see in the dark.



Power Visors cut the sun's glare with the touch of a button, allowing you to make adjustments with precision. And when it's time for privacy, the visors extend all the way to the dash to close out the world.

# THE HIGH-GLOSS PAINT REFLECTS YOUR ELEGANT TASTE.

The light bounces off the highly polished paint, revealing Providence's ultra-smooth walls down the entire length of the coach. The full-body paint is carefully applied using a two-step process and DuPont® paint for maximum durability and undeniable beauty.

Pacific Blue  
SCHEME 1\*



Black Gold  
SCHEME 1\*



Mocha  
SCHEME 1\*



Iron  
SCHEME 1\*



White Diamond  
SCHEME 1\*



Iron  
SCHEME 2\*

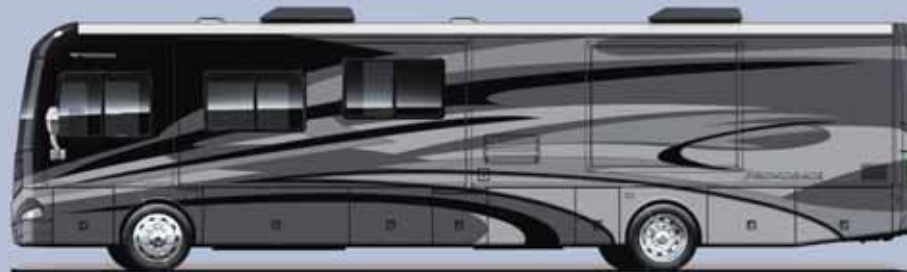

\* Each color is available in both Scheme 1 and Scheme 2 graphics. See your Fleetwood dealer or visit our website at [www.fleetwoodrv.com](http://www.fleetwoodrv.com) to view all graphic and color choices.



# FRIENDS WILL ASK FOR THE NUMBER OF YOUR DECORATOR.

One glance will tell you that a lot of talent went into decorating Providence interiors, with their distinct designer look. Select from three décor palettes and three wood finishes, all coordinated throughout the coach.

## MINERAL

Living/Dining Room



Sofa

Dinette Cushions

Ultraleather™  
Driver and Front  
Passenger Seats,  
Sofa (optional)

Bedroom



Bedsread

Pillow Shams

Throw Pillows

## BRIARWOOD

Living/Dining Room

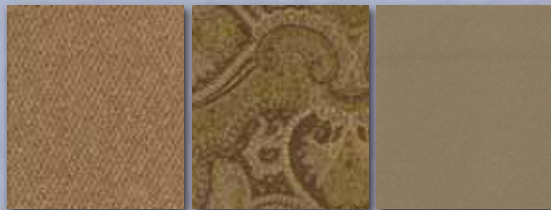

Sofa

Dinette Cushions

Ultraleather™  
Driver and Front  
Passenger Seats,  
Sofa (optional)

Bedroom



Bedsread

Pillow Shams

Throw Pillows

## RAVEN

Living/Dining Room

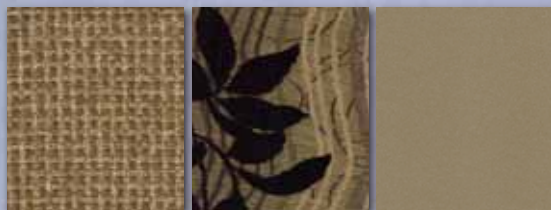

Sofa

Dinette Cushions

Ultraleather™  
Driver and Front  
Passenger Seats,  
Sofa (optional)

Bedroom

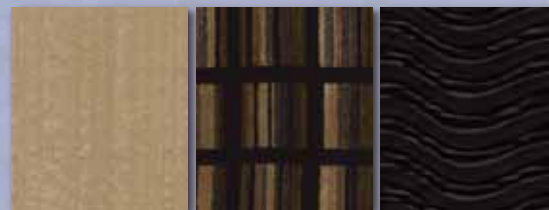

Bedsread

Pillow Shams

Throw Pillows

## WOOD FINISHES



Plantation Cherry



Summit Ash



Windsor Birch

# A FULL-FEATURED BEAUTY.

In Providence, you'll find an abundance of standard features to make your life more convenient and comfortable. Here are just a few of our favorites.

- ① Electric Awnings for the patio and entry door provide a shady outdoor area to sip ice tea and enjoy the fresh air. And should the wind kick up when you're out on the links, the awnings will retract, thanks to the wind sensor on the main awning.
- ② The Illuminated Entry Handle glows from within, helping you to see at night and accenting your coach dramatically.



Vehicle shown in Iron Scheme 1 exterior graphics.

- ③ Stylish Chrome Heated Mirrors add sparkling flair, and stay warm to prevent dew or frost build-up for a clearer view.
- ④ The Front Cap, redesigned for 2008, exudes sophistication. The raised chrome logos highlight Providence's status.

- ① Dual Air Conditioning Units are mounted on top to improve cooling, and create more room for storage below.
- ② Storage Compartments feature insulated aluminum doors and gas-lift strut supports. You can open the single paddle latches with one hand, and the lighted interiors help you to see your gear at night.



Vehicle shown in Iron Scheme 1 exterior graphics.

- ③ High-Mounted Taillights are easy to see, even over towed vehicles, to warn tailgaters away.
- ④ 4-Point Automatic Leveling System levels your coach at the push of a button.





The Utility Compartment lets you empty the holding tanks from one central place. And the water sprayer rinses your sandy feet after a walk on the beach.

## GO OUT AND PLAY.

With Providence's plush interior, you'll be tempted to cocoon inside. But we've placed quite a few extraordinary features on the outside to coax you out to play. You'll remember why they call it the great outdoors.



The Side View Cameras (optional) mounted on the left and right sidewalls, transmit to the driver's area monitor. The cameras are controlled by the driver to help you see blind spots in the adjacent lanes. Once you're docked, they're handy for extra security.



The Spot Light (optional) illuminates the darkest night. Who needs the moonlight to play a game of gin rummy outside in the warm summer air? Use the wireless remote to move the spotlight easily.



Exterior Entertainment Center (optional) lets you watch the big game outdoors, just like the fans in the stadium. It features a 19" Samsung® LCD HDTV that folds neatly out of the way, and an AM/FM radio with a CD/DVD player.



Diamond Shield (optional) protects your paint finish on the lower front cap from paint chips and damage caused by road debris, bug acids and weathering. This clear, 8 mil. urethane film will preserve the beauty of your Providence for years to come.



Exterior Grill and Kitchenette (optional) extends with a push of a button to be an instant party-starter. Just throw on some juicy steaks, and you'll become popular instantly! Includes a propane grill, refrigerator, sink with hot and cold running water, storage areas, and even outlets for your margarita blender.

# POWER PLATFORM.<sup>®</sup> BECAUSE YOU HAVE A LOT RIDING ON THIS.

Fleetwood's patented Power Platform<sup>®</sup> is as strong as they come. It begins with two ten-inch steel I-beams welded to the chassis, with steel outriggers extending outward. Together, they create a basement for the fluid tanks and storage, while supporting the floor, walls and roof with a rigid metal frame. The 2008 models feature Pass-Through Storage along with the EZ Store Compartment to provide an amazing amount of storage.

**BASEMENT STORAGE** features aluminum doors, constructed of heavy-duty molded polyethylene so you can hose the compartments out.

**LARGE TOWING CAPACITY** lets you tow most vehicles with ease!<sup>1</sup>

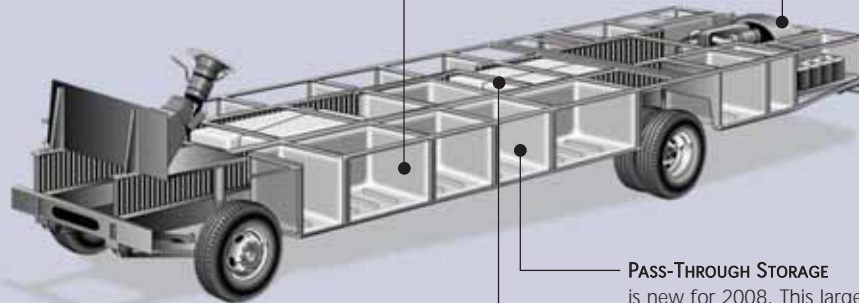

**HOLDING TANKS** are enclosed between the upper and lower basement floors so they can be heated in cold weather to help prevent freezing.

**PASS-THROUGH STORAGE** is new for 2008. This large compartment is lined with heavy-duty polyethylene so you can hose it out easily.

Drawings are for illustrative purposes only to highlight aspects of motor home construction. Actual motor home design depends on model and is subject to change.

<sup>1</sup> The chassis manufacturer recommends the installation of a supplemental brake control system to activate the brakes on the vehicle or trailer you are towing. Hitch receiver ratings expressed are maximum for the hitch receiver installed and may require the purchase of additional equipment that is dependent on the weight of the towed load. Consult with hitch receiver manufacturer for further information.

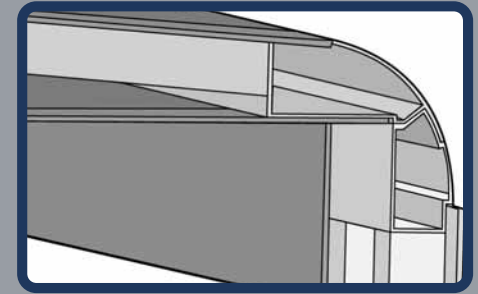

**Interlocking Ceiling-To-Sidewall Construction** helps keep the box square. This assures a proper cabinet fit.



**Interlocking Floor-To-Sidewall Construction** locks tightly to keep out water, dust and noise, and helps eliminate squeaks and rattles.

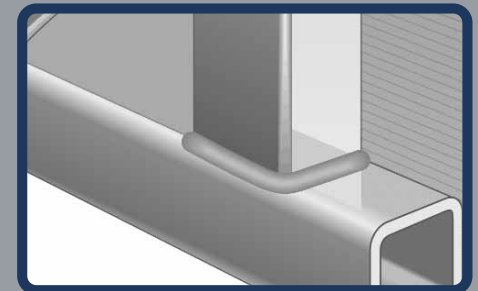

**Vacu-Bond<sup>®</sup> Sidewall Construction** creates a strong, weather-resistant structure. All sidewalls, floors and ceilings are Vacu-bonded to a durable metal frame, far superior to the pinch roll method our competitors often use.





The Pull-Out Basket keeps your smaller items together so they don't get scattered. It's a great place to stock your extra refreshments before they move to the refrigerator.

The EZ Store Compartment holds bulky items like golf equipment, coolers, or even a ladder. It's lined with a special polyethylene material that's easy to clean so your golf bag stays nice.



Pass-Through Storage is new on Providence for 2008. This big space holds chairs, sports gear and more – and you can access it from either side of the coach. The 40E model features two pass-through compartments.



## THE MOST IMPORTANT FEATURE IN PROVIDENCE: PEACE OF MIND.

Fleetwood engineers have designed dozens of safety features into Providence. They've thought of everything from blind-spot cameras (optional) to help you change lanes safely, to the safety inspection checklist on the information center monitor, to the four-wheel ABS air brakes. Combined with Fleetwood's superior construction, the result is a coach you can depend on for high quality and safety.

### Safety



You've got precious cargo. So we've engineered dozens of innovative safety features into our motor homes to give you more peace of mind.



PROVIDENCE

# PROVIDENCE FLOOR PLANS

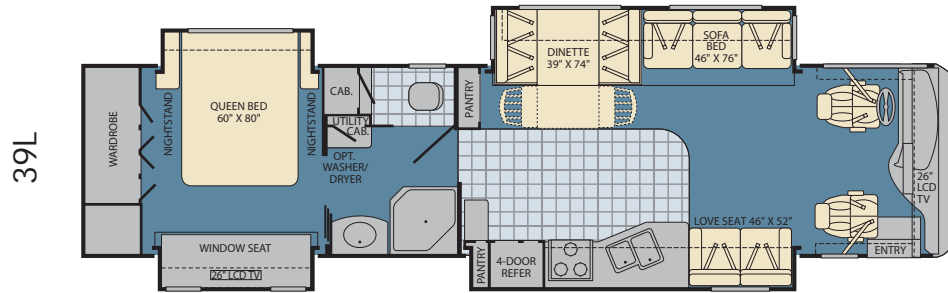

Interior Storage Capacity: 182 cu. ft.  
Exterior Storage Capacity: 162 cu. ft.

- Seating for up to 13 people in the huge dining and living room
- Cozy window seat in the second bedroom slide-out
- Available Options: 113, 126, 127, 128, 149, 173, 197, 200, 497, 821, 832, 833, 874

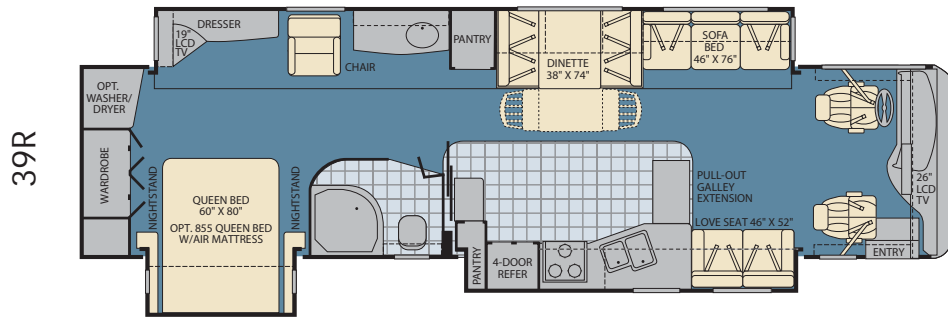

Interior Storage Capacity: 243 cu. ft.  
Exterior Storage Capacity: 201 cu. ft.

- Industry leading full-wall slide with opposing slide in the living room
- Residential dresser in the bedroom with multiple drawers
- Available Options: 113, 126, 127, 128, 149, 173, 197, 200, 497, 821, 832, 833, 874

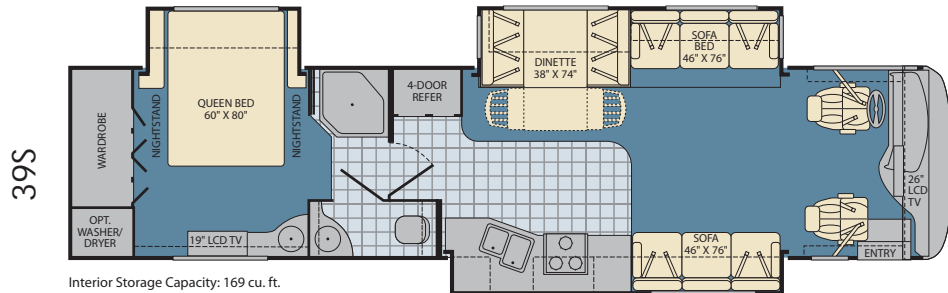

Interior Storage Capacity: 169 cu. ft.  
Exterior Storage Capacity: 162 cu. ft.

- Wide open living room and galley for extended use
- Second sink in the bedroom increases versatility
- Available Options: 113, 126, 127, 128, 149, 197, 200, 497, 804, 832, 833

## OPTIONS



OPT. 113  
3-BURNER  
RANGE  
W/OVEN



OPT. 128 DOMETIC 14 CU. FT.  
SIDE BY SIDE STAINLESS  
STEEL REFER



OPT. 126 DOMETIC 14 CU. FT.  
SIDE BY SIDE WITH WOOD  
INSERT DOOR PANELS



OPT. 127 NORCOLD 4-DOOR  
WITH WOOD INSERT DOOR PANELS

OPT. 149 NORCOLD 4-DOOR  
WITH WOOD INSERT DOOR PANELS

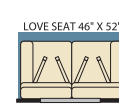

OPT. 173 ULTRALEATHER  
LOVE SEAT

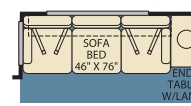

OPT. 174 ULTRALEATHER SOFA BED  
W/END TABLE AND LAMP

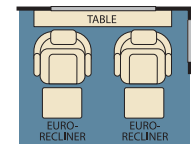

OPT. 197 DUAL SWIVEL  
RECLINERS W/TABLE

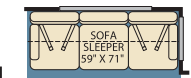

OPT. 200 ULTRALEATHER SOFA  
SLEEPER W/AIR MATTRESS

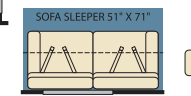

OPT. 201 ULTRALEATHER SOFA  
SLEEPER W/AIR MATTRESS



OPT. 497 PASSENGER SEAT  
W/FOOTREST



PROVIDENCE



39V

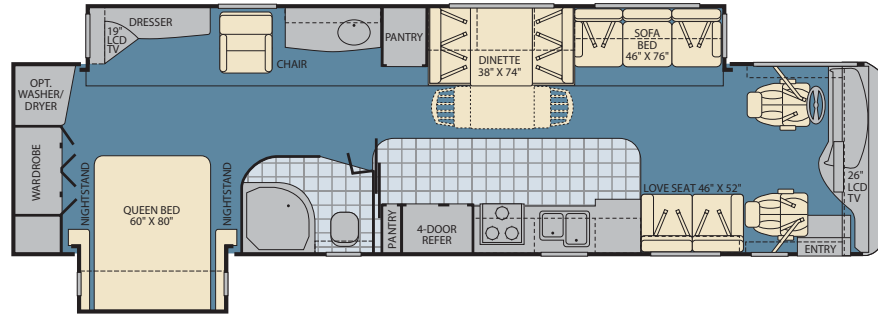

Interior Storage Capacity: 185 cu. ft.  
Exterior Storage Capacity: 189 cu. ft.

- Industry leading full-wall slide floor plan
- Large counter space for functional entertaining
- Available Options: 113, 126, 127, 128, 149, 173, 197, 200, 497, 821, 832, 833

40E

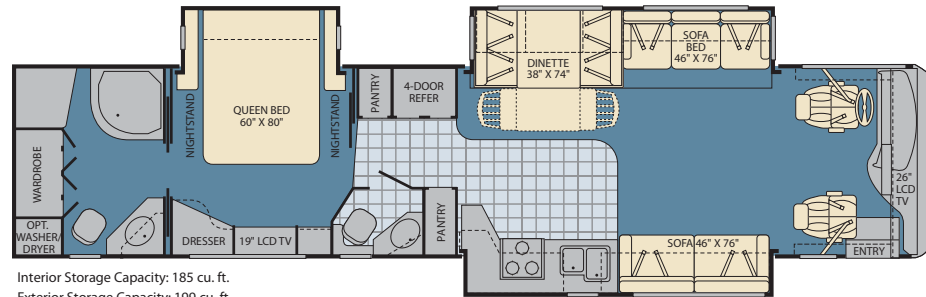

Interior Storage Capacity: 185 cu. ft.  
Exterior Storage Capacity: 199 cu. ft.

- Unique in class rear bath, bath and a half layout
- Seating for up to 14 people in the living and dining room
- Available Options: 113, 126, 127, 128, 149, 197, 200, 497, 804, 832, 833

40X

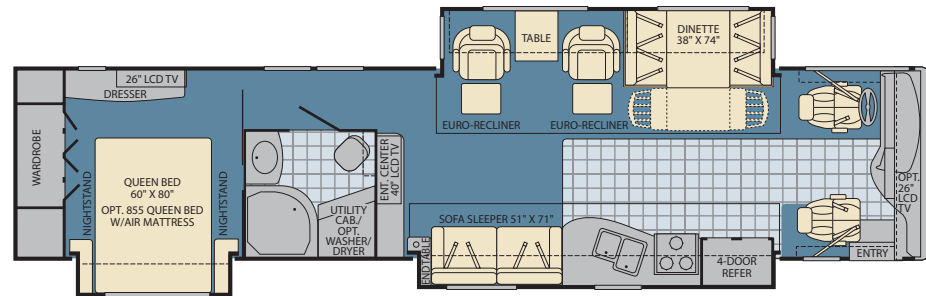

Interior Storage Capacity: 209 cu. ft.  
Exterior Storage Capacity: 206 cu. ft.

- Industry leading mid-coach home theater floor plan
- Side aisle bathroom for maximum privacy and space
- Available Options: 113, 126, 127, 128, 149, 174, 201, 497, 635, 832, 833

Seatbelt configuration may vary depending on options chosen.

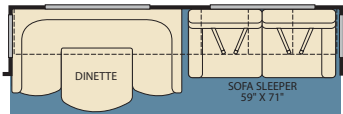

OPT. 635 U-SHAPED SECTIONAL SOFA/DINETTE AND ULTRALEATHER SOFA SLEEPER W/AIR MATTRESS

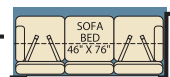

OPT. 804 ULTRALEATHER SOFA BED



OPT. 821 RECLINER W/TABLE

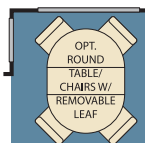

OPT. 832 FREE-STANDING DINETTE W/REMOVABLE LEAF

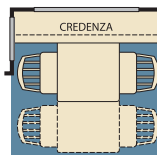

OPT. 833 FREE-STANDING DINETTE W/CREDENZA



OPT. 874 DESK W/FOLD-UP CHAIR

## Service



Help is nearby. When you need an upgrade or repair, you'll find facilities all across North America and more than 1,000 dealers ready to assist you.

## STANDARD FEATURES

### INTERIOR

#### Throughout

- 10 Gallon Quick Recovery Water Heater w/Direct Spark Ignition (Gas/Electric)
- 20,000/25,000 BTU Dual Furnaces
- 20,000/30,000 BTU Dual Furnaces (Model 39V)
- 84" Interior Ceiling Height
- Complete TuffPEX Plumbing System
- Crown Molding w/Decorative Corner Caps
- Day/Night Pleated Shades
- Deluxe Roller Bearing, Full Extension Drawer Guides & Transit-Ship Locks
- Demand Water Pump w/Filter
- Dual Roof Mounted A/C High Efficiency w/Solar Panel & Chill Grill on Front A/C
- Hardwood Cabinet Doors/Drawers
- Plush Wall-to-Wall Fabrica™ Carpet w/Carpet Pad
- Solid Surface Countertops and Sink Covers
- Vinyl Padded Ceiling
- Wall Switches (Includes Switches for Ceiling Lights & Vents)
- Water Heater Bypass
- Whole Coach Water Filtration System
- Wood Finish Return Air Intake for Furnace

#### Driver Convenience

- Adjustable 3 Point Seat Belts at Driver & Front Passenger Seats (with adjustable shoulder straps)
- AM/FM/CD Stereo, Sirius Satellite Radio® Ready
- Color Back-Up Monitor
- Auxiliary Start Circuit
- Backlit Switches & Gauges
- Battery Disconnect System
- CB Radio Ready
- Cruise Control
- Driver Side Manual Pull Down Shade
- Driver/Front Passenger Ultraleather™ Captain's Chairs w/Reclining Back/Slide Controls/Power/Heated/Adjustable Arms
- High-Output Auto A/C Heater Combo
- Passenger Armrest w/Integrated Magazine Rack
- Passenger Seat w/Power Footrest & Adjustable Armrest
- Power Driver/Front Passenger Sun Visors
- Radio Switch Main/Auxiliary Power
- Soft Surface Automotive Dash w/Area for Laptop GPS (Laptop & GPS Not Included)
- Tilt/Telescoping Steering Wheel

#### Galley

- 1.4 cu.ft. Convection Microwave Oven w/Stainless Steel Front
- Norcold® 12 cu.ft. 4 Door Stainless Steel Refrigerator w/Ice Maker and Water Dispenser
- 3 Burner, High-Output Cooktop w/Sealed Burners
- Adjustable Cabinet Shelves (Select Cabinets)
- Fan-Tastic® Power Roof Vent w/Wall Switch
- Laminate Floor Tile
- Large, Double Stainless Steel Sink
- Raised Panel Cabinet Doors
- Single Lever Galley Faucet w/Pullout Sprayer

- Six Person Pull-Out Dinette Table (Select Models)
- Slide-Out Dinette Bins w/Latches
- Soap & Lotion Dispensers
- Solid Surface Countertop, Sink & Range Covers
- Under Galley Shelving & Wastebasket
- Window Over Sink

#### Living Room

- Samsung® 26" LCD HDTV (40" 40X Model)
- DSS/Stationary Auto Locating Satellite Dish (Covered)
- Samsung® DVD Home Theater Sound System w/Hidden Surround Sound Speakers
- Easy Sweep Laminate Flooring at Entry
- Flexsteel® Residential Seat Styling
- TV Antenna w/Signal Booster
- Ultraleather™ Sofa Bed

#### Bedroom

- Bedspread w/Decor Pillows
- Cabinet Storage Above the Bed
- Coffered Ceiling
- Mirrored Wardrobe Doors
- Remote Generator Start
- Restonic® Deluxe Pillow Top Innerspring Mattress
- Ventilated Rear Wardrobe w/Cedar Lining, Carpeted Floor & Wire Organizer
- Wardrobe Lighting
- Bedroom Entertainment Center w/Samsung® 19" LCD HDTV and Home Theater (26" on model 39L & 40X)

#### Bathroom

- Cabinet Toe Kicks
- Coordinated Bath Accessories
- Fan-Tastic® Power Roof Vent w/Wall Switch
- Hardwood Bath Door/Trims
- Laminate Floor Tile
- Lighted Assist Handle
- Molded Shower Enclosure w/Skylight
- Porcelain Toilet w/Water Saver
- Stainless Steel Sink

#### Safety/Convenience

- Carbon Monoxide Detector/Alarm
- Energy Management System (EMS) w/Soft Start
- Fire Extinguisher
- Multiple Seatbelt Locations
- Propane Detector/Alarm
- Smoke Detector/Alarm

#### EXTERIOR

##### Throughout

- 120V/12V AC/DC Converter
- 120V/12V Wire Raceways
- 2000 Watt Pure Sine Wave Inverter w/Remote
- 4 Point Automatic Levelers
- 50 Amp Service
- 8.0 kW Onan® Quiet Diesel Generator
- Awning Rail/Drip Molding (Both Sides)
- Choice of 5 Colorways in 2 Graphic Schemes
- Dual Battery Charge Control
- Dual Pane Windows w/Screens
- Fiberglass Front Quarter Panels

- Fiberglass Front/Rear Caps w/High Mounted Taillights
- Fiberglass Wheel Well Trims
- Full-Body Paint
- Remote/Heated Rear View Mirrors
- Utility Compartment w/Exterior Shower
- Water Pump Switch (Multiple Locations)
- Weather Pro Power Awnings (Patio Awning Includes Wind Sensor)

#### Automotive

- 10,000 lb. Weight Distributing Hitch Receiver w/7 Pin Electrical Hook-Up!
- 360HP Cummins® ISC 8.3L Engine
- Aluminum Wheels
- Dual Fuel Fill (One on Each Side)
- Fog Lamps
- Freightliner® Chassis
- Large One-Piece Bonded-in Windshield
- Mud Flaps
- Rear Vision Camera
- Single Motor Denso Windshield Wipers w/Wet Arm
- Tire Valve Extenders
- Underhood Utility Light

#### Safety/Convenience

- 4 Wheel ABS Air Brakes
- 20' Sewer Hose
- Automotive Safety Glass
- Central Electrical Panel
- Daytime Running Lights
- Doorside Patio Receptacle
- Entry Door w/Screen Door & Deadbolt Lock
- Four 6V/Deep Cycle House Batteries
- Keyless Entry Remote
- Lighted Entry Assist Handle
- Park Cable Receptacle
- Porch Light (Doorside)
- Power Entry Step
- Roof Ladder
- Toilet Tank San-T-Flush™ System
- Touch Sensor Tank Monitoring System

#### Storage

- Continuous One-Piece Compartment Bulb Seal
- EZ Store Compartment on Living Area Slide-Outs
- Gas Lift Strut Supports (Two-Stage Under Slide Box)
- Hidden, Stainless Steel Latch Rods
- Insulated Aluminum Luggage Doors w/Single Paddle Metal Latches & Stainless Steel Hinges
- Lighted Luggage Compartments
- Pass Through Storage
- Side Swinging Luggage Doors (Selected Areas)
- Rotomolded Polyethylene Luggage Compartments
- Spare Tire Compartment (Spare Tire Not Included)

#### Body Structure

- Aluminum Interlocking Floor/Wall/Ceiling Framing
- Color Coordinated Royal Tuff-Ply Roof
- Heated Water & Holding Tank Compartments
- Royal Tuff-Ply Radius Roof w/Ducted A/C
- Power Platform® Construction (Fleetwood Exclusive)
- Vacu-bond® Upper/Lower Floors
- Full-Wall Slide (Patent Pending)

## OPTIONS

### INTERIOR - THROUGHOUT

- Automatic Generator Start System
- Central Vacuum System
- CSA Package (Canadian Specs)\*\*
- Heat Pumps
- Spotlight w/Remote Control
- Washer/Dryer
- Water Heater 16 Gallon Output

### DRIVER CONVENIENCE

- Blind Spot/Security Vision Package

### GALLEY

- 14 cu.ft. Dometic® Stainless Steel Frost-Free Refrigerator
- 12 cu.ft. Norcold® 4 Door w/Wood Inserts
- 14 cu.ft. Dometic® Frost-Free Refrigerator w/Wood Inserts
- 3 Burner Range w/Oven
- Free-Standing Dinette w/Credenza
- Free-Standing Table & Chairs
- Laminate Wood Flooring
- Laminate Floor Gallery to Entry
- Flip Down 10" LCD TV w/DVD Player

### LIVING ROOM

- Recliner w/Table (39L & 39V)
- Samsung® 26" LCD HDTV in Front Overhead (40X Only)
- Ultraleather™ Sofa Sleeper w/Air Mattress
- Leather Euro Recliner Free-Standing (Select Models)
- Desk (39L & 39R)

### BEDROOM

- Adjustable Air Mattress

### BATHROOM

- Laminate Wood Flooring

### EXTERIOR - THROUGHOUT

- Entertainment Center w/Samsung® 19" LCD HDTV and Stereo
- Diamond Shield Clear Front Protective Mask
- Exterior Grill and Kitchenette (Select Models)
- Window Awning Package

## FLEETWOOD ADVANTAGES

- 360HP Cummins® ISC 8.3L Engine
- Vacu-bond® Walls w/Smooth High Gloss Exterior Tuff-Coat® Fiberglass
- Power Platform® Construction (Fleetwood Exclusive)
- Large One-Piece Bonded-in Windshield
- Pass Through Storage
- Side Swinging Luggage Doors (Select Doors)
- Samsung® 26" LCD HDTV in Living Room, Samsung® 19" LCD HDTV in Bedroom
- Deluxe Roller Bearing, Full Extension Drawer Guides
- 84" Interior Ceiling Height

\*\*CSA standards may require substitution or deletion to achieve conformance.



## WEIGHTS AND MEASUREMENTS

### FREIGHTLINER® CHASSIS

MODELS	39L	39R	39S	39V	40E	40X
Engine Displacement (Liters)	8.3	8.3	8.3	8.3	8.3	8.3
Wheelbase (Inches)	252"	252"	252"	252"	276"	276"
GVWR (lbs) <sup>1</sup>	31,000	31,000	31,000	31,000	31,000	31,000
Front GAWR (lbs) <sup>2</sup>	12,000	12,000	12,000	12,000	12,000	12,000
Rear GAWR (lbs) <sup>2</sup>	19,000	19,000	19,000	19,000	19,000	19,000
GCWR (lbs) <sup>3</sup>	41,000	41,000	41,000	41,000	41,000	41,000
Hitch Rating Weight (lbs) <sup>4</sup>	10,000	10,000	10,000	10,000	10,000	10,000
Tongue Weight (lbs) <sup>1</sup>	1,000	1,000	1,000	1,000	1,000	1,000
Fuel Capacity (gal)	90	90	90	90	90	90

### DIMENSIONS & CAPACITIES

MODELS	39L	39R	39S	39V	40E	40X
Overall Length <sup>4</sup>	39' 6"	39' 6"	39' 6"	39' 6"	41' 6"	41' 6"
Overall Height (with A/C)	12' 10"	12' 10"	12' 10"	12' 10"	12' 10"	12' 10"
Overall Width (maximum) <sup>5,6</sup>	102"	102"	102"	102"	102"	102"
Interior Height (maximum)	84"	84"	84"	84"	84"	84"
Interior Width (maximum)	96"	96"	96"	96"	96"	96"
Fresh Water Holding Tank (gal)	86	86	86	86	86	86
Grey Water Holding Tank (gal)	50	50	50	50	50	50
Black Water Holding Tank (gal)	50	50	50	50	50	50
Appliance Propane Tank (gal) (WC) <sup>7</sup>	38	38	38	38	38	38
Water Heater Tank (gal)	10	10	10	10	10	10

Liquid Weight Reference: Water (gal) = (8.3 lbs/3.8 kgs) Fuel (gal) = (7.1 lbs/3.2 kgs) Propane (gal) = (4.2 lbs/1.9 kgs)

Metric Conversion: Multiply pounds x 0.453 to obtain kilograms. Multiply gallons x 3.785 to obtain liters. Multiply liters x 61 to obtain cubic inches.

### CHASSIS

**Model:** Freightliner®  
**Engine:** Cummins® ISC 8.3L  
**Horsepower:** 360HP  
**Torque:** 1050 lbs-ft  
**Alternator:** 170 Amp Leece Neville®  
**Transmission:** Allison® 3000MH 6-Speed w/Electronic Shifter

### Warranty



Exclusive RV ownercare warranty.  
See your Fleetwood dealer for details.

**PROVIDENCE**  
CLASS A DIESEL

- GVWR (Gross Vehicle Weight Rating) is the maximum permissible weight of this fully loaded motor home. The GVWR is equal to or greater than the sum of the (UVW) unloaded vehicle weight plus the (CCC) cargo carrying capacity.\*
- GAWR (Gross Axle Weight Rating) is the maximum permissible loaded weight a specific axle is designed to carry.
- GCWR (Gross Combined Weight Rating) is the value specified by the motor home manufacturer as the maximum allowable loaded weight of this motor home with its towed vehicle. Towing and braking capacities may be different. Refer to Fleetwood and chassis manufacturer's manuals for complete information.
- Length measured from front bumper to rear bumper (excludes accessories).
- Excludes safety equipment and awnings.
- Motor homes feature a body-width over 96" which will restrict your access to certain roads. Before purchasing, you should research any state and/or province road laws which may affect your usage.
- Tank manufacturer's listed water capacity (WC). Actual propane capacity is 80% of water listing as required by the safety code.

† The chassis manufacturer recommends the installation of a supplemental brake control system to activate the brakes on the vehicle or trailer you are towing. Hitch receiver ratings expressed are maximum for the hitch receiver installed and may require the purchase of additional equipment that is dependent on the weight of the towed load. Consult with hitch receiver manufacturer for further information.

N/A = Not available at time of printing.

\*UVW and CCC are found on the cargo carrying capacity label in each RV.

**IMPORTANT— PLEASE READ:** Product information, photography and illustrations included in this publication were as accurate as possible at the time of printing. For further product information and changes, please visit our website at [www.fleetwoodrv.com](http://www.fleetwoodrv.com) or contact your local Fleetwood dealer. Prices, materials, design and specifications are subject to change without notice. All weights, fuel, liquid capacities and dimensions are approximate. Fleetwood has designed its recreational vehicles to provide a variety of uses for its customers. Each vehicle features optimal seating, sleeping, storage and fluid capacities. The user is responsible for selecting the proper combination of loads (i.e. occupants, equipment, fluids, cargo, etc.) to ensure that the vehicle's capacities are not exceeded.

# PROVIDENCE<sup>®</sup>

CLASS A DIESEL

## RV OWNERCARE\*

Limited one-year/15,000-mile coach warranty and three-year/50,000-mile structural warranty, whichever occurs first, and it is fully transferable for the first 12 months. RV OWNERCARE is one of the RV industry's most comprehensive programs and includes systems, appliances, components and construction, with no deductible and no service charge. RV OWNERCARE coverage is provided from a company that will be around in the future to service your needs. See your nearest Fleetwood dealer for a full explanation of benefits and restrictions.

## CONTACT US

To locate a dealer near you, visit our website at [www.fleetwoodrv.com](http://www.fleetwoodrv.com) or call 1-800-444-4905. We can also be contacted at Fleetwood Customer Relations, P.O. Box 1007, Decatur, IN 46733.

## FLEETWOOD TRAVELCADE CLUB

As a Fleetwood owner, you're eligible to become a member of the Fleetwood Travelcade Club. It's a perfect way to meet other Fleetwood owners who love to travel across America and share in the RV lifestyle. Call (877) 577-2560, or visit our website at [www.fleetwoodrv.com/owners\\_clubs](http://www.fleetwoodrv.com/owners_clubs) to learn more, and join the fun.



treadlightly!<sup>®</sup>  
LEAVING A GOOD IMPRESSION



YOUR LOCAL FLEETWOOD DEALER IS:

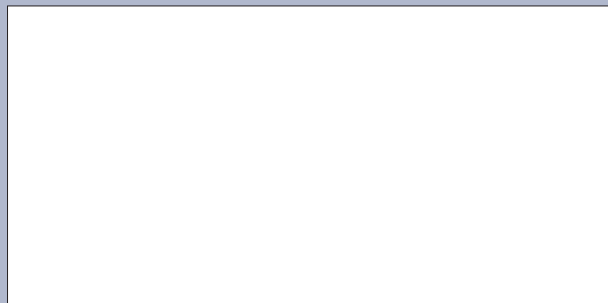

\*For complete info see your Fleetwood dealer.

©2007. Fleetwood Enterprises, Inc.  
Printed in the USA. Inventory Control Number PRO08B2, 11/07.  
Model Year 2008, Second Edition.

## IMPORTANT—PLEASE READ

Product information, photography and illustrations included in this publication were as accurate as possible at the time of printing. For further product information and changes, please visit our website at [www.fleetwoodrv.com](http://www.fleetwoodrv.com) or contact your local Fleetwood dealer. Prices, materials, design and specifications are subject to change without notice. All weights, fuel, liquid capacities and dimensions are approximate. Fleetwood has designed its recreational vehicles to provide a variety of uses for customers. Each vehicle features optimal seating, sleeping, storage and fluid capacities. The user is responsible for selecting the proper combination of loads (i.e. occupants, equipment, fluids, cargo, etc.) to ensure that the vehicle's capacities are not exceeded.

## WHY FLEETWOOD?



### Quality

There's no cutting corners. Skilled craftsmen build every Fleetwood RV for maximum durability and longevity.



### Trust

More people trust Fleetwood. After all, we've spent over 50 years perfecting RVs, earning the loyalty of generations of RVers.



### Passion

We're truly passionate about the RV lifestyle. Fleetwood was founded by RV enthusiasts, and that tradition continues today.



### Safety

You've got precious cargo. So we've engineered dozens of innovative safety features into our motor homes to give you more peace of mind.



### Service

Help is nearby. When you need an upgrade or repair, you'll find facilities all across North America and more than 1,100 dealers ready to assist you.



### Warranty

Exclusive RV ownercare warranty. See your Fleetwood dealer for details.

 **FLEETWOOD**  
*Driven to Explore*