

SABRE

FIFTH WHEELS

FIFTH WHEELS

SABRE

30RLT

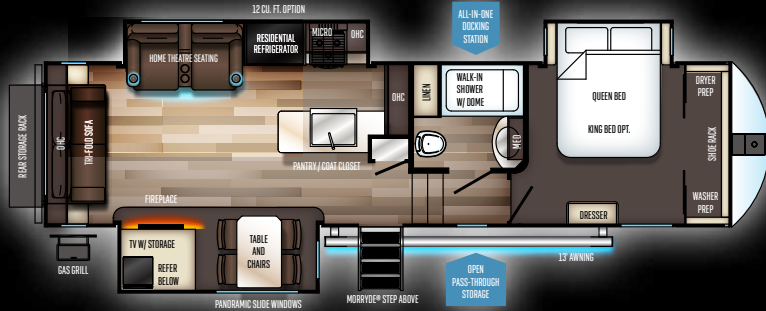

31IKT



32DPT



36BHQ

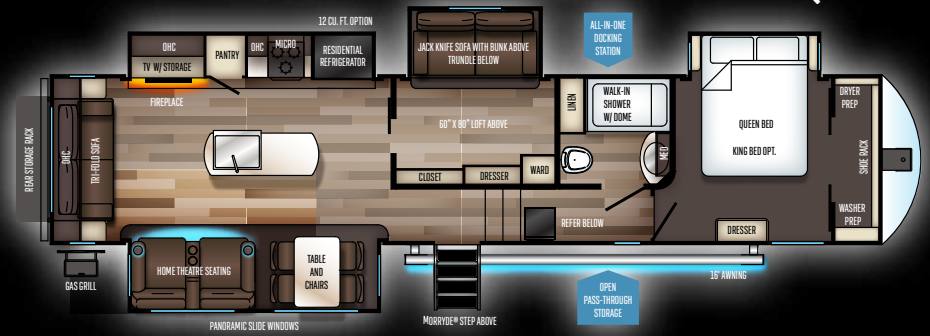

36FRP

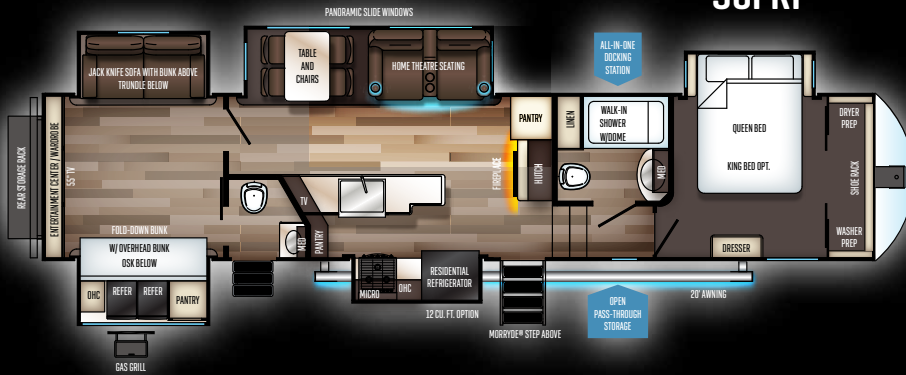

38RDP





31IKT / KITCHEN & DINING



32DPT / BATHROOM



32DPT / KITCHEN DINING



32DPT / BEDROOM

STANDARDS, OPTIONS & PACKAGES

COBALT PACKAGE

[NOT ALL ITEMS AVAILABLE ON ALL MODELS]

- ▶ Cinemax seating with cup holders, heat, massage and backlighting
- ▶ Fireplace with remote
- ▶ Double high output USB Charging Ports (nightstands, bunks, kitchen and end tables)
- ▶ Large residential size LED TV
- ▶ Deluxe soft pull roller shades (main living slide)
- ▶ 42" ceiling fan
- ▶ Residential style farm sink with seamless cover
- ▶ True-Sheen high gloss exterior
- ▶ Generation III electric Auto-Leveling system
- ▶ EZ-Stow rear accessory storage rack and spare tire (200# capacity not including tire)
- ▶ Rear view camera prep
- ▶ Tire Pressure safety sensors
- ▶ 50 amp detachable marine style power cord with 2nd AC prep
- ▶ 20 amp solar prep
- ▶ Ambient up lighting above crown molding in main living area

- ▶ Craftsman style barn door hardware with oversized carriage wheel
- ▶ MOR/Ryde Quad "Step Above" Entry/Exit Landing

BISTRO KITCHEN PACKAGE

[NOT ALL ITEMS AVAILABLE ON ALL MODELS]

- ▶ Colossal Camper residential French door fridge with dual freezer drawers and 1000w inverter
- ▶ Seamless countertops throughout
- ▶ Stainless steel appliance accents
- ▶ Commercial grade range with ambient lighting control, glass cover and lower pots/pans drawer
- ▶ Radiant under cabinet LED lighting
- ▶ High rise deluxe pull down kitchen faucet with spring spout
- ▶ Free standing table with 4 chairs

ALL INCLUSIVE PACKAGE

[NOT ALL ITEMS AVAILABLE ON ALL MODELS]

- ▶ Forced air, heated and enclosed gate valves and underbelly
- ▶ High gloss gelcoat front cap with LED lighting
- ▶ Aluminum rims with EZ Lube hubs

- ▶ Adjustable power awning with LED lighting
- ▶ Battery disconnect with dual battery capacity
- ▶ All weather, heavy duty PVC roof membrane
- ▶ Exterior TV hookup with cable/SAT/110V/LED speakers
- ▶ Friction Hinge Entry Door
- ▶ Large folding entry assist handle
- ▶ Universal Docking Station (includes black tank flush and outside shower)
- ▶ 10 gallon G/E DSI water heater with quick recovery
- ▶ E-Z maintenance rear ladder
- ▶ "Lock-Tite" wood core cabinetry construction
- ▶ Industry leading, campsite-view, panoramic, slide windows
- ▶ Interior/exterior LED lighting throughout
- ▶ AM/FM/CD/DVD multi-media system with Bluetooth
- ▶ Porcelain stool with water jet assist
- ▶ Glass shower enclosure
- ▶ Bath skylight
- ▶ Separated washer and dryer prep locations

AVAILABLE OPTIONS

- ▶ 15K Air Conditioner IPO 13.5 Air Conditioner
- ▶ 2nd 13.5K Air Conditioner Ducted with Thermostat
- ▶ 12 cu. ft. RV fridge IPO Colossal Camper fridge
- ▶ Foil Insulation Upgrade (Roof, Underbelly, Front Wall, Rear Wall, Under Main Slide Carpet)
- ▶ King Bed
- ▶ Off Grid Solar Prep Package IPO STD Solar Prep
- ▶ Solid Surface Kitchen Countertops
- ▶ Tri Fold Hide a Bed IPO Jackknife and Trundle Sofa (36BHQ and 36FRP)
- ▶ Tri-fold Hide a Bed IPO Cinemax Seating
- ▶ Booth Dinette with Pots/Pans Drawers ILO FS Table and Four Chairs
- ▶ Versa-Bed Tilting Mechanism

WEIGHTS & MEASUREMENTS

	30RLT	31IKT	32DPT	36BHQ	36FRP	38RDP
HITCH WEIGHT (LB.)	1,935	1,740	1,955	2,095	1,867	1,950
UVW (LB.)	9,833	9,918	10,020	11,943	12,483	12,213
CCC (LB.)	4,102	2,222	2,297	2,472	1,829	2,057
EXTERIOR LENGTH	34' 1"	36' 0"	36' 7"	42' 0"	41' 6"	42' 5"
EXTERIOR HEIGHT	12' 5"	12' 5"	12' 5"	12' 7"	12' 7"	12' 7"
EXTERIOR WIDTH	96"	96"	96"	96"	96"	96"
FRESH WATER (GAL.)	49	49	49	49	49	49
BLACK WATER (GAL.)	35	38	38	35	70	38
GRAY WATER (GAL.)	35	76	76	70	70	76
AWNING SIZE (FT.)	13'	13'	13'	16'	20'	20'



FREE MEMBERSHIP
to Forest River Owners' Group



PRE-DELIVERY INSPECTION FACILITY

20,000 square feet of quality assurance. The bare essentials for a premium product. This state-of-the-art facility gives immediate daily feedback to production for quality assurance in every unit built.



24/7 EMERGENCY ROADSIDE ASSISTANCE

For a worry-free ownership experience Forest River includes one

year of Coach-Net RV Technical & Roadside Assistance with each RV purchase. Whether new to the RV lifestyle or an experienced RV enthusiast, Forest River owners have 24/7 access to technical, operational and emergency road service coverage throughout the US & Canada. Coach-Net's fast, dependable service is just a phone call away.

Coach-Net[®]
RV Technical & Roadside Assistance

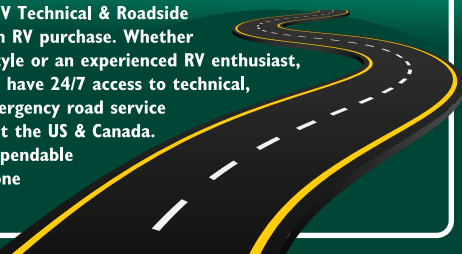

SPECIFICATION DEFINITIONS

GVWR (Gross Vehicle Weight Rating) - is the maximum permissible weight of the unit when fully loaded. It includes all weights, inclusive of all fluids, cargo, optional equipment and accessories. For safety and product performance do NOT exceed the GVWR.

GAWR (Gross Axle Weight Rating) - is the maximum permissible weight, including cargo, fluids, optional equipment and accessories that can be safely supported by a combination of all axles.

UVW (Unloaded Vehicle Weight)* - is the typical weight of the unit as manufactured at the factory. It includes all weight at the unit's axle(s) and tongue

or pin and LP Gas. The UVW does not include cargo, fresh potable water, additional optional equipment or dealer installed accessories.

*Estimated average based on standard build optional equipment.

CCC (Cargo Carrying Capacity)** - is the amount of weight available for fresh potable water, cargo, additional optional equipment and accessories. CCC is equal to GVWR minus UVW. Available CCC should accommodate fresh potable water (8.3 lbs per gallon). Before filling the fresh water tank, empty the black and gray tanks to provide for more cargo capacity.

** Estimated average based on standard build optional equipment

Each Forest River RV is weighed at the manufacturing facility prior to shipping. A label identifying the unloaded vehicle weight of the actual unit and the cargo carrying capacity is applied to every Forest River RV prior to leaving our facilities.

The load capacity of your unit is designated by weight, not by volume, so you cannot necessarily use all available space when loading your unit.

CUSTOMER SATISFACTION



YOUR SABRE DEALER



Learn More
Scan this barcode using a QR Reader on your smart phone to learn more about Forest River.



WWW.FORESTRIVERINC.COM/SABRE

All information contained in this brochure is believed to be accurate at the time of publication. However, during the model year, it may be necessary to make revisions and Forest River, Inc., reserves the right to make all such changes without notice, including prices, colors, materials, equipment and specifications as well as the addition of new models and the discontinuance of models shown in this brochure. Therefore, please consult with your Forest River dealer and confirm the existence of any materials, design or specifications that are material to your purchase decision. Litho. U.S.A. FOR 1542 P&W; 2018.08.02

www.ForestRiverBuyLocal.com