

T W O   T H O U S A N D   T H R E E

# Tropi-Cal

*Announcing the return of  
Tropi-Cal, now as a powerful  
diesel pusher motorhome.*



- **330 HP Caterpillar® Diesel Engine**
- **Freightliner® Raised Rail Chassis**
- **Spacious Tripe-Slide Floorplans**



# WIDE OPEN SPACES...



T370 • SPICE • OAK

**T**ropi-Cal is back with diesel power, thoughtful new interiors and more living space than ever. And with loads of standard features, Tropi-Cal is the best buy going in diesel motorhomes!

Spacious triple-slide floorplans provide plenty of room to stretch out, and tropical-themed fabrics complement hand-crafted oak or walnut cabinetry. Tropi-Cal's abundant entertainment opportunities include two large TVs (27" lounge & 19" bedroom) with front A/V jacks, a hi-fi VCR, multi-speaker sound and optional patio entertainment system.

The Onan® 7.5 kW diesel generator, 50 amp shore power and optional 2,000 watt inverter keep the coach powered up and the good times rolling, whether in a nice campground or far from civilization. Whatever the weather conditions are, Tropi-Cal remains comfortable inside with dual low profile air conditioners, dual fur-



T350 • EMERALD • WALNUT



T370 • SPICE • OAK

naces and a cocoon of block foam insulation vacuum-bonded into the steel-framed coach body.

Tropi-Cal boasts many "residential" features to make you feel right at home, including National RV's exclusive "Sandpiper Deluxe" pillow top mattress and floors covered with patterned plush carpeting and hand-laid ceramic tile. Each floorplan also features two wash basins for extra convenience.



T350 • EMERALD • WALNUT

# ...POWER AND VALUE—TROPICAL DELIVERS!

With a 330 HP Caterpillar® turbo diesel engine, Tropi-Cal outperforms other motorhomes in its class and makes getting there half the fun. The brawny Freightliner® raised rail chassis features a tuned air-ride suspension for stable, responsive handling and a smooth, safe ride.

See your nearest National RV dealer today to experience the wide open spaces, power and value of the new Tropi-Cal.



## FREIGHTLINER® XC-SERIES CHASSIS

|                                  |  |
|----------------------------------|--|
| Gross Vehicle Weight Rating:     | 27,910 lbs.  |
| Chassis Design                   | Raised rail  |
| Steering Gear                    | TRW TAS 55 power steering gear with 51° turning angle and 20.4:1 steering ratio                      |
| Tires                            | Michelin® radial tires 255/80R22.5 14 ply  |
| Wheels                           | Steel wheels with stainless steel wheel simulators and valve extensions; 10 lugs                     |
| Service Brakes                   | Full air brakes with ABS; Wabco 4S/4M; 15x4" Q+cam front drums, 16.5x7" Q+cast spider cam rear drums |
| Alternator                       | Delco Remy® 130 amp alternator   |
| Chassis Batteries                | Two Alliance® 1131MF - min 1900 CCA Batteries  |
| Front Suspension                 | Neway® AS-120—10,500 lb. GAWR  |
| Rear Suspension                  | Neway® ADL—17,500 lb. GAWR   |
| Spring Type                      | Neway® full air suspension system with manual air dump   |
| Shock Absorbers                  | Sachs®   |
| Drive Axle                       | Meritor® RS-17-144   |
| Drive Axle Ratio                 | 4.63:1   |
| Fuel Tank Capacity               | 100 gallon fuel tank   |
| Engine Block Heater              | Phillips® 115V 750 watt engine block heater  |
| Cooling Pack Mounting            | Rear mounted   |
| Air Intake Restriction Indicator | 60" Flex ducting with 12" air intake pre-cleaner and a 6" intake pipe with air restriction indicator |
| Towing Equipment                 | 7,000 lb. Class III hitch receiver with skid bar and six-pin electrical connector                    |
| Chassis Warranty                 | 2 years/50,000 miles   |

## NEW TROPICAL THEMED INTERIOR DÉCORS

### EMERALD



### SPICE



## CATERPILLAR® 3126B ENGINE

|                      |                              |
|----------------------|------------------------------|
| Displacement         | 7.2 liters                   |
| Peak Horsepower      | <b>330 HP</b> @ 2,200 RPM    |
| Peak Torque          | 860 lb/ft torque @ 1,440 RPM |
| Engine/Exhaust Brake | Pac Brake® exhaust brake     |
| Engine Warranty      | 5 years/unlimited miles      |

## ALLISON® MH 3000 TRANSMISSION

|                       |   |
|-----------------------|---|
| Transmission Type     | Six speed automatic with 2 overdrive gears  |
| Gear ratios           | 3.49:1 First gear<br>1.86:1 Second gear<br>1.41:1 Third gear<br>1.00:1 Fourth gear<br>0.75:1 Fifth gear<br>0.65:1 Sixth gear<br>-5.03:1 Reverse |
| Transmission Shifter  | Touch pad electronic shifter with digital display   |
| Transmission Warranty | 3 years/unlimited miles   |

## SPACIOUS TRIPLE-SLIDE FLOORPLANS!

### T350

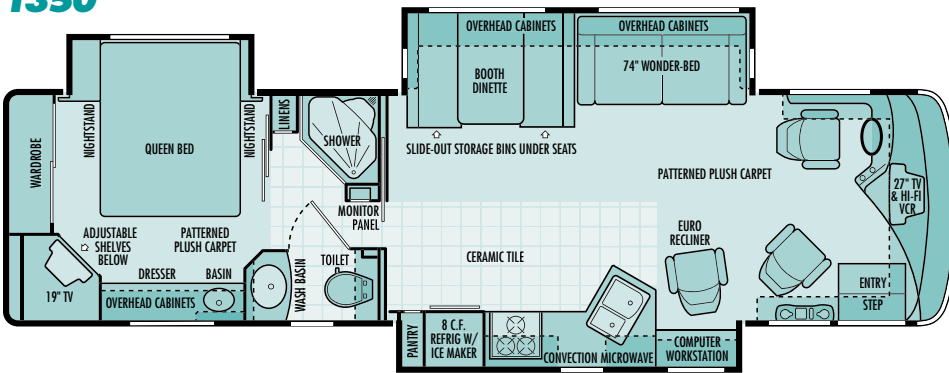

### T370

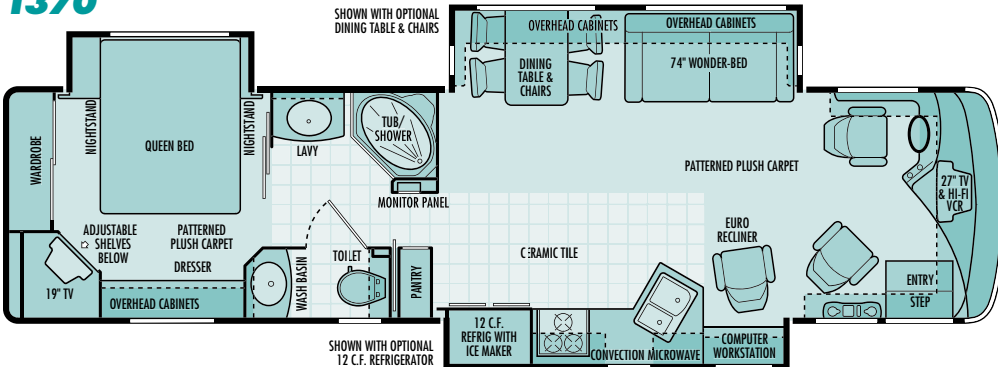

## WEIGHTS

|                                | T350        | T370        |
|--------------------------------|-------------|-------------|
| Gross Vehicle Weight Rating    | 27,910 lbs. | 27,910 lbs. |
| Gross Combined Weight Rating   | 32,910 lbs. | 32,910 lbs. |
| Front Gross Axle Weight Rating | 10,410 lbs. | 10,410 lbs. |
| Rear Gross Axle Weight Rating  | 17,500 lbs. | 17,500 lbs. |
| Unloaded Vehicle Weight        | 23,480 lbs. | TBD         |
| Maximum Carrying Capacity      | 4,430 lbs.  | TBD         |
| Cargo Carrying Capacity (CCC)  | 2,694 lbs.  | TBD         |

## MEASUREMENTS

|                                  | T350    | T370    |
|----------------------------------|---------|---------|
| Wheelbase                        | 208"    | 228"    |
| Overall Length                   | 35' 5"  | 37' 1"  |
| Exterior Height                  | 12' 1"  | 12' 1"  |
| Exterior Height (with Satellite) | 12' 5"  | 12' 5"  |
| Interior Height                  | 79 1/2" | 79 1/2" |
| Interior Width                   | 98"     | 98"     |
| Exterior Width                   | 102"    | 102"    |

## TANK CAPACITIES

|                           | T350    | T370    |
|---------------------------|---------|---------|
| Water Heater              | 10 gal. | 10 gal. |
| Gray Tank                 | 40 gal. | 40 gal. |
| Black Tank                | 60 gal. | 60 gal. |
| Fresh Water Tank(s)       | 95 gal. | 95 gal. |
| LP-Gas Tank (Volume W.C.) | 69 gal. | 69 gal. |

# STANDARD FEATURES

## COACH BODY CONSTRUCTION

Duraframe® patented steel sub-floor construction  
Steel framed laminated floor  
Steel framed crowned laminated fiberglass roof  
Steel framed laminated fiberglass high glass walls  
Custom vinyl exterior graphics with two available color schemes: Emerald Coast and Spice Island  
Molded, high gloss, full fiberglass caps with integrated front and rear bumpers  
Soft touch interior ceiling material  
Insulated fiberglass exterior storage compartment doors with integrated paddle latches and gas struts  
Electric slide-out rooms  
Aluminum rear ladder  
Convenience D-Ring mounts in basement storage compartments  
Automotive undercoating as required  
Steel insulated front bulkhead

## COCKPIT FEATURES

JVC® AM/FM stereo with CD player and four speakers  
Driver and passenger gooseneck reading lights  
Custom dash in dark gray matte grid finish with full gauge package  
Cockpit heater and air conditioner with dash controls  
Convenience tray  
Pantographic windshield wipers  
Power steering  
Electronic cruise control  
18" tilt and telescopic steering wheel  
Rear vision system with microphone  
White power controlled, heated exterior mirrors  
Hydraulic leveling jacks with dash mounted controls  
Passenger workstation with 12V & 110V receptacles  
Aviation style sun visors  
Cup holders  
Two 2-speed dash fans  
Electric stepwell cover  
Wraparound privacy curtain with easy-reach wand  
Pre-wired for your CB radio

## APPLIANCES & ACCESSORIES

RCA® 27" TV with front A/V jacks in cockpit  
RCA® Hi-Fi VCR in cockpit  
Multi-speaker TV sound  
RCA® 19" TV with front A/V jacks in bedroom  
8 cu. ft. double door refrigerator with ice maker  
High output three burner cook top with flush mount Corian® range cover  
GE® SpaceSaver® convection microwave oven with carousel, built-in light and fan  
Systems monitor panel  
Cable TV hook-up and multiple telephone jacks  
Winegard® TV antenna  
Winegard® video control box allows for a third TV

## FURNITURE

Kustom Fit® fabric driver recliner seat with swivel base  
Kustom Fit® fabric pass. recliner seat with swivel base  
Kustom Fit® 74" Wonder-Bed® sleeper sofa with slide-in armrests  
Freestanding Kustom Fit® fabric swivel Euro-recliner

## INTERIORS

### Throughout Coach

Oak paneling and doors  
Solid wood, raised panel cabinet doors in living area, flat panel doors on base cabinets in dressing and bedroom  
Deluxe overhead storage doors with telestrut hardware; positive catches on all other doors  
Drawers with ball bearing roller guide design

### Cockpit Area

Floormats

### Living Area

Patterned plush carpet with deluxe pad  
Pleated day/night shades  
Valances and lambrequins  
48" deep booth dinette with slide-out storage drawers

### Kitchen Area

Corian® kitchen countertop  
Swanstone® under-mount kitchen sink  
Slide-out pantry  
Wastebasket  
Silverware organizer  
Ceramic tile floor  
Venetian blind and valance

### Bath Area

Ceramic tile floor  
Pleated day/night shades  
Flat panel doors  
Insulated skylight in shower  
Towel bars  
Two towel rings  
Medicine cabinet  
Window, valance and blinds in the private toilet room  
Residential style door for private toilet room  
Stylish, decorative wall border

### Bedroom Area

Patterned plush carpet with deluxe pad  
Pleated day/night shades  
Valances and lambrequins  
Flat panel doors  
"Sandpiper Deluxe" pillow top mattress (60" x 80")  
Queen bed slide-out  
Stylish coordinate bedspread, pillows and shams  
Radius padded headboard  
Laminate top nightstands with woodgrain edge  
Cedar lining in wardrobe  
Wall dresser with drawers and laundry hamper  
Residential style closet rods  
Hardwood louvered washer/dryer doors below the TV  
Second lavy sink (T350)

## ELECTRICAL SYSTEM

120V distribution panel  
50 Amp shore power cord  
40 watt solar panel  
Onan® 7.5 kW diesel generator  
Two 6V deep cycle house batteries  
Slide-out battery tray  
Two 1900 CCA 12V maintenance-free chassis batteries  
Easily accessible battery disconnect switch

Porch light and patio receptacle in sidewall  
Three water pump switches (kitchen, bath and service station)  
Decorative overhead dining light  
Decorative overhead light in bedroom  
Cosmetic light in bathroom  
Stylish, designer decorative lights in living area  
Courtesy light at entry-door switch panel  
Fluorescent ceiling lights

## PLUMBING & LPG SYSTEMS

### Coach Exterior

Heated and insulated holding and water tanks  
Manual dump valves  
Pressurized water fill with regulator  
Demand water pump  
Water heater by-pass valve  
Winterization antifreeze inlet to pump  
Holding tank rinsing system (waste tank only)  
Outside shower

### Kitchen Area

Water filter/faucet in kitchen  
10 gallon gas/electric water heater  
Price Pfister® single lever faucet with detachable goose-neck sprayer

### Bedroom/Bathroom Area

Low-profile porcelain toilet with sprayer  
Designer, "Leaf Patterned" glass shower enclosure  
One piece fiberglass shower with seat (T350)  
One piece fiberglass tub and shower, lowered for easy entry and exit (T370)  
Single lever brass faucets with crystal handle for lavys  
Pre-plumbed for washer/dryer

## SAFETY FEATURES

Fire extinguisher  
Deadbolt lock on entrance door  
120V GFI protected circuits (kitchen, bath & exterior)  
Smoke, carbon monoxide (CO) and LPG detectors  
Driver and passenger three point lap and shoulder seatbelts  
Egress window  
Deluxe acrylic exterior assist handle

## WINDOWS DOORS AWNINGS

Insulated and tinted dual pane windows  
Power double anti-skid entrance step with light  
Tinted skylight in bathroom  
Slide-out topper awnings on living room, galley and bedroom slide  
Electric patio awning in the stylish Sand Shadow scheme with matching white hardware for a bright, vibrant appearance

## VENTILATION

Dual 13,500 BTU Duo-Therm® low profile Penguin® air conditioners with in-ceiling ducting  
Dual 20,000 BTU furnaces  
12V fan in bathroom  
12V Fan-Tastic® Vent with wall thermostat and rain sensor in living area

# OPTIONS

## EXTERIOR OPTIONS

Dual roof mounted chrome trumpet air horns  
Manual front entry door awning  
Manual living room and bedroom window awning package

## ELECTRICAL SYSTEM OPTION

2,000 watt inverter, two additional 6V batteries

## INTERIOR OPTIONS

### Throughout Coach

Walnut paneling and doors  
Maple paneling and doors

### Furniture

Kustom Fit® Ultra-Leather™ 6-way power driver recliner seat with swivel base and Kustom Fit® Ultra-Leather™ passenger recliner seat with swivel base  
Kustom Fit® 74" Ultra-Leather™ Wonder-Bed® sleeper sofa with slide-in armrests  
Freestanding Kustom Fit® Ultra-Leather™ swivel Euro-recliner chair

### Entertainment Systems

Home theater package: Includes an RCA® DVD digital receiver; a subwoofer/speaker system; 20" TV with a swivel base located in an exterior compartment on a full-extension slide tray with a fixed stereo unit with two speakers mounted by the exterior TV  
Kingdome® automatic stationary satellite dish with RCA® satellite receiver  
Kingdome® automatic stationary satellite dish without satellite receiver  
RCA® satellite receiver  
JVC® multi-disc CD changer

### Living Area

Freestanding dinette table with two low-back wooden chairs and two wooden folding chairs

### Kitchen Area

Corian® countertop extension  
21" high output three burner range and oven  
12 cu. ft. side-by-side refrigerator with ice maker (replaces the slide-out pantry)

### Bedroom/Bathroom Area

Combination washer/dryer

*Nearly 40 Years of Innovation!*



Wayne Mertes, founder of National RV, and his father, Leonard, building Dolphin campers in 1964.

## NATIONAL R.V., INC.

3411 N. Perris Boulevard  
Perris, California 92571  
(909) 943-6007 - Fax (909) 943-8498

[www.nationalrv.com](http://www.nationalrv.com)

© 2003 National R.V., Inc. Due to continuing product improvements, colors, specifications and equipment are subject to change without notice. 1/6/03

**YOUR AUTHORIZED TROPICAL DEALER IS:**