

# QUANTUM™



HOT STREAK **WHD**



LET IT RIDE **WHD**



JOKERS WILD II PARTIAL PAINT



DOUBLE DOWN II PARTIAL PAINT



BLACK ONYX FULL-BODY PAINT  
(KW29, LF31, PD31, & WS31)



TOPAZ BLUE FULL-BODY PAINT  
(KW29, LF31, PD31, & WS31)

SPRINTERS



HOT STREAK **WHD**



LET IT RIDE **WHD**



BLACK ONYX FULL-BODY PAINT



TOPAZ BLUE FULL-BODY PAINT



ARCTIC FROST II

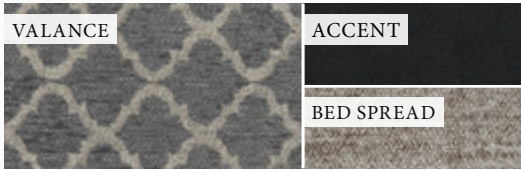

CLOUD NINE II



MID TOWN TAUPE II

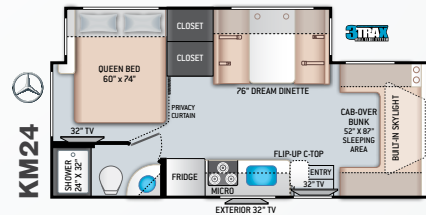
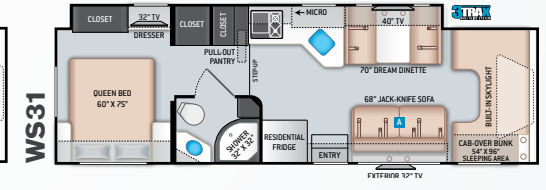
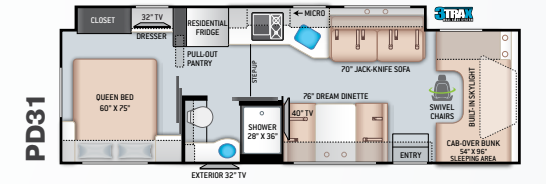
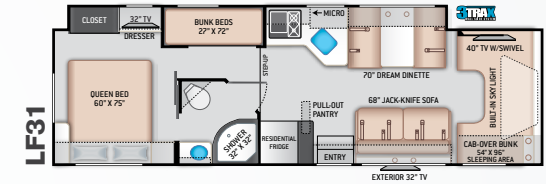
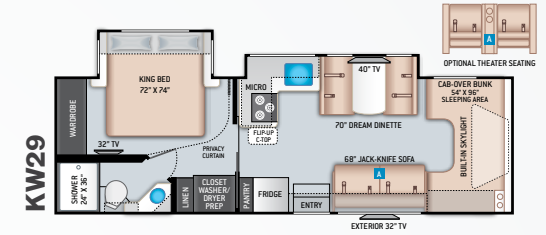
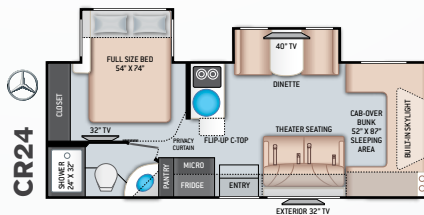
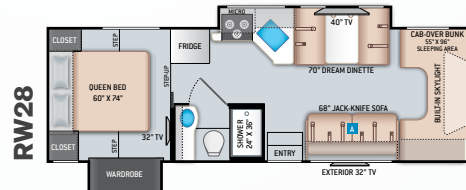
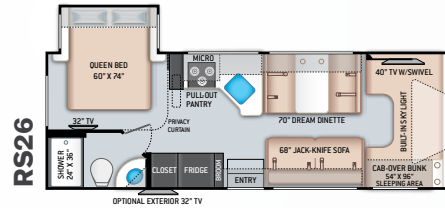
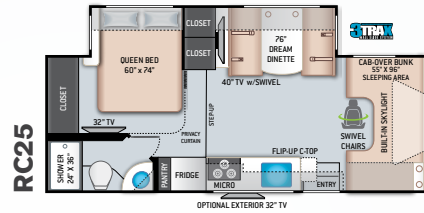
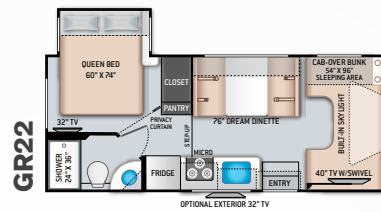
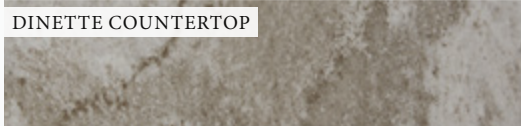
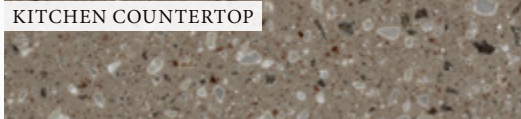
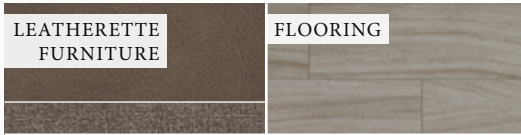

# Class C Featured Highlights

## CONSTRUCTION & EXTERIOR

- Automatic Leveling Jacks (LF31, PD31 & WS31)
- HD-MAX® Exterior with Graphics Package (GR22, RC25, RS26, RW28 & KW29)
- MEGA-Storage™ Compartment (GR22, RC25, RS26 & RW28)
- Portable Table (RW28)
- Framed Slider Windows (GR22, RC25, RS26, RW28 & KW29)
- Frameless Slider Windows (PD31, LF31 & WS31)

## CONSTRUCTION & EXTERIOR OPTIONS

- Electric Stabilizing System (OPT GR22, RS26 & RW28 / STD RC25 & KW29)
- Partial Paint on HD-MAX® Exterior with Graphics Package (STD LF31, PD31 & WS31)
- Full Body Paint Package with Gel-Coat Sidewalls & Invisible Front Mask Paint Protection (KW29, LF31, PD31 & WS31)

## AUTOMOTIVE & COCKPIT

- Touchscreen Dash Radio with Navigation & Back-Up Monitor
- SiriusXM® Radio Tuner & Antenna
- Leatherette Captain's Chairs (GR22, RS26, RW28, KW29, LF31 & WS31)
- Leatherette Swivel Captain's Chairs with Filler Cushions (RC25 & PD31)
- Deluxe Exterior Mirrors (GR22, RC25 & RS26)
- Emergency Engine Start Switch
- Aluminum Running Boards
- Stainless Steel Wheel Liners
- Valve Stem Extenders

## AUTOMOTIVE & COCKPIT OPTIONS

- Heated/Remote Exterior Mirrors with Integrated Side View Camera (STD RW28, KW29, LF31, PD31 & WS31)
- Power Driver's Seat - Ford® Chassis Only (RW28, KW29, LF31 & WS31)
- Cockpit Carpet Mat

## INTERIOR

- Leatherette Jack-Knife Sofa (RS26, RW28, KW29, LF31, PD31 & WS31)
- Leatherette Dream Dinette® Booth
- 40" TV in Living Area
- 32" TV in Bedroom
- Two (2) 15" TVs w/DVD Player in Bunk Bed Area (LF31)
- HDMI Video Distribution Box
- Winegard® Connect™ 2.0 4G LTE Router & WiFi Extender
- Wall Cubby with Net & USB Charging Port
- Double Door Gas/Electric RV Refrigerator with Smoked Acrylic Panel Inserts (GR22, RC25, RS26, RW28 & KW29)
- Residential Refrigerator with Ice Maker (LF31, PD31 & WS31)
- Recessed 3-Burner Gas Cooktop with Glass Cover (GR22, RC25, RS26, RW28 & KW29)
- 2-Burner Gas with Single Induction Cooktop (LF31, PD31 & WS31)
- Microwave Oven (GR22, RC25, RS26, RW28 & KW29)
- 30" Over-the-Range Convection Microwave Oven (LF31, PD31 & WS31)
- Flip-Up Countertop Extension (RC25 & KW29)
- Pop-Up Countertop Outlet & Charging Center (LF31, PD31 & WS31)
- Solid Surface Kitchen Countertops
- Denver Mattress® Queen Size Bed (N/A KW29)
- Denver Mattress® King Size Bed (KW29)
- Bedroom 12-volt Outlet for CPAP Machine
- 12-volt Attic Fan with Cover in Bedroom

## INTERIOR OPTIONS

- Leatherette Theater Seat IPO Jack-Knife Sofa (RW28, KW29, & WS31)
- Cab-Over Child Safety Net
- 12-volt Attic Fan with Cover in Cab-Over Bunk
- Single Child Safety Tether in Dinette
- Recessed 3-Burner Gas Cooktop/Oven with Glass Cover (GR22, RC25, RS26, RW28 & KW29)

- Convection Microwave Oven (GR22, RC25, RS26, RW28 & KW29)
- 32" Exterior TV on Manual Swivel with Bluetooth® Sound Bar (STD - RW28, KW29, LF31, PD31 & WS31)

## ELECTRICAL & PLUMBING

- Onan® RV QG 4000 Gas Generator
- Automatic Generator Start (LF31, PD31 & WS31)
- 30-amp Shoreline Power Cord
- 1800-watt Inverter (LF31, PD31 & WS31)
- Second Auxiliary House Battery
- Battery Tray for Four (4) Batteries (LF31, PD31 & WS31)
- Solar Prep - Includes Solar Controller
- Tankless Water Heater
- 13,500 BTU Roof Front Air Conditioner (GR22, RC25 & RS26)
- 15,000 BTU Roof Front Air Conditioner (RW28, KW29, LF31, PD31 & WS31)
- Exterior LP Connection
- Whole Coach Water Filtration System (LF31, PD31 & WS31)
- Outside Shower
- 360° Siphon® RV Holding Tank Vent Cap
- Black Tank Flush System
- Enclosed Sewer Area for Sewer Tank Valves (LF31, PD31 & WS31)
- Holding Tanks with Heat Pads
- Stackable Washer/Dryer Prep (KW29)
- Rapid Camp® Wireless Control System (LF31, PD31 & WS31)

## ELECTRICAL & PLUMBING OPTIONS

- 15,000 (IPO 13,500) BTU Roof Front Air Conditioner (GR22, RC25 & RS26)
- Dual 11,000 BTU Roof Air Conditioners IPO 15,000 BTU Roof Air Conditioner (KW29, LF31, PD31 & WS31)

For a complete listing of available features visit [thormotorcoach.com/quantum](http://thormotorcoach.com/quantum).



# Sprinter Featured Highlights

## CONSTRUCTION & EXTERIOR

- Electric Stabilizing System
- Fiberglass Front Cap with Skylight & Power Shade
- HD-MAX® Exterior with Graphics Package
- Lighted Rotocast Storage Compartments
- Flush Mount Radius Compartment Doors
- Power Patio Awning with Integrated LED Lighting

## CONSTRUCTIVE & EXTERIOR OPTIONS

- Full-Body Paint Package with Invisible Front Mask Paint Protection

## AUTOMOTIVE & COCKPIT

- Touchscreen Dash Radio with Navigation, Back-Up Monitor & Integrated Camera
- SiriusXM® Radio Tuner & Antenna
- Heated/Remote Exterior Mirrors
- Leatherette Swivel Captain's Chairs with Two (2) Filler Cushions
- Cockpit Carpet Mat
- Stainless Steel Wheel Liners
- Keyless Entry System
- Valve Stem Extenders

## INTERIOR

- 40" TV in Living Area (CR 24)
- 32" TV on Manual Swivel in Living Area (KM24)
- 32" TV in Bedroom
- 32" Exterior TV on Manual Swivel with Bluetooth® Sound Bar
- HDMI Video Distribution Box
- Winegard® Connect™ 2.0 4G LTE Router & WiFi Extender
- Cab-Over Bunk Ladder
- Wall Cubby with Net & USB Charging Port
- Leatherette Theater Seating with Footrests (CR24)
- Leatherette Dream Dinette® Booth (KM24)
- Leatherette Dream Dinette® Booth with Two (2) Storage Drawers (CR24)
- Double Door Gas/Electric RV Refrigerator with Smoked Acrylic Panel Inserts
- 3-Burner Gas Cooktop with Glass Cover (KM24)

- 2-Burner Gas Cooktop with Glass Cover & Electric Start (CR24)
- Convection Microwave Oven
- Solid Surface Kitchen Countertop
- 12-volt Fan in Kitchen
- Denver Mattress® Queen Size Bed (KM24)
- Denver Mattress® Full Size Bed (CR24)
- Bedroom 12-volt Outlet for CPAP Machine
- 12-volt Attic Fan with Cover in Bathroom & Bedroom

## INTERIOR OPTIONS

- Cab-Over Child Safety Net
- 12-volt Attic Fan with Cover in Cab-Over Bunk
- Single Child Safety Tether in Dinette (KM24)

## ELECTRICAL & PLUMBING

- Onan® RV QG 3600 LP Generator
- 30-amp Shoreline Power Cord
- Automatic Shoreline-to-Generator Transfer Switch
- Battery Disconnect Switch
- Second Auxiliary House Battery
- 13,500 BTU Roof Front Air Conditioner
- Systems Control Center
- Exterior LP Connection
- Solar Prep - Includes Solar Controller
- Tankless Water Heater
- 1" Fresh Water Tank Drain
- 360° Siphon® RV Holding Tank Vent Cap
- Holding Tanks with Heat Pads
- Black Tank Flush System
- Outside Shower

## ELECTRICAL & PLUMBING OPTIONS

- Onan® RV QD 3200 Diesel Generator
- 15,000 (IPO 13,500) BTU Roof Front Air Conditioner

For a complete listing of available features, visit [thormotorcoach.com/quantum-sprinter](http://thormotorcoach.com/quantum-sprinter).

	CLASS C							SPRINTER		
	GR22	RC25	RS26	RW28	KW29	LF31	PD31	WS31	CR24	KM24
Chassis	Ford / Chevy	Ford	Ford / Chevy	Ford	Ford	Ford	Ford	Ford	Mercedes-Benz	Mercedes-Benz
Gross Vehicle (GVWR)	12,500 / 12,300	14,500	12,500 / 14,200	14,500	14,500	14,500	14,500	14,500	11,030	11,030
Gross Combined (GCWR)	18,500 / 16,000	22,000	18,500 / 20,000	22,000	22,000	22,000	22,000	22,000	15,250	15,250
Wheel Base	158" / 159"	178"	183" / 184"	212"	212"	223"	212"	223"	170.3"	170.3"
Exterior Length (w/o ladder)	24' / 24'-6"	26'-3"	27'-6" / 28'	30'-2"	30'-11"	32'-7"	31'-3"	32'-2"	25'-8"	24'-8"
Exterior Height (w/AC)	11"	11'-2"	11'-2"	11'-2"	11'-2"	11'-2"	11'-2"	11'-2"	12'-1"	12'-1"
Exterior Width (w/o mirrors)	99"	99"	99"	99"	99"	99"	99"	99"	90"	90"
Interior Height (living area)	84"	84"	84"	84"	84"	84"	84"	84"	84"	84"
Awning Size	15'	16'	18'	14'	18'	16'	16'	16'	16'	15'
Fuel (gal)	55 / 57	55	55 / 57	55	55	55	55	55	26.4	26.4
LPG (lbs)	40.9	40.9	40.9	40.9	40.9	40.9	40.9	40.9	68.2	68.2
Fresh/Waste/Gray Water (gal)	40 / 29 / 25	40 / 34.5 / 37	40 / 29 / 25	40 / 26 / 32	40 / 34.5 / 37	40 / 28 / 28	40 / 28 / 28	40 / 28 / 28	30 / 34.5 / 37	30 / 24.5 / 38
Water Heater (gal)	Tankless	Tankless	Tankless	Tankless	Tankless	Tankless	Tankless	Tankless	Tankless	Tankless
Furnace (BTUs)	19,000	30,000	30,000	30,000	30,000	30,000	30,000	30,000	30,000	30,000
Exterior Storage Capacity (cu. ft.)	30.9	45.1	40.0	99.9	50.4	55.7	52.9	55.7	47	48.5
Hitch Weight Rating (lbs)	8,000	8,000	8,000	8,000	8,000	8,000	8,000	8,000	5,000	5,000



IMPORTANT—PLEASE READ: This brochure reflects product design, fabrication, material, components and specifications at the date of printing, which date is disclosed below. Please visit us online at [ThorMotorCoach.com](http://ThorMotorCoach.com) or consult with your selling dealership for the latest in standards, options, specification and technical information. Photographs in the brochure may depict optional equipment or may only be available in certain floor plans. Components, appliances and the chassis may have been manufactured in a calendar year before the vehicle's designated model year. All capacities are approximate. The actual length of the vehicle may differ from that indicated in the brochure due to variances in the manufacturing processes and/or installed components. All dry weights are based on standard model features and do not include optional features or equipment. Component part and appliance manufacturers issue limited warranties covering portions of the vehicle not covered under the limited warranty we issue. Copyright Thor Motor Coach, Inc. © MY 05/10/2019

Made to fit.

P.O. Box 1486, Elkhart, IN 46515 Sales Department: 800.860.5658

[thormotorcoach.com](http://thormotorcoach.com)

