



Jayco

AMERICA'S MOST LIVEABLE RVs.

2010 MELBOURNE

Easy Driver



The



DURABLE

Melbourne features TuffShell™ vacuum-bonded laminated sidewalls, TuffShell™ fiberglass roof with radius corners and a steel-truss floor system for long-lasting toughness.

MELBOURNE®
2010 Motorhomes by Jayco®

LIVEABILITY MEETS TRANQUILITY

perfect fit.

In today's "anything goes" society, it's nice to know there are still some things you can depend on. Like the 2010 Jayco Melbourne, for instance. Designed for people who love to travel, Melbourne's smaller, more manageable size and responsive handling make it perfect for any situation, from city streets to steep mountain passes. Every detail of the Melbourne—from the materials we use to our construction techniques—was selected for how they ultimately fit together. And how they fit your life. Perfectly.



POWERFUL

With a five-speed automatic transmission with overdrive, a Triton® V-10 305 HP engine, and a 5,000-pound towing hitch, Melbourne gives you the confidence to tackle the road ahead.

MANEUVERABLE

Built on a Ford® E-450 chassis, and featuring power anti-lock brakes, power steering and cruise control, Melbourne makes it easy to go just about anywhere.

A TRADITION OF LIVEABILITY

Starting with our first lifter system for fold-down campers in 1968, which made for an easier, more enjoyable camping experience, Jayco has always been about liveability. Today, we're the world's largest family-owned RV manufacturer, yet our priorities remain the same: making RVs more liveable and family time more memorable.



MELBOURNE 29D | DESERT WITH PROVINCIAL GLAZED MAPLE CABINETRY



BETTER BUILT FOR BETTER LIVEABILITY.

Everything about Melbourne is meant to enhance the RV lifestyle, from its flexible floorplans, with sleeping for up to four adults, to its time-proven construction techniques. High-end features, such as Northridge Maple cabinetry, hidden cabinet hinges, a 26" digital LCD HDTV, and recessed halogen lighting, come standard on Melbourne, making it the perfect combination of form and function.

SERENE

With a deluxe pillowtop Cloud Ten™ mattress, quilted bedspread and padded headboard, Melbourne's bedroom is the picture of serenity.

SMART

The kitchen's designed to make mealtime a breeze, with modern appliances, ample storage and a cook-friendly layout.

PRIVATE

Relax in Melbourne's private bathroom with a shower, skylight, mirrored wooden medicine cabinet and an optional glass shower door.



MELBOURNE 29D | DESERT



MELBOURNE 29D | DESERT



MELBOURNE 29D | DESERT

Jayco construction

At Jayco, we've built a reputation for superior construction and craftsmanship. We always use top-quality materials and production techniques, giving our products **reliable resale value** and our owners peace of mind.

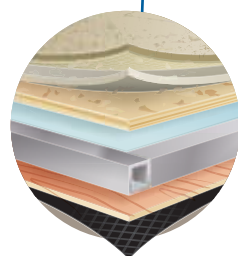

FLOOR

Vacuum bonding joins our welded aluminum frame with a heavy-duty Structurwood® floorboard to create one of the strongest foundations in the industry.

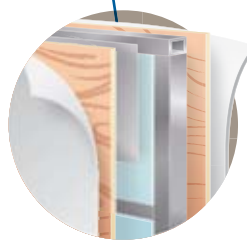

WALLS

TuffShell™ vacuum-bonded lamination combined with welded aluminum frames and metal backers create a durable structure designed to withstand use and travel.

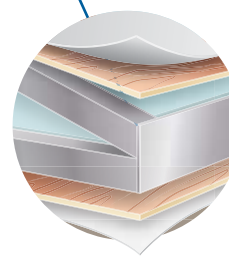

ROOF

The laminated, vacuum-bonded roof is comprised of ¼" plywood decking on 5" arched aluminum trusses with bead-foam insulation (R-23) and a seamless one-piece fiberglass shield that protects against moisture and resists aging.

Jayco craftsmanship

Jayco's dedicated production team includes Amish craftsmen who build with well-honed woodworking techniques passed down for generations.



Jayco liveability

At Jayco, it's always been about liveability.

COMMAND CENTER

Control all your generator and slideout functions from one convenient interior location.

DRAWER GUIDES

New ball bearing drawer guides provide smooth operation and full-drawer extension.

SLIDEOUT AWNINGS

Multiple slideout awnings offer added protection from weather and aging.

DUAL-USE SOFA

Your guests will love the Optima leather comfort lounger that doubles as a luxurious sofa with a 54-inch sleeping area.

Standards and options

STANDARD BATHROOM EQUIPMENT

6-panel residential-style passage doors
ABS shower with one-piece surround
Porcelain stool with foot flush
Removable clothing rod in shower (select models)
Residential linoleum floor
Residential medicine cabinet with mirror
Robe/towel hooks
Skylight in shower with light (select models)
Stainless-steel sink bowl
Toilet paper holder
Towel holder
Towel ring

STANDARD BEDROOM EQUIPMENT

22" digital LCD HDTV
Accordion door to rear bedroom
Halogen reading lights
Padded headboard
Queen bed with Cloud Ten™ pillowtop mattress
Quilted bedspread
Rear window (select models)
Under-bed storage

STANDARD KITCHEN EQUIPMENT

6 cu. ft. refrigerator
Drawer for silverware, divided for utensils
Dream Dinette™ mechanism, raises and lowers dinette table top
Fluorescent light over kitchen sink
High-rise single-lever faucet with pull-out sprayer
Mini blind
One-piece J-Stone® solid-surface high-gloss countertop with integrated deep bowls
Range hood
Residential linoleum floor in kitchen
Sink/cutting board covers (2)
Splash guard, made of Plexiglas® (select models)
Under-counter Apollo® convection microwave with 3-burner top
Water purification system

STANDARD CAB EQUIPMENT

3-point lap and shoulder safety belts (driver and passenger)
Auxiliary start switch
Headliner with padded fabric
Optima leather driver seat with 6-way power
Optima leather passenger seat
Privacy drape for lower cab
Remote keyless entry

STANDARD CHASSIS EQUIPMENT

5-speed automatic Torqueshift® series transmission with overdrive
55-gallon fuel tank
78" ceiling height
130-amp alternator
5,000-lb. hitch with 7-way plug
A/C and cruise control
Dome lights
Ford® E-450 chassis
Hellwig® helper springs
Power anti-lock brakes with power steering
Power window and door locks
Rubber body mounts
Tilt steering wheel
Triton® 6.8L EFI V-10 305 HP engine

STANDARD CONSTRUCTION FEATURES

Bead-foam insulation (R-23 max roof, R-9 max floor, R-6 max walls)
Cabinetry crafted with screwed-stile construction
Curved sidewall construction
Electric-powered slideouts
High-gloss, gel-coat sidewalls
One-piece fiberglass roof
TuffShell™ vacuum-bonded 5" crowned laminated roof
TuffShell™ vacuum-bonded laminated floor and sidewalls
Unitized, 1-1/2" laminated construction of floor
Welded aluminum sidewall framework

STANDARD EXTERIOR EQUIPMENT

110V G.F.C.I. protected exterior receptacle
Automotive taillights
Dual sliding battery tray
Electric-powered, double entrance step
Entry door gas strut
Exterior speakers, high-output marine-grade (2)
Fiberglass running boards
Front and rear gel-coat fiberglass caps
Heated holding tanks, 12V pads
Heavy-duty grab handle for entry assistance
House battery
Lockable exterior storage compartments with door pulls
Painted skirting
Patio awning
Patio light with inside switch
Radius-cornered entrance door with screen
Roof ladder
Sewer hose compartment with door
Slideout topper awnings
Spare tire and carrier located under unit
Wheel liners

STANDARD INTERIOR EQUIPMENT

Ball bearing drawer guides 100-lb. capacity with full-drawer extension
Brushed nickel fixtures
Cable TV hookup with RG-6 coax
Crank-up digital antenna for TV with signal booster
Decorative pillows for sofa
Deluxe hidden cabinet hinges
Entertainment center in front, includes 26" digital LCD HDTV
Fabric-covered box valances with lambrequin legs
High-intensity halogen recessed 12V lighting package
Leather touch comfort lounger with cup holders in arms
Northridge Maple cabinetry
Padded vinyl ceiling
Padded wings behind cab
Prep for satellite dish for roof and sidewall
Raised-panel cabinet doors throughout
Trackless carpeting with padding throughout unit
Under-cabinet halogen lighting

STANDARD HEAT, POWER AND WATER

6-gal. gas/electric DSI auto-ignition water heater
12V demand water pump
12V electrical system with 110V, 45-amp power converter
30-amp power cord
56-lb. chassis-mounted propane tank
Auto-ignition furnace with wall thermostat
Black holding tank sprayer
Conveniently placed water pump switches
Hookup for city water
Interior Command Center®
Onan® 4,000-watt MicroQuiet™ generator with auto-changeover
Outside shower
Water heater bypass system

STANDARD SAFETY EQUIPMENT

Battery disconnect
Deadbolt lock on entrance door
Driver and passenger air bags
Egress window
Fire extinguisher
Lap safety belts in living area
Propane/carbon monoxide alarm
Smoke alarm
Third brake light
Tinted safety-glass windows

OPTIONS

22" LCD HDTV on door side exterior
400-watt inverter
15,000-BTU A/C with heat pump
Attic fan in bedroom
Canadian standards
Customer Value Package
Diamond Shield™ paint protection film
Dinette in lieu of leather comfort lounger (select models)
Driver/passenger side-view cameras
Electric leather comfort lounger
Leather comfort lounger in lieu of dinette (select models)
Navigation system
Premium paint package
Provincial Glazed Maple cabinetry
Satellite kit
Winegard® dome satellite dish

CUSTOMER VALUE PACKAGE

Attic fan
Bathroom power vent
Deluxe, remote-control, heated, side-view mirrors
Glass shower door
Pleated day/night shades throughout
Portable, outside gas grill
Touch-Screen Pemium In-Dash Sound System™ AM/FM/CD/DVD with back-up camera monitor
Woodgrain dash kit

Specifications

FLOORPLAN	EXTERIOR LENGTH	EXTERIOR		GROSS VEHICLE WEIGHT RATING (LBS.)	GROSS COMBINED WEIGHT RATING (LBS.)	ENGINE/SIZE	WHEEL BASE	FURNACE AUTO-IGNITION (BTUS)	FRESH WATER CAPACITY		GRAY WASTE WATER CAPACITY (GALS.)	BLACK WASTE WATER CAPACITY (GALS.)
		HEIGHT	W/AC						INTERIOR HEIGHT	(GALS.) (INCLUDES WATER HEATER)		
24E	25' 11"	125"	78"	14,500	19,500	Triton EFI V10	176"	25M	37	32	32	
26A	28' 8"	125"	78"	14,500	19,500	Triton EFI V10	181"	31M	37	34	32	
29C	31' 8"	125"	78"	14,500	19,500	Triton EFI V10	212"	31M	37	34	32	
29D	31' 8"	125"	78"	14,500	19,500	Triton EFI V10	212"	31M	37	34	32	

Floorplans

◀ = outside storage MICRO. = microwave REFRIG. = refrigerator
 LAV. = bathroom sink OHC. = overhead cabinets WARD. = wardrobe

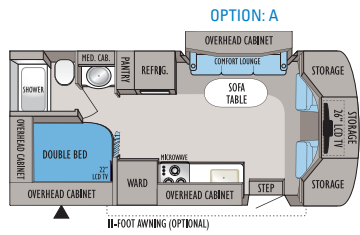

MELBOURNE | 24E
 Ext. Length: 25' 11" Ext. Height: 125"

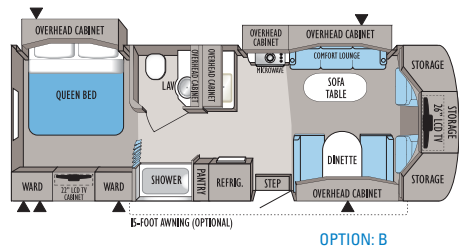

MELBOURNE | 29C
 Ext. Length: 31' 8" Ext. Height: 125"

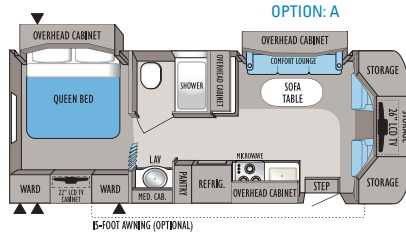

MELBOURNE | 26A
 Ext. Length: 28' 8" Ext. Height: 125"

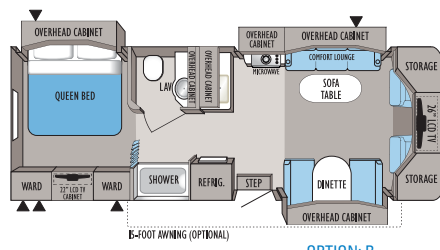

MELBOURNE | 29D
 Ext. Length: 31' 8" Ext. Height: 125"

Floorplan options (available on select models only)

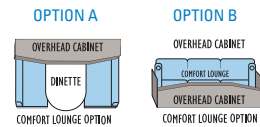

Exterior color options



VINYL GRAPHICS WITH SKIRT PAINT (STANDARD)



PREMIUM PAINT (OPTIONAL)

Gross Vehicle Weight Rating (GVWR): GVWR means the maximum permissible weight of the motorhome, including the Unloaded Vehicle Weight (UVW) plus passengers, personal items, all cargo, fluids, options and dealer-installed accessories. The GVWR is equal to or greater than the sum of the UVW and the Cargo Carrying Capacity.

Gross Combined Weight Rating (GCWR): The maximum allowable combined weight of the motorhome used as a tow vehicle and the attached towed vehicle.

It is important for your safety and enjoyment that you are aware of the weights and tow ratings of the RV you select. Consult a competent advisor for questions or advice. Whether you are new to RVing or a veteran, get a feel for the performance of your RV before heading out on the roadways. When you tow a vehicle with your RV, you must drive differently than when you drive a single vehicle. Practice hooking up, driving, backing up and braking in a safe environment or seek out professional instruction. Jayco affixes a weight label to each RV which lists weight information for that vehicle. Refer to that label to verify the vehicle will meet your requirements.

Interior color options

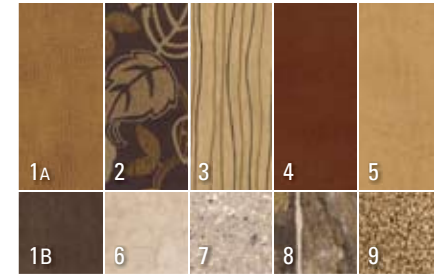

NUTMEG



LATTE

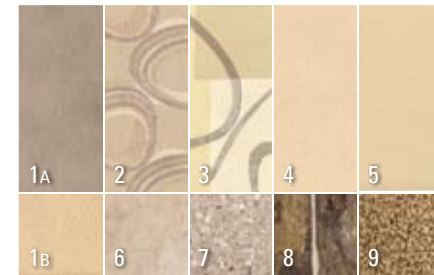

DESERT



WOOD OPTIONS

- 1 Sofa and driver/passenger chairs (with insert)
- 2 Accent fabric
- 3 Bedroom accent
- 4 Bedroom accent
- 5 Drapery
- 6 Wall panel
- 7 Countertop
- 8 Flooring
- 9 Carpet



AMERICA'S MOST **LIVEABLE** RVs.

2 YEAR WARRANTY

The Jayco Co-Pilot Warranty is a manufacturer's limited warranty. It comes from the people who build Jayco recreation vehicles to the people who buy them. Each Jayco is warranted to the original purchaser for twenty-four (24) months or twenty-four thousand (24,000) miles (mileage limitation applies to motorized products only), whichever occurs first, from the original date of purchase against defects in materials and workmanship. Jayco's limited warranty is not transferable.

Go ahead and compare the Jayco warranty with other manufacturers' warranties. You'll find it's the best in the business!

For a copy of the limited warranty with full terms and conditions, ask your local Jayco dealer.

300 JAYCO DEALERS

Establishing a solid relationship with your local Jayco dealer is a key component in the enjoyment of your new Jayco. By purchasing from a local dealer, you will have a convenient location for sales, parts and service support.

Jayco dealers are required to deliver all products at the site of the sale to provide a full product orientation and walkthrough at the time of delivery. It's a good way to become familiar with your Jayco and to meet the service, parts and warranty staff members who will be assisting you. If you live in Canada, there are regulations that must be met when buying a Jayco RV. Your local Canadian dealer is a professional at meeting these requirements and regulations. There simply is no substitute for a good relationship with your local Jayco dealer.

1 YEAR ROADSIDE ASSISTANCE

Travel worry-free with Jayco's Customer First Roadside Assistance program, yours at no cost during your first year of ownership. This program is offered through Coach-Net®, the largest RV emergency road service in the country, and gives you immediate access to dependable roadside assistance and support services with a simple phone call.

- Free jump starts
- Free tire changes
- Free fuel delivery
- Free lockout service
- Free travelers checks
- Toll-free nationwide service appointment assistance
- 24-hour toll-free emergency message service
- Free custom trip routing and full-color map service
- Free dispatch of on-site mechanical service
- \$2,000 trip-interruption reimbursement
- RV technical assistance hotline
- Free towing to nearest qualified service

Your Jayco Dealer



Jayco proudly sponsors Tread Lightly!®, a nonprofit organization whose mission is to empower generations to enjoy the outdoors responsibly through education and restoration.

JayPlus

From RV insurance to extended warranties, JayPlus has it covered. Ask your Jayco dealer about our exclusive JayPlus program today.



As a Jayco owner, you can be part of the Jayco Jafari International Travel Club. Ask your dealer about the Jafari "flight" in your area, write Jayco or visit our website.

Jayco, Inc., P.O. Box 460, Middlebury, IN 46540
www.jayco.com 

See dealer for further information and prices. All information in this brochure is the latest available at the time of publication approval. Jayco reserves the right to make changes and to discontinue models without notice or obligation. Photos in this brochure may show optional equipment and props for photography purposes. RVs built for sale in Canada may differ to conform to Canadian codes. ©2010 Jayco, Inc. 10-MEL-PL-PL 0809-50K Printed in U.S.A.