



# Bounder



BOUNDER-Class A Gas-2006



**1986** Bounder is born, Leading the way in the basement storage trend.



**2001** Introduced on the Power Platform, providing even more storage than previous models.



**2006** Updated with 84" interior ceiling height and available with 22.5" wheels for the next generation.



**Celebrating 20 years of innovation.**

# Floor Plans

**32W**  
Double Slide-Out  
Sleeping Accommodations: 4\*

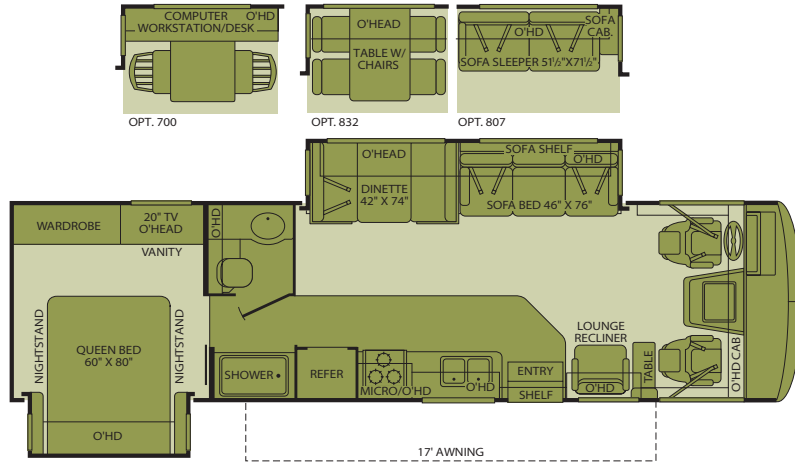

Interior Storage Capacity: 140 cu. ft.  
Exterior Storage Capacity: 105 cu. ft.

**33R**  
Double Slide-Out  
Sleeping Accommodations: 5\*

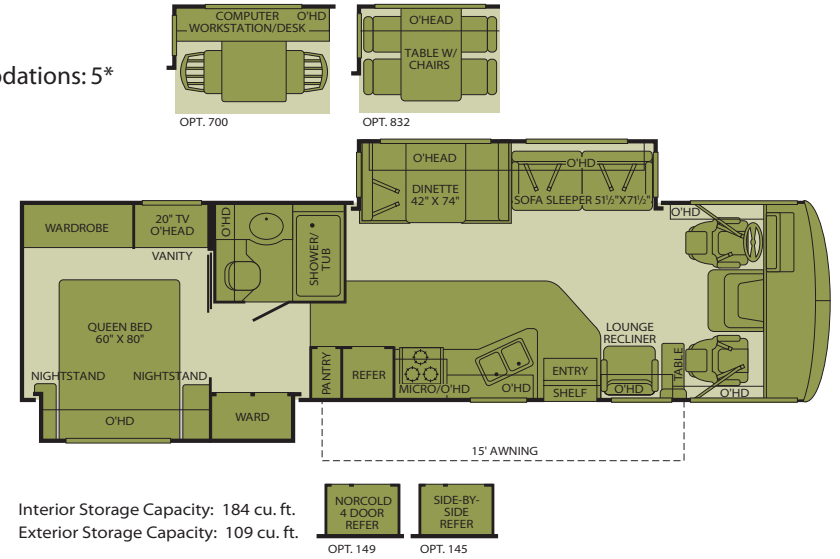

Interior Storage Capacity: 184 cu. ft.  
Exterior Storage Capacity: 109 cu. ft.

**35E**  
Double Slide-Out  
Sleeping Accommodations: 4\*

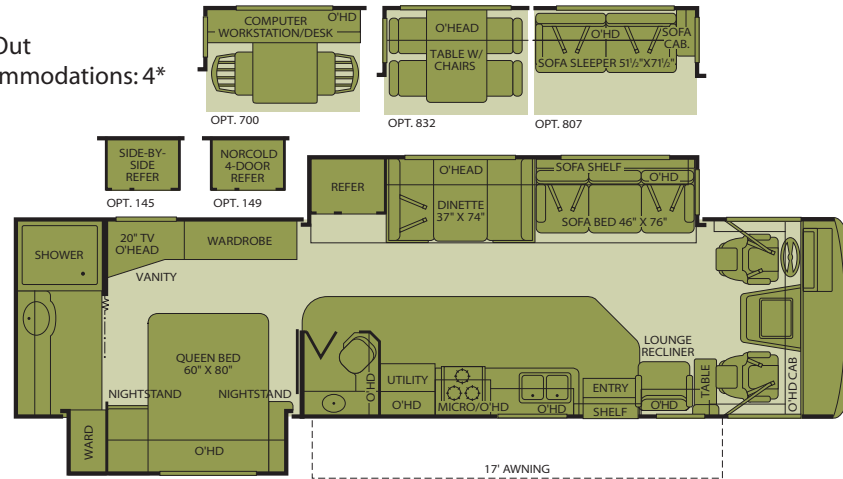

Interior Storage Capacity: 184 cu. ft.  
Exterior Storage Capacity: 129 cu. ft.

Seatbelt configuration may vary depending on options chosen.



**34F**  
Triple Slide-Out  
Sleeping Accommodations: 4\*

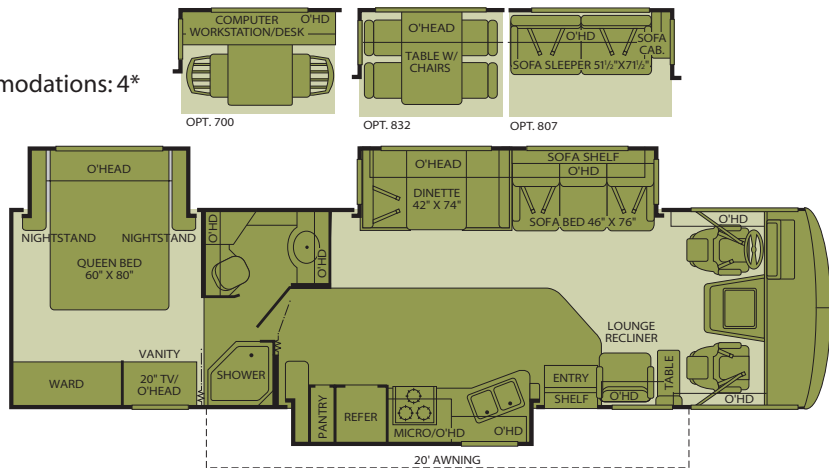

Interior Storage Capacity: 158 cu. ft.  
Exterior Storage Capacity: 91 cu. ft.



Setting the Standard in Motor Home Quality.

**Fleetwood® prototypes are exposed to thousands of miles of durability testing. Those components that don't survive are redesigned until they do.** This sets our standard in safety and durability.

**Royal Tuff-Ply roofing technology is one of the most durable roofing materials on the market and also reflects sunlight to reduce chalking.** White roof material minimizes heat build-up, keeping the temperature cool and comfortable.

**Reliable TuffPEX® plumbing runs throughout each vehicle creating a durable seal on all internal tubing. TuffPEX® assures water flow and functions in colder temperatures.** The TuffPEX® system is an industry leader in quality plumbing.

**For each outer wall, Fleetwood uses one seamless, solid piece of its exclusive Tuff-Coat® fiberglass composite. It resists UV rays, cracks and impacts.** Our products look newer longer and that's a big plus at resale time.

**To assure a strong, weather-resistant structure, Fleetwood Vacu-bonds® all sidewalls, floors and ceilings to a durable aluminum or steel frame.** The Vacu-bond® process is unmatched by many competitors.

**Fleetwood's patented Power Platform supports the body with a rigid frame that reinforces the chassis to make it even stronger.** This allows Fleetwood to offer triple slide-outs.

**Fleetwood sinks and shelves are designed to handle full-size kitchenware.** Few competitors can say the same.

**36Z**  
Double Slide-Out  
Sleeping Accommodations: 4\*

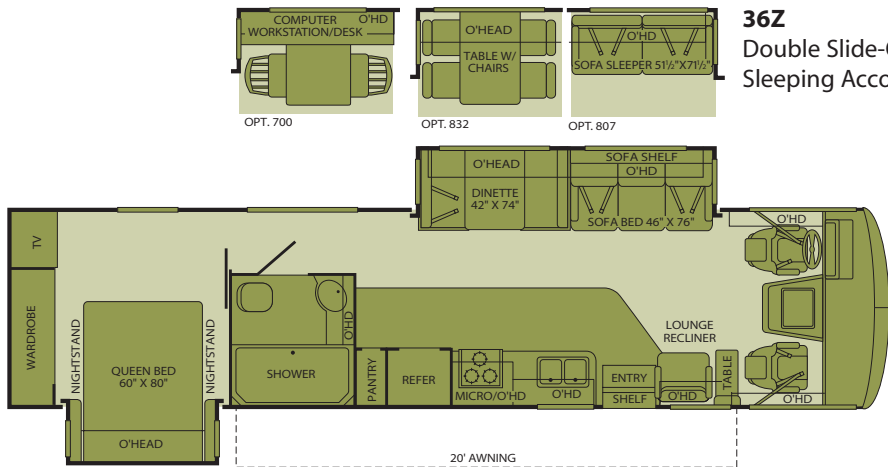

Interior Storage Capacity: 190 cu. ft.  
Exterior Storage Capacity: 144 cu. ft.



*\*Sleeping accommodations are based on designed sleeping areas and may be greater than Sleeping Capacity Weight Rating (SCWR) found on the Cargo Carrying Capacity label located in each RV. Sleeping accommodations are based on standard layout. Optional furniture may increase or decrease sleeping accommodations.*

## Standard Features

### Interior

#### THROUGHOUT

- **Deluxe Roller Bearing, Full Extension Drawer Guides**
- **Plush Wall-to-Wall Carpet w/Carpet Pad**
- **Whole Coach Water Filtration System**
- 6 Gallon Quick-Recovery Water Heater w/Direct Spark Ignition
- 120V/12V AC/DC Converter
- 120V/12V Wire Raceways

#### DRIVER CONVENIENCE

- **AM/FM Radio w/CD Player, Satellite Radio Ready**
- **Double Swivel Sun Visors w/Map Pockets**
- **Driver/Front Passenger Captain's Chairs with Reclining Back/Slide Controls**

#### LIVING ROOM

- **Front 27" Flat Screen Stereo TV in Overhead**

#### GALLEY

- **8 cu. ft. Dometic® Double Door Refrigerator**
- **Large, Double Stainless Steel Sink**
- 1.4 cu. ft. Over the Range Microwave Oven w/Electronic Touch Pad
- 3-Burner Cook Top

#### BEDROOM

- **20" Flat Screen TV**
- **Deluxe Mattress**
- Bedspread w/Decor Pillows

#### BATHROOM

- **Glass Shower w/Skylight and Lower-Step Threshold**
- Coordinated Bath Accessories

#### SAFETY/CONVENIENCE

- 10 ABC Fire Extinguisher
- Carbon Monoxide Detector/Alarm

- 3 Interior Decors
- 34,000 BTU Furnace (30,000/20,000 BTU on 34F Only)
- 3-Way Water Pump Switch
- Central Electrical Panel
- Coordinated Cabinet Hardware
- Decor Lighting
- Dual 6V Deep-Cycle House Batteries
- Dual Roof A/C High Efficiency w/Solar Panel on Front A/C

- 3-Point Seat Belts at Driver & Front Passenger Seats
- Auto A/C Heater Combo
- Auxiliary Start Circuit
- Battery Shut-Off Switch
- CB Radio Ready
- Cruise Control

- Entry Assist Handle
- Hi-Fi VCR

- Adjustable Cabinet Shelves (Select Cabinets)
- Demand Water Pump with Filter
- Fan-Tastic® Power Roof Vent
- Flat Panel Base Cabinet Doors
- Folding Range Cover
- Large Drawers Under Dinette

- Pleated Shades
- Rear Speakers
- Restonic® Innerspring Mattress

- Fan-Tastic® Power Roof Vent
- Hardwood Bath Door/Trims
- Molded Tub/Shower Enclosure

- Propane Detector/Alarm
- Smoke Detector/Alarm

- Energy Management System
- Fluorescent Lighting
- Incandescent Lighting
- Radius Corner Cabinetry
- Solid Divider Doors
- Telephone Jack in Dash
- TV Antenna
- Wall Switches
- Water Heater Bypass
- Wood Drawers

- Dash Fans
- Intermittent Wiper Control
- Low Profile Engine Cover
- Monitor Panel in Dash
- Radio Switch-Main/Auxiliary Power
- Soft-Surface Automotive Dash
- Tilt Steering Wheel

- Lounge Recliner
- Residential Seat Styling

- Raised-Panel Cabinet Doors
- Single-Lever Galley Faucet w/Pullout Sprayer
- Sink Cover Cutting Board
- Vinyl Flooring
- Waste Basket

- Second Phone Jack
- Wardrobe Lighting

- Porcelain Toilet w/Water-Saver
- Skylight in Tub/Shower
- Toilet Tank San-T-Flush™ System

### Exterior

#### THROUGHOUT

- **Heated Water & Holding Tank Compartments**
- 3 Colorway Graphics to Match Decor
- 5.5 kW Onan® Generator
- 50 Amp Service (Optional on 32W & 33R, 30 Amp Standard on 32W & 33R)
- ABS Wheel Well Trims

#### AUTOMOTIVE

- **4-Point Automatic Electric Levelers**
- Large, Curved Aerodynamic Bonded in Windshield
- Steel Surface on Bulkhead
- Trailer Hitch with 7-Point Electrical Hook-Up†

#### SAFETY/CONVENIENCE

- **Remote Heated Rear View Mirrors**
- Entry Door w/Screen Door & Deadbolt Lock

#### BODY STRUCTURE

- **Basement Floor Configuration**
- **Vacu-bond® Upper/Lower Floors**
- **Vacu-bond® Walls with Smooth**

#### STORAGE

- **EZ-Store Compartment on Living Area Slide-Outs**
- **Rotomolded Polyethylene Luggage Compartments**

- Awning Rail/Drip Molding (Both Sides)
- Dual Battery Charge Control
- Dual Pane Windows w/Screens
- Dual Patio Receptacles
- Fiberglass Front/Rear Caps
- Large Headlamps
- Mud Flaps
- Park Cable Receptacle
- Patio Awning

- Underhood Utility Light

† The chassis manufacturer recommends the installation of a supplemental brake control system to activate the brakes on the vehicle or trailer you are towing. Hitch receiver ratings expressed are maximum for the hitch receiver installed and may require the purchase of additional equipment that is dependant on the weight of the towed load. Consult with hitch receiver manufacturer for further information.

- Porch Light (Doorside)
- Power Entry Step
- Roof Ladder

#### High-Gloss Exterior Fiberglass

- Aluminum Interlocking Floor/Wall/Ceiling Framing

- Continuous One-Piece Compartment Bulb Seal
- Gas-Lift Strut Supports
- Hidden, Stainless Steel Latch Rods

- Single Motor Windshield Wipers with Wet Arm
- TV/12V Jack in Doorside Compartment
- Utility Compartment with Exterior Shower
- Valve Extenders
- Wheel Simulators (Aluminum Wheels on Ford® Chassis on 33R, 34F, 35E & 36Z)

- Spare Tire (32W Only)

- Radius Roof w/Ducted A/C
- Royal Tuff-Ply Radius Roof w/Ducted A/C

- Insulated Aluminum Luggage Doors w/Single Paddle Metal Latches & Stainless-Steel Hinges
- Lighted Luggage Compartments

## Fleetwood Advantages

- **Complete TuffPEX® Plumbing System**
- **Power Platform Construction\***

- **Royal Tuff-Ply UV-Resistant Heat/Cold Insulated Roofing Technology**
- **Vacu-Bond® Upper/Lower Floors**

- **Vacu-Bond® Walls w/Smooth High-Gloss Exterior Tuff-Coat® Fiberglass**

*Bold Denotes Fleetwood's Key Features*

*\* Denotes Fleetwood Exclusives*

## Options

#### DRIVER CONVENIENCE

- DSS Satellite Dish
- Ultraleather™ Driver and Front Passenger Chairs

#### BEDROOM

- Torque Windows

#### LIVING ROOM

- DVD/VCR Combo Player

#### GALLEY

- 12 cu. ft. Side-by-Side Dometic® Refrigerator w/Ice Maker (Select Models)
- 3-Burner, High-Output Range w/Oven
- Convection Microwave Oven
- Free Standing Table & Chairs
- Norcold® 4-Door Refrigerator w/Ice Maker (Select Models)

#### THROUGHOUT (INTERIOR)

- 10 Gallon Water Heater (Gas/Electric)
- Computer Work Station
- CSA Package
- Washer/Dryer (Select Models)

#### THROUGHOUT (EXTERIOR)

- Electric Awning
- Full Body Paint
- Rear Vision Camera



# Weights and Measurements

FORD®/ WORKHORSE™ CHASSIS	32W	33R	34F	35E	36Z
<b>Engine Displacement (Liters)</b>	6.8/8.1	6.8/8.1	6.8/8.1	6.8/8.1	6.8/8.1
<b>Wheelbase (Inches)</b>	208/208	208/208	228/228	228/228	228/228
<b>GVWR (lbs)<sup>1</sup></b>	20,500/20,700	22,000/22,000	22,000/22,000	22,000/22,000	22,000/22,000
<b>Front GAWR (lbs)<sup>2</sup></b>	7,000/7,500	7,500/8,000	7,500/8,000	7,500/8,000	7,500/8,000
<b>Rear GAWR (lbs)<sup>2</sup></b>	13,500/13,500	14,500/14,500	14,500/14,500	14,500/14,500	14,500/14,500
<b>Base Weight (lbs)<sup>3</sup></b>	16,800/17,150	17,550/17,800	18,150/18,350	18,150/18,350	18,350/18,550
<b>GCWR (lbs)<sup>4</sup></b>	25,500/25,700	26,000/26,000	26,000/26,000	26,000/26,000	26,000/26,000
<b>Hitch Rating Weight (lbs)<sup>†</sup></b>	5,000/5,000	5,000/5,000	5,000/5,000	5,000/5,000	5,000/5,000
<b>Tongue Weight (lbs)<sup>†</sup></b>	500/500	500/500	500/500	500/500	500/500
<b>Fuel Capacity (gal)</b>	75/75	75/75	75/75	75/75	75/75

DIMENSIONS AND CAPACITIES					
<b>Overall Length<sup>5</sup></b>	33' 3"	34' 3"	34' 9"	35' 3"	37' 3"
<b>Overall Height (with A/C)</b>	12' 7"	12' 10"	12' 10"	12' 10"	12' 10"
<b>Overall Width (maximum)<sup>6,7</sup></b>	102"	102"	102"	102"	102"
<b>Interior Height (maximum)</b>	84"	84"	84"	84"	84"
<b>Interior Width (maximum)</b>	96"	96"	96"	96"	96"
<b>Fresh Water Holding Tank (gal)</b>	85	85	85	85	85
<b>Grey Water Holding Tank (gal)</b>	58	58	58	58	58
<b>Black Water Holding Tank (gal)</b>	42	42	42	42	42
<b>Appliance Propane Tank (gal) (WC)<sup>8</sup></b>	25	25	25	25	25
<b>Water Heater Tank (gal)</b>	6	6	6	6	6

**Liquid Weight Reference:** Water (gal) = (8.3 lbs/3.8 kgs) Fuel (gal) = (6.1 lbs/2.8 kgs) Propane (gal) = (4.2 lbs/1.9 kgs)  
**Metric Conversion:** Multiply pounds x 0.453 to obtain kilograms. Multiply gallons x 3.785 to obtain liters.

CHASSIS	
<b>Model:</b> Ford®/Workhorse™	<b>Transmission:</b> 5-Speed Automatic with Overdrive/
<b>Engine:</b> 6.8L Triton® V10/8.1L Vortec™ V8	6-Speed Automatic with Overdrive
<b>Torque:</b> 457 lb-ft @ 4750 RPM/455 lb-ft @ 3200 RPM	<b>Horsepower:</b> 362 HP/340 HP
<b>Alternator Amps:</b> 130 Amp/145 Amp	<b>Tires:</b> 245/70R 19.5(F)/245/70R 19.5(G)/(32W)/ 235/80R 22.5(G)(33R, 34F, 35E & 36Z)

- GVWR (Gross Vehicle Weight Rating) is the maximum permissible weight of this fully loaded motor home. The GVWR is equal to or greater than the sum of the unloaded vehicle weight plus the cargo carrying capacity.
  - GAWR (Gross Axle Weight Rating) is the maximum permissible loaded weight a specific axle is designed to carry.
  - Base Weight is the estimated weight of the motor home without fuel, options, water, cargo or passengers.
  - GCWR (Gross Combined Weight Rating) is the value specified by the motor home manufacturer as the maximum allowable loaded weight of this motor home with its towed vehicle. Towing and braking capacities may be different. Refer to Fleetwood and chassis manufacturer's manuals for complete information.
  - Length taken from front bumper to rear bumper (excludes accessories).
  - Excludes safety equipment and awnings.
  - Motor homes feature a body-width over 96" which will restrict your access to certain roads. Before purchasing, you should research any state and/or province road laws which may affect your usage.
  - Tank manufacturer's listed water capacity (WC). Actual propane capacity is 80% of water listing as required by the safety code.
- † The chassis manufacturer recommends the installation of a supplemental brake control system to activate the brakes on the vehicle or trailer you are towing. Hitch receiver ratings expressed are maximum for the hitch receiver installed and may require the purchase of additional equipment that is dependant on the weight of the towed load. Consult with hitch receiver manufacturer for further information.

**IMPORTANT — PLEASE READ:** Product information, photography and illustrations included in this publication were as accurate as possible at the time of printing. For further product information and changes, please visit our website at [www.fleetwoodrv.com](http://www.fleetwoodrv.com) or contact your local Fleetwood dealer. Prices, materials, design and specifications are subject to change without notice. All weights, fuel, liquid capacities and dimensions are approximate. Fleetwood has designed its recreational vehicles to provide a variety of uses for its customers. Each vehicle features optimal seating, sleeping, storage and fluid capacities. The user is responsible for selecting the proper combination of loads (i.e. occupants, equipment, fluids, cargo, etc.) to ensure that the vehicle's capacities are not exceeded.

## What Drives You?

Maybe it's feeling like you're the only one on Earth. Perhaps it's the unique sense of closeness with the great outdoors. Or, it might be the joy that comes from spending quality time with family and friends. Whatever the reason, we know that you have a strong drive to experience everything that comes with spending time on the road. And for more than 50 years, we've shared that passion with you. Because we're RV enthusiasts ourselves, you can see our passion in the vehicles we design and build. Own a Fleetwood, and you'll feel like you're not just traveling, but embarking on an experience unlike any other. Set your own course for adventure and get out there and explore the world around you. Once you do, you'll see what it is that drives us — it's you.



**RV OWNERCARE\*** is a limited one-year/15,000-mile coach warranty and three-year/50,000-mile structural warranty, whichever occurs first, and it is fully transferable for the first 12 months. RV OWNERCARE is one of the RV industry's most comprehensive programs and includes systems, appliances, components and construction, with no deductible and no service charge. RV OWNERCARE coverage is provided from a company that will be around in the future to service your needs. See your nearest Fleetwood dealer for a full explanation of benefits and restrictions.

**FLEETWOOD TRAVELCADE CLUB** As a Fleetwood owner, you're eligible to become a member of our owners' group, Fleetwood Travelcade Club. It's a perfect way to meet other Fleetwood owners who love to travel across America and share in the RV lifestyle. Call (877) 577-2560 or visit [www.fleetwood.com/clubs](http://www.fleetwood.com/clubs) to learn more and join the fun! For Boulder specific club information visit: Bounders of America at [www.bounder.org](http://www.bounder.org) or Bounders United at [www.bounder.net](http://www.bounder.net).

**FLEETWOODRV.COM** To locate a dealer near you, visit our website or call 1-800-444-4905. We can also be contacted at Fleetwood Customer Relations, P.O. Box 7638, Riverside, CA 92513-7638.

**IMPORTANT—PLEASE READ** Product information, photography and illustrations included in this publication were as accurate as possible at the time of printing. For further product information and changes, please visit our website at [www.fleetwoodrv.com](http://www.fleetwoodrv.com) or contact your local Fleetwood dealer. Prices, materials, design and specifications are subject to change without notice. All weights, fuel, liquid capacities and dimensions are approximate. Fleetwood has designed its recreational vehicles to provide a variety of uses for customers. Each vehicle features optimal seating, sleeping, storage and fluid capacities. The user is responsible for selecting the proper combination of loads (i.e.: occupants, equipment, fluids, cargo, etc.) to ensure that the vehicle's capacities are not exceeded.

Your local Fleetwood dealer is:



[www.fleetwoodrv.com](http://www.fleetwoodrv.com)

\*For complete info see your Fleetwood dealer. ©2005. Fleetwood Enterprises, Inc.  
Printed in the USA. Inventory control number BDR06F2 10/05.

