



07 SIMBA® GAS



Live out **loud.**



SIMBA GAS FABRICS & EXTERIOR COLORS

DECOR CHOICES THAT ARE ANYTHING BUT ORDINARY.

Safari coaches are designed for those who see things a bit differently than most people. So when it comes to decor choices, we go beyond the ordinary to offer striking graphics, bold colors and innovative patterns. The result is a look that stands out from the crowd while maintaining a definitive sense of style. Just like you.

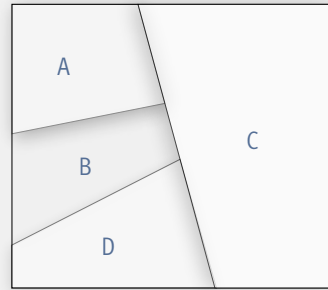

- A. BEDSPREAD
- B. SOFA
- C. DINETTE
- D. CARPET

POMEGRANATE

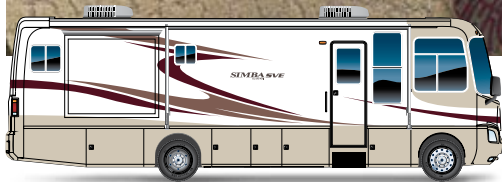

SVE

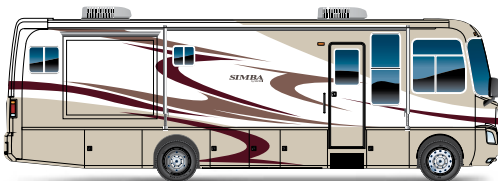

Painted Mask and Skirt Standard

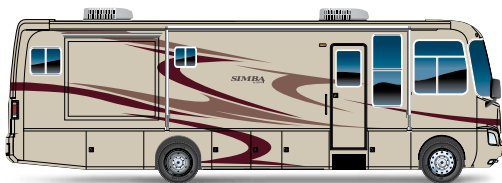

Full-Body Paint Option

HONEYCOMB

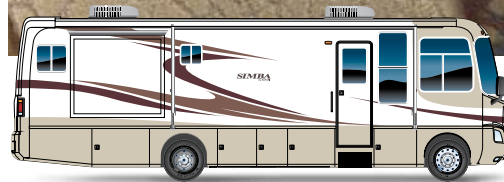

SVE

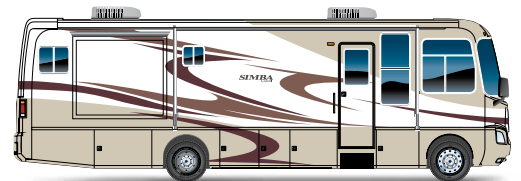

Painted Mask and Skirt Standard

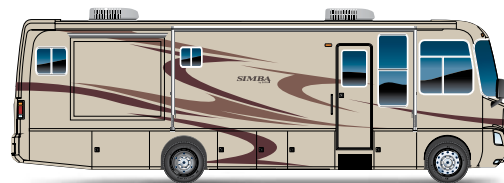

Full-Body Paint Option

New Vintage Oak



Newport Cherry



Champagne Select



CLIFFSIDE

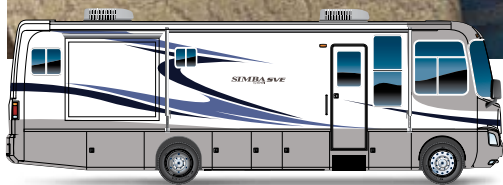

SVE

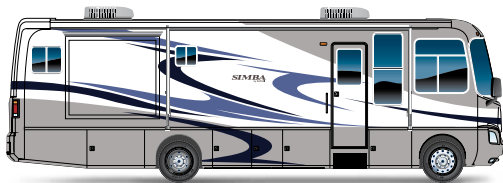

Painted Mask and Skirt Standard

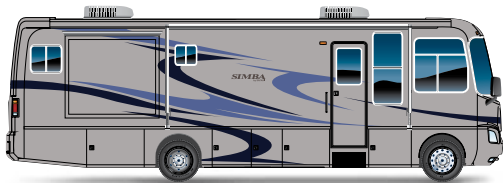

Full-Body Paint Option

CHARCOAL

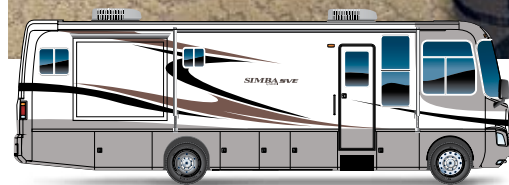
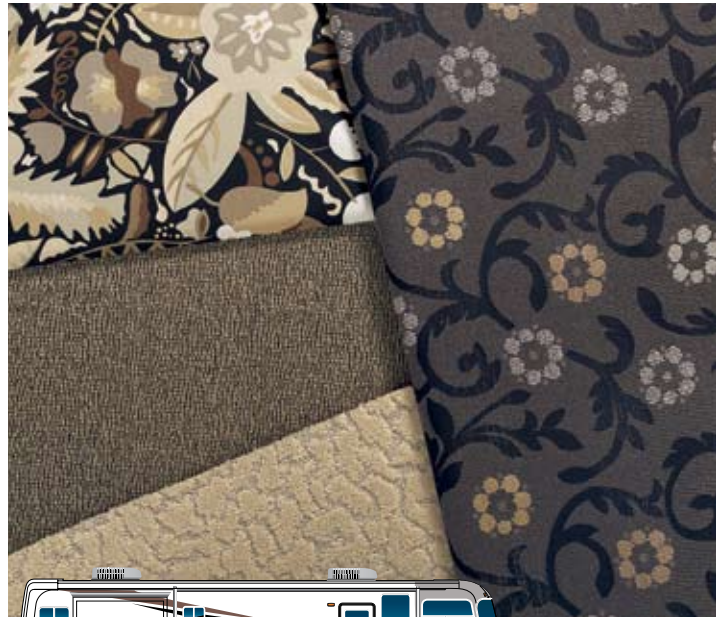

SVE

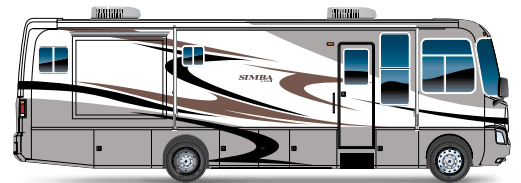

Painted Mask and Skirt Standard

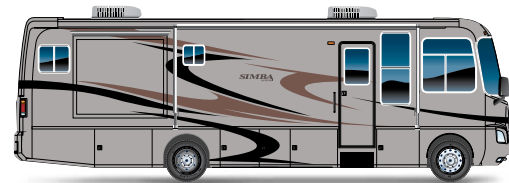

Full-Body Paint Option

Go ahead. Play hard. We're built for it.



2007 SIMBA GAS

SMARTSTRUCTURE II

SmartStructure II adapts the principles of our diesel chassis technology for use with a gas chassis. While other motorhomes use outriggers to hang the walls and storage compartments, our exclusive truss system is integrated with the chassis rails to provide a solid platform.

The floor and storage bays are all one piece, and the truss system works with the chassis rails to channel weight toward the center of the motorhome. Greater strength. Better weight distribution. A solid foundation. That's SmartStructure II.

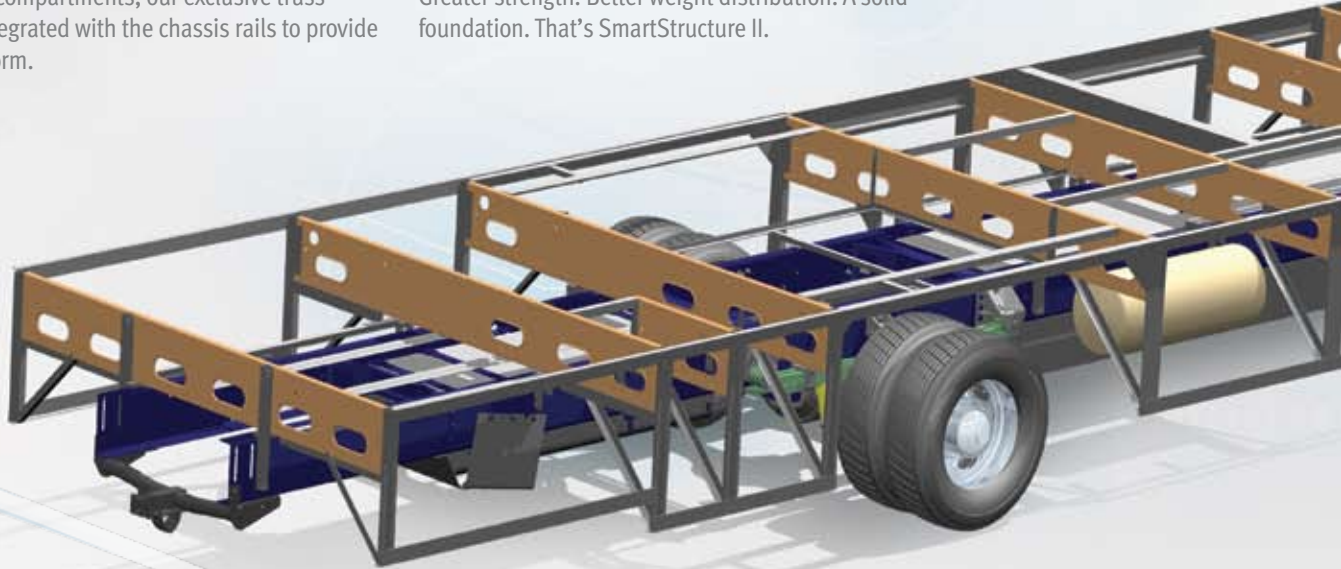

VORTEC™ 8100 ENGINE:

This Workhorse chassis, 8.1L V-8 engine features 340 HP and 455 lbs./ft. torque. The Ford chassis comes standard with a 6.8L 3-valve V-10 engine with 362 HP and 457 lbs./ft. torque.

SLIDE-OUT CONSTRUCTION:

When you purchase a Safari coach, you can be sure the slide-out boxes are some of the strongest and most reliable you'll find anywhere. They feature our exclusive multi-layer construction to give you maximum insulation and to reduce the chance of warping, twisting or shifting.



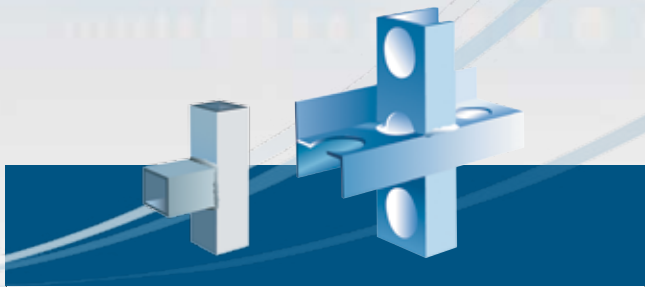

Aluminum
(Butt-Welded)

Alumaframe®
(C-Channel)

The Strength of Alumaframe®

Thanks to our Alumaframe® Superstructure, your Safari coach is built to take on anything the road can dish out. We revolutionized the industry by replacing outdated tubular aluminum construction with our exclusive system of aluminum C-Channel crossmembers. These run the full length of the coach, with double-welded intersections for superior strength. This makes your Safari lighter and sturdier than other coaches and gives you reliability you can count on down the road.



9-Layer Roof (top to bottom)

- One-piece peaked fiberglass roof
- Luau backing
- Thick, tapered bead foam insulation
- Aluminum double I-beam superstructure filled with fiberglass insulation
- Vapor barrier
- Structure foam: thermal insulative barrier
- 1/2" bead foam insulation
- Foam padding for extra insulation
- Padded vinyl ceiling



5-Layer Sidewall (left to right)

- Smooth gel coat fiberglass
- Interlocking C-Channel filled with 1-1/2" fiberglass insulation bonded in place so it doesn't sag or leave spaces uninsulated
- Vapor barrier
- Bead foam adds comfort, saves energy and provides a thermal insulative barrier
- Interior paneling

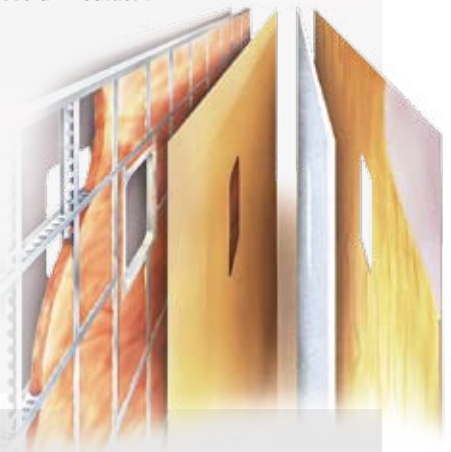

4-Layer Floor (top to bottom)

- Strukturwood™
- Blue foam insulation
- 1-1/2" aluminum tube
- Three-ply poly underbelly

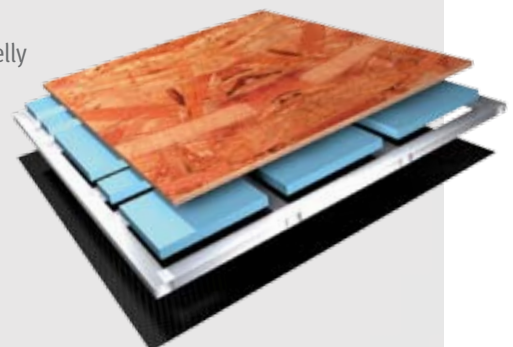

SIMBA GAS 07 FEATURES & OPTIONS

BODY CONSTRUCTION

- Alumaframe® Superstructure
- Steel Cage Cockpit Construction
- Peaked One-Piece Fiberglass Roof with Fiberglass Insulation
- Smooth Gel Coat Fiberglass Exterior Walls
- Redesigned Front Cap with New Headlamps and New Automotive Style Taillights in Rear Cap
- Panaview™ 1-Piece Front Windshield
- Interior Height 84"
- Aluminum Framed Floor on Steel Trusses
- Laminated Structurwood™ Flooring
- Interior Paneling with 3/4" Insulation
- Foam Insulated Floor Framing with 3-Ply Underbelly
- One-Piece Engine Cover
- Power Heated Remote Exterior Mirrors
- Fog Lights
- Low-Profile Sealed LED Marker Lights
- Integrated Metal Fuel Door with Lock
- 30" Deep Bedroom Slide-Out Houses (N/A: 33SFS, 34SBD, 37PRT)
- Pass-Through Storage Bays under Slide-Outs with Polyethylene Boxes
- Side-Hinged Baggage Doors
- One-Piece Polyethylene Storage Compartments
- Painted Mask and Skirt with Vinyl Exterior Graphics
- Rear Ladder
- Interior Rubber Entry Steps with Built-In Stepwell Storage Bucket
- Exterior Triple Entry Steps
- Undercoating

OPTIONS

- Deluxe Full-Body Paint with Vinyl Graphics; Any Awning Selected with Full-Body Paint will have Metal Cover
- Chrome Power Heated Remote Exterior Mirrors
- 3M Film Front Mask
- Standard Run Savings Package: Deluxe Full-Body Paint with Vinyl Graphics, 3M Film Front Mask, 3-Camera Rear Vision System, Power Sunvisors, Home Theater Surround Sound System with Sub-Woofers, Hardwood Raised Panel Doors on Refrigerator, Energy Management System, 600 Watt Inverter, Storage Compartment Tank Monitor Gauge, Fantastic 12V Attic Fan with Rain Sensor with Electronic Wall Thermostat in Bath, Eclipse Automatic Patio Awning
- Full-Length Mud Flap

FORD CHASSIS/ENGINE/SUSPENSION — 22,000 LBS. (N/A: 33SFS)

- 6.8L 3-Valve V-10 Gasoline Engine with Electronic Fuel Injection
- Engine Displacement: 6.8 Liters 415 Cu. In.
- Power: 362 HP
- Torque: 457 lbs./ft.
- TorqShift 5-Speed Automatic Overdrive Transmission with Tow/Haul Mode
- New Transmission Oil Temperature Gauge
- Fuel Tank Capacity 75 Gallon
- 130 Amp Alternator
- Rear Axle Ratio 5.38:1
- Radial Tires 235/80R x 22.5G
- Polished Aluminum Wheels
- Leaf Spring Suspension
- 4-Wheel Anti-Lock Disc Brakes
- Heavy-Duty Front Track Bar with Shock Absorbers
- Fully Automatic Hydraulic Leveling System
- Pre-Wire for Supplemental Braking System
- 4,000 Lb. Hitch Receiver with Dual Connector 4-Pin or 7-Pin
- SmartStructure II

WORKHORSE CHASSIS/ENGINE/SUSPENSION — 22,000 LBS.

- 8.1L V-8 Gasoline Engine with Electronic Fuel Injection
- Engine Displacement: 8.1 Liters 496 Cu. In.
- Power: 340 HP
- Torque: 455 lbs./ft.
- 6-Speed Automatic Transmission with Overdrive
- Fuel Tank Capacity 75 Gallon
- 145 Amp Alternator
- Rear Axle Ratio 5.86:1
- Radial Tires 235/80R x 22.5G
- Stainless Steel Wheel Liners
- Leaf Spring Suspension
- ABS Brake System
- Fully Automatic Hydraulic Leveling System
- Pre-Wire for Supplemental Braking System
- 4,000 Lb. Hitch Receiver with Dual Connector 4-Pin or 7-Pin
- SmartStructure II

COCKPIT

- Fiberglass Automotive Dash with Vinyl Covering, Brushed Gray Instrument Panel
- CD Player/Radio with DVD Player, Sirius-Ready Compatibility, Weather Band, Remote and Four Speakers
- Multi-Positioned Sunvisors
- Rear Vision System Prep
- Intermittent Windshield Wipers
- Tilt Steering Wheel
- Cruise Control
- Power Steering
- Electric Automotive Horn
- Wood Center Console on Engine Cover, Recess Tray with Rubber Mat, and Plastic Two-Tier Cup Holders
- Front Tip-Door Ford/Front Drawer Workhorse Chassis
- Soft Touch Vinyl Pilot and Co-Pilot Recliner Seats
- Six-Way Power Pilot Seat
- Carpeted Driver and Passenger Floor Mats
- Dash Workstation
- Wood Framed Cabinet Doors with Smoked Glass over Front Entertainment Center Systems
- Secure Front Cab over Television with Steel Framing

OPTIONS

- Six-Way Power Co-Pilot Seat
- Sirius Satellite Radio System with 6 Months Pre-Paid Activation
- Single Camera Rear Vision System with Audio and Adjustable Camera
- 3-Camera Rear Vision System with Audio and Adjustable Center Camera
- Power Sunvisors
- Pilot and Co-Pilot Side Window Pull-Down Sunshades
- Interior Sunscreens
- CB Radio Prep
- Driver's Side Door with Power Window

SIMBA GAS 07 FEATURES & OPTIONS

APPLIANCES AND ACCESSORIES

- Large Double-Door Refrigerator
- High-Output 3-Burner Cooktop without Oven
- Bi-Fold Range Cover
- Spacesaver Convection Microwave with Touch Control
- 24" Stereo Color TV with Remote Control in Cockpit Overhead
- 20" Color TV with Remote Control in Bedroom
- TV Antenna
- DVD and Video Control Box with Booster and RF Modulator; Control Boxes Allow DVD Player to Play Video in Bedroom TV
- Wiring for DVD Player Hook-Up to Both TV Locations
- Exterior Hook-Ups for DSS Dish and Cable
- Interior Cable TV Hook-Up and Telephone Jacks
- Digital Satellite System Prep
- Exterior Gas Line Hook-Up Prep for LP Accessories

OPTIONS

- Large Double-Door Refrigerator with Ice Maker
- Large 10 Cu. Ft. Double-Door Refrigerator with Ice Maker
- Large Four-Door Refrigerator with Ice Maker (N/A with Pantry) (N/A: 33SFS)
- High-Output 3-Burner Range with Oven
- Washer/Dryer Prep (Requires 50 Amp Service Option) (33PBD, 36PCT, 36DBD)
- Combination Washer/Dryer (Requires Washer/Dryer Prep Option) (33PBD, 36PCT, 36DBD)
- Central Vacuum System
- Home Theater Surround Sound System with Sub-Woofer, Added to In-Dash Stereo with DVD Player
- Exterior Entertainment Center, CD Player Radio with Two Speakers

INTERIOR

- New Vintage Oak Cabinetry
- Upper Cabinet Doors and Wardrobe Doors with Single Oval Arch, with Woven Insert; Flat Panel Doors on Base Cabinets
- Black ABS Refrigerator Insert
- Wallpaper Border Bath
- Self-Supporting Top-Hinged Overhead Storage Doors, Except Side Wing Cabinet Doors inside Cockpit with Mini-Struts, and Positive Catches on All Other Doors
- Heavy-Duty Ball Bearing Drawer Guides
- Wood Cabinet Drawer Boxes
- Wood Interior Grab Handle with Satin Nickel End Brackets Mounted to Cabinet at Entry Door
- Long Interior Grab Handle at Entry Door
- Satin Nickel Cabinetry Hardware and Bath Accessories
- Integrated Cup Holder to Slide-Out next to Sofa
- Solid Surface Radius Profile Kitchen Countertop with Stainless Steel Sink, Chrome Pullout Faucet and Two Sink Covers
- Pullout Countertop Extension with Two Drawers Built In (N/A: 33SFS, 36PCT)
- Toe Kicks Kitchen and Bath Base Cabinets
- Laminate Bathroom Countertop with Decorative Backsplash and Laminate Perm-Edge
- All Other Countertops Are Laminate with Perm-Edge
- Kitchen Overhead Cabinets with Adjustable Shelf
- Kitchen Pantry next to Refrigerator with Full Height Roll-Out Storage Cabinet (N/A with Four-Door Refrigerator Option)
- Mirrors above Kitchen Countertop
- Laminate Tile Flooring Kitchen, Bath and Entryway
- Laminate Tile Flooring Rear Bath (36DBD)
- Upgrade Nylon Carpeting with Pad in Living Area and Bedroom
- Soft Touch Padded Vinyl Ceiling
- New Style Wood Slide-Out Fascia
- Picture next to Dinette Area or Bedroom, Wainscoting Accent under Picture Dinette Area (34SBD, 36PCT)
- Hutch with Glass Doors and Back Lighted Glass (37PRT, 37PCT)
- Bath Door with Accent Trim on Hallway Side, with Woven Inserts
- Wood Trim on Bath Door Opening Hallway Side
- French Style Door into Bedroom (37PRT, 37PCT)
- Magazine Rack Bathroom (N/A: 33PBD, 33SFS, 34SBD)
- Wood Grain Crown Molding in Bedroom and Living Area on All Open Walls
- Bathroom Lavatory Base Mirror with Wood Frame

- Accent Mirror on Rear Wall with Chair Rail and Wainscoting Accent under Mirrors (34SBD)
- Chair Rail and Wainscoting on Rear Wall (33PBD, 34SBD, 36PCT)
- Side Wardrobe Closet with Deluxe Mirrored Door Frames Satin Nickel Finish (33PBD, 36PCT)
- Bedroom Swing-Away TV Cabinets (Stationary on 33SFS and 36DBD)
- Bedspread with Two Decorative Pillows
- Decorative Fabric Headboard (N/A: 37PRT)
- Blackout Day/Night Pleated Shades in Living Area and Bedroom; Mini Blinds in Kitchen and Bathroom, Where Applicable
- Soil Repellent Fabric Protection

OPTIONS

- New Decors: Cliffside, Pomegranate, Honeycomb, Charcoal
- Wood Choice: Newport Cherry, Champagne Select
- Hardwood Raised Panel Doors on Refrigerator IPO Black ABS Refrigerator Insert
- Hardwood Raised Panel Cabinet Doors IPO Woven Raffia Cabinet Doors

FURNITURE

- Queen Bed with Nightstands (N/A: 37PRT)
- Murphy Bed with Side Cabinets (Fabric Jackknife Sofa Located on Bottom Side of Murphy Bed) (37PRT)
- Roadside Bedroom Slide-Out: Fabric Wall Hugger Sleeper Sofa, Two Pillows (37PRT)
- Arched Back Wood Booth Dinette, with Legless Dream Dinette Countertop and 30" Drawer (N/A: 33SFS)
- Forward-Facing Seatbelts in Booth Dinette inside Living Area Slide-Out (N/A: 33SFS)
- Freestanding Dinette with Two Freestanding Chairs and Two Folding Chairs (33SFS)
- Roadside: Fabric Wall Hugger Sleeper Sofa, Two Pillows on All Sofas
- Fabric Swivel Glider Barrel Chair
- Roadside Dresser below Bedroom Window (36DBD)
- Fabric Swivel Glider Barrel Chair with Desk and Desk Chair Bedroom (37PCT)

OPTIONS

- Roadside Front of Coach: Fabric Hide-A-Bed Sofa with Two Pillows
- Roadside Front of Coach: Fabric Hide-A-Bed Sofa with Air Mattress and Two Pillows
- Soft Touch Vinyl Swivel Recliner Chair IPO Fabric Swivel Glider Barrel Chair
- OptimalLeather™ Euro-Recliner Chair with Ottoman IPO Barrel Chair
- Two Fabric Swivel Glider Barrel Chairs with Center Lift-Up Table IPO Desk and Desk Chair Bedroom (37PCT)
- Bedroom Desk IPO Dresser (36DBD)
- Hallway Bunks with LCD TV and AV Game Plate Built into Outside of Bath Wall with Bunk Ladder (34SBD)
- Freestanding Round Dinette Table with Two Chairs, and Longer Windows IPO Booth Dinette (N/A: 33SFS)

SIMBA GAS 07 FEATURES & OPTIONS

ELECTRICAL SYSTEMS AND LIGHTS

- 50 Amp 120V Distribution Panel and Cord
- 60 Amp Electronic 12V Power Converter
- Onan® 5.5 kW Gas Generator
- Two 6V House Batteries
- Battery Disconnect Switches
- 12V & 110V Outlet in Cockpit Area
- Porch Light and Exterior Step Light on Same Switch
- Exterior Power Entry Step with Light
- Interior Stepwell Entry Step Lights
- Water Pump Switch in Service Bay Area and Convenience Center
- Lights in Outside Storage Compartments
- 120V Receptacles in Outside Storage Compartment
- Underhood Utility Light
- Receptacle and Phone Jack in Dinette Area
- Directional Map Lights Pilot and Co-Pilot Seats
- Hallway Convenience Center
- Fluorescent Light(s) with Night Light Function, under Kitchen Overhead
- Fluorescent Ceiling Lights Throughout
- Fluorescent Ceiling Lights inside Living Area Slide-Out House
- Decorative Wood Framed Galley Ceiling Fluorescent Light with Skylight and Shade
- Decorative Satin Nickel Lighting Living Room Wall Light, Dinette Overhead Light, Bathroom Lavatory Light with Lens Cover, and Bedroom Cosmetic Vanity Light
- Satin Nickel Halogen Lights under Living Room and Dining Room Overhead Cabinets
- Satin Nickel Finish Bullet Lights over Bed with His and Hers Switches
- Wardrobe Closet Lights (N/A: 33PBD)

OPTIONS

- 50 Amp Energy Management System
- 600 Watt Inverter
- Storage Compartment Tank Monitor Gauge

PLUMBING AND LP SYSTEMS

- Kitchen Stainless Steel Sink with Single Lever Chrome Pullout Faucet
- Separate Chrome Faucet for Filtered Water
- Satin Nickel Bath Lavatory Faucet
- Demand Water System and Water Pump
- 10 Gallon LP Gas/Electric Water Heater with Electronic Ignition
- Winterization Valving System
- Water Heater Bypass Valve
- Toilet with Sprayer
- No-Fuss Flush Holding Tank Rinsing System
- Insulated Systems Compartment with Easy Access to Hook-Up
- Shower inside Wet Bay with Hot/Cold Water, Shower Head with Shut-Off
- Soap Dispenser inside Utility Bay
- Gravity and Pressurized Water Fill
- Contained Storage Area for Sewer Hose
- One-Piece Fiberglass Shower
- Shower Faucet with Shower Hose and Head with Shut-Off
- Shower Light on Wall inside Shower Area
- Satin Nickel Shower Door Frame with Obscure Glass (N/A: 36PCT, 37PRT, 37PCT)
- Rounded Satin Nickel Shower Door Frame with Decorative Glass (36PCT, 37PRT, 37PCT)

OPTIONS

- RV Sani-Con 2 System
- Bathtub IPO Shower

HEATING, VENTS AND AIR CONDITIONING

- Dual 13.5M BTU Air Conditioner, with Ducted Air and Wall Thermostats
- 35M BTU Electronic Ignition Furnace
- Electronic Dash AC/Heat Climate Control System
- In-Floor Ducted Heating System with Metal Floor Registers
- Kitchen Powered Attic Fan with Wall Control of Automatic Dome and Fan Power
- Bath Powered Attic Fan with Wall Control of Automatic Dome and Fan Power (36DBD will have a Roof Vent in each Bath Location)
- 12V Heater in Wet Bay, Heat Pad on Fresh Tank
- Metal Air Return Grill Furnace Satin Nickel Finish
- Metal Floor Registers Satin Nickel

OPTIONS

- Dual 13.5M BTU Air Conditioner with Heat Pumps
- Fantastic 12V Attic Fan with Rain Sensor with Electronic Wall Thermostat in Kitchen
- Fantastic 12V Attic Fan with Rain Sensor with Electronic Wall Thermostat in Bath

WINDOWS, DOORS AND AWNINGS

- Radius Flush-Mount Dual Pane Safety Glass Dark Tinted Windows
- Opera Window at Swivel Glider Barrel Chair Location
- Rear Wall Bedroom Window (N/A: 33SFS, 34SBD, 36DBD)
- Bathroom Window (N/A: 33PBD, 33SFS, 34SBD)
- Radius Entrance Door with Clear Glass, Roller Shade, Screen Door and Anti-Skid Steps
- Two Interior Grab Handles and One Exterior Grab Handle
- Topper Slide-Out Awnings Living Area and Bedroom
- Protecta Glaze Tinted Plexiglas® Skylight in Kitchen with Pleated Shade
- Protecta Glaze Tinted Plexiglas® Skylight in Bathroom
- Awning Rail

OPTIONS

- Poly-Weave Patio Awning
- Eclipse Poly-Weave Automatic Patio Awning
- Poly-Weave House Awnings Living Area Slide-Out House Windows
- Bedroom Skylight 30" x 30" Decorative Wood Framed with Shade (37PRT, 37PCT)
- Rear Wall Bedroom Window (34SBD)
- Poly-Weave Side Window Awning Bedroom (33SFS, 34SBD, 36DBD)

SAFETY

- Fire Extinguisher
- Deadbolt Lock on Entrance Door
- 120V GFI Protected Circuit, Kitchen, Bath and Exterior
- LP Gas Detector
- Smoke Detector
- Carbon Monoxide Detector
- Pilot and Co-Pilot Three-Point Seatbelts
- Third Brake Safety Light
- Egress Window(s)

SIMBA GAS 07 WEIGHTS & MEASUREMENTS

	33PBD	33SFS	34SBD	36PCT	36DBD	37PRT	37PCT
Weights (Ford 22,000 Lb. Chassis) * (Lbs.)							
Gross Vehicle Weight Rating	22,000	N/A	22,000	22,000	22,000	22,000	22,000
Gross Combined Weight Rating	26,000	N/A	26,000	26,000	26,000	26,000	26,000
Front Gross Axle Weight Rating	7,500	N/A	7,500	7,500	7,500	7,500	7,500
Rear Gross Axle Weight Rating	14,500	N/A	14,500	14,500	14,500	14,500	14,500
Weights (Workhorse 22,000 Lb. Chassis) * (Lbs.)							
Gross Vehicle Weight Rating	22,000	22,000	22,000	22,000	22,000	22,000	22,000
Gross Combined Weight Rating	26,000	26,000	26,000	26,000	26,000	26,000	26,000
Front Gross Axle Weight Rating	8,000	8,000	8,000	8,000	8,000	8,000	8,000
Rear Gross Axle Weight Rating	14,500	14,500	14,500	14,500	14,500	14,500	14,500
Measurements							
Wheelbase	228"	228"	228"	242"	242"	242"	242"
Overall Length	34' 3"	34' 3"	35' 2"	36' 9"	36' 9"	36' 9"	37' 4"
Overall Height, Including A/C	12' 6"	12' 6"	12' 6"	12' 6"	12' 6"	12' 6"	12' 6"
Interior Height	84"	84"	84"	84"	84"	84"	84"
Interior Width	94.5"	94.5"	94.5"	94.5"	94.5"	94.5"	94.5"
Exterior Width	100.5"	100.5"	100.5"	100.5"	100.5"	100.5"	100.5"
Tank Capacities ** (Gal.)							
Water Heater	10	10	10	10	10	10	10
Gray Tank (Ford/Workhorse)	45	54	40	TBD	42/39	45	45
Black Tank (Ford/Workhorse)	54	42	42	TBD	42/39	54	54
Fresh Tank	60	60	60	60	60	60	60
LP Tank ***	24	24	24	24	24	24	24



* Towing capacity is limited by GCWR; your vehicle's towing capacity is the difference between the GCWR and the actual vehicle weight, including all water, fuel, passengers and cargo. Your towed vehicle should be equipped with auxiliary brakes if the weight of the towed vehicle exceeds 1,000 lbs. Consult your owner's manual for further towing information.

** All tank capacities are estimated based upon calculations provided by the tank manufacturers and represent approximate capacities. The actual "usable capacity" may be greater or less than the estimated capacities based upon fabrication and installation of the tanks.

*** Actual filled LP capacity is 80% of listing due to safety shut-off required on tank.

The actual overall length of the recreational vehicle may differ from that indicated in the brochure due to variances in the manufacturing process and/or installed components. The actual length may be greater or less than that indicated. Due to the large variety of options and floorplan arrangements available to our customers, actual weights for each unit can differ significantly. Safari provides a weight sticker on each unit we produce which includes that unit's tank capacities and approximate weight. Consult your local Safari dealer for unit availability and further information. The information printed in this brochure reflects product design, fabrication, and component parts at the date of printing. The manufacturer reserves the right, at any time, to make changes in product design or material or component specifications as its sole option, without notice. This includes the substitution of components of a different brand or trade name which will result in comparable performance. All information printed in this brochure is subject to change after the date of printing. Some features shown or mentioned in this brochure are optional and may only be available in selected floorplans. Photographs may show props or decorations that are not standard equipment on Safari models. Safari, the Safari logo and its design, are registered trademarks. All other products and company names are trademarks and/or registered trademarks of their respective holders. While the color of the motorhome's exterior and the interior fabrics depicted in this sales brochure are fair and reasonable depictions, the colors depicted may not be an exact match of the actual colors because of the variances in photo-processing and variances caused by inserting the photographs within the sales brochure. Due to product improvements, changes during the model year and/or transcription errors that may occur, information represented within this brochure may not be accurate at the time of your purchase. If certain information is significant to your purchasing decision, please confirm the information with your dealer prior to submitting your order. Component part and appliance manufacturers issue limited warranties covering those portions of the recreational vehicle not covered by the Limited Warranties issued by Monaco Coach Corporation. To learn which specific component parts and appliances are excluded from the Limited Warranties issued by Monaco Coach Corporation, please contact your selling dealership or Monaco Coach Corporation directly, or review the warranty packet inside the recreational vehicle.

SIMBA GAS 07 FLOORPLANS

TILE 
 CARPET 

33PBD

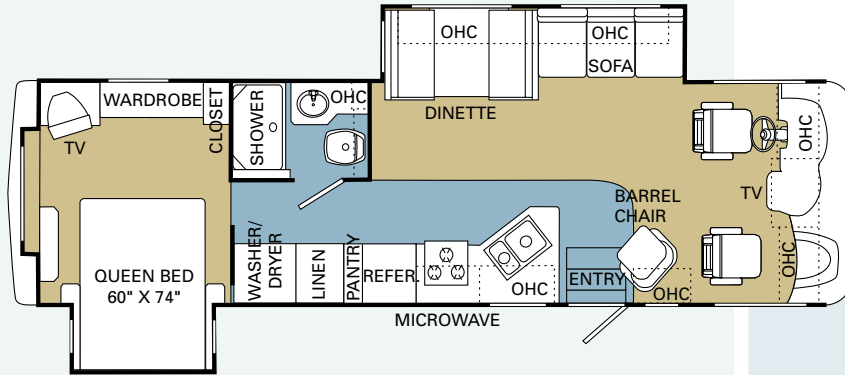

33SFS

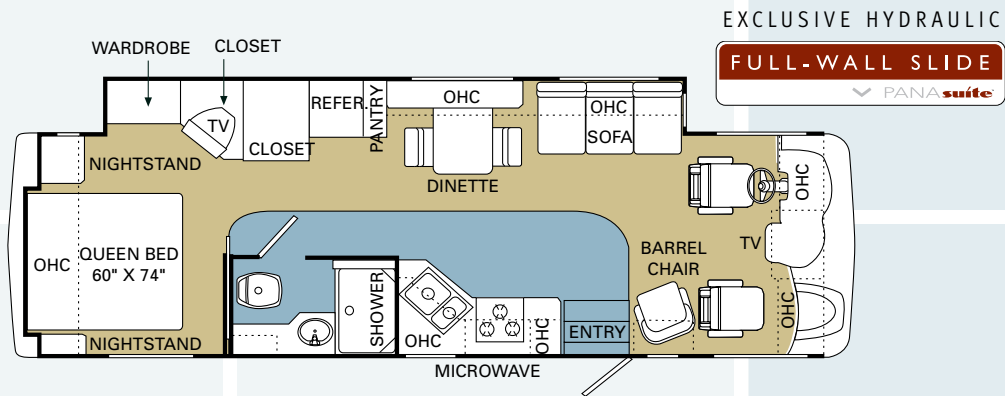

34SBD

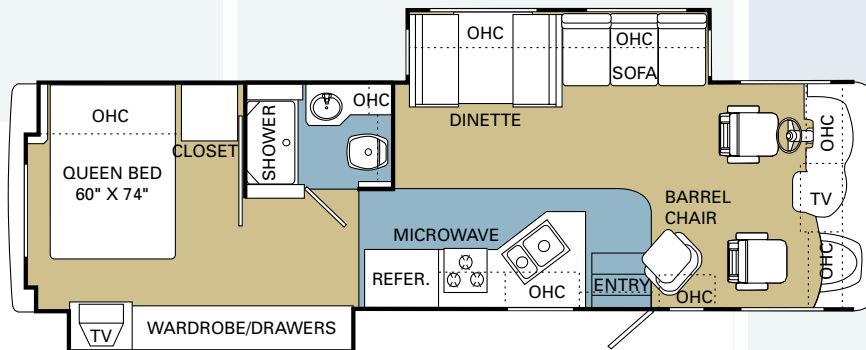

36PCT

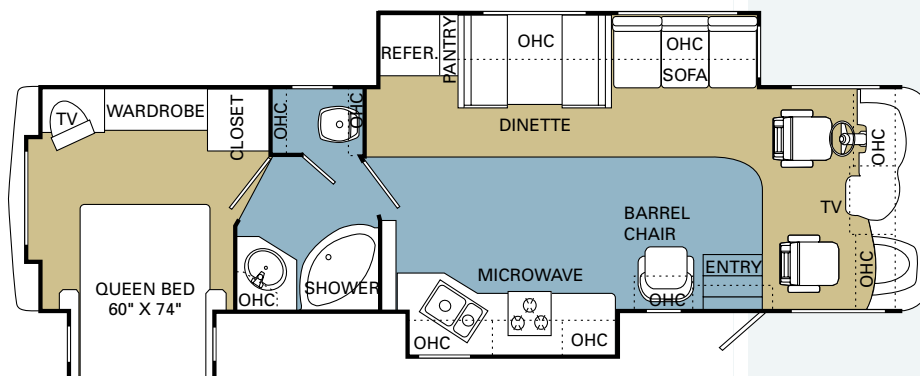

36DBD

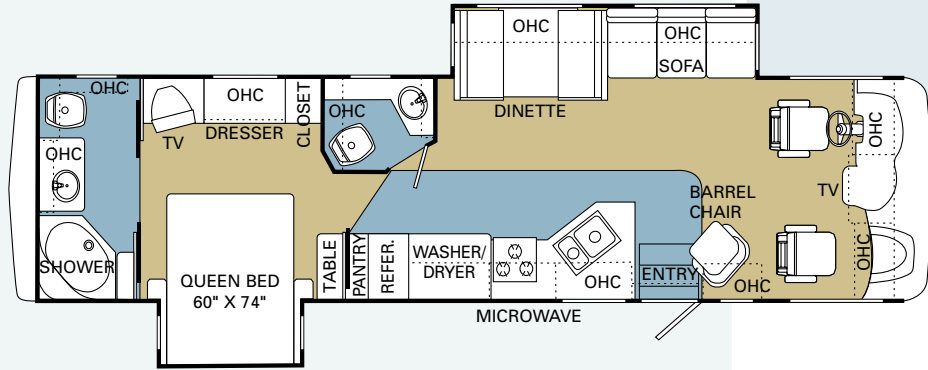

37PRT

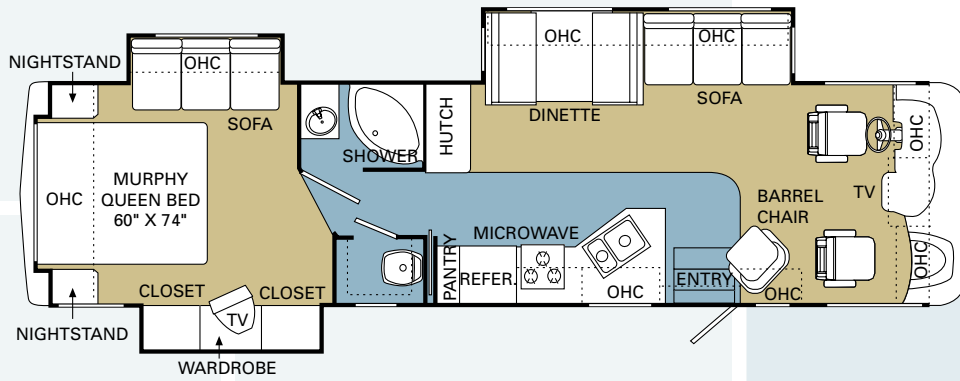

37PCT

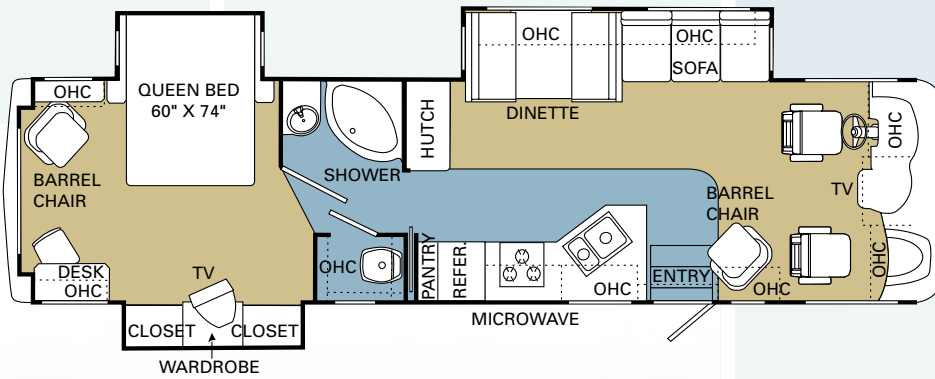

SIMBA SVE GAS 07 FEATURES & OPTIONS

BODY CONSTRUCTION

- Alumaframe® Superstructure
- Steel Cage Cockpit Construction
- Peaked One-Piece Fiberglass Roof with Fiberglass Insulation
- Smooth Aluminum Exterior Walls
- Redesigned Front Cap
- Panaview™ 1-Piece Front Windshield
- Interior Height 8'4"
- Aluminum Framed Floor on Steel Trusses
- Laminated Structurwood™ Flooring
- Interior Paneling with 3/4" Insulation
- Foam Insulated Floor Framing with 3-Ply Underbelly
- One-Piece Engine Cover
- Black Front-Mounted Exterior Mirrors
- Fog Lights
- Low-Profile Sealed LED Marker Lights
- Integrated Metal Fuel Door with Lock
- 30" Deep Bedroom Slide-Out Houses (N/A: 30PBS, 30SFS)
- Pass-Through Storage Bays under Slide-Outs with Polyethylene Boxes
- Side-Hinged Baggage Doors, All Door Locations
- One-Piece Polyethylene Storage Compartments
- New Painted Skirt and Mask with Vinyl Exterior Graphics
- Interior Rubber Entry Steps
- Exterior Double Entry Steps
- Undercoating

OPTIONS

- Rear Ladder
- Standard Run Savings Package: Rear Ladder; Fully Automatic Hydraulic Leveling System; Rear Vision System with Audio and Adjustable Camera; Six-Way Power Pilot Seat; Bi-Fold Range Cover; 20" Stereo Color TV with Remote Control in Bedroom; 6 Gallon LP Gas/Electric Water Heater with Electronic Ignition, DSI; 12V Heater in Wet Bay; Vinyl Patio Awning

FORD CHASSIS/ENGINE/SUSPENSION — 20,500 LBS. (N/A: 33PBD)

- 6.8L 3-Valve V-10 Gasoline Engine with Electronic Fuel Injection
- Engine Displacement: 6.8 Liters 415 Cu. In.
- Power: 362 HP
- Torque: 457 lbs./ft.
- TorqShift 5-Speed Automatic Overdrive Transmission with Tow/Haul Mode
- New Transmission Oil Temperature Gauge
- Fuel Tank Capacity 75 Gallon
- 130 Amp Alternator
- Rear Axle Ratio 5.38:1
- Radial Tires 245/70R x 19.5F
- Chrome Wheel Covers
- Leaf Spring Suspension
- 4-Wheel Anti-Lock Disc Brakes
- Heavy-Duty Front Track Bar with Shock Absorbers
- Pre-Wire for Supplemental Braking System
- Hitch Receiver with Dual Connector 4-Pin or 7-Pin
- SmartStructure II

WORKHORSE CHASSIS/ENGINE/SUSPENSION — 20,700 LBS. (N/A: 33PBD)

- 8.1L V-8 Gasoline Engine with Electronic Fuel Injection
- Engine Displacement: 8.1 Liters 496 Cu. In.
- Power: 340 HP
- Torque: 455 lbs./ft.
- 6-Speed Automatic Transmission with Overdrive
- Fuel Tank Capacity 75 Gallon
- 145 Amp Alternator
- Rear Axle Ratio 5.13:1
- Radial Tires 245/70R x 19.5F
- Stainless Steel Wheel Liners
- Leaf Spring Suspension
- ABS Brake System
- Pre-Wire for Supplemental Braking System
- Hitch Receiver with Dual Connector 4-Pin or 7-Pin
- SmartStructure II

FORD CHASSIS/ENGINE/SUSPENSION — 22,000 LBS. (N/A: 30PBS, 30PDD, 30SFS)

- 6.8L 3-Valve V-10 Gasoline Engine with Electronic Fuel Injection
- Engine Displacement: 6.8 Liters 415 Cu. In.
- Power: 362 HP
- Torque: 457 lbs./ft.
- TorqShift 5-Speed Automatic Overdrive Transmission with Tow/Haul Mode
- New Transmission Oil Temperature Gauge
- Fuel Tank Capacity 75 Gallon
- 130 Amp Alternator
- Rear Axle Ratio 5.38:1
- Radial Tires
- Polished Aluminum Wheels
- Leaf Spring Suspension
- 4-Wheel Anti-Lock Disc Brakes
- Heavy-Duty Front Track Bar with Shock Absorbers
- Pre-Wire for Supplemental Braking System
- Hitch Receiver with Dual Connector 4-Pin or 7-Pin
- SmartStructure II

WORKHORSE CHASSIS/ENGINE/SUSPENSION — 22,000 LBS. (N/A: 30PBS, 30PDD, 30SFS)

- 8.1L V-8 Gasoline Engine with Electronic Fuel Injection
- Engine Displacement: 8.1 Liters 496 Cu. In.
- Power: 340 HP
- Torque: 455 lbs./ft.
- 6-Speed Automatic Transmission with Overdrive
- Fuel Tank Capacity 75 Gallon
- 145 Amp Alternator
- Rear Axle Ratio 5.86:1
- Radial Tires
- Stainless Steel Wheel Liners
- Leaf Spring Suspension
- ABS Brake System
- Pre-Wire for Supplemental Braking System
- Hitch Receiver with Dual Connector 4-Pin or 7-Pin
- SmartStructure II

FORD AND WORKHORSE CHASSIS OPTIONS

- Fully Automatic Hydraulic Leveling System
- Stainless Steel Wheel Simulators, Standard on Workhorse Chassis (N/A: 33PBD)

COCKPIT

- Fiberglass Automotive Dash with Vinyl Covering, Brushed Gray Instrument Panel
- CD Player/Radio with DVD Player, Sirius-Ready Compatibility, Weather Band, Remote and Six Speakers
- Multi-Positioned Sunvisors
- Rear Vision System Prep
- Intermittent Windshield Wipers
- Tilt Steering Wheel
- Cruise Control
- Power Steering
- Electric Automotive Horn
- Soft Touch Vinyl Pilot and Co-Pilot Recliner Seats
- Carpeted Driver and Passenger Floor Mats
- Wood Framed Cabinet Doors with Smoked Glass over Front Entertainment Center Systems
- Secure Front Cab over Television with Steel Framing

OPTIONS

- Six-Way Power Pilot Seat
- Sirius Satellite Radio System with 6 Months Pre-Paid Activation
- Single-Camera Rear Vision System with Audio and Adjustable Camera
- Interior Sunscreens

SAFETY

- Fire Extinguisher
- Deadbolt Lock on Entrance Door
- 120V GFI Protected Circuit, Kitchen, Bath and Exterior
- LP Gas Detector
- Smoke Detector
- Carbon Monoxide Detector
- Pilot and Co-Pilot Three-Point Seatbelts
- Third Brake Safety Light
- Egress Window(s)

SIMBA SVE GAS 07 FEATURES & OPTIONS

APPLIANCES AND ACCESSORIES

- Double-Door Refrigerator
- High-Output 3-Burner Cooktop without Oven
- Microwave with Touch Control and Under-Mounted Range Hood
- 24" Stereo Color TV with Remote Control in Cockpit Overhead
- TV Antenna
- DVD and Video Control Box with Booster and RF Modulator; Control Boxes Allow DVD Player to Play Video in Bedroom TV
- Exterior Hook-Ups Cable TV
- Digital Satellite System Prep
- Interior Cable TV Hook-Up and Telephone Jacks
- Exterior Gas Line Hook-Up Prep for LP Accessories

OPTIONS

- Large Double-Door Refrigerator
- High-Output 3-Burner Range with Oven
- Bi-Fold Range Cover
- Convection Microwave with Touch Control and Under-Mounted Range Hood
- Central Vacuum System
- 20" Stereo Color TV with Remote Control in Bedroom

INTERIOR

- New Vintage Oak Cabinetry
- Upper Cabinet Doors with Single Oval Arch, with Woven Insert; Cockpit Side Cabinet Doors with Square Panel, with Woven Insert; Flat Panel Doors on Base Cabinets and Wardrobes
- Wood Grain Refrigerator Panel Insert
- Wallpaper Border Bath
- Mini Struts on Top-Hinged Overhead Storage Doors and Positive Catches on All Other Doors
- Heavy-Duty Ball Bearing Drawer Guides
- Wood Cabinet Drawer Boxes
- Wood Interior Grab Handle on Cabinet at Entry Door
- Satin Nickel Cabinetry Hardware and Bath Accessories
- Laminate Kitchen Countertop with Decorative Backsplash, White Sink, Chrome High-Profile Double Handle Faucet and One Sink Cover
- Toe Kicks Kitchen and Bath Base Cabinets
- Kitchen Countertop Extension (N/A: 33PBD)
- Laminate Bathroom Countertop with Decorative Backsplash and Laminate Perm-Edge
- All Other Countertops are Laminate with Perm-Edge
- Kitchen Overhead Cabinets with Adjustable Shelf
- Linoleum Flooring in Kitchen and Bath
- Upgrade Nylon Carpeting with Pad in Living Area and Bedroom
- Soft Touch Padded Vinyl Ceiling
- New Style Wood Slide-Out Fascia
- Bathroom Lavatory Base Mirror with Wood Frame

- Bedroom Swing-Away TV Cabinets with TV Option
- Bedspread
- Fabric Headboard
- Blackout Day/Night Pleated Shades in Living Area and Bedroom
- Soil Repellant Fabric Protection
- Kitchen Pantry next to Refrigerator with Adjustable Shelves and Drawers (33PBD)

OPTIONS

- New Decors: Cliffside, Pomegranate, Honeycomb, Charcoal
- Wood Choice: Newport Cherry, Champagne Select

FURNITURE

- Queen Bed with Nightstands
- Bedroom Desk (N/A: 30PBS, 30SFS, 33PBD)
- Arched Back Wood Booth Dinette with Side Sliding Table Top (N/A: 30SFS)
- Freestanding Dinette with Two Freestanding Chairs and Two Folding Chairs (30SFS)
- Roadside: Fabric Wall Hugger Sleeper Sofa, One Pillow
- Fabric Swivel Glider Barrel Chair (33PBD)

OPTIONS

- Forward-Facing Seatbelts in Booth Dinette inside Living Area Slide-Out (N/A: 30SFS)
- Wonder Style Bed Sofa with One Pillow (30SFS)
- Roadside: Fabric Hide-A-Bed Sofa with One Pillow (N/A: 30SFS)

ELECTRICAL SYSTEMS AND LIGHTS

- 30 Amp 120V Distribution Panel and Power Cord
- 60 Amp Electronic 12V Power Converter
- Onan® 4.0 kW Gas Generator
- Two 6V House Batteries
- Battery Disconnect Switches
- 12V and 110V Outlet in Cockpit Area
- Porch Light and Exterior Step Light on Same Switch
- Exterior Power Entry Step with Light
- Water Pump Switch in Service Bay Area and Convenience Center
- Lights in Outside Storage Compartments
- 120V Receptacles in Outside Storage Compartment
- Underhood Utility Light
- Receptacle and Phone Jack in Dinette Area
- Directional Map Lights Pilot and Co-Pilot Seats
- Hallway Convenience Center
- Decorative Satin Nickel Dinette Overhead
- Satin Nickel Decorative Bathroom Wall Light
- Two Single Pancake Lights under Living Room and Dining Room Overhead Cabinets
- Single Pancake Lights over Bed with His and Hers Switches

PLUMBING AND LP SYSTEMS

- Kitchen White Double Bowl Sink with Chrome High-Profile Double Handle Faucet
- Satin Nickel Bath Lavatory Faucet
- Demand Water System and Water Pump 6 Gallon LP with Electronic Ignition
- Winterization Valving System
- Water Heater Bypass Valve
- Thetford Toilet
- No-Fuss Flush Holding Tank Rinsing System
- Insulated Systems Compartment with Easy Access to Hook-Up
- Shower inside Wet Bay with Hot/Cold Water
- Gravity and Pressurized Water Fill
- Contained Storage Area for Sewer Hose
- ABS Shower with Surround
- Shower Faucet with Shower Hose and Head with Shut-Off
- Folding Shower Door

OPTIONS

- 6 Gallon LP Gas/Electric Water Heater with Electronic Ignition
- Satin Nickel Shower Door Frame with Obscure Glass

HEATING, VENTS AND AIR CONDITIONING

- One 13.5M BTU Air Conditioner with Ducted Air and Analog Wall Thermostat, Low-Profile Ford and Workhorse (N/A: 33PBD)
- One 13.5M BTU and One 11.0M BTU Air Conditioner with Ducted Air and Wall Analog Thermostat, Low-Profile Ford and Workhorse (33PBD)
- Electronic Ignition Furnace (31M BTU: 30PBS, 30PDD, 30SFS) (35M BTU: 33PBD)
- Electronic Dash AC/Heat Climate Control System
- In-Floor Ducted Heating System with Metal Floor Registers
- Living Area 12V Roof Vent
- Bath 12V Roof Vent
- Metal Air Return Grill Furnace Satin Nickel Finish
- Metal Floor Registers Satin Nickel

OPTIONS

- One 15M BTU Air Conditioner with Ducted Air and Analog Wall Thermostat, Low-Profile Ford and Workhorse (N/A: 33PBD)
- Living Area Powered Attic Fan with Wall Control of Automatic Dome and Fan Power
- Bath Powered Attic Fan with Wall Control of Automatic Dome and Fan Power
- 12V Heater in Wet Bay

WINDOWS, DOORS AND AWNINGS

- Radius Flush-Mount Single Pane Safety Glass Dark Tinted Slider Windows
- Radius Entrance Door with Clear Glass, Roller Shade, Screen Door and Anti-Skid Steps
- One Interior Grab Handle and One Exterior Grab Handle
- Topper Slide-Out Awnings
- Protecta Glaze Tinted Plexiglas® Skylight in Bathroom
- Awning Rail

OPTIONS

- Poly-Weave Patio Awning
- Rear Wall Bedroom Window (30PDD, 33PBD)

SIMBA SVE GAS 07 WEIGHTS & MEASUREMENTS

	30PBS	30PDD	30SFS	33PBD
Weights (Ford 20,500 Lb. Chassis) * (Lbs.)				
Gross Vehicle Weight Rating	20,500	20,500	20,500	N/A
Gross Combined Weight Rating	25,500	25,500	25,500	N/A
Front Gross Axle Weight Rating	7,000	7,000	7,000	N/A
Rear Gross Axle Weight Rating	13,500	13,500	13,500	N/A
Weights (Workhorse 20,700 Lb. Chassis) * (Lbs.)				
Gross Vehicle Weight Rating	20,700	20,700	20,700	N/A
Gross Combined Weight Rating	25,700	25,700	25,700	N/A
Front Gross Axle Weight Rating	7,500	7,500	7,500	N/A
Rear Gross Axle Weight Rating	13,500	13,500	13,500	N/A
Weights (Ford 22,000 Lb. Chassis) * (Lbs.)				
Gross Vehicle Weight Rating	N/A	N/A	N/A	22,000
Gross Combined Weight Rating	N/A	N/A	N/A	26,000
Front Gross Axle Weight Rating	N/A	N/A	N/A	7,500
Rear Gross Axle Weight Rating	N/A	N/A	N/A	14,500
Weights (Workhorse 22,000 Lb. Chassis) * (Lbs.)				
Gross Vehicle Weight Rating	N/A	N/A	N/A	22,000
Gross Combined Weight Rating	N/A	N/A	N/A	26,000
Front Gross Axle Weight Rating	N/A	N/A	N/A	8,000
Rear Gross Axle Weight Rating	N/A	N/A	N/A	14,500
Measurements				
Wheelbase	190"	190"	190"	228"
Overall Length	31'	31'	31'	34' 3"
Overall Height, Including A/C Workhorse 20,700 / Ford 20,500 Chassis	12' 6"	12' 6"	12' 6"	N/A
Overall Height, Including A/C Workhorse 22,000 / Ford 22,000 Chassis	N/A	N/A	N/A	TBD
Interior Height	84"	84"	84"	84"
Interior Width	94.5"	94.5"	94.5"	94.5"
Exterior Width	100.5"	100.5"	100.5"	100.5"
Tank Capacities ** (Gal.)				
Water Heater	6	6	6	6
Gray Tank	42	43	43	42
Black Tank	42	45	45	42
Fresh Tank	60	60	60	60
LP Tank ***	18	18	18	18



* Towing capacity is limited by GCWR; your vehicle's towing capacity is the difference between the GCWR and the actual vehicle weight, including all water, fuel, passengers and cargo. Your towed vehicle should be equipped with auxiliary brakes if the weight of the towed vehicle exceeds 1,000 lbs. Consult your owner's manual for further towing information.

** All tank capacities are estimated based upon calculations provided by the tank manufacturers and represent approximate capacities. The actual "usable capacity" may be greater or less than the estimated capacities based upon fabrication and installation of the tanks.

*** Actual filled LP capacity is 80% of listing due to safety shut-off required on tank.

The actual overall length of the recreational vehicle may differ from that indicated in the brochure due to variances in the manufacturing process and/or installed components. The actual length may be greater or less than that indicated. Due to the large variety of options and floorplan arrangements available to our customers, actual weights for each unit can differ significantly. Safari provides a weight sticker on each unit we produce which includes that unit's tank capacities and approximate weight. Consult your local Safari dealer for unit availability and further information. The information printed in this brochure reflects product design, fabrication, and component parts at the date of printing. The manufacturer reserves the right, at any time, to make changes in product design or material or component specifications as its sole option, without notice. This includes the substitution of components of a different brand or trade name which will result in comparable performance. All information printed in this brochure is subject to change after the date of printing. Some features shown or mentioned in this brochure are optional and may only be available in selected floorplans. Photographs may show props or decorations that are not standard equipment on Safari models. Safari, the Safari logo and its design, are registered trademarks. All other products and company names are trademarks and/or registered trademarks of their respective holders. While the color of the motorhome's exterior and the interior fabrics depicted in this sales brochure are fair and reasonable depictions, the colors depicted may not be an exact match of the actual colors because of the variances in photo-processing and variances caused by inserting the photographs within the sales brochure. Due to product improvements, changes during the model year and/or transcription errors that may occur, information represented within this brochure may not be accurate at the time of your purchase. If certain information is significant to your purchasing decision, please confirm the information with your dealer prior to submitting your order. Component part and appliance manufacturers issue limited warranties covering those portions of the recreational vehicle not covered by the Limited Warranties issued by Monaco Coach Corporation. To learn which specific component parts and appliances are excluded from the Limited Warranties issued by Monaco Coach Corporation, please contact your selling dealership or Monaco Coach Corporation directly, or review the warranty packet inside the recreational vehicle.

SIMBA SVE 07 FLOORPLANS

TILE 
 CARPET 

30PDD

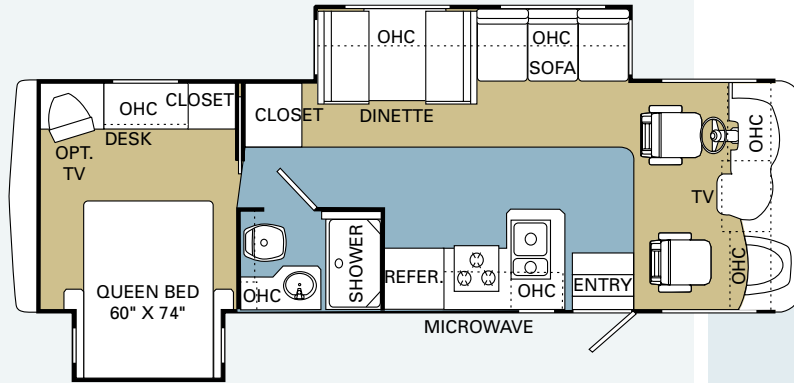

30PBS

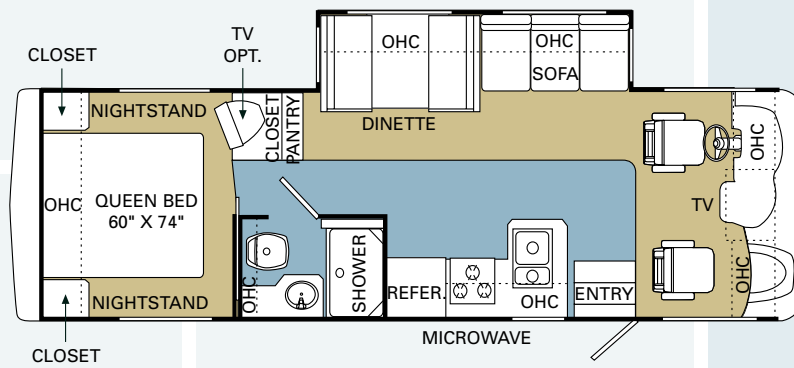

30SFS

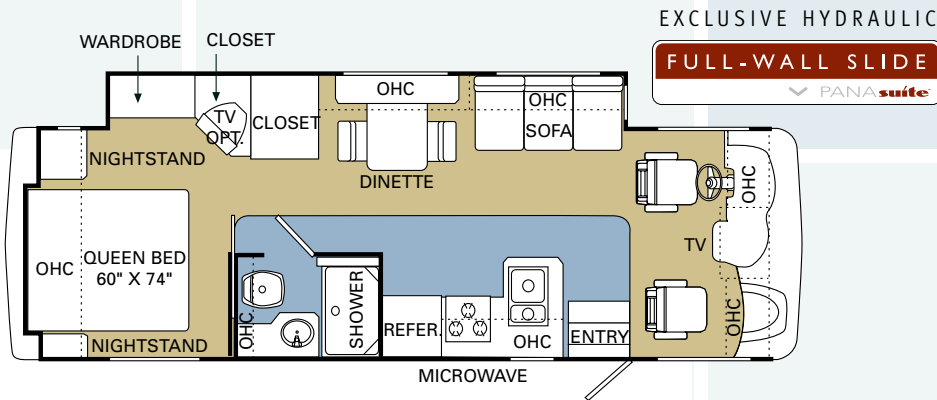

33PBD

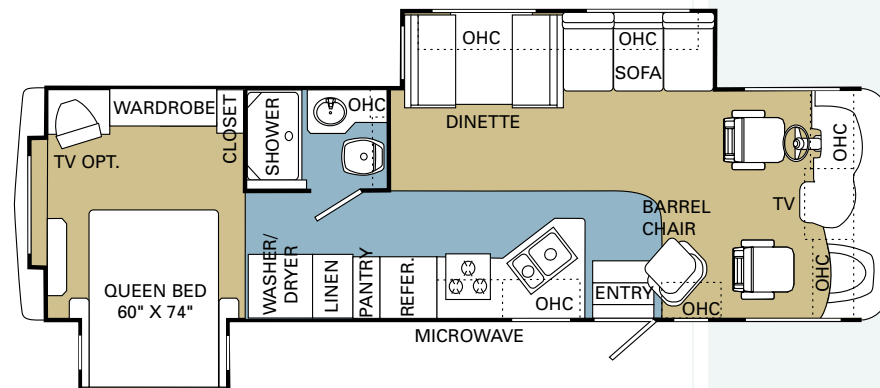

WE'RE HERE.
ANYTIME, EVERY TIME.

- Reach us anytime — literally — via our live customer support line.
- Drive in to one of our 350 Service Centers.
- Enjoy the first year free when you enroll in our Owner Advantage Roadside Assistance Program.
- See where it all begins with a tour of one of our facilities in Indiana or Oregon. Call 1-800-650-7337 or 1-800-634-0855 to find out more.



ASSISTANCE
SALES • TECH • ROADSIDE

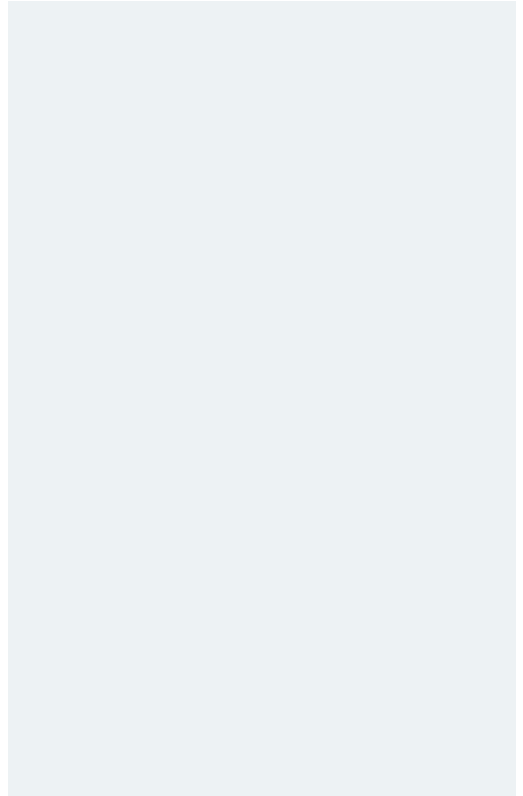
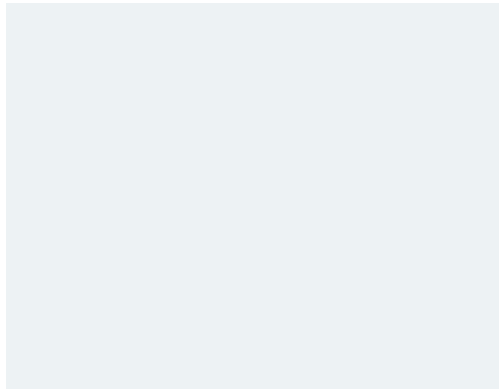
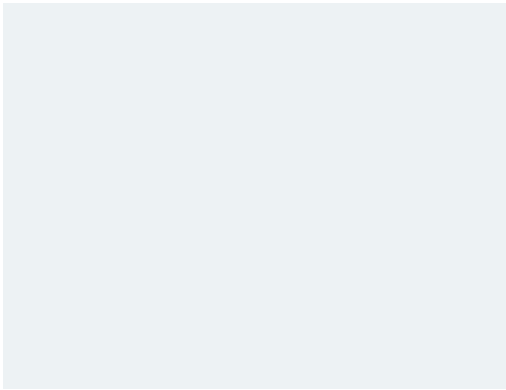

www.safarimotorcoaches.com

91320 Coburg Industrial Way, Coburg, OR 97408

1.800.458.8735