



2006 **LAKOTA**® FIFTH WHEEL



BEHIND EVERY ADVENTURE

INTERIORS

2006 LAKOTA FIFTH WHEEL



▲ Tabasco with New Vintage Oak Wood 32SKD

FIND OUT WHAT YOU'RE MADE OF.

The mountains are calling, your favorite trout stream beckons. And with a new 2006 Lakota fifth wheel, you're there in a heartbeat. This legendary value is loaded with more residential styling than ever before, with new plush fabrics, color-coordinated carpeting and new countertops with Corian® accent. You'll also love the signature styling of the woodwork, with raised panel cabinet doors and decorative slide-out fascia trim. The Lakota encourages you to customize your interior with some impressive optional features, including a home theater system with surround sound speakers, plank flooring and a fireplace, available on select models. Choose from a wide variety of innovative floorplans, including the exciting new 35REQ quad slide-out model, with a rear entertainment center.

INTERIORS

The interior of the 2006 Lakota will rival even the most beautiful countryside. After a day exploring the great outdoors, continue to take in your surroundings with our new standard dark tinted radius windows. Or choose the optional bay windows at dinette area where you can dine in high style with the option of a beautiful and functional freestanding dinette table with hidden leaf and four chairs.



Details such as decorative carved hardwood fascia make the Lakota something truly special.



After dinner, relax and put your feet up with the optional Ultra Vinyl swivel rocker recliners.



The beautiful vintage oak wood cabinets of the entertainment center are highlighted with smoked glass. Add a 27" or 20" color TV with remote and our new-for-2006 home theater surround sound system for your own on-the-road theater experience.

INTERIORS

The Lakota's kitchen is where form and functionality come together – beautifully. You'll find ample storage with raised panel vintage oak cabinets throughout, including a pantry with adjustable shelves and an 8 or 10 cubic foot refrigerator that completes the look with a raised panel door. There's plenty of space for food prep with new Corian®-edged countertops, sink and range covers and countertop extensions on select floorplans. You'll love cooking on the road with a high-output 3-burner range with oven and a microwave with touch control, or for the ultimate in convenience, add a convection microwave. Cleanup is a snap, too, with a standard high-profile single handle faucet and easy-clean linoleum or striking, yet practical, optional plank flooring.





With every inch of space put to good use, you'll feel right at home in the Lakota's bathroom. It begins with a tinted skylight for a spacious and open feeling. The raised panel cabinets and Corian®-edged countertops continue in the bath, and the 2006 model includes the option of a vented, front load, stacked washer/dryer.



Get comfortable in a sumptuous bedroom that includes a custom headboard, designer bedspread, carpeting and pleated day/blackout shades for privacy. Of course, we added practical touches, too, including a handy slide-out with chest of drawers, ample storage, a TV shelf and a spacious closet. And now, you have the option of adding a king-sized bed on select floorplans.

From numerous and conveniently located outlets and phone jacks to ample lighting, the Lakota's attention to detail adds to your overall comfort.



FABRICS



Perfect Storm



Tabasco



Appletini

- A - Bedspread
- B - Sofa
- C - Accent
- D - Carpet

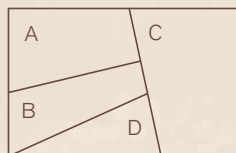

Manufactured in, not added on. For added protection against stains, soil repellent is applied to virtually all upholstery fabric during the finishing process for superior coverage.*



*Brand and application of upholstery fabric protection may vary depending on date recreational vehicle was manufactured.

WOODS



New Vintage Oak



LAKOTA HARDWARE

Our elegant cabinet hardware design features a brushed nickel finish.



EXTERIOR



The new, upgraded exterior graphics complement a new, color-coordinated, texturized fabric awning – all standard.



Standard radial tires and stylized 16" chrome wheels with center hub give a sporty look.



Take along whatever you need without worry. Large pullout storage provides ample packing space and makes loading and unloading easy.

Examine the details, and you'll know exactly why the Lakota is one of the best built, most reliable RVs you'll find anywhere. No other construction compares to the strength of the Alumaframe® superstructure, with double-welded intersections and crossmembers running the entire length of the unit. You'll also enjoy year-round comfort, thanks to the superior insulation of the exclusive multi-layer roof, wall and floor designs. The flat-floor slide-outs enhance your comfort inside the fifth wheel, and the high-gloss fiberglass sidewalls with distinctive new graphics ensure you'll turn heads at every campground.



CONSTRUCTION

The Lakota features McKenzie's exclusive Alumaframe® superstructure. Our revolutionary system of aluminum H and C-channel crossmembers runs the entire length of the unit, with double-welded intersections for added strength. This rigid design is both lighter and sturdier than wood or tubular aluminum frames — and much more reliable than butt-welded or screwed joint designs. From dirt roads to potholes, you can count on Alumaframe® to handle the relentless stresses of the road and provide superior structural integrity for many years to come.

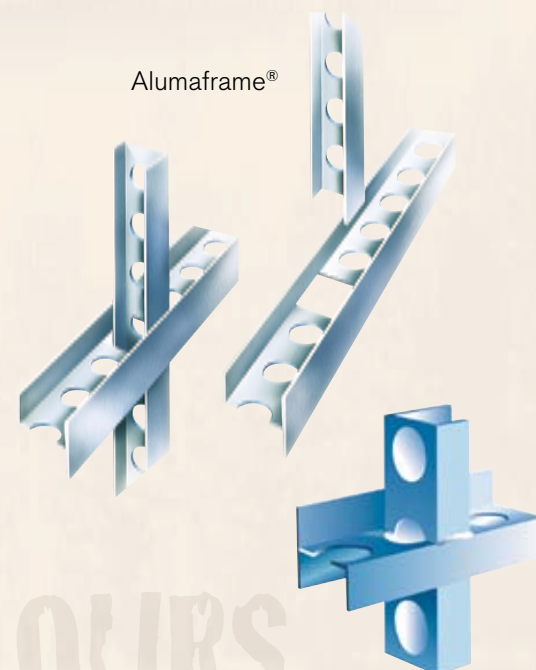
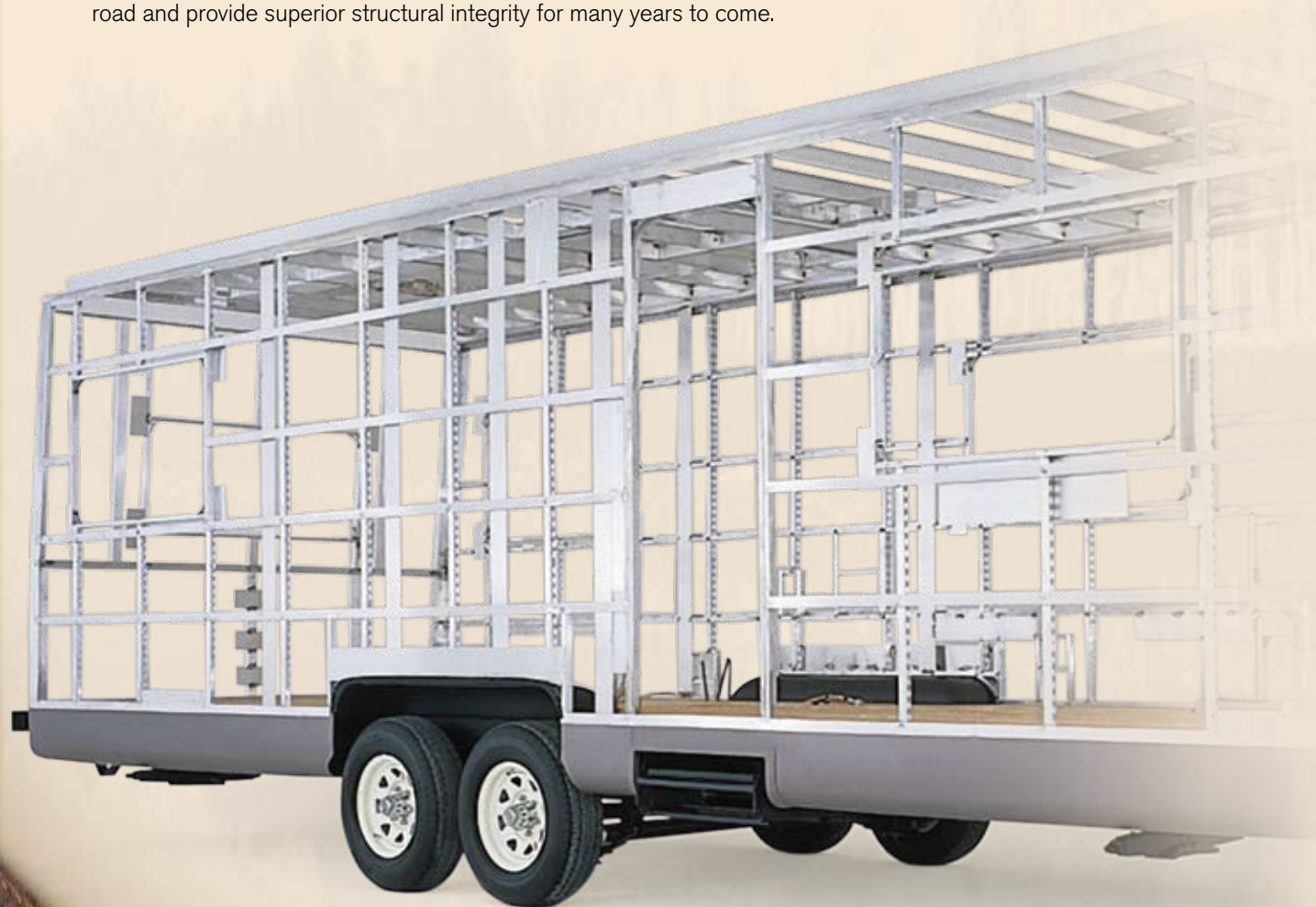

OURS
VS.
THEIRS

Alumaframe®
(C-Channel)



Aluminum
(Butt-Welded)



Wood

9-LAYER ROOF



- A Peaked roof with BriteTek™ exterior
- B Luaun backer
- C Thick, tapered bead foam insulation
- D Aluminum double I-beam superstructure filled with fiberglass insulation
- E Vapor barrier
- F Structure foam: thermal insulated barrier
- G Vapor barrier
- H Luaun backer
- I Vinyl ceiling

6-LAYER EXTERIOR WALL

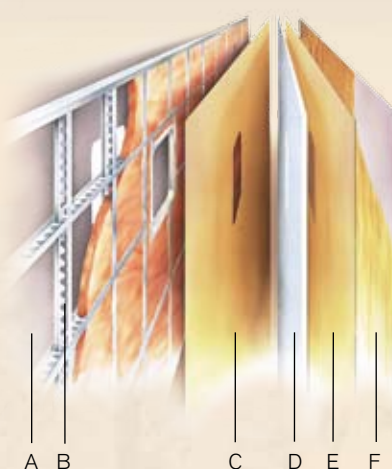

- A High-gloss gel coat fiberglass is standard
- B Interlocking C-Channel filled with 1-1/2" fiberglass insulation bonded in place so it doesn't sag or leave spaces uninsulated
- C Vapor barrier
- D Bead foam adds comfort, saves energy and provides a thermal insulative barrier
- E Vapor barrier
- F Interior paneling

6-LAYER FLOOR

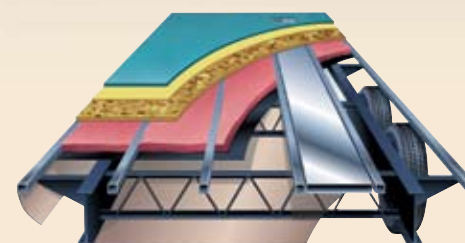

Your fifth wheel features a six-layer floor and a fully enclosed, heated and insulated underbelly. The smooth underbelly contains freshwater and wastewater tanks, dump valves, wiring harness and heating ducts, which help keep the fluid tanks from freezing and improve the overall insulation factor of your Lakota. The smoothness of the underbelly provides unrestricted air flow that results in easier towing and improved gas mileage. And the outer shell of the undercarriage is made of rugged composite material that withstands damage from road debris. In addition, the frame is coated with a rust-inhibiting paint.

SLIDE-OUT

When you purchase a McKenzie, you can be sure the slide-out boxes are some of the strongest and most reliable you'll find anywhere. They feature our exclusive multi-layer construction to give you maximum insulation and to reduce the chance of warping, twisting or shifting. In addition, the actuator has a mechanical room lock that is built in, and there are adjustable built-in stops for in and out positions.

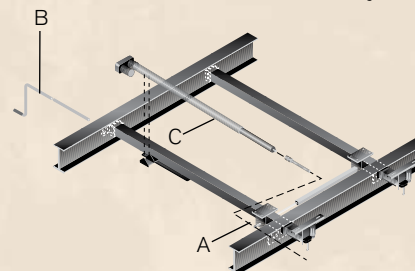

- A Bearing packs are bolted in 4 places, locking the gear and rack in place
- B A manual crank and extension rod comes standard with every unit, to serve as override if needed
- C Actuator motor is positioned to provide smoother movement and reduce twisting on the slide-out room

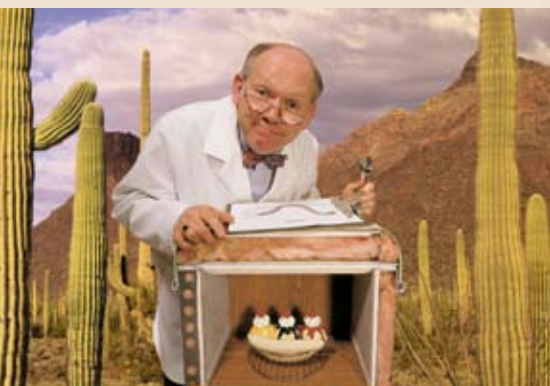

IT'S 101° OUTSIDE. DON'T LOSE YOUR COOL INSIDE.

How do you keep cool inside your RV when it's hot outside? McKenzie has the answer, with our exclusive, multi-layer insulation concept. Just ask Charlie. It's his job to see how we stack up with the competition. He tested McKenzie's nine-layer roof and six-layer wall construction against other RVs in a thermal chamber. The result: the temperature in the competing test unit rose approximately 30 percent more per hour on average than in the McKenzie test unit.*

*Test performed by an independent testing facility, February, 1999.
Based on measurements taken every 15 minutes.
For full details, visit your local dealer.

SPECIFICATIONS

BODY AND FRAME CONSTRUCTION

- › Alumiframe® Superstructure
- › E-Coated Frame
- › Vinyl Exterior Graphics
- › High-Gloss Gel Coat
- › Fiberglass Sidewalls
- › Front and Rear Molded Fiberglass Caps
- › Main Slide-Out House, 6'1" Head Room
- › 3/8" Foam Core, Thermal Barrier, Laminated Sidewall Structure
- › Rear Bay Cap with Three Windows (N/A: 29RKT, 30RKD, 35REQ, 35FLQ)
- › Color-Coordinated Painted Skirts
- › Molded ABS Fender Skirts
- › 1-1/2" Steel Framed Sub-Floor
- › Laminated 5/8" Sturdi-Wood Flooring

- › Laminated Bath Deck (N/A: 35FLQ)
- › Aluminum Roof Structure with Double I-Beam Roof Rafter 16" on Center
- › BriteTek™ Exterior Roof Material
- › Vapor Barrier in Roof
- › Hard Board Vinyl Ceiling
- › Flat Floor Slide-Out - Main Living Area
- › Enclosed and Heated Underbelly
- › Oversized Exterior Storage Door with Below-Floor Storage (N/A: 35FLQ)
- › Frame-Mounted Entry Step
- › Power Landing Jacks

- › 6,000 Lb. Nev-R-Lube Tandem Axles with Electric Brakes
- › 7,000 Lb. Nev-R-Lube Tandem Axles with Electric Brakes (35FLQ, 35REQ, 35RLQ)
- › Radial Tires
- › Stylized 16" Chrome Wheels with Center Hub
- › Ladder
- › Stabilizer Jacks (N/A with Quick Draw Leveling)
- › Shock Absorbers
- › Spare Tire with Sport Wheel
- › Chrome Rims (4 Wheels)

OPTIONS

- › 7,000 Lb. Nev-R-Lube Axles with Chrome Wheels (4 Total) (34RLT, 35SKT)
- › Bike Rack
- › Quick Draw Electrical Leveling Rear (N/A with Stabilizer Jacks)
- › Aluminum Rims - 4 Wheels
- › Wrap Storage Doors (N/A: 35REQ, 35RLQ)

APPLIANCES

- › 8 Cu. Ft. Refrigerator
- › Microwave with Touch Control
- › High-Output 3-Burner Range with Oven
- › Systems Monitor Panel on Range Hood (12 Volt Fan) (N/A: 29RKT, 34RLT)
- › Bi-Fold Range Cover

- › Digital 12V Linear AM/FM with CD Player Stereo with 4 Speakers
- › Telephone Jacks at Kitchen Table, Desk Area and Entertainment Center

OPTIONS

- › 10 Cu. Ft. 2-Way Refrigerator
- › Three-Burner Cooktop without Oven
- › Roll-Out Pantry with Cabinet with Baskets (N/A: 29RKT)
- › Convection Microwave
- › 27" Color TV with Remote - Living Area, TV Swivel Base Required (N/A: 29RKT, 31SKT)
- › 20" Color TV with Remote - Living Area, TV Swivel Base Required (29RKT, 31SKT)

- › 13" Color TV with Remote Control - Bedroom
- › TV Swivel Base - Required Option for 20" and 27" TV
- › Home Theater Surround Sound System
- › Fireplace (N/A: 29RKT, 31SKT)
- › Exterior Radio with CD Player
- › Washer/Dryer Prep with 50 Amp Service - Requires 10 Gal. Water Heater (N/A: 31SKT)
- › Vented Washer/Dryer Stacked (N/A: 31SKT)

PLUMBING AND LP SYSTEMS

- › White FBG Kitchen Sink with Chrome High-Profile Single Handle Faucet
- › Demand Water System with SHURflo® Water Pump

- › 10 Gal. LP Gas/Electric Water Heater
- › Fiberglass One-Piece Shower with Glass Door
- › Water Management System - Includes Outside Shower

- › Water Heater Bypass Kit
- › No-Fuss Flush Holding Tank Rinsing System
- › Two 30 Lb. LP Tanks with Automatic Changeover and Cover
- › Sewer Hose Storage with Hatch and Tube

OPTIONS

- › Water Filter System in Kitchen
- › One-Piece Fiberglass Tub with Glass Door

SPECIFICATIONS

INTERIORS

- › New Vintage Oak Cabinets
- › Raised Panel Cabinet Doors
- › Raised Panel Refrigerator Door
- › Decorative Slide-Out Room Fascia with Trim and Accents
- › Laminate Countertop with Corian® Accent Edge - Galley and Lavatory
- › Galley and Lavatory Backsplash
- › Toe Kicks
- › Kitchen Sink Cover
- › Raised 6-Panel Woodgrain Passage Doors
- › Workstation with Keyboard Drawer

- › TV Shelf in Bedroom
- › Carpeting and Pad in Living Area, Hallway and Bedroom
- › Utility Center by Entrance Door - Slide-Out Switches, Key Hooks and Security Light Switches
- › Linoleum in Kitchen, Bath and Entry
- › Decor Mirrors - Smoked Glass on Entertainment Center Door Only (N/A: 35REQ)
- › Overhead Cabinets in Main Floor Slide-Out above Sofa (N/A: 35FLQ)

- › Pantry/Closet at Front Entry Door with Adjustable Shelves (N/A: 29RKT, 31SKD, 31SKT, 34RLT)
- › Magazine Rack in Stool Room Incorporated into Medicine Cabinet
- › Wood Grain Double Doors in Washer/Dryer Cabinet, Hamper in Lavatory Base (N/A: 31SKT)
- › Wood Interior Grab Handle

OPTIONS

- › Decor Colors: Tabasco, Appletini, Perfect Storm
- › Kitchen Countertop Extension - End of Countertop (29RKT, 31SKT, 32SKD, 35REQ, 35RLQ)
- › Leaded Glass in Living Area Overheads (N/A: 35FLQ)
- › Plank Flooring in Kitchen/Entry
- › Designer Accessory Package

FURNITURE

- › Bedroom Slide-Out with Chest of Drawers
- › Wardrobe Slide-Out (35FLQ)
- › Wood Booth Dinette with End Door and Arched Back Cushions
- › Bedspread
- › Headboard

- › Magazine Table between Chairs (N/A: 29RKT, 30RKD, 35REQ)
- › Swivel Barrel Chair(s)
- › Hide-a-Bed Sofa (N/A: 35FLQ)
- › Jackknife Sofa Slide-Out - Roadside (35FLQ)
- › Bar Stools (31SKD, 35FLQ)

OPTIONS

- › King Bed (35REQ)
- › Curbside Jackknife Sofa Slide-Out (35FLQ)
- › Hide-a-Bed Sofa with Footrests (N/A: 35FLQ)
- › Fabric Swivel Rocker Recliner(s)

- › Ultra Vinyl Swivel Rocker Recliner Chair(s)
- › High-Back Desk Chair (31SKT, 35RLQ, 35SKT)
- › Freestanding Dinette Table with Hidden Leaf and 4 Chairs (Half-Back Style Chairs)

ELECTRICAL SYSTEMS AND LIGHTS

- › Decorative Wall Light with Swing Arm in Living Area
- › Water Heater Switch
- › 30 Amp Electrical Management System
- › Porch Light
- › Hitch Light

- › Two Exterior Security Lights - Individual Switches in the Utility Center
- › Exterior Side Wall Turn Signal
- › Disconnect and Battery Box
- › Trunk Light
- › Bath Bar Light

- › Cable TV/DSS/VCR Ready with Video Box
- › 12V Receptacle Located in Kitchen
- › TV Antenna with Cable Box Dual Exterior Cable/Satellite Receptacle

OPTIONS

- › One 12V Deep Cycle Battery with Disconnect
- › Two 12V Deep Cycle Batteries with Disconnect
- › Solar Prep
- › Fluorescent Lighting in Living Room and Kitchen
- › 50 Amp Electrical Management Service
- › Generator Prep
- › 5.5 kW Marquis Gold (LP) Onan® Generator

LAKOTA

SPECIFICATIONS

HEATING, VENTS AND AIR CONDITIONING

- › 35M BTU Hydroflame Electronic Ignition Furnace (29RKT, 30RKD, 31SKD, 31SKT, 32SKD)
- › 40M BTU Hydroflame Electronic Ignition Furnace (34RLT, 35REQ, 35FLQ, 35RLQ, 35SKT)
- › In-Floor Ducted Heating System
- › Ceiling Fan
- › Manual Roof Vent
- › 12V Roof Vent in Bathroom
- › One Carrier 13.5M BTU Rooftop Air Conditioner with Remote Control
- › Wire Prep and Ducting for Second Air Conditioner with Optional 50 Amp Service

OPTIONS

- › One Carrier High-Capacity Rooftop Air Conditioner with Remote Control
- › One Carrier High-Capacity Heat Pump Rooftop Air Conditioner with Remote Control
- › Second Carrier 13.5M BTU Rooftop Air Conditioner with Remote (Requires 50 Amp Service Option)
- › Second Carrier High-Capacity Heat Pump Air Conditioner with Remote
- › Attic Fan with Thermo and Rain Sensor with 2-Way Switch - Except Bath 1-Way Switch

WINDOWS, DOORS AND AWNINGS

- › Dark Tinted Radius Windows
- › Tinted Skylight in Bathroom
- › Color-Coordinated Texturized Fabric Awning

- › 30" Radius Main Entrance Door with Anti-Skid Steps
- › Swing-Out Entry Door Handle

- › Window in Stool Room (N/A: 31SKD)

OPTIONS

- › Slide-Out Awning or Cover Available on Specific Houses
- › Dual Pane Windows with Dark Tint
- › Bay Window at Dinette

WINDOW TREATMENTS

- › Living Room: Mini Blinds, Padded Valances and Lambrequins
- › Rear Bay Window with Residential Style Vertical Blinds (N/A: 29RKT, 30RKD, 35REQ, 35FLQ)

- › Kitchen: Mini Blinds and Valance
- › Bedroom: Mini Blinds, Valances and Decorative Drapery Panels

- › Bathroom: Mini Blinds and Valance
- › Pleated Day/Blackout Shades in Living Area and Bedroom

SAFETY FEATURES

- › Fire Extinguisher
- › Deadbolt Lock(s) on Entrance Door(s)
- › 120V GFI Protected Outlets (Kitchen, Bath, Exterior)

- › Breakaway Switch
- › LP Gas Detector
- › Smoke Detector

- › Egress Window(s)
- › Safety Glass



AT MCKENZIERV.COM, WE'RE ALWAYS OPEN.

Visit our website anytime day or night to check out the latest product news and updates. You can also take a factory tour, find a dealer near you, get information on club events and much more. It's also an easy way to contact us via e-mail.

WWW.MCKENZIERV.COM

SPECIFICATIONS

WEIGHTS*	29 RKT	30 RKD	31 SKD	31 SKT	32 SKD	34 RLT	35 REQ	35 FLQ	35 RLQ	35 SKT
Gross Vehicle Weight Rating (Lbs.)	14,400	14,400	14,400	14,400	14,400	N/A	N/A	N/A	N/A	14,400
GVWR with 7,000 Lb. Axles (Lbs.)	N/A	N/A	N/A	N/A	N/A	16,950	16,950	16,950	16,950	N/A
Hitch Weight (Lbs.)	2,490	TBA	1,820	1,850	2,430	2,330	2,260	2,590	2,300	TBA
Axle(s) Weight (Lbs.)	6,000	6,000	6,000	6,000	6,000	6,000	7,000	7,000	7,000	6,000
Unloaded Vehicle Weight (Lbs.)	10,740	10,430	10,300	10,800	10,310	11,630	12,230	11,740	12,140	10,990
Net Carrying Capacity (NCC) (Lbs.)	3,660	3,970	4,100	3,600	4,100	2,770	N/A	N/A	N/A	3,410
NCC with 7,000 Lb. Axles (Lbs.)	N/A	N/A	N/A	N/A	N/A	TBA	4,720	5,210	4,810	N/A
Tire Size	16"	16"	16"	16"	16"	16"	16"	16"	16"	16"
Tire Size and Load Range with 7,000 Lb. Axles	N/A	N/A	N/A	N/A	N/A	16" G HT	16" G HT	16" G HT	16" G HT	16" G HT
Tire Load Range	E	E	E	E	E	E HT	G T	G T	G HT	E HT

MEASUREMENTS

Overall Length	31' 6"	32' 6"	33' 10"	33' 3"	33' 10"	35' 10"	36' 10"	36' 10"	36' 10"	36' 10"
Overall Height (Including A/C)	12' 8"	12' 7"	12' 8"	12' 8"	12' 8"	12' 10"	12' 9"	12' 10"	12' 8"	12' 9"
Exterior Width	98"	98"	98"	98"	98"	98"	98"	98"	98"	98"
Awning Length	16'	17'	20'	15'	18'	16'	20'	20'	17'	17'

TANK CAPACITIES**

Water Heater (Gal.)	6	6	6	6	6	6	6	6	6	6
Gray Tank (Gal.)	40/40	40/40	40/40	40/40	40/40	40/40	40/40	40/40	40/40	40/40
Black Tank (Gal.)	40	40	40	40	40	40	40	40	40	40
Fresh Tank (Gal.)	50	50	50	50	50	50	50	50	50	50
LP Tank (Gal.)***	30 (2)	30 (2)	30 (2)	30 (2)	30 (2)	30 (2)	30 (2)	30 (2)	30 (2)	30 (2)

* Weights may vary by options.

** Variances in the fabrication and installation of the tanks may cause the actual "usable capacity" to be greater or less than the capacities designated above.

*** Actual filled LP capacity is 80% of listing due to safety shut-off required on tank.

Due to the large variety of options and floorplan arrangements available to our customers, actual weights for each unit can differ significantly. McKenzie provides a weight sticker on each unit we produce which includes that unit's tank capacities and approximate weight. Consult your local McKenzie dealer for unit availability and further information.

The information printed in this brochure reflects product design, fabrication, and component parts at the date of printing. The manufacturer reserves the right, at any time, to make changes in product design or material or component specifications as its sole option, without notice. This includes the substitution of components of a different brand or trade name, which will result in comparable performance. All information printed in this brochure is subject to change after the date of printing. Some features shown or mentioned in this brochure are optional and may only be available in selected floorplans. Photographs may show props or decorations that are not standard equipment on McKenzie models. McKenzie, the McKenzie logo and its design, are registered trademarks. All other products and company names are trademarks and/or registered trademarks of their respective holders.

While the color of the towable's exterior and the interior fabrics depicted in this sales brochure are fair and reasonable depictions, the colors depicted may not be an exact match of the actual colors because of the variances in photo-processing and variances caused by inserting the photographs within the sales brochure. Due to product improvements, changes during the model year and/or transcription errors that may occur, information represented within this brochure may not be accurate at the time of your purchase. If certain information is significant to your purchasing decision, please confirm the information with your dealer prior to submitting your order.

The actual overall length of the recreational vehicle may differ from that indicated in the brochure due to variances in the manufacturing process and/or installed components. The actual length may be greater or less than that indicated.

Component part and appliance manufacturers issue limited warranties covering those portions of the recreational vehicle not covered by the Limited Warranties issued by Monaco Coach Corporation. To learn which specific component parts and appliances are excluded from the Limited Warranties issued by Monaco Coach Corporation, please contact your selling dealership or Monaco Coach Corporation directly, or review the warranty packet inside the recreational vehicle.

FLOORPLANS

■ LINOLEUM □ CARPET

29 RKT

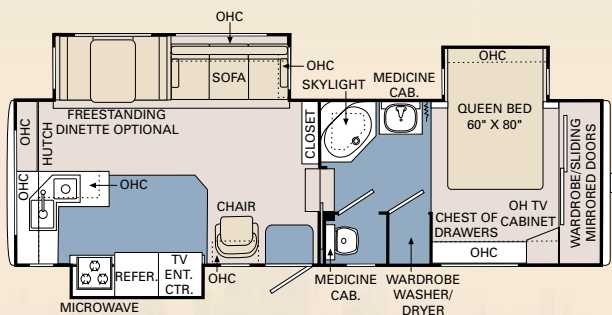

31 SKT

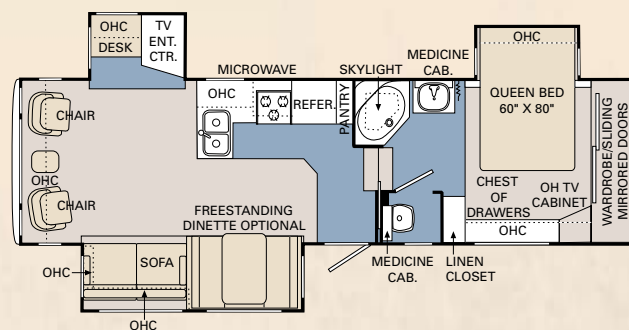

30 RKT

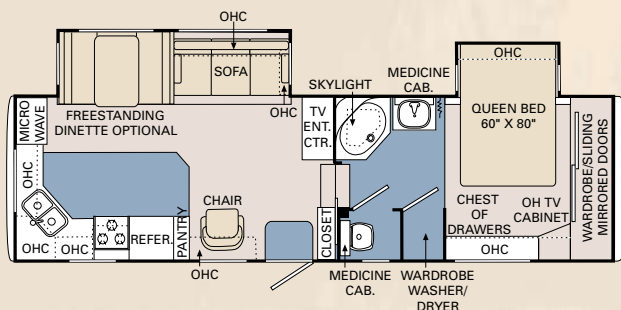

32 SKD

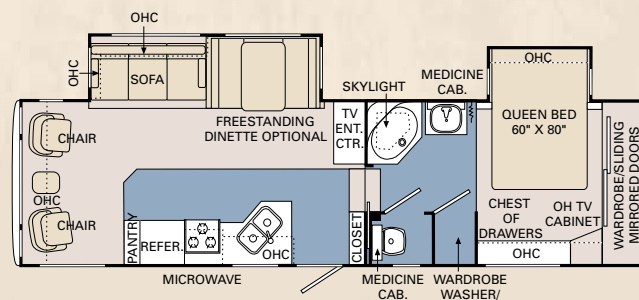

31 SKD

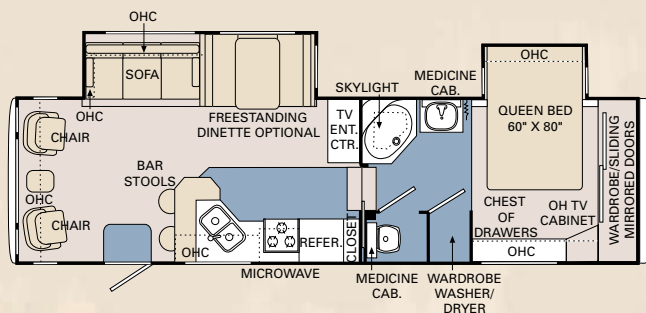

34 RLT

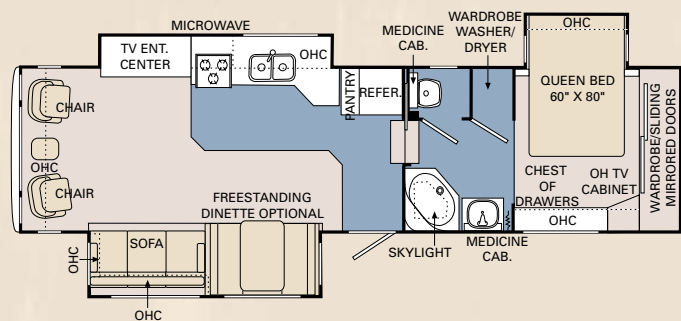

FLOORPLANS

■ LINOLEUM □ CARPET

35 FLQ

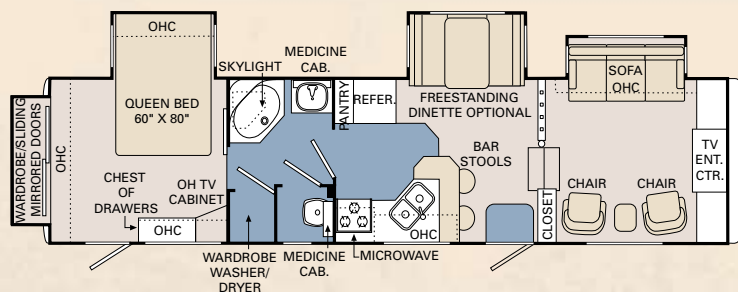

35 RLQ

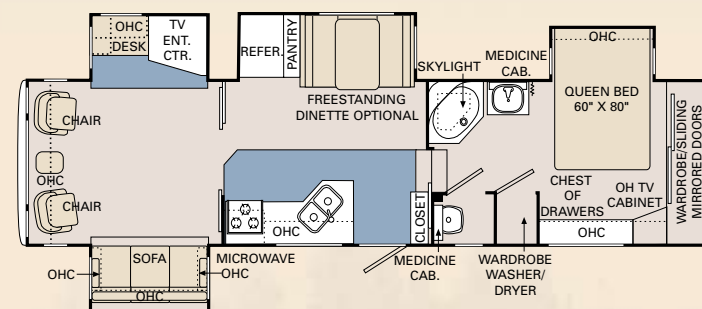

35 REQ

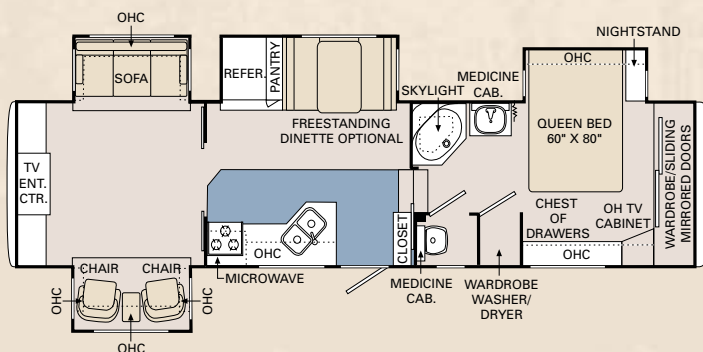

35 SKT

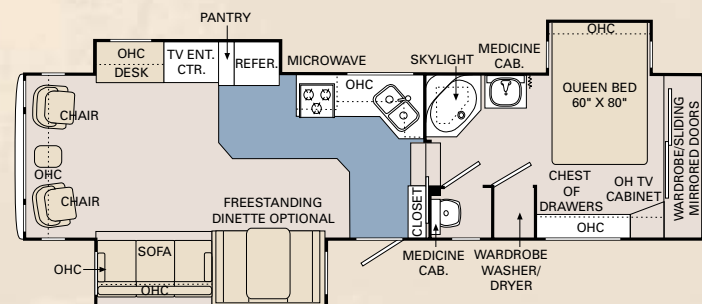

WE'VE GOT YOUR BACK.

- Live customer support 24/7/365
- 350 Nationwide Service Centers
- Free first-year enrollment in our Owner Advantage Roadside Assistance Program
- Call 1-800-634-0855 or 1-800-650-7337 to arrange a tour of one of our state-of-the-art production facilities in Indiana or Oregon.



BEHIND EVERY ADVENTURE

Thank you for your interest in McKenzie, a division of the world's leading RV manufacturer, Monaco Coach Corporation. Our value-packed fifth wheels and travel trailers come with the same legendary customer service and technical support you'd get with our top-of-the-line motorhomes. In short, when you buy a McKenzie, you have the backing of our entire company mile after mile, year after year.

We know how you take your playtime seriously. Seizing every moment. Squeezing the excitement out of every new adventure. And it's simple, really. To have a better RV experience, you've got to have one thing: A better RV. The 2006 Lakota.

www.MCKENZIERV.com

WARRANTIES

12 MONTH basic limited warranty

5 YEAR limited warranty on aluminum or steel frame structure of sidewall, roof, front and rear cap



MONACO COACH CORPORATION

MNC
LISTED
NYSE



McKenzie, a division of Monaco Coach Corporation
606 Nelson's Parkway, Wakarusa, Indiana 46573 • Telephone 800.634.0855 or Fax 541.681.8842
Visit our website at www.mckenzierv.com
Monaco Coach is traded on the NYSE under the symbol MNC.
Litho in USA 0805 NPN: BROMCLAK