



2008

TRAVEL STAR[®]

BY STARCRAFT



19CK

Expandables

XLTs



21SD EXTREME



28SSO



Travel Star Expandables



Quality starts with attitude. At Starcraft, we've always referred to that attitude as *Starcraftsmanship!* It's a working philosophy that starts with research and design, and carries all the way through production to sales and service. It's our way of bringing you more in terms of value, service and warranty.

It's a standard of excellence, a frame of mind. *Our* frame of mind. *Our* standard of excellence. A standard of quality and craftsmanship we continually strive to expand every day.

When you take the best ideas, designs, materials and people, and put them all together, year after year, you earn a reputation. That reputation goes on the line every time we sell another product. Add up the reasons for our success, and you have the best reason of all to buy a Starcraft ... *Starcraftsmanship.*



19CK Green Leaf
w/Sierra Maple Décor

Whether your lifestyle leans toward relaxed or active, Starcraft's Travel Star expandable travel trailers are the ideal home base. We use Aqualon®-7 tent fabric in our fold-down bunkends that have Conestoga-shaped roofs for proper water runoff. Several of our floorplans offer a slideout, and three new décors coordinate handsomely with the Sierra maple cabinetry.

Settle in for meals and conversation on comfortable 4" foam reversible dinette seat cushions and new contoured, B-Back cushion backs with zippers. A spacious storage compartment is located under each seat. When the day is finished, dinettes convert into a comfortable bed.

LEGEND: COMFORT AREAS VINYL
 CARPET STORAGE

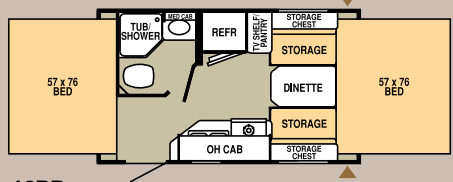

16RB

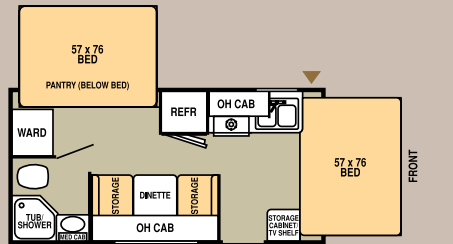

18SB

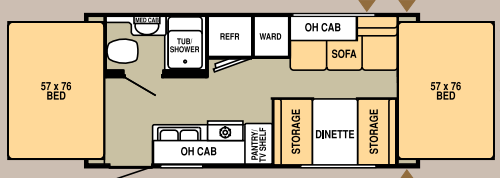

19CK



21SD EXTREME

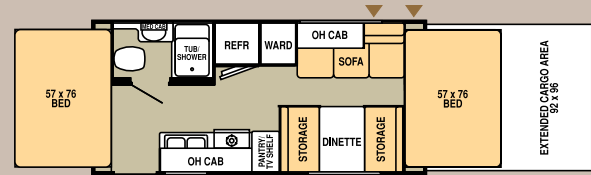

19SD EXTREME

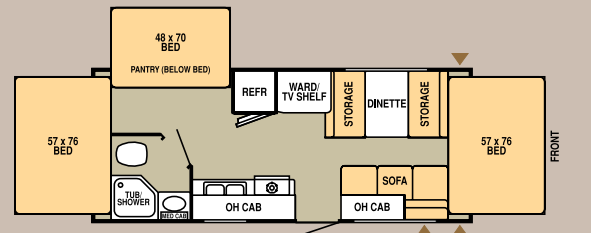

21SB

People seem to gather in the kitchen, so we make sure ours is fully equipped, easy to use and provides a welcoming look and feeling. A double-door refrigerator, laminated counters, residential linoleum, plentiful cabinet and drawer storage and a black range hood with fan and light are all standard.



21SD Copper Spice w/Sierra Maple Décor



19CK Green Leaf w/Sierra Maple Décor

Travel Star expandables provide the perfect camping experience, by combining the ambience of tent camping with the security of a conventional travel trailer. Travel Star brings you outstanding quality, reliability and good looks that last.



21SD Copper Spice w/Sierra Maple Décor



Talk about extreme! Travel Star's huge extended front cargo area lets you include motorcycles, dirt bikes, 4-wheelers, firewood, decoys ... pretty much everything you need to make your camping experience sensational!



21SD Copper Spice w/Sierra Maple Décor

To help you stay comfortable, standard amenities include an electronic-ignition ducted furnace, a 6-gallon LP water heater with bypass, dual 30# LP tanks with automatic regulator and a 45-AMP power center with a battery charger.

This cozy bathroom adds convenience and privacy. Included are a toilet, sink, shower, mirrored medicine cabinet and storage in every possible location.

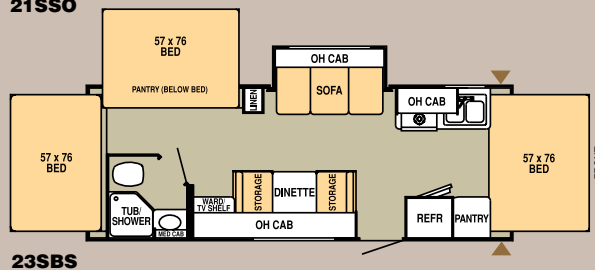
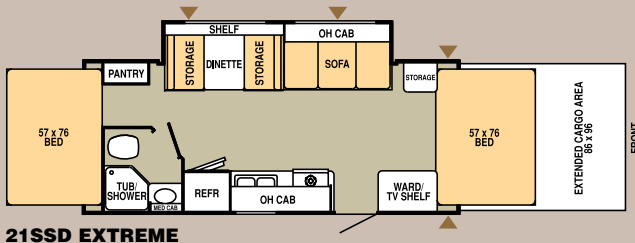
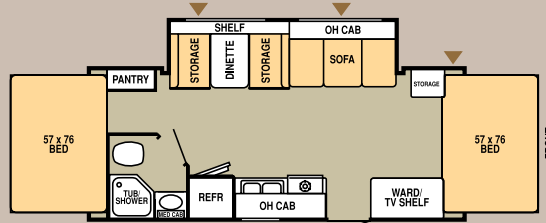
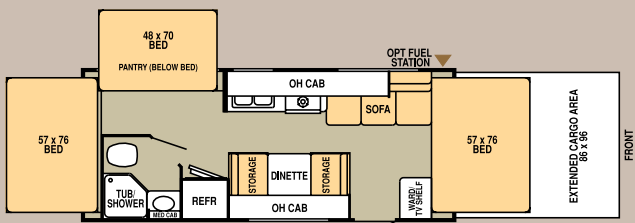

Travel Star

XLTs



28SSO Slate Blue w/Sierra Maple Décor



28SSO Slate Blue w/Sierra Maple Décor

Travel Star XLT's are ultra lightweight travel trailers with hard side and end walls. XLTs provide attractive, functional dining and living areas that offer such standards as under dinette storage, convertible sleeping space and plenty of additional storage. Kitchens are furnished with all the necessities, plus ample workspace.



28SSO Slate Blue w/Sierra Maple Décor

The queen bed lifts to reveal storage underneath; wardrobe and drawer space is generous. Window treatments are coordinated with the standard bedspread.



28SSO Slate Blue w/Sierra Maple Décor

Most Travel Star XLTs offer bunk beds that supply comfortable sleeping.



28SSO Slate Blue w/Sierra Maple Décor

Bathrooms include a tub with shower and ample space for dressing in private.

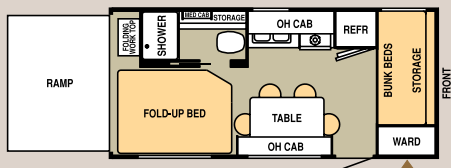

18FB EXTREME

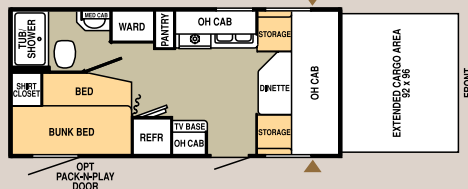

21DSD EXTREME

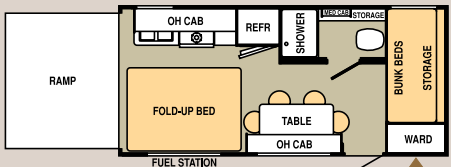

19FB EXTREME

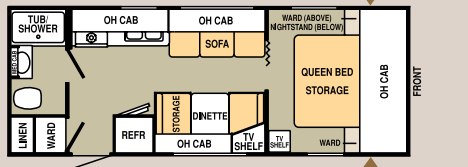

24QB

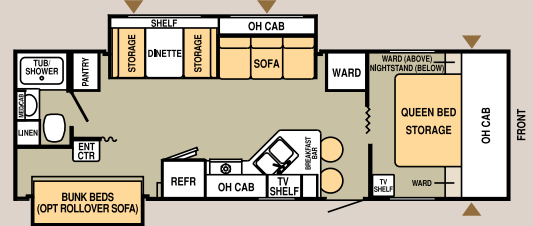

28SSO

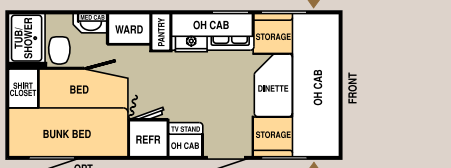

21DBB

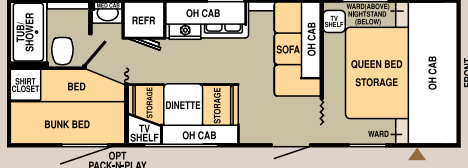

27RBH

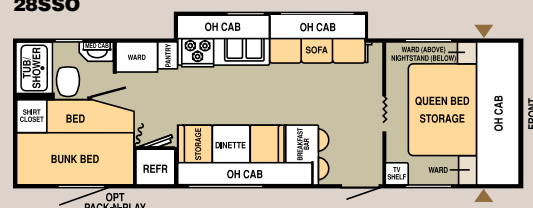

30QBS

Specifications — WEIGHTS, MEASUREMENTS & CAPACITIES

Travel Star Expandables	16RB	18SB	19CK	19SD EXTREME	21SB	21SD EXTREME	21SSD EXTREME	21SSO	23SBS
GVWR (gross vehicle weight rating — lbs.)	3500	3700	5000	7100	5000	7100	7100	5000	5000
UVW (unloaded vehicle weight — approx. lbs.)	2513	2628	3110	4350	3315	4551	4830	3681	3705
HW (hitch weight — approx. lbs.)	268	467	361	457	411	510	614	490	518
CCC (cargo carrying capacity — approx. lbs.)	627	712	1530	2156	1325	1955	1676	959	935
Overall Length (add 11" for opt. spare tire & carrier) — Center of Ball to Bumper	16' 11"	19' 6"	20' 4"	28' 9"	22' 5"	30' 10"	30' 10"	22' 5"	24' 9"
Overall Length — (bunk(s) open)	21' 10"	20' 2"	25' 2"	32' 10"	27' 3"	35' 0"	35' 0"	27' 3"	29' 7"
Body Width	8' 0"	8' 0"	8' 0"	8' 0"	8' 0"	8' 0"	8' 0"	8' 0"	8' 0"
Interior Height	6' 4"	6' 4"	6' 4"	6' 4"	6' 4"	6' 4"	6' 4"	6' 4"	6' 4"
Overall Exterior Height (add 8" for opt. A/C)	9' 0"	9' 0"	9' 0"	9' 4"	9' 0"	9' 4"	9' 4"	9' 0"	9' 0"
Tire Size	ST205/75R 14C	ST205/75R 14C	ST205/75R 14C	LT235/75R 15C	ST205/75R 14C	LT235/75R 15C	LT235/75R 15C	ST205/75R 14C	ST205/75R 14C
Ducted Furnace w/Electronic Ignition	19M BTU	19M BTU	19M BTU	19M BTU	19M BTU	19M BTU	19M BTU	19M BTU	19M BTU
6-Gallon LP Water Heater w/Bypass	X	X	X	X	X	X	X	X	X
Freshwater System w/12-Volt Quiet Pump — Includes Water Heater (approx.)	36 gal. under floor	36 gal. under floor	36 gal. under floor	64 gal. under floor	36 gal. under floor	64 gal. under floor	64 gal. under floor	36 gal. under floor	36 gal. under floor
Gray/Black Holding Tanks (approx.)	27/25 gal.	27/25 gal.	27/25 gal.	27/25 gal.	27/25 gal.	27/25 gal.	27/25 gal.	27/25 gal.	27-27/25 gal.
Double 30# LP Tanks w/Auto Regulator	X	X	X	X	X	X	X	X	X
45-AMP Power Center w/Battery Charger	X	X	X	X	X	X	X	X	X
Straight Axle(s) w/All-Wheel Electric Brakes	1	1	2	2	2	2	2	2	2
Ball Coupler	2 5/16"	2 5/16"	2 5/16"	2 5/16"	2 5/16"	2 5/16"	2 5/16"	2 5/16"	2 5/16"
Sleeping Capacity	6	6	8	8	10	10	8	8	10

Travel Star XLTs	18FB EXTREME	19FB EXTREME	21DBB	21DSD EXTREME	24QB	27RBH	28SSO	30QBS
GVWR (gross vehicle weight rating — lbs.)	7100	7100	5800	7100	5800	7100	7100	7100
UVW (unloaded vehicle weight — approx. lbs.)	3808	4313	3317	4205	3957	4463	5610	5104
HW (hitch weight — approx. lbs.)	438	426	377	681	349	532	553	666
CCC (cargo carrying capacity — approx. lbs.)	2698	2193	2123	2301	1483	2277	1130	1635
Overall Length (add 11" for opt. spare tire & carrier) — Center of Ball to Bumper	21' 11"	21' 11"	22' 8"	30' 9"	26' 0"	29' 1"	31' 0"	31' 11"
Body Width	8' 0"	8' 0"	8' 0"	8' 0"	8' 0"	8' 0"	8' 0"	8' 0"
Interior Height	6' 8"	6' 8"	6' 6"	6' 6"	6' 6"	6' 6"	6' 6"	6' 6"
Overall Exterior Height (add 8" for opt. A/C)	9' 4"	9' 4"	9' 3"	9' 7"	9' 3"	9' 3"	9' 6"	9' 6"
Tire Size	ST205/75R 14C	ST205/75R 14C	ST205/75R 14C	LT235/75R 15C	ST205/75R 14C	ST205/75R 14C	ST205/75R 14C	ST205/75R 14C
Ducted Furnace w/Electronic Ignition	19M BTU	19M BTU	19M BTU	19M BTU	19M BTU	19M BTU	19M BTU	19M BTU
6-Gallon LP Water Heater w/Bypass	X	X	X	X	X	X	X	X
Freshwater System w/12-Volt Quiet Pump — Includes Water Heater (approx.)	64 gal. under floor	64 gal. under floor	36 gal. under floor	64 gal. under floor	36 gal. under floor	36 gal. under floor	36 gal. under floor	36 gal. under floor
Gray/Black Holding Tanks (approx.)	35/26 gal.	35/26 gal.	26/26 gal.	26/26 gal.	26/30 gal.	26/26 gal.	30-35/30 gal.	26/26 gal.
Double 30# LP Tanks w/Auto Regulator & Cover	X	X	X	X	X	X	X	X
45-AMP Power Center w/Battery Charger	X	X	X	X	X	X	X	X
Straight Axle(s) w/All-Wheel Electric Brakes	2	2	2	2	2	2	2	2
Ball Coupler	2 5/16"	2 5/16"	2 5/16"	2 5/16"	2 5/16"	2 5/16"	2 5/16"	2 5/16"
Sleeping Capacity	4	4	5	5	6	9	8	9

GVWR — Gross Vehicle Weight Rating
The maximum permissible weight of the trailer when fully loaded with all systems filled. It includes all weight at the trailer axle(s) plus hitch.

UVW — Unloaded Vehicle Weight
Sometimes referred to as the Gross Vehicle Weight or Curb Weight, the UVW is the dry weight of the trailer as manufactured at the factory. It includes all weight at the trailer axle(s) plus hitch.

HW — Hitch Weight
Hitch Weight represents the portion of the trailer weight that is carried by the tongue to the hitch ball on the tow vehicle.

CCC — Cargo Carrying Capacity
Sometimes referred to as Rated Cargo Load, the CCC is equal to the GVWR minus each of the following: UVW, full fresh water weight (including water heater) plus filled propane tank(s) and battery weight.

TRAVEL STAR EXPANDABLE OPTIONS

Green Leaf w/Sierra Maple Décor
Copper Spice w/Sierra Maple Décor
Slate Blue w/Sierra Maple Décor
Convenience Package: Privacy Drape(s), LP Tank Cover, Monitor Panel, Sink Cover, Sand Pads
Program Package: A&E Systems Awning, TV Antenna, Spare Tire w/Cover & Carrier, AM/FM/CD Stereo w/Outside Speakers & iPod®/Mp3 Adapter, Skylight over Shower in Bath
Comfort Package: Dometic® Microwave, Outside Shower, Gas/Electric DSI Water Heater

13.5M-BTU Duo-Therm™ Air Conditioner
Aluminum Wheels
Oven
Carryout Gas Grill
Bunk Fan Light
Second Bunk Fan Light
Third Bunk Fan Light (21SB, 21SD, 23SBS)
Cathedral Wood Refrigerator Panels
Clip-On Bumper Cover
Tinted Safety Glass Windows
15" LCD TV & DVD Player
Slideout Topper(s) (21SSD, 21SSO, 23SBS)
Fuel Station with 18 gallon Gasoline Tank (21SD; standard on the 19FB)

TRAVEL STAR XLT OPTIONS

Green Leaf w/Sierra Maple Décor
Copper Spice w/Sierra Maple Décor
Slate Blue w/Sierra Maple Décor
Program Package: A&E Systems Awning, TV Antenna, Spare Tire w/Cover & Carrier (spare tire cover- n/a on the 18FB & 19FB), AM/FM/CD Stereo w/Outside Speakers & iPod®/Mp3 Adapter
Ducted 13.5M-BTU Duo-Therm™ Air Conditioner (21DBB & 21DSD non-ducted)
Carryout Gas Grill
Slideout Topper — Bunk Beds (28SSO)
Dometic® Microwave
Gas/Electric DSI Water Heater

Front Window w/Rock Guard (21DBB, 21DSD)
Pack-N-Play Door (21DBB, 21DSD, 27RBH, 30QBS)
Cathedral Wood Refrigerator Panels
Rollover Sofa in Bunk Slideout (28SSO)
Aluminum Wheels
Tinted Safety Glass Windows
Clip-On Bumper Cover
Exterior Storage Drawer
15" LCD TV & DVD Player
Outside Shower
Slideout Topper (30QBS)
Slideout Topper — Dinette/Sofa (28SSO)

STARCRAFT®

2008 Travel Star Travel Trailers



Black appliances add contrast and distinction to Travel Star kitchens.



The top of this roomy storage cabinet (some models) doubles as a TV shelf.



Pass-through storage allows you to easily store all sorts of gear.



Talk about extreme! This versatile front cargo area allows you to include all sorts of toys (21SD shown).

Warranty

Info.*

- 1-Year Hitch-to-Bumper
- 7-Year Aqualon®-7 Tent (expandables)
- 12-Year Roof Covering
- 2- and/or 3-Year Appliances

*Refer to Actual Warranty Information for Details.

décor

Décor Key:

- A** – Dinette, Sofa & Hard Valance
- B** – Bedspread & Bunk Valance
- C** – Window & Privacy Drape
- D** – Bunk Mat
- E** – Bunk Valance
- F** – Bedspread; Window & Privacy Drape

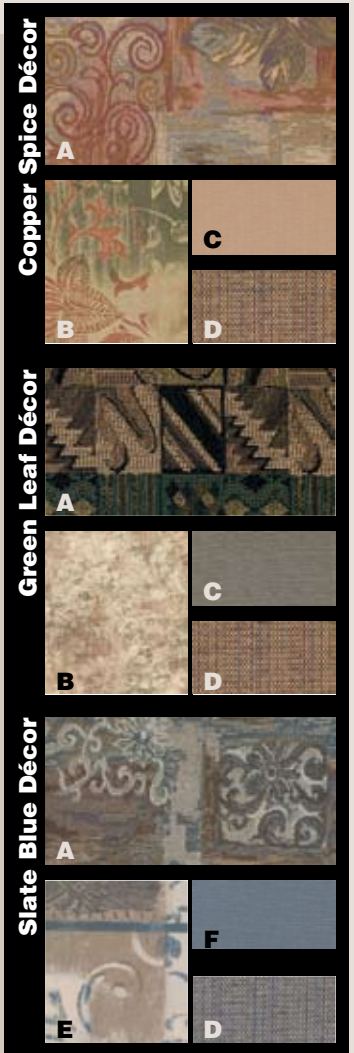

Join

the Starcraft

Camper Club...

When you purchase a new Travel Star Travel Trailer, you'll receive a free one-year membership to the Starcraft Camper Club, a camping group of Starcraft owners. Our club offers you the friendship and security of caravan-style travel at lower group rates. Organized trips and gatherings are held throughout the year and detailed in the club's quarterly publication, Chatter. Participating in the Starcraft Camper Club is a great way to develop friendships with people who have the same interests and share your love of RVing.

Go RVing®

Colton RV
3122 Niagara Falls Blvd.
North Tonawanda, NY 14120
(716) 694-0188
(800) 628-4889
www.ColtonRV.com

Colton RV
3443 Southwestern Blvd.
Orchard Park, NY 14127
(716) 957-3250
(800) 628-4889
www.ColtonRV.com



Be sure to visit our website at www.starcraftrv.com for the latest product updates and floorplans, additional in-depth specs and information, and to locate your nearest dealer.

©2007 Starcraft RV, Inc. • P.O. Box 458 • Topeka, IN 46571 • (260) 593-2550
Due to constant product improvements, Starcraft RV, Inc. reserves the right to make changes, including (but not limited to) equipment, accessories, colors and prices without further notice or obligation. Some equipment shown separately, or on product illustrated in this catalog, may be optional at extra cost.