

# Freelander™

2005 Class C Motorhomes By Coachmen



# Coachmen®

Recreational Vehicles

*Leader to the Great Outdoors®*



# Freelander™

## Made for your enjoyment

The Freelander™ by Coachmen sets the standard for quality, features and amenities in a Class C motorhome. Freelander's approach is simple, adhere to a high standard of construction and produce the best value in a Class C available today and into the future. The Coachmen Freelander provides all the options, features and amenities to exceed your camping expectations.

In a Freelander™ Class C Motorhome by Coachmen, there is no need to rush or worry about reservations. There is always a meal and a comfortable bed at the end of the day. Your agenda and destination is whatever and wherever you want it to be, thanks to the convenience and affordability of the Freelander.



*(Shown in Princeton Pine decor with Monterey Haze cabinetry.)*

### Decor Selections

*Dazzling interiors feature skillfully coordinated upholstery and window treatments. Coachmen RV chooses only top-grade fabrics wear-dated as heavy-duty. These fabrics have been tested for durability beyond 15,000 double rubs (in and out action) to simulate heavy usage. An average chair in an American home is subjected to only 3,000 double rubs per year.*

**Fabric Key: A. Main B. Accent C. Bedspread**

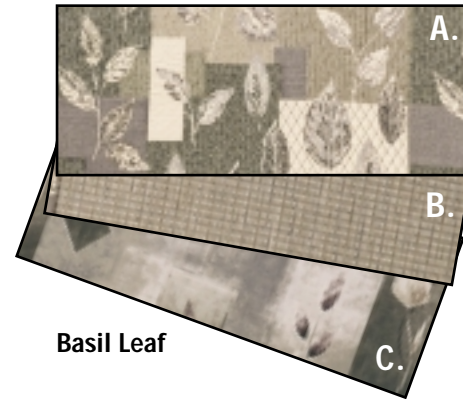

**Basil Leaf**

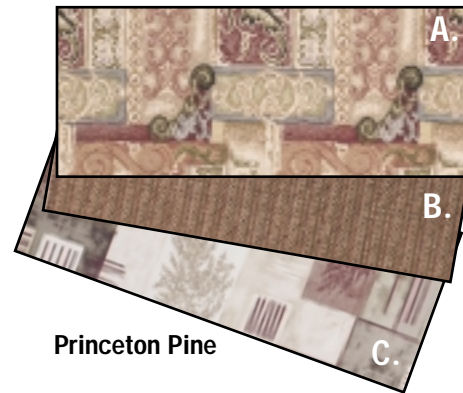

**Princeton Pine**

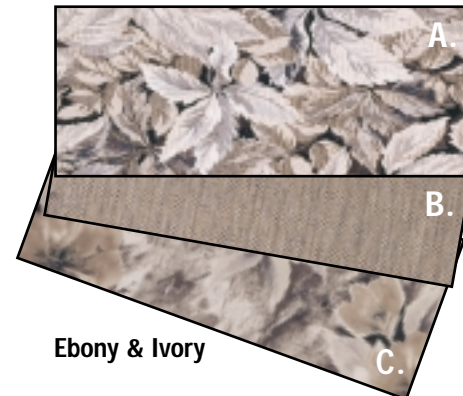

**Ebony & Ivory**







*The interior of the Freelande 3150SS is extremely spacious with the generous sofa and dinette slideroom. The Freelande is also loaded with valuable features such as self edged countertops, high spout faucet, under sink silverware drawer, designer window treatments and a tall 6'10" interior ceiling height. (Shown in Ebony & Ivory decor with Ashland Oak cabinetry)*

# Freelande™

2005 Class C Motorhomes By Coachmen



# Freelander™ Features Galore

Discover Freelander™ Class C Motorhomes by Coachmen, and see the outstanding value and safety that is designed into every coach. These affordable, value packed coaches have features galore to enhance your RV'ing experience. It is sometimes the things you can't see like our **SureLine™** Electrical Harness and **Duratube** LP lines that set us apart from the crowd, while other times it is the items that are easily visible. Take a minute to see just a few of the benefits that set us apart from the rest.



*The deluxe overhead entertainment center option features a 27" flatscreen television, DVD/VCR combo and large angled cabinet storage.*



*The optional cabover entertainment center offers a 24" flatscreen television, DVD/VCR combo and plenty of additional space for a full size adult to sleep.*



*While the law requires enough seat belts to equal the number of sleeping positions, Coachmen knows that any seating location is fair game while traveling. That's why we have put seat belts at most fixed seating locations. All of our seat belts meet the FMVSS standards as stated by the government.*



*This optional AM/FM stereo complete with cassette, CD player, and built in weather band was specifically designed for use in RV's. The large, easy to use buttons and knobs let you keep your eyes on the road rather than on the radio.*



Our standard metal drawer guides with glide wheels provide a friction free sliding drawer that is extremely durable. The drawer guides also act as a catch so that the drawer will not slide open during travel. Simply lift up and pull to open the drawers.



The handy cockpit convenience area features room for 2 large drinks, \$.05, \$.10, and \$.25 change holder, and extra miscellaneous storage for your essentials like sunglasses, road maps and tissues.



The Freelanders 2600WB features an impressive cathedral picture window, that provides an expansive view of your surroundings.



**SAFETY FIRST**

The optional Ride Rite® Air Assist Suspension lets you adjust your rig for a smooth level ride. Air assist helps to prevent uneven tire wear and provides for safer travel.



Get a better picture and more channels with the optional Satellite TV dish.



The optional Fantastic Fan™ with variable speed control, is quiet, yet powerful enough to keep fresh air circulating throughout the coach.



All Coachmen Class C Motorhomes feature a raised departure angle for greater ground clearance at the rear of the coach.

**Freelanders™**  
 2005 CLASS C Motorhomes By Coachmen



# Freelander™ Features Galore continued

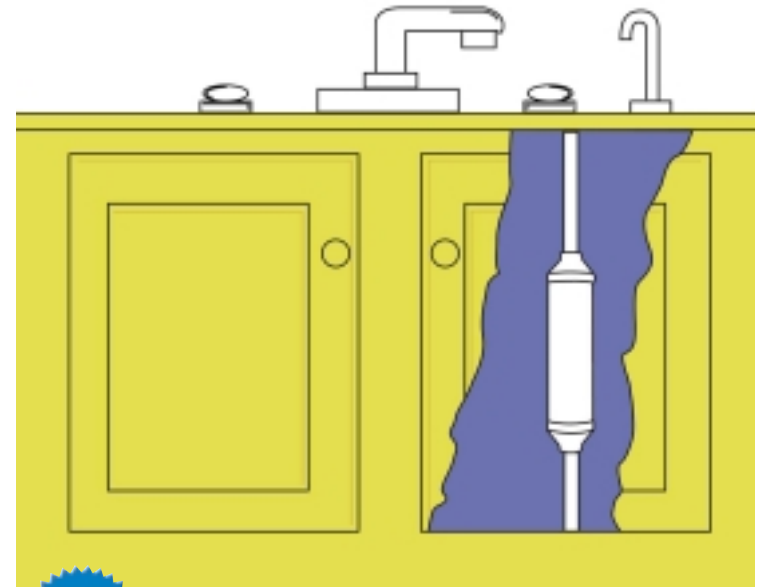

*The optional water purifier significantly reduces the number of bacteria in the water, which results in safer, cleaner and better tasting water. There is also a dedicated drinking faucet available for great tasting water.*



*The Freelander™ 2600SO boasts a huge rear storage bay with three large access doors. Recessed molded storage areas provide additional covered space for some of your smaller items.*

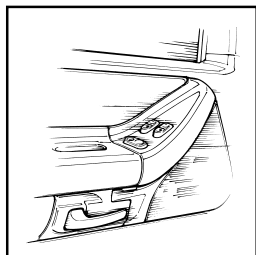

*Standard power windows and door locks are a comfort you don't have to go without. The large push button controls are conveniently located on the cockpit door arm rests for both the passenger and the driver.*



*The deluxe glass shower enclosure provides an easy to clean glass surface that gives a sophisticated residential look to the bath area..*



*The Flair-It™ water line system uses radius bends to reduce the number of fittings used (approximately 56% less). Where connectors are needed, a compression fitting ensures a long term, tight seal.*



*Jalousie bedroom windows tilt out design allows them to be opened for ventilation even when the weather outside is less than favorable. Just because the rain keeps you inside, doesn't mean that you can't enjoy the fresh air outside.*



The optional **Grill-2-Go™** is the ultimate grilling machine. Lightweight, durable and extremely functional, this grill was designed to give you the opportunity to grill any time and anywhere. (Select Models)



**SAFETY FIRST** All Coachmen Motorhomes come standard with an LP leak detector, fire extinguisher, smoke detector and carbon monoxide detector for your safety.

## Ask your dealer about these Coachmen exclusive design features



**SAFETY FIRST**

**Coachmen's SureLine Electrical Harness™** provides color coded wiring and specific wiring schematics for easy serviceability. High quality automotive electrical connectors and autoloom protective covering make for a reliable and durable harness. The wires are grouped together and neatly tucked into the framework under the coach, safe from road debris.



The **Coachmen Even Cool™** air conditioning system is ducted through the crowned, vacuumbonded roof and utilizes AMOCO insulated ductwork with radiused corners to provide for maximum cooling efficiency.



All Coachmen Motorhomes utilize **DurAtube™** full length copper LP lines with double flared ends to ensure a tight seal and years of corrosion free use. Coachmen builds quality for the long haul.



**STOW-N-GO** The large **Stow-N-Go garage door** easily opens with the assistance of 2 gas struts. Inside is cavernous storage with convenient shelving and pegboard to keep your items organized. (Select Models)



**Water Works™** **UTILITY PANEL**

It doesn't have to be a weekend project figuring out how to fill, drain, or winterize your RV. Our easy to use **Water Works Utility Panel™** with large dials, simply displays how to perform each function. No lengthy explanations or wordy booklets are necessary.

**Freelander™**  
 2005 CLASS C Motorhomes By Coachmen



# Freelander™ FLOORPLANS

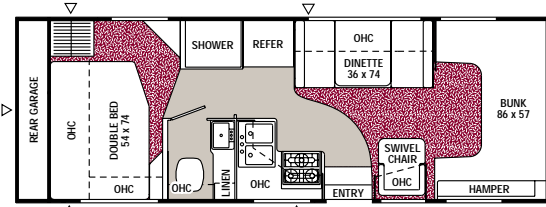

**2400WB**  
Available with options: A, B, C

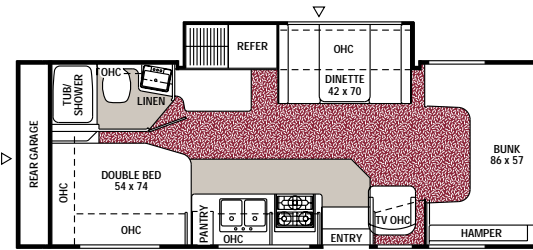

**2490SO**  
Available with options: A, B

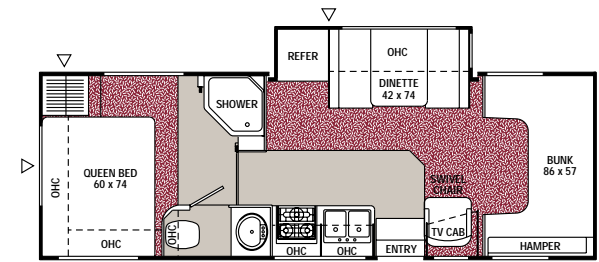

**2600SO**  
Available with options: A, B

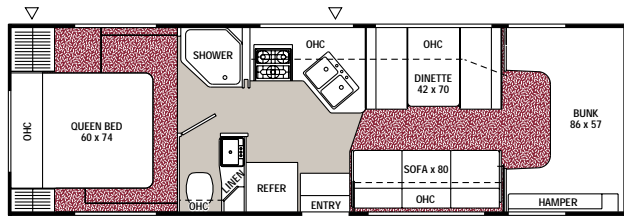

**2890QB**  
Available with options: A, B

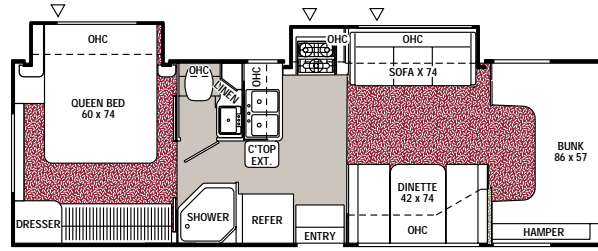

**2920DS**  
Available with options: A, B

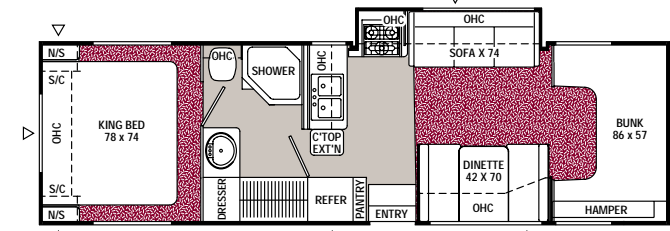

**3100SO**  
Available with options: A, B, D

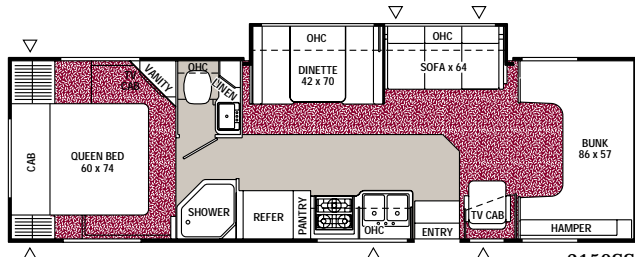

**3150SS**  
Available with options: A, B

## Options Key:

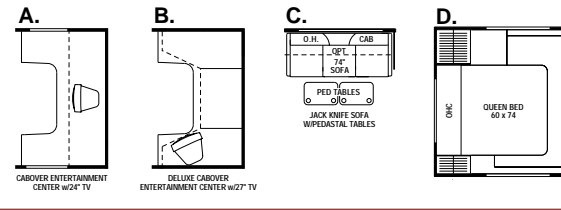

■ INDICATES CARPETING    ▲ INDICATES OUTSIDE STORAGE LOCATION



## Quality by Design

Coachmen RV is committed to providing a high quality, reliable, and innovative product. That's why Coachmen designs quality into our products up-front, through computer aided design and analysis software. This helps to assure appropriate weight distributions, structural integrity, alignment of the various parts and components and overall reliability of the design. Our attention to quality does not stop on the computer screen as all of our major product designs undergo rigorous road tests, rain booth testing, complete compliance audits for all codes, standards and safety related items, and comprehensive product audits. Coachmen designs, builds and markets a superior product for reasons that may not always be easy to see, however, are very easy to appreciate down the road. Our quality equates to high value, which can be critical to your long-term satisfaction.



LIFE IN THE FAST LANE  
NASCAR driver Mike Wallace makes a Coachmen RV motorhome his home on the road. The middle brother of auto racing's famed Wallace family, Mike is a veteran of NASCAR's racing circuit.



# Freelander™

2005 Class C Motorhomes By Coachmen

Specifications	2400WB	2490SO	2600SO	2890QB	2920DS	3100SO	3150SS
Chassis	FORD	FORD	FORD	FORD	FORD	FORD	FORD
Chassis Model	E-45	E-45	E-45	E-45	E-45	E-45	E-45
Engine Size (liter)	6.8L	6.8L	6.8L	6.8L	6.8L	6.8L	6.8L
Wheel Base	158"	170"	208"	208"	208"	208"	208"
Rear Axle Ratio	4.63	4.63	4.63	4.63	4.63	4.63	4.63
Tire Size	(1)	(1)	(1)	(1)	(1)	(1)	(1)
GVWR (Pounds)	14,050	14,050	14,050	14,050	14,050	14,050	14,050
CW (Pounds)	9,958†	10,213	10,523	10,167†	10,969†	11,179	11,058
GAWR Front (Pounds)	4,600	4,600	4,600	4,600	4,600	4,600	4,600
GAWR Rear (Pounds)	9,450	9,450	9,450	9,450	9,450	9,450	9,450
GCWR (Pounds)	20,000	20,000	20,000	20,000	20,000	20,000	20,000
Exterior Length	26'8"	25'10"	27'8"	29'6"	29'	31'	30'6"
Exterior Height*	11'2"	11'2"	11'2"	11'2"	11'2"	11'2"	11'2"
Exterior Width	8'4"	8'4"	8'4"	8'4"	8'4"	8'4"	8'4"
Sleeping Capacity**	5	5	5	6	6	6	6
Interior Width	8'	8'	8'	8'	8'	8'	8'
Interior Height	6'10½"	6'10½"	6'10½"	6'10½"	6'10½"	6'10½"	6'10½"
Fuel Capacity (gal.)	55	55	55	55	55	55	55
Alternator Amps	130	130	130	130	130	130	130
Fresh Water Capacity (gal.)	37	50	31	50	30	54	40
Waste Water Capacity (gal.)	29	27	29	28	28	28	28
Grey Water Capacity (gal.)	28	35	29	27	27	27	27
Water Heater Capacity (gal.)	6	6	6	6	6	6	6
LP Gas Capacity (lbs.)	68	68	68	68	68	68	68
Furnace Rating (x 1000) BTU	30	30	30	30	30	30	30

† Estimated \* Includes clearance for A/C Tire Sizes = (1) LT225/75R16E \*\*Front entertainment center options delete one or two sleeping positions.

**GVWR (Gross Vehicle Weight Rating):** The maximum permissible weight of the unit, including the UVW plus all fluids, cargo, optional equipment and accessories. For safety and product performance, do not exceed the GVWR.

**CW (Curb Weight):** The weight of the unit without factory or dealer installed options, plus allowance for the weight of full fuel capacity. The "payload capacity" for all other fluids, cargo, occupants, optional equipment and accessories can be determined by subtracting the CW from the GVWR.

**GAWR (Gross Axle Weight Rating):** The total weight each front/rear axle, suspension and tire system is designed to carry. When loading the unit, care should be taken to balance cargo weight in consideration of the GAWRs.

**GCWR (Gross Combined Weight Rating):** The maximum total weight of the loaded unit, plus a tow vehicle. This includes the weight of both the unit and tow vehicle, fuel for each, all other fluids, cargo, occupants, optional equipment and accessories.

**Wider Widths:** Numerous Coachmen floorplans feature the "wide body" design concept, which gives you significantly enhanced interior living space and innovative floorplans. In making your purchase decision, you should be aware that a few states restrict access on some or all roads within the state to vehicle with a maximum 96" width, although special road usage permits may be available. Vehicles up to 102" in width are permitted in the vast majority of states. You should confirm the road usage laws in the states of interest to you before making your purchase decision. If width is of concern to you, we invite you to consider the broad array of other Coachmen models offered in the standard 96" width.

**IMPORTANT NOTE:** All capacities are approximate, and all dimensions are nominal. Coachmen motorhomes are designed to allow for a wide variety of uses, extended trips with two people or short trips with multiple people. Accordingly, each unit allows ample room for sleeping, seating, fluids and cargo. While the customer is the beneficiary of this design, the customer also bears the responsibility to select the proper combination of passengers, cargo, load, and tow vehicle without exceeding the chassis weight capabilities. Consumer may need additional braking capacity to tow loads greater than 1,000 pounds.

Seat belts should always be worn for passenger safety. Seat belts are provided at most locations to allow convenience in selecting which seat to occupy. However, it is not intended that all seating positions equipped with a seat belt may be occupied while the vehicle is in motion, without regard to other weight factors. All Coachmen motorhomes are designed to ensure that the number of passengers allowed while the vehicle is in motion will always at least equal the stated sleeping capacity. Though extra seat belts may be provided, for your safety and the proper operation of your vehicle, limit your passengers to the number allowed by the Net Carrying Capacity of your vehicle.

*All information contained in this brochure is believed to be accurate at the time of publication. However, during the model year, it may be necessary to make revisions and Coachmen reserves the right to make all such changes without notice, including changes in prices, colors, materials, equipment and specifications, as well as the addition of new models and the discontinuance of models shown in this brochure. Therefore, please consult with your Coachmen dealer and confirm the existence of any materials, design or specifications that are material to your purchase decision.*

# Freelander™ STANDARDS & OPTIONS

## Standard Features

### INTERIOR APPOINTMENTS

- Ashland Oak Cabinetry
- Residential Metal Drawer Guides
- Techwood® Drawer Sides
- Linoleum Flooring (Kitchen & Bath)
- Carpet w/Pad (Bed & Living)
- Mini Blinds Throughout
- Radius Jalousie Windows-Safety Glass (Bedrooms)
- Radius Slider Windows-Safety Glass (Coach)
- Jack Knife Sofa (Except 2400WB, 2490SO)
- Booth Dinette
- Reclining Pilot & Passenger Seats

### INTERIOR EQUIPMENT

- AM/FM Stereo w/CD Player and Four Speakers
- TV Antenna and Rotor Package
- Cable Jack(s)
- Prewired for Satellite Dish
- LP Leak Alarm
- Smoke Detector
- Carbon Monoxide Detector
- Fire Extinguisher

### GALLEY

- Residential Size Microwave
- 3-Burner (High Output) Range Top w/Pots & Pans Drawer

- Power, Lighted Range Hood
- Double Door Refrigerator
- Freezer Shelf & Refrigerator Light
- Monitor Panel
- Pull Out Pantry (3150SS)
- Stainless Steel Kitchen Sink
- Silverware Tray

### SLEEPING

- Queen Bed (2890QB, 2920DS, 3150SS)
- King Bed (3100SO)
- Corner Double Bed (2400WB, 2490SO)
- Corner Queen Bed (2600SO)
- Cabover Bunk
- Deluxe Innerspring Mattress-312 Coil
- Bedspread & Pillow Shams
- Privacy Drape - Lower Cab
- Accordion Privacy Door- Bedroom (Except 2490SO, 3100SO)
- Privacy Drape - Bedroom (2490SO)
- Privacy Door - Bedroom (3100SO)

### ELECTRICAL/HEATING/ AIR CONDITIONING

- 30 Amp Power Cord
- 55 Amp Electronic Converter
- GFI Circuit
- Auxiliary Battery
- Outside 120V Receptacle

- Generator Ready
- Patio Light
- 30,000 BTU E.I. Furnace
- Wall Mounted Thermostat
- 13,500 BTU Ducted Roof Air Conditioner

### BATH AND WATER

- Power Bath Vent
- One-Piece ABS Tub Surround
- Glass Shower Enclosure
- 6-Gallon E.I. Water Heater
- Demand Water Pump
- Lavatory Sink
- Towel Bar
- Medicine Cabinet
- Skylight

### AUTOMOTIVE/EXTERIOR

- 55-Gallon Fuel Tank
- Dual Air Bags
- Deluxe Chassis Package
- Cruise Control
- Tilt Steering Wheel
- Power Windows and Locks
- Dash Air Conditioning
- Chrome Front Bumper
- Radial Tires
- Full Metal Wheel Covers

- Laminated, Floor & 2" Sidewalls
- Crowned Laminated Rubber Roof
- Roof Ladder (2600SO & up)
- Aluminum Running Boards
- Single Entrance Step
- Rubber Entry Step Tread
- Dead Bolt Lock Entrance Door
- Warehouse Storage (except 2490SO, 2920DS)
- Radius Entry Door
- Patio Awning
- Stow-N-Go™ Rear Garage Storage (2400WB, 2490SO)
- Rear Bumper w/Stabilizer Jacks (Slide Models)



## Optional Equipment

### □ Deluxe Package - Includes:

- Phone Jack
- 3-Burner (High Output) Range w/Oven
- Emergency Start Switch
- Coach Battery Disconnect
- Upgraded Mirrors
- Hitch
- Owner's Information Package
- Premier Package - Includes:
- Deluxe Package Items plus:
- Outside Shower
- Night Shades - Throughout
- Fantastic Three-Speed Roof Vent
- Range Cover
- Water Purifier
- Dedicated Drinking Faucet

- Monterey Haze Cabinetry
- Jack Knife Sofa w/Pedestal Table (2400WB)
- Sofa w/Out Arms (2920DS, 3100SO)
- Front Cabover Entertainment center ( 24" Flatscreen Television & DVD/VCR Combo)
- Deluxe Front Cabover Entertainment Center (27" Flatscreen Television & DVD/VCR Combo)
- Coach Entertainment Center (Roadstar TV Antenna, Television, DVD/VCR Combo & Wireless Headphones)
- DVD/VCR Combination
- Satellite TV System
- 20" Flat Screen TV - Coach (N/A with Front Entertainment Center)
- Deluxe AM/FM Stereo w/Cassette, CD Player and Weatherband

- Grill-2-Go™ (2400WB, 2490SO)
- Privacy Drape Cabover
- Queen Bed (3100SO)
- Front Cabover Window
- Tinted Windows
- 3.6 KW LP Vapor Generator (Diesel Only)
- 4.0 KW Gas Generator (Onan)
- 4.0 KW Gas Generator (Generac)
- Power Entrance Step
- Stainless Steel Wheel Inserts
- Spare Tire
- Air Assist Suspension
- Rear Bumper With Stabilizer Jacks (2400WB, 2890QB)
- Painted Skirt

- Slide-Out Room Awning-Coach (Slideout Models)
- Slide-Out Room Awning Bedroom (2920DS)
- Electric Heated Holding Tanks
- 6-Gallon Gas/Electric E.I. Water Heater
- Dual Auxiliary Batteries
- 6.0L Diesel Engine - Ford (2400WB, 2490WB, 2600SO, 2890QB)
- CSA Upfit



# CONSTRUCTION



## Additional Value Added Construction Features:



- Our **Water Works™** Utility Panel makes filling tanks and draining water lines easy.
- **Heat reflectors** are installed over the exhaust system to reduce heat inside the coach.
- **Two year structural and major components warranty**, along with the industry's leading full one-year Coachmen Buckstopper™ Warranty assures peace of mind.
- Every motorhome is **tested for leaks** in a simulated rain storm created by a rain test lab within the manufacturing plant



- **Duratube™** copper LP lines ensure a tight seal and years of corrosion free use.

## Take a Closer Look at Coachmen Quality & Construction

- 1** Tubular aluminum cage construction of our roof and sidewalls provide great strength without adding unnecessary top-heavy weight - this improves handling and fuel efficiency.
- 2** All cabinets and tables are mounted to **electro galvanized steel backers** in the sidewalls to stay securely in place.
- 3** Our **2" sidewalls** are one of the thickest in the Industry. We bond the wall using reactive hot melt urethane lamination with one piece fiberglass, high-grade Lauan backer, block foam insulation, tubular aluminum framing and an interior panel. This provides superior strength and durability.
- 4** **Jalousie and slider windows** are combined to offer optimal viewing and ventilation in all weather conditions.
- 5** We **insulate around every refrigerator** to improve operating efficiency and prolong the trouble free life of the refrigerator.
- 6** **Warehouse storage space** has been added wherever possible for maximum storage.
- 7** **Tubular steel floor framing** provides strength and structural integrity.
- 8** All **storage areas are water tight sealed** to keep the elements out and your stored gear dry.
- 9** **Power windows and door locks** are standard features on all Freelanders.
- 10** We replaced all the trim parts with **internal sealants** to create a clean, easy to maintain chassis to upfit attachment.
- 11** We will not build a motorhome with a flat roof! All **roofs are vacuumbond laminated with a crown** for controlled water run-off and additional strength.
- 12** The roofs are covered with **seamless, industrial grade rubber**. All roof openings are sealed with butyl rubber based sealants that expand and contract with the climate to help prevent leaks.
- 13** Coachmen's **Even Cool™ ducted roof air conditioning** provides quiet, cool air that easily distributes through the entire motorhome through baffled ducting.



2005 CLASS C Motorhomes By Coachmen  
**Freelanders™**

## Discover the Coachmen Advantages

### **Service After the Sale**

**Industry Leading Buckstopper™ Warranty –** Coachmen's exclusive Buckstopper™ Limited Warranty provides one-year coverage on most parts, components and appliances. Coachmen stands behind their product and is supported by a network of over 300 service centers.

**Two Year Structural & Major Components Manufacturer's Warranty –** Coachmen provides a two-year structural and major components manufacturer's warranty, along with a complete written Warranty Summary Guide, for your peace of mind.

**Comprehensive Owner's Information –** For your convenience we offer published materials on key equipment and options, as well as information pertaining to the function of important components. We also offer a true **Trouble Shooting and Maintenance Guide** for the simple answers to frequently asked questions.



**Toll Free Service Numbers –** Our toll free phone numbers provide you with direct access to a Coachmen RV Service Representative.

**Dealer Support Tools –** Coachmen makes sure that their dealers are well equipped and trained to service your needs with: Systems Manuals, PDI Manuals, Electronic Parts Catalogs, Coach-Link® "On-Line" Electronic Dealer Communication System and continual service training.

**Service Support Center Web Site –** Coachmen provides you access to key information 24-hours a day through the Internet. On-line you can find a Service Dealer Locator, Maintenance Information, Trouble Shooting Information, Product Warranty Information, Customer "E-Assistance", Frequently Asked Questions (FAQ's) and Publications ordering, dating back to 1972 models.

**Priority Parts Ordering –** Coachmen provides a program for overnight parts shipment in critical repair situations.



Coachmen Recreational Vehicle Company, LLC  
P.O. Box 30, Middlebury, IN 46540  
P.O. Box 948, Fitzgerald, GA 31750

Visit our website at: [www.coachmenrv.com](http://www.coachmenrv.com)

©2004 Coachmen Recreational Vehicle Company, LLC -  
All rights reserved. Litho in USA 7/04

### **Coachmen Caravan Camping Club™**

Coachmen Caravan Camping Club is your ticket to making friends for life. Share old stories and make new, in the company of fellow Coachmen Caravan members. With the purchase of a Coachmen RV, you are invited to join the nation's largest manufacturer sponsored RV club with a **FREE 1st year basic membership or discounted Platinum membership**. As part of the Coachmen Caravan family, you will receive incredible membership benefits that will help to ensure your safety and enjoyment throughout your RV experiences. Enjoy your Coachmen RV more with the Coachmen Caravan Camping Club.



### **Leader to the Great Outdoors®**

Coachmen RV Company is a proven leader in the RV Industry with 40 years of experience. We are dedicated to providing a high quality, reliable and innovative product, backed by high quality service support. Our mission is simple...to meet and exceed your expectations and to make your total RV experiences memorable and enjoyable!



**Coachmen RV Company... A Great Product,  
A Great Company, A Great Name!  
Coachmen RV Company... Leader to the  
Great Outdoors**

Colton RV  
North Tonawanda, NY 14120  
(716) 694-0188  
(800) 628-4889  
[www.ColtonRV.com](http://www.ColtonRV.com)

Colton RV  
Orchard Park, NY 14127  
(716) 957-3250  
(800) 628-4889  
[www.ColtonRV.com](http://www.ColtonRV.com)

