

NORTHWEST EDITION



360° OF  
ADVENTURE







1/2 Barrel Hidden Storage. Wildwood products are designed with a focus on storage.



AN ELEGANT BUNK MODEL

WILDWOOD  
**T27DBUD**

SHOWN IN TIFFANY LEATHER DÉCOR

**6,098 LB.**

Shown with Standard Beauflor®  
Plank Wood Linoleum & Optional TV

## Discover the best buy

### MORE FOR YOUR DOLLAR

The 27DBUD and all the Wildwood models offer more perceived value. With phenomenal market share growth over the last 6 years the Wildwood has become the buyers choice. The beautiful interiors are one reason. Our attention to details like the kitchen countertop, slide-out treatments, cabinet storage, window appointments, wood grain linoleum, bed-spreads, shower curtains, and the finishes on appliances, cabinets and hardware, show our commitment to quality. See for yourself. You'll notice the Wildwood is the best on the market.

- 1 Wildwood master bedroom includes solid doors (not drapes), which are excellent for privacy, and give access to the entertainment center TV. (Most models)
- 2 This shows one of the popular locations for a bedroom TV on the 27DBUD and other models.
- 3 An extra large 20" x 30" compartment door is standard on most Wildwood products (Per floorplan)
- 4 Shown are the 2 rear double beds in a 27DBUD model Wildwood



Access door for the laundry chute







OPEN LIVING, RECLINERS INCLUDED

WILDWOOD

# T27RKSS

SHOWN IN TIFFANY LEATHER DÉCOR

**6,798 LB.**

*Shown with Standard Beauflor®  
Plank Wood Linoleum*



# We never cut corners.

## COMMITTED TO QUALITY

Wildwood doesn't skimp on windows, drawers, solid interior doors, cabinets or other features. We are committed to manufacturing quality built products.

- 1 Full extension ball bearing drawer guides with cabinet-grade plywood drawer sides.
- 2 Two recliners are standard equipment on the T27RKSS & T27RLSS.
- 3 This upgraded glass radius shower is available on the 21RBS, 23RBS, 25RKS, 27RBSS, 27RKSS and 27RLSS.
- 4 "Double Deep" kitchen overhead cabinets provide a kitchen with the best storage space in the business.
- 5 We have added a new high quality vinyl coated back splash in the kitchen that is wonderfully wrinkle-free and heat-resistant.
- 6 LED lighting is a popular standard feature.
- 7 Recent redesigns have brought more space into the bedroom at the foot of the bed. Our customers love it!





16" x 24" Stained Glass Cabinets and Base Shelves (Where applicable)

New Dhalia Cherry Mouldings and Accents Throughout

LED Lights

Night Shades

Decorative Curtain Rods and Curtains

80" CEILING HEIGHT

WILDWOOD  
**INTERIOR FEATURES**

SOME FEATURES HAVE LIMITED AVAILABILITY

Stainless Steel Appliance Package

LG® Solid Surface Countertops

Full Extension, Extra-Deep Pot and Pan Drawer

Beauflor® Linoleum Scratch, Tear, and Cold, Crack Resistant Flooring





## Popular Features

### MORE REASONS WHY PEOPLE CHOOSE WILDWOOD OVER OTHER BRANDS

1. Solid Surface Countertops with Undermount Sink
2. Hinged 1/2 Barrel Storage (Most Models)
3. High Rise Faucet and 60/40 Sink
4. Extra Large Pass-Through Storage
5. Beauflor® One Piece Plank Wood Linoleum Flooring
6. Full Extension Ball Bearing Drawer Guides
7. FM Radio, DVD Player w/ MP3 Hookup (Limited Time Options\*)
8. Free Standing Gas Grill (Outside Kitchen Models Only)
9. Swivel Entertainment Center with Solid Doors to Bedroom (Shown with Customer-supplied TV)
10. 16" x 24" Stained Glass Cabinets and Base Shelves (Where applicable)
11. LED Awning Lights
12. Shoe Nook (Most Models)
13. Aerodynamic Front Profile



WILDWOOD

# CONSTRUCTION

- 1 Radius entry Steps
- 2 2" x 3" floor joists 12" on center
- 3 2" wall studs 16" or less on center
- 4 30" fiberglass radius entry door
- 5 .024 aluminum siding
- 6 5" bowed truss roof rafters
- 7 One piece seamless roof (12 yr. warranty)
- 8 R-7 fiberglass insulation throughout
- 9 Extra large full pass-thru storage w/ 20" x 30" Door (per floorplan)
- 10 Smooth rolled skirting
- 11 In floor ducted heat
- 12 Diamond plate rockguard
- 13 3/8" roof decking (full walk-on roof)
- 14 LP bottle cover w/ easy access
- 15 13.5K ducted roof, high output AC w/ quick cool
- 16 Hitch light
- 17 Stain resistant carpet
- 18 One piece plank wood linoleum flooring
- 19 Safety glass windows

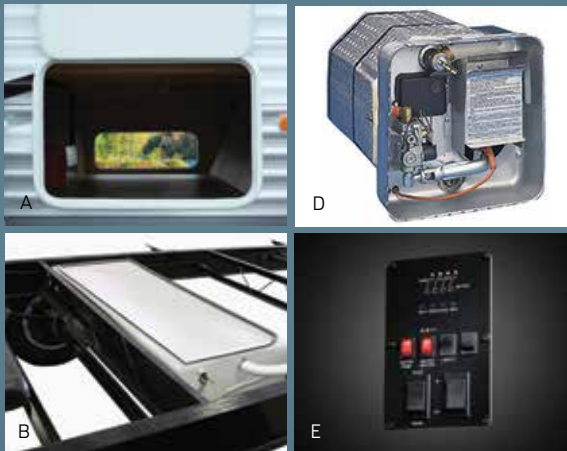

## FORM FOLLOWS FUNCTION.

At Wildwood your satisfaction is serious business and it shows. Our commitment to your satisfaction includes:

- A. Extra large pass-thru storage
- B. Heated and enclosed fresh water tank
- C. 6 gallon Gas/Electric DSI water heater with Quick Recovery
- D. New Centralized Command Center



# STANDARDS & OPTIONS

## CONSTRUCTION & EXTERIOR

- **One-piece 5/8" DynaSpan® flooring with a minimum 25 year warranty**
- Dicor Diflex II™ TPO roofing with limited 12 year warranty
- Extra large full pass through storage (per floorplan)
- Cold crack and mildew resistant vinyl patio awning
- Safety glass windows
- **Metal framed 30" smooth radius corner fiberglass main entry door**
- Cambered chassis
- **Enclosed fresh water tank in a heated compartment**
- 16-gal. per hour **Gas/Electric** quick recovery DSI water heater
- Water heater by-pass
- 2" wall construction, 16" (or less) on center
- R-7 fiberglass insulation throughout
- 13 ply cross micro-laminated beam header above slide out
- **Triple seal slide out system**
- Electric slide out systems (flush floor)
- Swing arm entry assist handle
- Two marine grade exterior speakers
- Electric front jacks (fifth wheels)
- **Aerodynamic front radius**
- Smooth aluminum front cap

## KITCHEN

- Dometic® double door refrigerator (2 yr. warranty)
- High rise faucet
- Undermount style sink
- Stainless steel finish microwave w/ carousel
- 3-Burner, high output range with oven (2 yr. warranty) Stainless steel finish on door
- Stainless steel finish range hood w/

- 12-volt exhaust fan and light
- One piece Beauflor® vinyl flooring
- Taller overhead cabinets (kit)
- Wood drawers w/ furniture-grade plywood sides
- Full extension ball bearing drawer guides
- Knife rack (behind cook top)
- **Shelving** in overhead cabinets in kitchen
- Central switch location for command center
- Brushed stainless finish hardware
- Abundant cabinet storage
- **Large pots and pans drawer under dinette**

## LIVING ROOM

- **Recliner or recliners included in one bedroom models**
- 80" interior height in travel trailers
- Ducted 13,500 BTU roof air conditioner w/ quick cool
- **Huge storage drawer under jiffy sofa**
- Booth dinette w/ large storage drawer (most models) (U-shaped dinette, some models)
- Large dinette picture window
- Winegard® antenna with booster
- Standard FM stereo w/ CD/DVD and four cube speakers
- Patio door w/ vertical blinds (36BHBS, 37BHSS2Q, 38RLTS)
- Decorative wall light
- 25K BTU suburban forced air DSI furnace w/ digital thermostat (2 yr. warranty)
- In-floor ducted heat
- Flip TV mount (most models)
- Cable TV hookup living room and bedroom
- **Wall switch controls for ceiling lights at key locations**

## BEDROOM

- Plush comforter and headboard
- **Strut lifted storage area under bed (master bedroom)**
- Bedside mirrored wardrobes w/ shelf above bed
- Bedside 110-volt power outlets (2)
- **Increased space at the foot of the bed (most models)**
- Solid bedroom privacy doors (most models)
- Storage shelf above bed
- Bedside hamper access (most models)

## BATHROOM

- 12-volt power bath roof exhaust vent
- Wooden medicine cabinet w/ mirrored door
- Foot flush toilet
- Tooth brush holder and towel ring
- Vinyl tub surround (neo-angle showers have an enclosure) (select floorplans)
- One-piece slip-resistant Beauflor® vinyl flooring

## SECURITY AND SAFETY

- LP leak detector
- Smoke detector
- Carbon monoxide detector
- Fire extinguisher
- Hitch light (travel trailers)
- Welded heavy duty safety chains (travel trailers)
- Electric brakes (all wheels)
- GFI receptacles
- ANSI 119.2 certified
- Meets all national highway administration specifications
- RVIA approved product
- Beauflor® vinyl floor with "SafetyGrip"
- Undermount kitchen sink

## WILDWOOD OPTIONS

- Stabilizer jacks [travel trailer (4)]
- Skylight over tub
- 30-lb LP bottles w/ cover and auto change over (travel trailers)
- 12v power four corner stabilizer jacks
- Power awning with LED light
- 15,000 BTU ducted air w/ quick cool
- Remote control for slide outs and power awning
- LG solid surface (Particle-board free) kitchen counter tops
- Undermount sink
- Electric front jack tongue
- LED Interior lights
- Radial tires (Mandatory option)

Contact your Wildwood dealer for a complete list of options.



Power awning with LED light



LG solid surface (Particle-board free) kitchen counter tops with undermount sink (Opt.)



# WILDWOOD TRAVEL TRAILERS

**T21RBS**  
4,853  
DRY WEIGHT

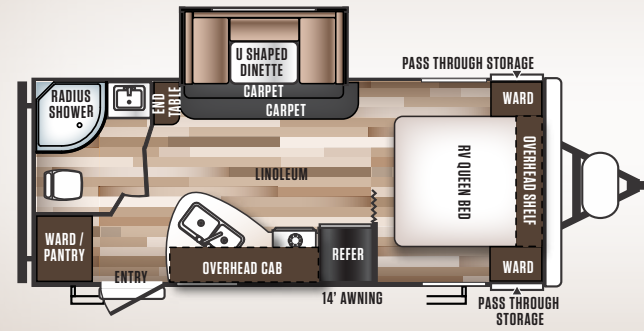

**T23RBS**  
6,030  
DRY WEIGHT



**T25RKS**  
5,794  
DRY WEIGHT

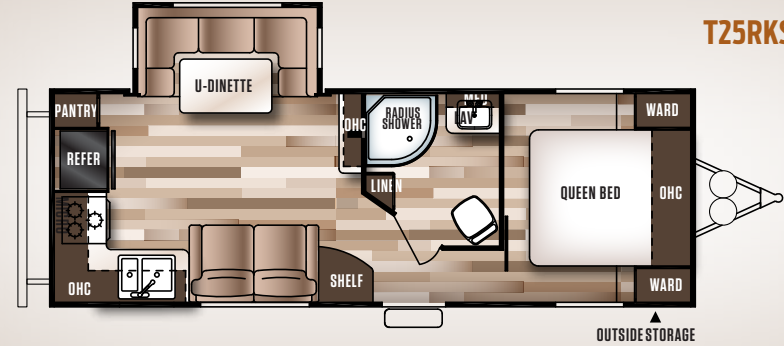

**T26TBUD**  
6,310  
DRY WEIGHT

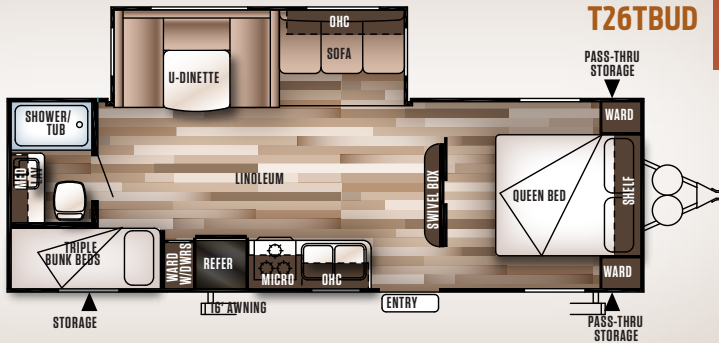

**T27TBUD**  
6,098  
DRY WEIGHT

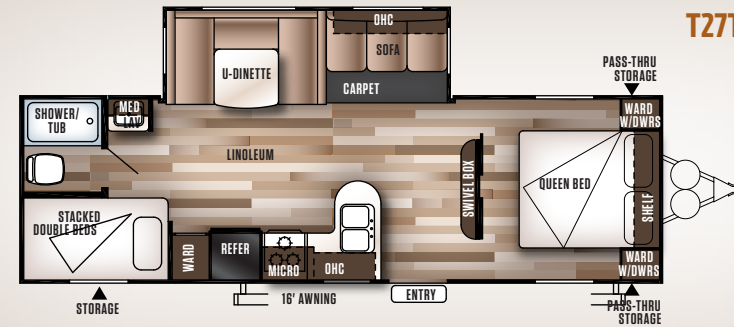

## WILDWOOD FLOOR PLAN KEY

*Pillows and blankets shown on beds and bunks are for demonstration purposes only and do not come with your new coach.*

- OHC**  
OVERHEAD CABINET
- WARD**  
WARDROBE
- MICRO**  
MICROWAVE
- LAV**  
BATHROOM SINK



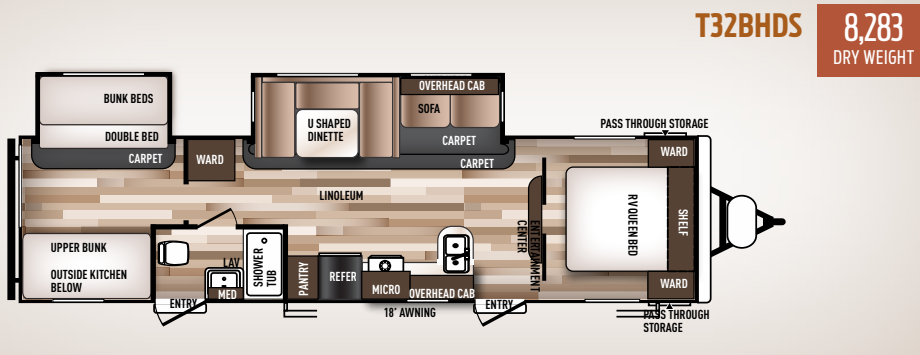
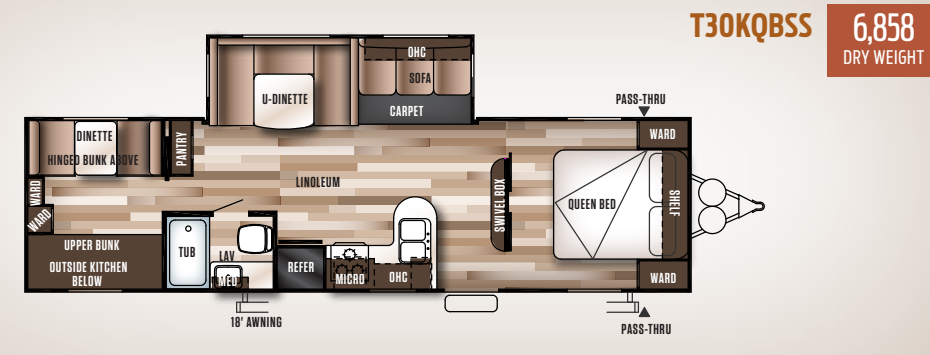
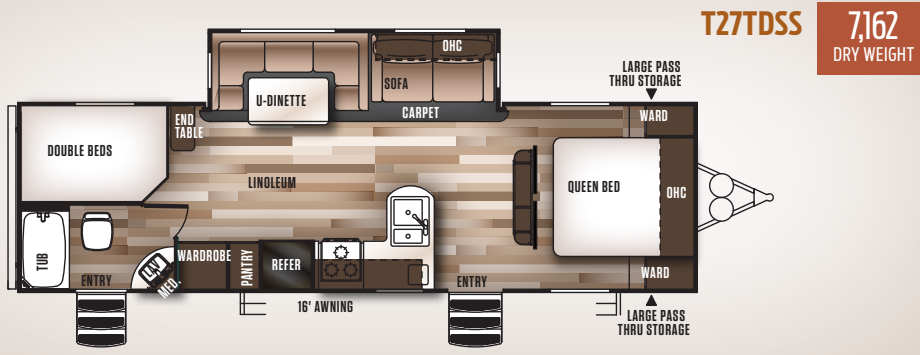
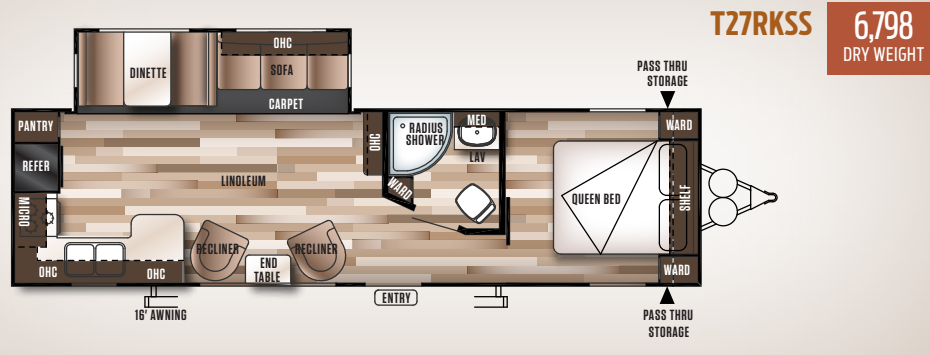
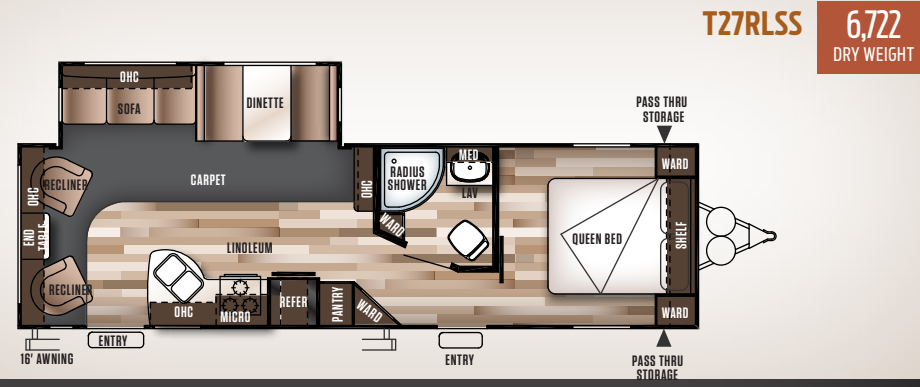
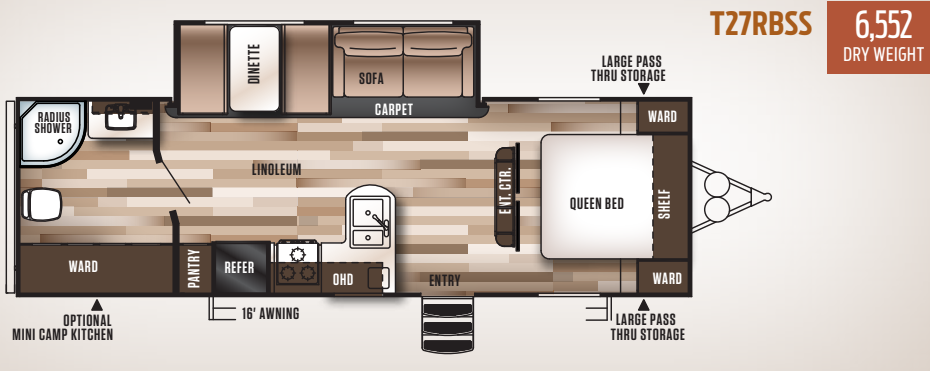

	T21RBS	T23RBS	T25RKS	T26TBUD	T27DBUD	T27RKSS	T27RLSS	T27RBSS	T27TDSS	T30KQBS	T32BHDS
HITCH WEIGHT (LBS.)	515	898	578	800	785	860	678	834	810	915	910
UNLOADED VEHICLE WEIGHT (LBS.)	4853	6030	5794	6310	6098	6798	6722	3082	2448	6858	8283
CARGO CARRYING CAPACITY (LBS.)	2662	1830	1784	1452	3450	2862	2756	3082	2448	2857	2787
EXTERIOR LENGTH	25'4"	26'5"	29'2"	29' 5"	30'8"	33'8"	32'8"	31'6"	32'8"	33'8"	36' 7"
EXTERIOR HEIGHT	11'3"	11'3"	11'3"	11'3"	11'3"	11'3"	11'3"	11'3"	11'3"	11'3"	11'5"
FRESH WATER CAPACITY (GAL.)	61	61	61	61	61	61	61	61	61	61	61
BLACK WATER CAPACITY (GAL.)	32	32	42	33	32	42	42	32	32	32	32
GREY WATER CAPACITY (GAL.)	28	28	66	28	28	66	66	74	74	28	32
AWNING (FT.)	14'	15'	16'	16'	16'	16'	16'	16'	16'	18'	18'

- Floorplan Key**
- OHC** Overhead Cabinet
  - WARD** Wardrobe
  - MICRO** Microwave
  - LAV** Bathroom Sink
  - MED** Medicine Cabinet





### PRE-DELIVERY INSPECTION FACILITY

20,000 square feet of quality assurance. The bare essentials for a premium product. This state-of-the-art facility gives immediate daily feedback to production for quality assurance in every unit built.



Forest River, Inc. encourages our customers to purchase their Forest River products from a local dealership whenever possible for the following reasons:

- 1) Forest River, Inc. dealers are independently owned and operated businesses so priority service and scheduling is at their discretion and is often provided to customers that purchased their unit at that dealership.
- 2) Purchasing locally allows customers to establish meaningful relationships with a dealer, enhancing the RV experience through assistance with product questions, user tips or RV regulations for your state or country, and much more!
- 3) Canadian customers must meet requirements to bring an RV purchased out of the country to their home. These requirements may involve additional inspections and certifications, taxes and fees. Your local Canadian Dealer is a professional at meeting these requirements.
- 4) Scheduling timely warranty repairs and adjustments through a local dealership provides far greater flexibility and convenience to you, the customer!

It is the goal of Forest River, Inc. that all of our RV owners fully enjoy the RV experience and that customer satisfaction meets or exceeds their expectations!

### 24/7 EMERGENCY ROADSIDE ASSISTANCE

For a worry-free ownership experience

Forest River includes one

year of Coach-Net RV Technical & Roadside Assistance with each RV purchase. Whether new to the RV lifestyle or an experienced RV enthusiast, Forest River owners have 24/7 access to technical, operational and emergency road service coverage throughout the US & Canada.

Coach-Net's fast, dependable service is just a phone call away.

**Coach-Net<sup>®</sup>**  
RV Technical & Roadside Assistance

## THE WILDWOOD LINE-UP



## Wildwood Heritage Glen



WILDWOOD

**DLX**

WILDWOOD

**LODGE**



**Learn More**  
Scan this barcode using a QR Reader on your smart phone to learn more about Forest River.



A Berkshire Hathaway company.

FOREST RIVER, INC. 55470 C.R. 1 ELKHART, IN 46515 | (503) 831-1200

WWW.FORESTRIVERINC.COM/WILDWOOD | WWW.FORESTRIVERACCESSORIES.COM

**FREE MEMBERSHIP**  
to Forest River Owners' Group



www.forestriverfrog.com

### Specification Definitions

**GVWR (Gross Vehicle Weight Rating)** - is the maximum permissible weight of the unit when fully loaded. It includes all weights, inclusive of all fluids, cargo, optional equipment and accessories. For safety and product performance do NOT exceed the GVWR.

**GAWR (Gross Axle Weight Rating)** - is the maximum permissible weight, including cargo, fluids, optional equipment and accessories that can be safely supported by a combination of all axles.

**UVW (Unloaded Vehicle Weight)\*** - is the typical weight of the unit as manufactured at the factory. It includes all weight at the unit's axle(s) and tongue or pin and LP Gas. The UVW does not include cargo, fresh potable water, additional optional equipment or dealer installed accessories.

\*Estimated average based on standard build optional equipment.

**CCC (Cargo Carrying Capacity)\*\*** - is the amount of weight available for fresh potable water, cargo, additional optional equipment and accessories. CCC is equal to GVWR minus UVW. Available CCC should accommodate fresh potable water (8.3 lbs per gallon). Before filling the fresh water tank, empty the black and gray tanks to provide for more cargo capacity.

\*\* Estimated average based on standard build optional equipment

Each Forest River RV is weighed at the manufacturing facility prior to shipping. A label identifying the unloaded vehicle weight of the actual unit and the cargo carrying capacity is applied to every Forest River RV prior to leaving our facilities.

The load capacity of your unit is designated by weight, not by volume, so you cannot necessarily use all available space when loading your unit.

All information contained in this brochure is believed to be accurate at the time of publication. However, during the model year, it may be necessary to make revisions and Forest River, Inc., reserves the right to make all such changes without notice, including prices, colors, materials, equipment and specifications as well as the addition of new models and the discontinuance of models shown in this brochure. Therefore, please consult with your Forest River dealer and confirm the existence of any materials, design or specifications that are material to your purchase decision. Litho. U.S.A P/W: 2016.02.26

YOUR WILDWOOD DEALER