

COACHMEN | 2009 FREELANDER CLASS C MOTORHOMES



2009 Coachmen Freelanders™

Step Into the Easy Life.



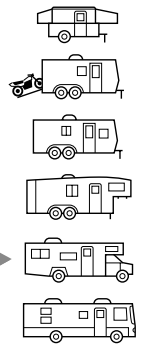

Frelander™

# It's Easy.

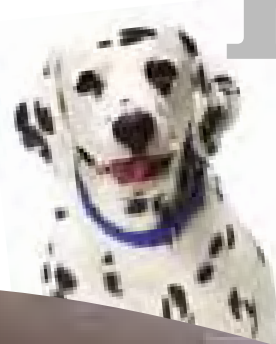

Whether you've outgrown your tent camper or you're just ready to explore the motorhome lifestyle, the easy life begins with the Coachmen Frelander. Stylish, roomy and affordable, Frelander has everything you and your family need to enjoy the great outdoors in comfort and convenience. 🐾 What's more, Frelander has tons of storage space, so you can take all your gear wherever the road leads you. 🐾 And Frelander is backed by Coachmen's warranty and a nationwide network of service centers. Ready for adventure?

It's as close as your nearest  
Coachmen dealer!





Frelander  
Class C Motorhomes

## Features that matter.



### Fresh Water System

Frelander  
50 Gallons

Other Brands  
41 Gallons

### EASY CONVENIENCES

Frelander makes it easy to take it all with you. The huge exterior compartments have more than 100 cubic feet of storage space (most models) while the industry-leading 50-gallon fresh water system allows you to enjoy the great outdoors even longer.



### EASY RESTING

Frelander accommodates the whole family in comfort for an easy night's sleep. Most models have residential-size queen beds (not the short variety usually found in RVs), a roomy bunk over the cab and on some models an easy-to-convert hide-a-bed sofa.

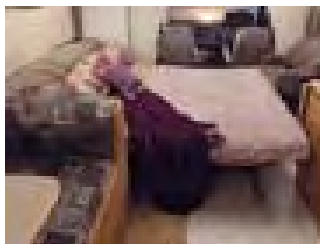

 The spacious, family friendly 3150SS provides ample seating as well as plenty of sleeping space, so everyone can relax in comfort.



Visit our website anytime at [www.easyRVing.com](http://www.easyRVing.com)

for more information and easy shopping tools like

- Finding the right Coachmen for you.
- Comparing different Coachmen models.
- Building your own RV.





# 2009 Coachmen Freelanders™

# Easy.

Step Into the Easy Life.



The unique Freelanders 3150SS is the perfect motorhome for any size family. From classic to extraordinary, the spacious slideout makes it easy for everyone to enjoy a little elbow room. A little extra space enhances a tight-knit family experience. (Shown in Birkdale Taupe decor)

## Decor Choices

**FABRIC KEY**  
**A.** Main **B.** Accent  
 Coachmen's dazzling interiors feature top-grade fabrics that have been tested for maximum durability.

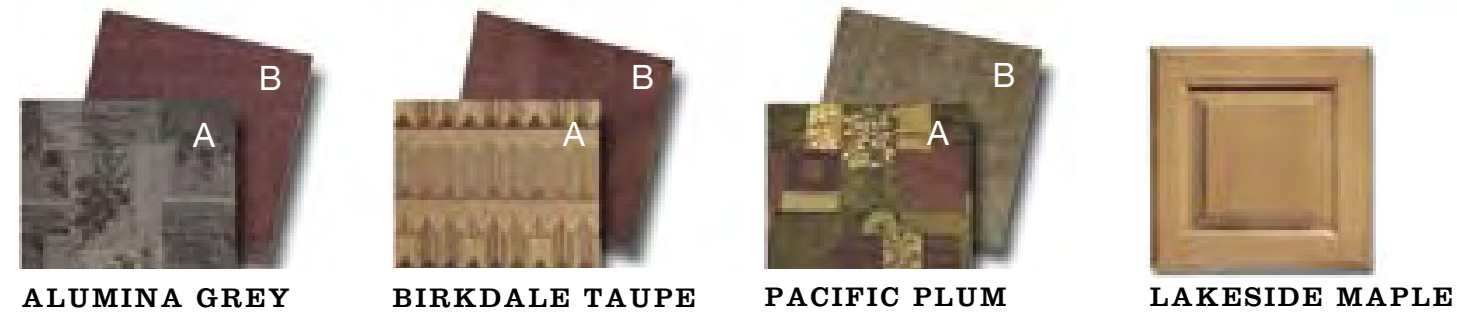

## Easy Features

	NS	SS		NS	SS		NS	SS		NS	SS
<b>LIVING APPOINTMENTS</b>											
Lakeside Maple cabinetry	S	S	Dash stereo with CD player (Chevy® chassis only)	S	-	55-amp electronic converter	S	S	☛ Spare tire kit (n/a 3130IS)	S	S
Hardwood cabinet doors and drawers	S	S	Reclining captains chairs	S	S	Auxiliary coach battery	S	S	Air-assist suspension	O	O
Linoleum flooring	S	S	<b>APPLIANCES AND ACCESSORIES</b>			Second coach battery	O	O	Laminated floor	S	S
Carpet (living and bedroom)	-	S	☛ Cabover entertainment center: 26" LCD® TV, DVD player and Bose Wave® radio	-	O	GFI circuit	S	S	☛ Laminated sidewalls with AZDEL SuperLite® substrate	S	S
Pleated window shades	-	S	☛ Side-mounted 20" LCD® TV and DVD player	O	O	Coach battery disconnect	S	S	Laminated crowned roof	S	S
Hide-a-bed sofa* (3130IS, 3150SS)	-	S	☛ 4000 Series gas generator (gas units only)	O	O	Outside 120-volt receptacle	S	S	Seamless TPO roof covering	S	S
Comfort lounge sofa (2230RK, 2700RS, 2890QB)	S	S	☛ 4000 Series LP generator (diesel units only)	O	O	Cable TV jacks	S	S	☛ Roof ladder	S	S
U-shaped booth dinette (2130QB, 2230RK)	S	-	Sirius® radio docking station (Ford® chassis only)	O	O	Patio light***	S	S	Aluminum running boards	S	S
Booth dinette (n/a 2130QB, 2230RK, 3130IS)	S	S	TV antenna	S	S	☛ 4000 Series LP generator (diesel units only)	S	S	Power entrance step	O	O
Hardwood-edge countertops	S	S	☛ Microwave oven	S	S	☛ Coach command center	S	S	80" tall entrance door	S	S
Removable bar stools (3130IS only)	-	S	3-burner range with oven (n/a 3130IS)	S	S	Auto rear trunk lights	S	S	Patio awning	S	S
<b>SLEEPING APPOINTMENTS</b>			Euro-style range with cover (3130IS only)	-	S	<b>PLUMBING AND LP SYSTEM</b>			Slideroom awnings	-	-
Residential 60" x 80" queen bed (n/a 2230RK)	-	S	Stainless steel kitchen sink (n/a 3130IS)	S	S	Durabute™ copper LP lines	S	S	Front cabover window	O	O
Innerspring mattress (n/a 2130QB, 2230RK, 2700RS)	S	S	Euro-style sink with cover (3130IS only)	-	S	6-gallon gas/electric E.I. water heater	-	S	CSA upfit (mandatory for all Canadian provinces)	O	O
Convertible day bed/queen bed (2700RS)	-	S	Double-door refrigerator	S	S	6-gallon gas E.I. water heater	S	-	<b>SAFETY AND SECURITY</b>		
Cabover queen bed — 57" x 95" Privacy drape — cabover bed	S	S	<b>HEATING AND AIR CONDITIONING</b>			☛ Water Works™ utility panel	S	S	LP leak alarm	S	S
Privacy drape — cockpit area	S	S	20,000 BTU furnace	S	-	☛ Exterior wash station	S	S	Fire extinguisher	S	S
Double bunk beds in place of queen bed** (2890QB and 3150SS only)	O	O	30,000 BTU furnace	-	S	☛ Demand water pump	-	S	Smoke detector	S	S
<b>COCKPIT APPOINTMENTS</b>			13,500 BTU non-ducted roof air conditioner	S	-	☛ Skylight over shower	S	S	Carbon monoxide detector	S	S
Cruise control	S	S	13,500 BTU ducted roof air conditioner	-	S	Glass shower enclosure (n/a 2130QB, 2230RK)	S	S	☛ Emergency start switch	S	S
Tilt steering wheel	S	S	Wall-mounted thermostat	S	S	Shower curtain (n/a 2890QB)	S	-	Driver and passenger air bags	S	S
Dash air conditioning	S	S	Power bath vent	S	S	One-piece ABS tub surround	S	-	Exterior security light***	-	-
Power windows and locks	S	S	<b>ELECTRICAL AND LIGHTING</b>			☛ Heated enclosed holding tanks**	S	S	Entrance door dead bolt lock	S	S
Dash stereo with CD player, weatherband and satellite radio capable (Ford® chassis only)	-	S	30-amp power cord	S	S	<b>EXTERIOR AND CONSTRUCTION</b>			Safety glass windows	-	-
						6.0L diesel engine — Ford® (n/a 2130QB, 2230RK)	O	O	Tinted safety glass windows	-	-
						5,000 lb. towing hitch (Ford® models)	S	S	☛ Front bunk ladder and child restraint system	O	O
						3,000 lb. towing hitch (Chevy® models)	S	S	Owner's information package	S	S
						Metal wheel covers	-	O	<b>Legend:</b> <b>S</b> = Standard <b>O</b> = Optional <b>NS</b> = Non-Slide Models <b>SS</b> = SuperSlide Models ☛ = Easy Feature * Hide-a-bed not available on 3150SS when equipped with rear bunk option. ** Chevy models equipped with rear bunk option have a reduced fresh water capacity of 25 gallons. *** Not available in units shipped to Canada.		

	Non-Slide Models			SuperSlide Models			
SPECIFICATIONS	2130QB	2230RK	2890QB	2600SO	2700RS	3130IS	3150SS
Chassis	Chevy	Chevy	Chevy/Ford	Chevy/Ford	Chevy/Ford	Ford	Chevy/Ford
Chassis model	C-3500	C-3500	C-3500/E-45	C-3500/E-45	C-3500/E-45	E-45	C-3500/E-45
Engine size (liter)	6.0	6.0	6.0/6.8	6.0/6.8	6.0/6.8	6.8	6.0/6.8
Wheel base	159"	177"	191/190"	177/176"	191/190"	208"	209/208"
Rear axle ratio	4.1	4.1	4.1/4.56	4.1/4.56	4.1/4.56	4.56	4.1/4.56
GVWR (lbs.)	12,300	12,300	12,300/14,500	14,050/14,500	14,050/14,500	14,500	14,050/14,500
CW (lbs.)	8,998	9,038	10,212/10,679	10,733/11,061	11,067/11,395	12,221	11,869/11,952
GCWR (lbs.)	16,000	16,000	16,000/20,000	16,000/20,000	16,000/20,000	20,000	17,600/20,000
Exterior length	23'8"	24'6"	30'4"/29'10"	28'2"/27'8"	28'6"/28"	31'11"	32'5"/31'11"
Exterior height (including A/C)	11'2"	11'2"	11'2"	11'2"	11'2"	11'2"	11'2"
Exterior width	8'4"	8'4"	8'4"	8'4"	8'4"	8'4"	8'4"
☛ Exterior storage capacity (cu. ft.)	102	38	55	112	57	104	113
Sleeping capacity	5	4	6	5	6	5	6
☛ Interior height	6'10-1/2"	6'10-1/2"	6'10-1/2"	6'10-1/2"	6'10-1/2"	6'10-1/2"	6'10-1/2"
Fuel capacity (gal.)	35	35	35/55	57/55	57/55	55	57/55
☛ Fresh water capacity (gal.)	50	50	50	50	50	43	50
Gray water capacity (gal.)	22	28	27	29	29	28	28
Waste water capacity (gal.)	37	28	27	29	29	27	27
LP gas capacity (lbs.)	40	40	40	68	68	68	68
Tire size	16"	16"	16"	16"	16"	16"	16"

**GVWR** (Gross Vehicle Weight Rating): The Maximum permissible weight of the unit, including the unloaded vehicle weight plus all fluids, cargo, optional equipment and accessories. For safety and product performance, do not exceed the GVWR.

**CW** (Curb Weight): The weight of the unit without factory or dealer installed options, plus allowance for the weight of full fuel capacity. The "payload capacity" for all other fluids, cargo, occupants, optional equipment, and accessories can be determined by subtracting the CW from the GVWR.

**GCWR** (Gross Combined Weight Rating): The maximum total weight of the loaded unit, plus a tow vehicle. This includes the weight of both the unit and tow vehicle, fuel for each, all other fluids, cargo, occupants, optional equipment and accessories.

**Wider Widths:** Numerous Coachmen floorplans feature the "wide body" design concept, which gives you significantly enhanced interior living space and innovative floorplans.

In making your purchase decision, you should be aware that a few states restrict access on some or all roads within the state to vehicles with a maximum 96" width, although special road usage permits may be available. Vehicles up to 102" in some width are permitted in the vast majority of states. You should confirm the road usage laws in the states of interest to you before making your purchase decision. If width is of concern to you, we invite you to consider the broad array of other Coachmen models offers in the standard 96" width.

**Important Note:** All capacities are approximate, and all dimensions are nominal. Coachmen motorhomes are designed to allow for a wide variety of uses, extended trips with two people or short trips with multiple people. Accordingly, each unit allows ample room for sleeping, seating, fluids and cargo. While the customer is the beneficiary of this design, the customer also bears the responsibility to select the proper combination of passengers, cargo, load, and tow vehicle without exceeding the chassis weight capabilities. Consumer may need additional braking capacity to tow loads greater than 1,000 pounds. Seat belt should always be worn for passenger safety. Seat belts are provided at most locations to allow convenience in selecting which seat to occupy. However, it is not intended that all seating positions equipped with a seat belt may be occupied while the vehicle is in motion, without regard to other weight factors.

All Coachmen motorhomes are designed to ensure that the number of passengers allowed while the vehicle is in motion will always at least equal the stated sleeping capacity. Though extra seat belts may be provided, for your safety and the proper operation of your vehicle, limit your passengers to the number allowed by the Net Carrying Capacity of your vehicle.



Freelanders, Non-Slide Models – Easy Living Floorplans



Freelanders, SuperSlide Models – Easy Living Floorplans

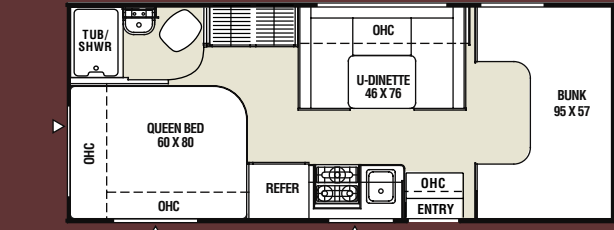

2130QB | Exterior Storage: 102 cu. ft. | Sleeps 5

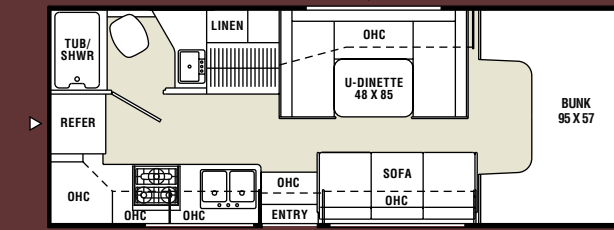

2230RK | Exterior Storage: 38 cu. ft. | Sleeps 4

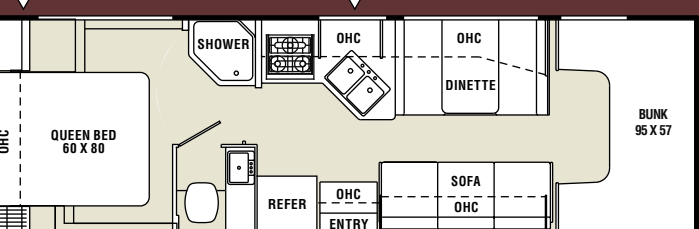

2890QB | Exterior Storage: 55 cu. ft. | Sleeps 6

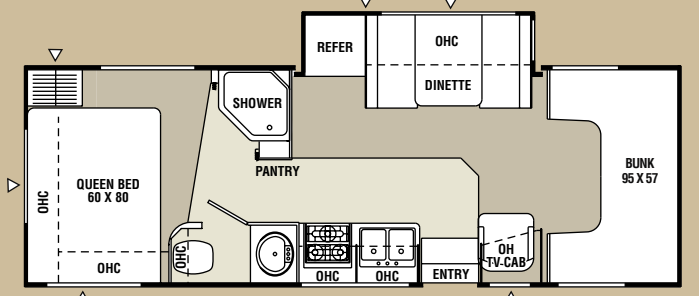

2600SO | Exterior Storage: 112 cu. ft. | Sleeps 5

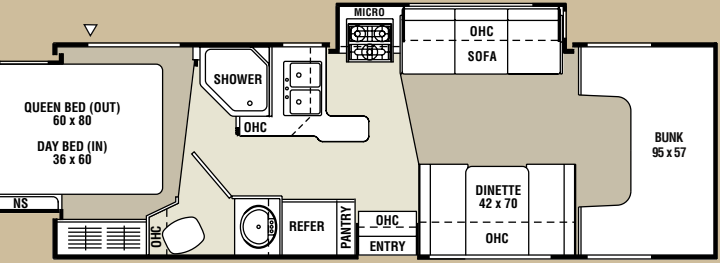

2700RS | Exterior Storage: 57 cu. ft. | Sleeps 6

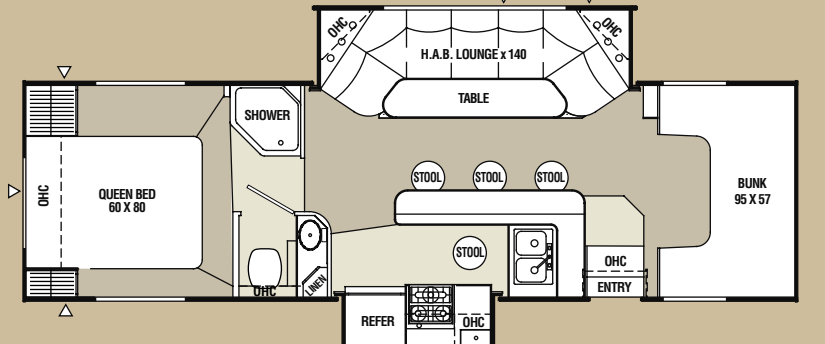

FAST LANE 3130IS | Exterior Storage: 104 cu. ft. | Sleeps 5

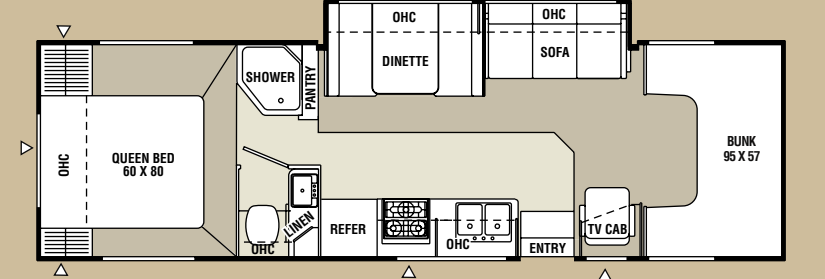

3150SS | Exterior Storage: 113 cu. ft. | Sleeps 6

▲ Outside Storage Location  
 ◻ Carpet  
 ◻ Linoleum



Automotive-style dash is loaded with conveniences like power windows and locks, cruise control, power steering, drink holders, dual air bags and dash stereo CD player that make driving simple and easy.

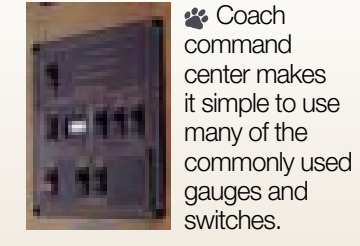

Coach command center makes it simple to use many of the commonly used gauges and switches.

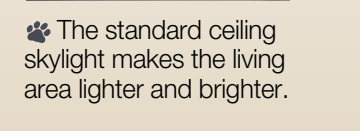

The standard ceiling skylight makes the living area lighter and brighter.

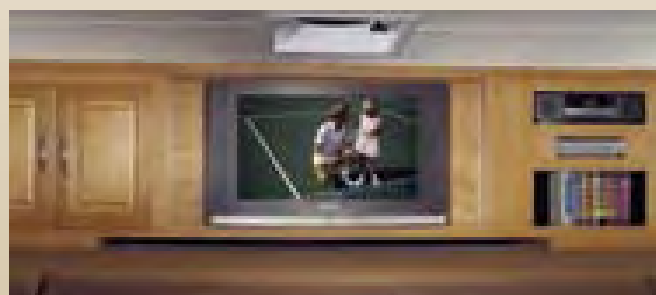

This advanced sidewall design features a high-gloss fiberglass exterior and AZDEL SuperLite® composite substrate. This combines the good looks of a quality exterior with a lightweight, moisture-resistant substrate that won't rot or grow mold like wood.

## Freelanders – Easy Exterior Features



Bunk Option Available on 2890QB and 3150SS

Optional overhead entertainment includes a 26" LCD TV, DVD player and a Bose Wave® radio sound system. It loads the Freelanders with fun for the whole family while still allowing room for a bunk that can sleep a full-size adult.



### Easy to Use. Really.

Pete symbolizes our commitment to being your best friend on the road. Like Pete, we're always there to make sure your Coachmen is as easy and uncomplicated as possible, so you can escape life's hassles and enjoy RVing more.

Your Coachmen will be easy to buy, easy to use and easy to own. That's our promise to you. We accomplish this through clever designs and superior support after the sale. But the real measure of "easy" is in the countless thoughtful touches we include throughout your new Coachmen.

### Easy to Own. Honest.

Our commitment to you is your ongoing satisfaction. Dealers are authorized to solve your problems on the spot and get you on your way without fuss or hassle. Should you ever need service or repair, it is easy to find one of the hundreds of Coachmen dealers or authorized repair centers nationwide.

Our toll-free service hotline (800-453-6064) and online service support center put you in touch with a Coachmen service representative, warranty information, maintenance information, troubleshooting tips, dealer locations and other helpful information. Coachmen. You couldn't ask for an easier traveling companion.

### Travel Easy™. Always.

RVing is easier with Coachmen's *Travel Easy*™ Roadside Assistance included for the first year on most new motorized and towable Coachmen RVs\*. Administered by Coach-Net®, this service provides you with 24/7 operational, technical and emergency road service coverage. Anywhere. Anytime. *Travel Easy*™ is the security of knowing that help is an easy phone call away.

\*See your dealer for details.



All information contained in this brochure is believed to be accurate at the time of publication. However, during the model year, it may be necessary to make revisions, and Coachmen reserves the right to make all such changes without notice, including changes in prices, colors, materials, equipment and specifications, as well as the addition of new models and the discontinuance of models shown in this brochure. Therefore, please consult with your Coachmen dealer and confirm the existence of any materials, design or specifications that are material to your purchase decision.

COA-126 5.08 Printed in USA



**Coachmen Recreational Vehicle Company, LLC**  
P.O. Box 30, Middlebury, IN 46540



### Easy to Enjoy. Seriously.

**Purchase a new Coachmen RV and receive a free one-year membership in the Coachmen Owners' Association (C.O.A.).**

**You'll enjoy exclusive discounts at campgrounds, theme parks and fuel stations. You'll also receive concierge service 24/7 so you can find and buy what you need, often at big discounts!**

**Other benefits include trip routing, vacation packages, event reservations, mail forwarding and our helpful owners magazine — Easy RVing. Plus annual camping events, a support network and services for first-time buyers.**

**Take advantage of your C.O.A. membership today by calling 888-422-2582.**

**To see how Coachmen is making the easy life even easier, visit [www.easyRVing.com](http://www.easyRVing.com) or call 1.800.353.7383.**