

BY FOREST RIVER



Flagstaff

BY FOREST RIVER

BY FOREST RIVER
TENT CAMPERS

Flagstaff



TENT CAMPERS



A



B

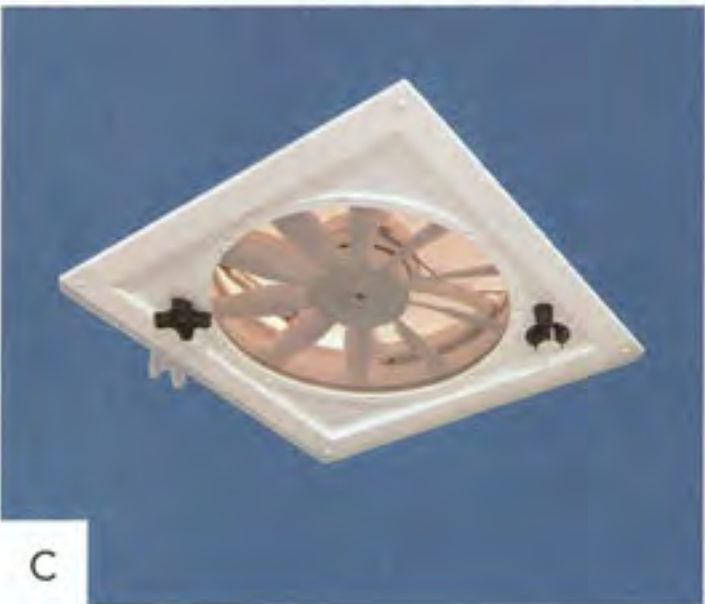

C



- A. Heated Mattress (OPT.)
- B. Marine Grade Plywood Bed Ends
- C. Fantastic Fan (OPT.)

Camping with the family in Autumn can be a beautiful experience. As warmer days move to colder nights, you will love the heated inner-spring mattress for a warm comfortable night's sleep. If you desire more air circulation in the camper, turn on the Fantastic Fan and the warmer air will be expelled in moments, bringing fresh air in its place.

Flagstaff

MAC / LTD SERIES

Flagstaff Tent Campers brings the comforts of home on the road. From features like the heated mattresses, metal drawer guides and Fantastic Fan, you can be sure your quality-built Flagstaff camper will be very enjoyable year after year. Vacation is just around the corner.

208



208



E



F

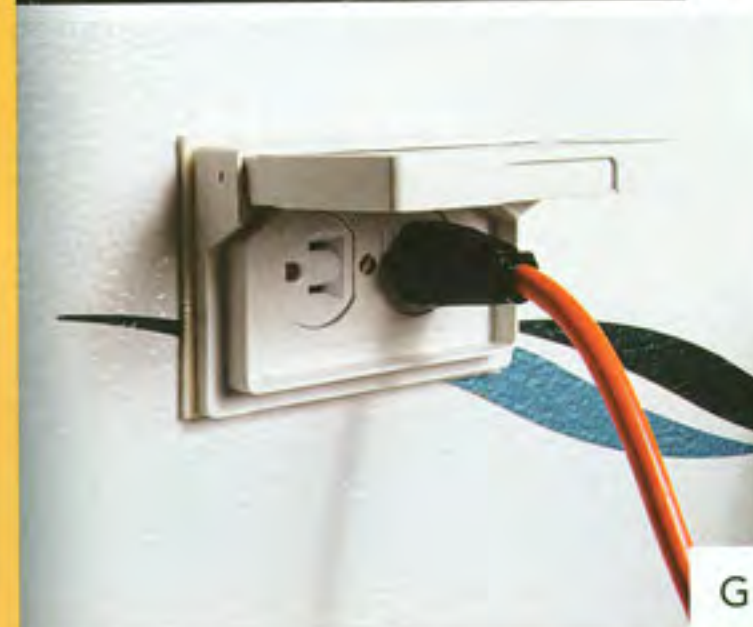

G



H



I



J

- E. Spare Tire (STD. with Travel Package)
- F. Water Pump (STD.)
- G. Exterior Electric Plug (Except 176LTD)

- H. Under Floor 20 Gallon Water Tank (STD. Except LTD.)
- I. Metal Drawer Guides
- J. One-Piece Door (STD. Except LTD.)

Flagstaff

CLASSIC SERIES

Flagstaff's Classic series has much to offer the camping enthusiast. From the expansive sliding storage trunk for that extra packing space, to a bunk light and air circulating fan, the convenient hanging shirt bar to place your clothes, and standard hot water package with outside shower are some of the trademarks that make the Flagstaff Classic luxurious.

823



A. Outside Shower (STD. on Classics and HW)

B. Port-a-Potty (STD. in Selected Models)

C. Sliding Storage Trunk (Some Models)

D. Hanging Shirt Bar (STD. on Classics and HW)

E. Bunk Light & Fan (STD. Classic, HW)

F. Crank Down Stabilizer Jack with Sand Pad



G



H



I

The 823 Classic has many new features to enhance your camping experience. The swing-down galley and standard power lift make the Classic a breeze to set-up. The upgraded stereo and exterior speakers allow you to listen to music in your camper or while you're hanging out by the camp fire.

- G. Exterior Speakers (STD. Classic, HW)
- H. Swing Down Galley (Most Models)
- I. Stereo with CD Player (STD. Classic, HW)



A



B



A. Shower (Some Models)
 B. Power Lift with Manual
 Override (STD. Classic, HW)

Cream colored cabinetry, stainless steel finishes and beautiful wood-look flooring puts this camper in a class of its own. The Flagstaff High Wall Campers are perfect for those families who want the luxurious features of a travel trailer in a much lighter towable option. It's your vacation. Go in style.

Flagstaff

HIGH WALL SERIES

No more waiting in line for the showers. Take a morning shower in privacy without leaving your camper while breakfast is started. Our high wall models include a three burner range, microwave, stereo, a larger kitchen sink and shower which brings the finer amenities to tent camping.

HW25S/C

HW25S/C

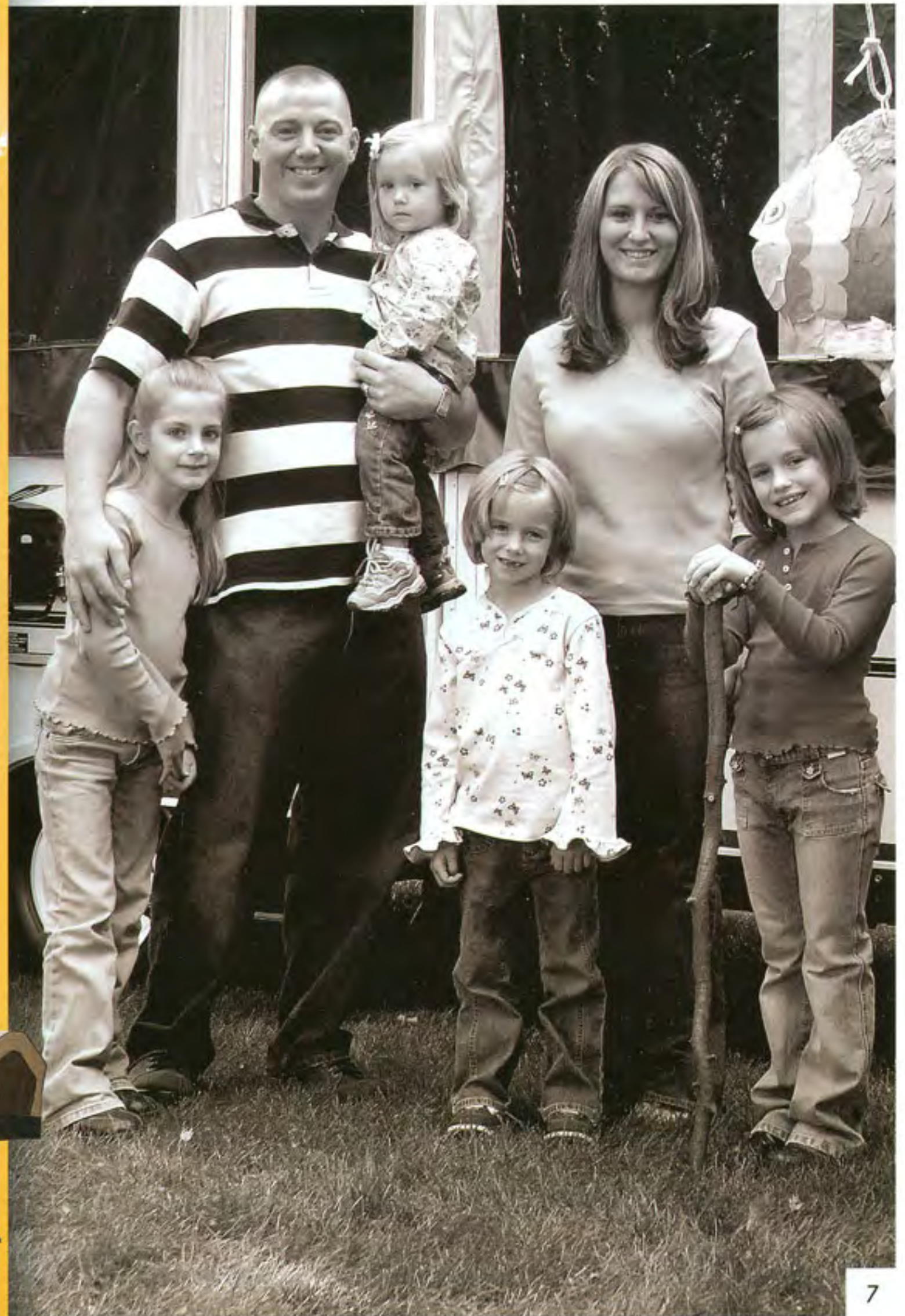



Flagstaff CONSTRUCTION



- 1) Three Stage Double Arm Lifter Posts
- 2) Fiberglass Vacuum Bonded Radius Roof w/ No Center Seam
- 3) Five-Piece Tenting with Breathable Bed Ends
- 4) E-Z Crank Down Stabilizer Jacks w/ Sand Pads
- 5) Full Perimeter Aluminum Bed Frames
- 6) Plywood Bunk Ends
- 7) Seven-Way Pigtail Wiring
- 8) Under Floor 20 Gallon Fresh Water Tank (Ltds 10 Gallon Above Floor)
- 9) Powder Coated Tubular Steel Frame
- 10) Powder Coated Rafter Poles and Bed Bows
- 11) Air Conditioner Reinforcing Laminated into Roof
- 12) 13" Radial Tires on 12' Models (12" Radial Tires on 8' & 10' Models)
- 13) Easy Lube Axles
- 14) Breathable Canvas Bed End Material
- 15) One-Piece Door (Except LTDs)

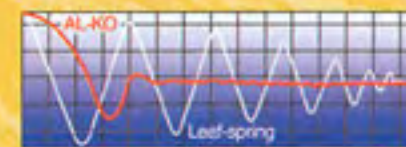

AL-KO® AXLES AND EASY LUBE HUBS

AL-KO Axles offer many advantages over conventional axles:

- Fully independent wheel suspension.
- Lower trailer center of gravity for improved stability.
- No metal to metal contact and no springs, shackles, hangers, or U-bolts to break or wear out.

The UltrULube™ Hubs allow you to repack bearings quickly and easily without disassembly.

Note: Torsion Axles on Classics and HW only. Easy-Lube Hubs on all units except LTDs.



Flagstaff

POPULAR TENT FEATURES



A



E



B



C



D

A. Screen Room with Flaps (OPT.)
B. Hanging Pantry (OPT.)
C. Outside Grill with Work Table
(STD. on all Except LTD)

D. Bike Rack (OPT.)
E. Hanging Wardrobe (OPT.)

Flagstaff

HIGH WALL SERIES STANDARDS & OPTIONS

STANDARD FEATURES

- Double Pan Sink with High Rise Faucet
- 14" Tires with Aluminum Rims
- 3500 LBS Torsion Axles by AL-KO
- Easy-Lube Axles
- New Exterior Graphics
- White Interior with "Wood Look" Linoleum
- AM/FM Stereo with CD player
- TV Outlet with Cable and Satellite Hook Up
- Three Burner Stove with Oven
- Microwave
- Hot Water Package (Incl. Water Filter, Outside Shower, DSI Six Gallon Hot Water Heater, Demand Water Pump)
- Electric Water Pump
- Water Purifier
- Two-20 lb. Gas Bottles
- Diamond Plated Metal End Caps
- Stainless Steel Appliances
- Six Gallon Gray Water Holding Tank
- Laminated Floor
- Bunk Light with Fan
- One-Piece Screen Door
- Electric Brakes
- Battery Box and Wiring Kit
- 12v Safety Switch
- Power Lift System
- Awning

OPTIONS

- 13,500 BTU Air Conditioner
- Create-a-Breeze Three Speed Fantastic Fan
- Heated Innerspring Mattresses
- 17,000 BTU Forced Air Furnace w/ Electric Ignition
- Screen Room with Flaps
- Convenience Package (Incl. Lined Privacy Curtain, Roof Valances, Patio Light, 110 Exterior Outlet)
- Travel Package (Incl. Spare Tire, Tire Bracket, Tire Cover, Step)

MODEL	HW25S/C	HW25ST	HW27S/C
GVWR	3,947	3,917	3789
Base/Dry Unit Weight	2,803	2,853	3021
Base/Dry Hitch Weight	447	417	289
Base/Dry Axle Weight	2,356	2,436	2732
Cargo Capacity	940	860	580
Box Size	12'	12'	14'
Trailer Size (Closed - w/ Hitch)	18'6"	18'6"	19'4"
Height (Closed)	68"	68"	68"
Trailer Length (Open)	22'6"	22'6"	24'9"
Interior Height	88"	88"	88"
Travel Width	85"	85"	85"



HW25S/C



HW25ST



HW27S/C

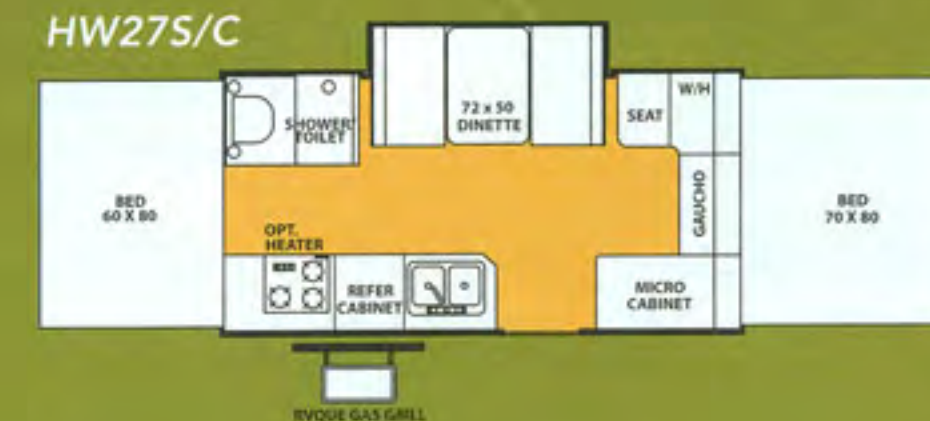

Flagstaff

CLASSIC STANDARDS & OPTIONS

CLASSIC STANDARD FEATURES

- Power Lift System
- Swing Level Galley with Storage
- Residential Style Kitchen Faucet w/ Electric Water Pump
- Larger Deeper Sinks
- Soft Quilted Top Innerspring Mattresses
- Outdoor Gas Grill w/ Worktable
- Sliding Storage Tray on All Front Trunk Models (Except 620ST)
- Water-Pur Filtration System
- E-Z Crank-down Stabilizer Jacks w/ Sand Pads
- Electric Brakes (12' Models)
- Residential Style Raised Panel Doors
- Three Double Ceiling Lights w/ Jacks for Accessories
- Bunk Light w/ Fan
- Permanently Mounted Three-Burner Indoor Range w/ Stove Cover
- Free Standing Table – High Pressure Laminate
- Comfortable Family Style Dinette w/ 4" Reversible Cushions
- Large Clothes Bar
- LP Leak Detector
- Metal Drawer guides
- Port-a-Potty in 425D and 620 Models
- A&E Free Standing Awning

- Hot Water Pkg. – Incl. Water Filter, Outside Shower, Six Gallon Hot Water Heater, Demand Water Pump
- AM/FM Stereo w/CD Player
- Outside Speaker

CLASSIC CONSTRUCTION FEATURES

- Smooth Fiberglass Vacuum Bonded Exterior
- Three-Stage Double Arm Lifter Posts
- Fiberglass Vacuum Bonded Radius Roof w/ No Center Seam
- One-Piece Screen Door
- Five-Piece Sectionalized Vinolon Supreme Tenting with Breathable Bunk Ends
- Under Floor 20 Gallon Fresh Water Tank
- Powder Coated Tubular Steel Frame
- One Piece Undercoated Structurewood Floor
- 13" Radial Tires (12" Models)
- Seven-Way Pigtail Plug
- Tent Permanently Attached on Bunk Ends and Slide Out
- Full Perimeter Aluminum Bed Frames
- Tinted Vinyl Windows
- Powder Coated Rafter Poles and Bed Bows
- Steel Air Conditioner Vent Reinforcing Laminated Into Roof
- Easy Lube Axles
- Two Tone Fabric Interior

- Plywood Bunk Ends
- Independent Torsion Axles
- Lower Door Operational in Closed Position
- 2000 lb. Tongue Jack w/ Swivel Wheel
- Seamless, High Density Polyethylene Wells
- Battery Box and Wiring Kit

CLASSIC POPULAR EXTRAS

- Create-A Breeze Three Speed Fantastic Fan
- Thermostatically Controlled Heated Mattresses
- 17,000 BTU Forced Air Furnace w/ Electric ignition
- Extra-Large 2.5 Cubic Ft. Refrigerator
- A&E Screen Room with Flaps
- Convenience Pkg. (Incl. Lined Privacy Curtains, Roof Valances, Patio Light, 110 Exterior Outlet)
- Travel Pkg. (Incl. Spare Tire, Tire Bracket, Tire Cover, Step)
- Overhead Kitchen Pantry
- Hanging Wardrobe
- Power Lift System
- Bike Rack
- Air Conditioning Wiring Kit
- Electric Brakes (10' models)
- 13" Radial Tires (10' models)
- Dual 20 lb. LP Bottles

FLAGSTAFF CLASSIC SERIES SPECIFICATIONS

MODEL	620ST	720	523	525D	625D	425D	823D	823
GVWR (Gross Vehicle Weight Rating)	2343	2355	3036	3035	3072	3071	3006	3006
Base/Dry Unit Weight	1814	1730	2297	2648	2539	2605	2317	2225
Base/Dry Hitch Weight	243	255	316	315	352	351	281	286
Base/Dry Axle Weight	1571	1475	1981	2333	2187	2254	2038	1939
Cargo Capacity	341	437	551	200	345	278	496	522
Box Size	10	10	12	12	12	12	12	12
Trailer Size (Closed - w/ Hitch)	15'5"	14	17'11"	15'11"	17'11"	17'11"	17'11"	17'11"
Height (Closed)	57"	57"	61"	57"	61"	61"	61"	61"
Trailer Length (Open)	20'2"	20'2"	23'6"	20'8"	23'6"	23'6"	23'6"	23'6"
Interior Height	6'6"	6'6"	6'6"	6'6"	6'6"	6'6"	6'6"	6'6"
Travel Width	85"	85"	85"	85"	85"	85"	85"	85"
Tire Size - 13"R std.	12"	12"	STD.	STD.	STD.	STD.	STD.	STD.
Power Converter with Charger: Amps	25	25	25	25	25	25	25	25



Flagstaff CLASSIC FLOORPLANS

720

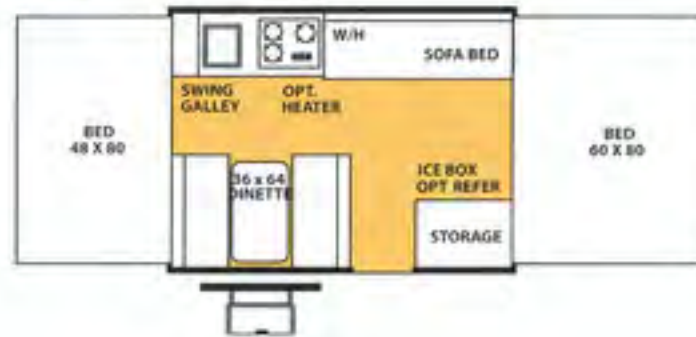

620ST

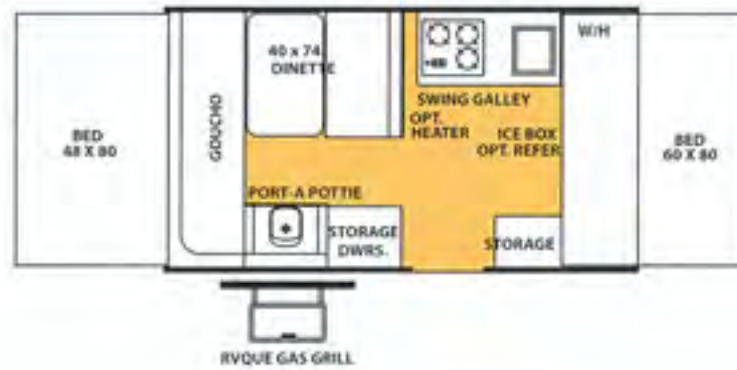

523



525D

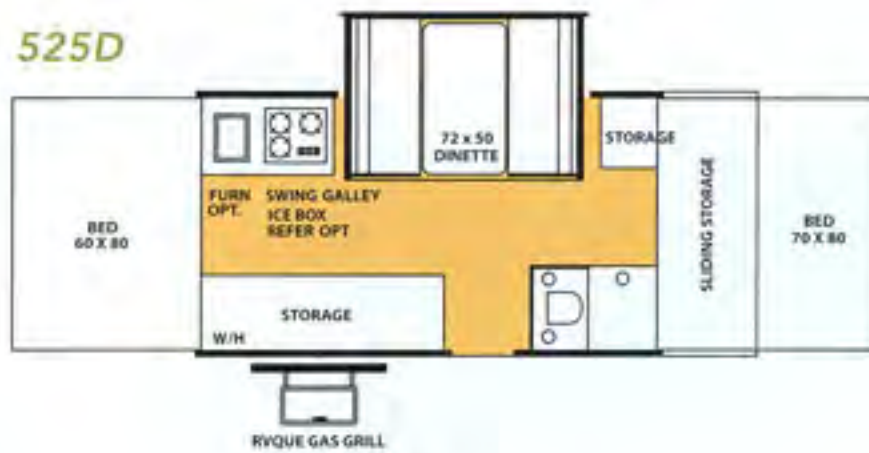

425D



625D



823

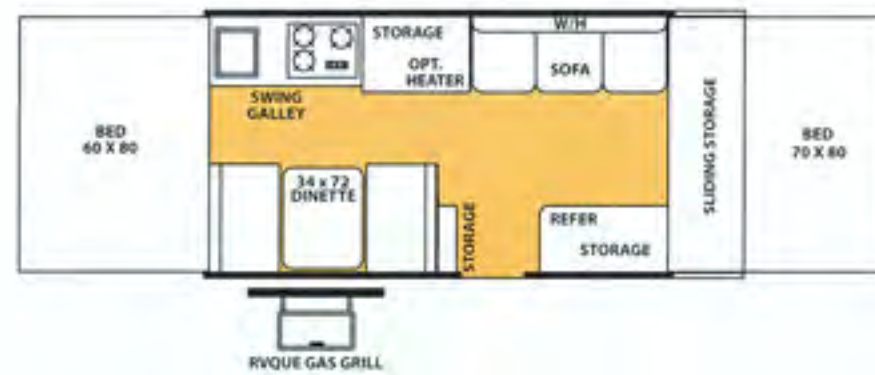

823D



Flagstaff

MAC/LTD STANDARDS & OPTIONS

MAC/LTD STANDARD FEATURES

- Residential Kitchen Faucet w/ Electric Water Pump
- Soft Quilted-Top Bed Mattresses (4" High Density Foam)
- Outside Gas Grill (Optional on LTDs)
- Water-Pur Filtration System w/ all Shower Models
- Permanently Mounted 3 Burner Indoor Range w/ Range Cover (except LTDs)
- Converter w/ Built in Battery Charger
- Electric Brakes (12' models)
- Tinted Vinyl Windows
- Fold Over Galley with Upper and Lower Storage
- Exterior Work Table (except LTDs)
- LP Leak Detector
- Automatic Safety Switch to Turn Off 12 Volt Current When Roof is Closed
- Large Built-In Icebox
- Drawer Guides
- One Piece Screen Door (Except LTDs)
- Port-a-Potty in 1910 Model
- A&E Awning
- Battery Box (Except LTDs)

MAC/LTD CONSTRUCTION FEATURES

- Three Stage Double Arm Lifter Posts
- Fiberglass Vacuum Bonded Radius Roof w/ No Center Seam
- Five-Piece Vinolon Supreme Tenting
- E-Z Crank Down Stabilizer Jacks w/ Sand Pads
- Full Perimeter Aluminum Bed Frames
- Plywood Bunk Ends
- Seven-Way Pigtail Wiring
- Under Floor 20 Gallon Fresh Water Tank (LTDs 10 Gallon above floor)
- Automotive E-Coated Tubular Steel Frame
- One-Piece Undercoated Structurewood Floor
- Electric Brakes (12' Models)
- Powder Coated Rafter Poles and Bed Bows
- Steel Air Conditioner Reinforcing Laminated into Roof
- 13" Radial Tires on 12' Models (12" Radial Tires on 8' & 10' Models)
- Leaf-Spring Axle
- Main Door Operational in Closed Position
- 2,000 lb. Tongue Jack w/ Swivel Wheel
- Easy Lube Axles (Except LTDs)
- Seamless, High Density Polyethylene Wheel Wells
- Battery Box and Wiring Kit
- Swing Level Galley with Storage

MAC POPULAR EXTRAS

- Create-A-Breeze Three Speed Fantastic Fan
- Thermostatically Controlled Heated Bed Mattresses
- 17,000 BTU Forced Air Furnace w/ Electric Ignition
- Large 1.9 Cubic Ft. Refrigerator
- Screen Room with Flaps
- Convenience Pkg. (Incl. Lined Privacy Curtains, Roof Valances, Patio Light, 110 Exterior Outlet)
- Travel Pkg. (Incl. Spare Tire, Tire Bracket, Tire Cover, Step)
- Shower/Cassette Option (Model 228 and 228D Incl. Water Filtration System, Six Gallon Hot Water Heater, Demand Water Pump, and Cassette Toilet)
- Overhead Kitchen Pantry
- Power Lift System
- Bike Rack
- Air Conditioner Wiring Kit
- Electric Brakes (Standard on 12' Models)
- Dual 20 Lb. LP Bottles with Cover

FLAGSTAFF MAC/LTD SERIES

MODEL	176ST	176ED	206ST	205	208	206BH	227	228	228D	176Ltd	206Ltd	BR19TH	BR23SC	BR28TSC
GVWR (Gross Vehicle Weight Rating)	2287	2259	2341	2355	2319	2383	2989	2975	3015	2278	2339	3755	2382	7208
Base/Dry Unit Weight	1574	1336	1719	1635	1569	1646	1809	1845	2079	1353	1486	2519	2677	2982
Base/Dry Hitch Weight	187	159	241	255	219	283	269	255	295	178	239	255	282	208
Base/Dry Axle Weight	1387	1177	1478	1380	1350	1363	1540	1590	1784	1175	1247	2264	2395	2774
Cargo Capacity	525	735	434	532	562	549	992	942	748	810	738	1000	917	4038
Box Size	8'	8'	10'	10'	10'	10'	12'	12'	12'	8'	10'	10'	10'	10'
Trailer Size (Closed - w/ Hitch)	14'	12'	15'11"	14'	14'	17'2"	15'11"	15'11"	15'11"	12'	14'	18'1"	22'1"	26'3"
Height (Closed)	57"	57"	57"	57"	57"	57"	57"	57"	57"	57"	57"	62.5"	62.5"	62.5"
Trailer Length (Open)	17'	17'	20'2"	20'2"	20'2"	20'3"	22'6"	22'6"	22'6"	17'	20'2"	N/A	N/A	30'3"
Interior Height	6'6"	6'6"	6'6"	6'6"	6'6"	6'6"	6'6"	6'6"	6'6"	6'6"	6'6"	6'6"	6'6"	6'6"
Travel Width	85"	85"	85"	85"	85"	85"	85"	85"	85"	85"	85"	85"	85"	85"
Tire Size - 13"R std.	12"	12"	12"	12"	12"	std	std	std	std	12"	12"	15"	15"	15"
Power Converter with Charger: Amps	25	25	25	25	25	25	25	25	25	12	12	12	12	12

LTD STANDARD FEATURES

- Spare Tire
- Awning
- Roof Vent
- Privacy Curtains
- Rear Crank Down Stabilizer Jacks w/ Sand Pads
- Outside Recep. (206 LTD only)
- Patio Light (206 LTD only)
- Step

LTD POPULAR EXTRAS

- Thermostatically Controlled Heated Bed Mattresses
- Large 1.9 Cubic Ft. Refrigerator
- 17,000 BTU Forced Air Furnace w/ Electronic Ignition
- Add-A-Room with Flaps
- Electric Brakes
- Outside Gas Grill
- Battery Box
- Power Lift

Flagstaff

MAC/LTD FLOORPLANS

176ST

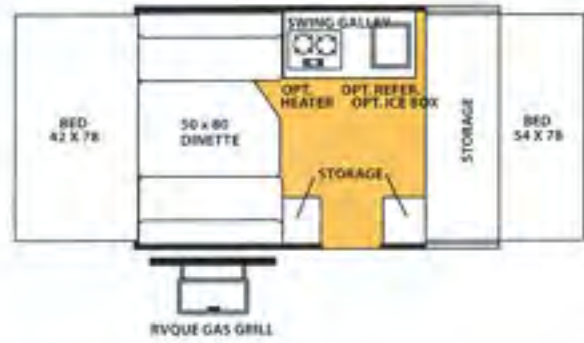

176ED



206ST

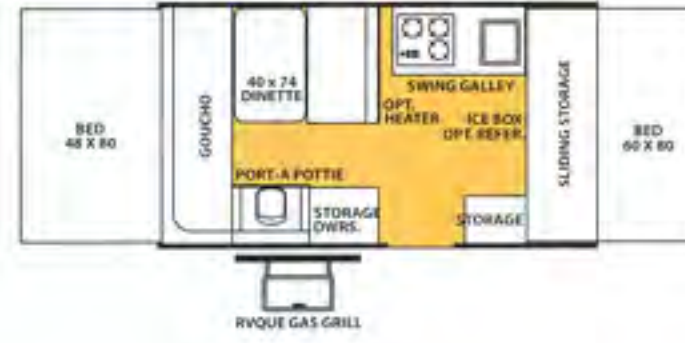

206BH

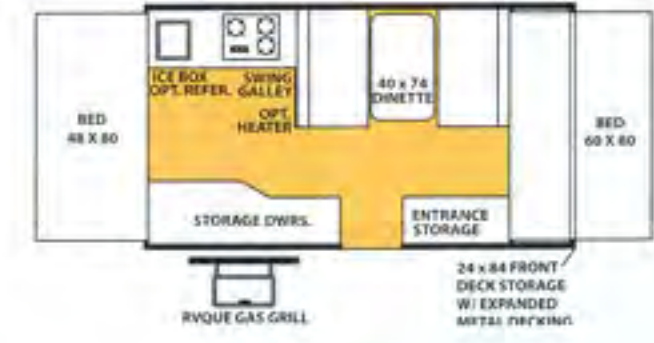

205



208



227

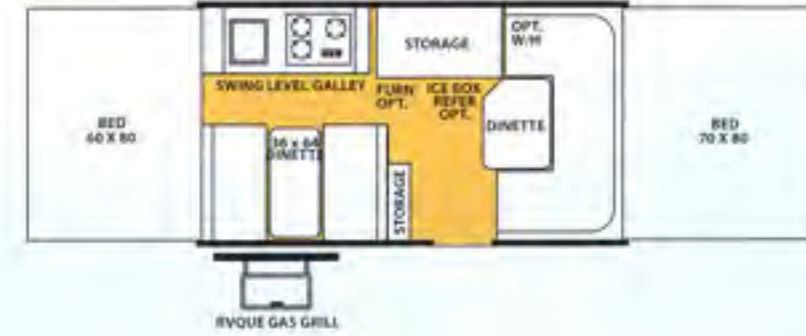

228

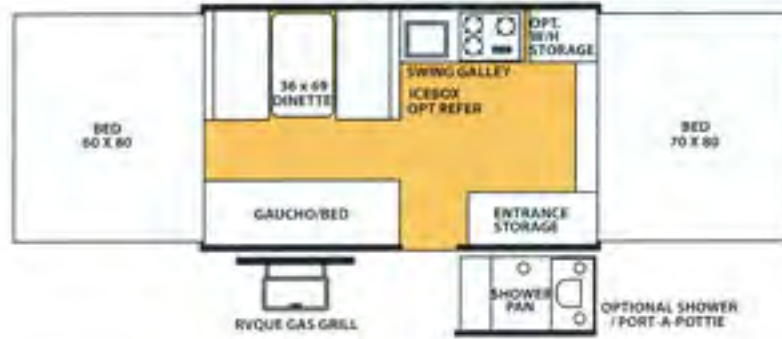

228D



176 LTD



206 LTD

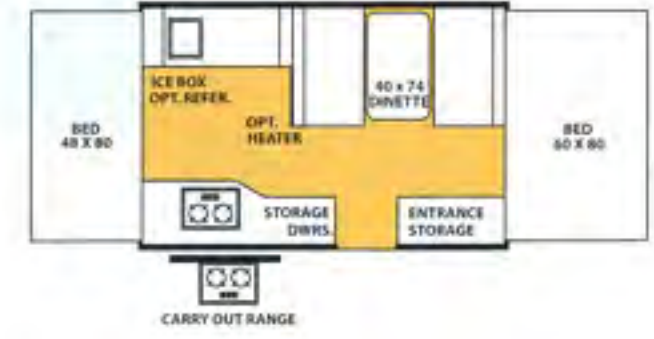

BR19TH



BR235C



BR28TSC



PEACE OF MIND.

Forest River has yet another exclusive feature to offer: One year of free roadside assistance will be given to every 2007 Flagstaff customer. This is just one more way to say "Thank you" and to ensure an enjoyable traveling experience.



FOREST RIVER'S HALLMARK OF EXCELLENCE:

PRE-DELIVERY INSPECTION FACILITIES



THAT'S 20,000 SQUARE FEET OF QUALITY ASSURANCE. THE BARE ESSENTIALS FOR A PREMIUM PRODUCT.

Brought online in 2005, Forest River is proud of its state-of-the-art test facility. This beautiful building blends many of the old tried and true methods of testing our diverse types of RVs with new innovative ways of solving quality issues. Being centrally located to most Forest River manufacturing facilities, this 20,000 square foot PDI (Pre-delivery Inspection) test building gives immediate daily feedback to individual managers. This assures the production facilities that nothing has slipped by the plant's quality assurance personnel and the units are "green" and ready to ship.

YOUR FLAGSTAFF DEALER

ROBERTS SALES
741 S. Federal Blvd.
Denver, Colo. 80219
303-922-6221
www.robertssales.com



For details on Flagstaff's complete warranty program, see your Flagstaff dealer. When it comes to backing products with the same quality and commitment it does when it begins the manufacturing process, the only name you have to remember when you're looking for a recreational vehicle is Flagstaff. Flagstaff offers the following additional limited warranties to the original purchasers. Consult written warranty for details.

1. Five-year roof warranty,
2. Twenty-five-year floor warranty,
3. Five-year frame warranty,
4. Five-year tent warranty,
5. Five-year warranty on torsion axle suspension,
6. Limited life-time warranty of lifter system,
7. One-year bumper to bumper. Ask your dealer about the available lifetime structural warranty.



All specifications contained herein are based on the latest product information at time of printing. Forest River reserves the right to make changes in colors, materials, equipment and specifications at any time without notice and assumes no responsibility for any errors in this brochure.