

AMBASSADOR®  
2009



HOLIDAY RAMBLER®  
*This is Living®*



*Ambassador*





*Ambassador*<sup>®</sup>  
2009

## THE ROADMASTER DIFFERENCE

Turn the key of the 2009 Ambassador and prepare to experience the best-in-class performance of the Roadmaster chassis. Roadmaster is the only chassis manufacturer with a 100 percent commitment to only producing chassis for luxury motorhomes. In fact, every Roadmaster chassis is custom built for the exact model and floorplan. That means you'll enjoy a smoother ride, superior front-to-rear balance and unbeatable strength and reliability. We encourage you to take a few minutes to learn more about the many features that put Roadmaster in a class by itself.



### SLIDE-OUT CONSTRUCTION:

When you purchase a Holiday Rambler, you can be sure the slide-out boxes are some of the strongest and most reliable you'll find anywhere. They feature our exclusive multi-layer construction to give you maximum insulation and to reduce the chance of warping, twisting or shifting.

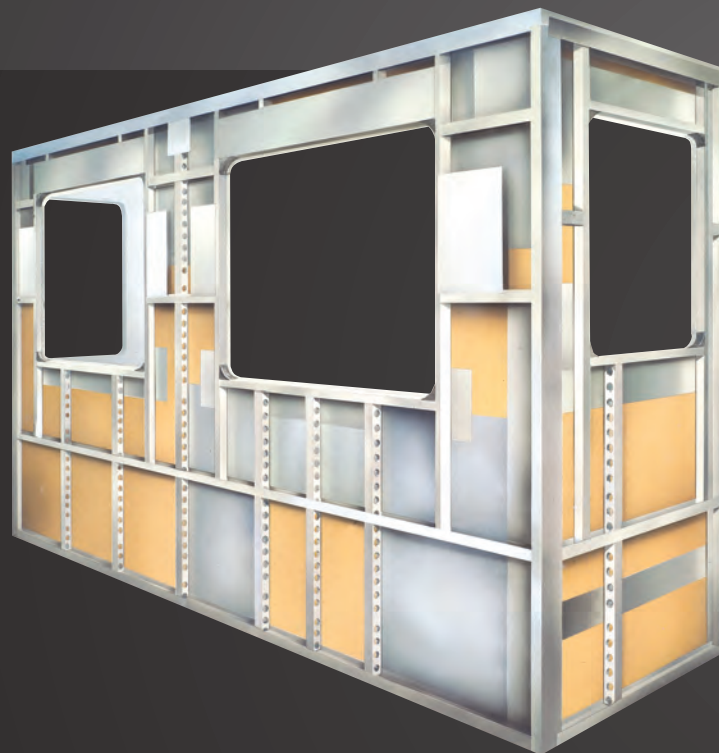

### 9-LAYER ROOF CONSTRUCTION

(top to bottom)

- One-piece peaked fiberglass roof
- Luaun backing
- Thick, tapered bead foam insulation
- Aluminum double I-beam superstructure filled with fiberglass insulation
- Vapor barrier
- Structure foam: thermal insulative barrier
- 1/2" bead foam insulation
- Foam padding for extra insulation
- Padded vinyl ceiling





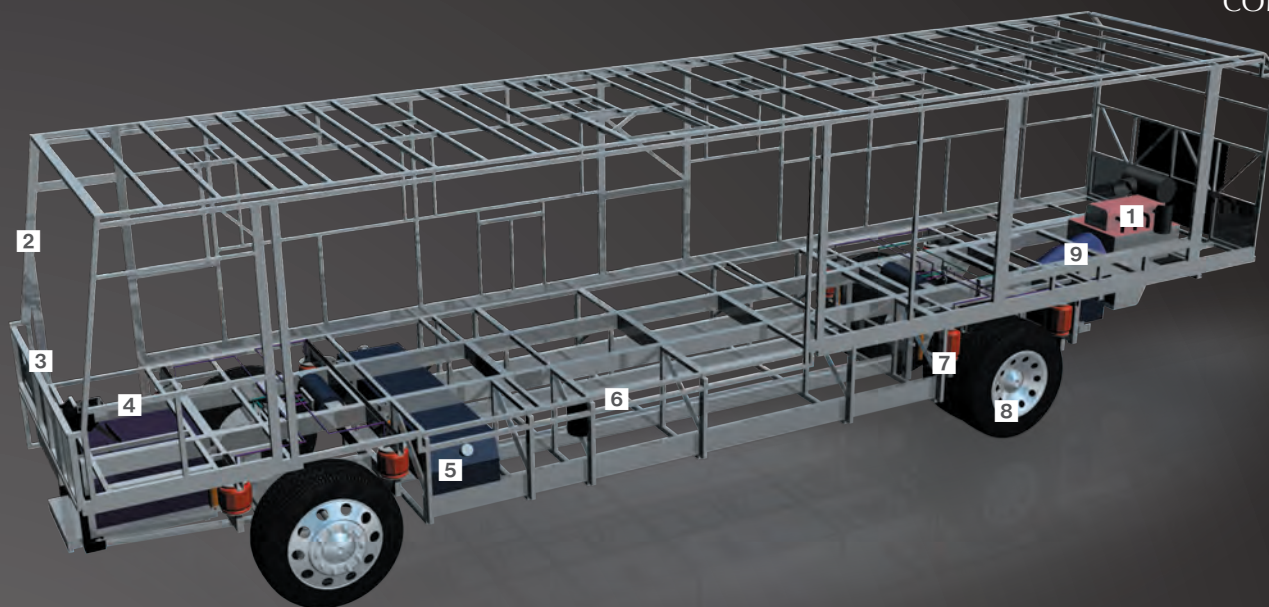

## ROADMASTER RR8R RAISED RAIL CHASSIS

- 1** The Ambassador features a gutsy standard Cummins® ISC 360 diesel engine with 1,050 lbs./ft. of torque.
- 2** A steel cage cockpit gives the Roadmaster chassis incomparable strength and safety in the front of the coach.
- 3** Every Roadmaster chassis features a steel firewall for added protection in the cockpit.
- 4** The main rails feature an exclusive raised rail design which provides for larger full pass-through storage bays with flush floors. Other highlights include a 3/8" thick frame rail — compared to the 1/4" of other manufacturers — and a stacked aluminum intercooler and radiator for optimum heat transfer and cooling.
- 5** Dual fuel fill allows you to fill the tank from either side of the coach, for greater convenience and flexibility at the pump.
- 6** This steel truss system is engineered as part of the chassis and provides outstanding strength and rigidity plus pass-through storage. In addition, the structure is pre-primed and coated with a rust-inhibiting paint.
- 7** Eight air bags work in conjunction with eight gas-charged shock absorbers to prevent road trauma from ever reaching the coach.

Ride height sensors continually adjust the air pressure at each axle to maintain a level ride and eliminate nosediving, weight transfer, and floating on curved roads. This system also stabilizes the coach on uneven surfaces.

**8** Automatic Traction Control (ATC) eliminates wheel slippage in slick conditions and heightens control. The Anti-Lock Braking System (ABS) gives you superior stopping power, especially on steep grades. Together, these sophisticated systems offer the very best safety on the road.

**9** Allison® 3000 MH 6-Speed World Transmission and electronic shifter. The three-point engine mounting system lowers the coach's center of gravity and reduces the amount of vibration that reaches the coach. The mounting also makes the engine easier to service.

A 10,000 lb. tow hitch rating is the highest in its class.



## 5-LAYER FLOOR CONSTRUCTION

(top to bottom)

- Structurwood™
- 1-1/2" x 1-1/2" square tubular frame
- High-performance thermal insulation foam
- Luaun
- 3-Ply Backer

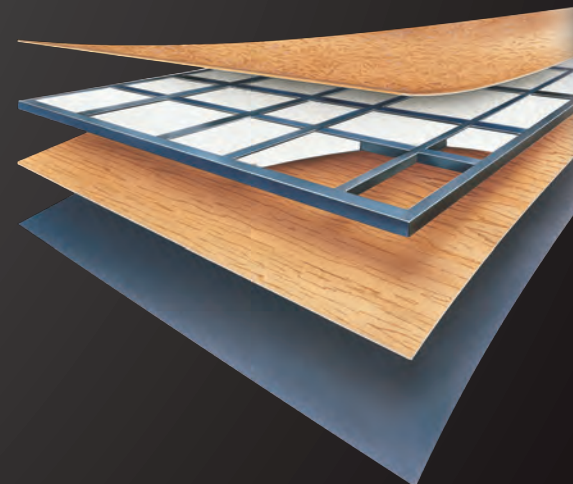





*Ambassador*<sup>®</sup>  
2009

## COLORS AND PATTERNS IN PERFECT HARMONY.

Leave it to Holiday Rambler to give you the most enticing choices of exterior colors and interior decors. Choose the one that fits your style — from

boldly sophisticated to classic elegance. Then, put it all together with your favorite cabinetry selection, and you've created a masterpiece all your own.



STARDUST II

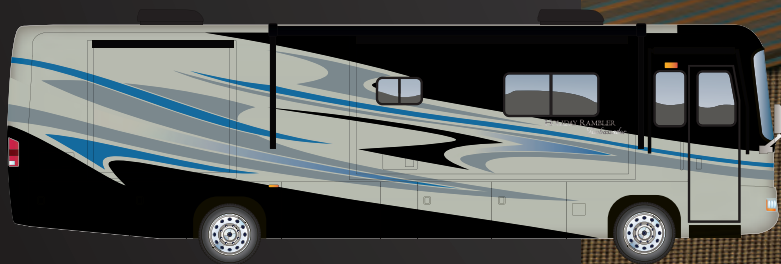

COCOA



NEWPORT CHERRY



CHAMPAGNE SELECT

UNMISTAKABLE QUALITY.

The hallmark of a Holiday Rambler is beautiful cabinetry with impeccable attention to detail. Raised panel hardwood doors provide a residential touch, while the decorative slide-out fascia trim adds elegance throughout the living areas. The storage spaces are as durable as they are attractive, with sturdy drawers and heavy-duty ball-bearing drawer guides.



TOPAZ

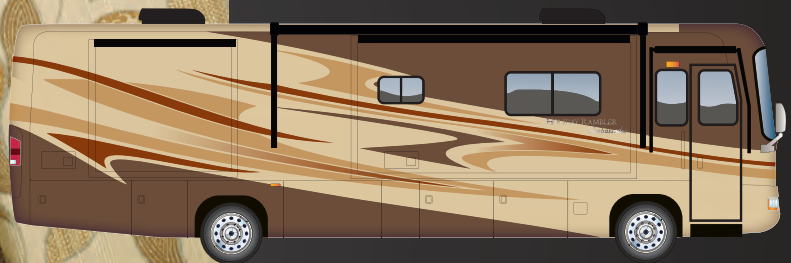

BETTER  
**STAIN**  
PROTECTION

Manufactured in, not added on. For added protection against stains, soil repellent is applied to virtually all upholstery fabric during the finishing process for superior coverage.\*

\*Brand and application of upholstery fabric protection may vary depending on date recreational vehicle was manufactured.

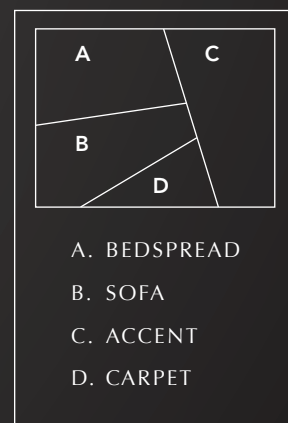





#### BODY CONSTRUCTION: FEATURES

- Steel Cage Cockpit Construction
- Peaked One-Piece Fiberglass Roof with Fiberglass Insulation
- Panaview™ 1-Piece Front Windshield
- Front and Rear Molded Fiberglass Cap
- One-Piece Generator Access Door
- Electric Flush-Floor Stepwell Cover
- Dual-Head Power-Controlled Heated Exterior Mirrors with Turn Indicator Lights
- Side-Hinged Baggage Doors
- Interior Rubber Stepwell Storage Bucket
- One-Piece Polyethylene Pass-Through Storage Compartment
- Full-Length Wheel Mud Flaps
- 3M Film Front Mask
- Deluxe Full-Body Paint
- Roof Ladder
- Undercoating

#### OPTIONS

- Full Pass-Through Storage Bay Slide-Out Tray (Complete Pass-Through)
- Slide-Out Battery Tray
- Standard Run Package: 3-Camera Vision System, Storage Bay Slide-Out Tray, Slide-Out Battery Tray, Central Vac, Exterior Tank Monitor Gauges, Keyless Entry, RV Sani-Con

#### CHASSIS/ENGINE/SUSPENSION: FEATURES

- Roadmaster Raised Rail Chassis RR8R
- Cummins® ISC 360 Engine with Allison® 3000 MH 6-Speed World Transmission and Electronic Shifter
- Engine Displacement: 8.3L/506 Cu. In.
- Torque: 1,050 lbs./ft. Max. Net at 1,400 RPM
- Aluminum Rear-Mounted Radiator with CAC Cooler
- Dual Fuel Fill
- 160 Amp Alternator
- Rear Axle Ratio: 4:30-1
- Radial Tires: 275/70R/22.5
- Polished Aluminum Wheels
- Cushion Air Glide Suspension with Eight Outboard-Mounted Air Bags and Eight Shock Absorbers
- Anti-Lock Braking System with Full Air Brake
- Automatic Traction Control
- Variable Geometry Turbo Exhaust Brake
- Auto Stack Adjusters
- Prewire for Supplemental Braking System
- Engine Block Heater
- Automatic Hydraulic Leveling System
- 10,000 Lb. Hitch Receiver with Dual Connector 4-Pin or 7-Pin

#### COCKPIT: FEATURES

- Automotive Dash with Brushed Gray Instrumentation Panel
- In-Dash AM/FM/CD Stereo Radio with Sirius-Ready Compatibility, iPod Control, Aux-In-Connection, SD Card Slot and Weather Band
- Rear Vision System with LCD Screen
- Adjustable Brake and Accelerator Pedals
- Intermittent Windshield Wipers
- 4-Spoke Steering Wheel with Horn Pad and Logo
- Air Horns
- Ultraleather™ Six-Way Power Pilot Seat
- Ultraleather™ Six-Way Power Co-Pilot Seat with Powered Footrest

#### OPTIONS

- Sirius Radio Satellite System (Requires Subscription)
- 3-Camera Rear Vision System with LCD Screen
- GPS System
- In-Dash Driver's Message Center

**APPLIANCES AND ACCESSORIES: FEATURES**

- Norcold® 12 Cu. Ft. 2-Way 4-Door Refrigerator with Ice Maker
- High-Output 3-Sealed-Burner Cooktop without Oven
- Spacesaver Convection Microwave with Touch Control
- 32" Flatscreen LCD TV in Front Cockpit Overhead (41DFT Only)
- 37" Flatscreen LCD TV in Living Area Hutch (Replaces Front Cockpit TV) (41SKQ Only)
- 37" Flatscreen LCD TV Facing Living Room Area; AV Game Plate Built into Outside of Kitchen Base Cabinet. (Replaces Front Cockpit TV) (38PKQ Only)
- 26" LCD Color TV with Remote Control in Bedroom
- Home Theater System
- Exterior Hook-Ups for DSS Dish and Cable
- CB Prep
- Digital Satellite System Prep
- Interior Cable TV Hook-Up and Telephone Jacks
- Exterior Gas Line Hook-Up for LP Accessories
- Washer/Dryer Prep

**OPTIONS**

- High-Output 3-Sealed-Burner Range with Oven
- Combination Washer/Dryer
- Domestic Sidewise 14 Cu. Ft. 2-Way Refrigerator with Ice Dispenser in the Door (41SKQ Only)

- Stainless Steel Package (Includes Stainless Steel Refrigerator and Microwave)
- Bedroom DVD Player
- Central Vacuum
- R5 KVH In-Motion Satellite (Does Not Include Receivers)
- Multi-Satellite HD KU/KA Dish (DIRECTV® Wineguard® Stationary Operation Only) (Does Not Include Receivers)
- Fireplace with Hardwood Frame (41SKQ Only)
- High-Definition Cinema Package (Sound Bar with DVD, Wireless Subwoofer and Blue Ray Player)
- Exterior Entertainment Center (32" LCD/AM/FM/CD Radio with Two Speakers) (N/A: 41SKQ)

**INTERIOR: FEATURES**

- Raised Panel Hardwood Cabinet Doors
- Refrigerator Raised Panel Hardwood Inserts
- Heavy-Duty Ball Bearing Drawer Guides
- Oil Rubbed Bronze Cabinetry Hardware and Bath Accessories
- Polished Radius Solid Surface Kitchen Countertop with Stainless Steel Sink with Two Sink Covers
- Solid Surface Radius Profile Bath Lavatory Countertop with Integrated Bowl
- All Other Countertops Laminated with Solid Surface Edge
- Solid Surface Kitchen Galley and Bathroom Lavatory Backsplash with Decorative Glass Insert
- Ceramic Tile in Kitchen and Bath
- Full Tile in Living Room (38PKQ Only)
- Tile Entry Floor
- Textured Style Nylon Carpeting with Pad in Living Area and Bedroom (N/A: 38PKQ)
- Textured Style Nylon Carpeting with Pad in Bedroom (38PKQ Only)
- Hardwood Slide-Out Fascia with Decorative Center Block
- Decorative Glass Doors for Living Room Hutch Cabinets (41SKQ Only)
- Hall Cabinet (41SKQ Only)
- Hardwood Raised Panel Bathroom Door
- Oversized Rear Wardrobe Closet with Deluxe Mirror Door Frames Oil Rubbed Bronze with Decorative Hardwood Header

- Bedroom Wardrobe Slide-Out Foot of Bed
- Decorative Window Valances
- Day/Night Pleated Blackout Shades in Living Area and Bedroom; EZ Lift Mini Blinds in Kitchen and Private Bath
- Soil Repellent Protection on Fabric
- Center Island with Full-Length Flip-Down Countertop Extension (38PKQ Only)
- Pullout Countertop Extension with Drawers and Corian® Top (38PKQ Only)

**OPTIONS**

- Decors: Topaz, Cocoa, Stardust II
- Full-Tile Living Room (N/A: 38PKQ)
- Wood Choices: Newport Cherry, Champagne Select

**FURNITURE: FEATURES**

- Queen Bed with Overhead Cabinet and Nightstands
- Arched Back Wood Booth Dinette with Side-Sliding Dinette Tabletop (41SKQ Only)
- Freestanding Dinette with Full-Length Wall Cabinet, Two Freestanding Chairs and Two Folding Chairs (41DFT Only)
- Wood Pedestal Dinette Table with Extension, Two Freestanding Chairs and Two Folding Chairs (38PKQ Only)
- Roadside: Fabric Easy Bed Sofa
- Curbside: Fabric Easy Bed Sofa (N/A: 38PKQ)

**OPTIONS**

- Queen Bed Select Comfort Air Mattress
- Roadside: Ultraleather™ Easy Bed Sofa
- Roadside: Fabric Hide-A-Bed Sofa with Air Mattress
- Roadside: Ultraleather™ Hide-A-Bed with Air Mattress
- Roadside: Wraparound Computer Desk with Ultraleather™ Euro-Recliner (41SKQ Only)
- Roadside: Ultraleather™ Booth Dinette Ensemble with Easy Bed Sofa (41SKQ Only)

- Roadside: Ultraleather™ Sectional Hide-A-Bed Sofa with Air Mattress (38PKQ Only)
- Roadside: Two Leather Euro-Recliners with Table (41SKQ Only)
- Curbside: Ultraleather™ Easy Bed Sofa (N/A: 38PKQ)
- Curbside: Ultraleather™ Hide-A-Bed Sofa with Air Mattress (N/A: 38PKQ)
- Freestanding Dinette with Full-Length Wall Cabinet, Two Freestanding Chairs and Two Folding Chairs (41SKQ Only)



#### ELECTRICAL SYSTEMS AND LIGHTS: FEATURES

- 50 Amp 12V Distribution Panel and Power Cord
- Energy Management System
- 2,000-Watt Inverter
- Onan<sup>®</sup> 8.0 kW QD Diesel Generator
- Four 6V House Batteries
- Two 12V Heavy-Duty Chassis Batteries
- Battery Disconnect Switch at Front Door
- Porch Light and Exterior Step Light on Same Switch
- Exterior Power Entry Step with Light
- Interior Stepwell Entry Step Lights
- Lights in Outside Storage Compartments
- 120V Receptacles in Outside Storage Compartment
- Underhood Utility Light
- Convenience Center in Hallway
- Decorative Lighting

#### OPTIONS

- Exterior Tank Monitor Gauge in Wet Bay

#### PLUMBING AND LP SYSTEMS: FEATURES

- Single-Lever Kitchen Faucet with Pullout Sprayer
- Chocolate Finish Bath Lavatory Faucet
- Central Water Filtration System
- Demand Water System and Water Pump
- Water Pump Switch in Convenience Center, Kitchen Galley and Service Bay Area
- 10-Gallon LP Gas/Electric Water Heater with Electronic Ignition, DSI
- Winterization Valving System
- Water Heater Bypass Valving
- China Toilet Electronic Silent Plus (41DFT Only)
- China Toilet Electronic Silent Plus (41SKQ Only)
- China Toilet (N/A: 41SKQ)
- Holding Tank Rinsing System
- Insulated Systems Compartment with Easy Access to Hook-Up
- Shower inside Wet Bay with Hot/Cold Water
- Gravity and Pressurized Water Fill
- One-Piece Neo-Angled Shower with Obscured Glass Door (41DFT Only)
- One-Piece Round Shower (N/A: 41DFT)

- Oil Rubbed Bronze Shower Faucet with Slide Bar and Shut-Off Valve at Shower Head

#### OPTIONS

- RV Sani-Con 1 System – Holding Tank Flush System (Replaces Contained Storage Area for Sewer Hose)
- Power Water Hose Reel
- Neo-Angled Bathtub

#### HEATING, VENTS AND AIR CONDITIONING: FEATURES

- Dual BTU Roof Air Conditioner with Ducted Air, Heat Pumps and Digital Thermostat Control
- Electronic Ignition Furnace
- Electronic AC/Heat Climate Control System
- Kitchen Powered 12V Attic Fan with Wall Control of Automatic Dome and Fan Power
- Bath Powered 12V Attic Fan with Wall Control of Automatic Dome and Fan Power
- 12V Heater in Wet Bay

#### OPTIONS

- Ceiling Fan in Bedroom



**WINDOWS, DOORS AND AWNINGS: FEATURES**

- Radius Flush-Mounted Dual Pane Safety Glass Dark Tinted Slider Windows
- Automatic Front Door Awning
- Front Entry Door with Removable Screen and Anti-Skid Steps
- Automatic Patio Awning
- Topper Slide-Out Awnings Living Area and Bedroom
- Window Awnings on All Slide-Out House Windows except Kitchen Windows and Slide-Out Windows under Patio Awning
- Tinted Skylight in Bathroom with Protecta Glaze

**OPTIONS**

- Keyless Entry (Key Fob Only)

**SAFETY: FEATURES**

- Fire Extinguisher (10BC)
- Deadbolt Lock on Entrance Door
- 120V GFI Protected Circuit Kitchen, Bath and Exterior
- LP Gas Detector
- Smoke Detector
- Carbon Monoxide Detector
- Driver and Passenger Three-Point Seatbelts (Wall-Mounted)
- Third Brake Safety Light
- Egress Window (One in Bedroom)

Due to continuous product improvement, please see the website for the latest in standards and options, specifications, and technical data. Go to [www.holidayrambler.com](http://www.holidayrambler.com).

Weights*	38PKQ	41SKQ	41DFT
Gross Vehicle Weight Rating	33,000	33,000	33,000
Gross Combined Weight Rating	43,000	43,000	43,000
Front Gross Axle Weight Rating	13,000	13,000	13,000
Rear Gross Axle Weight Rating	20,000	20,000	20,000
Measurements			
Wheelbase	237"	273"	273"
Overall Length	38' 11"	41' 11"	41' 11"
Overall Height with A/C (w/o DSS option)	12' 6"	12' 6"	12' 6"
Interior Height	84"	84"	84"
Interior Width	94.5"	94.5"	94.5"
Exterior Width	100.5"	100.5"	100.5"
Tank Capacities** (Gal.)			
Water Heater	10	10	10
Gray Tank	62	62	62
Black Tank	40	40	40
Fresh Tank	100	100	100
LP Tank ***	39	39	39
Fuel Tank	100	100	100

\* Towing capacity is limited by GCWR; your vehicle's towing capacity is the difference between the GCWR and the actual vehicle weight, including all water, fuel, passengers and cargo. Your towed vehicle should be equipped with auxiliary brakes if the weight of the towed vehicle exceeds 1,000 lbs. Consult your owner's manual for further towing information.

\*\* All tank capacities are estimated based upon calculations provided by the tank manufacturers and represent approximate capacities. The actual "usable capacity" may be greater or less than the estimated capacities based upon fabrication and installation of the tanks.

\*\*\* Actual filled LP capacity is 80% of listing due to safety shut-off required on tank.

The actual overall length of the recreational vehicle may differ from that indicated in the brochure due to variances in the manufacturing process and/or installed components. The actual length may be greater or less than that indicated. Due to the large variety of options and floorplan arrangements available to our customers, actual weights for each unit can differ significantly. Holiday Rambler provides a weight sticker on each unit we produce which includes that unit's tank capacities and approximate weight. Consult your local Holiday Rambler dealer for unit availability and further information. The information printed in this brochure reflects product design, fabrication, and component parts at the date of printing. The manufacturer reserves the right, at any time, to make changes in product design or material or component specifications as its sole option, without notice. This includes the substitution of components of a different brand or trade name which will result in comparable performance. All information printed in this brochure is subject to change after the date of printing. Some features shown or mentioned in this brochure are optional and may only be available in selected floorplans. Photographs may show props or decorations that are not standard equipment on Holiday Rambler models. Holiday Rambler, the Holiday Rambler logo and its design, are registered trademarks. All other products and company names are trademarks and/or registered trademarks of their respective holders. While the color of the motorhome's exterior and the interior fabrics depicted in this sales brochure are fair and reasonable depictions, the colors depicted may not be an exact match of the actual colors because of the variances in photo-processing and variances caused by inserting the photographs within the sales brochure. Due to product improvements, changes during the model year and/or transcription errors that may occur, information represented within this brochure may not be accurate at the time of your purchase. If certain information is significant to your purchasing decision, please confirm the information with your dealer prior to submitting your order. Component part and appliance manufacturers issue limited warranties covering those portions of the recreational vehicle not covered by the Limited Warranties issued by Monaco Coach Corporation. To learn which specific component parts and appliances are excluded from the Limited Warranties issued by Monaco Coach Corporation, please contact your selling dealership or Monaco Coach Corporation directly, or review the warranty packet inside the recreational vehicle.



38PKQ

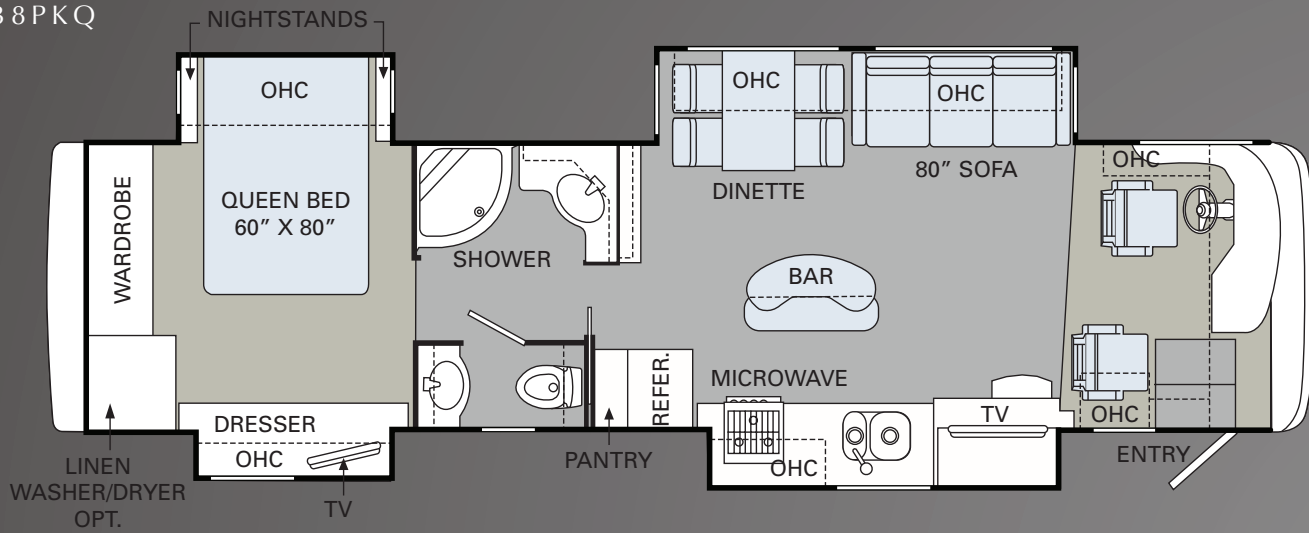

41SKQ

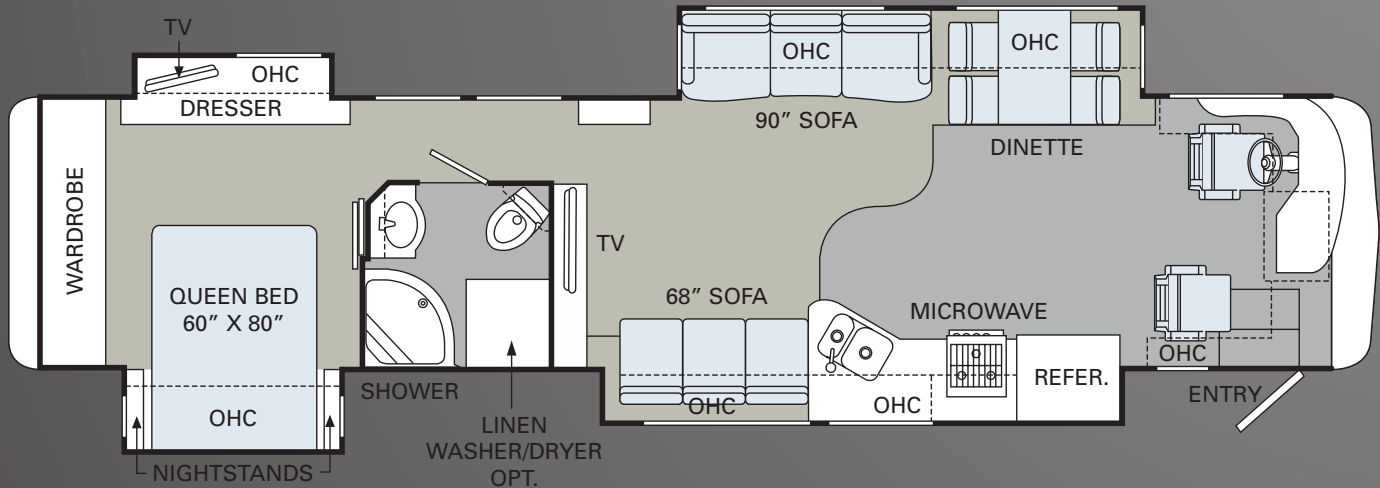

41 DFT

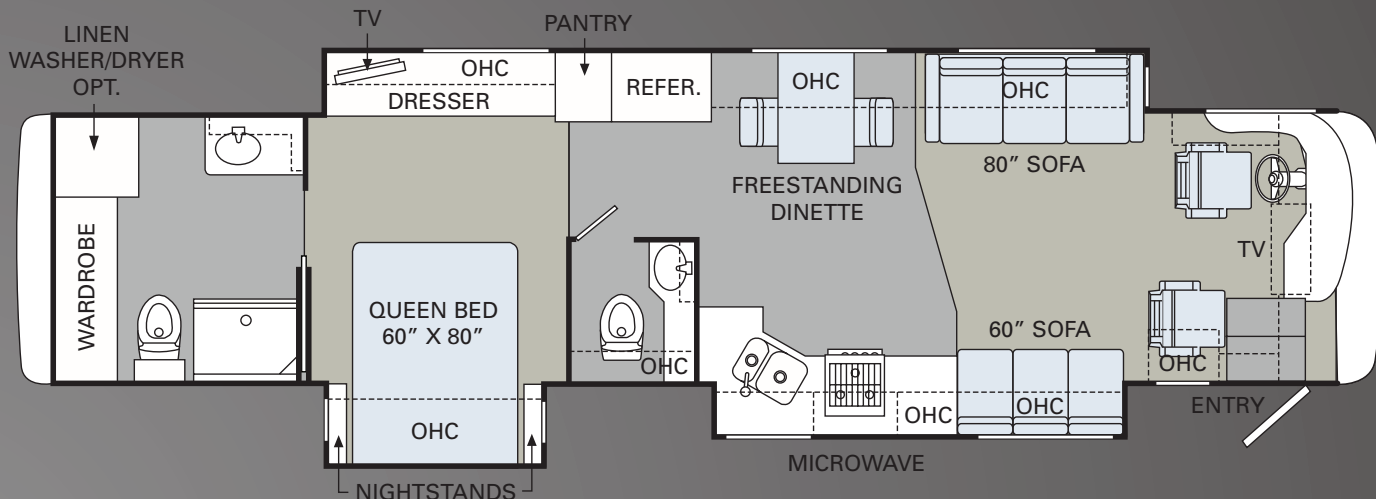

H O L I D A Y R A M B L E R . C O M

Log on to our website anytime, night or day. It's your link to everything Holiday Rambler, including product news and updates, club events, dealer and service center info and much more. Take it for a test drive today.



WE'RE HERE. ANYTIME, EVERY TIME.

- Reach us anytime — literally — via our live customer support line.
- Drive in to one of our 350 Service Centers.
- Enjoy the first year free when you enroll in our Owner Advantage Roadside Assistance Program.
- See where it all begins with a tour of one of our facilities in Indiana or Oregon. Call 1-800-650-7337 or 1-800-634-0855 to find out more.



AMBASSADOR®  
2009



HOLIDAY RAMBLER®  
*This is Living*

## BEING DIFFERENT MAKES ALL THE DIFFERENCE.

Take a closer look, and you'll discover that Holiday Rambler, a brand of Monaco Coach Corporation, gives you more industry "bests" than any other RV manufacturer. Like the incomparable ride and handling of the Roadmaster Chassis. The convenience of our 350 service centers. The peace of mind of 24/7 roadside assistance. The value of Monaco Financial Services. And the online support of holidayrambler.com. At Holiday Rambler, we've built our reputation by listening to you — and answering to you. And that's the difference that's made us the best.

## WARRANTIES

12 MONTH/24,000 MILE basic limited warranty

5 YEAR/50,000 MILE limited warranty on aluminum or steel frame structure of sidewall, roof, front and rear cap

3 YEAR/50,000 MILE limited warranty on Roadmaster chassis

Applies to certain models. See owner's manual for complete details.

NAVIGATOR®



IMPERIAL™



SCEPTER®



ENDEAVOR®



AMBASSADOR®



NEPTUNE®



VACATIONER XL®



ADMIRAL®



ARISTA™



ATLANTIS®



AUGUSTA



606 Nelson's Parkway, Wakarusa, IN 46573 | 800 245-4778 | [www.holidayrambler.com](http://www.holidayrambler.com)

Monaco Coach Corporation is traded on the NYSE under the listing MNC. | 0608 NPN: BROMAMB