

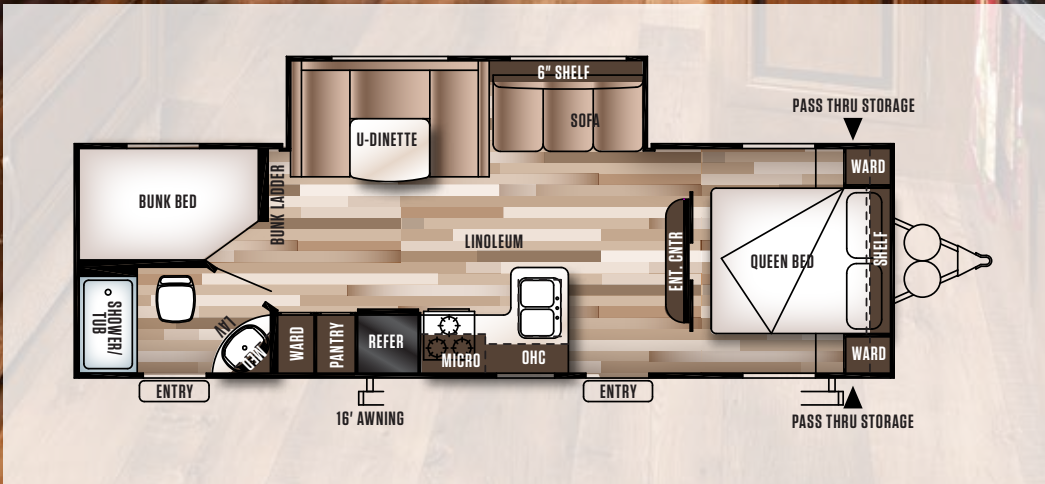

360° OF  
AWESOME





WIDE OPEN LIVING ROOM

WILDWOOD XLITE  
**263BHXL**

SHOWN IN TIFFANY LEATHER DÉCOR

**5,816 LB.**

*Shown with Standard Beauflor®  
Plank Wood Linoleum & Optional TV*

## Definition of **AWESOME:**

Extremely  
impressive,  
excellent,  
amazing,  
fantastic,  
cool.

### WILDWOOD XLITE BOASTS SOME AWESOME FEATURES

- 1 AM/FM radio, DVD player with MP3 hookup
- 2 2 inch wood blinds (living area)
- 3 Shoe nook (Some models)
- 4 Double-stitched pillow back jiffy sofa
- 5 "High definition" countertops
- 6 New roomier living room slides with deeper sides
- 7 New Beauflor® plank wood linoleum



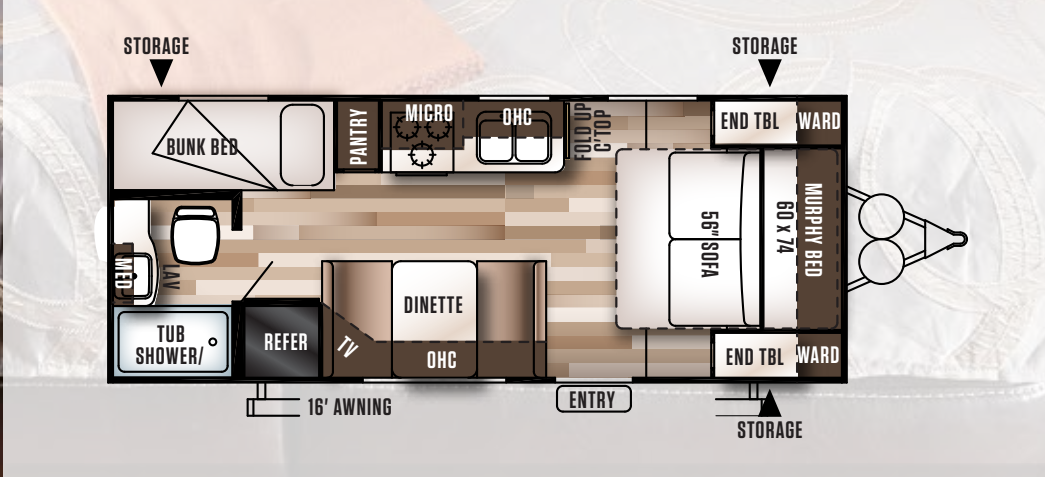

WILDWOOD XLITE  
**201BHXL**

SHOWN IN TIFFANY LEATHER DÉCOR

**4,105 LB.**

**AMERICA'S** best selection of  
quality-built and affordable  
travel trailers



**AERODYNAMIC, EFFICIENT & EASY TO MANEUVER**



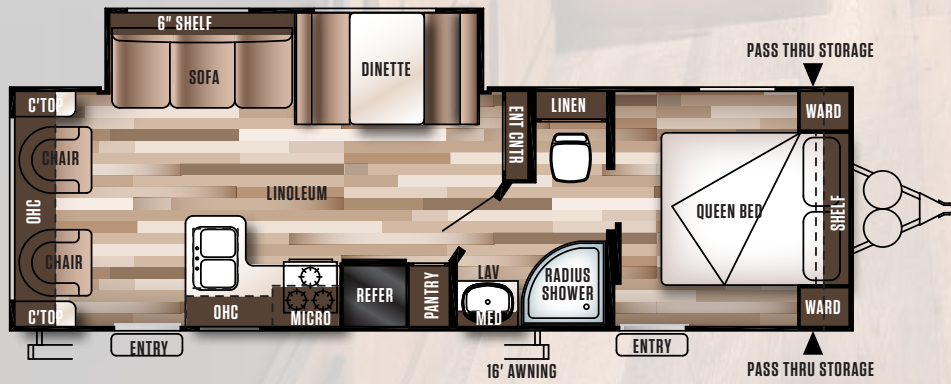

WIDE OPEN LIVING ROOM

WILDWOOD XLITE  
**254RLXL**

SHOWN IN ONYX DÉCOR

**5,597 LB.**

*Shown with Standard Beauflor®  
Plank Wood Linoleum & Optional TV*

**ISN'T IT TIME** you treated  
your family to an extra  
degree of **AWESOME?**



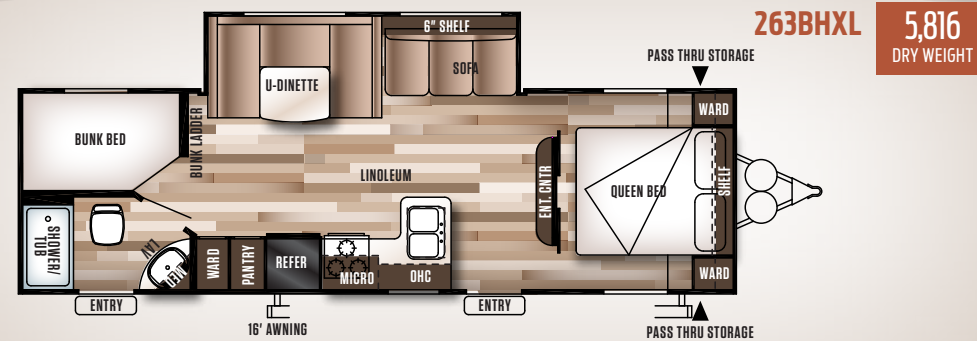
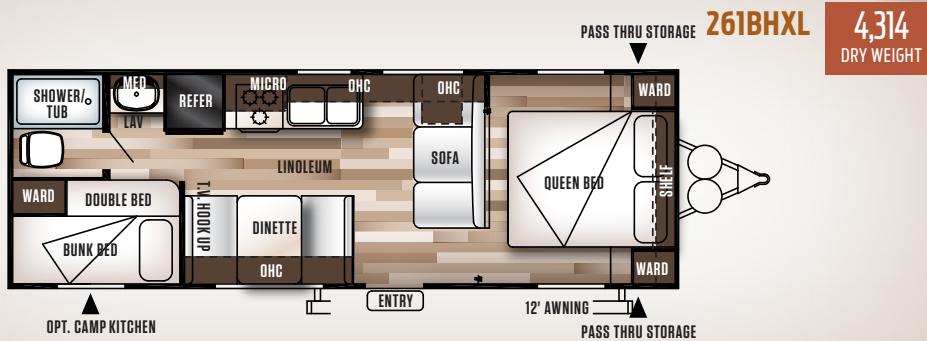
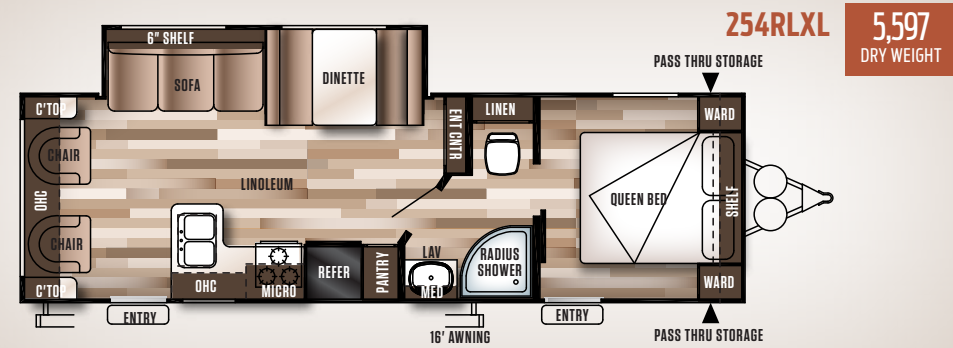
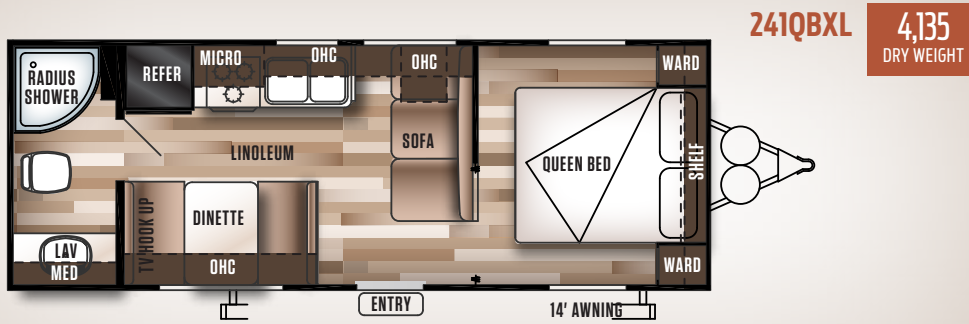
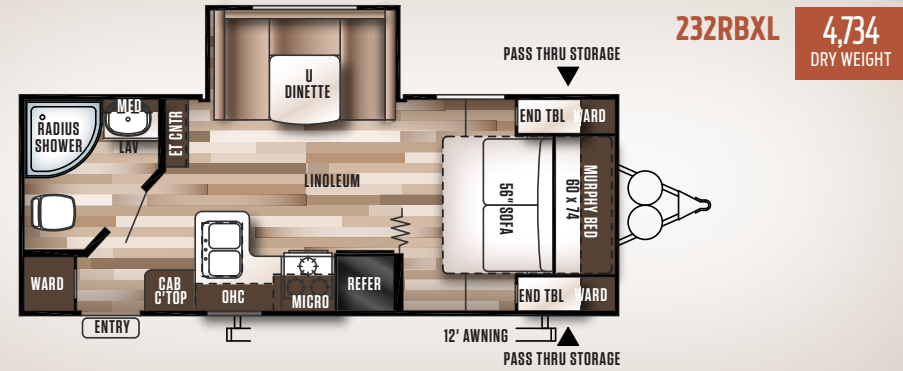
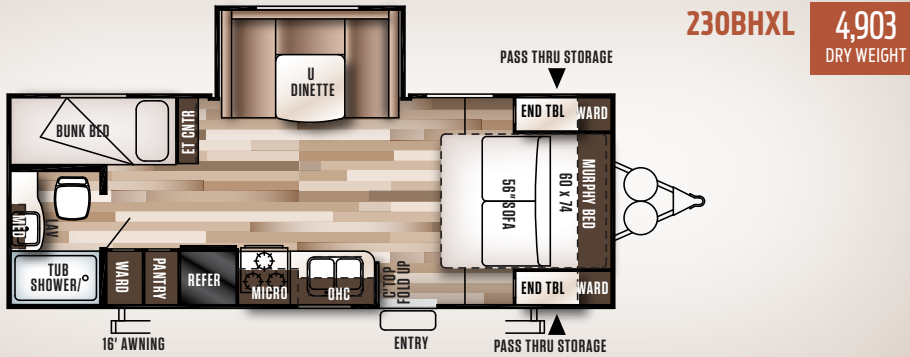
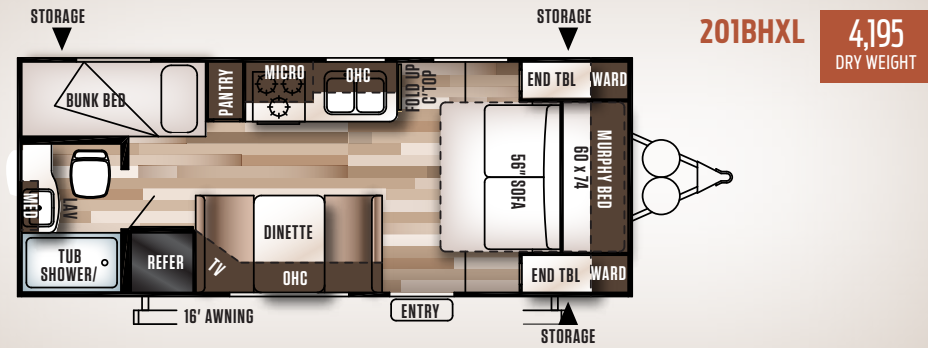
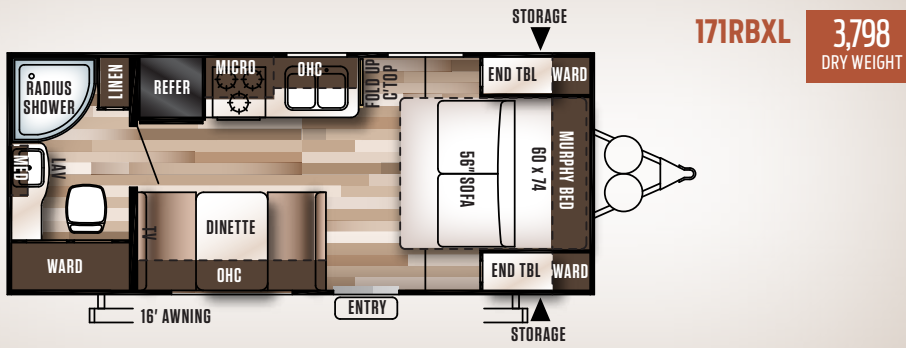



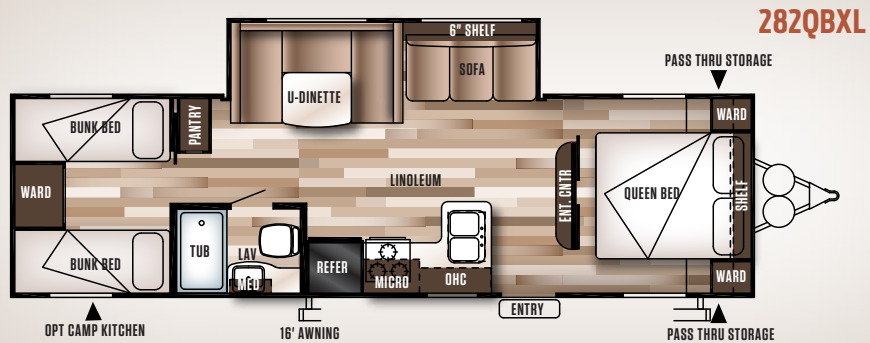
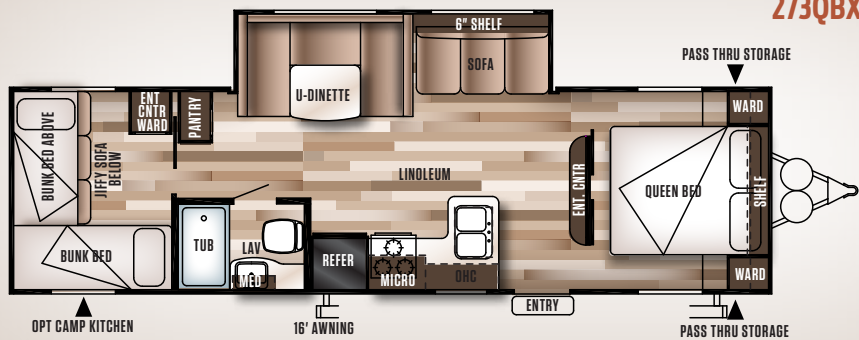
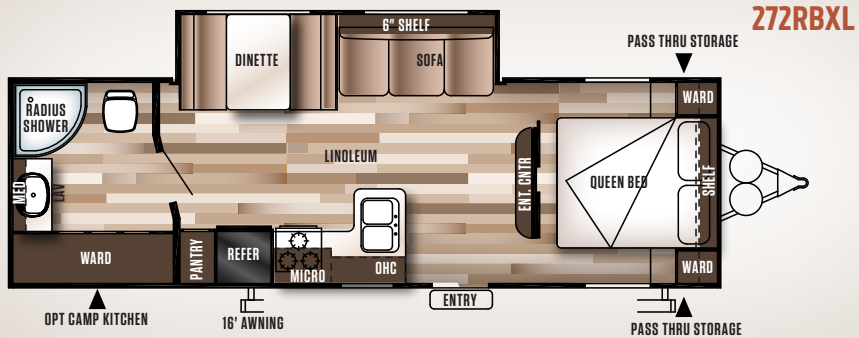

WE FOCUS ON VALUE. YOU NEED TO CHECK OUR PRICES.  
**STANDARDS & OPTIONS**

**STANDARD FEATURES**

- 3 burner cook top
- 13.5K AC (non-ducted)
- Diamond plate rockguard on front wall
- Digital TV antenna w/ booster
- Cable/ Satellite ready
- Radio w/ CD player 2 exterior speakers
- 2-20# LP bottles w/ hard cover
- Extra large kitchen overhead cabinets
- Microwave
- Water heater by-pass
- Mini-blinds
- Kitchen backsplash
- Refrigerator
- Ball bearing drawer guides
- 6 gal. gas DSI water heater
- Radius shower enclosure (per floorplan)
- Pass thru storage
- Awning
- Bedspread for main bed

**POPULAR OPTIONS**

- Double door refer IPO single door
- Stabilizer jacks
- Range w/ oven IPO cook top
- Spare tire & carrier
- Ducted A/C
- Outside camp kitchen (Model determined)
- Power awning
- Colored LED awning light w/ remote (Limited time option)
- Four corner power stabilizer jacks

	171RB	201BH	230BH	232RB	241QB	254RL	261BH	263BH	272RB	273QB	282QB
HITCH WEIGHT (LBS.)	521	528	694	620	499	668	434	682	617	680	636
UNLOADED VEHICLE WEIGHT (LBS.)	3798	4195	4903	4734	4135	5597	4314	5816	5863	5937	6155
CARGO CARRYING CAPACITY (LBS.)	3685	3295	2753	2848	3326	2033	3082	1828	1716	1724	1443
EXTERIOR LENGTH	22'5"	23'7"	25'10"	24'7"	26'11"	31'3"	29'1"	31'5"	31'0"	33'3"	32'11"
EXTERIOR HEIGHT	9'11"	9'11"	10'4"	10'4"	9'11"	10'4"	9'11"	10'4"	10'4"	10'4"	10'2"
FRESH WATER CAPACITY (GAL.)	40	40	40	40	40	40	40	40	40	40	40
BLACK WATER CAPACITY (GAL.)	30	32	40	32	30	43	30	32	43	34	34
GREY WATER CAPACITY (GAL.)	30	32	40	43	40	32	28	64	32	32	66
AWNING SIZE (FT.)	16'	16'	16'	12'	14'	16'	12'	16'	16'	16'	16'



FACTORY SELECT

# 195BH

SHOWN IN TIFFANY LEATHER DÉCOR

**3,003 LB.**

*Shown with Standard Beauflor®  
Plank Wood Linoleum*

# Factory Selects

## STANDARD FEATURES

- 8' wide construction
- Full interior stand up height
- 8k BTU side mount A/C
- 4.3 cu. ft. electric fridge
- Full extension ball bearing drawer guides
- Microwave
- Cold crack and mildew resistant vinyl patio awning
- One piece, full walk-on seamless roof (12 yr. warranty)
- 28 gal. fresh water tank
- 6 gal. gas DSI water heater (Push Button)

- Controlled)
- Truss built roof with "walk-on" decking
- 2 burner cook top
- Large operable windows w/ mini blinds

## OPTIONAL FEATURES

- Stabilizer jacks
- Spare tire & carrier
- RV refer IPO electric refer
- TV antenna

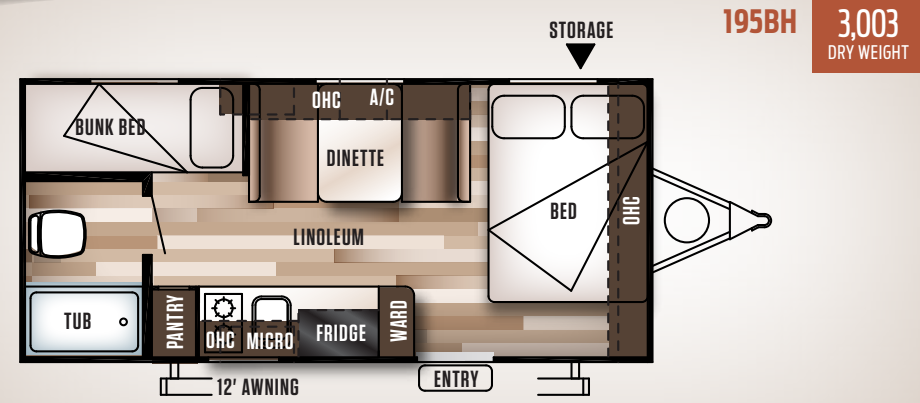
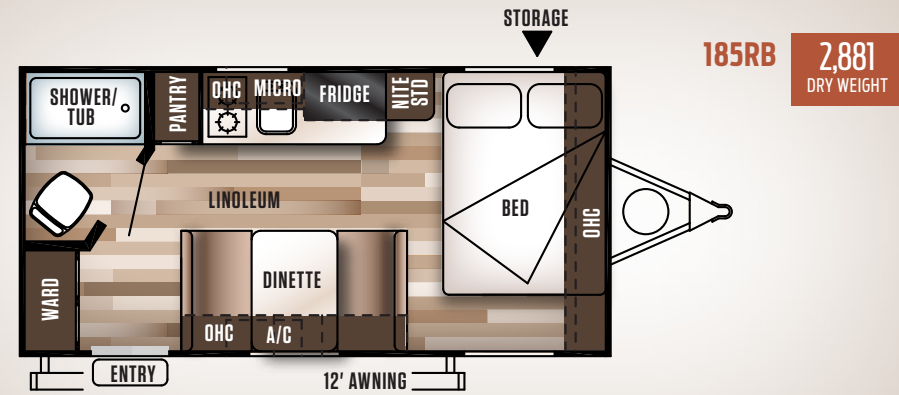

	185RB	195BH
HITCH WEIGHT (LBS.)	328	403
UNLOADED VEHICLE WEIGHT (LBS.)	2881	3003
CARGO CARRYING CAPACITY (LBS.)	928	881
EXTERIOR LENGTH	19'10"	21'5"
EXTERIOR HEIGHT	10'4"	10'4"
FRESH WATER CAPACITY (GAL.)	28	28
BLACK WATER CAPACITY (GAL.)	25	25
GREY WATER CAPACITY (GAL.)	25	25
AWNING SIZE (FT.)	14'	14'

- WILDWOOD**
- FLOOR PLAN KEY**
- OHC** OVERHEAD CABINET
  - WARD** WARDROBE
  - MICRO** MICROWAVE
  - LAV** BATHROOM SINK

*Pillows and blankets shown on beds and bunks are for demonstration purposes only and do not come with your new coach.*



### PRE-DELIVERY INSPECTION FACILITY

20,000 square feet of quality assurance. The bare essentials for a premium product. This state-of-the-art facility gives immediate daily feedback to production for quality assurance in every unit built.



Forest River, Inc. encourages our customers to purchase their Forest River products from a local dealership whenever possible for the following reasons:

- 1) Forest River, Inc. dealers are independently owned and operated businesses so priority service and scheduling is at their discretion and is often provided to customers that purchased their unit at that dealership.
- 2) Purchasing locally allows customers to establish meaningful relationships with a dealer, enhancing the RV experience through assistance with product questions, user tips or RV regulations for your state or country, and much more!
- 3) Canadian customers must meet requirements to bring an RV purchased out of the country to their home. These requirements may involve additional inspections and certifications, taxes and fees. Your local Canadian Dealer is a professional at meeting these requirements.
- 4) Scheduling timely warranty repairs and adjustments through a local dealership provides far greater flexibility and convenience to you, the customer!

It is the goal of Forest River, Inc. that all of our RV owners fully enjoy the RV experience and that customer satisfaction meets or exceeds their expectations!

### 24/7 EMERGENCY ROADSIDE ASSISTANCE

For a worry-free ownership experience Forest River includes one year of Coach-Net RV Technical & Roadside Assistance with each RV purchase. Whether new to the RV lifestyle or an experienced RV enthusiast, Forest River owners have 24/7 access to technical, operational and emergency road service coverage throughout the US & Canada. Coach-Net's fast, dependable service is just a phone call away.

**Coach-Net<sup>®</sup>**  
RV Technical & Roadside Assistance

## THE WILDWOOD LINE-UP



## Wildwood Heritage Glen



WILDWOOD

**DLX**

WILDWOOD

**LODGE**



**Learn More**  
Scan this barcode using a QR Reader on your smart phone to learn more about Forest River.



A Berkshire Hathaway company.

FOREST RIVER, INC. 55470 C.R. 1 ELKHART, IN 46515 | (574) 533-5934

WWW.FORESTRIVERINC.COM/WILDWOOD | WWW.FORESTRIVERACCESSORIES.COM

**FREE MEMBERSHIP**  
to Forest River Owners' Group

www.forestriverfrog.com



### Specification Definitions

**GVWR (Gross Vehicle Weight Rating)** - is the maximum permissible weight of the unit when fully loaded. It includes all weights, inclusive of all fluids, cargo, optional equipment and accessories. For safety and product performance do NOT exceed the GVWR.

**GAWR (Gross Axle Weight Rating)** - is the maximum permissible weight, including cargo, fluids, optional equipment and accessories that can be safely supported by a combination of all axles.

**UVW (Unloaded Vehicle Weight)\*** - is the typical weight of the unit as manufactured at the factory. It includes all weight at the unit's axle(s) and tongue or pin and LP Gas. The UVW does not include cargo, fresh potable water, additional optional equipment or dealer installed accessories.

\*Estimated average based on standard build optional equipment.

**CCC (Cargo Carrying Capacity)\*\*** - is the amount of weight available for fresh potable water, cargo, additional optional equipment and accessories. CCC is equal to GVWR minus UVW. Available CCC should accommodate fresh potable water (8.3 lbs per gallon). Before filling the fresh water tank, empty the black and gray tanks to provide for more cargo capacity.

\*\* Estimated average based on standard build optional equipment

Each Forest River RV is weighed at the manufacturing facility prior to shipping. A label identifying the unloaded vehicle weight of the actual unit and the cargo carrying capacity is applied to every Forest River RV prior to leaving our facilities.

The load capacity of your unit is designated by weight, not by volume, so you cannot necessarily use all available space when loading your unit.

All information contained in this brochure is believed to be accurate at the time of publication. However, during the model year, it may be necessary to make revisions and Forest River, Inc., reserves the right to make all such changes without notice, including prices, colors, materials, equipment and specifications as well as the addition of new models and the discontinuance of models shown in this brochure. Therefore, please consult with your Forest River dealer and confirm the existence of any materials, design or specifications that are material to your purchase decision. Litho. U.S.A P/W: 2015.12.12

YOUR WILDWOOD DEALER

2016