

Winnebago Minnie Winnie





Rolling Along.



There is something about the flow of a river that thoroughly satisfies our need to travel. In a Winnebago® Minnie Winnie®, you can experience this same sense of satisfaction on the road.

Over the years,

thousands of travelers have made Minnie Winnie the most popular class C motor home in America. Because every year, Minnie Winnie gives them more standard features, more quality and more value.

From the economical

319 to the spacious 26RT, you'll find that Minnie Winnie's popularity is well deserved.

Come explore the joys of owning a Minnie Winnie. You'll discover a motor home that fits the flow of your life.

While 2/3 of the earth is covered with water, only 1/4,000 of that water is found in rivers. Yet rivers are vital to our food chain and transportation system and hold a prominent place in the literature and folklore of our civilization.



Minnie Winnie 26RT

Adventure At Every Bend.

At every bend, rivers take on a new personality. Each portion having its own spirit and beauty. The

same is true of roads. And in a Minnie Winnie, you have a vehicle that allows you to take advantage of

all the new opportunities a road will put before you.

Because the road to adventure isn't easy on

a motor home, you need Minnie Winnie's technology, craftsmanship and quality. Its parts have gon

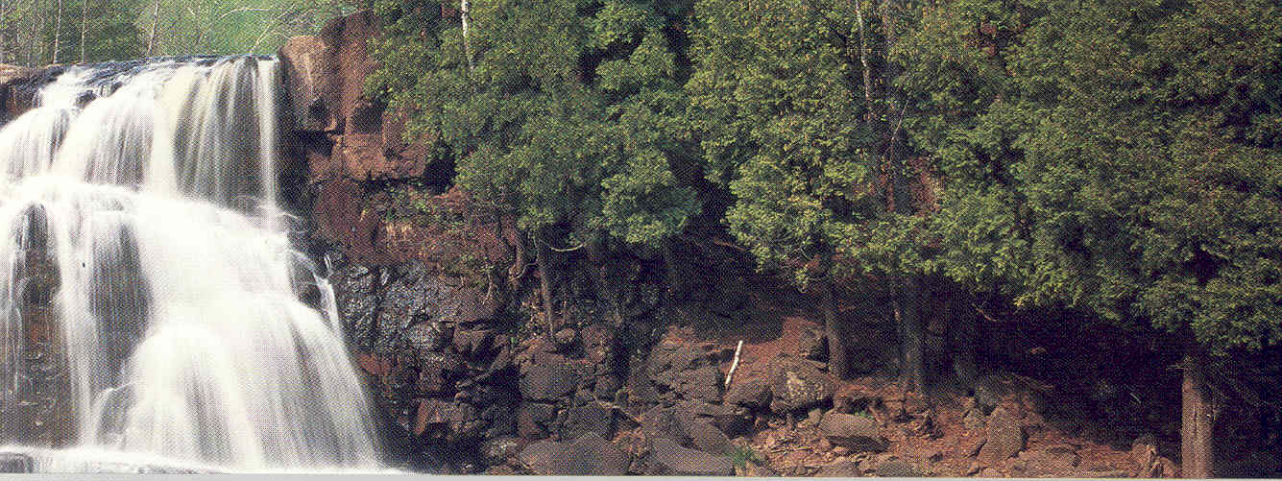

through rigorous testing. The chassis has been fine-tuned with leveling rails. And it's the only motor home in its class to pass Winnebago's drop test.

Behind the wheel, a driver will find the features that make driving a plea-

sure. The fabric covered seats swivel and slide. The steering wheel tilts. And this year, special driver amenities like automotive air conditioning, cruise control and a deluxe trim are standard on many models.

And throughout the Minnie Winnie, ample storage space allows you to bring more with you, to get more out of your travels.

Test drive a Minnie Winnie. Experience the way it creates adventure at every turn.

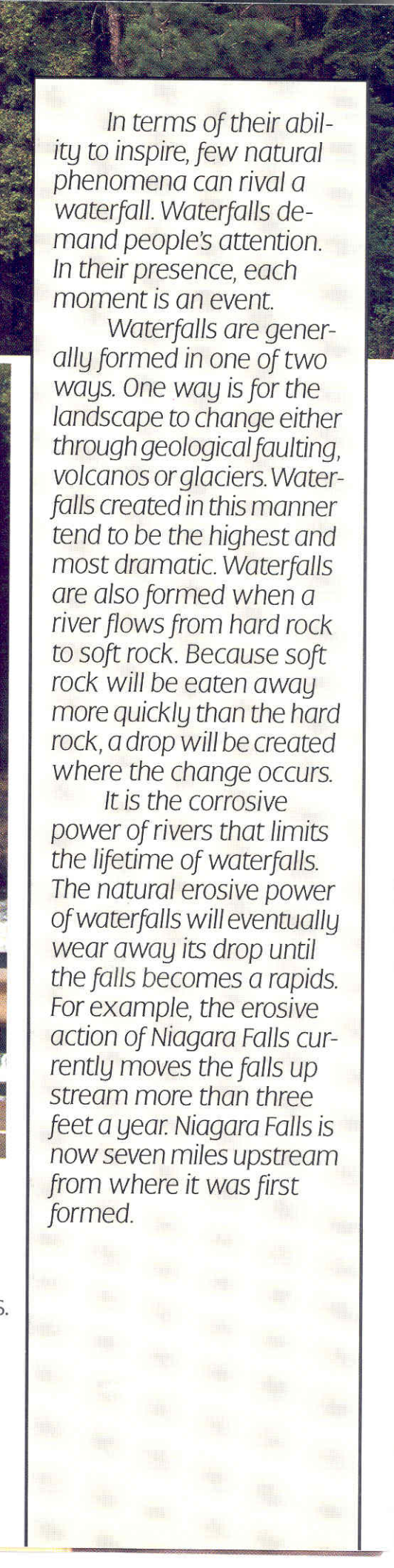

In terms of their ability to inspire, few natural phenomena can rival a waterfall. Waterfalls demand people's attention. In their presence, each moment is an event.

Waterfalls are generally formed in one of two ways. One way is for the landscape to change either through geological faulting, volcanos or glaciers. Waterfalls created in this manner tend to be the highest and most dramatic. Waterfalls are also formed when a river flows from hard rock to soft rock. Because soft rock will be eaten away more quickly than the hard rock, a drop will be created where the change occurs.

It is the corrosive power of rivers that limits the lifetime of waterfalls. The natural erosive power of waterfalls will eventually wear away its drop until the falls becomes a rapids. For example, the erosive action of Niagara Falls currently moves the falls upstream more than three feet a year. Niagara Falls is now seven miles upstream from where it was first formed.

Rivers and the course of history have flowed together.

The first known human settlements occurred along rivers. Rivers provided an easy means of transportation, an abundance of fish and wildlife and, most importantly, their water could be used for the new-found skill of agriculture. The fertile flood plains and ease of irrigation made river banks ideal locations for settlements.

The European exploration of North and South America was greatly facilitated by rivers, because rivers provided the easiest access to the interior. Later the settlement of the Ohio Valley and Great Plains was enhanced by America's heartland rivers.

Today our nation still is highly dependent upon rivers. More than ever before, barges are carrying our minerals, grains and manufactured goods. Our major metropolitan areas are located on rivers. And rivers remain a major source of our water supply.



source of our water supply.

1. 319RB interior. 2. 26RT bedroom. 3. 26RT interior. 4. 26RT bathroom and shower. 5. 26RT galley. 6. 319RB bedroom. 7. 3-way refrigerator. 8. Microwave/convection oven and monitor panel. 9. 319RB bath.

Cruising In Full Gear.

Whether they be on the river or on the road, journeys take thoughtful planning, careful use of

space and the right equipment. All these qualities can be found throughout the Minnie

Winnie.

Minnie Winnie's Sealy Posturepedic® mattresses are ready for a sound night's



3

sleep or for catching a quick nap on a lazy afternoon.

With Minnie Winnie's full-featured galley, you can enjoy full meals wherever you may be. For preparation and clean-up, there's a double stainless steel sink. For cooking, it has a

4-burner stove and glass-door oven. And above and below, there's storage space for your food and kitchenware.

In the interior, you'll find an amazingly economical use of space. Storage cabinets are tucked neatly

into the upper corners. And the furniture is arranged to create a comfortable setting.

Plus, Minnie Winnie has the standard features that are all too often options on other class C motor homes like a deluxe

monitor panel, a power bath vent, a magazine rack and a full length mirror.

Bring a Minnie Winnie on your next trip. With all its features, you'll be prepared for everything without sacrificing anything.

From an 18-foot wide and one-foot deep beginning at Lake Itasca, to mile wide, hundred-foot deep stretches, the Mississippi is the dominant waterway in North America. No other geographic feature holds such a prominence in our literature, folklore and economy.

The Algonkian Indians called it "Misi Sipi" which means Big Waters. Water from 31 states and 2 Canadian provinces drains into Old Man River. Each year it carries more than 350 million yards of gravel, dirt and sand into the Gulf of Mexico.

Since 1879 when Congress created the Mis-

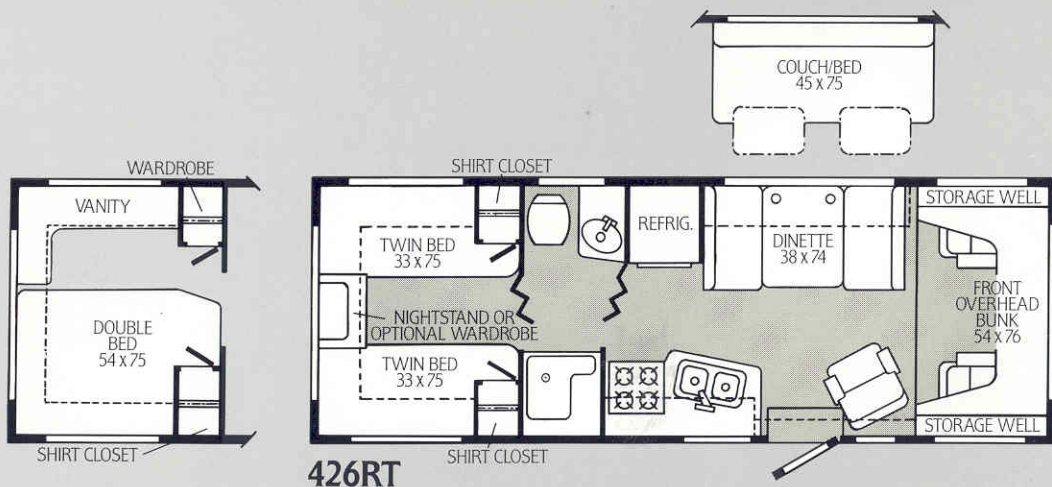
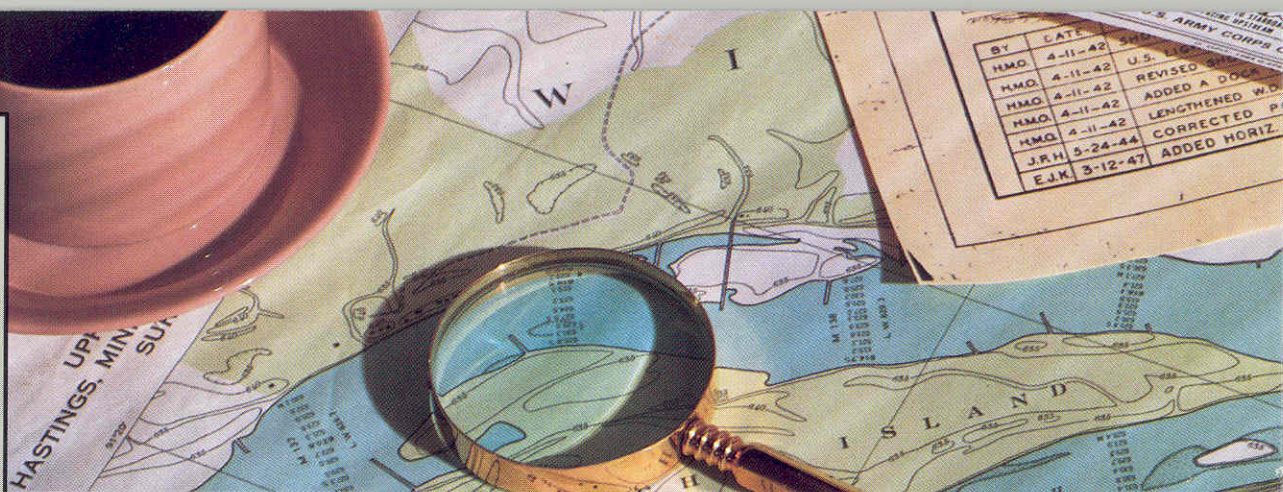

Mexico.

Since 1879 when Congress created the Mississippi River Commission, people have tried to control the river's flow to prevent flooding. By the 1920s, it was felt that the river was under complete control. But the floods of 1927 shattered this myth. Twenty-six thousand square miles of land were flooded and a billion dollars of damage occurred.

Since then, a complex system of levees, improved channels, spillways and reservoirs have successfully protected the area from the floods in 1945 and 1950. However the system failed to hold back the extremely high floodwaters of 1973.

SHIRT CLOSET

426RT

SHIRT CLOSET

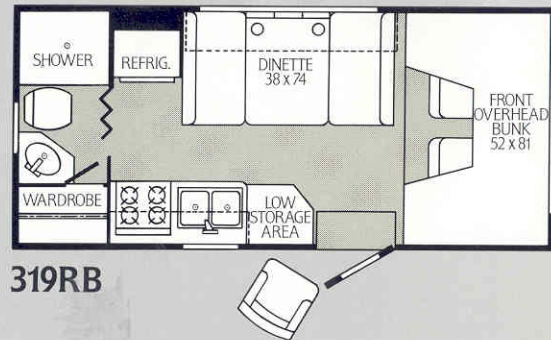
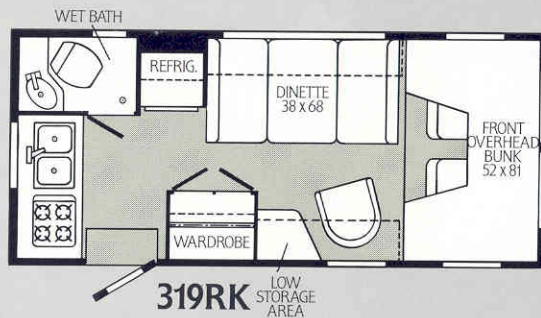

Charting Your Course.

For some, the lazy ambling of a wide river suits their need for relaxation. Others enjoy the rushing excitement of the

rapids. It's variety that attracts so many to rivers. And it's variety that has made the Minnie Winnie so popular.

The 26RT gives you the room and comforts of a class A motor home while maintaining the value of a class C. The 319 provides

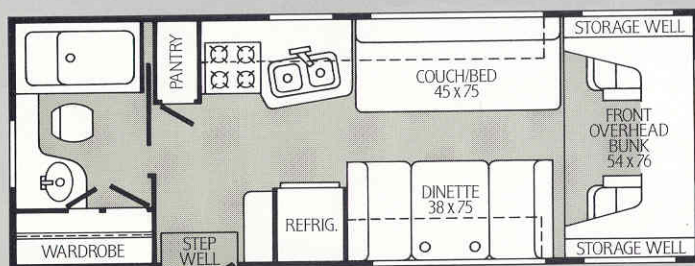
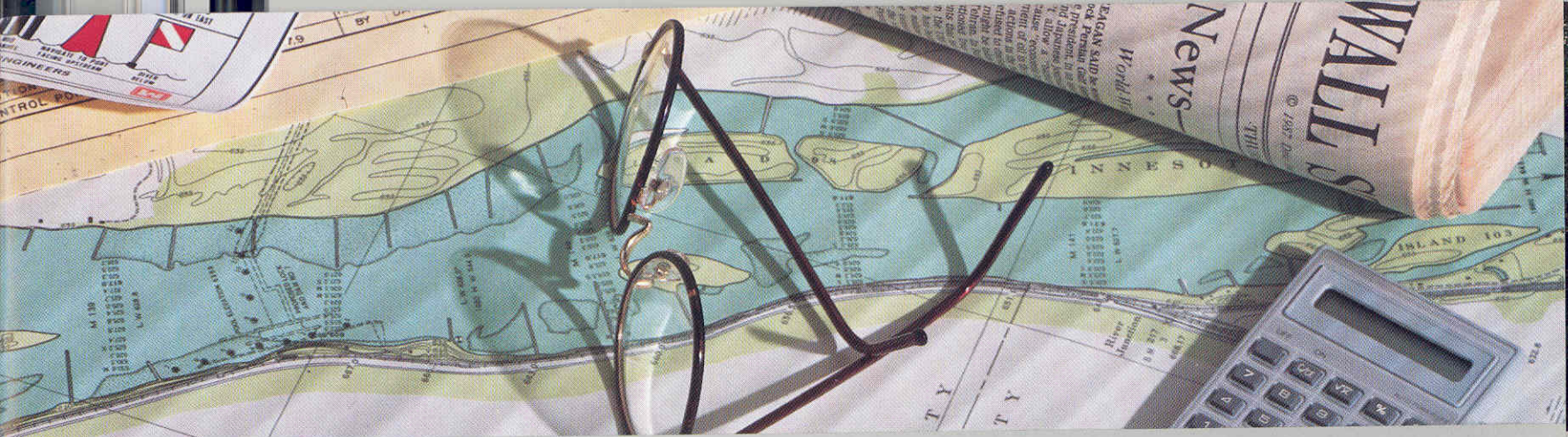

424RB

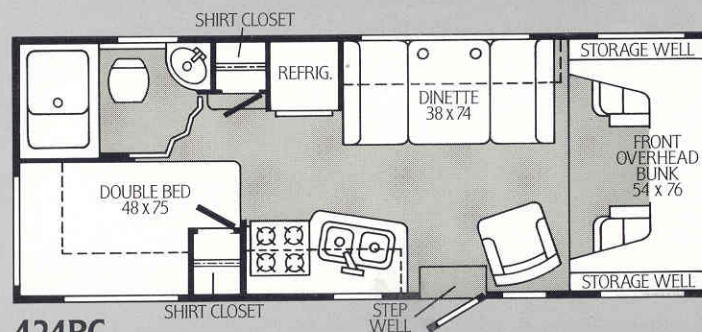

424RC

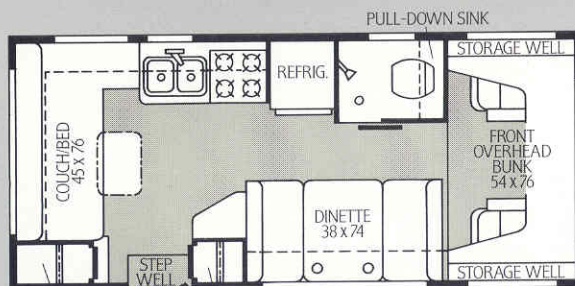

420RG

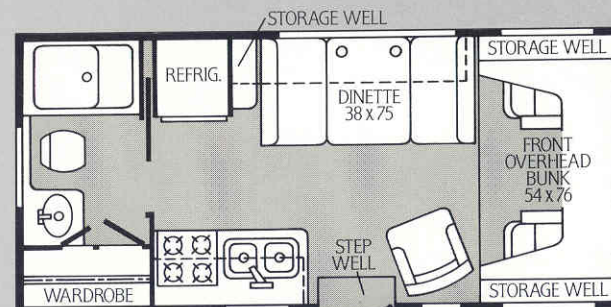

421RB

Note: Dimensions shown are for sleeping areas.

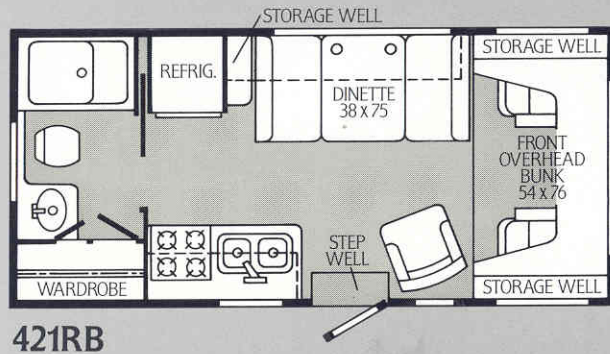
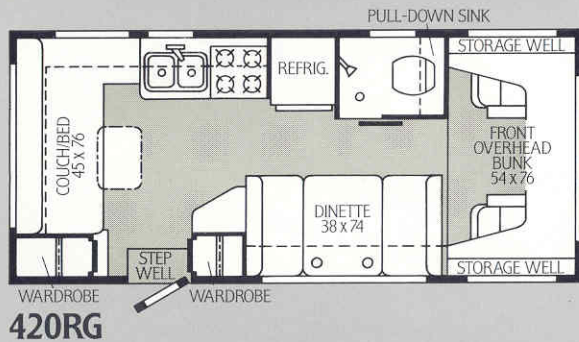

Note: Dimensions shown are for sleeping areas.

an economical way to get into motor homing. And in between, there are models to fit every lifestyle.

And when you buy a Minnie Winnie, you're backed throughout the country. Your dealer has full details on Winnebago's

nationwide service network, extensive warranty and optional traveler's protection plan.

Another advantage to buying a Winnebago is its price sticker. It gives you a precise cost on each standard feature and option.

One of the great joys of travel is the people you meet along the way. And one of the best ways to do that is to join the Winnebago-Itasca Travelers Club. You'll enjoy special benefits tailored to enhance your motor

homing pleasure.

When reviewing all your options in class C motor homes, you'll find that Minnie Winnie's are the only course to take. Minnie Winnie gives you more features while delivering more value.



The walls and roof are built around a rigid structure of steel.

Steel tie-downs hold appliances in place for added safety.

Our Thermo-Panel® sidewalls revolutionized the way RVs were built. They're light, tight and fully insulated.

Full-scale clay modeling assures symmetry and finish.

For added safety, your generator is encased in a steel compartment.

Non-hardening sealant throughout.

Floors and walls are connected solidly with our unique locking-joint construction.



Built To Serve For The Long Run.



Extended roof design allows for extra headroom in coach.

Aluminum trim is electrostatically painted and baked for a smooth, lasting finish.

The front floor and dash sub-structure are solid steel.

Specially strengthened screen keeps insects out.

Reinforced dead-bolt lock on main entrance door.

Water tanks are seamless and are strategically positioned for even weight distribution.

Rear wheel wells are tough, rustproof plastic.

Sealed aluminum underflooring resists corrosion.

Steel outriggers and full-length leveling rails are welded directly to the chassis for a firm coach foundation.

Critical steel parts are cleansed with acid, rust-proofed and primed with paint.

After animal power, water power was the first source to be utilized to create mechanical energy. And until the invention of the steam engine, the waterwheel was industry's most important source of power.

The waterwheel appears in both European and Oriental literature during the first century B.C. Its original use was milling grain. But soon other applications were found, such as operating bellows, spinning yarn, pressing grapes and sawing wood.

Because of the lack of sophistication in gearing mechanisms, these early waterwheels were mounted horizontally rather than vertically. But by the first century A.D., the vertical waterwheel began to take over.

The potential water power in the world has been estimated at over 660 million horsepower. That's more than four times the horsepower from any other source. Internationally less than 20% of the world's water power is presently being utilized.

While thousands of commercially operating waterwheels are still in use today, the main vehicle for converting water power into electrical power is the turbine.

Specifications

SPECIFICATIONS	20RG	21RB	24RB	24RC	26RT
Length (Chevy/Ford)	20'9"/21'4"	20'9"/21'4"	24'1"/24'8"	23'5"/24'1"	NA/26'9"
Exterior Height w/Roof Air (Chevy/Ford)	10'1"/10'3"	10'1"/10'3"	10'1"/10'3"	10'1"/10'3"	NA/10'3"
Exterior Width	8'0"	8'0"	8'0"	8'0"	8'0"
Interior Height (Max.)	6'5"	6'5"	6'5"	6'5"	6'5"
V-8 Engine (CID Chevy/Ford)	350/351	350/351	350/460	350/460	NA/460
Battery CCA/Amp.-Hr. (Chevy/Ford)	525/71	525/71	525/71	525/71	NA/71
Fuel Capacity (Gal. Chevy/Ford)	33/40	33/40	33/40	33/40	NA/40
Fresh Water Capacity (Gal. w/Heater)	34	34	41	42	36
Holding Tank Capacity (Gal. Main/Aux.)	25/25	35/35	35/35	35/35	28/37
LP Capacity (Lbs.)	42	42	80	80	68
Sleeping Capacity (STD/OPT)	5/5	3/3	5/5	5/5	5/5
GVWR (Lbs. Chevy/Ford)	10,200/10,250	10,200/10,250	10,500/11,000	10,500/11,000	NA/11,000
Wheelbase (Chevy/Ford)	125"/138"	125"/138"	146"/158"	146"/158"	NA/176"
FEATURES	20RG	21RB	24RB	24RC	26RT
2nd Deep Cycle Marine/RV Battery	OPT	STD	STD	STD	NA
Fluorescent Galley Lighting	NA	NA	STD	STD	STD
Reading Lights	NA	NA	STD	STD	NA
Shower Skylight	NA	NA	NA	NA	STD
Flip-Up Galley Extension	OPT	STD	NA	STD	STD
3-Way Refrigerator (Large Single Door/Double Door)	STD/NA	NA/STD	NA/STD	NA/STD	NA/STD
Make-Up Lights	OPT	OPT	OPT	OPT	STD
Shower Light	STD	STD	STD	STD	NA
Pantry Cabinet	NA	NA	STD	NA	NA
Wardrobe Mirror	NA	STD	NA	STD	NA
Bedroom Vent	NA	NA	NA	NA	STD
Bath Door	STD	STD	STD	STD	NA
Shower (Curtain/Door)	STD/NA	NA/STD	NA/STD	NA/STD	NA/STD
Entrance Door Cabinet	NA	STD	NA	STD	STD
Room Dividers	NA	NA	NA	STD	STD
Electronic Ignition Furnace (BTUs STD/OPT)	24,000/NA	24,000/NA	24,000/34,000	24,000/34,000	30,000/NA
Rear Bumper (Bright/Chrome)	STD/NA	STD/NA	NA/STD	NA/STD	NA/STD

STANDARD FEATURES*:

AUTOMOTIVE:

3-Speed Automatic Transmission w/Cooler, Power Steering, Coil Spring Front Suspension, 2-Stage Multi-Leaf Rear Suspension, 6.8.0 x 16.5D Tires (Chevy), 100-Amp. Alternator (Ford), 85-Amp. Alternator (Chevy), Automotive Air Conditioning, Cruise Control, Dome Light, Floor Mats, Beverage Tray, Bunk/Transition Panel Trim, Fabric Door Panels (Chevy), Front Wraparound Curtain, Intermittent Wipers, Inside Rearview Mirrors, Blackout Curtain, Deluxe Bucket Seats (Swivel/Slide, Reclining, Armrests), Battery Gauge, Cigarette Lighter, Ashtray, Emergency Start Solenoid, Sunvisors, Tilt Steering Wheel, Pre-Wired for Radio and Speakers, Cab Carpeting.

APPLIANCES/SAFETY:

Direct Drive Water Pump, 4-Burner Range w/Glass Door Oven, Powered Range Hood w/Deluxe Monitor Panel, Double Stainless Steel Sink w/Butcher Block Cover and Faucet, 6-Gallon Electronic Ignition Water Heater, 5-B:C Fire Extinguisher, Smoke

Detector, Ground Fault Interrupter, LP Leak Detector.

INTERIOR:

Brass-Tone Bathroom Faucet, Bath Mirror, Bathroom Light, Marine Toilet, Wood Framed Medicine Cabinet, Shower w/Flexible Shower Head, Towel Ring, Tissue Holder, Coach Vent, Powered Lavatory Vent, Entry Assist Strap, Carpeting w/Pad, Carpeted Wardrobe Shelf, Wardrobe Light, Drawer to Accommodate Silverware Tray, Spice Rack, Magazine Rack, Wastebasket, Entrance Door Curtain w/Tieback, Galley Area Mini-Blinds w/Padded Valance, Bath Area Mini-Blinds w/Valance, Lounge/Dining Area Mini-Blinds w/Padded Valances Side Panels and Tiebacks, Front Overhead Bunk Drapery Panels and Tiebacks.

EXTERIOR:

Dual-Locking Storage Doors, LP Tank, Retracting Entrance Door Step, 110-Volt Outlet w/Cord, Lockable Water and Fuel Fill Doors, Bright Rearview Mirrors, 32-Amp.

Converter/Battery Charger, Lighted Assist Handle, Mud Flaps, Entrance Screen Door, Deep Cycle Marine/RV Battery, Chrome Front Bumper, Sewer Hose and Storage, Tire Tools, All Tinted Windows, Extensive Warranty.

OPTIONAL EQUIPMENT*:

460 CID V-8 (Ford), AM/FM/MPLX Cassette Stereo, AM/FM/MPLX Cassette Stereo w/Electronic Tuner, 7 LT215/85R-16D Tires (Mandatory on Ford), 7 8.00 x 16.5D Radial Tires (Chevy), Rear Window Wiper, Stabilizer Shocks, Water Purification System, Decorator Kit, Microwave/Convection Oven w/Range Top and Ovenware Drawer, 2,500-Watt Generator, 4,000-Watt Generator, Generator Prep. Kit, 13,500-BTU Roof Air, Motoraid and Rear Automotive Heater, Larger Electronic Ignition Furnace, Double-Door Refrigerator, Rear Pedestal Table, TV Antenna w/Two Jacks and Cable Connection, Luggage Rack and Ladder, Running Boards/Fender Flares, Spare Tire (Chevy), Wheel Covers, Stainless Steel Wheel Liners,

Undercoating, Trailer Towing Package, Steel Plates, Traveler's Protection Plan.#

319RB AND 319RK

SPECIFICATIONS: 20'7" Length, 9'4" Height w/Roof Air (RB Only), 8'8" Height w/o Roof Air, 7'1" Exterior Width, 6'2" Interior Height (Max.), 17.2-Gal. Gasoline Capacity, 18-Gal. Fresh Water Capacity, 2 14-Gal. Capacity Holding Tanks, 28-Lb. LP Capacity, 3-Person Sleeping Capacity, 5,500-Lb. GVWR, 137" Wheelbase.

STANDARD AUTOMOTIVE FEATURES:

4-Cylinder 2.4-Liter Toyota Engine, 4-Speed Automatic Transmission, 7 185R14LT Radial Tires, Fuel Injection, Cold Kit, 60-Amp. Alternator, 60-Amp. Battery, Tinted Cab Windows, Power Steering, Automatic Air Conditioner, Cruise Control, Door Trim Panels and Map Pockets, Smart Stick, Ashtray, Cigarette Lighter, Digital Clock, Remote Hood Release, Map Light, Bucket Seats, Emergency Start Solenoid, Floor Mat, AM/FM/MPLX Stereo w/Cassette and Speaker.

STANDARD APPLIANCES/SAFETY FEATURES:

Direct Drive Water Pump, 4-Burner Range Top, Power Hood, Wall Mount Motor Panel, 110V/LP Refrigerator, 12,000-BTU Forced Air Direct Ignition Furnace, Double Stainless Steel Sink, 4-Gal. LP Water Heater, LP Leak Tester, Smoke Detector, Ground Fault Interrupter, 5-B:C Fire Extinguisher.

STANDARD INTERIOR FEATURES:

Front Overhead Bunk, Lavatory, Shower w/Curtain and Light, Marine Toilet, Medicine Cabinet w/Mirror, Skylight, Decorator Lamp, Power Bath Vent, Coach Vent, Power Galley Vent, Carpet, Side Bunk Windows and Coverings, Assist Strap, Bath Mirrors, Bath Door, Chrome Bath Accessories, Curtain Panels w/Valance Insert and Pull Shade.

STANDARD EXTERIOR FEATURES:

Deep Cycle Aux. Battery, 32-Amp. Converter/Battery Charger, Storage Compartments, Porch Light, Assist Strap, Sewer Hose Compartment, Lockable Water/Fuel Fill Doors, Screen Door.

OPTIONAL EQUIPMENT:

4-Speed Manual Transmission, Right Front Swivel Chair, Power Roof Vent, 7,100-BT Roof Air Conditioner, Mud Flaps, Fabric Covered Buck Seats.

*Not all standard features or options are available on all models. See your dealer for the availability of specific options.

#In Canada contact your dealer for availability.

1 Available on the 319RB only.

2 Available on the 319RK only.

3 Optional on the 319RB. Standard on the 319RK.

Winnebago's continuing program of product improvement makes specifications, equipment, model availability and prices subject to change without notice. Some items shown may be extra cost options.

For Winnebago sales and service, contact: