

# FREEDOM ELITE

## CLASS C FLOOR PLANS

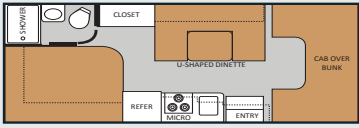

21C

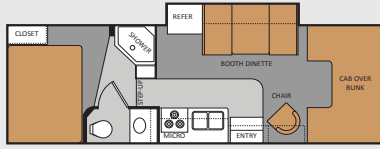

26E

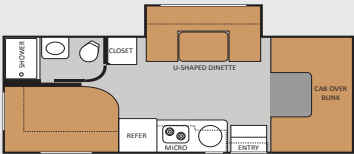

23S

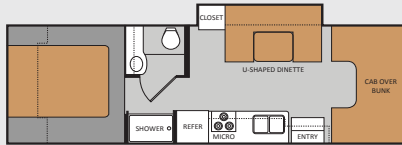

28U



CLASS C EXTERIOR

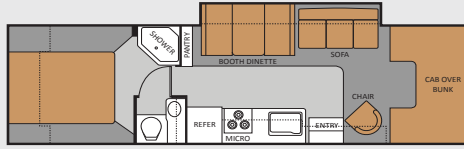

31R

## CLASS B+ FLOOR PLANS

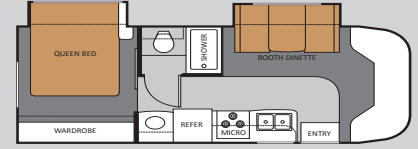

26BE



CLASS B+ EXTERIOR



## SPECIFICATIONS

	Class C					Class B+	
Floor Plan	21C	23S	26E	28U	31R	26BE	
WEIGHT RATING (LBS.)	<b>Ford Chassis - Triton Engine</b>	6.8L/V-10	N/A	6.8L/V-10	6.8L/V-10	6.8L/V-10	6.8L/V-10
	Gross Vehicle (GVWR)	12,500	N/A	14,500	14,500	14,500	14,500
	Gross Combined (GCWR)	18,500	N/A	20,000	20,000	20,000	20,000
	<b>Sprinter Chassis - Turbo Diesel Engine</b>	N/A	3.0L/V-6	N/A	N/A	N/A	N/A
	Gross Vehicle (GVWR)	N/A	11,030	N/A	N/A	N/A	N/A
Gross Combined (GCWR)	N/A	15,250	N/A	N/A	N/A	N/A	
MEASUREMENTS	Wheel Base	158"	170"	176"	210"	219"	181"
	Exterior Length (w/out ladder)	23' 11"	24' 9"	28' 3 1/2"	29' 10 1/2"	32' 5"	27' 4"
	Exterior Height (w/ AC)	10'-10"	11'	10'-10"	10'-10"	10'-10"	10'-6"
	Exterior Width (without mirrors)	99"	90"	99"	99"	99"	94"
	Interior Height	82"	80"	82"	82"	82"	80"
Awning Size	15'	15'	15'	14'	16'	18'	
CAPACITIES	Fuel (gallons) (Ford/Chevy)	55	26.4	55	55	55	55
	LPG (pounds)	40.9	68.2	68.2	68.2	68.2	40.9
	Fresh Water (gallons)	50	40	50	40	50	33
	Waste Water (gallons)	24	38	29	31	31	25
	Gray Water (gallons)	37	34	29	29	29	33
	Water Heater (gallons)	6	6	6	6	6	6
	Furnace (BTUs)	25,000	25,000	30,000	30,000	30,000	25,000
Exterior Storage Capacity (cubic feet)	81	65	102	101	112	16	

# FREEDOM ELITE FEATURES

## BODY CONSTRUCTION/EXTERIOR

Curved sidewall design (26BE)

Fully welded tubular aluminum roof and sidewall cage construction

Vacu-Bond laminated roof, walls and floors with high-density block foam insulation

Slick fiberglass exterior sidewalls

Exterior graphics package (N/A 26BE)

Full-body paint package with Gel-coat sidewalls (26BE)

Premium one-piece TPO roof

Roof ladder

One-piece fiberglass front and rear caps (26BE)

Manual patio awning

Slide-out room awning (N/A 21C)

Seamless roto-cast storage compartments

Rear MEGA storage compartment (21C, 26E, 28U & 31R)

1 - Folding/Portable table (21C)

2 - Folding/Portable tables (26E, 28U & 31R)

Rubber tread entry steps

Acrylic entry grab handle

Drop down stairwell entrance step (21C, 26E, 28U & 31R)

Automatic electric entrance step (23S & 26BE)

Rear exterior spot light on driver's side (23S, 26E, 28U & 31R)

Outside Shower (N/A 21C)

## AUTOMOTIVE/COCKPIT

"RV Style" AM/FM dash radio with CD player, Weather Band tuner and auxiliary input

Power window and door locks

Keyless entry to the cab (23S, 26BE, 26E, 28U & 31R)

3-Point driver and passenger seat belts

Driver and passenger air bags (26BE)

Metal running boards (21C, 26E, 28U & 31R)

Fiberglass running boards (26BE)

Deluxe exterior mirrors (21C, 26E, 28U & 31R)

Deluxe heated remote exterior mirrors (23S & 26BE)

Air assist suspension (26E, 28U & 31R)

Stainless steel wheel liners

Valve stem extenders (26BE, 26E, 28U & 31R)

Spare tire kit

3,500-lb. trailer hitch with 7 pin connector

Upgrade dash insert with drink tray (26BE, 26E, 28U & 31R)

Fabric driver & passenger captain's chairs (21C)

Leatherette driver & passenger captain's chairs (23S, 26BE, 26E, 28U & 31R)

## INTERIOR

Residential linoleum throughout (21C & 23S)

Residential linoleum (galley, bath & entry way) (26BE, 26E, 28U & 31R)

Metal entry grab handle

Windshield privacy curtain

13,500 BTU low-profile A/C in front

Ceiling ducted A/C system (N/A 23S)

Fluorescent ceiling lighting

Directional reading lights (26BE)

Cherry cabinetry

Day/Night shades throughout

Hard vinyl ceiling (21C)

Soft touch vinyl ceiling (N/A 21C)

Booth dinette (26BE, 26E & 31R)

Fabric U-shaped dinette (21C)

Leatherette U-shaped dinette (23S & 28U)

Leatherette hide-a-bed sofa with air mattress (31R)

Fabric barrel chair (26E & 31R)

## GALLEY

Double door refrigerator

Black glass refrigerator door inserts (23S)

Stainless steel refrigerator door inserts (26BE)

3-burner high-output cook top with cover (26BE)

3-burner high-output cook top with oven (21C, 26E, 28U & 31R)

European 2-burner high-output gas range top with glass cover (23S)

Stainless steel power range hood (26BE)

Stainless steel convection microwave (26BE)

Microwave oven (N/A 26BE)

Laminate countertops

Flip-up countertop extension

Large single bowl sink (21C & 23S)

Large double bowl sink (26BE, 26E, 28U & 31R)

Skylight in kitchen area (21C, 26E, 28U & 31R)

Full extension drawer guides

## ENTERTAINMENT & ACCESSORIES

26" LCD TV on electric swivel in cab over (26E, 28U & 31R)

32" LCD TV front entertainment center with remote control in cab-over (26BE)

19" LCD TV - Bedroom (26BE)

Coach radio system (23S)

TV antenna and booster

Cable TV prep

HD/DSS satellite prep

## BEDROOM/BATHROOM

Queen-size innerspring mattress (26BE)

Select Comfort air mattress (28U & 31R)

Fiber mattress (21C, 23S & 26E)

Bedspread and pillow shams

Power bath vent

Fantastic® Fan (26BE)

China bowl toilet

Skylight in shower

Shower with glass door

## SAFETY/CONVENIENCE

Entry door with dead bolt lock

System control center

Smoke, LPG, carbon monoxide detectors

Fire extinguisher

Slide-out battery tray (26BE)

Passenger seat belts in select areas

## ELECTRICAL & PLUMBING

Onan® RV MicroQuiet™ 4.0 (4000 watts) gas generator (21C, 26BE, 26E, 28U & 31R)

Onan® 3.6 (3600 watts) LP generator (23S)

30-amp service with shore line power cord

Automatic shoreline-to-generator transfer switch

Battery disconnect switch

Emergency start switch

Auxiliary house battery

Second auxiliary house battery

6-gallon gas water heater (21C)

6-gallon gas/electric water heater (23S, 26BE, 26E, 28U & 31R)

Black tank flush system (26BE)

Water heater bypass system

Holding tanks with heat pads (N/A 21C)

**VEHICLE LOADING:** Every effort has been made to provide the greatest number of options for the recreation vehicle owner. Along with these choices comes the responsibility to manage the loads that are imposed by the choices so that they remain within the manufacturer's specified chassis weight limits. Do not overload the recreation vehicle.

**IMPORTANT:** Towing capacity may vary by chassis model, floorplan, options and loading of the vehicle. This may result in a towing capacity which is less than the maximum capacity of the hitch. Do not exceed the vehicle's Gross Combined Weight Rating (GCWR), or the hitch rating. A separate functioning

brake system is required for any towed vehicle or trailer weighing more than 1,000 lbs. (450 KG) when fully loaded. Liquid capacities and weights are approximations only.

**WARNING:** This information is intended as a guide only. Weights of individual vehicles may vary. Consult your owner's manual and weight sticker affixed to each vehicle for complete loading, weighing, and towing instructions.

**WARRANTY:** The vehicles are provided with a twelve (12) month, 15,000-mile limited warranty. Chassis, component part and appliance manufacturers may issue limited warranties covering those portions of

the vehicle not covered by the limited warranties issued by Four Winds International. To learn what portions of the vehicle are excluded from coverage under the limited warranties issued by Four Winds International, please contact your selling dealership or Four Winds International directly, or review the warranty packet inside the vehicle.

Product information, specifications, and photography in this brochure were as accurate as possible at time of printing. Photographs may contain some features that are optional on your vehicle. Since we continually strive to improve our products, actual products may differ. The manufacturer reserves the

right, at any time, to make changes in product design, materials, component specifications and pricing, without notice. All capacities are approximate and dimensions are nominal. Some features or options may be different or unavailable in Canada.

# FREEDOM ELITE