

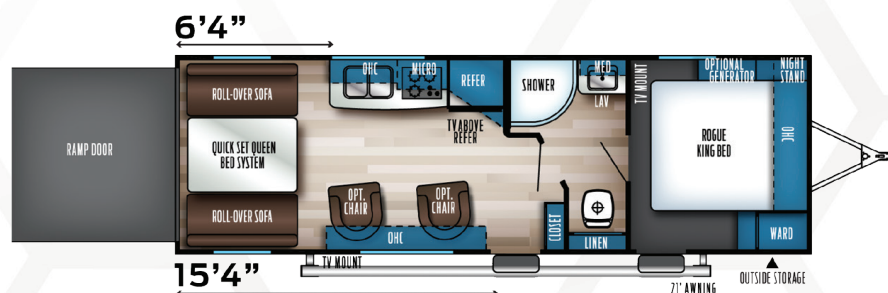

TRAVEL TRAILER TOY HAULERS

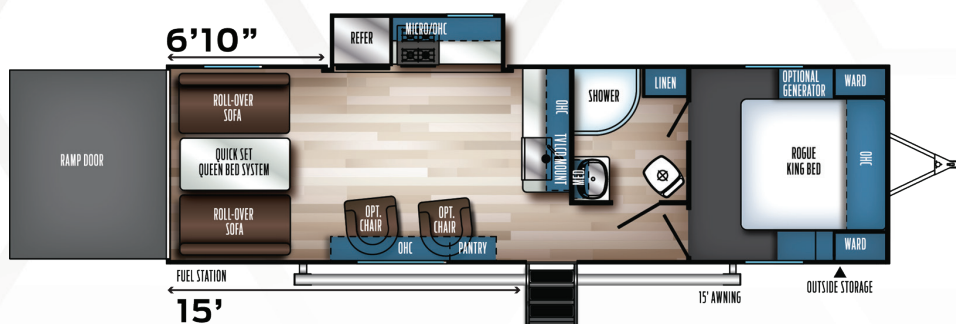

25V
Actual Length: 30' 6"
Dry Weight: 6,498 lb.



26VKS
Actual Length: 33' 8"
Dry Weight: 7,408 lb.

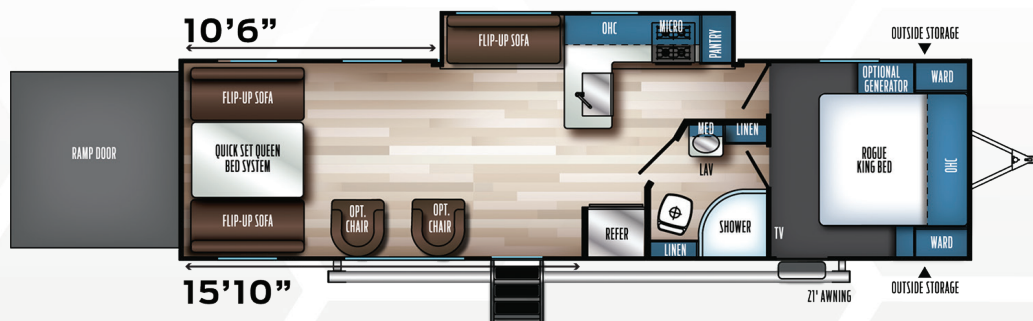

29KS
Actual Length: 35' 7"
Dry Weight: 8,620 lb.



32V
Actual Length: 39' 1"
Dry Weight: 9,946 lb.



BEST IN CLASS STANDARD FEATURES:

EXTERIOR HIGHLIGHTS

- 102" Wide Body Construction
- Ramp Door Patio System
- 3,000 lb. Rated Ramp Door
- Solar Reflective Windows
- Two 20lb LP Tanks with Cover
- Generator Ready
- Enclosed Underbelly
- Heated Holding Tanks
- Four Camera Backup/Observation Camera Ready
- Black Tank Flush System
- Detachable Coil Spray Hose
- Outside Shower
- Spare Tire
- Power Awning w/ LED Lighting
- Solar Panel Ready
- Satellite Ready

INTERIOR HIGHLIGHTS

- Quick Set Garage Bed System
- Flip Up Rear Sofas
- Zebra Shades in Living Areas
- Raised Roofline allows Taller Vehicles to Fit
- 2,500 lb. Tie Downs with Welded D Rings

- Tankless On Demand Water Heater
- Rear Screen Wall
- 12V Bedroom Outlet
- Bluetooth Receiver System with Outside Speakers
- Pleated Shades in Bedrooms
- 10 cu. ft. 12V Refrigerator
- 3 Burner Range w/ Oven
- 1000 Watt Microwave
- Black Stainless Steel Farm Sink
- Pull Down Spray Faucet
- Seamless Countertops
- Glass Shower Enclosure (N/A 32V)
- Foot Flush Toilet
- LED Interior Lighting

EQUIPMENT

- 12V Battery Disconnect
- 15,000 BTU Ducted Air Conditioning
- Tankless On Demand Water Heater
- Scissor Stabilizer Jacks
- One Control System for Lights, Awning, and Slides
- 30 Amp Service w/ Detachable Power Cord
- 100 Gallon Fresh Water Capacity
- 12 Volt Heat Pads on All Holding Tanks

AVAILABLE OPTIONS

- Gel Coat Fiberglass Exterior
- Euro Recliner Black Leather
- Inverter Generator
- Power Tongue Jack
- Juice Pack - 100 W Solar Panel, Controller & Battery
- Juice Pack Expansion 100 Watt Solar Panel
- 2nd A/C with 50 AMP Service

SCAN QR CODE

TO LEARN MORE ABOUT
ROGUE TRAVEL TRAILER
TOY HAULERS

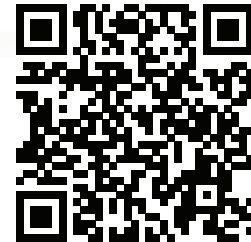

All information contained in this brochure is believed to be accurate at the time of publication.

However, during the model year, it may be necessary to make revisions and Forest River, Inc. reserves the right to make all such changes without notice, including prices, colors, materials, equipment and specifications as well as the addition of new models and the discontinuance of models shown in this brochure.

Therefore, please consult with your Forest River dealer and confirm the existence of and materials, design or specifications that are material to your purchase decision.

For more information visit:
www.forestriverinc.com/Rogue



Learn More
Scan this barcode using
a QR Reader on your
smart phone to learn
more about Forest River.



A Berkshire Hathaway company.

SPECIFICATIONS	25V	26VKS	29KS	32V
Unloaded Vehicle Weight	6,498 lb.	7,408 lb.	8,620 lb.	9,946 lb.
Dry Hitch Weight	1,014 lb.	1,148 lb.	1,375 lb.	1,598 lb.
Axle Weight	5,484 lb.	6,260 lb.	6,363 lb.	8,348 lb.
GVWR w/Brakes	11,274 lb.	11,348 lb.	11,874 lb.	13,598 lb.
Cargo Carrying Capacity	4,560 lb.	3,902 lb.	3,254 lb.	3,652 lb.
Exterior Length	30' 6"	33' 8"	35' 7"	39' 1"
Exterior Height w/ A/C	12' 1"	12' 4"	12' 4"	12' 4"
Exterior Width	102"	102"	102"	102"
Fresh Capacity - Gal	100	100	100	100
Grey Capacity - Gal	38	38	38	38
Black Capacity - Gal	38	38	38	76
Cargo Area Drivers Side	6' 4"	6' 10"	10' 6"	12' 6"
Cargo Area Curb Side	15' 4"	15'	15' 10"	12' 6"



SCAN QR CODE
TO LEARN MORE ABOUT
ROGUE ARMORED
5TH WHEEL TOY HAULERS



FIFTH WHEEL TOY HAULERS

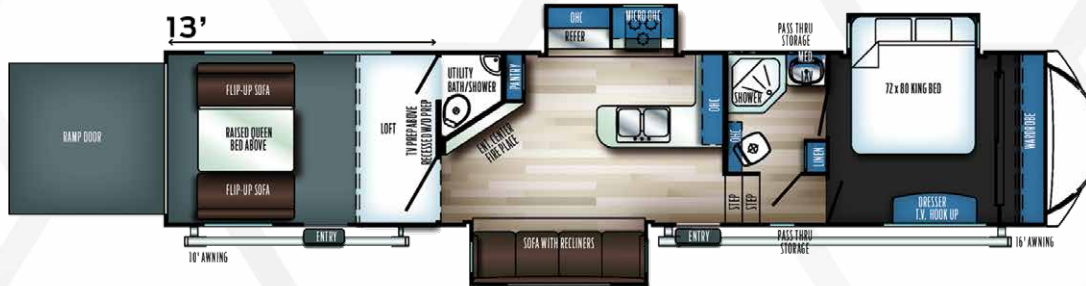

351G2

Actual Length: 45' 1"
Dry Weight: 13,000 lbs.

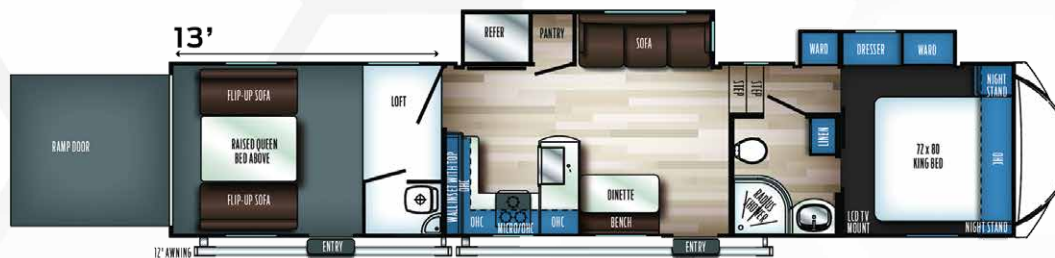

371A13

Actual Length: 43' 4"
Dry Weight: 12,764 lbs.

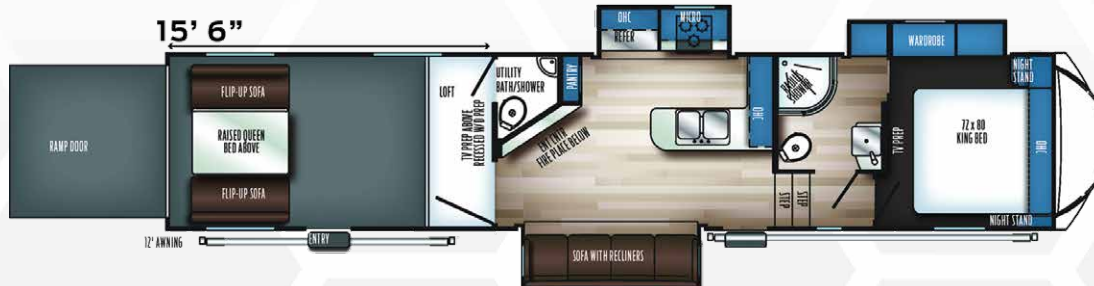

383G2

Actual Length: 45' 1"
Dry Weight: 13,219 lbs.



4007G2

Actual Length: 45' 4"
Dry Weight: 13,174 lbs.

TOY HAULER STANDARD BUILD: FEATURES AND OPTIONS

EQUIPMENT

- One control phone app for lights, slides, and awnings
- Roof mounted solar ready
- 7,000 lb. axles
- 16" Aluminum wheels
- On Demand Tankless Water Heater
- 50AMP service with detachable power cord
- Four Point Backup/Observation Camera ready
- Two 15,000 BTU A/Cs "Super H Ducted"
- Heated enclosed holding tanks
- 158 Gallon fresh tank capacity

GARAGE

- Quick Set garage bed system
- Flip up garage sofas w/ table
- 5,000 lb. tie downs mounted thru steel chassis plates
- DuraPoxy® gas/oil resistant flooring
- Solid Seal glass vapor door
- Rear screen wall
- Ram air vents (2)
- Power fan roof vent
- 3,000 lb. rated ramp door
- Ducted A/C, ducted heat
- Washer/dryer ready
- Half bath or Utility Bath in Garage

INTERIOR

- 16 Cu. Ft. 12 volt black glass residential-style refrigerator
- 30" Microwave
- 3 Burner range w/oven
- Solid surface countertops
- Zebra Shades in living areas
- Recliner sofas w/ heated seats, LED lights, and massage
- LED puck lighting throughout
- Black Glass entry doors
- Bluetooth stereo system
- Multiple USB charging stations
- Black stainless steel farm sink
- Pull down spray faucet
- Spa shower in master bath
- Glass shower surround
- Porcelain foot flush toilets
- Power adjustable king bed
- Skylight over shower
- Power vent fan in master bath
- Loft bunk ladder

SAFETY

- Fire extinguisher
- Smoke detector
- LP detector
- CO2 detector
- Emergency breakaway switch

EXTERIOR

- 102" Wide body construction
- Aluminum frame sidewalls
- Vacuum bonded sidewalls
- Fiberglass front cap with lights
- Generator prep with start/stop switch, and hour meter & fuel gauge
- 30 Gal. fuel station
- 6-Point automatic leveling system
- Ramp door patio system
- Spare tire & carrier
- Dual LED ramp cargo lights
- Exterior compartment lights
- LED brake/tail lights
- Solar Reflective windows
- Dual power awnings w/LED lights
- LP quick connect
- Tire Pressure Monitor System
- Outside shower
- Radius PVC walk on roof

OPTIONS

- 5500 Watt NPC generator
- Ramp patio step w/ wall mount
- Power Pack Solar/Inverter system
- Juice Pack 100 Watt solar system with battery and controller
- Juice Pack Expansion 100 Watt solar panel

All information contained in this brochure is believed to be accurate at the time of publication.

However, during the model year, it may be necessary to make revisions and Forest River, Inc. reserves the right to make all such changes without notice, including prices, colors, materials, equipment and specifications as well as the addition of new models and the discontinuance of models shown in this brochure.

Therefore, please consult with your Forest River dealer and confirm the existence of and materials, design or specifications that are material to your purchase decision.

For more information visit:
www.forestriverinc.com/Rogue



Learn More
Scan this barcode using
a QR Reader on your
smart phone to learn
more about Forest River.



A Berkshire Hathaway company.

SPECIFICATIONS	351	371	383	4007
Dry Hitch Weight	3,435 lb.	2,685 lb.	3,300 lb.	3,100 lb.
Unloaded Vehicle Weight	13,000 lb.	12,764 lb.	13,219 lb.	13,174 lb.
Axle Weight	10,079 lb.	9,919 lb.	10,074 lb.	10,074 lb.
GVWR w/Brakes	17,435 lb.	16,685 lb.	17,300 lb.	17,100 lb.
Cargo Carrying Capacity	4,042 lb.	3,921 lb.	4,081 lb.	3,926 lb.
Exterior Length	45' 1"	43' 4"	45' 1"	45' 4"
Exterior Height w/ AC	13' 4"	13' 4"	13' 4"	13' 4"
Exterior Width	102"	102"	102"	102"
Fresh Capacity	158 gal.	158 gal.	158 gal.	158 gal.
Grey Capacity	100 gal.	100 gal.	100 gal.	100 gal.
Black Capacity	40 gal.	40 gal.	40 gal.	40 gal.
Rear Bath Tank Capacity	40 gal.	40 gal.	40 gal.	40 gal.
Awning Size	10' & 16'	12' & 18'	12' & 15'	12' & 18'



23SUT TOY HAULER TRAVEL TRAILER

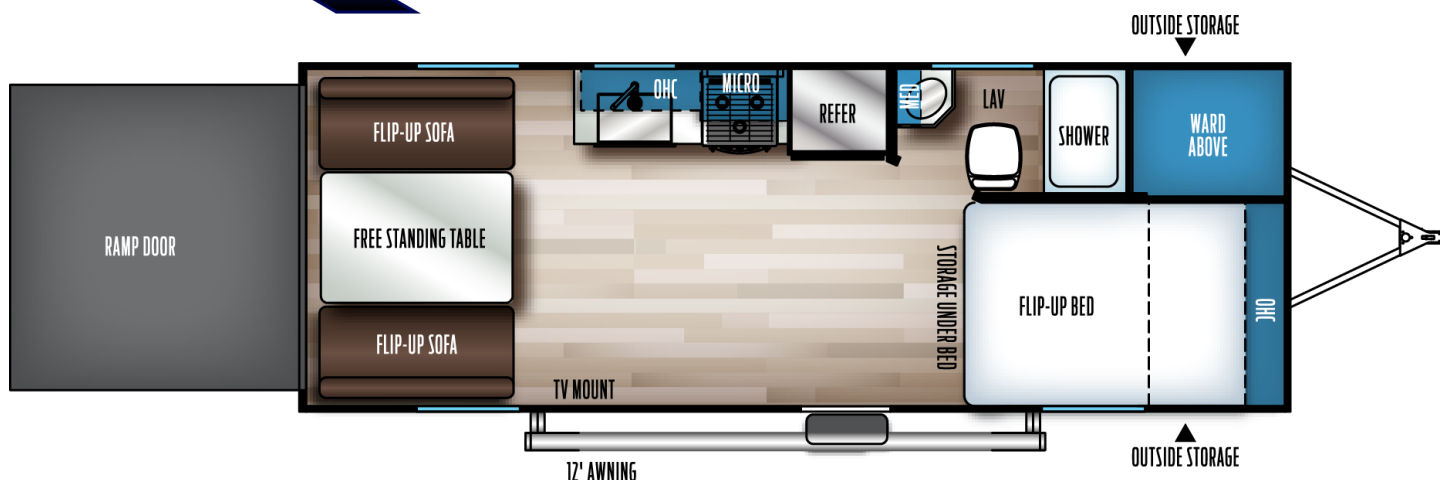

EXTERIOR HIGHLIGHTS

- 102" Wide Body Construction
- 3,000 lb. Rated Ramp Door
- Two 20lb LP Tanks w/ Cover
- Enclosed Underbelly
- Four Camera Backup/Observation Camera Ready
- Black Tank Flush System
- Detachable Coil Spray Hose
- Outside Shower
- Spare Tire
- Power Awning w/ LED Lighting
- Solar Panel Ready
- Satellite Ready
- 30" Friction Hinge Entry Door
- Rogue Stable Steps
- Detachable Power Cord
- LED Rear Loading Lights

INTERIOR HIGHLIGHTS

- Flip Up Rear Sofas
- Zebra Shades in Living Areas
- Raised Roofline for Taller Vehicles to Fit
- 2,500 lb. Tie Downs w/ Welded D Rings
- Tankless On Demand Water Heater
- 12V Bedroom Outlet for 12V TV
- Bluetooth Receiver System w/Outside Speakers
- Pleated Shades in Bedrooms
- 10 cu. ft. 12V Refrigerator
- 3 Burner Range w/ Oven
- 1000 Watt Microwave
- Black Stainless Steel Farm Sink
- Pull Down Spray Faucet
- Seamless Countertops
- Foot Flush Toilet
- LED Interior Lighting

EQUIPMENT

- 12V Battery Disconnect
- 15,000 BTU Ducted Air Conditioning
- Tankless On Demand Water Heater
- One Control System for Lights, Awning, Slides
- 30 Amp Service w/ Detachable Power Cord

SPECIFICATIONS

Unloaded Vehicle Weight	5,755
Dry Hitch Weight	1,105
Axle Weight	4,650
GVWR w/Brakes	11,305
Cargo Carrying Capacity	5,512
Exterior Length	27' 2"
Exterior Height w/ AC	12' 1"
Exterior Width	102"
Grey Capacity	40
Black Capacity	40
Fresh Capacity	100
Awning Size	12"
Linear Storage Space	20'

YOUR LOCAL DEALER:

For more information visit

www.forestriverinc.com/Rogue



Learn More
Scan this barcode using
a QR Reader on your
smart phone to learn
more about Forest River.



A Berkshire Hathaway company.

All information contained in this brochure is believed to be accurate at the time of publication. However, during the model year, it may be necessary to make revisions and Forest River, Inc. reserves the right to make all such changes without notice, including prices, colors, materials, equipment and specifications as well as the addition of new models and the discontinuance of models shown in this brochure. Therefore, please consult with your Forest River dealer and confirm the existence of and materials, design or specifications that are material to your purchase decision.



327SUT TOY HAULER 5TH WHEEL

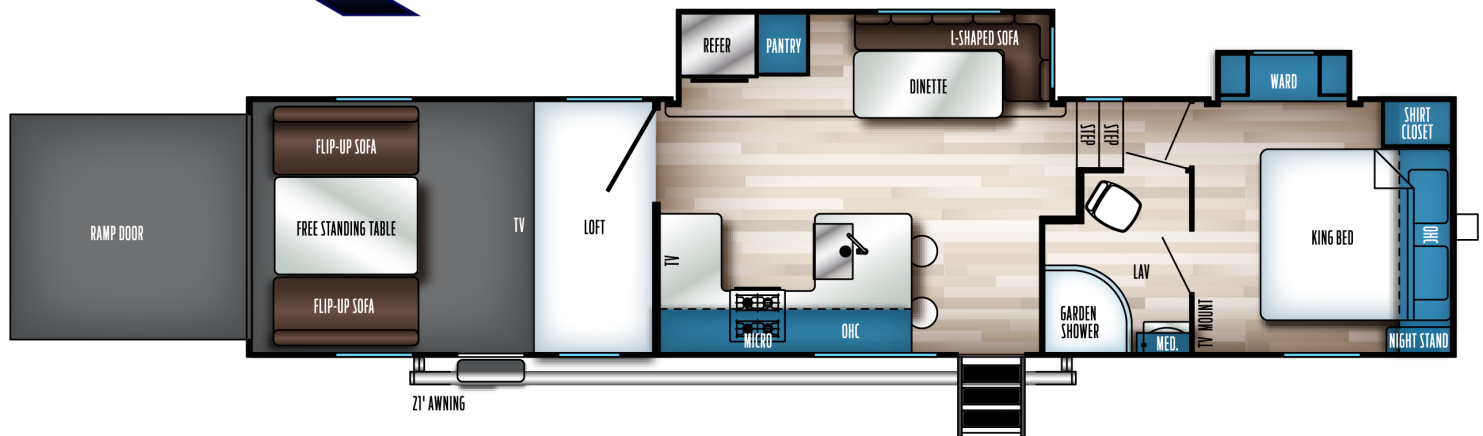

EXTERIOR HIGHLIGHTS

- 102" Wide Body Construction
- 30 Gallon Fuel Station
- 3,000 lb. Rated Ramp Door
- Two 20lb LP Tanks w/ Cover
- Generator Ready
- Enclosed Underbelly
- Four Camera Backup/Observation Camera Ready
- Black Tank Flush System
- Detachable Coil Spray Hose
- Outside Shower
- Spare Tire
- Power Awning w/ LED Lighting
- Solar Panel Ready
- Satellite Ready
- 30" Friction Hinge Entry Door
- Rogue Stable Steps
- Back up Camera Ready

INTERIOR HIGHLIGHTS

- Flip Up Rear Sofas
- Zebra Shades in Living Areas
- Raised Roofline for Taller Vehicles to Fit
- 2,500 lb. Tie Downs w/ Welded D Rings
- Tankless On Demand Water Heater
- Rear Screen Wall
- 12V Bedroom Outlet for 12V TV
- Bluetooth Receiver System w/ Outside Speakers
- Multiple USB Charging Stations
- Pleated Shades in Bedrooms
- 10 cu. ft. 12V Refrigerator
- 3 Burner Range w/ Oven
- 1000 Watt Microwave
- Black Stainless Steel Farm Sink
- Pull Down Spray Faucet
- Seamless Countertops
- Glass Shower Enclosure

EQUIPMENT

- 12V Battery Disconnect
- 15,000 BTU Ducted Air Conditioning
- Generator Ready
- One Control System for Lights, Awning, Slides
- 50 Amp Service w/ Detachable Power Cord

SPECIFICATIONS

Unloaded Vehicle Weight	11,395
Dry Hitch Weight	2,795
Axle Weight	8,600
GVWR w/Brakes	16,795
Cargo Carrying Capacity	5,362
Exterior Length	39' 11"
Exterior Height w/ AC	13' 4"
Exterior Width	102"
Grey Capacity	40
Black Capacity	40
Fresh Capacity	100
Awning Size	21'
Garage Length	13'

YOUR LOCAL DEALER:

For more information visit

www.forestriverinc.com/Rogue



Learn More
Scan this barcode using
a QR Reader on your
smart phone to learn
more about Forest River.



A Berkshire Hathaway company.

All information contained in this brochure is believed to be accurate at the time of publication. However, during the model year, it may be necessary to make revisions and Forest River, Inc. reserves the right to make all such changes without notice, including prices, colors, materials, equipment and specifications as well as the addition of new models and the discontinuance of models shown in this brochure. Therefore, please consult with your Forest River dealer and confirm the existence of and materials, design or specifications that are material to your purchase decision.