

2023 OVERLAND SERIES

170MBH

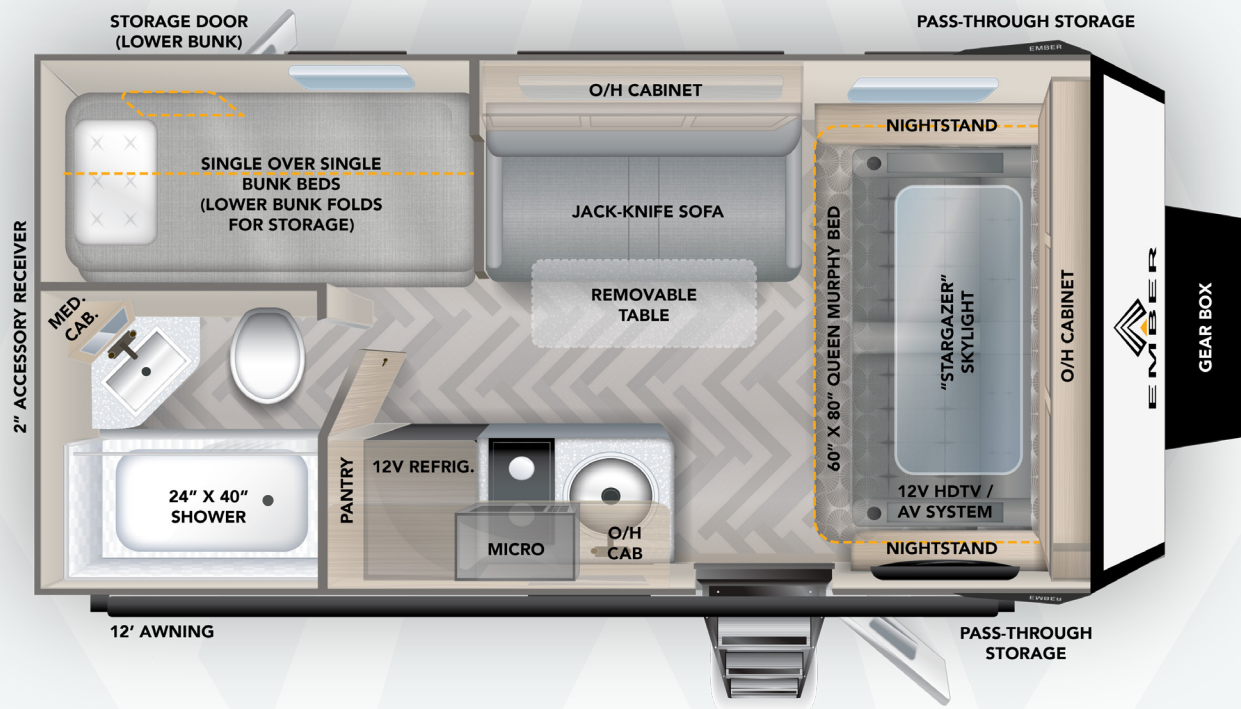

SPECIFICATIONS

	LENGTH	HEIGHT	DRY WEIGHT	HITCH WEIGHT
170MBH	20'6"	10'4"	4,190 LBS	650 LBS

KEY FEATURES

- Residential Queen Size 60" x 80" Murphy Bed with Sofa below
- "Stargazer" Skylight
- Jack-knife Sofa with Removable Table converts from lounging to sleeping
- Single over Single size Bunks
- Lower Bunk folds up creating Exterior/ Bike Storage below accessible through Lockable Side Door
- EmberLink "Smart RV" system controls Slide Room, Awning, and Lighting
- Standard Off-grid Solar Package with 200W Rooftop panel, 1000W Inverter, and 30 Amp Controller
- Sleeps 4-6



2023 OVERLAND SERIES



STANDARDS

Construction

- CURT Independent Suspension: Heavy-Duty Coil Springs with Dual Shock Absorbers (each wheel)
- Trailblazer™ Heavy-Duty Offroad Chassis
- VersaCoupler™ Height-Adjustable Bolt-On Hitching System
- 5-Sided Aluminum Frame Construction
- Laminated Azdel Onboard® Composite Walls (inner and outer substrates)
- Laminated Azdel Onboard® Composite Rooftop (inner and outer substrates)
- TRANSCORE™ Structural Composite Flooring
- Steel Fenders/Wheel Wells
- Aluminum Bed, Bunk, and/or Dinette Construction (where applicable)

Exterior

- European Dual-Pane Acrylic Windows with Integrated Shades
- Nitro-filled 16" Goodyear Wrangler Off-Road Tires - Load Range E (including spare)
- Custom Aluminum Rims (including spare)
- Gear Box: Tongue-Mounted, Formed Aluminum, LP and Lockable Storage
- XL Fresh Water Tank (55 gallons)
- Fully Adjustable Triple Solid Step™
- 13.5K BTU Low Profile Roof A/C
- Electric Awning with Dimmable LED Light
- Front Electric Flat Jack
- Go Power!® 200W Rooftop Solar Panel
- Side and Rooftop Solar Ports
- Tire Pressure Monitoring System (TPMS)
- Pre-wired For Rear/Side Observation Camera
- Lockable Parking Brake
- High-Visibility LED Exterior Lighting
- Back-Up Light
- Keyed-Alike System
- Enclosed Radiant Barrier Underbelly
- 12V Tank Heaters
- Self-Adjusting Electric Brakes

- Dual 20# LP Tanks (40# total capacity)
- LP Quick Connect
- 30 Amp Service
- Detachable Shore Power Cord with Faultsmart™ indicators and Pullsmart™ handle
- Outside Shower
- Standard Frame Integrated Rear 2" Accessory Receiver
- Front and Rear Quick Drop™ Stabilizers
- Repositionable/Telescoping Roof Ladder + Bracket
- Winegard Air 360+ Omnidirectional Antenna
- 360 Siphon® Cap on Black Tank
- Black Tank Flush
- Repositionable/Telescoping Roof Ladder

Interior

- "Stargazer" European Dual Pane Acrylic Skylight
- 60" x 80" Residential-Sized Queen Bed
- EmberLink™ Smart RV Control System
- 12V LED HDTV w/ Built-In Bluetooth
- 1000W Pure Sine Wave Inverter
- 30 Amp Solar Controller
- Smoke/CO/LP Detectors
- Fire Extinguisher
- 12V Refrigerator
- Microwave
- Hardwood Framed Cabinet Doors and Drawer Fronts
- Dimmable Interior/Exterior LED Lighting
- 3-Speed 12V Powered Ceiling Vent
- Seamless Countertops
- Shaw Flooring
- Stainless Steel Kitchen Sink with Flush Mount Cover
- Dual-burner cooktop
- Showermiser™ Fresh Water Saver
- Porcelain Foot Flush Toilet
- Winegard 360+ WiFi Prep

OPTIONS

- (MANDATORY) Truma Combi: High Efficiency LP Water Heater and Furnace Combo
- (MANDATORY) Truma Aventa A/C: Low-profile "Whisper Quiet" Energy Efficient 13,500 BTU Air Conditioner
- Outside Griddle (connects to LP Quick Connect, N/A 170MBH, 191MSL, 201FBQ)
- Wireless Side/Rear Observation Camera System with Monitor
- MAX SOLAR PACKAGE: 3000W Inverter (in place of 1000W), 270Ah 12V Battle Born® Gamechanger Lithium-ion (LiFePO4) Battery, Two Additional Roof-mounted 200W Solar Panels (600W total), Upgraded Bluetooth MPPT Controller
- Additional 270Ah 12V Battle Born® Gamechanger Lithium-ion (LiFePO4) Battery



FINALIST



NOTES



2023 OVERLAND SERIES

170MRB

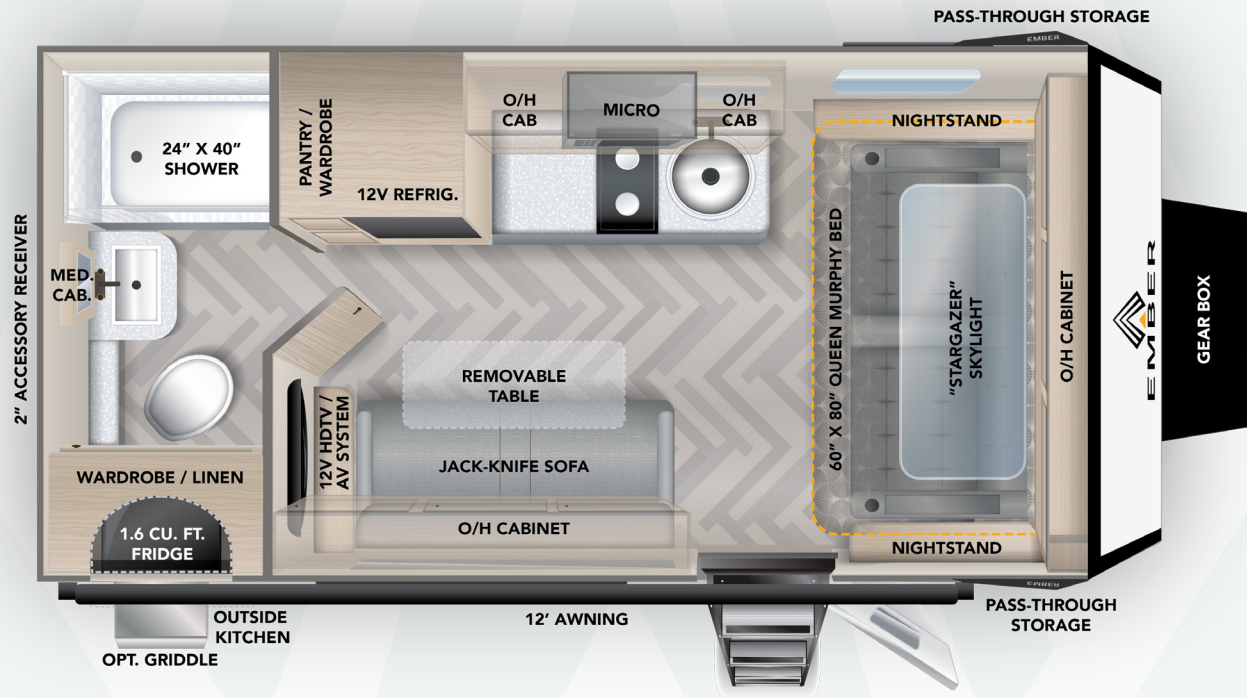

SPECIFICATIONS

	LENGTH	HEIGHT	DRY WEIGHT	HITCH WEIGHT
170MRB	20'6"	10'4"	4,180 LBS	630 LBS

KEY FEATURES

- Residential Queen Size 60" x 80" Murphy Bed with Sofa below
- "Stargazer" Skylight
- Jack-knife Sofa with Removable Table converts from lounging to sleeping
- Large Rear Bathroom features extra Wardrobe and Linen storage
- Outside kitchen with 1.6 cu. ft. Fridge and room for optional Griddle
- EmberLink "Smart RV" system controls Slide Room, Awning, and Lighting
- Standard Off-grid Solar Package with 200W Rooftop panel, 1000W Inverter, and 30 Amp Controller
- Sleeps 2-4



2023 OVERLAND SERIES



STANDARDS

Construction

- CURT Independent Suspension: Heavy-Duty Coil Springs with Dual Shock Absorbers (each wheel)
- Trailblazer™ Heavy-Duty Offroad Chassis
- VersaCoupler™ Height-Adjustable Bolt-On Hitching System
- 5-Sided Aluminum Frame Construction
- Laminated Azdel Onboard® Composite Walls (inner and outer substrates)
- Laminated Azdel Onboard® Composite Rooftop (inner and outer substrates)
- TRANSCORE™ Structural Composite Flooring
- Steel Fenders/Wheel Wells
- Aluminum Bed, Bunk, and/or Dinette Construction (where applicable)

Exterior

- European Dual-Pane Acrylic Windows with Integrated Shades
- Nitro-filled 16" Goodyear Wrangler Off-Road Tires - Load Range E (including spare)
- Custom Aluminum Rims (including spare)
- Gear Box: Tongue-Mounted, Formed Aluminum, LP and Lockable Storage
- XL Fresh Water Tank (55 gallons)
- Fully Adjustable Triple Solid Step™
- 13.5K BTU Low Profile Roof A/C
- Electric Awning with Dimmable LED Light
- Front Electric Flat Jack
- Go Power!® 200W Rooftop Solar Panel
- Side and Rooftop Solar Ports
- Tire Pressure Monitoring System (TPMS)
- Pre-wired For Rear/Side Observation Camera
- Lockable Parking Brake
- High-Visibility LED Exterior Lighting
- Back-Up Light
- Keyed-Alike System
- Enclosed Radiant Barrier Underbelly
- 12V Tank Heaters
- Self-Adjusting Electric Brakes

- Dual 20# LP Tanks (40# total capacity)
- LP Quick Connect
- 30 Amp Service
- Detachable Shore Power Cord with Faultsmart™ indicators and Pullsmart™ handle
- Outside Shower
- Standard Frame Integrated Rear 2" Accessory Receiver
- Front and Rear Quick Drop™ Stabilizers
- Repositionable/Telescoping Roof Ladder + Bracket
- Winegard Air 360+ Omnidirectional Antenna
- 360 Siphon® Cap on Black Tank
- Black Tank Flush
- Repositionable/Telescoping Roof Ladder

Interior

- "Stargazer" European Dual Pane Acrylic Skylight
- 60" x 80" Residential-Sized Queen Bed
- EmberLink™ Smart RV Control System
- 12V LED HDTV w/ Built-In Bluetooth
- 1000W Pure Sine Wave Inverter
- 30 Amp Solar Controller
- Smoke/CO/LP Detectors
- Fire Extinguisher
- 12V Refrigerator
- Microwave
- Hardwood Framed Cabinet Doors and Drawer Fronts
- Dimmable Interior/Exterior LED Lighting
- 3-Speed 12V Powered Ceiling Vent
- Seamless Countertops
- Shaw Flooring
- Stainless Steel Kitchen Sink with Flush Mount Cover
- Dual-burner cooktop
- Showermiser™ Fresh Water Saver
- Porcelain Foot Flush Toilet
- Winegard 360+ WiFi Prep

OPTIONS

- (MANDATORY) Truma Combi: High Efficiency LP Water Heater and Furnace Combo
- (MANDATORY) Truma Aventa A/C: Low-profile "Whisper Quiet" Energy Efficient 13,500 BTU Air Conditioner
- Outside Griddle (connects to LP Quick Connect, N/A 170MBH, 191MSL, 201FBQ)
- Wireless Side/Rear Observation Camera System with Monitor
- MAX SOLAR PACKAGE: 3000W Inverter (in place of 1000W), 270Ah 12V Battle Born® Gamechanger Lithium-ion (LiFePO4) Battery, Two Additional Roof-mounted 200W Solar Panels (600W total), Upgraded Bluetooth MPPT Controller
- Additional 270Ah 12V Battle Born® Gamechanger Lithium-ion (LiFePO4) Battery



FINALIST



NOTES



2023 OVERLAND SERIES

171FB

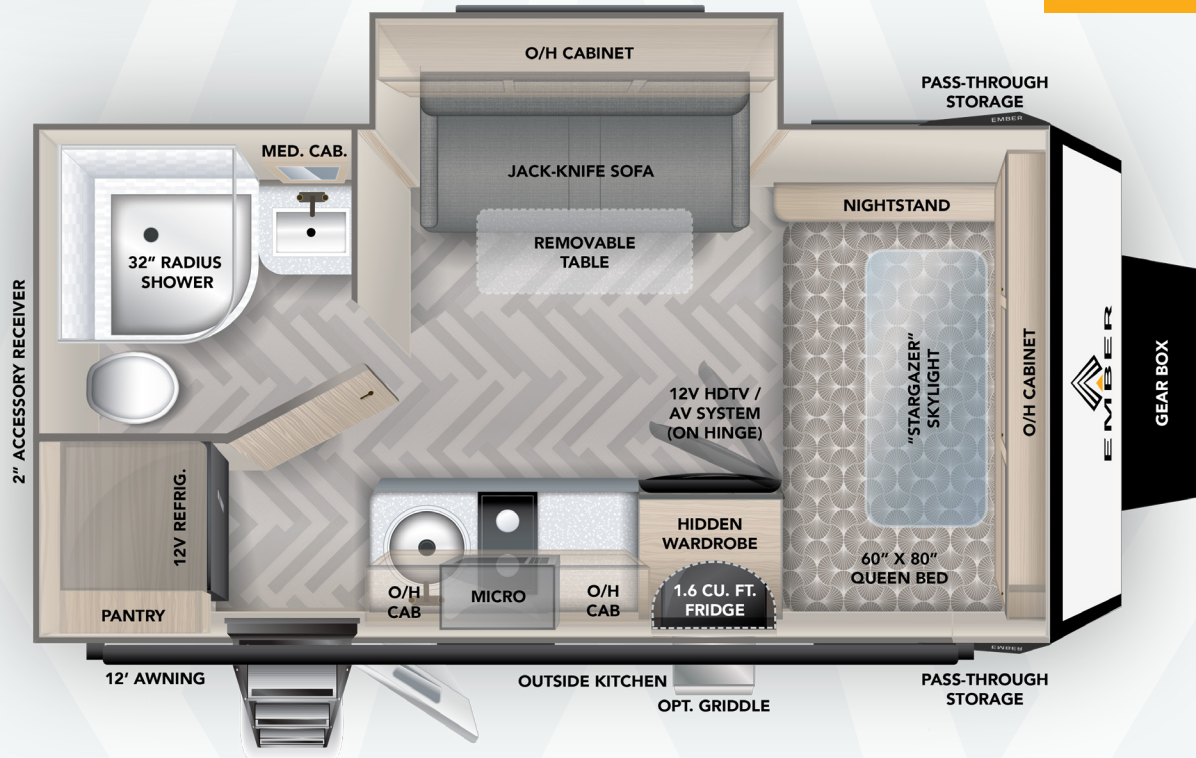

SPECIFICATIONS

	LENGTH	HEIGHT	DRY WEIGHT	HITCH WEIGHT
171FB	20'6"	10'4"	4,165 LBS	570 LBS

KEY FEATURES

- Residential Queen Size 60" x 80" Front Bed with Storage below
- "Stargazer" Skylight
- Jack-knife Sofa with Removable Table converts from lounging to sleeping
- 12V HDTV opens on bracket to reveal Hidden Wardrobe Storage
- Outside kitchen with 1.6 cu. ft. Fridge and room for optional Griddle
- EmberLink "Smart RV" system controls Slide Room, Awning, and Lighting
- Standard Off-grid Solar Package with 200W Rooftop Panel, 1000W Inverter, and 30 Amp Controller
- Sleeps 2-4



2023 OVERLAND SERIES



STANDARDS

Construction

- CURT Independent Suspension: Heavy-Duty Coil Springs with Dual Shock Absorbers (each wheel)
- Trailblazer™ Heavy-Duty Offroad Chassis
- VersaCoupler™ Height-Adjustable Bolt-On Hitching System
- 5-Sided Aluminum Frame Construction
- Laminated Azdel Onboard® Composite Walls (inner and outer substrates)
- Laminated Azdel Onboard® Composite Rooftop (inner and outer substrates)
- TRANSCORE™ Structural Composite Flooring
- Steel Fenders/Wheel Wells
- Aluminum Bed, Bunk, and/or Dinette Construction (where applicable)

Exterior

- European Dual-Pane Acrylic Windows with Integrated Shades
- Nitro-filled 16" Goodyear Wrangler Off-Road Tires - Load Range E (including spare)
- Custom Aluminum Rims (including spare)
- Gear Box: Tongue-Mounted, Formed Aluminum, LP and Lockable Storage
- XL Fresh Water Tank (55 gallons)
- Fully Adjustable Triple Solid Step™
- 13.5K BTU Low Profile Roof A/C
- Electric Awning with Dimmable LED Light
- Front Electric Flat Jack
- Go Power!® 200W Rooftop Solar Panel
- Side and Rooftop Solar Ports
- Tire Pressure Monitoring System (TPMS)
- Pre-wired For Rear/Side Observation Camera
- Lockable Parking Brake
- High-Visibility LED Exterior Lighting
- Back-Up Light
- Keyed-Alike System
- Enclosed Radiant Barrier Underbelly
- 12V Tank Heaters
- Self-Adjusting Electric Brakes

- Dual 20# LP Tanks (40# total capacity)
- LP Quick Connect
- 30 Amp Service
- Detachable Shore Power Cord with Faultsmart™ indicators and Pullsmart™ handle
- Outside Shower
- Standard Frame Integrated Rear 2" Accessory Receiver
- Front and Rear Quick Drop™ Stabilizers
- Repositionable/Telescoping Roof Ladder + Bracket
- Winegard Air 360+ Omnidirectional Antenna
- 360 Siphon® Cap on Black Tank
- Black Tank Flush
- Repositionable/Telescoping Roof Ladder

Interior

- "Stargazer" European Dual Pane Acrylic Skylight
- 60" x 80" Residential-Sized Queen Bed
- EmberLink™ Smart RV Control System
- 12V LED HDTV w/ Built-In Bluetooth
- 1000W Pure Sine Wave Inverter
- 30 Amp Solar Controller
- Smoke/CO/LP Detectors
- Fire Extinguisher
- 12V Refrigerator
- Microwave
- Hardwood Framed Cabinet Doors and Drawer Fronts
- Dimmable Interior/Exterior LED Lighting
- 3-Speed 12V Powered Ceiling Vent
- Seamless Countertops
- Shaw Flooring
- Stainless Steel Kitchen Sink with Flush Mount Cover
- Dual-burner cooktop
- Showermiser™ Fresh Water Saver
- Porcelain Foot Flush Toilet
- Winegard 360+ WiFi Prep

OPTIONS

- (MANDATORY) Truma Combi: High Efficiency LP Water Heater and Furnace Combo
- (MANDATORY) Truma Aventa A/C: Low-profile "Whisper Quiet" Energy Efficient 13,500 BTU Air Conditioner
- Outside Griddle (connects to LP Quick Connect, N/A 170MBH, 191MSL, 201FBQ)
- Wireless Side/Rear Observation Camera System with Monitor
- MAX SOLAR PACKAGE: 3000W Inverter (in place of 1000W), 270Ah 12V Battle Born® Gamechanger Lithium-ion (LiFePO4) Battery, Two Additional Roof-mounted 200W Solar Panels (600W total), Upgraded Bluetooth MPPT Controller
- Additional 270Ah 12V Battle Born® Gamechanger Lithium-ion (LiFePO4) Battery



FINALIST



NOTES



2023 OVERLAND SERIES

190MDB

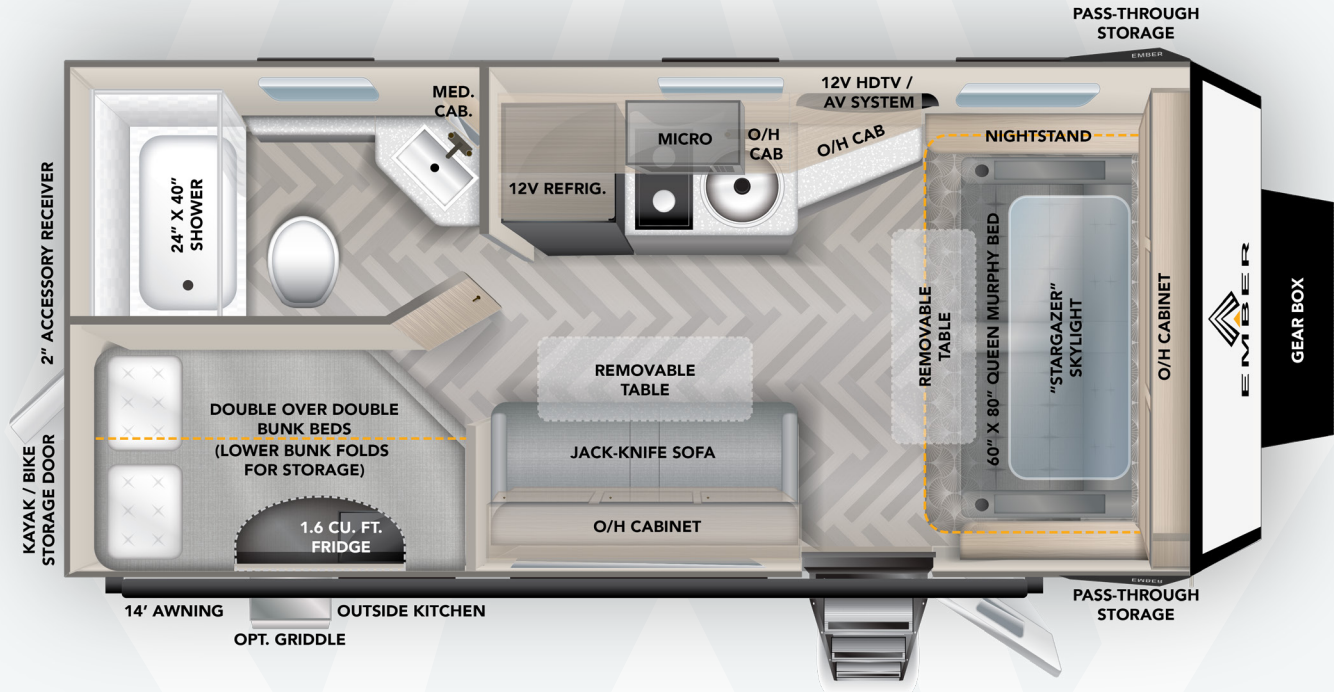

SPECIFICATIONS

	LENGTH	HEIGHT	DRY WEIGHT	HITCH WEIGHT
190MDB	22'6"	10'4"	4,385 LBS	580 LBS

KEY FEATURES

- Residential Queen Size 60" x 80" Murphy Bed with Sofa and Removable Table
- "Stargazer" Skylight
- Jack-knife Sofa with Removable Table converts from lounging to sleeping
- Large Double over Double size Bunks
- Lower Bunk folds up creating Bike/ Kayak Storage Below accessible through Lockable Rear Door
- Outside kitchen with 1.6 cu. ft. Fridge and room for optional Griddle
- EmberLink "Smart RV" system controls Slide Room, Awning, and Lighting
- Standard Off-grid Solar Package with 200W Rooftop Panel, 1000W Inverter, and 30 Amp Controller
- Sleeps 5-8



2023 OVERLAND SERIES



STANDARDS

Construction

- CURT Independent Suspension: Heavy-Duty Coil Springs with Dual Shock Absorbers (each wheel)
- Trailblazer™ Heavy-Duty Offroad Chassis
- VersaCoupler™ Height-Adjustable Bolt-On Hitching System
- 5-Sided Aluminum Frame Construction
- Laminated Azdel Onboard® Composite Walls (inner and outer substrates)
- Laminated Azdel Onboard® Composite Rooftop (inner and outer substrates)
- TRANSCORE™ Structural Composite Flooring
- Steel Fenders/Wheel Wells
- Aluminum Bed, Bunk, and/or Dinette Construction (where applicable)

Exterior

- European Dual-Pane Acrylic Windows with Integrated Shades
- Nitro-filled 16" Goodyear Wrangler Off-Road Tires - Load Range E (including spare)
- Custom Aluminum Rims (including spare)
- Gear Box: Tongue-Mounted, Formed Aluminum, LP and Lockable Storage
- XL Fresh Water Tank (55 gallons)
- Fully Adjustable Triple Solid Step™
- 13.5K BTU Low Profile Roof A/C
- Electric Awning with Dimmable LED Light
- Front Electric Flat Jack
- Go Power!® 200W Rooftop Solar Panel
- Side and Rooftop Solar Ports
- Tire Pressure Monitoring System (TPMS)
- Pre-wired For Rear/Side Observation Camera
- Lockable Parking Brake
- High-Visibility LED Exterior Lighting
- Back-Up Light
- Keyed-Alike System
- Enclosed Radiant Barrier Underbelly
- 12V Tank Heaters
- Self-Adjusting Electric Brakes

- Dual 20# LP Tanks (40# total capacity)
- LP Quick Connect
- 30 Amp Service
- Detachable Shore Power Cord with Faultsmart™ indicators and Pullsmart™ handle
- Outside Shower
- Standard Frame Integrated Rear 2" Accessory Receiver
- Front and Rear Quick Drop™ Stabilizers
- Repositionable/Telescoping Roof Ladder + Bracket
- Winegard Air 360+ Omnidirectional Antenna
- 360 Siphon® Cap on Black Tank
- Black Tank Flush
- Repositionable/Telescoping Roof Ladder

Interior

- "Stargazer" European Dual Pane Acrylic Skylight
- 60" x 80" Residential-Sized Queen Bed
- EmberLink™ Smart RV Control System
- 12V LED HDTV w/ Built-In Bluetooth
- 1000W Pure Sine Wave Inverter
- 30 Amp Solar Controller
- Smoke/CO/LP Detectors
- Fire Extinguisher
- 12V Refrigerator
- Microwave
- Hardwood Framed Cabinet Doors and Drawer Fronts
- Dimmable Interior/Exterior LED Lighting
- 3-Speed 12V Powered Ceiling Vent
- Seamless Countertops
- Shaw Flooring
- Stainless Steel Kitchen Sink with Flush Mount Cover
- Dual-burner cooktop
- Showermiser™ Fresh Water Saver
- Porcelain Foot Flush Toilet
- Winegard 360+ WiFi Prep

OPTIONS

- (MANDATORY) Truma Combi: High Efficiency LP Water Heater and Furnace Combo
- (MANDATORY) Truma Aventa A/C: Low-profile "Whisper Quiet" Energy Efficient 13,500 BTU Air Conditioner
- Outside Griddle (connects to LP Quick Connect, N/A 170MBH, 191MSL, 201FBQ)
- Wireless Side/Rear Observation Camera System with Monitor
- MAX SOLAR PACKAGE: 3000W Inverter (in place of 1000W), 270Ah 12V Battle Born® Gamechanger Lithium-ion (LiFePO4) Battery, Two Additional Roof-mounted 200W Solar Panels (600W total), Upgraded Bluetooth MPPT Controller
- Additional 270Ah 12V Battle Born® Gamechanger Lithium-ion (LiFePO4) Battery



FINALIST



NOTES



2023 OVERLAND SERIES

191MDB

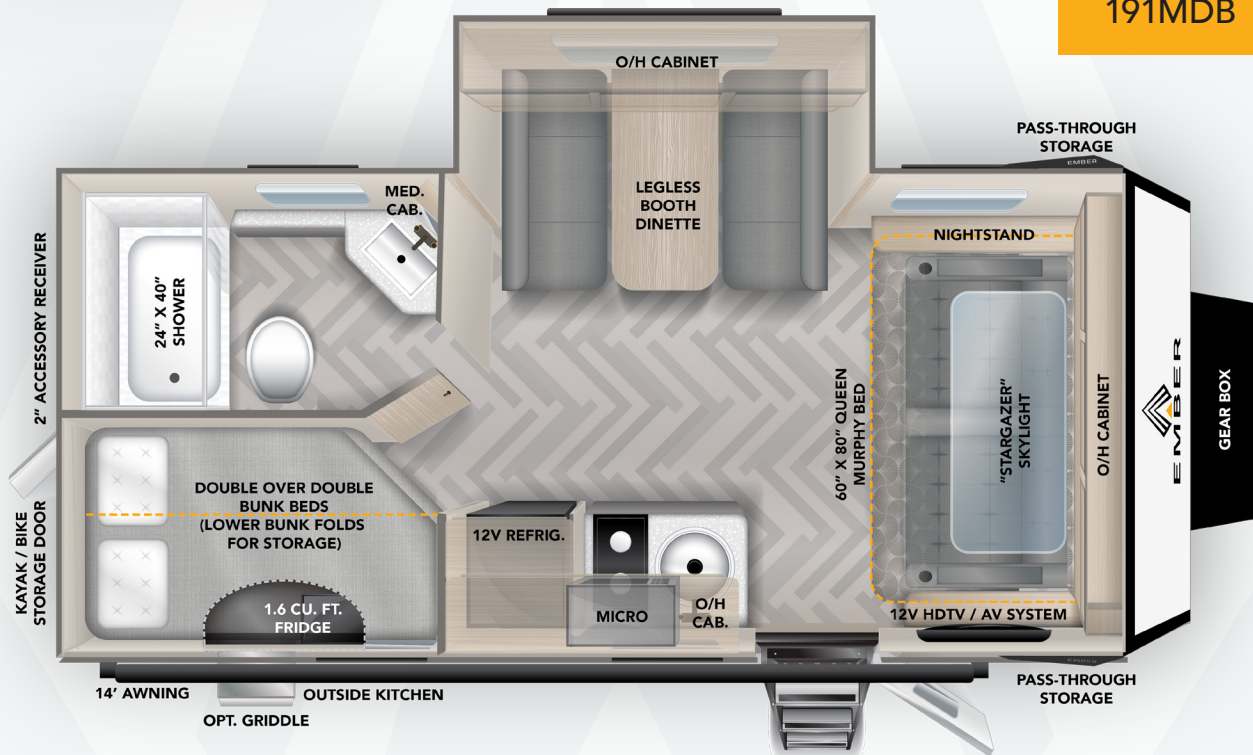

SPECIFICATIONS

	LENGTH	HEIGHT	DRY WEIGHT	HITCH WEIGHT
191MDB	22'6"	10'4"	4,780 LBS	680 LBS

KEY FEATURES

- Residential Queen Size 60" x 80" Murphy Bed with Sofa below
- "Stargazer" Skylight
- Legless Booth Dinette converts to Bunk
- Large Double over Double size Bunks
- Lower Bunk folds up creating Bike/ Kayak Storage Below accessible through Lockable Rear Door
- Outside kitchen with 1.6 cu. ft. Fridge and room for optional Griddle
- EmberLink "Smart RV" system controls Slide Room, Awning, and Lighting
- Standard Off-grid Solar Package with 200W Rooftop Panel, 1000W Inverter, and 30 Amp Controller
- Sleeps 5-8



2023 OVERLAND SERIES



STANDARDS

Construction

- CURT Independent Suspension: Heavy-Duty Coil Springs with Dual Shock Absorbers (each wheel)
- Trailblazer™ Heavy-Duty Offroad Chassis
- VersaCoupler™ Height-Adjustable Bolt-On Hitching System
- 5-Sided Aluminum Frame Construction
- Laminated Azdel Onboard® Composite Walls (inner and outer substrates)
- Laminated Azdel Onboard® Composite Rooftop (inner and outer substrates)
- TRANSCORE™ Structural Composite Flooring
- Steel Fenders/Wheel Wells
- Aluminum Bed, Bunk, and/or Dinette Construction (where applicable)

Exterior

- European Dual-Pane Acrylic Windows with Integrated Shades
- Nitro-filled 16" Goodyear Wrangler Off-Road Tires - Load Range E (including spare)
- Custom Aluminum Rims (including spare)
- Gear Box: Tongue-Mounted, Formed Aluminum, LP and Lockable Storage
- XL Fresh Water Tank (55 gallons)
- Fully Adjustable Triple Solid Step™
- 13.5K BTU Low Profile Roof A/C
- Electric Awning with Dimmable LED Light
- Front Electric Flat Jack
- Go Power!® 200W Rooftop Solar Panel
- Side and Rooftop Solar Ports
- Tire Pressure Monitoring System (TPMS)
- Pre-wired For Rear/Side Observation Camera
- Lockable Parking Brake
- High-Visibility LED Exterior Lighting
- Back-Up Light
- Keyed-Alike System
- Enclosed Radiant Barrier Underbelly
- 12V Tank Heaters
- Self-Adjusting Electric Brakes

- Dual 20# LP Tanks (40# total capacity)
- LP Quick Connect
- 30 Amp Service
- Detachable Shore Power Cord with Faultsmart™ indicators and Pullsmart™ handle
- Outside Shower
- Standard Frame Integrated Rear 2" Accessory Receiver
- Front and Rear Quick Drop™ Stabilizers
- Repositionable/Telescoping Roof Ladder + Bracket
- Winegard Air 360+ Omnidirectional Antenna
- 360 Siphon® Cap on Black Tank
- Black Tank Flush
- Repositionable/Telescoping Roof Ladder

Interior

- "Stargazer" European Dual Pane Acrylic Skylight
- 60" x 80" Residential-Sized Queen Bed
- EmberLink™ Smart RV Control System
- 12V LED HDTV w/ Built-In Bluetooth
- 1000W Pure Sine Wave Inverter
- 30 Amp Solar Controller
- Smoke/CO/LP Detectors
- Fire Extinguisher
- 12V Refrigerator
- Microwave
- Hardwood Framed Cabinet Doors and Drawer Fronts
- Dimmable Interior/Exterior LED Lighting
- 3-Speed 12V Powered Ceiling Vent
- Seamless Countertops
- Shaw Flooring
- Stainless Steel Kitchen Sink with Flush Mount Cover
- Dual-burner cooktop
- Showermiser™ Fresh Water Saver
- Porcelain Foot Flush Toilet
- Winegard 360+ WiFi Prep

OPTIONS

- (MANDATORY) Truma Combi: High Efficiency LP Water Heater and Furnace Combo
- (MANDATORY) Truma Aventa A/C: Low-profile "Whisper Quiet" Energy Efficient 13,500 BTU Air Conditioner
- Outside Griddle (connects to LP Quick Connect, N/A 170MBH, 191MSL, 201FBQ)
- Wireless Side/Rear Observation Camera System with Monitor
- MAX SOLAR PACKAGE: 3000W Inverter (in place of 1000W), 270Ah 12V Battle Born® Gamechanger Lithium-ion (LiFePO4) Battery, Two Additional Roof-mounted 200W Solar Panels (600W total), Upgraded Bluetooth MPPT Controller
- Additional 270Ah 12V Battle Born® Gamechanger Lithium-ion (LiFePO4) Battery



FINALIST



NOTES



2023 OVERLAND SERIES

191MSL

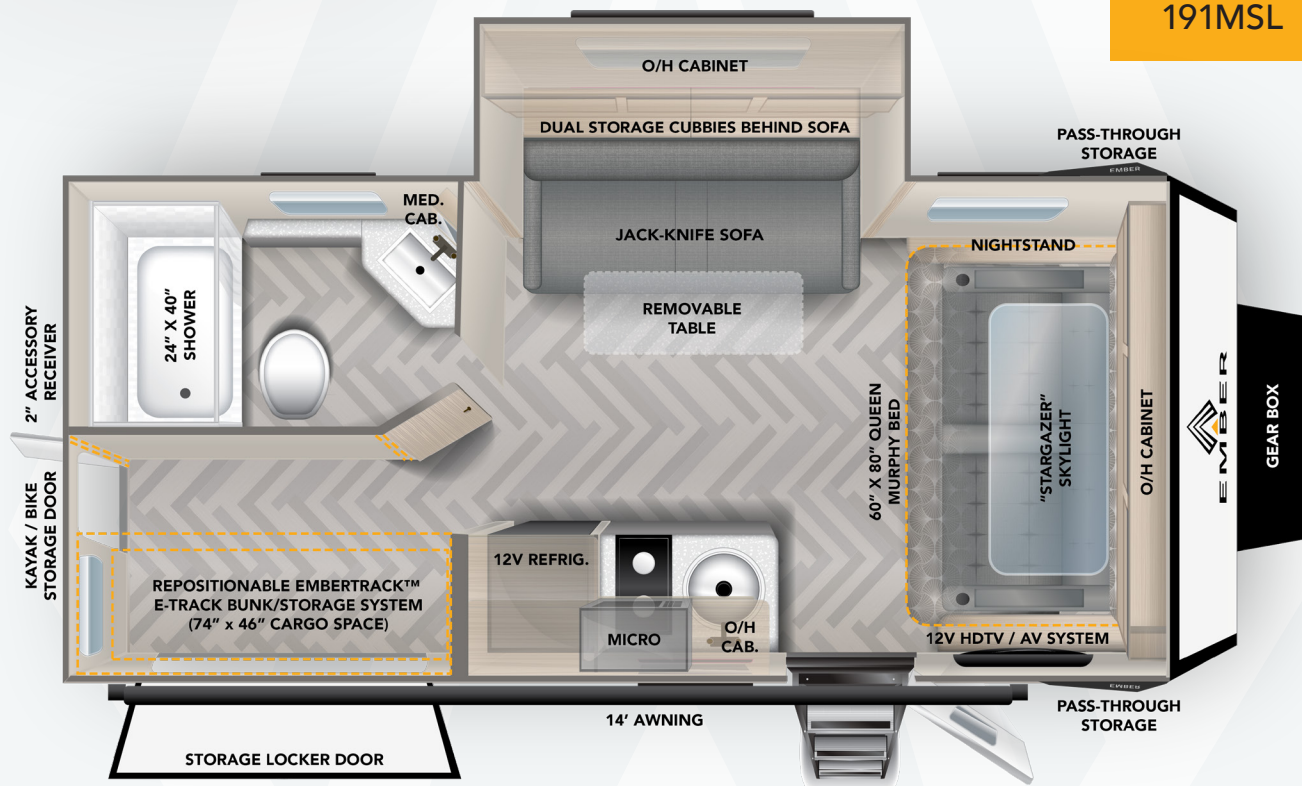

SPECIFICATIONS

	LENGTH	HEIGHT	DRY WEIGHT	HITCH WEIGHT
191MSL	22'6"	10'4"	4,505 LBS	605 LBS

KEY FEATURES

- Residential Queen Size 60" x 80" Murphy Bed with Sofa below
- "Stargazer" Skylight
- Jack-Knife Sofa Slide with Removable Table and Dual Built-In Storage Cubbies
- 74" x 46" Rear "Do-It-Yourself" Cargo Area with Repositionable EmberTrack™ E-Track Bunk/Storage System
- Large Exterior Storage Locker Door and Rear Kayak/Bike Door
- EmberLink "Smart RV" system controls Slide Room, Awning, and Lighting
- Standard Off-grid Solar Package with 200W Rooftop Panel, 1000W Inverter, and 30 Amp Controller
- Sleeps 4-6



2023 OVERLAND SERIES



STANDARDS

Construction

- CURT Independent Suspension: Heavy-Duty Coil Springs with Dual Shock Absorbers (each wheel)
- Trailblazer™ Heavy-Duty Offroad Chassis
- VersaCoupler™ Height-Adjustable Bolt-On Hitching System
- 5-Sided Aluminum Frame Construction
- Laminated Azdel Onboard® Composite Walls (inner and outer substrates)
- Laminated Azdel Onboard® Composite Rooftop (inner and outer substrates)
- TRANSCORE™ Structural Composite Flooring
- Steel Fenders/Wheel Wells
- Aluminum Bed, Bunk, and/or Dinette Construction (where applicable)

Exterior

- European Dual-Pane Acrylic Windows with Integrated Shades
- Nitro-filled 16" Goodyear Wrangler Off-Road Tires - Load Range E (including spare)
- Custom Aluminum Rims (including spare)
- Gear Box: Tongue-Mounted, Formed Aluminum, LP and Lockable Storage
- XL Fresh Water Tank (55 gallons)
- Fully Adjustable Triple Solid Step™
- 13.5K BTU Low Profile Roof A/C
- Electric Awning with Dimmable LED Light
- Front Electric Flat Jack
- Go Power!® 200W Rooftop Solar Panel
- Side and Rooftop Solar Ports
- Tire Pressure Monitoring System (TPMS)
- Pre-wired For Rear/Side Observation Camera
- Lockable Parking Brake
- High-Visibility LED Exterior Lighting
- Back-Up Light
- Keyed-Alike System
- Enclosed Radiant Barrier Underbelly
- 12V Tank Heaters
- Self-Adjusting Electric Brakes

- Dual 20# LP Tanks (40# total capacity)
- LP Quick Connect
- 30 Amp Service
- Detachable Shore Power Cord with Faultsmart™ indicators and Pullsmart™ handle
- Outside Shower
- Standard Frame Integrated Rear 2" Accessory Receiver
- Front and Rear Quick Drop™ Stabilizers
- Repositionable/Telescoping Roof Ladder + Bracket
- Winegard Air 360+ Omnidirectional Antenna
- 360 Siphon® Cap on Black Tank
- Black Tank Flush
- Repositionable/Telescoping Roof Ladder

Interior

- "Stargazer" European Dual Pane Acrylic Skylight
- 60" x 80" Residential-Sized Queen Bed
- EmberLink™ Smart RV Control System
- 12V LED HDTV w/ Built-In Bluetooth
- 1000W Pure Sine Wave Inverter
- 30 Amp Solar Controller
- Smoke/CO/LP Detectors
- Fire Extinguisher
- 12V Refrigerator
- Microwave
- Hardwood Framed Cabinet Doors and Drawer Fronts
- Dimmable Interior/Exterior LED Lighting
- 3-Speed 12V Powered Ceiling Vent
- Seamless Countertops
- Shaw Flooring
- Stainless Steel Kitchen Sink with Flush Mount Cover
- Dual-burner cooktop
- Showermiser™ Fresh Water Saver
- Porcelain Foot Flush Toilet
- Winegard 360+ WiFi Prep

OPTIONS

- (MANDATORY) Truma Combi: High Efficiency LP Water Heater and Furnace Combo
- (MANDATORY) Truma Aventa A/C: Low-profile "Whisper Quiet" Energy Efficient 13,500 BTU Air Conditioner
- Outside Griddle (connects to LP Quick Connect, N/A 170MBH, 191MSL, 201FBQ)
- Wireless Side/Rear Observation Camera System with Monitor
- MAX SOLAR PACKAGE: 3000W Inverter (in place of 1000W), 270Ah 12V Battle Born® Gamechanger Lithium-ion (LiFePO4) Battery, Two Additional Roof-mounted 200W Solar Panels (600W total), Upgraded Bluetooth MPPT Controller
- Additional 270Ah 12V Battle Born® Gamechanger Lithium-ion (LiFePO4) Battery



FINALIST



NOTES



2023 OVERLAND SERIES TANDEM

201FBQ

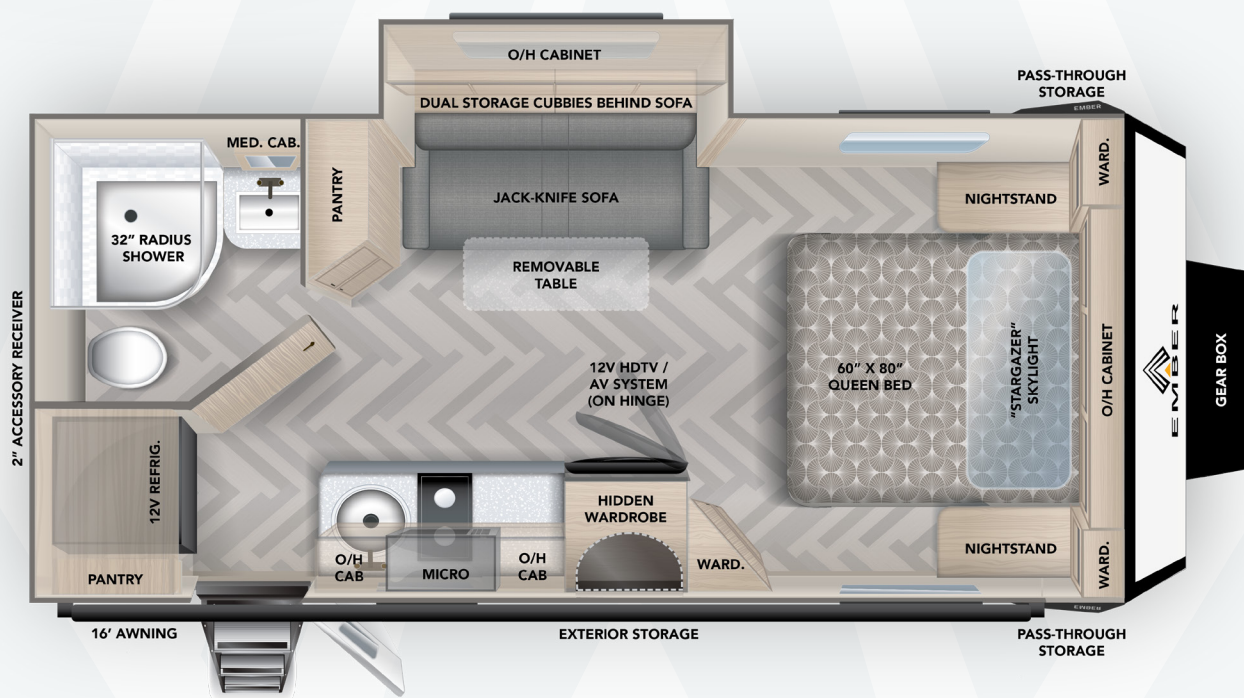

SPECIFICATIONS

	LENGTH	HEIGHT	DRY WEIGHT	HITCH WEIGHT
201FBQ	24'1"	10'4"	5,255 LBS	605 LBS

KEY FEATURES

- Tandem CURT Independent Suspension
- Walk-around Residential Queen Size 60" x 80" Front Bed with Storage below
- "Stargazer" Skylight
- Side Wardrobe Storage, Nightstands, and Overhead Cabinets above Bed
- Jack-Knife Sofa Slide with Removable Table and Dual Built-In Storage Cubbies
- 12V HDTV opens on bracket to reveal Hidden Wardrobe Storage
- EmberLink "Smart RV" system controls Slide Room, Awning, and Lighting
- Standard Off-grid Solar Package with 200W Rooftop Panel, 1000W Inverter, and 30 Amp Controller
- Sleeps 2-4



2023 OVERLAND SERIES TANDEM



STANDARDS

Construction

- Tandem CURT Independent Suspension: Heavy-Duty Coil Springs with Dual Shock Absorbers (each wheel)
- Trailblazer™ Heavy-Duty Offroad Chassis
- VersaCoupler™ Height-Adjustable Bolt-On Hitching System
- 5-Sided Aluminum Frame Construction
- Laminated Azdel Onboard® Composite Walls (inner and outer substrates)
- Laminated Azdel Onboard® Composite Rooftop (inner and outer substrates)
- TRANSCORE™ Structural Composite Flooring
- Steel Fenders/Wheel Wells
- Aluminum Bed, Bunk, and/or Dinette Construction (where applicable)
- 30 Amp Service
- Detachable Shore Power Cord with Faultsmart™ indicators and Pullsmart™ handle
- Outside Shower
- Standard Frame Integrated Rear 2" Accessory Receiver
- Front and Rear Quick Drop™ Stabilizers
- Repositionable/Telescoping Roof Ladder + Bracket
- Winegard Air 360+ Omnidirectional Antenna (Wi-Fi/LTE Prep)
- 360 Siphon® Cap on Black Tank
- Black Tank Flush

Exterior

- European Dual-Pane Acrylic Windows with Integrated Shades
- Nitro-filled 16" Goodyear Wrangler Off-Road Tires - Load Range E (including spare)
- Custom Aluminum Rims (including spare)
- Gear Box: Tongue-Mounted, Formed Aluminum, LP and Lockable Storage
- XL Fresh Water Tank (55 gallons)
- Fully Adjustable Triple Solid Step™
- Electric Awning with Dimmable LED Light
- Front Electric Flat Jack
- Go Power!® 200W Rooftop Solar Panel
- Side and Rooftop Solar Ports
- Tire Pressure Monitoring System (TPMS)
- Pre-wired For Rear/Side Observation Camera
- Lockable Parking Brake
- High-Visibility LED Exterior Lighting
- Back-Up Light
- Keyed-Alike System
- Enclosed Radiant Barrier Underbelly
- 12V Tank Heaters
- Self-Adjusting Electric Brakes
- Dual 20# LP Tanks (40# total capacity)
- LP Quick Connect

Interior

- "Stargazer" European Dual Pane Acrylic Skylight
- 60" x 80" Residential-Sized Queen Bed
- EmberLink™ Smart RV Control System
- 12V LED HDTV w/ Built-In Bluetooth
- 1000W Pure Sine Wave Inverter
- 30 Amp Solar Controller
- Smoke/CO/LP Detectors
- Fire Extinguisher
- 12V Refrigerator
- Microwave
- Hardwood Framed Cabinet Doors and Drawer Fronts
- Dimmable Interior/Exterior LED Lighting
- 3-Speed 12V Powered Ceiling Vent
- Seamless Countertops
- Shaw Flooring
- Stainless Steel Kitchen Sink with Flush Mount Cover
- Dual-burner cooktop
- Showermiser™ Fresh Water Saver
- Porcelain Foot Flush Toilet

OPTIONS

- (MANDATORY) Truma Combi: High Efficiency LP Water Heater and Furnace Combo
- (MANDATORY) Truma Aventa A/C: Low-profile "Whisper Quiet" Energy Efficient 13,500 BTU Air Conditioner
- Outside Griddle (connects to LP Quick Connect, N/A 170MBH, 191MSL, 201FBQ)
- Wireless Side/Rear Observation Camera System with Monitor
- MAX SOLAR PACKAGE: 3000W Inverter (in place of 1000W), 270Ah 12V Battle Born® Gamechanger Lithium-ion (LiFePO4) Battery, Two Additional Roof-mounted 200W Solar Panels (600W total), Upgraded Bluetooth MPPT Controller
- Additional 270Ah 12V Battle Born® Gamechanger Lithium-ion (LiFePO4) Battery



FINALIST



NOTES



2023 OVERLAND SERIES TANDEM

221MDB

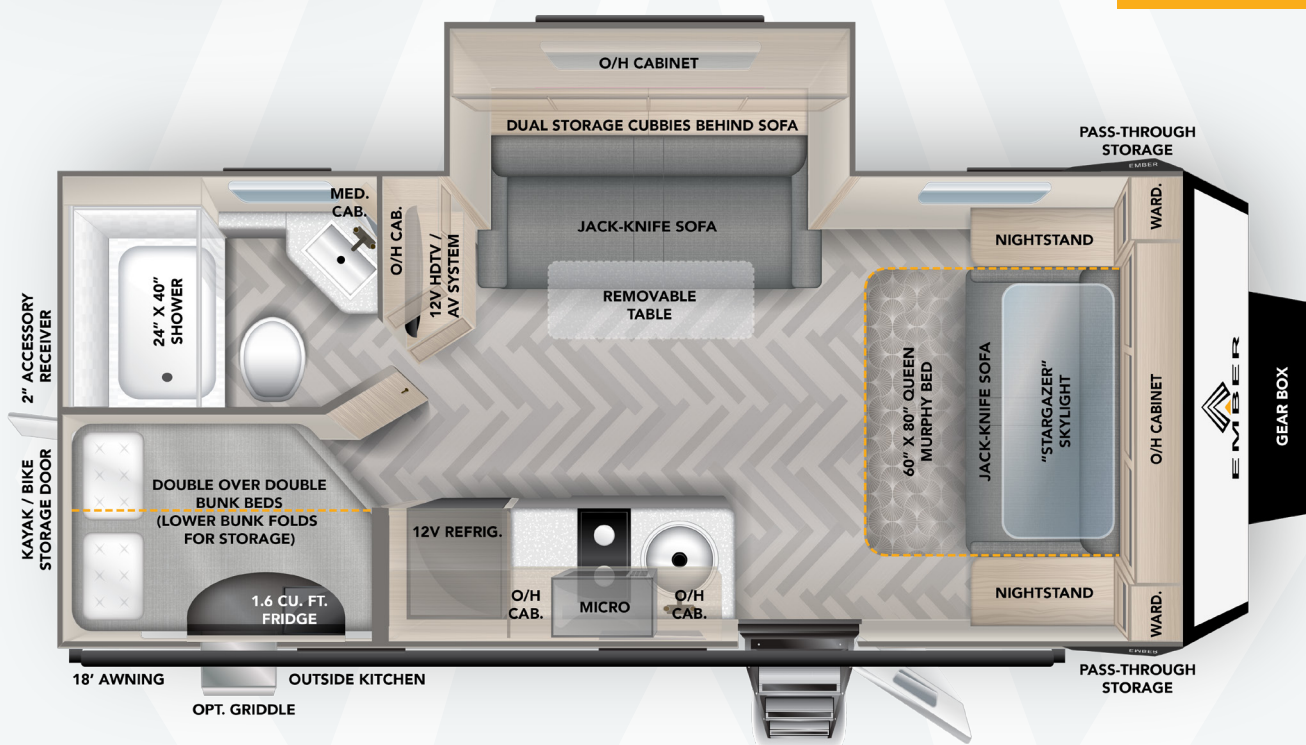

SPECIFICATIONS

	LENGTH	HEIGHT	DRY WEIGHT	HITCH WEIGHT
221MDB	26'1"	10'4"	5,690 LBS	620 LBS

KEY FEATURES

- Tandem CURT Independent Suspension
- Walk-around Residential Queen Size 60" x 80" Murphy Bed with Sofa below
- "Stargazer" Skylight
- Jack-Knife Sofa Slide with Removable Table and Dual Built-In Storage Cubbies
- Lower Bunk folds up creating Bike/ Kayak Storage Below accessible through Lockable Rear Door
- Large Double over Double size Bunks
- Outside kitchen with 1.6 cu. ft. Fridge and room for optional Griddle
- EmberLink "Smart RV" system controls Slide Room, Awning, and Lighting
- Standard Off-grid Solar Package with 200W Rooftop Panel, 1000W Inverter, and 30 Amp Controller
- Sleeps 5-8



2023 OVERLAND SERIES TANDEM



STANDARDS

Construction

- Tandem CURT Independent Suspension: Heavy-Duty Coil Springs with Dual Shock Absorbers (each wheel)
- Trailblazer™ Heavy-Duty Offroad Chassis
- VersaCoupler™ Height-Adjustable Bolt-On Hitching System
- 5-Sided Aluminum Frame Construction
- Laminated Azdel Onboard® Composite Walls (inner and outer substrates)
- Laminated Azdel Onboard® Composite Rooftop (inner and outer substrates)
- TRANSCORE™ Structural Composite Flooring
- Steel Fenders/Wheel Wells
- Aluminum Bed, Bunk, and/or Dinette Construction (where applicable)

Exterior

- European Dual-Pane Acrylic Windows with Integrated Shades
- Nitro-filled 16" Goodyear Wrangler Off-Road Tires - Load Range E (including spare)
- Custom Aluminum Rims (including spare)
- Gear Box: Tongue-Mounted, Formed Aluminum, LP and Lockable Storage
- XL Fresh Water Tank (55 gallons)
- Fully Adjustable Triple Solid Step™
- Electric Awning with Dimmable LED Light
- Front Electric Flat Jack
- Go Power!® 200W Rooftop Solar Panel
- Side and Rooftop Solar Ports
- Tire Pressure Monitoring System (TPMS)
- Pre-wired For Rear/Side Observation Camera
- Lockable Parking Brake
- High-Visibility LED Exterior Lighting
- Back-Up Light
- Keyed-Alike System
- Enclosed Radiant Barrier Underbelly
- 12V Tank Heaters
- Self-Adjusting Electric Brakes
- Dual 20# LP Tanks (40# total capacity)
- LP Quick Connect

- 30 Amp Service
- Detachable Shore Power Cord with Faultsmart™ indicators and Pullsmart™ handle
- Outside Shower
- Standard Frame Integrated Rear 2" Accessory Receiver
- Front and Rear Quick Drop™ Stabilizers
- Repositionable/Telescoping Roof Ladder + Bracket
- Winegard Air 360+ Omnidirectional Antenna (Wi-Fi/LTE Prep)
- 360 Siphon® Cap on Black Tank
- Black Tank Flush

Interior

- "Stargazer" European Dual Pane Acrylic Skylight
- 60" x 80" Residential-Sized Queen Bed
- EmberLink™ Smart RV Control System
- 12V LED HDTV w/ Built-In Bluetooth
- 1000W Pure Sine Wave Inverter
- 30 Amp Solar Controller
- Smoke/CO/LP Detectors
- Fire Extinguisher
- 12V Refrigerator
- Microwave
- Hardwood Framed Cabinet Doors and Drawer Fronts
- Dimmable Interior/Exterior LED Lighting
- 3-Speed 12V Powered Ceiling Vent
- Seamless Countertops
- Shaw Flooring
- Stainless Steel Kitchen Sink with Flush Mount Cover
- Dual-burner cooktop
- Showermiser™ Fresh Water Saver
- Porcelain Foot Flush Toilet

OPTIONS

- (MANDATORY) Truma Combi: High Efficiency LP Water Heater and Furnace Combo
- (MANDATORY) Truma Aventa A/C: Low-profile "Whisper Quiet" Energy Efficient 13,500 BTU Air Conditioner
- Outside Griddle (connects to LP Quick Connect, N/A 170MBH, 191MSL, 201FBQ)
- Wireless Side/Rear Observation Camera System with Monitor
- MAX SOLAR PACKAGE: 3000W Inverter (in place of 1000W), 270Ah 12V Battle Born® Gamechanger Lithium-ion (LiFePO4) Battery, Two Additional Roof-mounted 200W Solar Panels (600W total), Upgraded Bluetooth MPPT Controller
- Additional 270Ah 12V Battle Born® Gamechanger Lithium-ion (LiFePO4) Battery



FINALIST



NOTES

221MSL

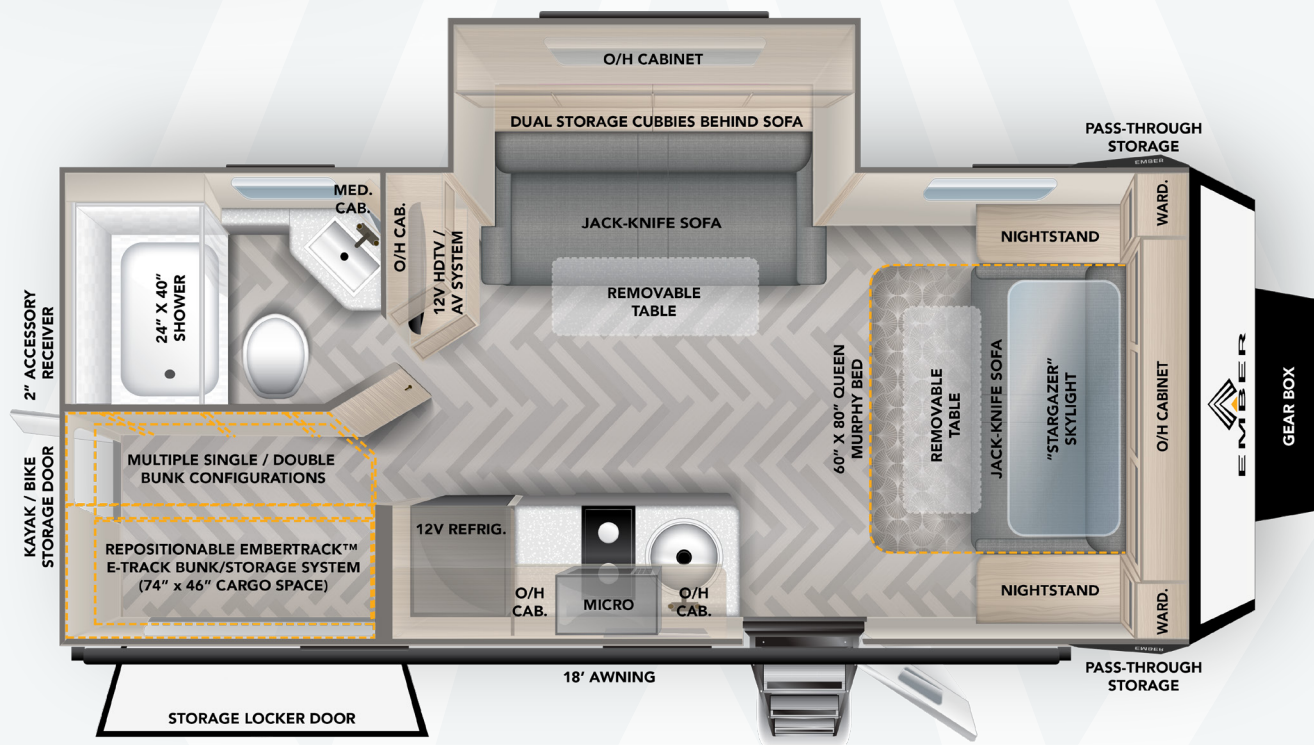

SPECIFICATIONS

	LENGTH	HEIGHT	DRY WEIGHT	HITCH WEIGHT
221MSL	26'1"	10'4"	5,680 LBS	655 LBS

KEY FEATURES

- Tandem CURT Independent Suspension
- Walk-around Residential Queen Size 60" x 80" Murphy Bed with Sofa below
- "Stargazer" Skylight
- Jack-Knife Sofa Slide with Removable Table and Dual Built-In Storage Cubbies
- 74" x 46" Rear "Do-It-Yourself" Cargo Area with Repositionable EmberTrack™ E-Track Bunk/Storage System
- Large Exterior Storage Locker Door and Rear Kayak/Bike Door
- EmberLink "Smart RV" system controls Slide Room, Awning, and Lighting
- Standard Off-grid Solar Package with 200W Rooftop Panel, 1000W Inverter, and 30 Amp Controller
- Sleeps 5-8



2023 OVERLAND SERIES TANDEM



STANDARDS

Construction

- Tandem CURT Independent Suspension: Heavy-Duty Coil Springs with Dual Shock Absorbers (each wheel)
- Trailblazer™ Heavy-Duty Offroad Chassis
- VersaCoupler™ Height-Adjustable Bolt-On Hitching System
- 5-Sided Aluminum Frame Construction
- Laminated Azdel Onboard® Composite Walls (inner and outer substrates)
- Laminated Azdel Onboard® Composite Rooftop (inner and outer substrates)
- TRANSCORE™ Structural Composite Flooring
- Steel Fenders/Wheel Wells
- Aluminum Bed, Bunk, and/or Dinette Construction (where applicable)
- 30 Amp Service
- Detachable Shore Power Cord with Faultsmart™ indicators and Pullsmart™ handle
- Outside Shower
- Standard Frame Integrated Rear 2" Accessory Receiver
- Front and Rear Quick Drop™ Stabilizers
- Repositionable/Telescoping Roof Ladder + Bracket
- Winegard Air 360+ Omnidirectional Antenna (Wi-Fi/LTE Prep)
- 360 Siphon® Cap on Black Tank
- Black Tank Flush

Exterior

- European Dual-Pane Acrylic Windows with Integrated Shades
- Nitro-filled 16" Goodyear Wrangler Off-Road Tires - Load Range E (including spare)
- Custom Aluminum Rims (including spare)
- Gear Box: Tongue-Mounted, Formed Aluminum, LP and Lockable Storage
- XL Fresh Water Tank (55 gallons)
- Fully Adjustable Triple Solid Step™
- Electric Awning with Dimmable LED Light
- Front Electric Flat Jack
- Go Power!® 200W Rooftop Solar Panel
- Side and Rooftop Solar Ports
- Tire Pressure Monitoring System (TPMS)
- Pre-wired For Rear/Side Observation Camera
- Lockable Parking Brake
- High-Visibility LED Exterior Lighting
- Back-Up Light
- Keyed-Alike System
- Enclosed Radiant Barrier Underbelly
- 12V Tank Heaters
- Self-Adjusting Electric Brakes
- Dual 20# LP Tanks (40# total capacity)
- LP Quick Connect

Interior

- "Stargazer" European Dual Pane Acrylic Skylight
- 60" x 80" Residential-Sized Queen Bed
- EmberLink™ Smart RV Control System
- 12V LED HDTV w/ Built-In Bluetooth
- 1000W Pure Sine Wave Inverter
- 30 Amp Solar Controller
- Smoke/CO/LP Detectors
- Fire Extinguisher
- 12V Refrigerator
- Microwave
- Hardwood Framed Cabinet Doors and Drawer Fronts
- Dimmable Interior/Exterior LED Lighting
- 3-Speed 12V Powered Ceiling Vent
- Seamless Countertops
- Shaw Flooring
- Stainless Steel Kitchen Sink with Flush Mount Cover
- Dual-burner cooktop
- Showermiser™ Fresh Water Saver
- Porcelain Foot Flush Toilet

OPTIONS

- (MANDATORY) Truma Combi: High Efficiency LP Water Heater and Furnace Combo
- (MANDATORY) Truma Aventa A/C: Low-profile "Whisper Quiet" Energy Efficient 13,500 BTU Air Conditioner
- Outside Griddle (connects to LP Quick Connect, N/A 170MBH, 191MSL, 201FBQ)
- Wireless Side/Rear Observation Camera System with Monitor
- MAX SOLAR PACKAGE: 3000W Inverter (in place of 1000W), 270Ah 12V Battle Born® Gamechanger Lithium-ion (LiFePO4) Battery, Two Additional Roof-mounted 200W Solar Panels (600W total), Upgraded Bluetooth MPPT Controller
- Additional 270Ah 12V Battle Born® Gamechanger Lithium-ion (LiFePO4) Battery



FINALIST



NOTES