



Newport Ash 826MBR



Newport Ash 826MBR



Newport Ash 826MBR



Acadia & Newport Ash 826MBR

Classic

BEAUTIFUL SPACIOUS INTERIORS COME STANDARD.

The Classic series has many outstanding features to enhance your camping experience. The open floorplans and generous storage space allows extra room for those extra things you want to bring along. Sleeping on the comfortable bed, you'll forget you were in the great outdoors. The spacious interior and picturesque view through the many windows enable you to experience your surroundings in the comfort of your Classic travel trailer.



Classic Construction



SUPERIOR CONSTRUCTION

- 1 Complete **Azdel** Wall Construction
- 2 Fully Laminated Walkable Roof
- 3 6-Sided Full-Aluminum Frame
- 4 Aluminum Truss Roof Bracing
- 5 5/8" Tongue & Groove Plywood Floor
- 6 Aluminum Floor Joists
- 7 Frameless Windows
- 8 Painted Fiberglass Front Cap with Clear Coat
- 9 Automotive Glass Windshield¹

¹ N/A 832RKSB

Optional Features

- 25 Auto-Leveling (Not Pictured)



STANDARD FEATURES

- 10 200W Solar Panel with 1000W Inverter & 30 AMP Charge Controller¹
- 11 Back-Up Camera Prep
- 12 Maxxair Fan with Cover
- 13 Teton All-In-One WiFi Prep/Antenna
- 14 Key-Alike Lock System
- 15 Additional Solar Prep
- 16 PSX2 Power Stabilizers
- 17 Double Battery Boxes
- 18 Double 30 Lb. LP Tanks

¹ 832RKSB comes standard with an 1800W inverter



SAFETY STANDARDS

- 19 TST Tire Pressure Monitor System
- 20 Goodyear Endurance Tires
- 21 Dexter Torsion Axles
- 22 MORryde Strut Assist Steps



CLIMATE PROTECTION PACKAGE

- 23 12V Thermostat-Controlled Heated Tanks
- 24 Radiant Foil In Underbelly, Front Cap & Slides

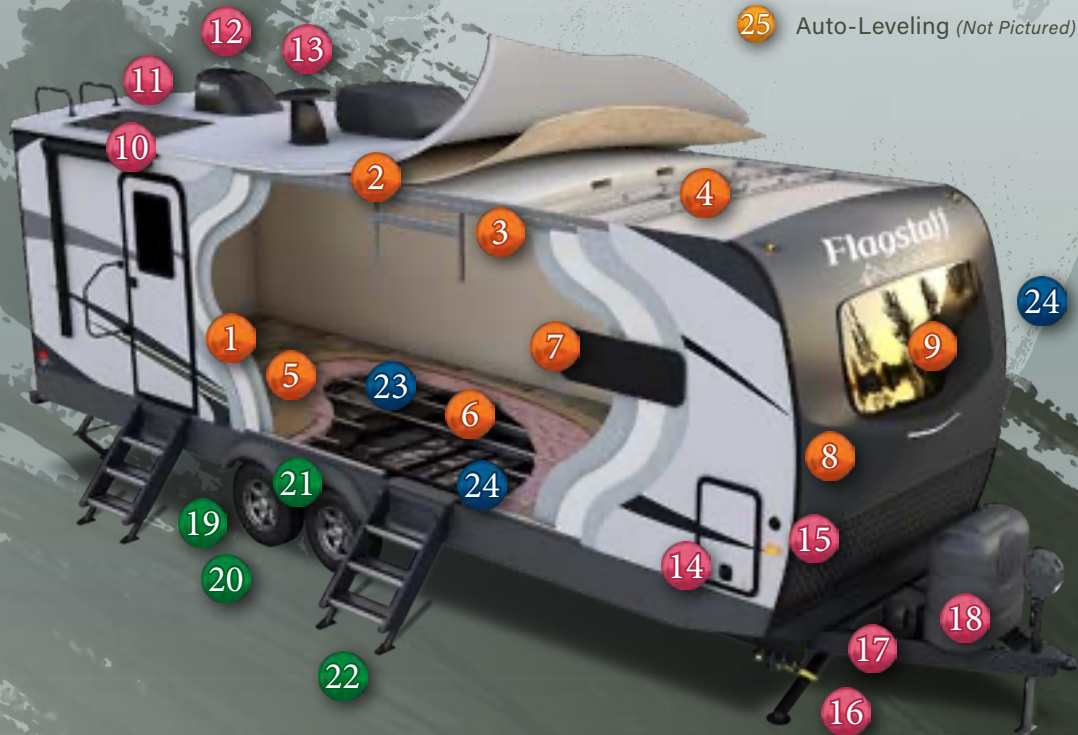

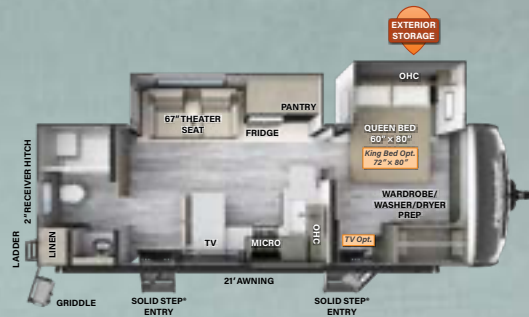

826RBS

SUITE SERIES

LENGTH: 29' 11" WIDTH: 8' HEIGHT: 11' 7" HITCH: 1070 AXLE: 6580

UVW: 7709 CCC: 2161 **F** 54 GAL **G** 70 GAL **B** 40 GAL

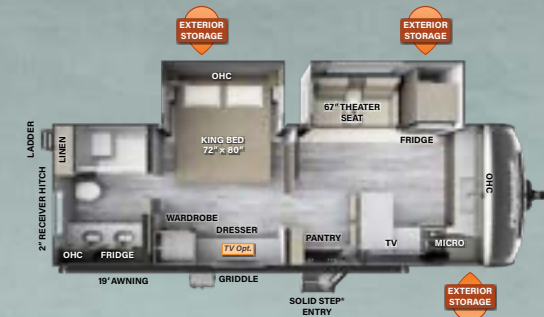

826MBR

SUITE SERIES

LENGTH: 29' 11" WIDTH: 8' HEIGHT: 11' 7" HITCH: 1065 AXLE: 6685

UVW: 7809 CCC: 2056 **F** 54 GAL **G** 80 GAL **B** 40 GAL



826BHS

SUITE SERIES

LENGTH: 29' 11" WIDTH: 8' HEIGHT: 11' 7" HITCH: TBD AXLE: TBD

UVW: TBD CCC: TBD **F** 54 GAL **G** 90 GAL **B** 50 GAL

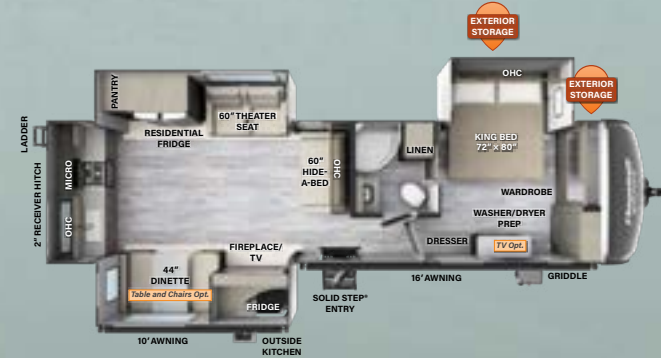

832RKSB

REAR KITCHEN

LENGTH: 36' 8" WIDTH: 8' HEIGHT: 11' 7" HITCH: 1130 AXLE: 8255

UVW: 9444 CCC: 1686 **F** 54 GAL **G** 110 GAL **B** 50 GAL

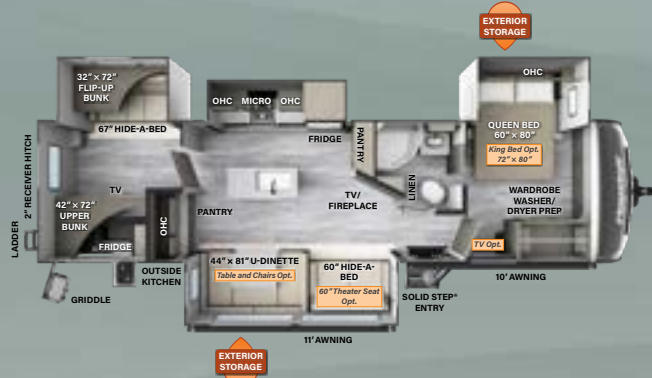

832BWS

BUNK HOUSE

LENGTH: 36' 8" WIDTH: 8' HEIGHT: 11' 7" HITCH: 1320 AXLE: 8290

UVW: 9669 CCC: 1651 **F** 54 GAL **G** 130 GAL **B** 50 GAL



832IKRL

REAR LIVING

LENGTH: 36' 8" WIDTH: 8' HEIGHT: 11' 7" HITCH: 1315 AXLE: 7835

UVW: 9209 CCC: 2106 **F** 54 GAL **G** 120 GAL **B** 50 GAL