

WILDWOOD

HERITAGE GLEN



WILDWOOD
HERITAGE GLEN

HYPER-LYTE TRAVEL TRAILERS

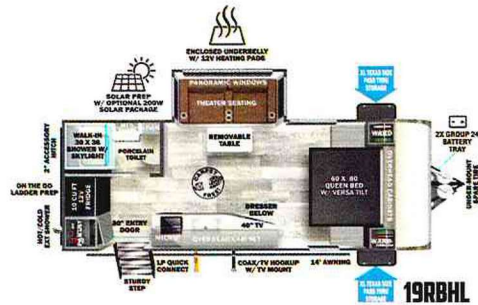

19RBHL
UVW = 5,403 lb
Length = 24'

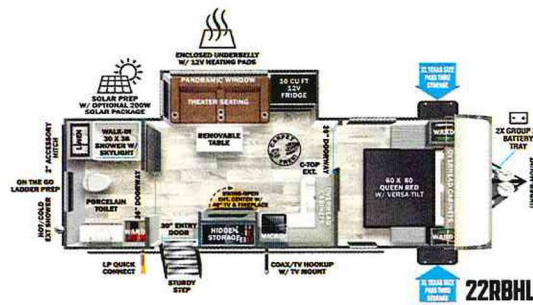

22RBHL
UVW = 6,198 lb
Length = 27' 6"



22RKHL
UVW = 6,128 lb
Length = 26' 10"

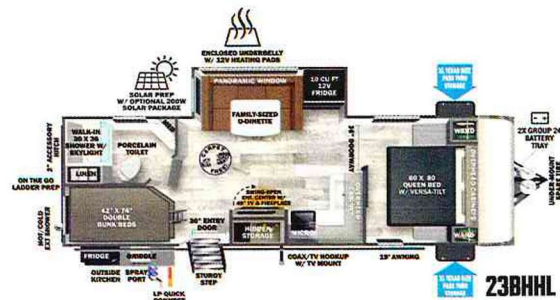

UVW = 6,478 lb
Length = 29' 11"

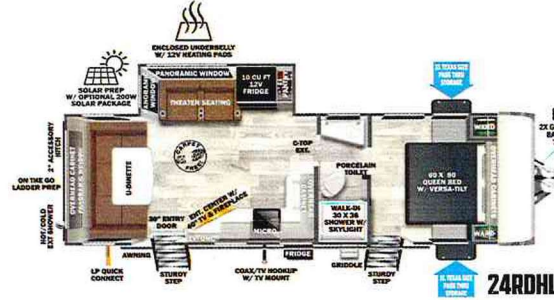

UVW = 6,228 lb
Length = 29' 11"



UVW = 7,028 lb
Length = 33' 11"



UVW = 6,678 lb
Length = 30' 10"

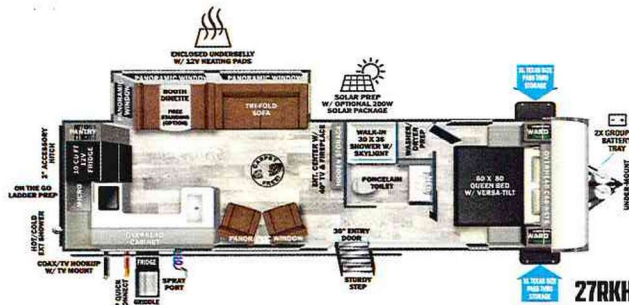

UVW = 6,758 lb
Length = 34' 0"

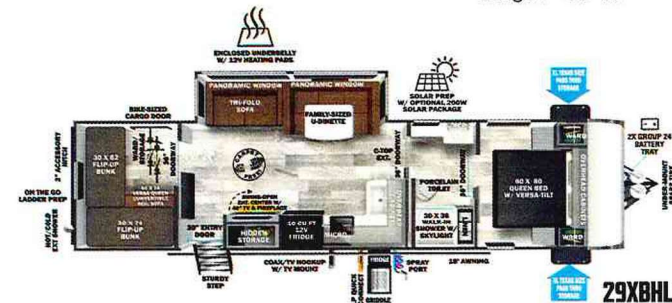

UVW = 7,173 lb
Length = 36' 10"



**SCAN FOR SPECS
& MORE INFO**



TRAVEL TRAILERS



UVW = 7,553 lb
Length = 31' 5"

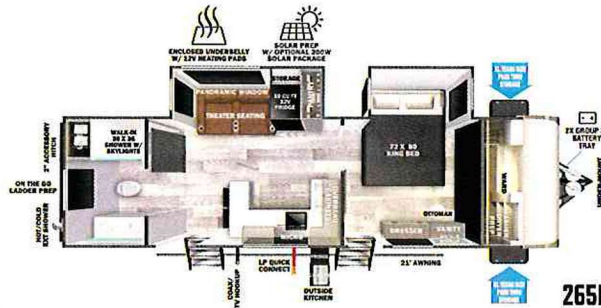

265BSRB
UVW = 7,858 lb
Length = 33' 2"

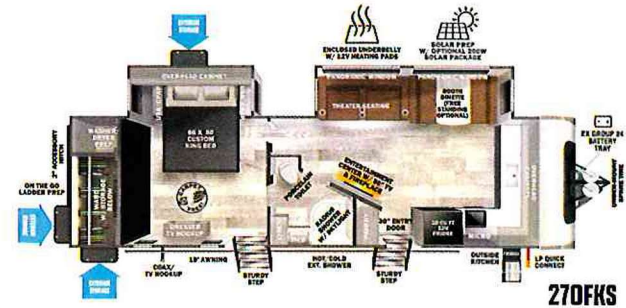

270FKS
UVW = 8,243 lb
Length = 33' 1"

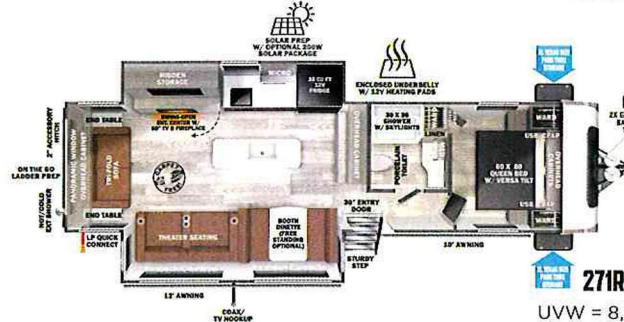

271RL
UVW = 8,268 lb
Length = 33' 10"

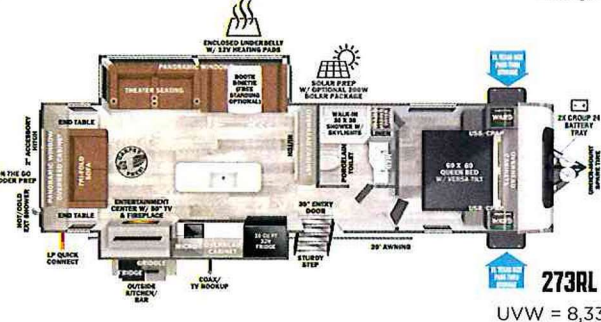

273RL
UVW = 8,338 lb
Length = 33' 10"

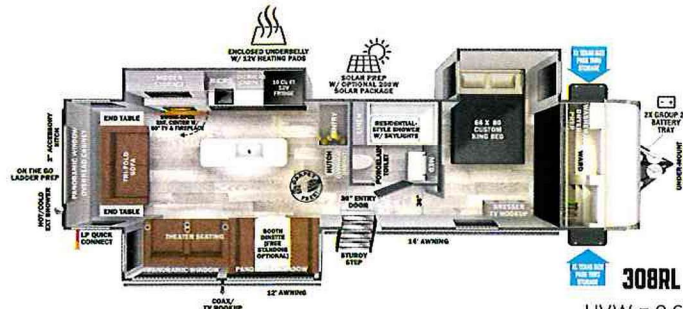

308RL
UVW = 9,688 lb
Length = 37' 11"

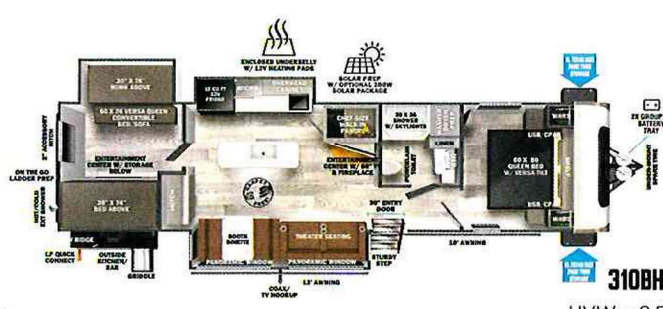

310BHI
UVW = 9,538 lb
Length = 37' 8"

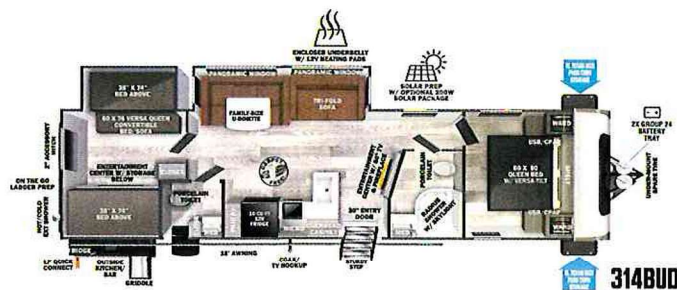

UVW = 8,873 lb
Length = 38' 9"

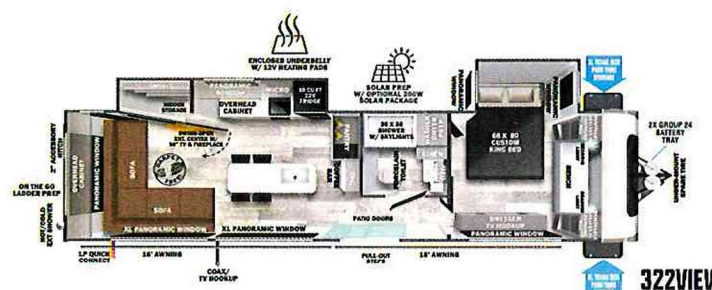

UVW = 9,309 lb
Length = 37' 10"

**SCAN FOR SPECS
& MORE INFO**



FIFTH WHEELS

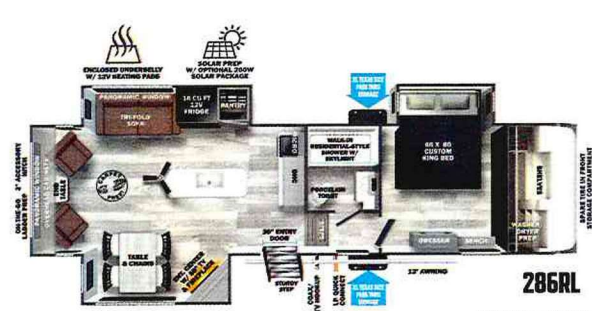

286RL
UVW = 9,380 lb
Length = 33' 11"

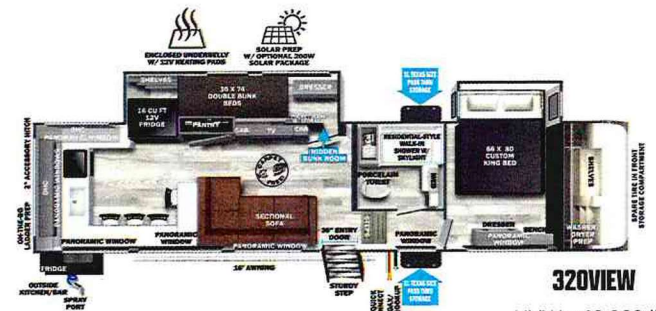

320VIEW
UVW = 10,269 lb
Length = 37' 11"

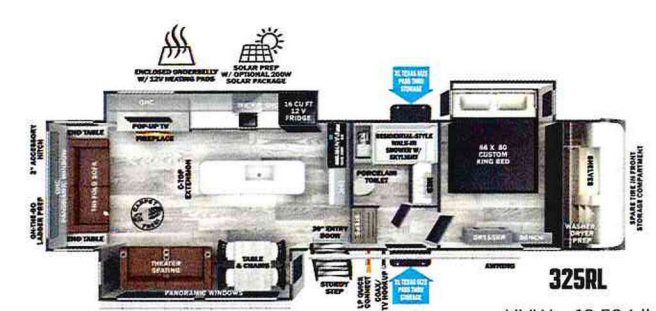

325RL
UVW = 10,594 lb
Length = 37' 8"



328BH
UVW = 10,064 lb
Length = 37' 10"

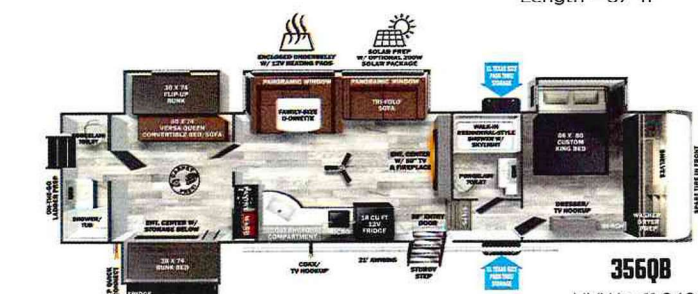

356QB
UVW = 11,249 lb
Length = 43' 0"

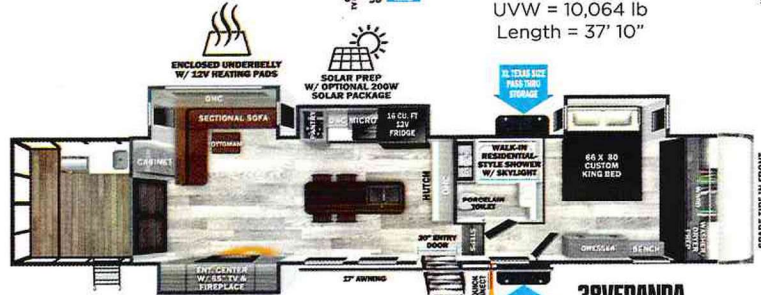

38VERANDA
UVW = 13,309 lb
Length = 43' 3"



369BL
UVW = 11,669 lb
Length = 43' 0"

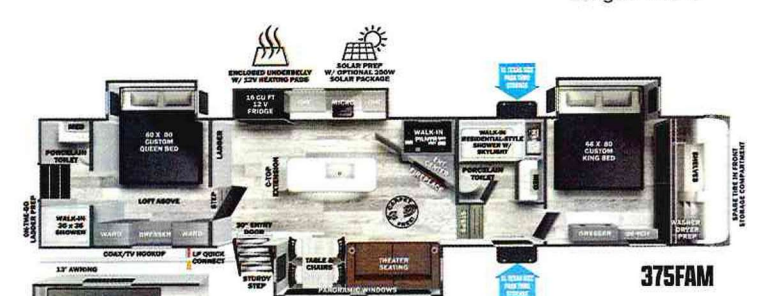

375FAM
UVW = 12,904 lb
Length = 42' 9"



378FL
UVW = 11,589 lb
Length = 43' 6"



SCAN FOR SPECS
& MORE INFO



ELITE FIFTH WHEELS

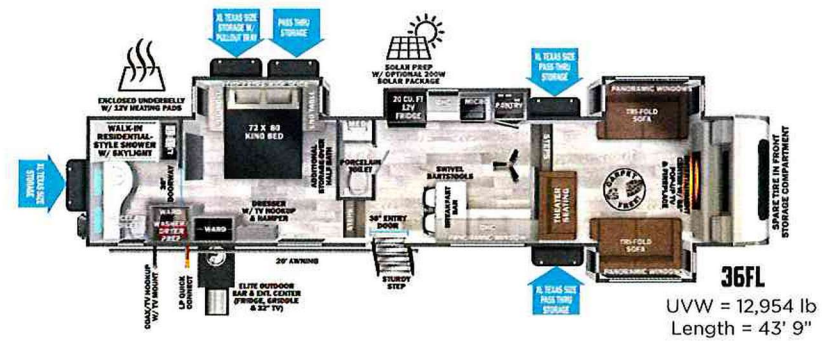
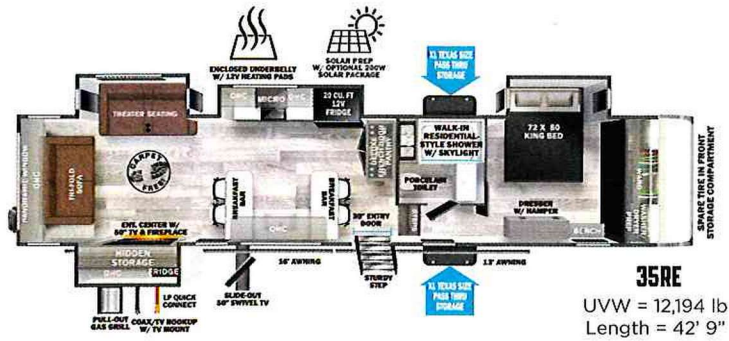

SCAN FOR SPECS
& MORE INFO



INTRODUCING . . . THE ROOST43! TWO INNOVATIVE LEVELS, ONE DISTINCTIVE FIFTH WHEEL.

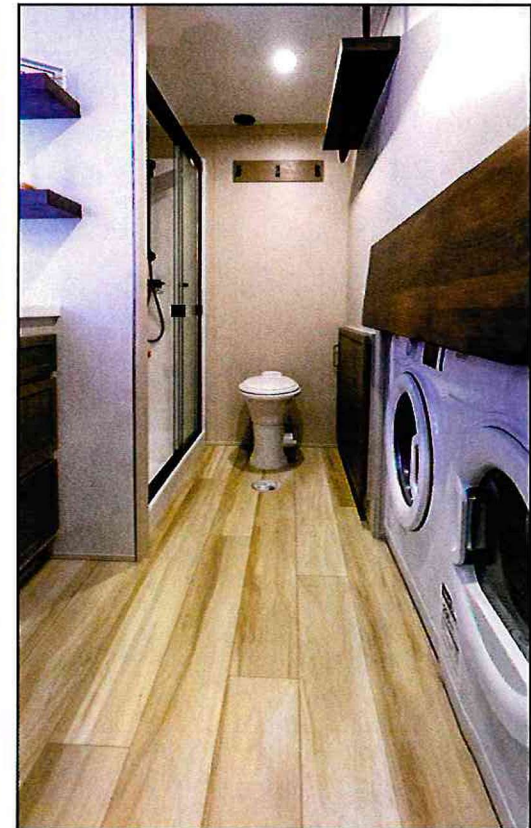
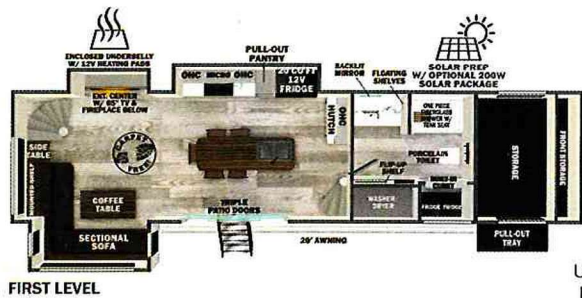
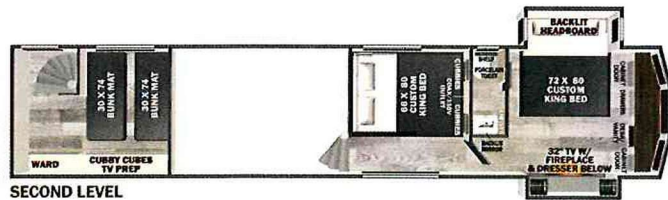

HERITAGE GLEN LAMINATED TRAVEL TRAILER CONSTRUCTION

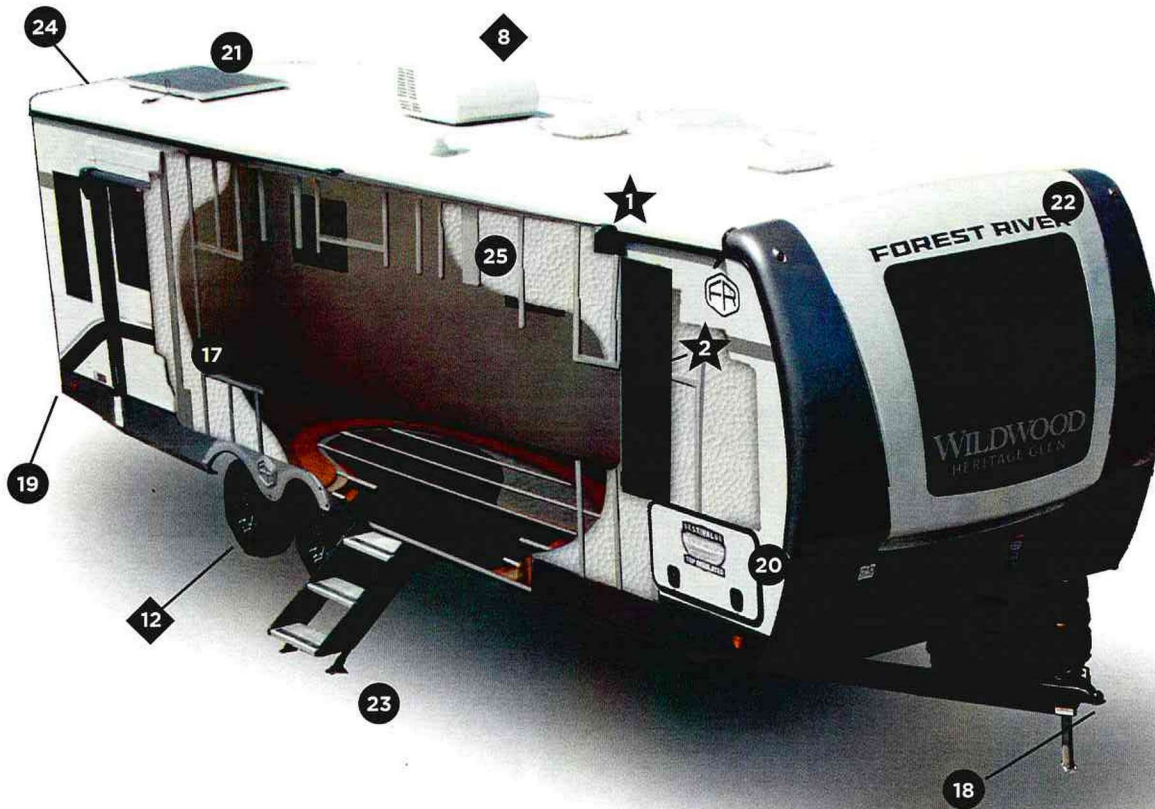

STAND OUT INTERIOR FEATURES

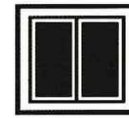

SQUARE TINTED WINDOWS



VERSA-TILT POWER BED



JBL SOUND SYSTEM



UPGRADED INTERIOR LIGHTING

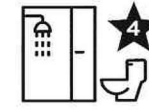

RESIDENTIAL STYLE BATHROOM



HERITAGE GLEN IS A CARPET-FREE RV

STAND OUT EXTERIOR FEATURES

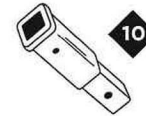

2" ACCESSORY HITCH RECEIVER

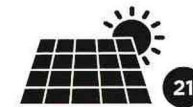

PREPPED FOR SOLAR



AUTO GRADE PAINTED FRONT CAP

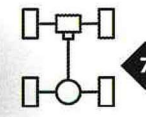

WIDE STANCE AXLES

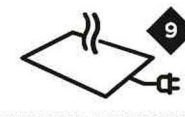

ENCLOSED UNDERBELLY WITH HEATED TANK PADS



WEATHERSHIELD FIBERGLASS ROOF

★ ELEVATED VALUE PACKAGE (INCLUDED)

1. WeatherShield one piece fiberglass roof
2. Square windows have built-in shades with reflective thermal foil backing & painted hardwood interior trim
3. Versa-Tilt power bed mechanism with appx 14.5" of additional walk-around space (N/A bed-slide models)
4. 60K BTU on-demand tankless water heater
5. JBL Sound System (head unit, interior speakers, & exterior speakers)
6. Ultimate Interior Lighting Upgrade: LED strip lighting (Main Living) & 4K LED recessed can lighting

◆ EXPEDITION PACKAGE (INCLUDED)

7. Wide stance axles (appx 42" hub to hub)
8. 15K BTU Quiet Cool A/C on race track duct system
9. Enclosed Accessibly underbelly with 12V heated tank pads
10. 2" Accessory hitch receiver
11. 4 storage bins included under bed*
12. MAXXIS radial tires with black-accented aluminum rims
13. 60" x 80" beds in all main bedrooms (72" x 80" bed in select models)*
14. Outside kitchen w/ griddle, fridge & spray port (N/A 19RBHL, 271RL, 308RL & 322VIEW)*
15. 50" LED Smart TV (40" TV in Hyper Lytes)*
16. Power stabilizer jacks (opt. on Hyper Lytes)*

● STANDARD FEATURES

17. Vacuum bonded "Aluma Frame" sidewalls
18. Power tongue jack with LED docking light
19. Outside shower with hot & cold water
20. Extra large pass through storage with slam latch baggage doors & magnetic catches
21. Solar panel & charge controller prepped (optional solar upgrade shown in image)
22. Automotive grade painted front cap with automotive grade gel coat
23. Step Above aluminum steps at main entry
24. Back-up/observation camera prep at back of unit
25. Block foam insulation
26. 10 CU FT (12V) refrigerator*

HERITAGE GLEN LAMINATED FIFTH WHEEL CONSTRUCTION

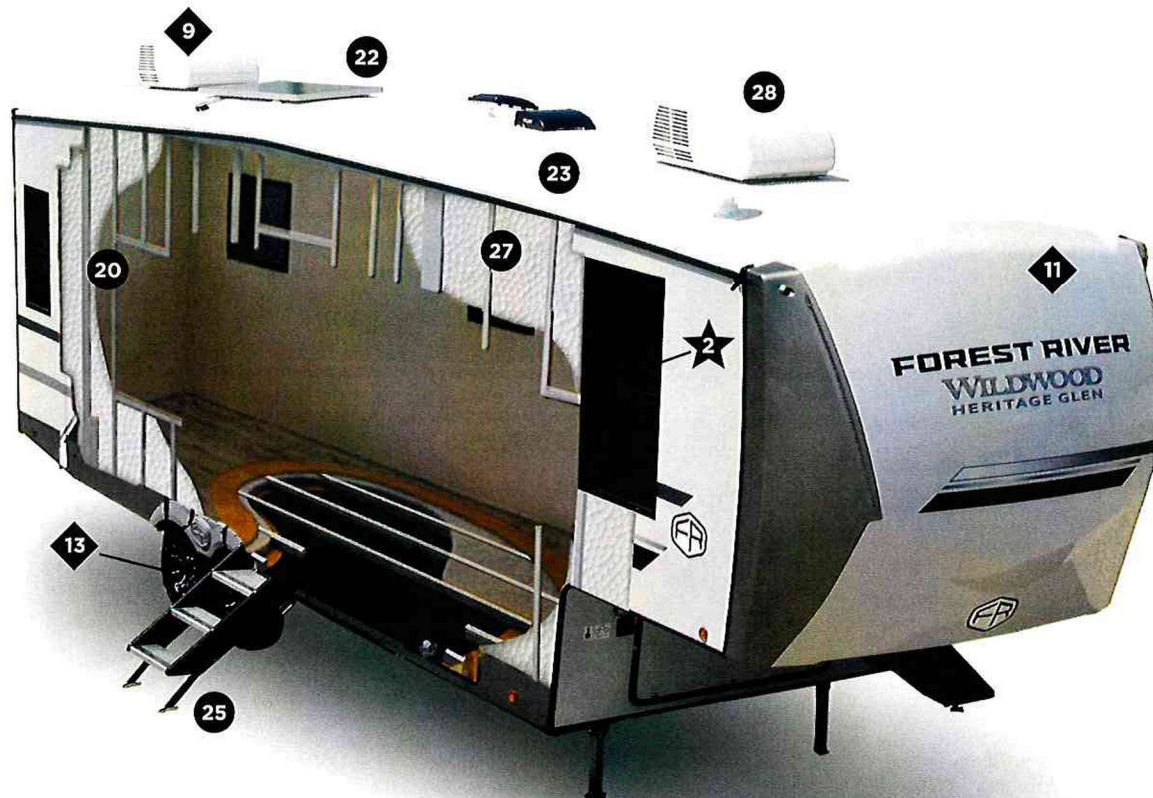

STAND OUT INTERIOR FEATURES

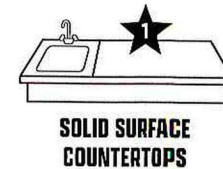

STAND OUT EXTERIOR FEATURES

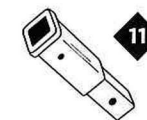

2" ACCESSORY HITCH RECEIVER

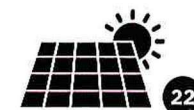

PREPPED FOR SOLAR

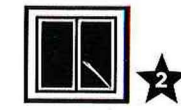

SQUARE TINTED WINDOWS



TUFFLEX PVC ROOF

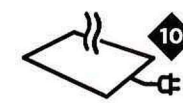

ENCLOSED UNDERBELLY WITH HEATED TANK PADS

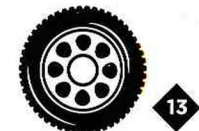

MAXXIS PREMIER RADIAL TIRES

★ ELEVATED VALUE PACKAGE (INCLUDED)

1. High end Solid Surface countertops
2. Square windows have built-in shades with reflective thermal foil backing & painted hardwood interior trim
3. JBL Sound System (head unit, interior speakers, & exterior speakers)
4. 60K BTU on-demand tankless water heaters
5. RV Airflow Mechanism: test results show at least 25% better airflow
6. Ultimate Interior Lighting Upgrade: LED strip lighting (Main Living) & 4K LED recessed can lighting
7. 1.7 cu/ft over-range 30" microwave
8. Residential-styled 4-burner gas range

◆ EXPEDITION PACKAGE (INCLUDED)

9. 15K BTU Quiet Cool A/C on race track duct system
10. Enclosed Accessibly underbelly with 12V heated tank pads
11. 2" Accessory hitch receiver (N/A 356QB, 375FAM 378FL, 38VERANDA, ROOST43 & 36FL)*
12. 4 storage bins included under bed*
13. MAXXIS radial tires with black-accented aluminum rims
14. 50" LED Smart TV (55" in 36FL, 65" in 38VERANDA & ROOST43)*
15. 30" Wide Main Entrance Door*
16. Mini-Max electric fan in bathrooms*
17. Outdoor Kitchen (328BH, 353BED, 356QB, 369BL, 38VERANDA & 36FL)*
18. 72" x 80" King Bed in Main Bedroom (Elites & ROOST43 only)*
19. In-Line Water Filtration System (Elites & ROOST43)*

● STANDARD FEATURES

20. Vacuum bonded "Aluma Frame" sidewalls
21. Docking station with hot and cold water*
22. Prepped for solar panel & charge controller (optional solar upgrade shown in image)
23. Dacor's Tufflex PVC roofing membrane
24. 12V Refrigerator (16 CU FT non-Elite series; 20 CU FT Elite series and ROOST43)*
25. Step Above aluminum steps (main entry doors)
26. 50 AMP service with washer/dryer prep*
27. Block foam insulation
28. Prepped for 2nd ducted A/C (15K BTU - optional 2nd A/C upgrade shown in construction diagram)
29. Full length barreled ceilings for additional head height & ~6' 5" of upper deck head room*

PACKAGES AND OPTIONS

ROOST FIFTH WHEEL

ELEVATED VALUE PACKAGE (INCLUDED)

- High-End Solid Surface & Maple-Stained Wood Countertops
- Square Windows with Built in Shades with Reflective Thermal-Foil Backing and Painted Hardwood Interior Trim
- JBL Sound System (Head Unit, Interior Speakers, Exterior Speakers & Subwoofer)
- 60K BTU On-Demand Tankless Water Heater
- (2) 15K BTU Quiet Cool Ducted Air Conditioner Units (Free 3rd A/C for Limited Time). RV Airflow System installed on all A/C's
- Side-by-Side Built-In Washer & Dryer (Free for Limited Time)
- Premium Alley Grey High-Gloss Gel Coat Fiberglass Sidewalls

EXPEDITION PACKAGE (INCLUDED)

- 20 Cubic Foot Refrigerator (12V)
- Race Track Air Conditioner Duct System (for max cooling efficiency)
- 65" LED Smart TV
- Accesibly Underbelly w/ 12V Tank Heaters on all Holding Tanks
- Triple-Paned Slider Entrance Door
- Dual Outdoor Refrigerators For Maximum Exterior Cold Storage

ADDITIONAL PHOTOS



EACH NEW FOREST RIVER PURCHASE PROVIDES:

- ✓ Pre-delivery Inspection.
- ✓ Digital Owner's Manual.
- ✓ Free Membership to Forest River Owners Group (FROG). Learn more at www.forestriverfrog.com.
- ✓ A Contribution to Care Camps Foundation www.carecamps.org.
- ✓ 1 Year Free Roadside Assistance from Date of Purchase.



SPEC DEFINITIONS:

Scan on your smartphone to learn RV terminology and more!



LEARN MORE:

Scan this QR code with your mobile device to learn more about Forest River.



Olathe Ford RV Center
19310 S Gardner Road
Gardner, KS 66030
(913) 856-8145
www.OlatheFordRV.com

YOUR HERITAGE GLEN DEALER

All information contained in this brochure is believed to be accurate at the time of publication. However, during any model year, it may be necessary to make changes to the manufacturing process of the units and information in this brochure. Your unit may differ from the information in this brochure due to any changes in the manufacturing process and equipment. Forest River, Inc., reserves the right to make all such changes without notice, including prices, colors, combinations, materials, equipment and specifications of any models as well as the addition of new models and the discontinuance of models shown in this brochure. Therefore, please consult with your Forest River dealer and confirm the availability of any materials, combinations, designs, or specifications that are meaningful to your purchase decision.
© 2024 Heritage Glen, a Division of Forest River, Inc., a Berkshire Hathaway Company. All Rights Reserved. Forest River, Inc. 12/24