

# MODEL Z AIR 310

AVAILABLE FALL 2024  
Standard Run MSRP \$98,863

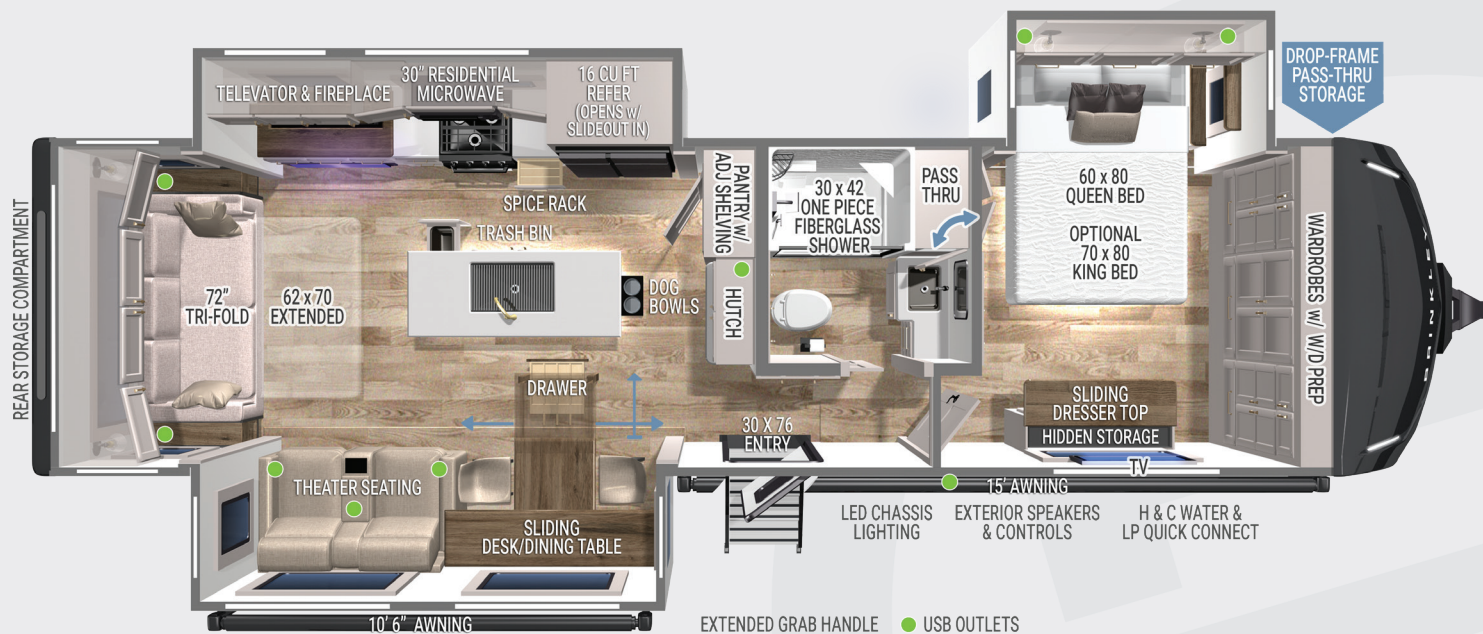

## SPECIFICATIONS:

- UVW – 10,961 lbs.
- GVWR – 14,495 lbs.
- Hitch Weight – 1,086 lbs.
- Exterior Length – 37' 10"
- Overall Height w/ AC – 11' 9"
- Width – 96"
- Interior Height - 84"
- Slide Height - 72.5"
- Wheels & Tires – 16" G-Rated
- Fresh Water Capacity – 62 gal
- Gray Water Capacity – 75+30 gal
- Black Water Capacity – 45 gal
- Insulation – Floors R40, Walls R9, Ceiling R40

## FEATURES:

- Sliding Desk/Dining Table w/ Extending Leaves & Storage Drawer (Seats up to 4)
- 72" Trifold Sofa w/ 62"x70" Sleeper
- Solid Surface Countertops
- Brinkley CraftSense™ Wood Trim Construction
- Premium Residential Cabinets & Drawers w/ Dovetail Joints
- Kitchen & Living Room/Dining Room Flush Floor Slides
- 18k Variable Speed Chill Cube Main AC & Bedroom AC
- Pull-Out Trash Bin w/ Utility Storage
- Large Pantry w/ Adjustable Shelves & Appliance Outlet
- Removable Pet Bowls w/ Storage Compartment
- Washer/Dryer Prep (combo or side by side)
- One-Piece Fiberglass Shower
- Square Euro Frameless Windows w/ 6" Openings
- Integrated Window Screens & Insulated Blackout Blinds (No Valances)
- Brinkley Automotive-Grade Sealant Package
- Automotive Grade Front Cap, Lights, & Lens
- Sleek Styling w/ Automotive-Grade Exterior Graphics
- 2 - Hot/Cold Outdoor Showers (BOTH sides of coach)
- Tankless On-Demand Water Heater
- Heated Enclosed Underbelly (Circulated)
- Custom LP Box w/ Battery Storage
- One Touch Automatic Leveling System
- Drop Frame Chassis w/ Motion Lighting & Power Outlets
- Premium Utility Center w/ Retractable 65' Water Hose
- Industry First Brass Plumbing Connections
- Industry First Low Maintenance Roof
- Heated Tanks w/ Electric Waste Valves (Manual-Override)
- Heavy-Duty 7,000 lbs. Axles w/ G-Rated Hankook Tires & 16" Aluminum Custom Wheels
- 370W Solar Panel w/ 60AMP MPPT Controller (Inverter Prep & Lithium Ready)

## FACTORY OPTIONS:

- Dual Pane Windows \$1,731
- King Bed \$0

073024

### PRE-PRODUCTION PREVIEW

Based on pre-production prototype. All preliminary info & content is subject to change without notice. Please consult with your dealer for current model details & information.



For More Information, Photos, Videos & Why Brinkley go to [BrinkleyRV.com](https://www.BrinkleyRV.com)

