

WILDWOOD

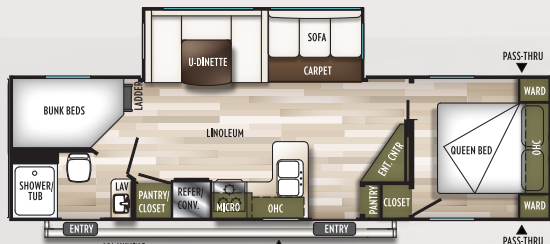

WE DON'T WAIT FOR THE FUTURE. **WE BUILD IT.**





26DBUD

UVW = 6885

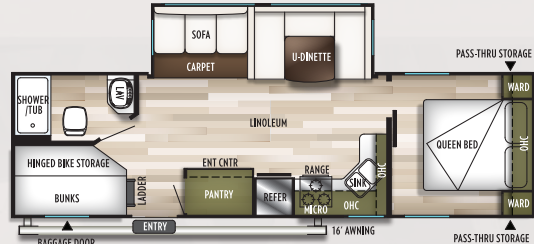

27DBK

UVW = 6380



27RE

UVW = 7545

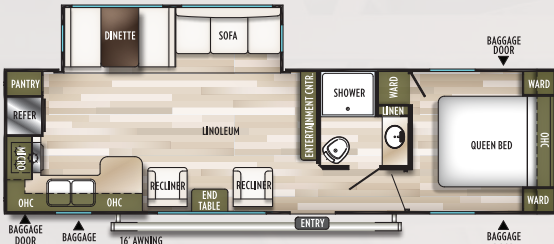

27RKS

UVW = 6750

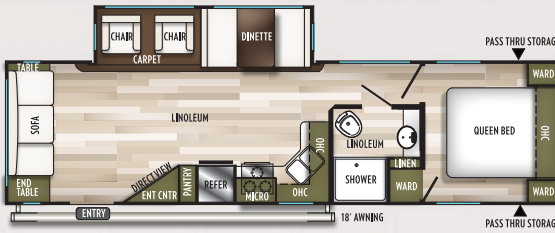

28RLSS

UVW = 6351



30KQBSS

UVW = 6780



31KQBTS

UVW = 8535



32BHDS

UVW = 7955

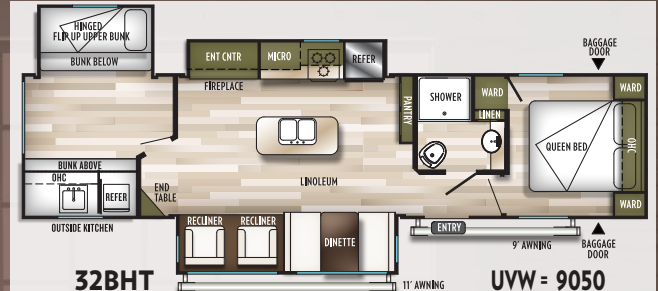

32BHT

UVW = 9050

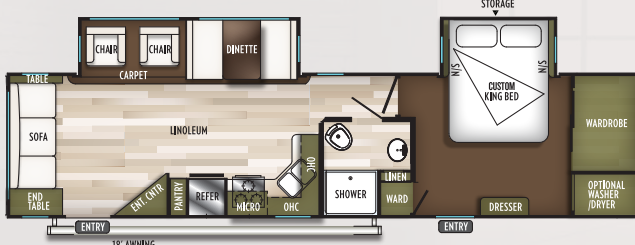

32RLDS

UVW = 8490



33TS

UVW = 9238

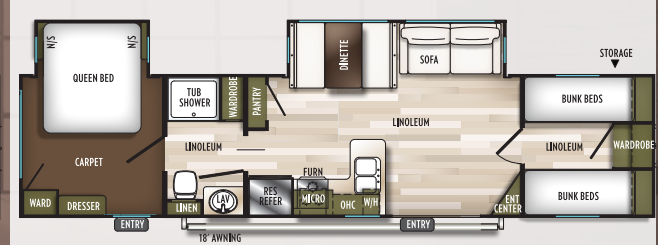

36BHDS

UVW = 8325

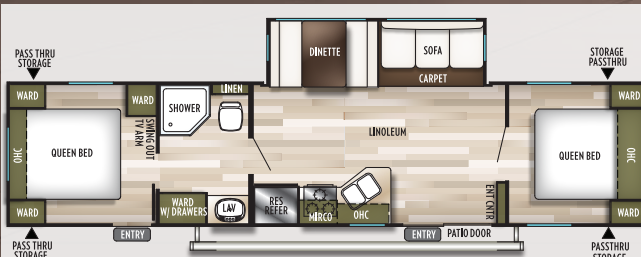

37BHSS2Q

UVW = 7600

	26DBUD	27DBK	27RE	27RKS	28RLSS	30KQBSS	31KQBTS	32BHDS	32BHT	32RLDS	33TS	36BHDS	37BHSS2Q
UVW	6885	6380	7545	6750	6351	6780	8535	7955	9050	8490	9238	8325	7600
Hitch Wt.	795	701	955	950	762	860	905	859	1080	980	1088	1015	970
Carrying Cap.	2672	1283	2332	1162	1373	2821	1292	1826	2192	1412	1852	3316	2271
Ext. Length	332"	320"	336"	337"	341"	330"	366"	358"	376"	38"	389"	388"	390"
Ext. Height	112"	114"	115"	112"	115"	112"	113"	112"	117"	112"	117"	112"	112"
Fresh Water	40	39	40	40	40	39	39	39	40	40	40	40	39
Gray Water	60	60	57	54	30	57	54	57	57	27	54	27	30
Black Water	30	30	38	27	30	27	27	30	38	27	30	38	27
Tire Size	15"	15"	15"	15"	15"	15"	15"	15"	15"	15"	15"	15"	15"

WILDWOOD
360° TOURS



<https://l.ead.me/bb1xy>



27RKS (SHOWN IN CLAY DECOR)



27RKS (SHOWN IN CLAY DECOR)

WHEN YOU COMPARE THE DIFFERENCE IS CLEAR

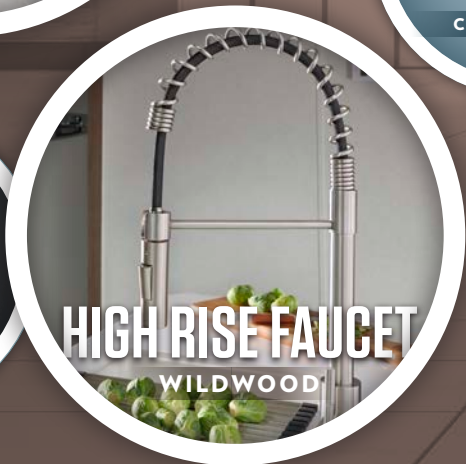

VISIT FORESTRIVERINC.COM/WILDWOOD

TO EXPERIENCE COMPLETE
STANDARDS & MUCH MORE

**24/7 EMERGENCY
ROADSIDE ASSISTANCE
WITH VEHICLE PURCHASE***

TOWING
JUMP-STARTS
TIRE CHANGES
FLUID DELIVERY
LOCKOUT
SERVICE

WINCH-OUT
MOBILE MECHANIC
TECHNICAL
SUPPORT
DEALER LOCATOR
SERVICES



*VALID FOR 1 YEAR FROM DATE OF PURCHASE

FREE MEMBERSHIP
to Forest River Owners' Group

www.forestriverfrog.com



Learn More
Scan this barcode using
a QR Reader on your
smart phone to learn
more about Forest River.



A Berkshire Hathaway company.

FOREST RIVER, INC. 55470 G.R. 1 ELKHART, IN 46515 | (574) 533-5934
WWW.FORESTRIVERINC.COM/WILDWOOD | WWW.FORESTRIVERACCESSORIES.COM



PRE-DELIVERY INSPECTION FACILITY

20,000 square feet of quality assurance. The bare essentials for a premium product. This state-of-the-art facility gives immediate daily feedback to production for quality assurance in every unit built.

Specification Definitions

GVWR (Gross Vehicle Weight Rating) - is the maximum permissible weight of the unit when fully loaded. It includes all weights, inclusive of all fluids, cargo, optional equipment and accessories. For safety and product performance do NOT exceed the GVWR.

GAWR (Gross Axle Weight Rating) - is the maximum permissible weight, including cargo, fluids, optional equipment and accessories that can be safely supported by a combination of all axles.

UVW (Unloaded Vehicle Weight)* - is the typical weight of the unit as manufactured at the factory. It includes all weight at the unit's axle(s) and tongue or pin and LP Gas. The UVW does not include cargo, fresh potable water, additional optional equipment or dealer installed accessories.

*Estimated average based on standard build optional equipment.

CCC (Cargo Carrying Capacity)** - is the amount of weight available for fresh potable water, cargo, additional optional equipment and accessories. CCC is equal to GVWR minus UVW. Available CCC should accommodate fresh potable water (8.2 lbs per gallon). Before filling the fresh water tank, empty the black and gray tanks to provide for more cargo capacity.

** Estimated average based on standard build optional equipment

Each Forest River RV is weighed at the manufacturing facility prior to shipping. A label identifying the unloaded vehicle weight of the actual unit and the cargo carrying capacity is applied to every Forest River RV prior to leaving our facilities.

The load capacity of your unit is designated by weight, not by volume, so you cannot necessarily use all available space when loading your unit.

All information contained in this brochure is believed to be accurate at the time of publication. However, during the model year, it may be necessary to make revisions and Forest River, Inc., reserves the right to make all such changes without notice, including prices, colors, materials, equipment and specifications as well as the addition of new models and the discontinuance of models shown in this brochure. Therefore, please consult with your Forest River dealer and confirm the existence of any materials, design or specifications that are material to your purchase decision. Litho. U.S.A. FOR 1422 P/W: 2017.11.01

CUSTOMER SATISFACTION



www.ForestRiverBuyLocal.com

YOUR WILDWOOD DEALER 2019

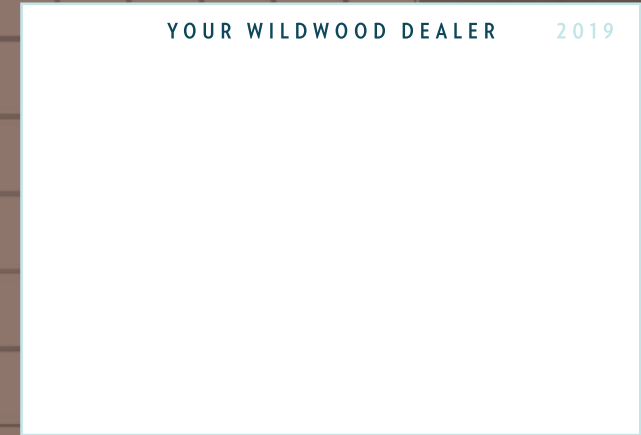

**WILDWOOD
PRODUCT FAMILY**



X-LITE



WILDWOOD



HERITAGE GLEN



DLX | LODGE | GRAND LODGE