

# FREEDOM Express

**PILOT**



19 FBS

The fully featured, easy to tow Pilot offers Freedom Express style, quality, and construction in a smaller, more lite weight package.

## Pilot FREEDOM VALUE PACKAGE (Required)

- ¾ Gel Coated Fiberglass Front Cap with LED Lights
- Aluminum Wheels
- Spare Tire Kit
- Detachable Power Cord
- Power Awning
- Magnetic Catches Compartment Doors
- Tinted Safety Glass Windows
- Front Diamond Plate
- TV and Radio Antenna with Booster
- E-Z Lube® Axles
- Enclosed Underbelly
- Solar Port
- Assist Handle
- Exterior Shower Station
- Winterize Ready Kit
- Black Tank Flush
- 2 Exterior Speakers, 4 Interior Speakers
- AM/FM/CD/DVD/Bluetooth
- 28" LED TV's
- Satellite Ready
- LED Interior Lighting
- Night Shades
- Congoleum Designer Carefree Flooring
- Mortise and Tenon Cabinet Doors
- Stonecast Sink
- Sink Covers
- Microwave with 2 Burner Cooktop
- Butcher Block Stove Cover
- 6 Cu. Ft. Two Door Refrigerator
- Silverware Drawer
- 60" x 80" Queen Bed
- Skylight in Bath
- RVIA
- White LED Awning Light
- 12" LED Step Light
- LED Light Strip in Pass-through Storage
- 24" x 48" Resin Outdoor Table
- USB Ports
- Porcelain Toilet



Pilot is specifically designed for smaller tow vehicles. Convenient USB ports in multiple locations, a large 6 cu. ft. refrigerator, and abundant storage are just a few of the features offered. 19FBS shown in Cashew decor.

## Options

- 15,000 BTU A/C
- Power Tongue Jack
- Coleman High Output Grill
- RV Eye Wi-Fi Cameras
- Frameless Windows
- Ladder
- Radiant Barrier Pack
- Canadian Compliance
- Winegard WIFI and 4G LTE Extender

## SOFA

CASHEW

RUSSET

FREEDOM TO EXPLORE



# FREEDOM

## PILOT

# Express



- 50% Lighter than wood
- No rot, mold or water damage
- R-2 thermal insulation
- Odorless, no formaldehyde
- Sound and energy absorbing
- Impact and puncture resistant
- Made in USA

Pilot models include this well-planned storage area

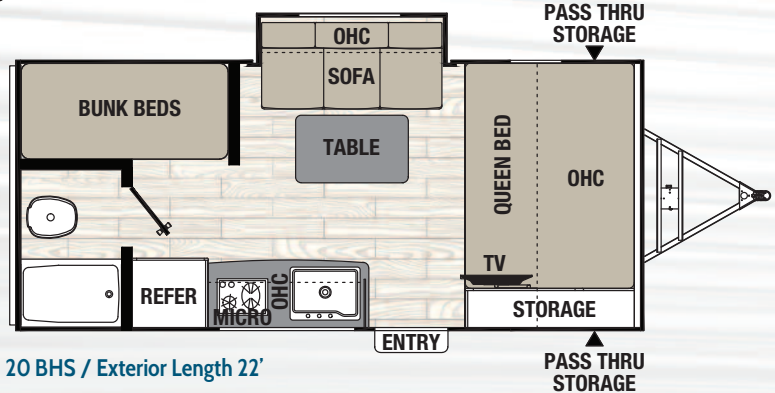
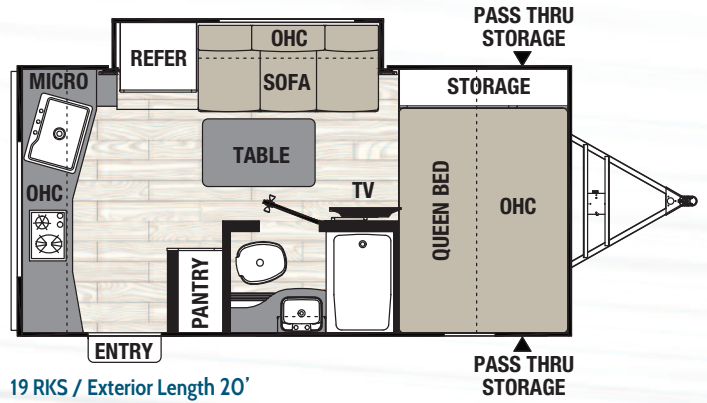
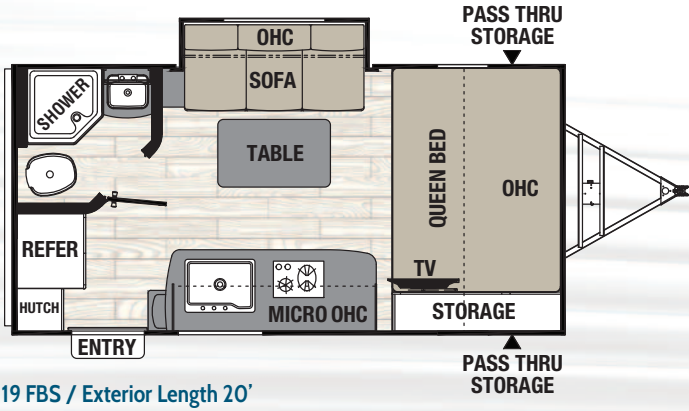
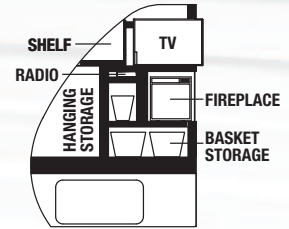

Freedom Express Pilot Editions	19FBS	19RKS	20BHS
UVW*	3,695	3,820	3,883
Hitch Weight	406	468	445
Carrying Capacity	1,105	980	917
Exterior Length	20'	20'	22'
Exterior Height	10' 6"	10' 6"	10' 6"
Interior Height	81"	81"	81"
Awning Length	12'	12'	12'
Fresh/Grey/Waste Water Capacity (gal.)	49/33/33	49/33/33	49/33/33
Tire Size	ST225/75R15D	ST225/75R15D	ST225/75R15D

\*Unloaded vehicle weights do not include options. See below for definitions of chart descriptions.



Your Freedom Express Dealer

423 N. Main Street ■ P.O. Box 30 ■ Middlebury, IN 46540

To learn more about Coachmen RV and our products and see how Coachmen is making the easy life easier, visit [www.coachmenrv.com](http://www.coachmenrv.com) or call 1.800.353.7383.

**GVWR (Gross Vehicle Weight Rating)** - is the maximum permissible weight of the unit when fully loaded. It includes all weights, inclusive of all fluids, cargo, optional equipment and accessories. For safety and product performance do NOT exceed the GVWR.

**GAWR (Gross Axle Weight Rating)** - is the maximum permissible weight, including cargo, fluids, optional equipment and accessories that can be safely supported by a combination of all axles.

**UVW (Unloaded Vehicle Weight)\*\*** - is the typical weight of the unit as manufactured at the factory. It includes all weight at the unit's axle(s) and tongue or pin and LP Gas. The UVW does not include cargo, fresh potable water, additional optional equipment or dealer installed accessories.

\*Estimated Average based on standard build optional equipment.

**CCC (Cargo Carrying Capacity)\*\*** - is the amount of weight available for fresh potable water, cargo, additional optional equipment and accessories. CCC is equal to GVWR minus UVW. Available CCC should accommodate fresh potable water (8.3 lbs per gallon). Before filling the fresh water tank, empty the black and gray tanks to provide for more cargo capacity.

\*\* Estimated average based on standard build optional equipment

Each Forest River RV is weighed at the manufacturing facility prior to shipping. A label identifying the unloaded vehicle weight of the actual unit and the cargo carrying capacity is applied to every Forest River RV prior to leaving our facilities.

The load capacity of your unit is designated by weight, not by volume, so you cannot necessarily use all available space when loading your unit.

All information contained in this brochure is believed to be accurate at the time of publication. However, during the model year, it may be necessary to make revisions and Forest River, Inc., reserves the right to make all such changes without notice, including prices, colors, materials, equipment and specifications as well as the addition of new models and the discontinuance of models shown in this brochure. Therefore, please consult with your Forest River dealer and confirm the existence of any materials, design or specifications that are material to your purchase decision.

©2017 Freedom Express by Coachmen, a Division of Forest River, Inc., a Berkshire Hathaway company. All Rights Reserved. 9/17



Find us on Facebook



[www.ForestRiverBuyLocal.com](http://www.ForestRiverBuyLocal.com)