

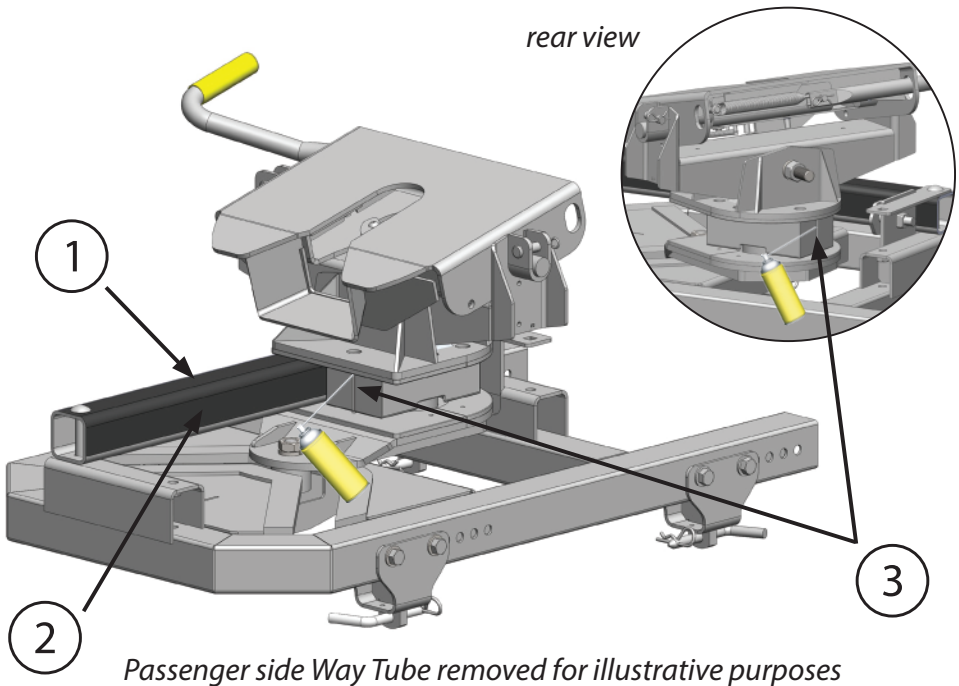

For information about your RV,
usage, Required Maintenance and Warranty,
please refer to your owners packet,
manufacturers website or www.pullrite.com

LUBRICATION INSTRUCTIONS



EVERY DAY YOU TOW, and as needed:

Apply WD-40 (or other light oil) to **Top** (1) and **Inside Face** (2) of Way Tubes and **between** the two plastic blocks inside the hitch (3).

Do not use other types of lubricant, particularly silicone or graphite-based.



For information about your RV,
usage, Required Maintenance and Warranty,
**please refer to your owners packet,
manufacturers website or www.pullrite.com**

PROPER HITCHING HEIGHT

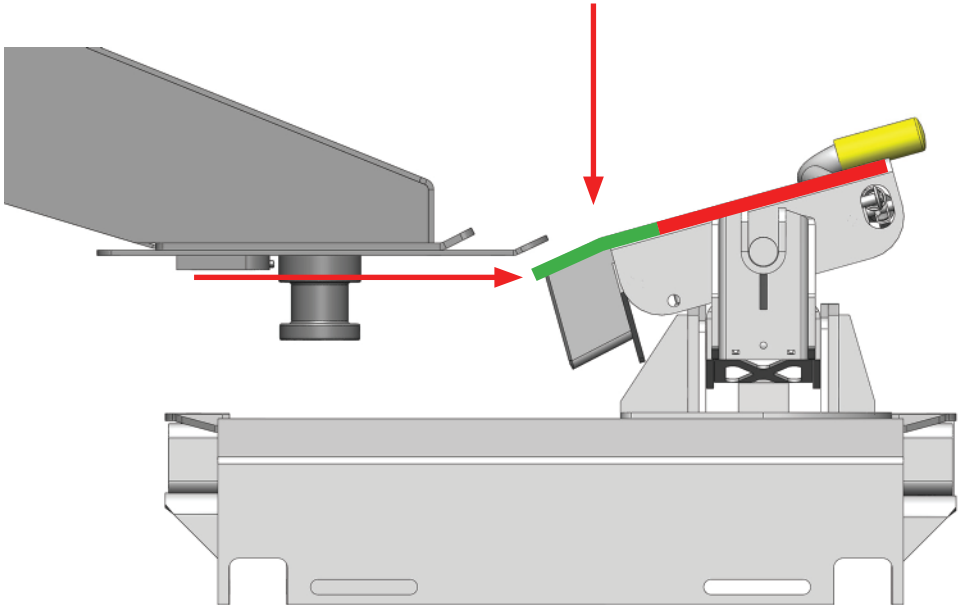

When **hitching**, aligning the leading edge of the King Pin box with the rearward portion (*green above*) of the hitch plate.

This will "squat" the truck, putting weight on the hitch.

When **unhitching**, do this in reverse. Leave some trailer weight on the hitch. The truck will rise up when pulling away.

For **full hitching instructions**, please see your *Owner's Manual*.

See Owner's Manual for additional details.