



Seneca



Serial #: 1UJNJCBU1N1HK4126
Model: 37K SENECA MHC
VIN#: 4UZADVFC0NCNP9130
Model Year: 2022 Dealer Name: PHARR RV'S, INC.
320 NORTH LOOP 289
LUBBOCK, TX 79403
USA

Standard Equipment

Optional Equipment

THE FOLLOWING ITEMS ARE STANDARD ON THIS MODEL
AT NO EXTRA CHARGE

OPTIONAL EQUIPMENT INSTALLED ON THIS VEHICLE
BY MANUFACTURER

- EXTERIOR
- Freightliner® S2RV chassis
 - GVWR- 29,000 lb.
 - GCWR- 41,000 lb.
 - Cummins® ISB 6.7L 360 HP diesel engine with 800 ft.-lb. torque
 - Allison® 3000 MH automatic transmission
 - 185-amp alternator
 - G-rated highway tires- 275/80R22.5
 - Alcoa® aluminum rims
 - Engine exhaust brake
 - 12,000-lb. rear hitch receiver
 - 7-pin plug
 - Dual 12V chassis batteries
 - 100 gal. fuel tank
 - 10 gal. DEF tank
 - Deluxe heated, remote-controlled, side-view mirrors
 - StrongholdVBL™ roof, floor and sidewalls
 - Bead-foam insulation (R-24 max roof, R-9 max floor and R-5 max walls)
 - One-piece, seamless, crowned fiberglass roof
 - Premium Sikkens full-body paint
 - Automatic hydraulic leveling jacks
 - Entrance door with industry's largest travel-view window
 - Electric-powered entrance step
 - Slideout cover awnings
 - Exterior entertainment center with outside speakers, LED TV mounted on swivel bracket and single-disc DVD/CD/AM/FM radio
 - Winegard® In-motion satellite dish
 - Carpeted, full pass-through storage compartments with lockable, slam latch doors
 - 24.5 gal. propane tank (83 lb.)
 - LP quick-connect hookup
 - Thetford® Sani-Con Turbo Macerator system
 - Exterior utility center
 - Winterization drain system
 - Black tank flush
 - Outside shower
 - 12V demand water pump
 - Onan® 8,000-watt Quiet Diesel generator and auto-gen start
 - Transfer switch with reverse polarity protection
 - (4) 6V AGM (220Ah) house batteries on slideout tray
 - 190W solar panel with dual controller
 - Flush-mount LED marker lights
 - Third brake light

- INTERIOR
- Driver and passenger airbags
 - Power windows and door locks
 - Tilt steering wheel
 - A/C and cruise control
 - Auxiliary start switch
 - Custom-molded ABS surround in cab-over area
 - Overhead bunk with 750 lb. capacity
 - JAYCOMMAND™ powered by Firefly
 - 84 in. interior ceiling height with padded vinyl ceiling
 - High-intensity, recessed LED ceiling lights
 - Vinyl plank flooring
 - Raised-panel, hardwood cabinetry throughout
 - Deluxe hidden cabinet hinges
 - Ball-bearing drawer guides
 - Jayco-exclusive, easy-operation legless dinette table
 - 2-point lap safety belts in all designated seating locations
 - 34,000 BTU auto-ignition furnace
 - Furrion® electric fireplace (N/A 37TS)
 - LED HD Smart Fire TV in living area
 - Cable TV hookup with RG-6 coax and video selector switch
 - Winegard 2.0 Wifi/4G antenna
 - Wood-framed kitchen window with spice cabinets
 - 2-burner induction cooktop
 - LED-lit, solid-surface kitchen countertops with integrated stainless steel sink and sink covers
 - Pull-out countertop extension (select models)
 - Water filtration system
 - One-piece, fiberglass shower with glass door, skylight and light
 - Porcelain toilet with foot flush
 - LED-lit, stainless-steel bathroom sink
 - Powered roof vent in bathroom with wall switch
 - Walk-around King-size bed with bedspread and nightstands
 - Under-bed storage
 - LED TV in bedroom
 - Large wardrobes
 - Bunks with industry-exclusive 300 lb. capacity each (37L)
 - Smoke alarm
 - Carbon monoxide detector

- CUSTOMER VALUE PACKAGE
- JRIDE® PREMIUM: Computer-balanced driveshaft, rear air suspension, heavy-duty rear stabilizer bar, full air brakes, SACHS shocks
 - One-piece, seamless, fiberglass front and rear caps
 - Automotive-bonded, panoramic window in front cap with power shade
 - Dual-pane, tinted, safety-glass windows
 - (2) 15,000 BTU A/C units with heat pumps
 - Electric patio awning with LED lights
 - 2,000-watt pure sine wave inverter
 - Power cord reel with 50-amp service
 - Girard® tankless water heater
 - Sony® infotainment center with Apple® CarPlay and Android Auto™
 - Backup and side-view cameras
 - Residential refrigerator
 - Convection microwave oven

Base price	295,943.00
Richmond	n/c
Acadia Paint Package	30.00
USA Standards	n/c
22 FR S2RV 31000 279"	
360 NA15	n/c
Customer Value Package	6,750.00
Residential Refrigerator	n/c
No Washer/Dryer	n/c
IN Motion DISH Satellite System	n/c
Booth Dinette	n/c

UNIT TOTAL 302,723.00

DEALER INSTALLED OPTIONS

Manufacturer's Suggested Retail Price \$302,723.00

TOTAL AMOUNT DOES NOT INCLUDE STATE AND LOCAL TAXES OR LICENSE FEES. THE PRICE SHOWN ABOVE MAY OR MAY NOT BE REPRESENTATIVE OF THE ACTUAL SELLING PRICE OF SIMILAR RECREATIONAL VEHICLES IN YOUR AREA.

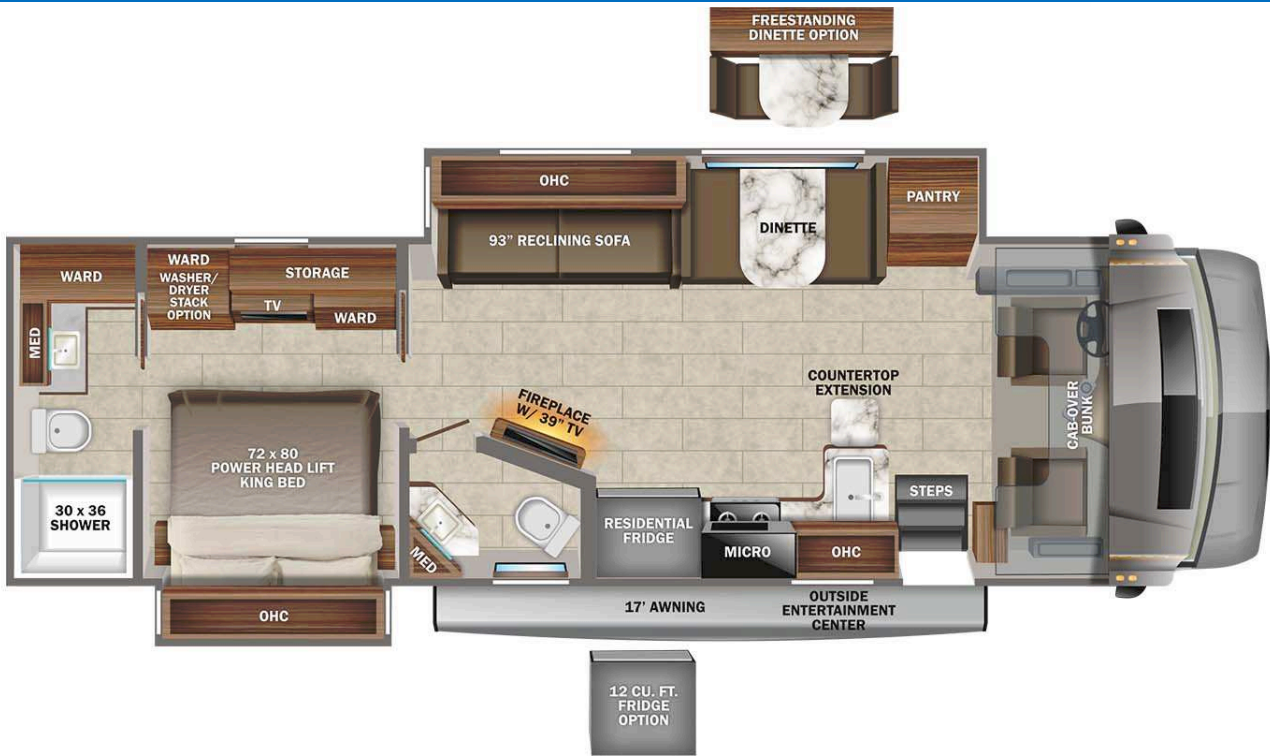

DIMENSIONS

Exterior height:.....160.00"
Exterior width:.....101.00"

CAPACITIES

Fresh water tank (gals.):...72.00
Gray water tank (gals.):...91.00
Black water/toilet tank (gals.):.....63.00
Propane (lbs.):.....83
Propane (gals.):.....19
Water heater (gals.):.....0.00

TIRES

Tire size (front):.....275/80R22.5G
Tire size (mid):.....
Tire size (rear):.....275/80R22.5G

Some dimensions may be rounded and may vary from the actual dimensions
Weights may be estimated calculations and may vary from the actual weight - refer to the vehicle weight labels for actual weights
Floorplans, features and specifications are subject to change without notice.

