

### Redhawk SE



Serial #: 1UJLJCB5N1GA4078  
 Model: 22A REDHAWK SE MHC  
 VIN#: 1HA6GUC70MN013342  
 Model Year: 2022 Dealer Name: RV ONE SUPERSTORES-DES MOINES  
 1400 NORTHDRIDGE CIRCLE  
 ALTOONA, IA 50009  
 USA

### Manufacturer's Suggested Retail Price

TOTAL AMOUNT DOES NOT INCLUDE STATE AND LOCAL TAXES OR LICENSE FEES. THE PRICE SHOWN ABOVE MAY OR MAY NOT BE REPRESENTATIVE OF THE ACTUAL SELLING PRICE OF SIMILAR RECREATIONAL VEHICLES IN YOUR AREA.

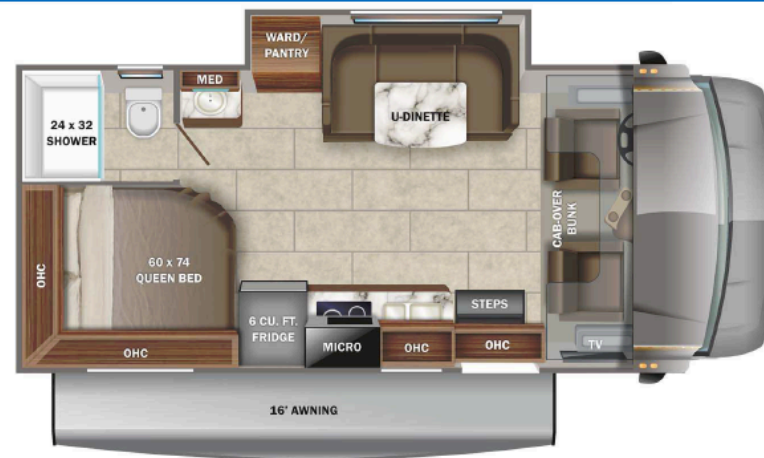

#### Standard Equipment

#### Optional Equipment

THE FOLLOWING ITEMS ARE STANDARD ON THIS MODEL AT NO EXTRA CHARGE

OPTIONAL EQUIPMENT INSTALLED ON THIS VEHICLE BY MANUFACTURER

- EXTERIOR**
- Chevy® 4500 Chassis
  - GVWR- 14,200 lb.
  - GCWR- 20,000 lb.
  - 6L Vortec V8 342 HP engine with 373 ft.-lb. torque
  - Hydra-matic 6-speed automatic transmission with overdrive
  - 120-amp alternator
  - E-rated highway tires- LT225/75R16
  - Power anti-lock brakes with power steering
  - 5,000 lb. hitch with 500 lb. tongue capacity and 7-pin plug
  - 12V chassis battery
  - 57 gal. fuel tank
  - Remote-controlled, side-view mirrors
  - Stronghold VBL™ roof, floor and sidewalls
  - Bead-foam insulation (R-24 max roof, R-9 max floor, R-5 max walls)
  - TPO laminated roof
  - Aluminum running boards
  - Fiberglass exterior walls with vinyl graphics
  - Leveling jack prep
  - Entrance door with industry's largest travel-view window
  - Electric-powered entrance step with integrated house battery compartment
  - 12V house battery
  - 12.2 gal. propane tank (41 lb.)
  - LP quick-connect hookup
  - Exterior utility center
  - Winterization drain system
  - Outside shower
  - 12V demand water pump
  - Onan® 4,000-watt MicroQuiet™ generator
  - Transfer switch with reverse polarity protection
  - 30-amp electrical service
  - Solar prep
  - Third brake light
  - Roof ladder
  - 4 in. bumper tube sewer hose storage

- INTERIOR**
- Driver and passenger airbags
  - Power windows and door locks
  - Tilt steering wheel
  - A/C and cruise control
  - Auxiliary start switch
  - Privacy curtains for cab area
  - 84 in. ceiling height
  - High-intensity, recessed LED ceiling lights
  - Hardwood cabinet doors
  - Ball-bearing drawer guides
  - Jayco-exclusive, easy-operation legless dinette table
  - 2-point lap safety belts in all designated seating locations
  - Interior entrance door grab handle
  - Interior command center
  - Pleated blackout shades
  - 13,500 BTU ducted A/C
  - 31,000 BTU auto-ignition furnace
  - 6 gal. gas/electric DSI auto-ignition water heater
  - Cable TV hookup with RG-6 coax
  - Digital antenna with signal booster
  - 2-burner cooktop with flush cover
  - Convection microwave oven
  - Stainless steel kitchen sink
  - Decorative kitchen backsplash
  - Water filtration system
  - Shower with decorative ABS surround and skylight
  - Stainless steel bathroom sink
  - Toilet with foot flush
  - Queen-size bed with bedspread
  - Under-bed storage (select models)
  - Large wardrobes
  - Overhead bunk with 750 lb. capacity
  - Smoke alarm
  - Carbon monoxide detector
- CUSTOMER VALUE PACKAGE**
- One-piece, seamless, fiberglass front cap
  - Heated holding tanks (12V pads)
  - Electric patio awning
  - Black holding tank sprayer
  - Backup camera
  - 6 cu. ft. flush-mount refrigerator
  - LED HDV

- Base price
- Blackstone
- USA Standards
- Customer Value Package
- No Solar Panel
- Standard House Battery

#### DIMENSIONS

Exterior height:.....138.00"  
 Exterior width:.....100.00"

#### CAPACITIES

Fresh water tank (gals.)....43.50  
 Gray water tank (gals.)....40.00  
 Black water/toilet tank (gals.).....32.00  
 Propane (lbs.).....41  
 Propane (gals.).....9  
 Water heater (gals.).....6.00

#### TIRES

Tire size (front):.....LT225/75R16ES  
 Tire size (mid):.....  
 Tire size (rear):.....LT225/75R16ES

UNIT TOTAL

DEALER INSTALLED OPTIONS

\*\*\*Some dimensions may be rounded and may vary from the actual dimensions\*\*\*  
 \*\*\*Weights may be estimated calculations and may vary from the actual weight - refer to the vehicle weight labels for actual weights\*\*\*  
 Floorplans, features and specifications are subject to change without notice.

