

# 14698

## Seneca Prestige



**Manufacturer's Suggested Retail Price \$355,501.00**

TOTAL AMOUNT DOES NOT INCLUDE STATE AND LOCAL TAXES OR LICENSE FEES. THE PRICE SHOWN ABOVE MAY OR MAY NOT BE REPRESENTATIVE OF THE ACTUAL SELLING PRICE OF SIMILAR RECREATIONAL VEHICLES IN YOUR AREA.



Serial #: 1UJNJCBU8N1LK4089  
 Model: 37K SENECA PRESTIGE MHC  
 VIN#: 4UZADVFC0NCNR9412  
 Model Year: 2022 Dealer Name: NORTH TRAIL RV  
 4601 LEXINGTON AVE  
 FT. MYERS, FL 33905  
 USA

### Standard Equipment

### Optional Equipment

THE FOLLOWING ITEMS ARE STANDARD ON THIS MODEL AT NO EXTRA CHARGE

OPTIONAL EQUIPMENT INSTALLED ON THIS VEHICLE BY MANUFACTURER

- EXTERIOR**
- Freightliner® S2RV front engine diesel "Super-C" cab chassis
  - Cummins® ISB 6.7L 360 HP diesel engine with 800 ft.-lb. torque
  - Allison® 3000 MH automatic transmission
  - Variable geometry engine exhaust brake
  - 185-amp alternator
  - Michelin® tires- 275/80R 22.5 14 ply
  - 12,000-lb. rear hitch receiver
  - 7-pin plug
  - Dual 12V chassis batteries - 1900 CCA
  - 100-gal. fuel tank
  - 13-gal. DEF tank
  - Onan® 8,000-watt diesel generator with auto-gen start
  - (4) 6V AGM (220Ah) house batteries on slideout tray
  - 4V AGM (220Ah) house batteries on slideout tray
  - Dual 15,000-BTU A/C unit with heat pumps
  - Touchstone electric 5,000 BTU thermostat controlled fireplace
  - Theford® Sani-Con Turbo Macerator system
  - Exterior utility center
  - Winterization drain system
  - Black tank flush
  - Outside shower
  - 12V demand water pump
  - Water filtration system
  - Power windows and door locks
  - Tilt and telescoping leather-wrapped steering wheel
  - TuffShell™ vacuum-bond laminated roof, floor and sidewalls
  - One-piece, seamless, crowned fiberglass roof
  - Bead-foam insulation (R-24 max roof, R-9 max floor, R-5 max walls)
  - One-piece, seamless, fiberglass front and rear caps
  - Automotive-bonded panoramic window in front cap with power shade
  - Premium Sikken's full-body paint
  - Automatic hydraulic leveling jacks
  - Alcoa® aluminum rims
  - Exterior entertainment center with outside speakers, LED TV mounted on swivel bracket and AM/FM radio
  - Winegard® in-motion satellite dish
  - Deluxe heated, remote-controlled, side-view mirrors
  - Entrance door with industry's largest travel-view window
  - Electric-powered entrance step
  - Slideout cover awnings
  - Chrome exterior baggage door handles and locks
  - Carpeted, full pass-through storage compartments with lockable alarm latch doors
  - Flush-mount LED marker lights

- INTERIOR**
- Power driver and passenger seats
  - Auxiliary start switch
  - Privacy curtains for cab area
  - Color-coordinated carpeted floor mat
  - Custom-molded ABS surround in cab-over area
  - Overhead bunk with 750 lb. capacity
  - JAYCOMMAND® powered by Firefly
  - High-intensity recessed LED ceiling lights
  - Raised-panel high-gloss hardwood cabinetry and stiles throughout
  - Deluxe hidden cabinet hinges
  - High-gloss, polished porcelain floor tile with heated floor mat
  - Multi-functional legless dinette table
  - 50 in. LED TV in living area (40 in. on 37K)
  - Sony Blu-Ray™ with HDMI® connections
  - Cable TV hookup with RC-6 coax and video selector switch
  - Wood-framed kitchen window with spice cabinets
  - 2-burner induction cooktop with LED display
  - Solid-surface kitchen countertop with large integrated stainless steel sink with sink covers
  - One-piece, fiberglass shower with glass door, skylight and light
  - Porcelain toilet with foot flush
  - Solid-surface bathroom sink
  - Powered roof vent in bathroom with wall switch
  - Walk-around, King-sized bed with bedspread and nightstands
  - 33" LED TV in bedroom
  - Large wardrobes
- CUSTOMER VALUE PACKAGE**
- JRIDED® PREMIUM: Computer-balanced driveshaft, rear air suspension, heavy-duty rear stabilizer bar, full air brakes, SACHS shocks
  - Dual-pane, tinted, safety-glass windows
  - Roof-mounted Girard® NOVA II dual-pitched patio awning with LED lights
  - 2,000-watt pure sine wave inverter
  - Power cord reel with 50-amp service
  - Aqua-Hot® 250D hydronic water and heating system
  - 9" Sony® infotainment center with Apple CarPlay® and Android Auto™
  - Backup and side-view cameras
  - 21-cu.ft. side-by-side residential refrigerator with ice and water in door
  - Flush-mounted convection microwave

Base price	340,800.00
Onyx	n/c
Linex Glazed Cabinetry	30.00
Linex Front Overhead	
Accent Wood	n/c
Grey Marvel Paint	30.00
USA Standards	n/c
22 FR S2RV 31000 279"	
360 NA15	n/c
Customer Value Package	11,250.00
Washer/Dryer Stackable	2,048.00
Trav'ler Direct TV	
Satellite Network	1,343.00
Booth Dinette	n/c

UNIT TOTAL **355,501.00**  
 DEALER INSTALLED OPTIONS

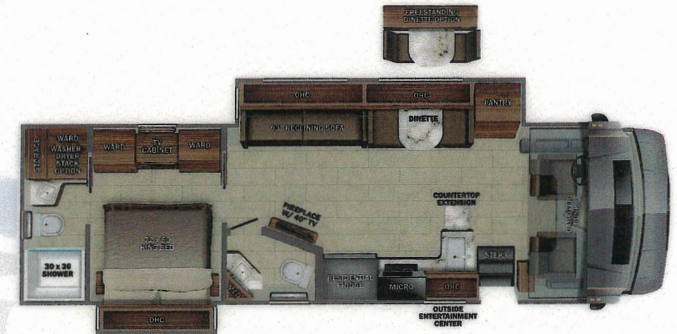

### DIMENSIONS

Exterior height:.....160.00"  
 Exterior width:.....101.00"

### CAPACITIES

Fresh water tank (gals.):...72.00  
 Gray water tank (gals.):...91.00  
 Black water/toilet tank (gals.):.....63.00  
 Propane (lbs.):.....0  
 Propane (gals.):.....0  
 Water heater (gals.):.....0.00

### TIRES

Tire size (front):.....275/80R22.5G  
 Tire size (mid):.....  
 Tire size (rear):.....275/80R22.5G

\*\*\*Some dimensions may be rounded and may vary from the actual dimensions\*\*\*  
 \*\*\*Weights may be estimated calculations and may vary from the actual weight\*\*\*  
 - refer to the vehicle weight labels for actual weights\*\*\*  
 Floorplans, features and specifications are subject to change without notice.

