

2026

GRAND STAR

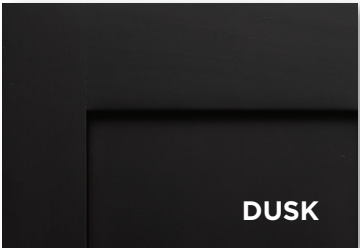

CABINET FINISHES



GRAYSON

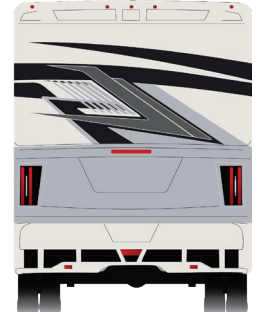
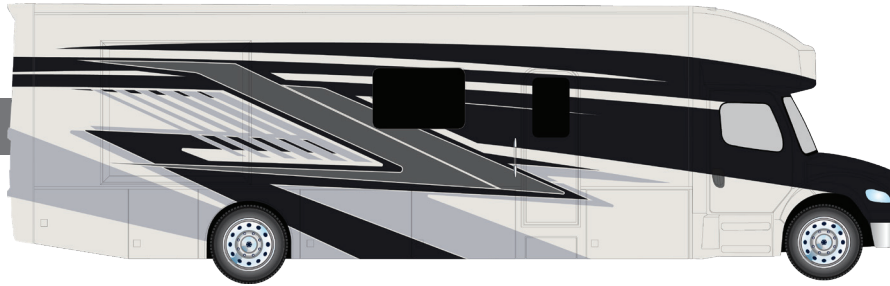

AZURE

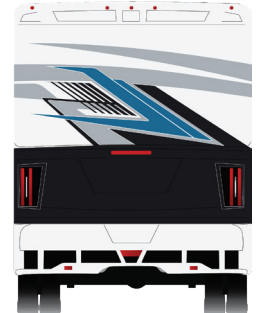
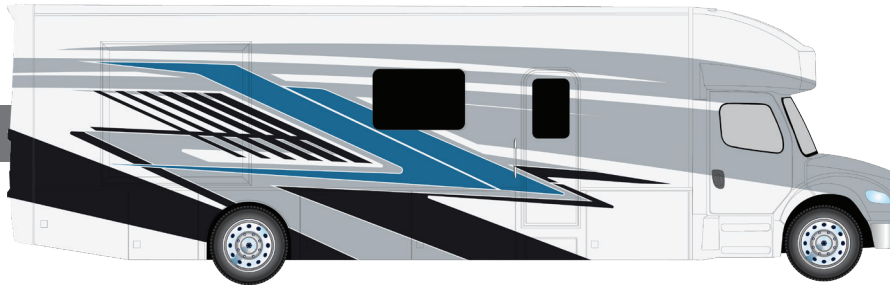

RUTLEDGE

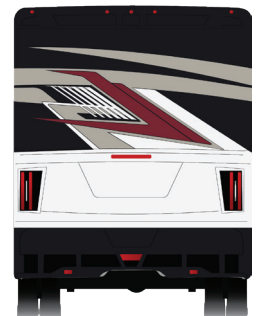
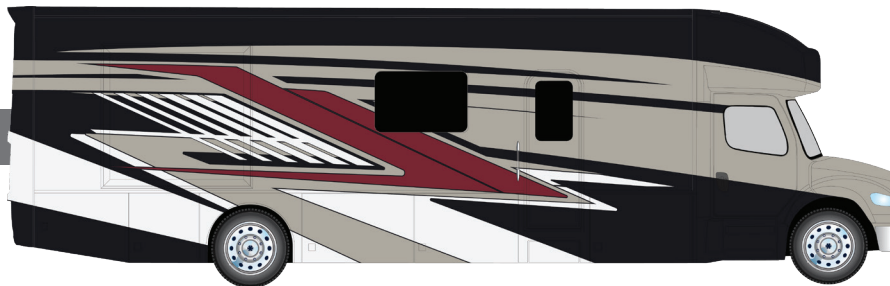

*Features subject to change. Check newmarcorp.com for additional features and options.

Length: 34' 10"

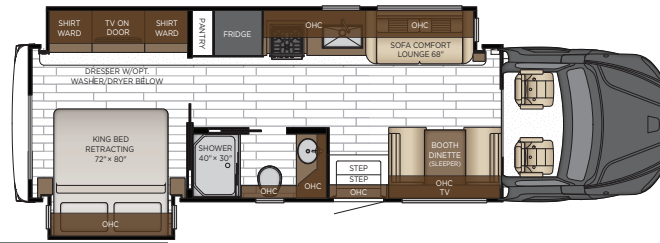

3444

Length: 39' 11"

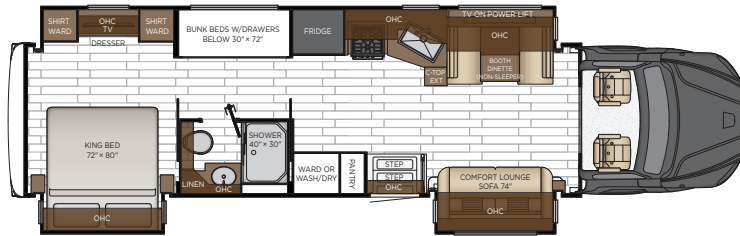

3940

Length: 39' 11"



3948

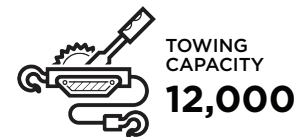
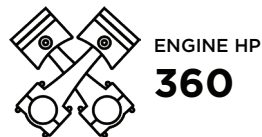



2025 SPEC SHEET

Newmar Grand Star

5-STAR FEATURES



24/7 factory-direct phone support



24/7 factory-direct phone support

Free mobile app: Search "Freightliner 24/7"

ENGINE

Make	Cummins B6.7
Horsepower	360 HP @ 2,600 rpm
Torque	800 lb-ft
Brake	VGT (Variable Geometry Turbocharger) Brake (single stage)

WEIGHT RATINGS

Front GAWR	12,200 lbs
Rear GAWR	23,000 lbs
Tag GAWR	N/A
Total GVWR	35,200 lbs

TRANSMISSION

Gears	Allison 3000
--------------	--------------

FUEL

Type	Diesel
Fuel Tank	100 Gallon
Def Tank	10 Gallon

SUSPENSION

Front	TAPERLEAF
Wheel Cut	55 Degree front wheel
Rear	Airliner

SHOCKS

Make	Sachs custom tuned
-------------	--------------------

AXLES

Front	Detroit DA-F-12.5-3
Rear	Detroit DA-RS-23.0-4
Axle Ratio	4.78

BRAKES

Front	Meritor Air Drum Brakes with ABS
Rear	Meritor Air Drum Brakes with ABS

COOLING

Radiator	750 sq. in., Front mounted
-----------------	----------------------------

RAILS

FRAME

Construction	5/16 X 3.00 X 10-1/8 inch steel frame
Wheel Base	279"

HITCH

Rating	Supplied by OEM
---------------	-----------------

TIRES

Make	Michelin XZE
Front Size	275/80R 22.5 16-ply
Rear Size	275/80R 22.5 16-ply
Wheels	8.25" Aluminum w/ Tire Pressure Monitoring System

ELECTRICAL

Alternator	240 Amp Leece-Neville
Battery	(2) 1,900 CCA @ 0 degrees F

CONTROLS

Steering Column	Adjustable Tilt and Telescoping
Steering Wheel	4-Spoke 18" (450MM) Leather Wrapped Wheel With Chrome Switches
Instruments	Premium Instrument Cluster with 5" TFT Color Display
Safety	Electronic Stability Control (ESC) with Roll Stability Support (RSS), Automatic Traction Control (ATC)

WARRANTY

Basic Chassis / Drivetrain	3 years, 50,000 mi
Engine	5 Years / 100,000 mi.
Transmission	3 years / 50,000 mi.
Battery	1 year, 100,000 mi
Corrosion / Brightwork	6 months unlimited
Frame Rails / Cross Member	5 years, 100,000 mi