



COUGAR

HALF-TON FIFTH WHEEL



26RKE

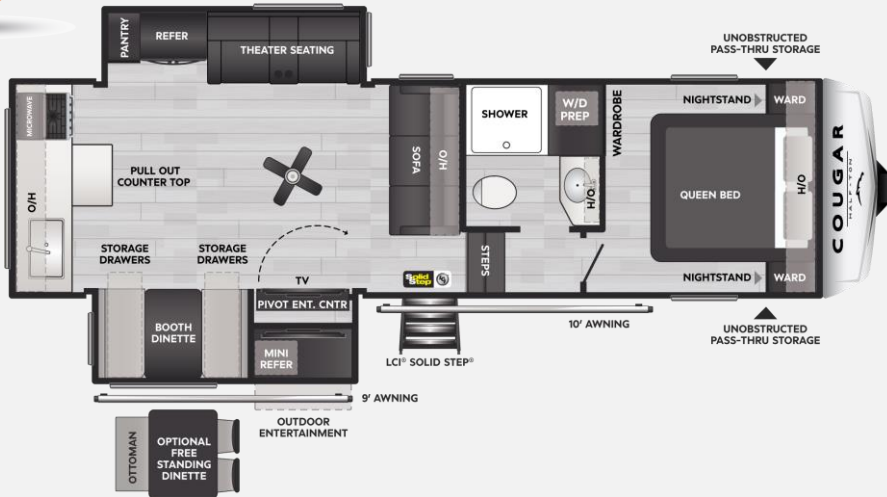

SPECIFICATIONS:

Shipping Wt.	TBD
Carrying Cap.	TBD
Hitch Weight	TBD
Length	30'10"
Height	12'7"*
Fresh Water	54 gal.
Gray Water	60 gal.
Black Water	30 gal.
Sleeps Up To	6

KEY FLOORPLAN ADVANTAGES:

- Wide-open floorplan with opposing slide outs
- Perfect length around 30' including towing hitch
- Outside Entertainment
 - 40" TV, refrigerator, and metal countertop with pull-out extension
- Washer / dryer combo prepped
- 16 cu. ft. 12-volt refrigerator with glass front
- Hidden utility / closet / pantry
- 12v Ceiling fan
- Dual power awnings: 9 ft. and 10 ft.
- Entertainment seating with reclining theater seat and tri-fold sofa
- Unique kitchen pull-out countertop with bank of drawers

ADDITIONAL STANDARD FEATURES:

- Road Armor Suspension System
- ABS - Anti-Lock Braking System
- Goodyear Endurance tires
- Solid Step entry steps
- Tankless water heater
- Climate Guard - Tested & Approved from 0° to 110°
- Heat & Massage in Theater Seats
- Winegard Air 360+ Antennae
- 12 Volt heat pads on all tanks
- Soft close cabinet doors
- 12 Volt refrigerator
- Roller shades throughout
- 50-amp service

KEYSTONE EXCLUSIVE FEATURES:

- HyperCore Composite Sidewalls
- Hyperdeck Composite Floor
- Key TV: all one-piece coax runs
- Giggy Box: 12v distribution box
- Color coded & unified wiring system
- Flush mount heat ducts
- My Keystone app for owners
- Solar Flex Protect 220
- Transferrable 1-year base warranty
- Transferrable 3-year structural warranty

AVAILABLE OPTIONS:

- Trifold Sofa or Theater Seating
- Dual Pane windows
- 15k Ducted Bedroom A/C
- Slide Toppers
- Free Standing Dinette with Ottoman
- Solar Flex Discover 440i
- Solar Flex Outlast 660i
- (2) 100-amp hour heated Lithium batteries

DISCLAIMER: Product information is as accurate as possible as of the date of this publication. All features, floor plans and specifications are subject to change without notice.

