



FOREST RIVER SALEM TRAVEL TRAILERS

Midwest • Northwest • West

FOREST RIVER SALEM





22RBS



26DBUD



27



29VBUD

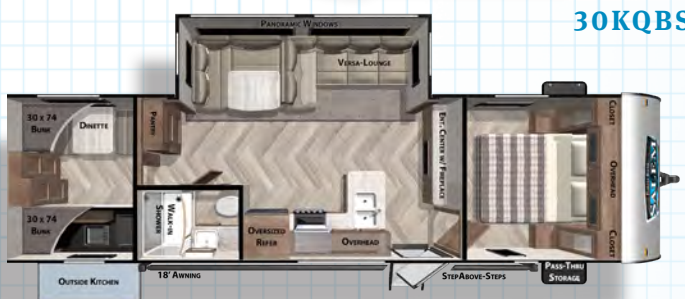

30KQBS



32BHDS



32RET



34MBS



36VBDS

For more info, pictures & 360 Tours, visit www.forestriverinc.com/Salem

27RE



27RK

31KQBS

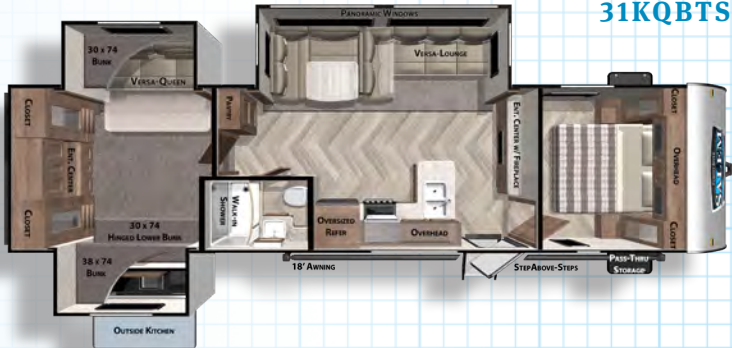

33TS



37BHSS2Q

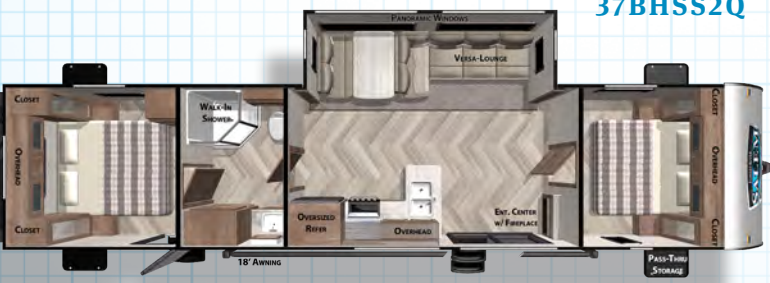

BEST IN CLASS VALUE PACKAGE

- » Upgraded Designer Furniture Package
- » Extra Large Panoramic Window Package in Main Slide
- » MORryde™ StepAbove Triple Step (Main Door Only) (N/A 36VBDS & 37BHSS2Q)
- » Large Capacity 11 CU FT Frost-Free Refrigerator (12-volt)
- » Accent Lighting Package (Awning & Over Main Slide-Out)
- » Seamless Countertops (No T-Mold)
- » 20.3 CU FT of Stow N Go Storage (Bed, Dinette & Sofa) (22RBS 17 CU FT)
- » Green PKG: Furrion Solar Prep & LED Mushroom Lights
- » Heated & Enclosed AccessBelly (w/ Removable Underbelly Panels)
- » Modern Cloth Roller Shades w/ AutoStop
- » Power Awning w/Adjustable Legs
- » Power Tongue Jack w/LED Light
- » True Stabilizer Jacks w/ JT StrongArms
- » 30" Built-In Electric Fireplace (Heater)
- » (2) Zone Residential Soundbar (FM, Bluetooth, HDMI & USB)
- » Ext. Convenience PKG: Friction Hinge & Baggage Door Magnets
- » Stainless Steel Roll Up Sink Cover
- » Slide-Out Awning Prep
- » WiFi Prep
- » Black Tank Flush
- » Designated CPAP Storage
- » Versa Lounge (Most Models)



27RK

	22RBS	26DBUD	27RE	27RK	29VBUD	30KQBSS	31KQBS	32BHDS	32RET	33TS	34MBS	36VBDS	37BHSS2Q
HITCH WEIGHT:	783 lb.	824 lb.	955 lb.	710 lb.	805 lb.	899 lb.	905 lb.	859 lb.	935 lb.	1088 lb.	1015 lb.	1155 lb.	970 lb.
UVW:	5743 lb.	6988 lb.	7583 lb.	7058 lb.	7397 lb.	6943 lb.	8573 lb.	7993 lb.	8853 lb.	9276 lb.	8543 lb.	8533 lb.	7659 lb.
CCC:	2040 lb.	2636 lb.	2332 lb.	2452 lb.	2208 lb.	2756 lb.	1292 lb.	1826 lb.	2282 lb.	2012 lb.	2672 lb.	1582 lb.	2271 lb.
EXTERIOR LENGTH:	27' 4"	33' 8"	33' 6"	33' 6"	36' 0"	33' 0"	36' 6"	35' 8"	36' 10"	38' 9"	38' 8"	38' 9"	39' 0"
EXTERIOR HEIGHT:	11' 3"	11' 3"	11' 5"	11' 3"	11' 3"	11' 3"	11' 5"	11' 3"	11' 5"	11' 5"	11' 5"	11' 5"	11' 3"
EXTERIOR WIDTH:	96"	96"	96"	96"	96"	96"	96"	96"	96"	96"	96"	96"	96"
FRESH WATER:	60 gal.	60 gal.	40 gal.	60 gal.	60 gal.	39 gal.	39 gal.	39 gal.	40 gal.	40 gal.	40 gal.	40 gal.	39 gal.
GRAY WATER:	64 gal.	75 gal.	57 gal.	75 gal.	66 gal.	57 gal.	54 gal.	57 gal.	57 gal.	54 gal.	57 gal.	27 gal.	30 gal.
BLACK WATER:	32 gal.	32 gal.	38 gal.	33 gal.	42 gal.	27 gal.	27 gal.	30 gal.	38 gal.	30 gal.	38 gal.	38 gal.	27 gal.
AWNING SIZE:	16'	18'	11' & 9'	20'	18'	18'	18'	18'	11' & 12'	18'	11' & 12'	18'	18'

SALEM PRODUCT FAMILY



FSX

CRUISE LITE

SALEM

VILLA / GRAND VILLA

HEMISPHERE



24/7 EMERGENCY ROADSIDE ASSISTANCE WITH VEHICLE PURCHASE*

TOWING
JUMP-STARTS
TIRE CHANGES
FLUID DELIVERY
LOCKOUT
SERVICE

WINCH-OUT
MOBILE MECHANIC
TECHNICAL
SUPPORT
DEALER LOCATOR
SERVICES



*VALID FOR 1 YEAR FROM DATE OF PURCHASE

FREE MEMBERSHIP to Forest River Owners' Group

www.forestriverfrog.com



Learn More
Scan this barcode using
a QR Reader on your
smart phone to learn
more about Forest River.



A Berkshire Hathaway company.

Specification Definitions

GVWR (Gross Vehicle Weight Rating) - is the maximum permissible weight of the unit when fully loaded. It includes all weights, inclusive of all fluids, cargo, optional equipment and accessories. For safety and product performance do NOT exceed the GVWR.

GAWR (Gross Axle Weight Rating) - is the maximum permissible weight, including cargo, fluids, optional equipment and accessories that can be safely supported by a combination of all axles.

UVW (Unloaded Vehicle Weight)* - is the typical weight of the unit as manufactured at the factory. It includes all weight at the unit's axle(s) and tongue or pin and LP Gas. The UVW does not include cargo, fresh potable water, additional optional equipment or dealer installed accessories.

*Estimated average based on standard build optional equipment.

CCC (Cargo Carrying Capacity)** - is the amount of weight available for fresh potable water, cargo, additional optional equipment and accessories. CCC is equal to GVWR minus UVW. Available CCC should accommodate fresh potable water (8.3 lbs per gallon). Before filling the fresh water tank, empty the black and gray tanks to provide for more cargo capacity.

** Estimated average based on standard build optional equipment

Each Forest River RV is weighed at the manufacturing facility prior to shipping. A label identifying the unloaded vehicle weight of the actual unit and the cargo carrying capacity is applied to every Forest River RV prior to leaving our facilities.

The load capacity of your unit is designated by weight, not by volume, so you cannot necessarily use all available space when loading your unit.

All information contained in this brochure is believed to be accurate at the time of publication. However, during the model year, it may be necessary to make revisions and Forest River, Inc., reserves the right to make all such changes without notice, including prices, colors, materials, equipment and specifications as well as the addition of new models and the discontinuance of models shown in this brochure. Therefore, please consult with your Forest River dealer and confirm the existence of any materials, design or specifications that are material to your purchase decision. Litho. U.S.A. FOR 1609 P/W: 2019.01.22

MEET YOUR SALEM DEALER

CUSTOMER SATISFACTION



www.ForestRiverBuyLocal.com



PRE-DELIVERY INSPECTION FACILITY

20,000 square feet of quality assurance. The bare essentials for a premium product. This state-of-the-art facility gives immediate daily feedback to production for quality assurance in every unit built.



NORTHWEST



NORTHWEST



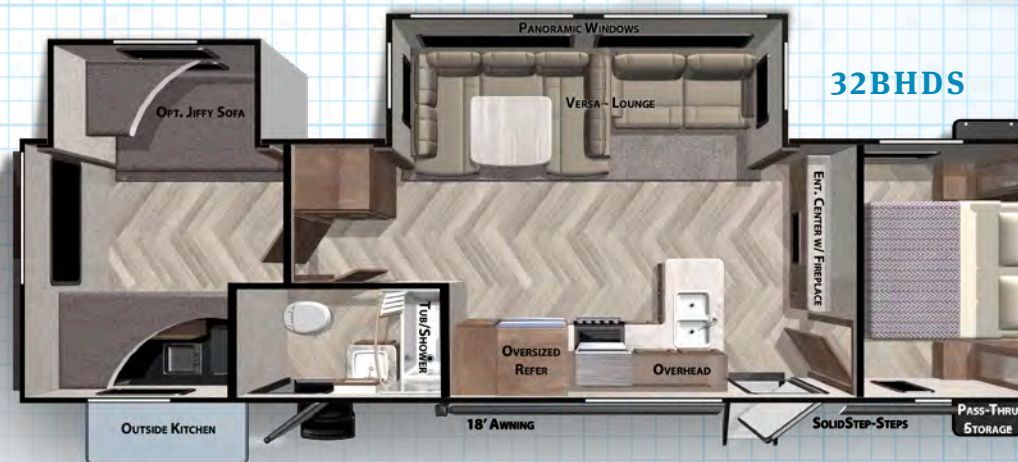
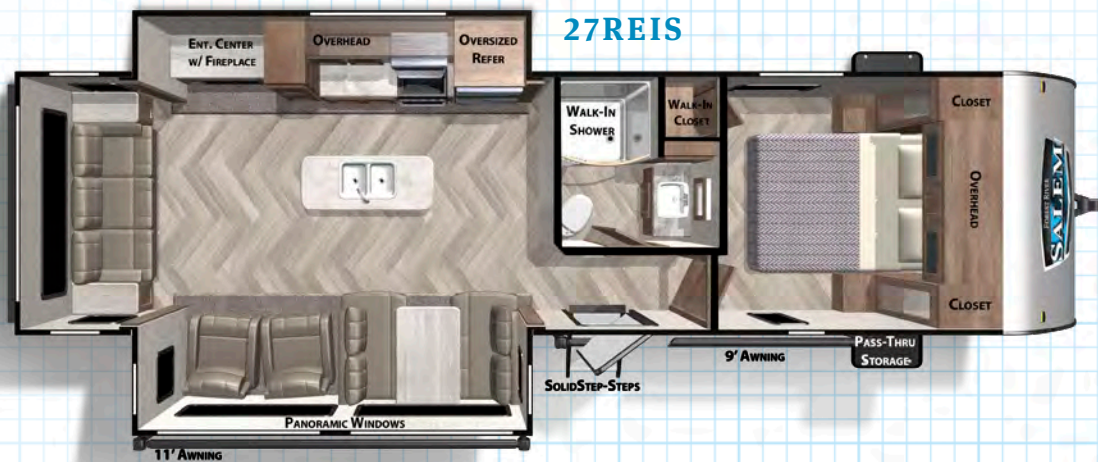
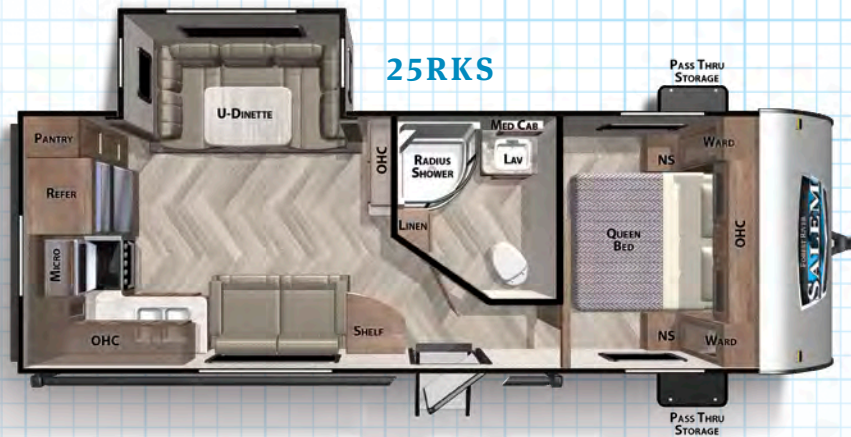
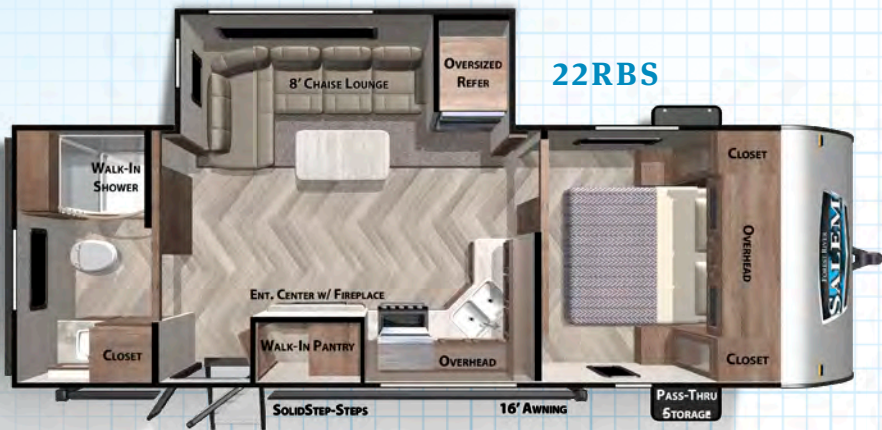



25RLS



26DBUD

For more info, pictures & 360 Tours, visit www.forestriverinc.com/Salem



26DBUD



	22RBS	25RKS	25RLS	26DBUD	27REIS	27RKSS	32BHDS
HITCH WEIGHT (LBS.):	783	578	597	824	735	860	910
UVW (LBS.):	5743	5794	5987	6988	7365	6798	8283
CCC (LBS.):	2040	1784	1610	2636	2170	2862	2787
EXT. LENGTH	27' 4"	29' 1"	30' 9"	33' 8"	34' 1"	33' 6"	36' 2"
EXT. HEIGHT W/AC	11' 2"	11' 3"	11'	11' 2"	11' 5"	11' 3"	11' 5"
EXTERIOR WIDTH	96"	96"	96"	96"	96"	96"	96"
FRESH WATER (GAL.)	61	61	61	61	61	61	61
GREY WATER (GAL.)	64	66	66	75	75	75	60
BLACK WATER (GAL.)	32	42	42	32	42	42	32
AWNING SIZE	16'	16'	12'	18'	11 & 10	16'	18'

BEST IN CLASS PACKAGE

- » Extra Large Panoramic Window Package in Main Slide
- » SolidStep Triple Step (Main Door Only)
- » Large Capacity 10.7 cu ft Stainless Steel Refrigerator (12-volt) (Optional 8 or 6 cu. ft. gas/electric)
- » Seamless Countertops w/ undermount sink (No T-Mold)
- » Modern Cloth Roller Shades w/ AutoStop
- » Stow N Go Storage (Some models)
- » Green Pkg: Furrion Solar Prep & LED Mushroom Lights
- » Power Awning w/Adjustable Legs
- » Power Tongue Jack
- » True Stabilizer Jacks w/ JT StrongArms
- » External LED strip lighting
- » ASTRO foil (Ceiling & Floor)
- » 30" Built-In Electric Fireplace (Heater) (Some models)
- » (2) Zone Residential Soundbar (Some models)
- » Friction Hinge Baggage Doors
- » Stainless Steel Roll Up Sink Cover
- » Black Tank Flush
- » Versa Lounge (Some models)
- » USB Port Package
- » Blue Tooth Stereo
- » Upgraded Pillow Top Mattress
- » Upgrade Appliance Package
- » Designer Spring Faucet

SALEM PRODUCT FAMILY



CRUISE LITE



SALEM



CLASSIC / ESTATE / GRAND VILLA



24/7 EMERGENCY ROADSIDE ASSISTANCE WITH VEHICLE PURCHASE*

TOWING
JUMP-STARTS
TIRE CHANGES
FLUID DELIVERY
LOCKOUT
SERVICE

WINCH-OUT
MOBILE MECHANIC
TECHNICAL
SUPPORT
DEALER LOCATOR
SERVICES



*VALID FOR 1 YEAR FROM DATE OF PURCHASE

FREE MEMBERSHIP to Forest River Owners' Group

www.forestriverfrog.com



Learn More
Scan this barcode using a QR Reader
on your smart phone to learn more
about Forest River.



Specification Definitions

GVWR (Gross Vehicle Weight Rating) - is the maximum permissible weight of the unit when fully loaded. It includes all weights, inclusive of all fluids, cargo, optional equipment and accessories. For safety and product performance do NOT exceed the GVWR.

GAWR (Gross Axle Weight Rating) - is the maximum permissible weight, including cargo, fluids, optional equipment and accessories that can be safely supported by a combination of all axles.

UVW (Unloaded Vehicle Weight)* - is the typical weight of the unit as manufactured at the factory. It includes all weight at the unit's axle(s) and tongue or pin and LP Gas. The UVW does not include cargo, fresh potable water, additional optional equipment or dealer installed accessories.

*Estimated average based on standard build optional equipment.

CCC (Cargo Carrying Capacity)** - is the amount of weight available for fresh potable water, cargo, additional optional equipment and accessories. CCC is equal to GVWR minus UVW. Available CCC should accommodate fresh potable water (8.3 lbs per gallon). Before filling the fresh water tank, empty the black and gray tanks to provide for more cargo capacity.

** Estimated average based on standard build optional equipment

Each Forest River RV is weighed at the manufacturing facility prior to shipping. A label identifying the unloaded vehicle weight of the actual unit and the cargo carrying capacity is applied to every Forest River RV prior to leaving our facilities.

The load capacity of your unit is designated by weight, not by volume, so you cannot necessarily use all available space when loading your unit.

All information contained in this brochure is believed to be accurate at the time of publication. However, during the model year, it may be necessary to make revisions and Forest River, Inc., reserves the right to make all such changes without notice, including prices, colors, materials, equipment and specifications as well as the addition of new models and the discontinuance of models shown in this brochure. Therefore, please consult with your Forest River dealer and confirm the existence of any materials, design or specifications that are material to your purchase decision. Litho. U.S.A. FOR 1609 P/W: 2019.01.22

MEET YOUR SALEM DEALER

CUSTOMER SATISFACTION



PRE-DELIVERY INSPECTION FACILITY

20,000 square feet of quality assurance. The bare essentials for a premium product. This state-of-the-art facility gives immediate daily feedback to production for quality assurance in every unit built.

www.ForestRiverBuyLocal.com

SALEM TRAVEL TRAILERS

FOREST RIVER
SALEM



WHERE AFFORDABILITY AND LUXURY MEET

Salem Travel Trailers





27RE

INTERIOR COLORS & EQUIPMENT MAY VARY



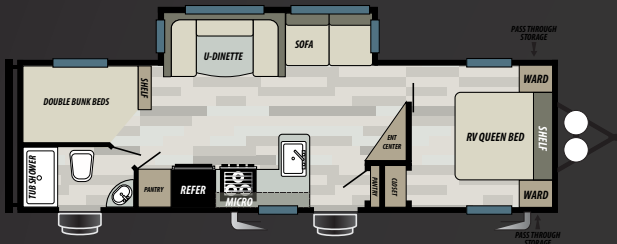

26DBUD

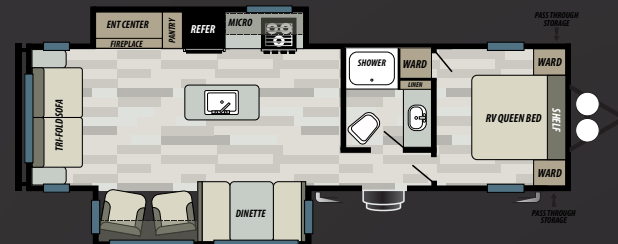

27RE

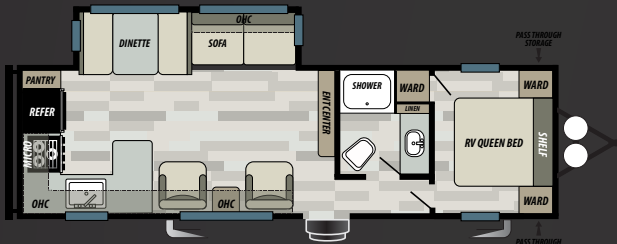

27RKS

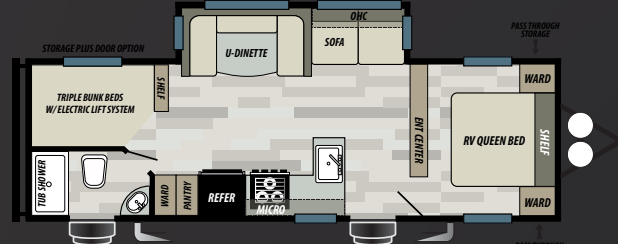

27TDSS

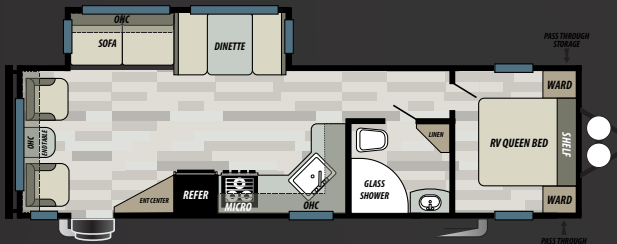

28RLSS

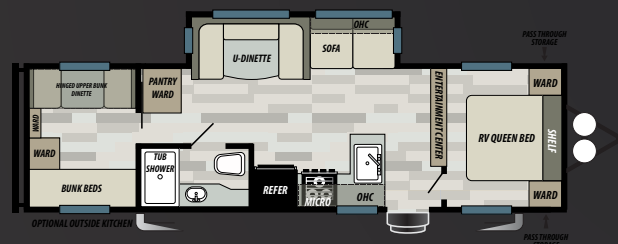

30QBSS

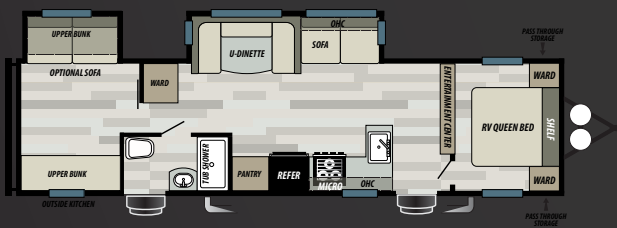

32BHDS

	26DBUD	27RE	27RKS	27TDSS	28RLSS	30QBSS	32BHDS
HITCH WEIGHT (LBS.)	866	877	836	806	844	817	931
GROSS VEHICLE WEIGHT RATING (LBS.)	9999	9999	9999	9980	9999	9985	9999
UNLOADED VEHICLE WEIGHT (LBS.)	7258	7965	7154	6662	7048	7145	8403
CARGO CARRYING CAPACITY (LBS.)	2741	1996	2845	3318	2913	2840	1596
EXTERIOR LENGTH (FT.)	33' 1"	34' 1"	33' 6"	32'	34' 9"	33' 10"	36' 4"
EXTERIOR HEIGHT (FT.)	11' 3"	11' 3"	11' 2"	11' 2"	11' 3"	11' 3"	11' 3"
FRESH WATER (GAL.)	56	56	56	56	56	56	56
GREY WATER (GAL.)	75	60	65	75	80	60	58
BLACK WATER (GAL.)	40	30	28	40	35	30	30
TIRE SIZE (IN.)	15	15	15	15	15	15	15

Standards & Options

CONSTRUCTION AND EXTERIOR

- 5/8 TONGUE AND GROOVE FLOOR DECKING
- FULL WALK ON SEAMLESS PVC ROOF WITH A 15 YEAR MANUFACTURER DEFECT WARRANTY
- EXTRA-LARGE FULL PASS THROUGH STORAGE (PER FP)
- MILDEW RESISTANT VINYL PATIO AWNING
- SAFETY GLASS WINDOWS
- POWDER COATED I-BEAM FRAME
- CAMBERED CHASSIS
- GAS/ELECTRIC QUICK RECOVERY DSI WATER HEATER
- WATER HEATER BYPASS
- 2" WALL CONSTRUCTION, 16"(OR LESS) ON CENTER
- TRIPLE SEAL SLIDE OUT SYSTEM
- FLUSH FLOOR ELECTRIC SLIDE OUT
- SWING ARM ENTRY ASSIST HANDLE
- TWO MARINE GRADE EXTERIOR SPEAKERS
- AERODYNAMIC FRONT RADIUS PROFILE
- SMOOTH .40 MIL ALUMINUM FRONT WRAP
- EASY LUBE AXLES W/ SELF ADJUSTING BRAKES
- ONE PIECE SLIP RESISTANT VINYL FLOOR
- R-7 FIBERGLASS INSULATION THROUGHOUT
- TEXTURED ROCKGAURD
- HURRICANE STRAPS
- LP QUICK DISCONNECT
- 1 1/4" RECEIVER
- 7 WAY CORD HOLSTER

KITCHEN

- NEW SHAKER STYLE CABINET DOORS
- HIDDEN HINGES THROUGHOUT
- DOUBLE DOOR REFER (2YR WARRANTY)
- HIGH RISE SPRING FAUCET
- RESIDENTIAL STYLE UNDER MOUNT KITCHEN SINK
- 3-BURNER, HIGH OUTPUT RANGE WITH OVEN (2YR WARRANTY)
- FULL EXTENSION BALL BEARING DRAWER GUIDES
- SHELVING IN OVERHEAD CABINETS IN THE KITCHEN
- LARGE POTS AND PANS STORAGE UNDER DINETTE (PER FP)
- HIGH DEFINITION COUNTERTOPS

LIVING ROOM

- 80" INTERIOR HEIGHT
- DUCTED 15 K A/C ROOF AIR CONDITIONER
- HUGE STORAGE DRAWER UNDER JIFFY SOFA
- LARGE DINETTE PICTURE WINDOW
- DIGITAL ANTENNA WITH BOOSTER
- BLUETOOTH FM STEREO
- 30K BTU SUBURBAN FORCED AIR DSI FURNACE W/ DIGITAL THERMOSTAT (2 YR WARRANTY)
- IN-FLOOR DUCTED HEAT
- CABLE TV HOOKUP LIVING ROOM AND BEDROOM

BEDROOM

- NEW UPGRADED MATTRESS WITH PILLOW TOP IN MASTER BED
- STRUT LIFTED STORAGE AREA UNDER BED
- BEDSIDE 110-VOLT POWER OUTLETS (2)
- BEDSIDE USB CHARGERS (2)
- SOLID BEDROOM PRIVACY DOOR (PER FP)
- BEDSIDE HAMPER ACCESS (PER FP)

BATHROOM

- 12-VOLT POWER BATH ROOF EXHAUST FAN
- FOOT FLUSH TOILET
- HIGH DEFINITION COUNTERTOPS

SECURITY AND SAFETY

- LP LEAK DETECTOR
- SMOKE DETECTOR
- CARBON MONOXIDE DETECTOR
- FIRE EXTINGUISHER
- WELDED HEAVY DUTY SAFETY CHAINS
- ELECTRIC FULL SELF-ADJUSTING BRAKES
- GFI RECEPTACLES
- ANSI 119.2 CERTIFIED
- MEETS ALL NATIONAL HIGHWAY ADMINISTRATION SPECS
- RVIA APPROVED PRODUCT



CRUISE LITE



263BHXL
INTERIOR COLORS & EQUIPMENT MAY VARY

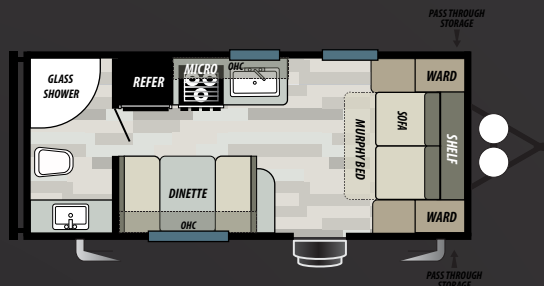

190RBXL

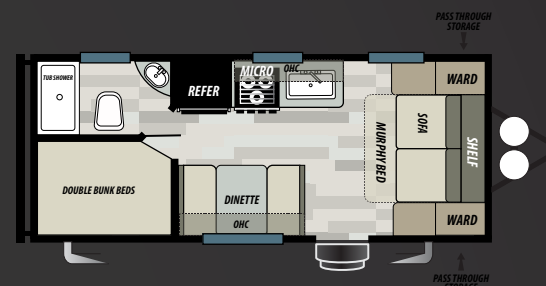

201BHXL

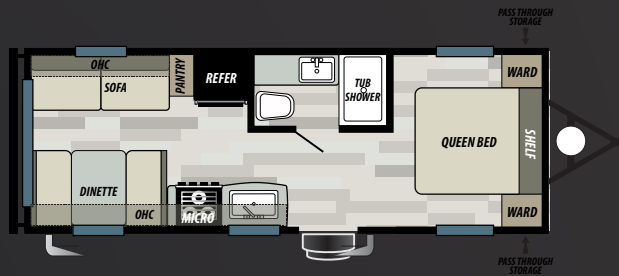

202RDXL

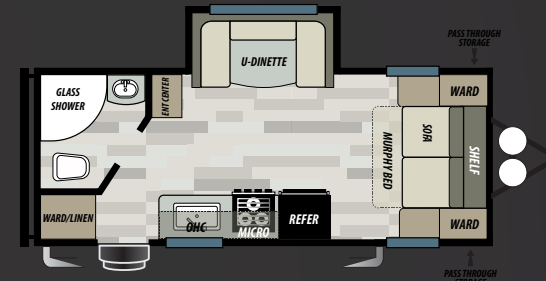

212RBXL

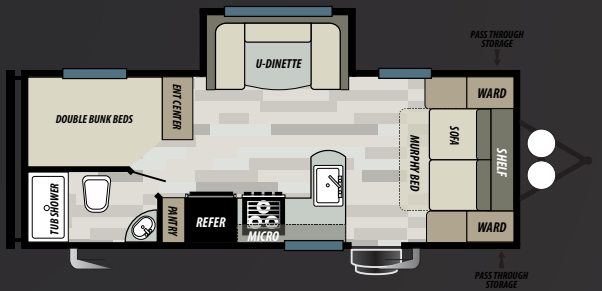

221BHXL

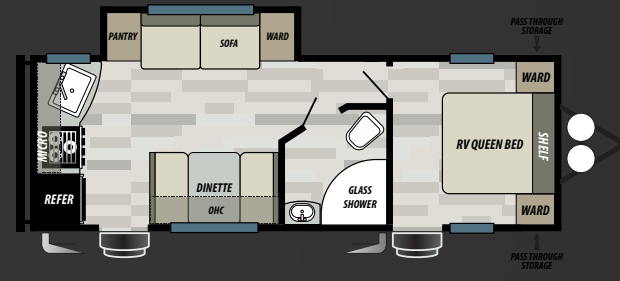

231RKXL

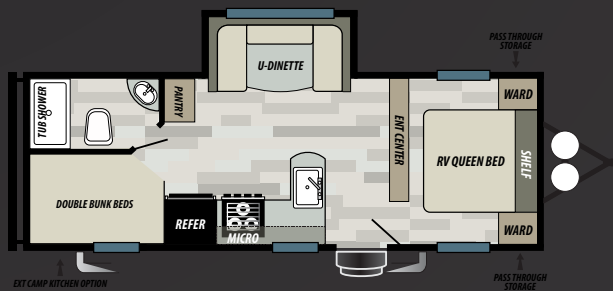

241BHXL

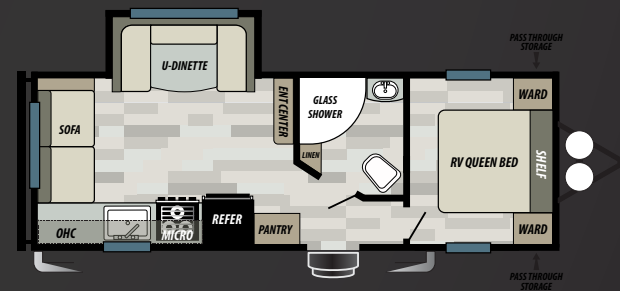

241RLXL

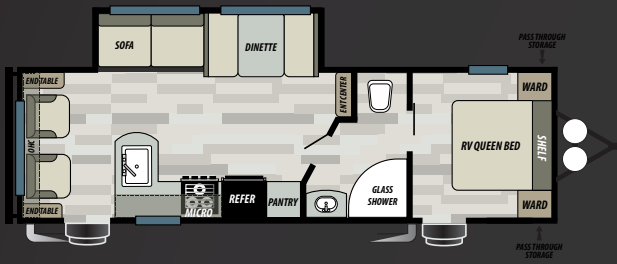

254RLXL

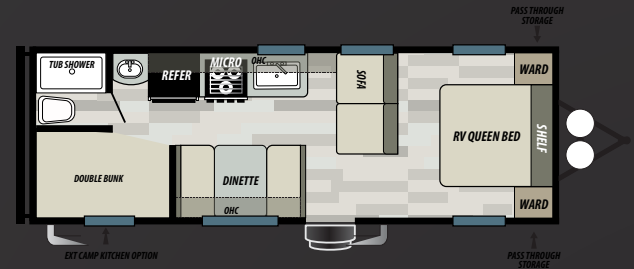

261BHLX

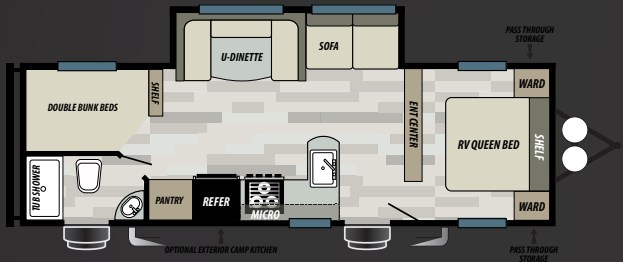

263BHLX

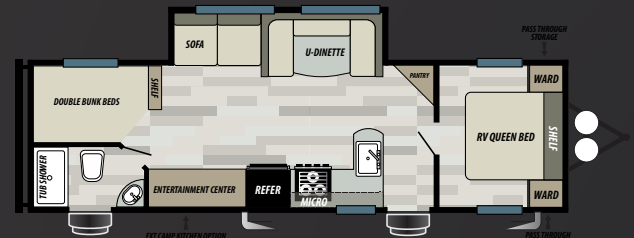

271BHLX

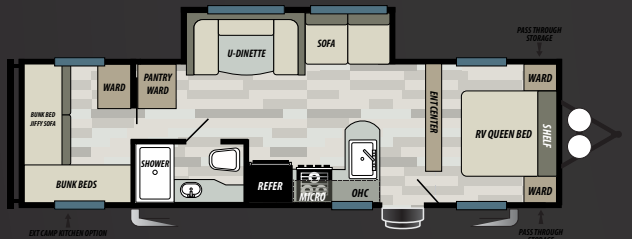

273QBXL

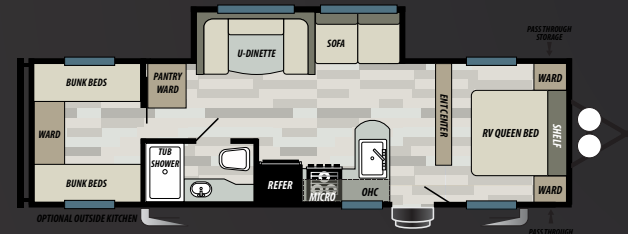

282QBXL



Selects

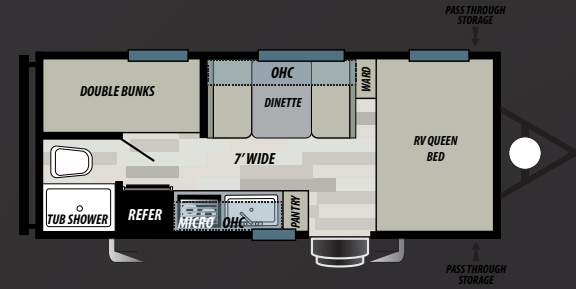

177BQ

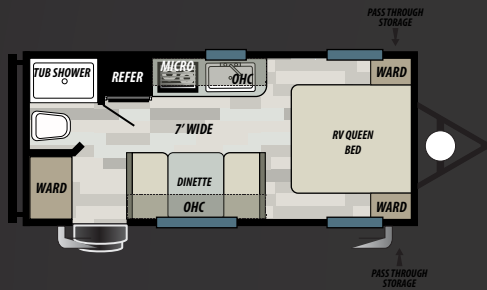

177FQ

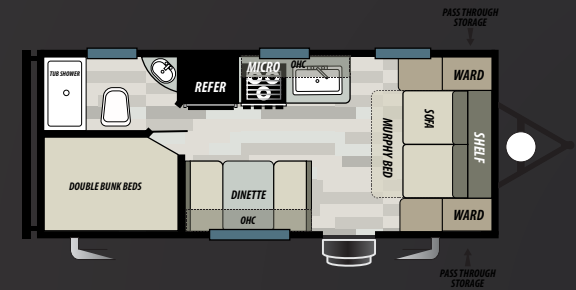

178DB

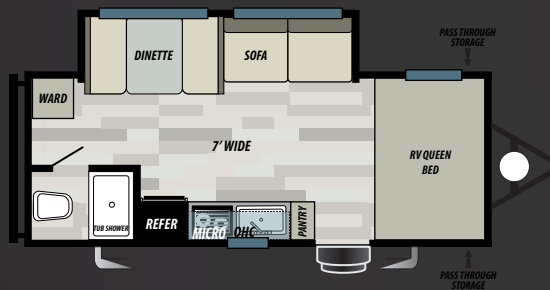

197SS

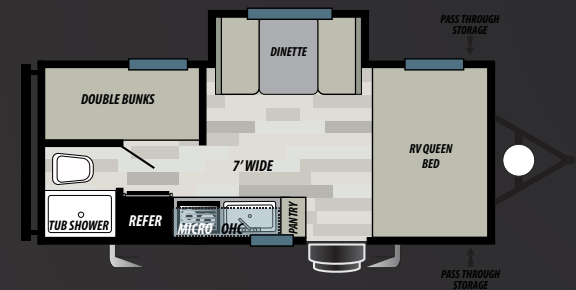

207BH

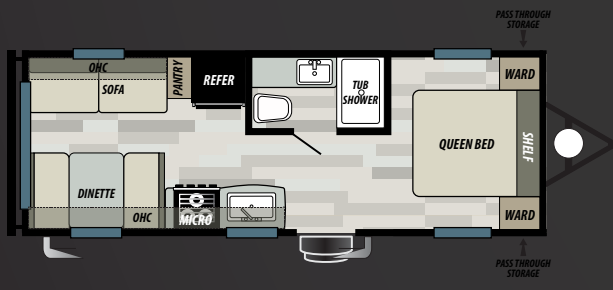

208RD

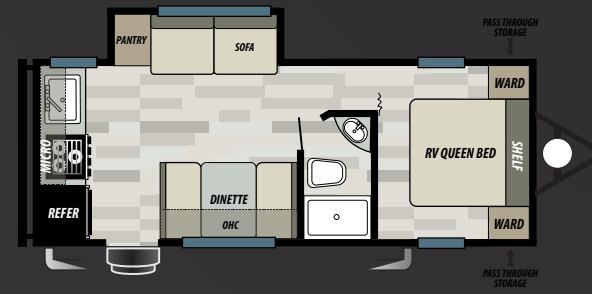

228RK

Standards & Options

STANDARD FEATURES

- NEW 6-WAY ADJUSTABLE HIDDEN HINGES
- STAINLESS STEEL SINGLE POLE FAUCET
- AERODYNAMIC FRONT PROFILE
- SHAKER STYLE CABINET DOORS
- NEW 3 BURNER COOK TOP
- 13.5K A/C
- TEXTURED ROCK GUARD
- NEW LP QUICK CONNECT
- NEW DOUBLE DOOR GAS & ELECTRIC REFER
- NEW RESIDENTIAL SINGLE BOWL SINK
- MICROWAVE WITH CAROUSEL
- AWNING
- 6 GAL GAS DSI WATER HEATER
- 1-20LB LP BOTTLE
- AUTO IGNITION 20K BTU FURNACE
- NEW EXTERIOR TV HOOK UP
- MINI-BLINDS THROUGHOUT
- NEW TEDDY BEAR BUNK MATS (PER F/P)
- WATER HEATER BY-PASS
- FULL WALK ON SEAMLESS ROOF WITH A 15 YEAR MANUFACTURER DEFECT WARRANTY
- KITCHEN DRAWER W/BALL BEARING GUIDES
- HIGH DEFINITION COUNTERTOPS
- 78" INTERIOR HEIGHT
- E-Z LUBE AXLES W/SELF-ADJUSTING BRAKES

POPULAR OPTIONS

- POWER AWNING W/ ADJUSTABLE LEGS
- BLUETOOTH STEREO WITH REMOTE
- BACKUP CAMERA PREP
- SOLAR PREP
- NEW USB PORTS
- SPARE TIRE AND CARRIER
- SKYLIGHT OVER TUB
- POWER TONGUE JACK
- STABILIZER JACKS (2 OR 4)

	177BQ	177FQ	178DB	197SS	207BH	208RD	228RK	267SS	268BH
HITCH WEIGHT (LBS.)	445	430	485	495	470	565	550	655	545
GROSS VEHICLE WEIGHT RATING (LBS.)	4845	4830	5585	5595	4870	7565	7550	8455	7545
UNLOADED VEHICLE WEIGHT (LBS.)	3374	3334	4033	4113	3728	4235	4708	5280	4559
CARGO CARRYING CAPACITY (LBS.)	1471	1496	1552	1482	1142	3292	2842	3175	2986
EXTERIOR LENGTH (FT.)	22' 8"	22' 8"	24'	24' 2"	22' 11"	25' 10"	26' 3"	31'	28' 8"
EXTERIOR HEIGHT (FT.)	10' 3"	10' 3"	10' 3"	10' 5"	10' 5"	10' 5"	10' 5"	10' 9"	10' 5"
FRESH WATER (GAL.)	48	48	48	48	48	48	48	48	48
GREY WATER (GAL.)	22	22	28	22	22	30	52	28	28
BLACK WATER (GAL.)	22	22	30	22	22	30	28	22	30
TIRE SIZE (IN.)	15	15	15	15	15	15	15	15	15

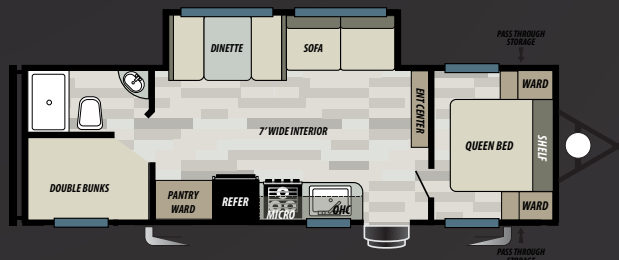

267SS

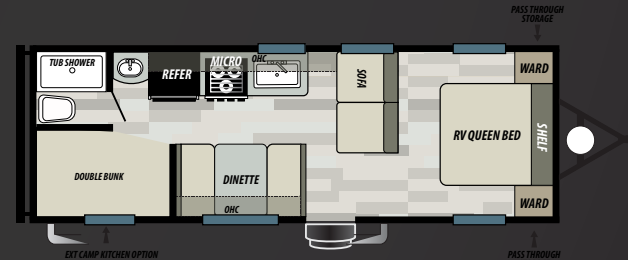

268BH

FOREST RIVER SALEM

CRUISE LITE

SELECT

FREE MEMBERSHIP
to Forest River Owners' Group

www.forestriverfrog.com



Learn More
Scan this barcode using
a QR Reader on your
smart phone to learn
more about Forest River.



A Berkshire Hathaway company.

FOREST RIVER INC., 255 S PEPPER AVE RIALTO, CA 92376 | (909) 873-3777
WWW.FORESTRIVERINC.COM/SALEM | WWW.FORESTRIVERACCESSORIES.COM
EFFECTIVE FOR UNITS PRODUCED STARTING SEPTEMBER 1ST, 2019

CUSTOMER SATISFACTION



www.ForestRiverBuyLocal.com

YOUR SALEM DEALER

Specification Definitions

GVWR (Gross Vehicle Weight Rating) - is the maximum permissible weight of the unit when fully loaded. It includes all weights, inclusive of all fluids, cargo, optional equipment and accessories. For safety and product performance do NOT exceed the GVWR.

GAWR (Gross Axle Weight Rating) - is the maximum permissible weight, including cargo, fluids, optional equipment and accessories that can be safely supported by a combination of all axles.

UVW (Unloaded Vehicle Weight)* - is the typical weight of the unit as manufactured at the factory. It includes all weight at the unit's axle(s) and tongue or pin and LP Gas. The UVW does not include cargo, fresh potable water, additional optional equipment or dealer installed accessories.

*Estimated average based on standard build optional equipment.

CCC (Cargo Carrying Capacity)** - is the amount of weight available for fresh potable water, cargo, additional optional equipment and accessories. CCC is equal to GVWR minus UVW. Available CCC should accommodate fresh potable water (8.3 lbs per gallon). Before filling the fresh water tank, empty the black and gray tanks to provide for more cargo capacity. ** Estimated average based on standard build optional equipment

Each Forest River RV is weighed at the manufacturing facility prior to shipping. A label identifying the unloaded vehicle weight of the actual unit and the cargo carrying capacity is applied to every Forest River RV prior to leaving our facilities. The load capacity of your unit is designated by weight, not by volume, so you cannot necessarily use all available space when loading your unit.

All information contained in this brochure is believed to be accurate at the time of publication. However, during the model year, it may be necessary to make revisions and Forest River, Inc., reserves the right to make all such changes without notice, including prices, colors, materials, equipment and specifications as well as the addition of new models and the discontinuance of models shown in this brochure. Therefore, please consult with your Forest River dealer and confirm the existence of any materials, design or specifications that are material to your purchase decision. Litho. U.S.A. FOR 1420 P/W: 2019.3.1