

TIMBERWOLF

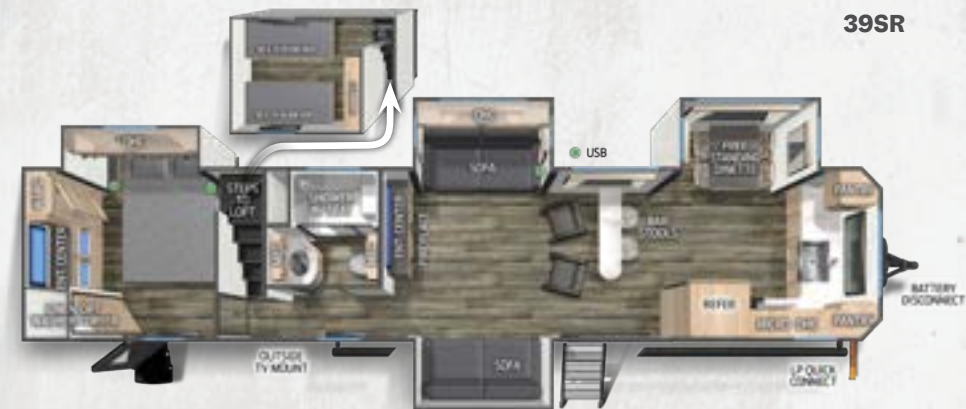

JOIN THE PACK.
DESTINATION TRAILER MODELS

TIMBERWOLF



	T39CA	T39DL	T39LB	T39NA	T39SR
Dry Hitch Weight	1230-LBS.	1095-LBS.	1335-LBS.	TBD	1650-LBS.
Ship Weight	10485-LBS.	10740-LBS.	10650-LBS.	TBD	11323-LBS.
Unloaded Vehicle Weight	10523-LBS.	10778-LBS.	10688-LBS.	TBD	11361-LBS.
Cargo Carrying Capacity	2707-LBS.	2317-LBS.	2647-LBS.	TBD	2289-LBS.
Axle Weight	9255-LBS.	9645-LBS.	9315-LBS.	TBD	9673-LBS.
Exterior Length	42'-4"	42'-8"	42'-11"	TBD	42'-11"
Exterior Height w/A/C	13'-4"	13'-4"	13'-4"	TBD	13'-4"
Exterior Width	97"	97"	97"	96"	97"
Grey Capacity	76-GAL	38-GAL	38-GAL	38-GAL	38-GAL
Black Capacity	66-GAL	38-GAL	38-GAL	38-GAL	38-GAL
Fresh Capacity	40-GAL	40-GAL	40-GAL	40 GAL	40-GAL

BLACK LABEL

The Timberwolf is proud to offer the Black Label Edition as an optional upgrade to the brand. The Black Label Edition includes all the regular standard Timberwolf features along these additional highlights shown below.



TIMBERWOLF BLACK LABEL EDITION EXTERIOR

Gel Coated Fiberglass, Power Tongue Jack, Aluminum Rims



Automotive Frameless Windows Package



Hands Free Baggage Door Catch



LG Solid Surface Countertop



Deep Stainless Steel Sink



Residential Pullout Faucet



Pillowtop Mattress



Thermo-Foil Arctic Insulation



Solid Wood Cabinet Doors



Designer Fabric



Reading Lights



Upgraded Shower Head



Upgraded Bedspread



Battery Minder



Battery Disconnect

* Optional. Not all items available on all models. See participating dealers for details.

Limited Package

- Upgraded Kitchen Appliance Package
- Extra Large Shower with Full Surround
- Fireplace
- Cherokee Total Control App & Remote Control System
- Detachable Power Cord
- LED Strip Lighting
- Light Filtering Sheer Shading Premium Zebra Blinds
- External LED Strip Lighting
- Premium Bedding Ensemble & Comforter
- LED Interior Lights
- Tire Pressure Monitors
- Power Gear Frame Technology
- Power Awning
- Cherokee Exclusive Stable Step with Oversized landing
- Supersized, Central Air Conditioning Unit (15,000 BTU)

- with Quick Cool Air Dump Feature
- Residential Undermount Kitchen Sink
- Seamless Roofing Membrane with Heat reflectivity
- USB Charging Stations
- Exclusive Solar Thermo Controlled Reflective Tinted Safety Glass Windows

XL Package

- Large Exterior Folding Assist Grab Handle
- On Demand Tankless Water Heater
- High Output Attic Fan in Bathroom
- Night Shades
- Outside Shower with Hot and Cold Water
- RV Grill Quick Connect
- Sky Light Over Tub

Standard Features

- Bluetooth Radio
- Real Blackout Glass, Safety Slam Friction Hinge Entry Door with Window & Shade Prep
- Interior & Exterior Ghost Lights
- External Porch Scare Light
- Cherokee Backup Camera System
- Ladder Prep
- Outside TV Bracket & Hookups
- 2nd 15,000 BTU Air Conditioning Unit



PRE-DELIVERY INSPECTION FACILITY

20,000 square feet of quality assurance. The bare essentials for a premium product. This state-of-the-art facility gives immediate daily feedback to production for quality assurance in every unit built.



Learn More
Scan this barcode using a QR Reader on your smart phone to learn more about Forest River.



A Berkshire Hathaway company.



www.forestriverfrog.com

CUSTOMER SATISFACTION



www.ForestRiverBuyLocal.com

YOUR TIMBERWOLF DEALER



24/7 EMERGENCY ROADSIDE ASSISTANCE WITH VEHICLE PURCHASE*

- | | |
|----------------|-----------------|
| TOWING | WINCH-OUT |
| JUMP-STARTS | MOBILE MECHANIC |
| TIRE CHANGES | TECHNICAL |
| FLUID DELIVERY | SUPPORT |
| LOCKOUT | DEALER LOCATOR |
| SERVICE | SERVICES |



*VALID FOR 1 YEAR FROM DATE OF PURCHASE

Specification Definitions

UVW (Unloaded Vehicle Weight)* - is the typical weight of the unit as manufactured at the factory. It includes all weight at the unit's axle(s) and tongue or pin and LP Gas. The UVW does not include cargo, fresh potable water, additional optional equipment or dealer installed accessories.

*Estimated average based on standard build optional equipment.

CCC (Cargo Carrying Capacity)** - is the amount of weight available for fresh potable water, cargo, additional optional equipment and accessories. CCC is equal to GVWR minus UVW. Available CCC should accommodate fresh potable water (8.3 lbs per gallon). Before filling the fresh water tank, empty the black and gray tanks to provide for more cargo capacity.

** Estimated average based on standard build optional equipment

Each Forest River RV is weighed at the manufacturing facility prior to shipping. A label identifying the unloaded vehicle weight of the actual unit and the cargo carrying capacity is applied to every Forest River RV prior to leaving our facilities.

The load capacity of your unit is designated by weight, not by volume, so you cannot necessarily use all available space when loading your unit.

All information contained in this brochure is believed to be accurate at the time of publication. However, during the model year, it may be necessary to make revisions and Forest River, Inc., reserves the right to make all such changes without notice, including prices, colors, materials, equipment and specifications as well as the addition of new models and the discontinuance of models shown in this brochure. Therefore, please consult with your Forest River, Inc., dealer and confirm the existence of any materials, design or specifications that are material to your purchase decision. Litho. U.S.A. FOR 2155 P/W: 2022.12.13