



**2022 Salem Cruise Lite Midwest\***  
**2020 Northwest**  
**2020 West**

\*2022 Midwest is the most up-to-date brochure available





2022 CRUISE LITE TRAVEL TRAILERS





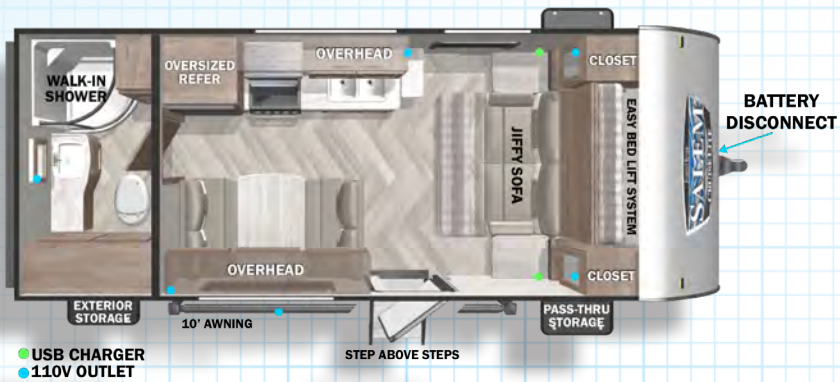

**MODEL #: 171RBXL UVW: 3,836 LBS LENGTH: 22'8"**

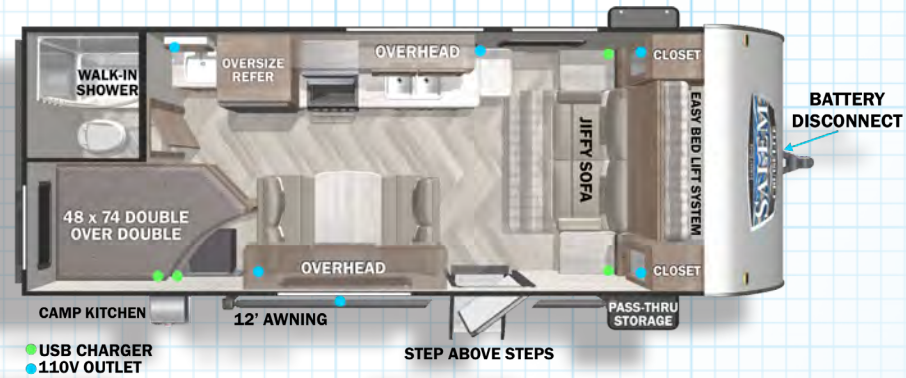

**MODEL #: 19DBXL UVW: 4,483 LBS LENGTH: 24'8"**

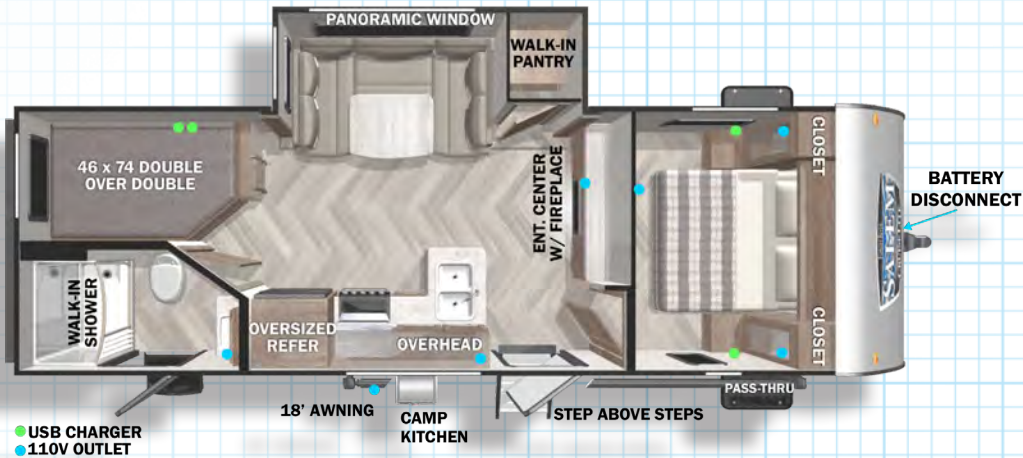

**MODEL #: 240BHXL UVW: 5,343 LBS LENGTH: 28'10"**

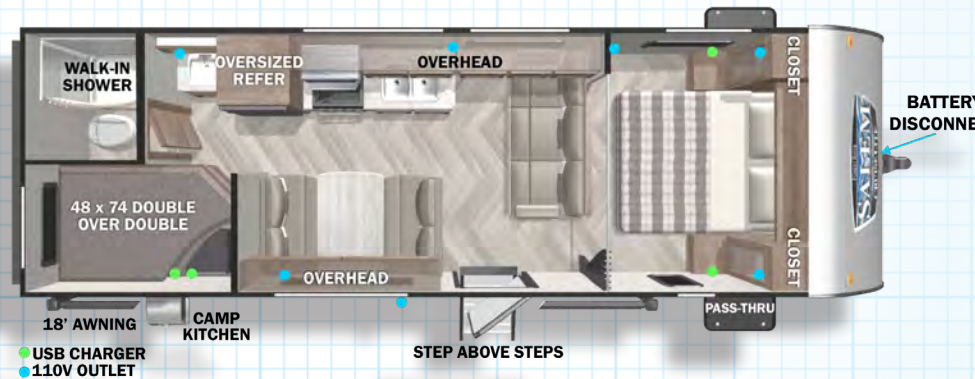

**MODEL #: 261BHXL UVW: 4,818 LBS LENGTH: 28'8"**

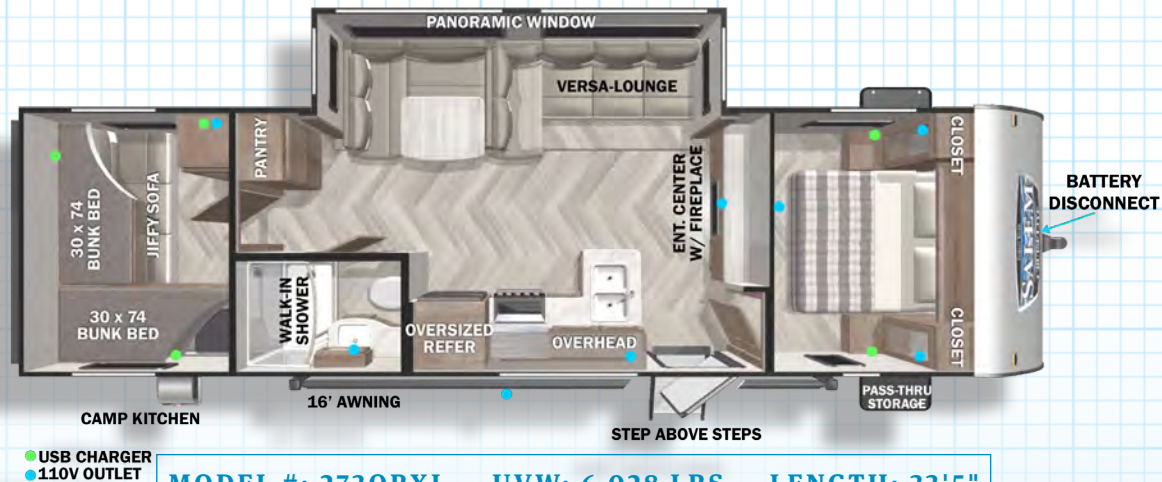

**MODEL #: 273QBXL UVW: 6,028 LBS LENGTH: 33'5"**



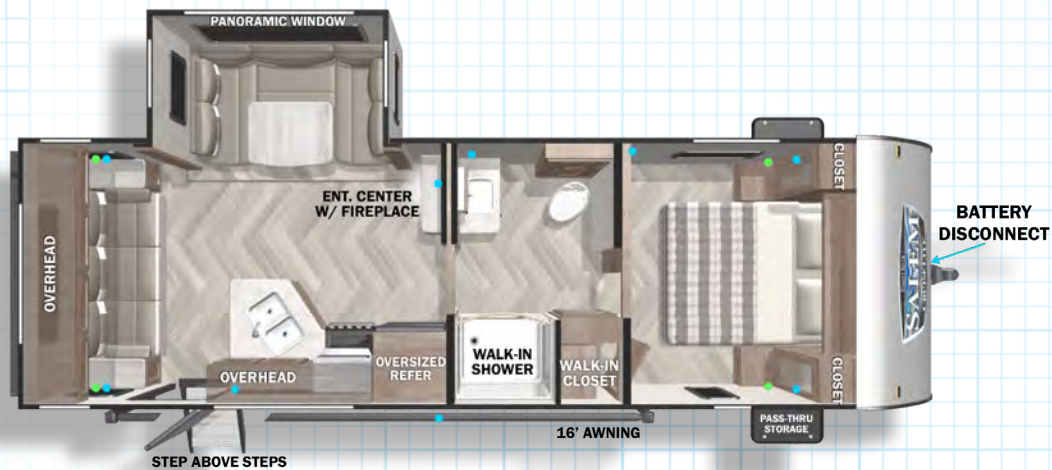

- USB CHARGER
- 110V OUTLET

**MODEL #: 24RLXL UVW: 5,063 LBS LENGTH: 28'11"**

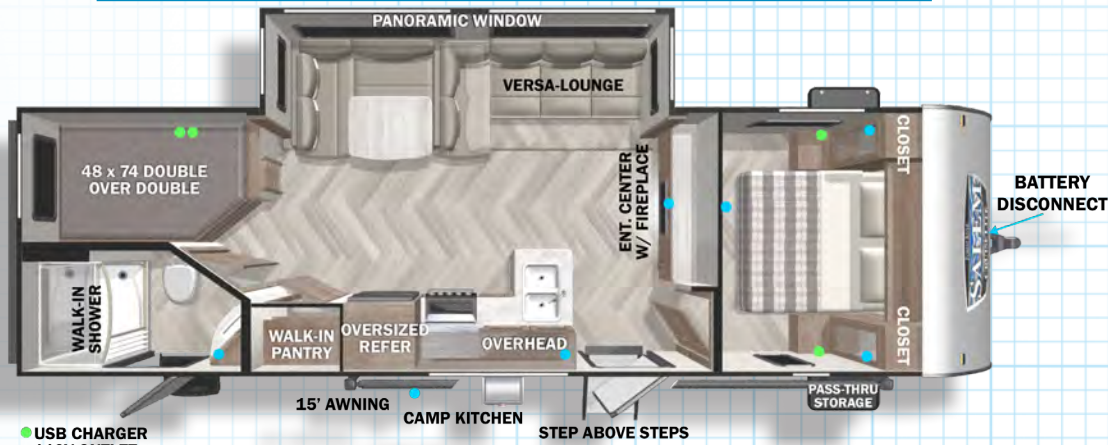

- USB CHARGER
- 110V OUTLET

**MODEL #: 263BHXL UVW: 5,854 LBS LENGTH: 31'9"**

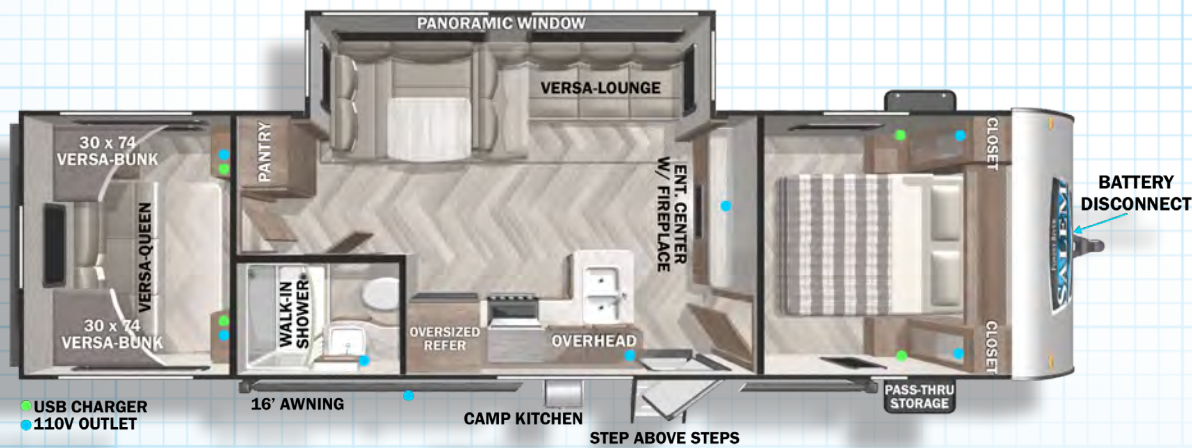

- USB CHARGER
- 110V OUTLET

**MODEL #: 28VBXL UVW: 6,208 LBS LENGTH: 33'2"**



For detailed specifications, pictures & 360 Tours, visit [www.forestriverinc.com/Salem](http://www.forestriverinc.com/Salem)

OR

Scan the QR code!

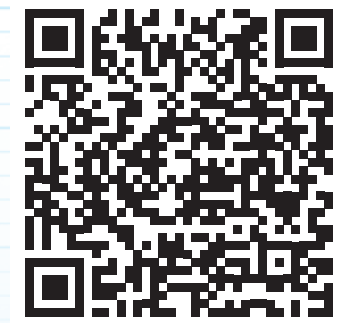



# SALEM PRODUCT FAMILY



FSX

CRUISE LITE

SALEM

VILLA / GRAND VILLA

HEMISPHERE



## 24/7 EMERGENCY ROADSIDE ASSISTANCE WITH VEHICLE PURCHASE\*

TOWING  
JUMP-STARTS  
TIRE CHANGES  
FLUID DELIVERY  
LOCKOUT  
SERVICE

WINCH-OUT  
MOBILE MECHANIC  
TECHNICAL  
SUPPORT  
DEALER LOCATOR  
SERVICES



\*VALID FOR 1 YEAR FROM DATE OF PURCHASE

## FREE MEMBERSHIP to Forest River Owners' Group

[www.forestriverfrog.com](http://www.forestriverfrog.com)



**Learn More**  
Scan this barcode using  
a QR Reader on your  
smart phone to learn  
more about Forest River.



A Berkshire Hathaway company.

### Specification Definitions

**GVWR (Gross Vehicle Weight Rating)** - is the maximum permissible weight of the unit when fully loaded. It includes all weights, inclusive of all fluids, cargo, optional equipment and accessories. For safety and product performance do NOT exceed the GVWR.

**GAWR (Gross Axle Weight Rating)** - is the maximum permissible weight, including cargo, fluids, optional equipment and accessories that can be safely supported by a combination of all axles.

**UVW (Unloaded Vehicle Weight)\*** - is the typical weight of the unit as manufactured at the factory. It includes all weight at the unit's axle(s) and tongue or pin and LP Gas. The UVW does not include cargo, fresh potable water, additional optional equipment or dealer installed accessories.

\*Estimated average based on standard build optional equipment.

**CCC (Cargo Carrying Capacity)\*\*** - is the amount of weight available for fresh potable water, cargo, additional optional equipment and accessories. CCC is equal to GVWR minus UVW. Available CCC should accommodate fresh potable water (8.3 lbs per gallon). Before filling the fresh water tank, empty the black and gray tanks to provide for more cargo capacity.

\*\* Estimated average based on standard build optional equipment

Each Forest River RV is weighed at the manufacturing facility prior to shipping. A label identifying the unloaded vehicle weight of the actual unit and the cargo carrying capacity is applied to every Forest River RV prior to leaving our facilities.

The load capacity of your unit is designated by weight, not by volume, so you cannot necessarily use all available space when loading your unit.

All information contained in this brochure is believed to be accurate at the time of publication. However, during the model year, it may be necessary to make revisions and Forest River, Inc., reserves the right to make all such changes without notice, including prices, colors, materials, equipment and specifications as well as the addition of new models and the discontinuance of models shown in this brochure. Therefore, please consult with your Forest River dealer and confirm the existence of any materials, design or specifications that are material to your purchase decision. Litho. U.S.A. FOR 1609 P/W: 2019.01.22

### MEET YOUR CRUISE LITE DEALER

### CUSTOMER SATISFACTION



[www.ForestRiverBuyLocal.com](http://www.ForestRiverBuyLocal.com)

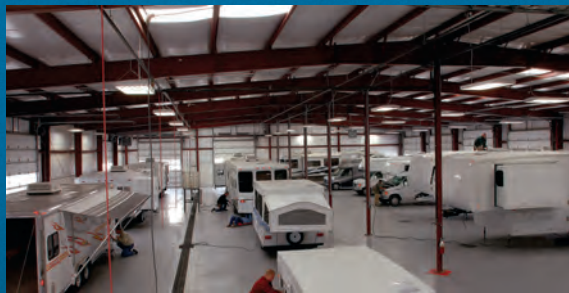

### PRE-DELIVERY INSPECTION FACILITY

20,000 square feet of quality assurance. The bare essentials for a premium product. This state-of-the-art facility gives immediate daily feedback to production for quality assurance in every unit built.





NORTHWEST



NORTHWEST





171RBXL



210RBXL

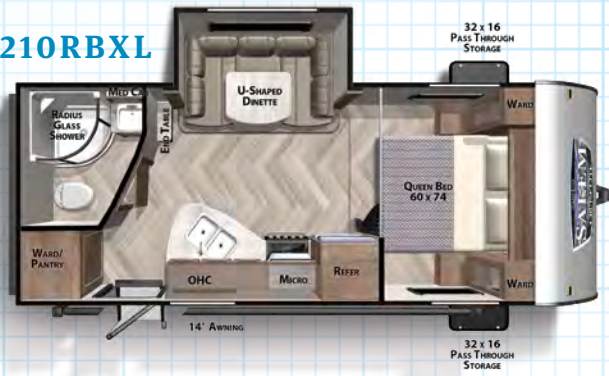

220BHXL



243BHXL

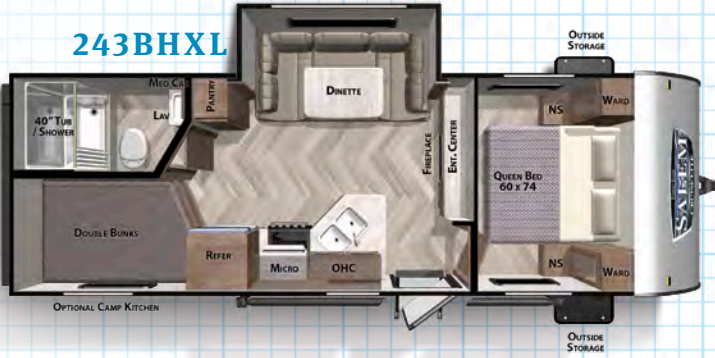

254RLXL



261BHXL



263BHXL

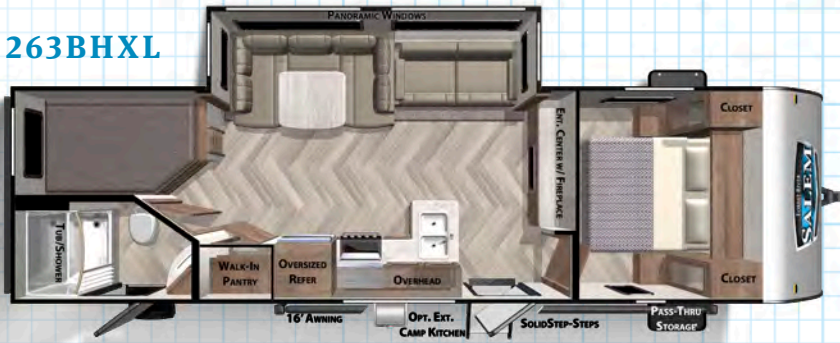

273QBXL



211SSXL

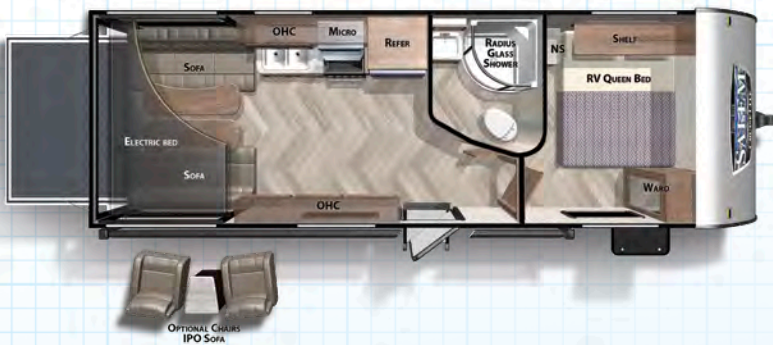

251SSXL

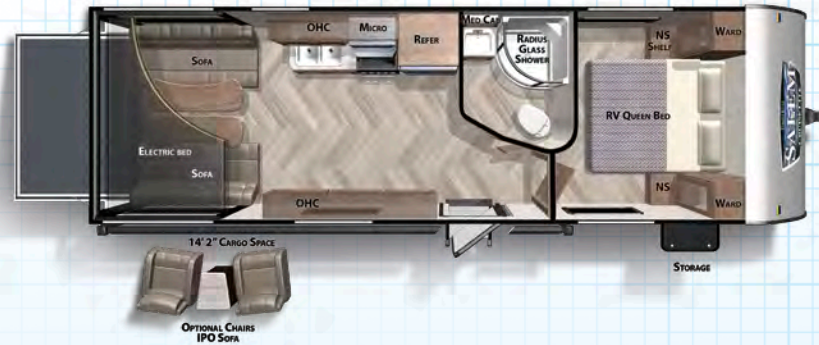



## 233RBXL

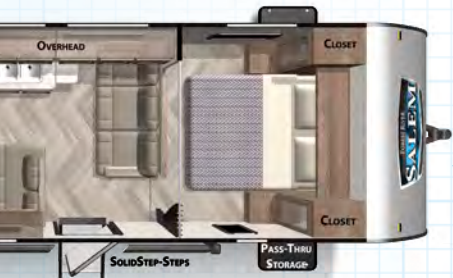

For more info, pictures  
& 360 Tours, visit  
[www.forestriverinc.com/Salem](http://www.forestriverinc.com/Salem)

## 282QBXL



## 260RT

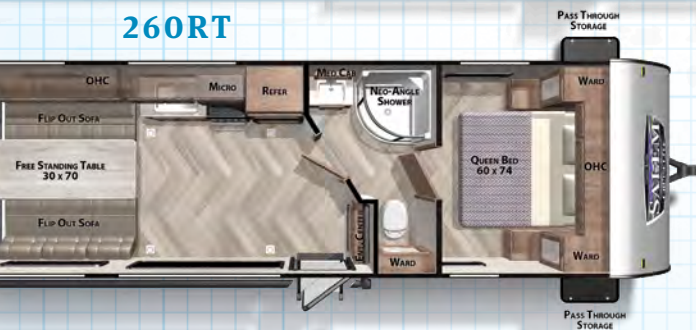

## BEST IN CLASS PACKAGE

- » SolidStep Double Step (Main Door Only)
- » Exterior LED Light Strip Under Awning
- » Modern Cloth Roller Shades w/ AutoStop
- » Green Pkg: Furion Solar Prep & LED Mushroom Lights
- » Power Awning w/Adjustable Legs
- » True Stabilizer Jacks w/ JT StrongArms
- » Power Tongue Jack
- » Stainless Steel Roll Up Sink Cover
- » Friction Hinge Baggage Doors
- » Large Capacity 10.7 cu ft Stainless Steel Refrigerator (12-volt) (Optional 8 or 6 cu. ft. gas/electric)
- » Black Tank Flush
- » Seamless Countertops (No T-Mold)
- » Stow N Go Storage (Bed & Dinette)
- » Updated Appliance Package
- » Electric Fireplace (N/A all models)
- » USB Port Package; Blue Tooth Stereo
- » Extra Large Panoramic Windows (On main slide)



## 263BHXL

	171RBXL	210RBXL	220BHXL	233RBXL	243BHXL	254RLXL	261BHXL	263BHXL	273QBXL	282QBXL	211SSXL	251SSXL	260RT
HITCH WEIGHT (LBS.):	522	500	602	596	566	630	499	736	752	768	740	746	650
UVW (LBS.):	4092	4830	4800	5278	5492	5793	5025	6406	6550	6564	5262	5664	5276
CCC (LBS.):	3430	2670	2802	2318	2074	1837	2474	1330	2002	2004	3278	2882	3174
EXT. LENGTH	23' 0"	25' 2"	27' 8"	26' 3"	28' 2"	30' 8"	28' 7"	31' 11"	33' 8"	33' 4"	27' 5"	29' 5"	28' 8"
EXT. HEIGHT W/AC	10' 1"	10' 3"	10' 3"	10' 3"	10' 1"	10' 3"	10' 1"	10' 3"	10' 3"	10' 3"	11' 8"	11' 8"	10' 6"
EXTERIOR WIDTH	96"	96"	96"	96"	96"	96"	96"	96"	96"	96"	96"	96"	96"
FRESH WATER (GAL.)	42	61	42	42	61	61	29	61	61	61	61	61	42
GREY WATER (GAL.)	32	42	60	32	60	32	32	74	32	32	28	28	28
BLACK WATER (GAL.)	32	32	32	32	32	42	28	32	42	42	32	32	32
AWNING SIZE	10	14'	12'	14'	12'	16'	12'	16'	16'	16'	18'	18'	15



# SALEM PRODUCT FAMILY



CRUISE LITE



SALEM



CLASSIC / ESTATE / GRAND VILLA

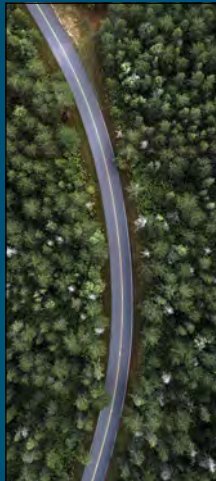

## 24/7 EMERGENCY ROADSIDE ASSISTANCE WITH VEHICLE PURCHASE\*

TOWING  
JUMP-STARTS  
TIRE CHANGES  
FLUID DELIVERY  
LOCKOUT  
SERVICE

WINCH-OUT  
MOBILE MECHANIC  
TECHNICAL  
SUPPORT  
DEALER LOCATOR  
SERVICES



\*VALID FOR 1 YEAR FROM DATE OF PURCHASE

## FREE MEMBERSHIP to Forest River Owners' Group

[www.forestriverfrog.com](http://www.forestriverfrog.com)



**Learn More**  
Scan this barcode using  
a QR Reader on your  
smart phone to learn  
more about Forest River.



A Berkshire Hathaway company.

### Specification Definitions

**GVWR (Gross Vehicle Weight Rating)** - is the maximum permissible weight of the unit when fully loaded. It includes all weights, inclusive of all fluids, cargo, optional equipment and accessories. For safety and product performance do NOT exceed the GVWR.

**GAWR (Gross Axle Weight Rating)** - is the maximum permissible weight, including cargo, fluids, optional equipment and accessories that can be safely supported by a combination of all axles.

**UVW (Unloaded Vehicle Weight)\*** - is the typical weight of the unit as manufactured at the factory. It includes all weight at the unit's axle(s) and tongue or pin and LP Gas. The UVW does not include cargo, fresh potable water, additional optional equipment or dealer installed accessories.

\*Estimated average based on standard build optional equipment.

**CCC (Cargo Carrying Capacity)\*\*** - is the amount of weight available for fresh potable water, cargo, additional optional equipment and accessories. CCC is equal to GVWR minus UVW. Available CCC should accommodate fresh potable water (8.3 lbs per gallon). Before filling the fresh water tank, empty the black and gray tanks to provide for more cargo capacity.

\*\* Estimated average based on standard build optional equipment

Each Forest River RV is weighed at the manufacturing facility prior to shipping. A label identifying the unloaded vehicle weight of the actual unit and the cargo carrying capacity is applied to every Forest River RV prior to leaving our facilities.

The load capacity of your unit is designated by weight, not by volume, so you cannot necessarily use all available space when loading your unit.

### CUSTOMER SATISFACTION



[www.ForestRiverBuyLocal.com](http://www.ForestRiverBuyLocal.com)



### PRE-DELIVERY INSPECTION FACILITY

20,000 square feet of quality assurance. The bare essentials for a premium product. This state-of-the-art facility gives immediate daily feedback to production for quality assurance in every unit built.

All information contained in this brochure is believed to be accurate at the time of publication. However, during the model year, it may be necessary to make revisions and Forest River, Inc., reserves the right to make all such changes without notice, including prices, colors, materials, equipment and specifications as well as the addition of new models and the discontinuance of models shown in this brochure. Therefore, please consult with your Forest River dealer and confirm the existence of any materials, design or specifications that are material to your purchase decision. Litho. U.S.A. FOR 1609 P/W: 2019.01.22

### MEET YOUR CRUISE LITE DEALER



SALEM TRAVEL TRAILERS

FOREST RIVER  
**SALEM**



WHERE AFFORDABILITY AND LUXURY MEET



# Salem Travel Trailers







**27RE**

INTERIOR COLORS & EQUIPMENT MAY VARY



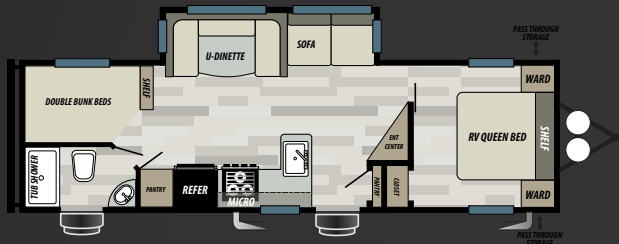

26DBUD

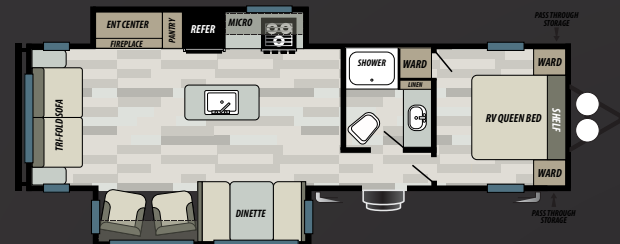

27RE

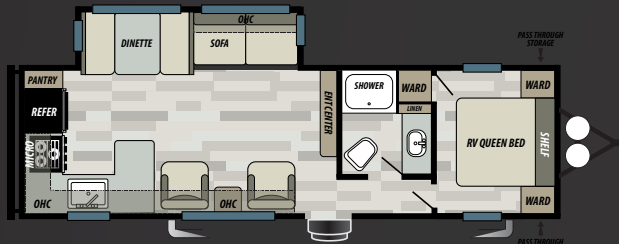

27RKS

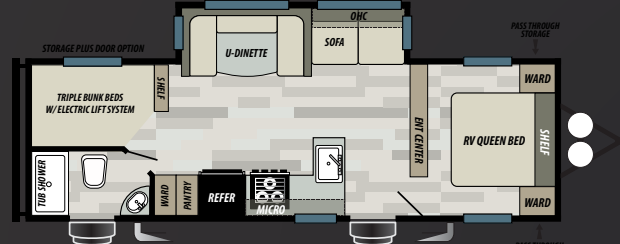

27TDSS

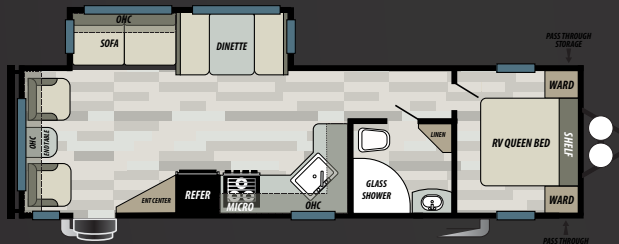

28RLSS

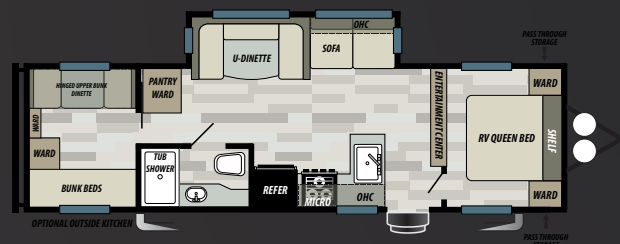

30QBSS

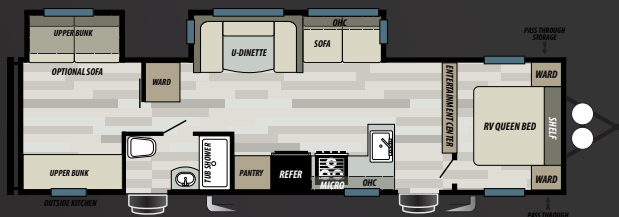

32BHDS

	26DBUD	27RE	27RKS	27TDSS	28RLSS	30QBSS	32BHDS
HITCH WEIGHT (LBS.)	866	877	836	806	844	817	931
GROSS VEHICLE WEIGHT RATING (LBS.)	9999	9999	9999	9980	9999	9985	9999
UNLOADED VEHICLE WEIGHT (LBS.)	7258	7965	7154	6662	7048	7145	8403
CARGO CARRYING CAPACITY (LBS.)	2741	1996	2845	3318	2913	2840	1596
EXTERIOR LENGTH (FT.)	33' 1"	34' 1"	33' 6"	32'	34' 9"	33' 10"	36' 4"
EXTERIOR HEIGHT (FT.)	11' 3"	11' 3"	11' 2"	11' 2"	11' 3"	11' 3"	11' 3"
FRESH WATER (GAL.)	56	56	56	56	56	56	56
GREY WATER (GAL.)	75	60	65	75	80	60	58
BLACK WATER (GAL.)	40	30	28	40	35	30	30
TIRE SIZE (IN.)	15	15	15	15	15	15	15



# Standards & Options

## CONSTRUCTION AND EXTERIOR

- 5/8 TONGUE AND GROOVE FLOOR DECKING
- FULL WALK ON SEAMLESS PVC ROOF WITH A 15 YEAR MANUFACTURER DEFECT WARRANTY
- EXTRA-LARGE FULL PASS THROUGH STORAGE (PER FP)
- MILDEW RESISTANT VINYL PATIO AWNING
- SAFETY GLASS WINDOWS
- POWDER COATED I-BEAM FRAME
- CAMBERED CHASSIS
- GAS/ELECTRIC QUICK RECOVERY DSI WATER HEATER
- WATER HEATER BYPASS
- 2" WALL CONSTRUCTION, 16"(OR LESS) ON CENTER
- TRIPLE SEAL SLIDE OUT SYSTEM
- FLUSH FLOOR ELECTRIC SLIDE OUT
- SWING ARM ENTRY ASSIST HANDLE
- TWO MARINE GRADE EXTERIOR SPEAKERS
- AERODYNAMIC FRONT RADIUS PROFILE
- SMOOTH .40 MIL ALUMINUM FRONT WRAP
- EASY LUBE AXLES W/ SELF ADJUSTING BRAKES
- ONE PIECE SLIP RESISTANT VINYL FLOOR
- R-7 FIBERGLASS INSULATION THROUGHOUT
- TEXTURED ROCKGAURD
- HURRICANE STRAPS
- LP QUICK DISCONNECT
- 1 1/4" RECEIVER
- 7 WAY CORD HOLSTER

## KITCHEN

- NEW SHAKER STYLE CABINET DOORS
- HIDDEN HINGES THROUGHOUT
- DOUBLE DOOR REFER (2YR WARRANTY)
- HIGH RISE SPRING FAUCET
- RESIDENTIAL STYLE UNDER MOUNT KITCHEN SINK
- 3-BURNER, HIGH OUTPUT RANGE WITH OVEN (2YR WARRANTY)
- FULL EXTENSION BALL BEARING DRAWER GUIDES
- SHELVING IN OVERHEAD CABINETS IN THE KITCHEN
- LARGE POTS AND PANS STORAGE UNDER DINETTE (PER FP)
- HIGH DEFINITION COUNTERTOPS

## LIVING ROOM

- 80" INTERIOR HEIGHT
- DUCTED 15 K A/C ROOF AIR CONDITIONER
- HUGE STORAGE DRAWER UNDER JIFFY SOFA
- LARGE DINETTE PICTURE WINDOW
- DIGITAL ANTENNA WITH BOOSTER
- BLUETOOTH FM STEREO
- 30K BTU SUBURBAN FORCED AIR DSI FURNACE W/ DIGITAL THERMOSTAT (2 YR WARRANTY)
- IN-FLOOR DUCTED HEAT
- CABLE TV HOOKUP LIVING ROOM AND BEDROOM

## BEDROOM

- NEW UPGRADED MATTRESS WITH PILLOW TOP IN MASTER BED
- STRUT LIFTED STORAGE AREA UNDER BED
- BEDSIDE 110-VOLT POWER OUTLETS (2)
- BEDSIDE USB CHARGERS (2)
- SOLID BEDROOM PRIVACY DOOR (PER FP)
- BEDSIDE HAMPER ACCESS (PER FP)

## BATHROOM

- 12-VOLT POWER BATH ROOF EXHAUST FAN
- FOOT FLUSH TOILET
- HIGH DEFINITION COUNTERTOPS

## SECURITY AND SAFETY

- LP LEAK DETECTOR
- SMOKE DETECTOR
- CARBON MONOXIDE DETECTOR
- FIRE EXTINGUISHER
- WELDED HEAVY DUTY SAFETY CHAINS
- ELECTRIC FULL SELF-ADJUSTING BRAKES
- GFI RECEPTACLES
- ANSI 119.2 CERTIFIED
- MEETS ALL NATIONAL HIGHWAY ADMINISTRATION SPECS
- RVIA APPROVED PRODUCT





# CRUISE LITE



**263BHXL**  
INTERIOR COLORS & EQUIPMENT MAY VARY



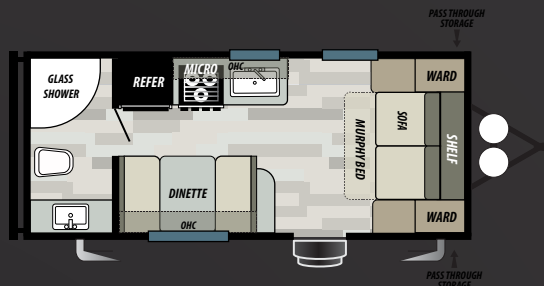

190RBXL

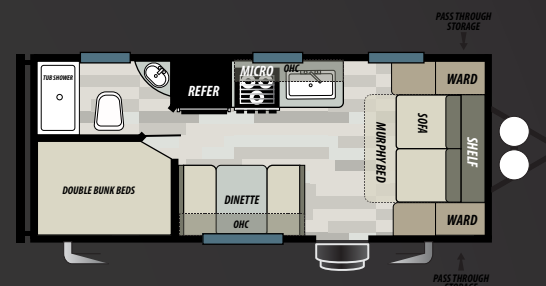

201BHXL

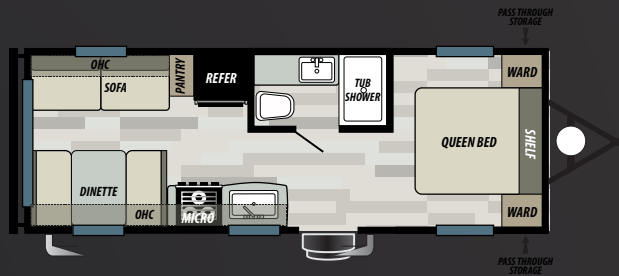

202RDXL

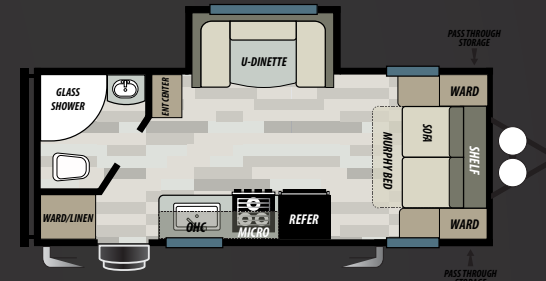

212RBXL

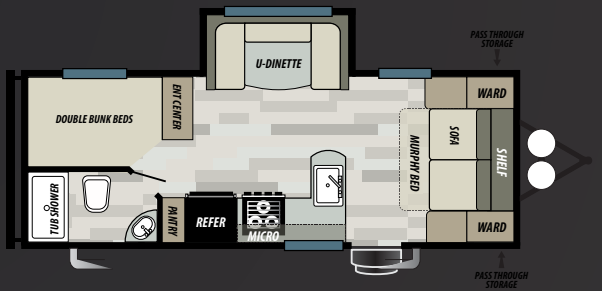

221BHXL

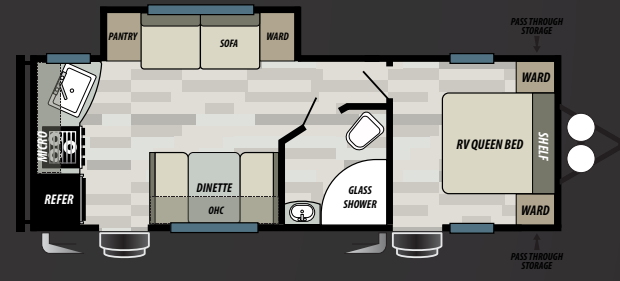

231RKXL

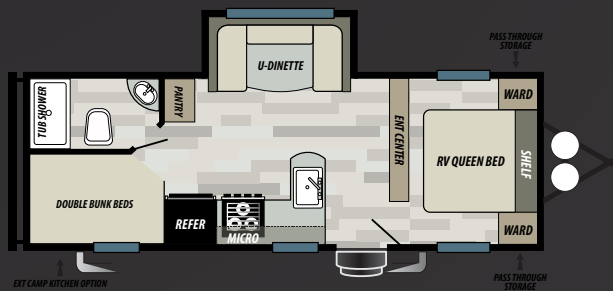

241BHXL

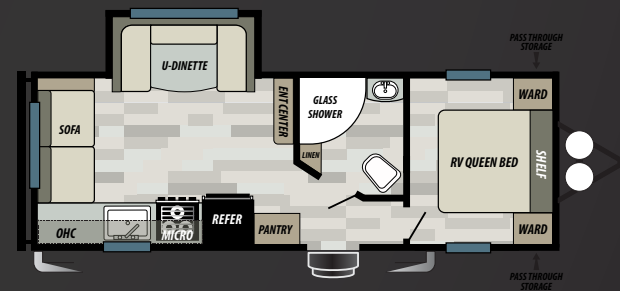

241RLXL



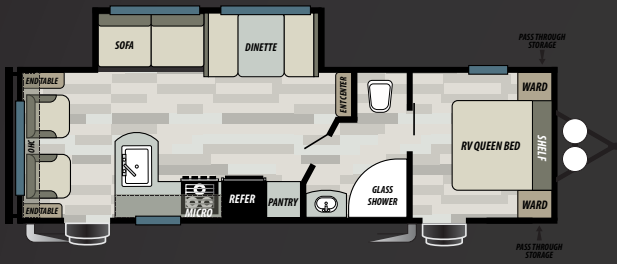

254RLXL

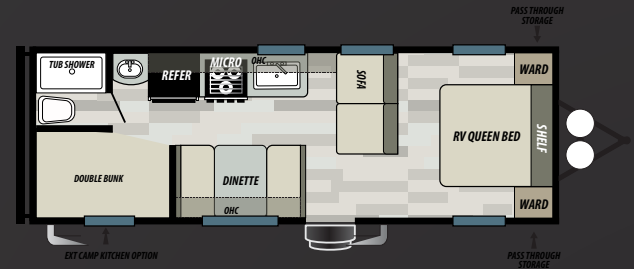

261BHLX

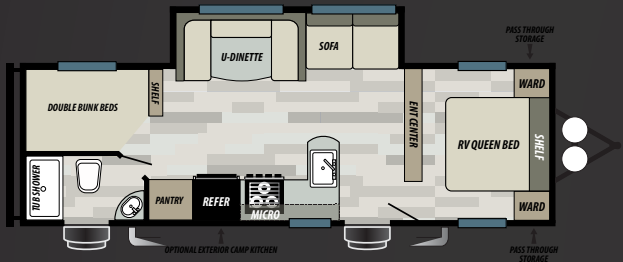

263BHLX

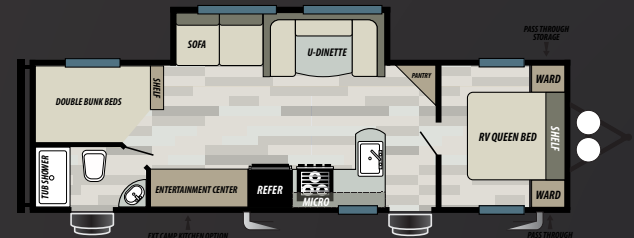

271BHLX

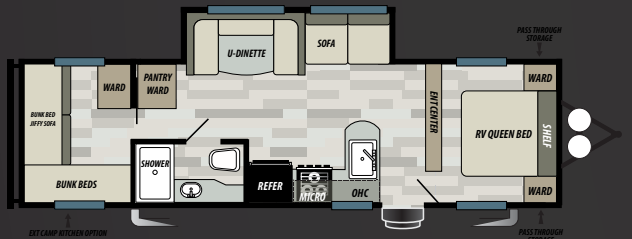

273QBXL

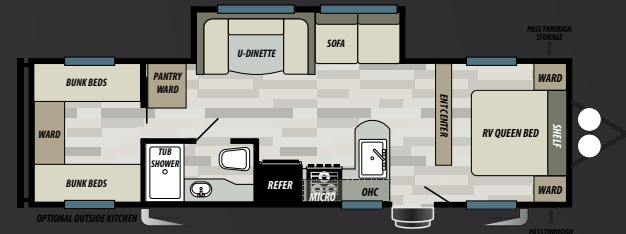

282QBXL









# Selects

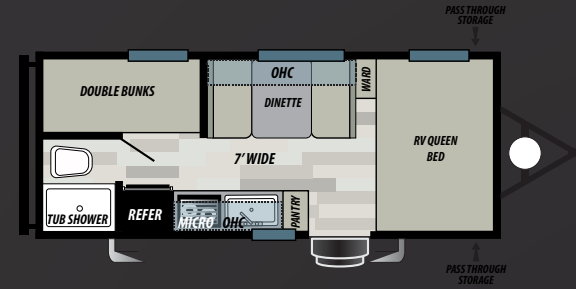

177BQ

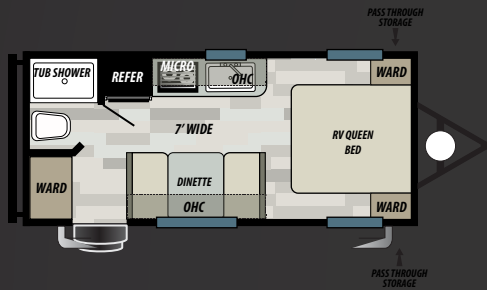

177FQ

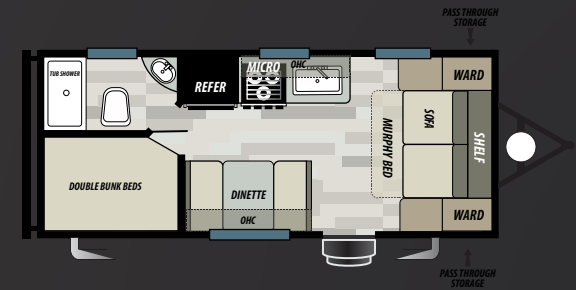

178DB

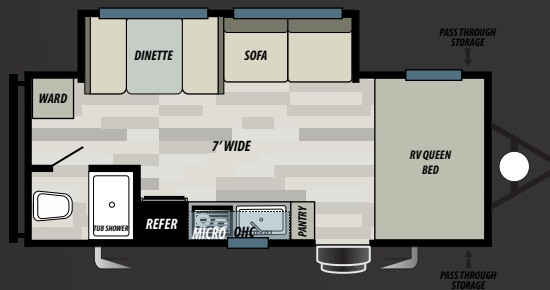

197SS

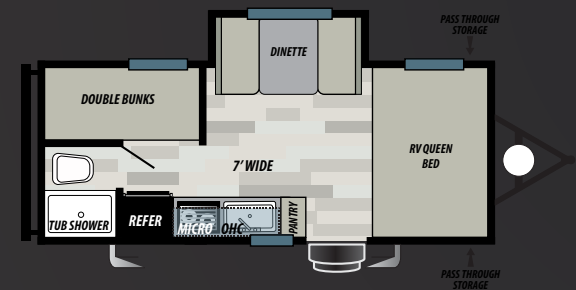

207BH

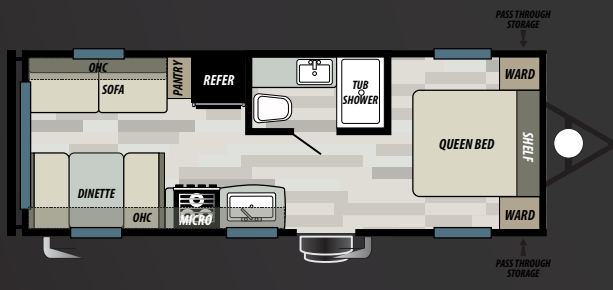

208RD

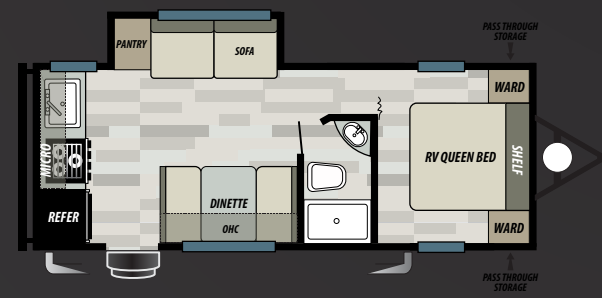

228RK

# Standards & Options

## STANDARD FEATURES

- NEW 6-WAY ADJUSTABLE HIDDEN HINGES
- STAINLESS STEEL SINGLE POLE FAUCET
- AERODYNAMIC FRONT PROFILE
- SHAKER STYLE CABINET DOORS
- NEW 3 BURNER COOK TOP
- 13.5K A/C
- TEXTURED ROCK GUARD
- NEW LP QUICK CONNECT
- NEW DOUBLE DOOR GAS & ELECTRIC REFER
- NEW RESIDENTIAL SINGLE BOWL SINK
- MICROWAVE WITH CAROUSEL
- AWNING
- 6 GAL GAS DSI WATER HEATER
- 1-20LB LP BOTTLE
- AUTO IGNITION 20K BTU FURNACE
- NEW EXTERIOR TV HOOK UP
- MINI-BLINDS THROUGHOUT
- NEW TEDDY BEAR BUNK MATS (PER F/P)
- WATER HEATER BY-PASS
- FULL WALK ON SEAMLESS ROOF WITH A 15 YEAR MANUFACTURER DEFECT WARRANTY
- KITCHEN DRAWER W/BALL BEARING GUIDES
- HIGH DEFINITION COUNTERTOPS
- 78" INTERIOR HEIGHT
- E-Z LUBE AXLES W/SELF-ADJUSTING BRAKES

## POPULAR OPTIONS

- POWER AWNING W/ ADJUSTABLE LEGS
- BLUETOOTH STEREO WITH REMOTE
- BACKUP CAMERA PREP
- SOLAR PREP
- NEW USB PORTS
- SPARE TIRE AND CARRIER
- SKYLIGHT OVER TUB
- POWER TONGUE JACK
- STABILIZER JACKS (2 OR 4)

	177BQ	177FQ	178DB	197SS	207BH	208RD	228RK	267SS	268BH
HITCH WEIGHT (LBS.)	445	430	485	495	470	565	550	655	545
GROSS VEHICLE WEIGHT RATING (LBS.)	4845	4830	5585	5595	4870	7565	7550	8455	7545
UNLOADED VEHICLE WEIGHT (LBS.)	3374	3334	4033	4113	3728	4235	4708	5280	4559
CARGO CARRYING CAPACITY (LBS.)	1471	1496	1552	1482	1142	3292	2842	3175	2986
EXTERIOR LENGTH (FT.)	22' 8"	22' 8"	24'	24' 2"	22' 11"	25' 10"	26' 3"	31'	28' 8"
EXTERIOR HEIGHT (FT.)	10' 3"	10' 3"	10' 3"	10' 5"	10' 5"	10' 5"	10' 5"	10' 9"	10' 5"
FRESH WATER (GAL.)	48	48	48	48	48	48	48	48	48
GREY WATER (GAL.)	22	22	28	22	22	30	52	28	28
BLACK WATER (GAL.)	22	22	30	22	22	30	28	22	30
TIRE SIZE (IN.)	15	15	15	15	15	15	15	15	15

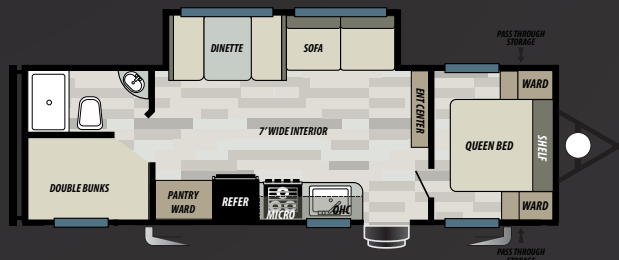

267SS

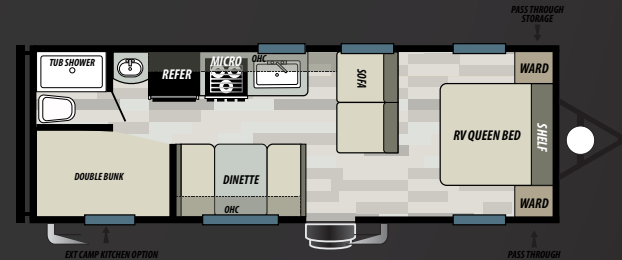

268BH



# FOREST RIVER SALEM

# CRUISE LITE

## SELECT

**FREE MEMBERSHIP**  
to Forest River Owners' Group

[www.forestriverfrog.com](http://www.forestriverfrog.com)



**Learn More**  
Scan this barcode using  
a QR Reader on your  
smart phone to learn  
more about Forest River.



A Berkshire Hathaway company.

FOREST RIVER INC., 255 S PEPPER AVE RIALTO, CA 92376 | (909) 873-3777  
WWW.FORESTRIVERINC.COM/SALEM | WWW.FORESTRIVERACCESSORIES.COM  
EFFECTIVE FOR UNITS PRODUCED STARTING SEPTEMBER 1ST, 2019

### CUSTOMER SATISFACTION



[www.ForestRiverBuyLocal.com](http://www.ForestRiverBuyLocal.com)

YOUR SALEM DEALER

### Specification Definitions

**GVWR (Gross Vehicle Weight Rating)** - is the maximum permissible weight of the unit when fully loaded. It includes all weights, inclusive of all fluids, cargo, optional equipment and accessories. For safety and product performance do NOT exceed the GVWR.

**GAWR (Gross Axle Weight Rating)** - is the maximum permissible weight, including cargo, fluids, optional equipment and accessories that can be safely supported by a combination of all axles.

**UVW (Unloaded Vehicle Weight)\*** - is the typical weight of the unit as manufactured at the factory. It includes all weight at the unit's axle(s) and tongue or pin and LP Gas. The UVW does not include cargo, fresh potable water, additional optional equipment or dealer installed accessories.

\*Estimated average based on standard build optional equipment.

**CCC (Cargo Carrying Capacity)\*\*** - is the amount of weight available for fresh potable water, cargo, additional optional equipment and accessories. CCC is equal to GVWR minus UVW. Available CCC should accommodate fresh potable water (8.3 lbs per gallon). Before filling the fresh water tank, empty the black and gray tanks to provide for more cargo capacity. \*\* Estimated average based on standard build optional equipment

Each Forest River RV is weighed at the manufacturing facility prior to shipping. A label identifying the unloaded vehicle weight of the actual unit and the cargo carrying capacity is applied to every Forest River RV prior to leaving our facilities. The load capacity of your unit is designated by weight, not by volume, so you cannot necessarily use all available space when loading your unit.

All information contained in this brochure is believed to be accurate at the time of publication. However, during the model year, it may be necessary to make revisions and Forest River, Inc., reserves the right to make all such changes without notice, including prices, colors, materials, equipment and specifications as well as the addition of new models and the discontinuance of models shown in this brochure. Therefore, please consult with your Forest River dealer and confirm the existence of any materials, design or specifications that are material to your purchase decision. Litho. U.S.A. FOR 1420 P/W: 2019.3.1