

Jayco | Jay Flight Travel Trailer

JAY FLIGHT

#1 SELLING TRAVEL TRAILER FOR 15 YEARS



2+3
YEAR | YEAR
WARRANTY

INTERIOR DESIGN



CLASSIC COTTAGE



Wood



Floor



Countertop

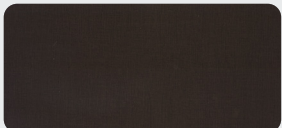

Main Fabric

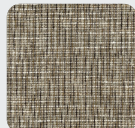

Accent Fabrics

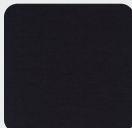

MODERN FARMHOUSE

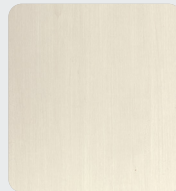

Wood

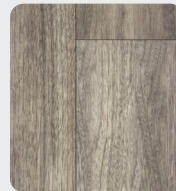

Floor

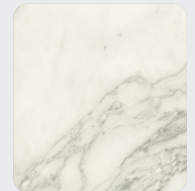

Countertop

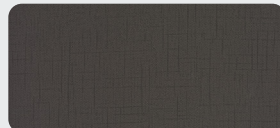

Main Fabric



Accent Fabrics



2120B



224BH

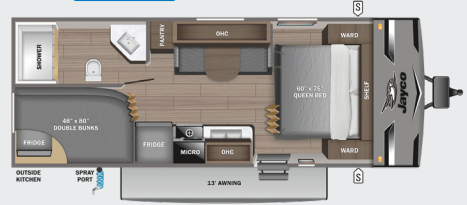

240RBS OPTION: A

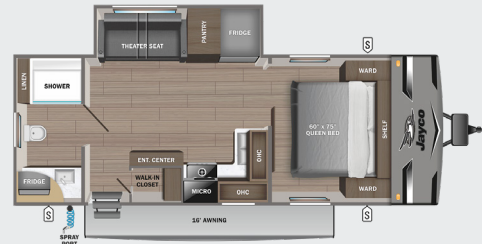

236TH

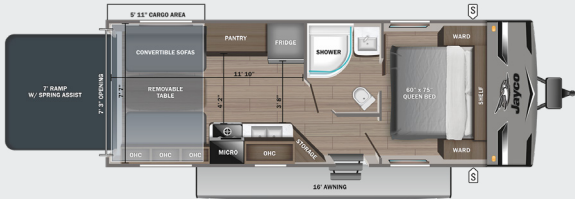

242BHS



247RBS

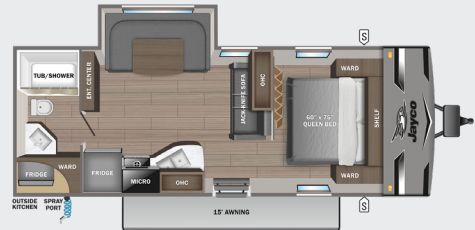

263RBS OPTION: A



264BH OPTION: B



265RLS OPTIONS: A, C



265TH

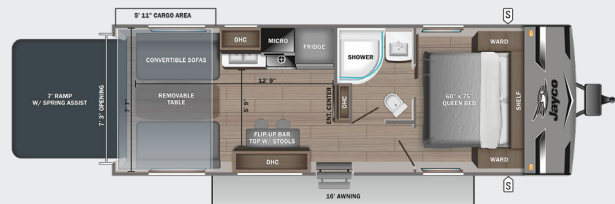

OPTIONS

-  STORAGE
- MICRO** MICROWAVE
- OHC** OVERHEAD CABINETS
- FRIDGE** REFRIGERATOR
- WARD** WARDROBE

A



Tri-fold Sofa

B



Chil N' Stor

C



Theater Seat

267BHS OPTIONS: A, C

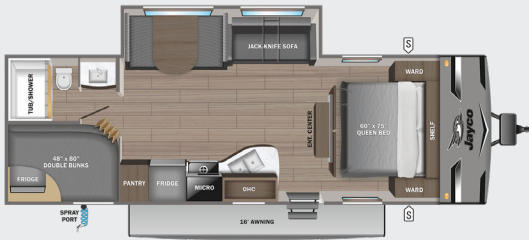

274BH



280BHK OPTIONS: A, C



280RKS OPTIONS: A, C

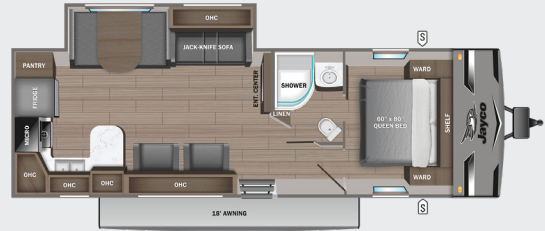

284BHS OPTIONS: A, C

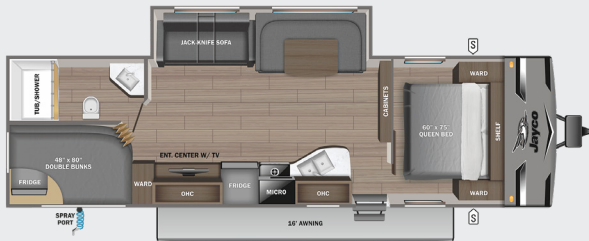

285BHS OPTIONS: A, C



2940BS OPTIONS: A, C

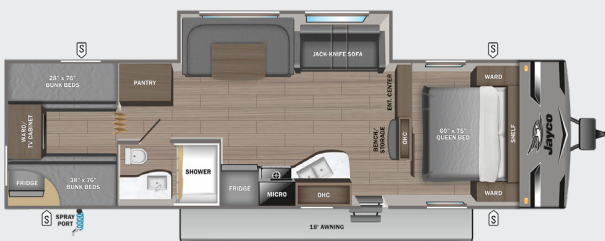



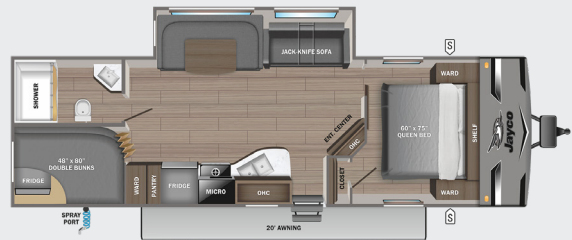

295BHS OPTIONS: A, C





324BDS OPTIONS: A, C



OPTIONS

-  STORAGE
-  MICRO MICROWAVE
-  OHC OVERHEAD CABINETS
-  FRIDGE REFRIGERATOR
-  WARD WARDROBE

- A**  Tri-fold Sofa
- B**  Chil'N Stor
- C**  Theater Seat

331BTS

OPTIONS: A, C, D, F

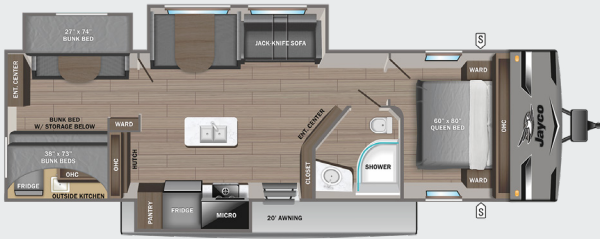
334RTS

OPTIONS: A, E, F

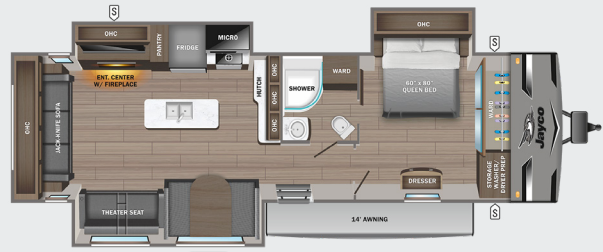
340RLK

OPTIONS: A, E

380DOS

OPTIONS: A, C, E

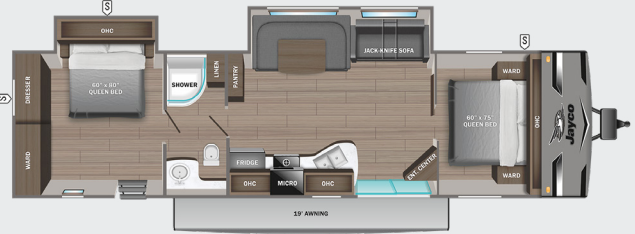
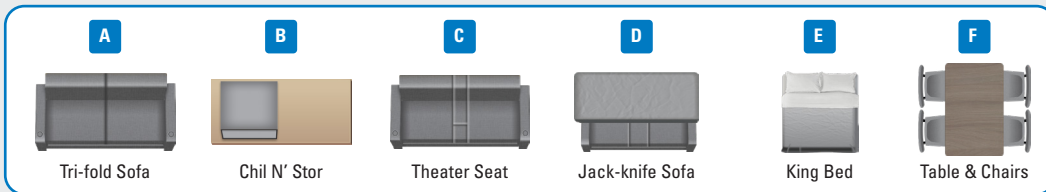
OPTIONS

*Indicates split tanks

FLOORPLAN	EXTERIOR TRAVEL LENGTH	EXTERIOR WIDTH	EXTERIOR HEIGHT (WITH A/C)	INTERIOR HEIGHT	UNLOADED VEHICLE WEIGHT	DRY HITCH WEIGHT	GVWR	CARGO CARRYING CAPACITY	FRESH WATER CAPACITY (INCLUDING WATER HEATER)	GRAY WASTE WATER CAPACITY	BLACK WASTE WATER CAPACITY	SLEEPING CAPACITY
212QB	25' 8"	8' 0"	10' 7"	6' 9"	4,290	490	5,500	1,210	42	33	39	4-5
224BH	27' 1"	8' 0"	10' 7"	6' 9"	4,490	510	5,600	1,110	42	39	39	7-8
236TH	28' 4"	8' 0"	10' 6"	6' 9"	5,020	845	7,500	2,480	42	39	39	4
240RBS	27' 4"	8' 0"	10' 11"	6' 9"	5,465	620	6,750	1,285	38	78*	39	2-4
242BHS	29' 4"	8' 0"	11' 2"	6' 9"	5,490	770	7,000	1,510	38	39	39	6-8
247RBS	28' 10"	8' 0"	11' 1"	6' 9"	5,340	645	6,750	1,410	38	39	39	4-6
263RBS	30' 1"	8' 0"	11' 0"	6' 9"	6,075	720	7,500	1,425	38	78*	39	4-6
264BH	29' 5"	8' 0"	10' 6"	6' 9"	4,730	500	6,000	1,270	42	39	39	8-9
265RLS	31' 1"	8' 0"	11' 1"	6' 9"	6,010	735	7,150	1,140	38	39	39	4-6
265TH	30' 5"	8' 0"	10' 7"	6' 9"	5,240	845	7,500	2,260	42	39	39	4-6
267BHS	30' 4"	8' 0"	11' 2"	6' 9"	5,880	775	7,100	1,220	38	39	39	8-10
274BH	30' 7"	8' 0"	10' 6"	6' 9"	5,265	645	6,500	1,235	42	39	39	6-8
280BHK	34' 7"	8' 0"	11' 2"	6' 9"	6,650	735	8,250	1,600	38	78*	39	8-10
280RKS	33' 10"	8' 0"	11' 3"	6' 9"	6,495	810	8,150	1,655	38	78*	39	4-6
284BHS	33' 7"	8' 0"	11' 1"	6' 9"	6,265	815	7,600	1,335	38	39	39	8-10
285BHS	33' 4"	8' 0"	11' 2"	6' 9"	6,450	760	8,150	1,700	38	78*	39	8-10
294QBS	35' 7"	8' 0"	11' 3"	6' 9"	6,640	910	8,250	1,610	38	47.5*	39	8-14
295BHS	34' 4"	8' 0"	11' 3"	6' 9"	6,450	815	7,750	1,300	38	39	39	8-10
324BDS	35' 4"	8' 0"	11' 2"	6' 9"	7,665	970	9,000	1,335	40	41*	39	9-10
331BTS	37' 10"	8' 0"	11' 3"	6' 9"	TBD	1,215	11,350	2,380	40	78*	39	6-7
334RTS	37' 10"	8' 0"	11' 2"	6' 9"	8,590	1,130	10,250	2,860	40	71.5*	39	4-5
340RLK	37' 8"	8' 0"	11' 2"	6' 9"	TBD	1,325	11,250	2,470	40	71.5*	39	4-5
380DOS	40' 6"	8' 0"	11' 2"	6' 9"	TBD	1,045	10,750	2,600	40	80	39	4-6

Some specs at the time of print may include estimates. For the most updated information, please visit Jayco.com

STANDARDS & OPTIONS

EXTERIOR

20 lb. LP bottles with cover (2)
Enclosed underbelly
Axles with electric, self-adjusting brakes and easy-lube hubs
I-Class™ cambered structural steel I-beams
Fully integrated A-frame
5/8 in. tongue-and-groove plywood floor decking
Magnum Truss™ Roof system with plywood decking
Seamless one piece roof material
Large exterior downspouts
Galvanized steel, impact-resistant wheel wells
30-amp service
Front diamond plate
Rock Solid Stabilizer System
Exterior TV mount and bracket
LED exterior lighting
Friction hinge entry door with shade-prep window
G20 dark tinted safety-glass privacy windows
LP quick connect (outside gas grill prep)
Detachable power cord
Backup and side marker camera prep

INTERIOR

81 in. ceiling height
8 cu. ft. 12V refrigerator
Shower/tub surround
Solid hardwood cabinet doors
LED interior lighting
J-Steel™ jack-knife sofa with armrest and cup holders (most models)
Vinyl flooring throughout (including slide floors)
Window shades
Smoked-glass cabinet door inserts (select models)

Residential-style kitchen countertops
3-burner range with glass cover
Oven with glass door and interior light
Heavy-duty, 75 lb., full-extension, steel ball-bearing drawer guides
Range hood
USB charging station
Queen mattress
Plywood bed platforms
Main bed struts
300 lb. rated bunk beds (select models)
600 lb. rated bunk beds (double bunks)
Privacy curtains in bunk areas (select models)
Vented bunk windows (select models)
4 in. thick bunk mats (select models)
Wooden bedroom doors (select models)
Shower curtain with curved shower track (select models)

CUSTOMER VALUE PACKAGE (MANDATORY)

Black tank flush
Roof mounted solar prep
Large main entry door grab handle
Solid Step® entry steps (N/A 380DQS)
Tankless water heater
Cable/satellite TV hookup
Digital TV antenna
Goodyear® Endurance® tires (made in the USA)
Outside shower
Power tongue jack
Spare tire with cover
Water heater bypass
Power awning with LED lights
Marine grade exterior speakers
Keyed-Alike™ entry and baggage doors

Bathroom power vent
Bathroom skylight
Tub surround

OPTIONS

15,000 BTU A/C
50-amp service
7 cu. ft. gas/electric refrigerator
Chil N' Stor (264BH)
Roof ladder (N/A 236TH, 265TH)
Wall-hugger theater seating (select models)
Overlander 1 Solar Package: (1) 200W solar panel and 30-amp digital controller
LED Smart TV (standard on 284BHS, 334RTS, 340RLK)
Hide-a-bed with tri-fold mattress (select models)
Outside griddle with bumper mount (select models)
Cargo accessory receiver (340RLK, 334RTS, 380DQS, 331BTS)
Fiberglass sidewalls (select models)
Rear sofa with folding bunk (331BTS)
2nd A/C in bedroom (340RLK, 334RTS, 380DQS, 331BTS)
Front bunks with dinette (380DQS)
King bed (340RLK, 334RTS, 380DQS)

Meet your Jayco Dealer



Some specs at the time of print may include estimates. For the most updated information, please visit Jayco.com

Jayco, Inc. | P.O. Box 460 | Middlebury, IN 46540

See dealer for further information and prices. All information in this brochure and on www.jayco.com is the latest available at the time of publication approval. Jayco reserves the right to make changes and to discontinue models without notice or obligation. Photography may show optional equipment or props used for decoration purposes only. RVs built for sale in Canada may differ to conform to Canadian codes. JAYCO and the JAYCO BIRD IN FLIGHT are registered trademarks of Jayco, Inc. Printed in USA 1/23 ©2023 Jayco, Inc. 2032594.2023



Jayco - Part of Jayco Family of Companies