

1995 Williamsburg
at Yosemite National Park



Experience America's Best!

1995



BY

FLEETWOOD

FOLDING TRAILERS Coleman® and  are registered trademarks of The Coleman Company, Inc., used under license.



Printed On Recycled Paper



Coleman Folding Trailers By Fleetwood... The Two Greatest Names in the Great Outdoors



This brochure is printed on recycled, coated paper so it can be reclaimed and used again. Like a lot of our customers, we believe it's time to do what we can to protect and preserve our environment. By using recycled paper we've saved approximately 1,216 trees, 500,513 gallons of water, 135 cubic yards of landfill space, and 293,150 kilowatt hours of electricity (enough to run 33-36 homes for one year)*. We hope that as you enjoy the camping experience and our great outdoors heritage, you will remember the camper's creed...

"Take only pictures and leave only footprints".

* Source: American Paper Institute; Numbers are estimated.

Five years ago Fleetwood acquired Coleman Folding Trailers, and the tradition of building the highest quality folding trailers with unsurpassed dependability was continued.

Fleetwood has invested the resources, money, and time it takes to develop product innova-

Look at the Company Behind the Product!

tions that satisfy our customers' needs and keeps them coming back...time and time again.

Fleetwood, the world's leading manufacturer of recreational vehicles, also builds the top selling motor homes, travel trailers, fifth wheels and truck campers, like Bouncer, Pace Arrow,

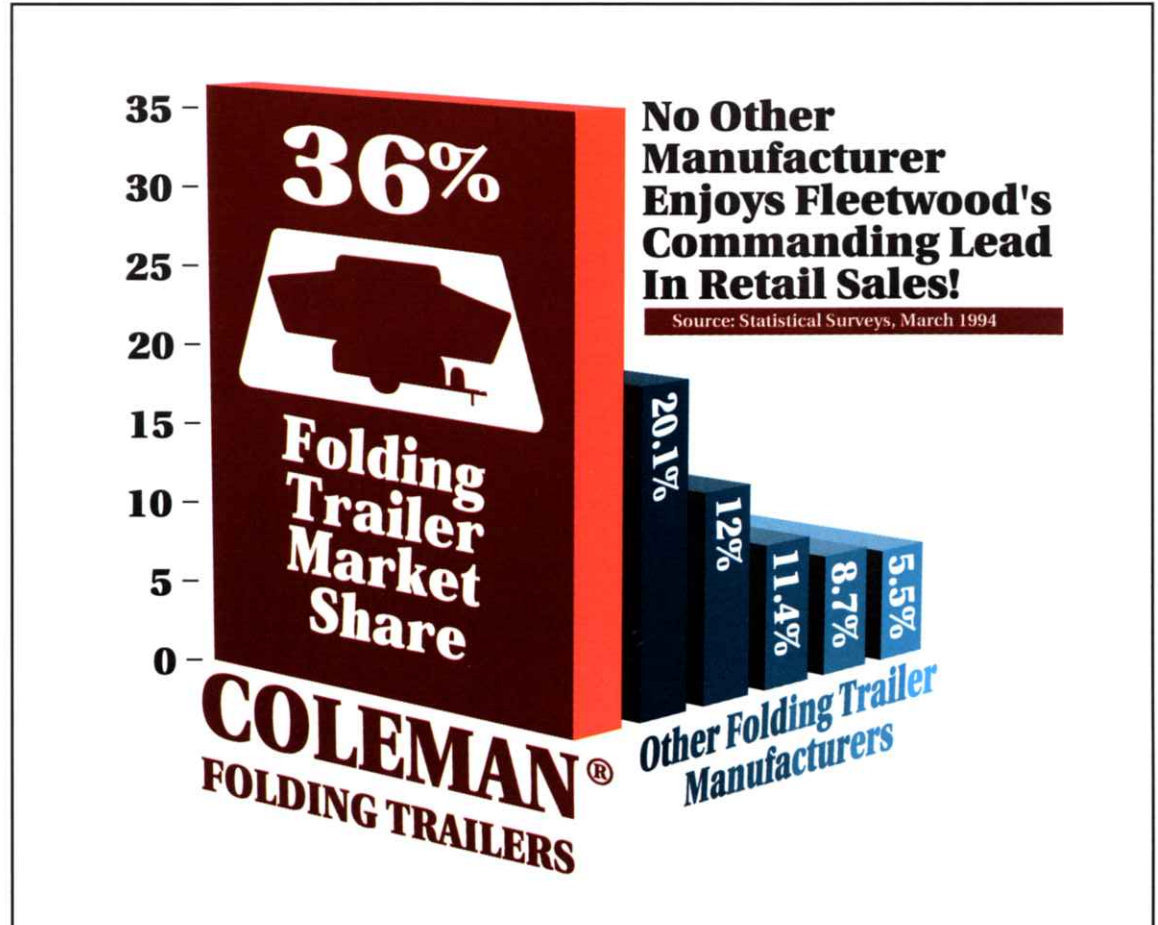

Avion, Prowler and Caribou. You can be confident that Coleman Folding Trailers by Fleetwood will uphold

the tradition of quality that it established nearly 30 years ago. Our commitment to you is to continue our philosophy that

states, "No product is really sold until it's delivering a satisfactory service to the purchaser".

Coleman and Fleetwood: A Heritage of Building High Quality Products With Complete Dedication to Total Customer Satisfaction!

Over the years, both Coleman and Fleetwood have grown steadily, establishing reputations built on providing customer value and satisfaction. Coleman has come to symbolize "the greatest name in camping and the great outdoors" with an unparalleled commitment to outdoor recre-

ation. The Fleetwood name is also widely recognized for its manu-

Coleman® Folding Trailers Maintains High Quality Standards

factured housing and recreational vehicle product's superior quality and value. The

Fleetwood name can be found on one out of every three RVs on the road today. Recognizing the same high quality standards already in place, Fleetwood is committed to maintaining the same standards in product, service, and quality that have been a hallmark of the Coleman heritage for years.

Three Generations of Satisfied Coleman Folding Trailer Owners



From little Katelynn Eash to the senior member of the family, Gerald Eash, generations of families like this one have logged many unforgettable memories in their Coleman Folding Trailers. Your affordable and comfortable vacation home away from home!

(L to R) Gerald, Patty & Kristi Eash, Hooversville, PA, Scott, Diane & Katelynn Eash, Hollsopple, PA



CIRCLE OF EXCELLENCE CUSTOMER SATISFACTION PROGRAM

"We Care..." Fleetwood's commitment to customer satisfaction is evident through our Circle of Excellence Customer Satisfaction Program. Each and every purchaser of a Coleman folding trailer receives a personal phone call or a written survey after six months of ownership of their camper to insure that our product is continuing to provide a satisfactory service. For three consecutive years, Coleman Folding Trailers has earned the coveted Customer Satisfaction Award and is currently ranked at 97.5%...the highest of any Fleetwood product or division!

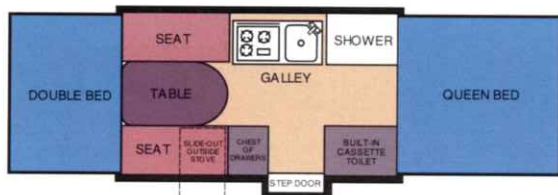

WILLIAMSBURG®

Towing Height.....47"
 Base Vehicle Weight1795 lbs
 Trailer Length (open)22'8"
 Sleeps.....7

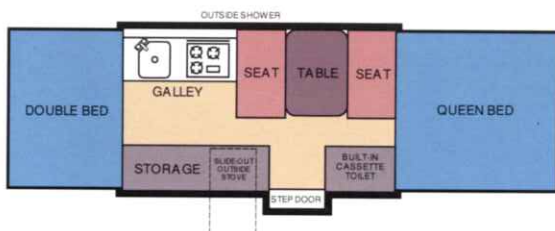

SEQUOIA®

Towing Height.....47"
 Base Vehicle Weight1760 lbs
 Trailer Length (open)22'8"
 Sleeps.....7

Refer to the back page for additional specifications.



1995 Williamsburg



The Ultimate In Folding Trailer Convenience...

The hydraulic lift system is a cinch to use, and so convenient! ❶ To operate, simply flick a switch, and watch as your folding trailer's roof raises automatically. ❷ The dependable hydraulic pump and motor are powered by an optional battery which can be located on the tongue of the trailer. ❸ Heavy gauge wire is used to connect the battery to the pump for efficient transmission of the 12V DC current. ❹ When the cylinder is fully extended, a safety latch engages the end of the cylinder to insure ease of operation and safety. ❺ Once you're ready to lower the trailer back to its closed position, just release the safety latch and turn in the valve handle. It's that simple!

Deluxe Americana Features

- ✓ Electric Brakes
- ✓ Under Floor Water Storage
- ✓ Lockable Utility Port
- ✓ Outside Hot Water Shower (Sequoia Only)
- ✓ Outside Access to Inside Storage
- ✓ Mini Blinds
- ✓ 3-Way Convertible Ice Chest
- ✓ Hydraulic Power Lift System
- ✓ "EZ-Crank" Stabilizers
- ✓ Built-In Cassette Toilet
- ✓ Storage Bumper
- ✓ Sunbrella® 302 Acrylic Tenting
- ✓ Swing-Level® Full Storage Galley

Optional Americana Convenience Pack

- ✓ Spare Tire
- ✓ Bed Light
- ✓ Wardrobe Rack
- ✓ Camper Caddie
- ✓ Two Sets of Privacy Curtains.



Experience the Ease of a Hydraulic Power Lift System

*patent pending hydraulic lift



CAMP TIP

Perishable food items, clothing, and bedding are most likely to be the last packed prior to departure, and the first items you'll want to unpack upon return. For this reason, Coleman's StepperDoors, front storage trunks, outside storage areas, portable ice chests, and CamperCaddies really simplify packing and unpacking.



The Coleman "EZ-Crank" stabilizers crank down into position with a minimum of effort (standard on Americanas, Yosemite, and Hatteras, optional on Cape Cod and Pioneer models).

1 Take advantage of the extra room in a Williamsburg model to enjoy some of your favorite hobbies, at the campsite or at home. Whether it's flower arranging, stamp collecting or bird watching...Coleman Folding Trailers can mean more than just camping today. 2 The Williamsburg model features hot water, tub and shower. When not in use, the shower top conceals the tub and doubles as a bedside nightstand. 3 The new Americana cassette toilet provides built-in convenience. 4 For hosing off the kids and pets, or just cleaning a mess of fish, you can't beat this exterior shower for convenience (only on Sequoia). 5 With Americana's Swing-Level® galley, you can pack things where they belong before you hit the road. Then once you arrive, just swing the galley into position. Everything stays just the way you packed it.



These newly styled chest of drawers provide a space to store personal belongings when you need that extra room.



1 Enjoy the best of both worlds in the new 1995 **Hatteras**, the comfort of a travel trailer and the ease of towing a folding trailer. Spend the afternoon on an outdoor trail, and the evening in your comfortable home away from home. 2 The **Hatteras** and **Yosemite** are as easy to set up as one.. 3 two.. 4 three!



Four Seasons... Folding Trailers with a Solid New Twist

The exciting new **Hatteras**, **Yosemite** and **Cape Cod** models offer the comfort and feel of a travel trailer, with the economy and ease of towing a folding trailer. These folding hardwall models feature solid panel walls made of maintenance-free and impact-resistant ABS plastic. The sidewalls set up automatically as the trailer roof is being raised. Then, with a simple twist of the sidewall latch, the walls are locked and secured in place. Extra-large tempered and tinted safety glass sliding windows circulate fresh air and offer a panoramic view of your surroundings. (*Four Seasons models are not available in Canada.*)



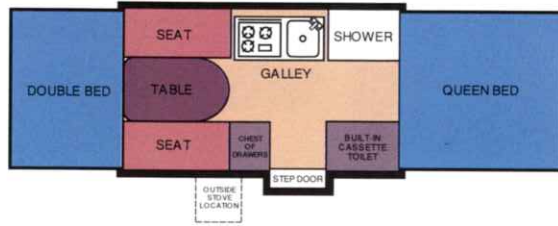

HATTERAS™

Towing Height.....57"
 Base Vehicle Weight1895 lbs
 Trailer Length (open)22'2"
 Sleeps.....7

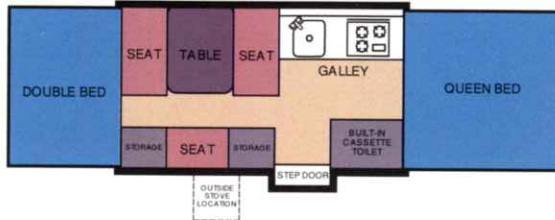

YOSEMITE™

Towing Height.....57"
 Base Vehicle Weight1895 lbs
 Trailer Length (open)22'2"
 Sleeps.....7

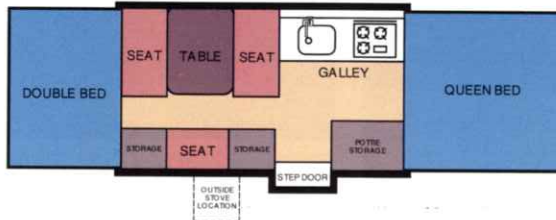

CAPE COD®

Towing Height.....57"
 Base Vehicle Weight1795 lbs
 Trailer Length (open)22'2"
 Sleeps.....7

Refer to the back page for additional specifications.



❶ The new Four Seasons cassette toilet features built-in convenience (not available on Cape Cod). ❷ The new **Hatteras** interior features a convenient shower with hot water. The shower top converts the tub into a handy bedside nightstand when not in use.

Deluxe Four Seasons Features

- ✓ Solid Impact-Resistant ABS Sidewalls
- ✓ Large, Tinted, Tempered Safety Glass Windows
- ✓ Tallest Interior Height - 7'1" Headroom
- ✓ Swing-Level® Full Storage Galley
- ✓ Hydraulic Power Lift on Yosemite & Hatteras
- ✓ "EZ-Crank" Stabilizers on Yosemite & Hatteras
- ✓ Sunbrella® 302 Acrylic Tenting

Optional Four Seasons Convenience Pack

- ✓ Spare Tire
- ✓ Bed Light
- ✓ Gas Bottle Cover
- ✓ Wardrobe Rack
- ✓ Camper Caddie
- ✓ Two Sets of Privacy Curtains

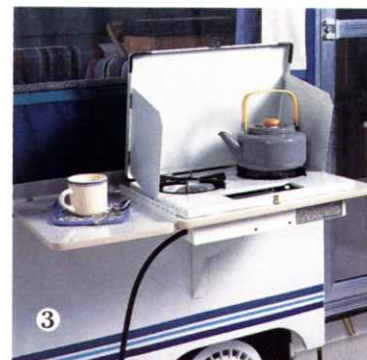

Avalon Storage

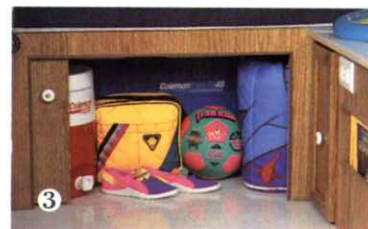

❶ Set up the games, pull out the food and let the fun begin! The new 1995 **Chesapeake CP** has plenty of room for kids and adults alike. And who could ask for a better view of the great outdoors, or a great race! ❷ Race on down to your local Coleman Folding Trailer dealer and ask to see the new **Chesapeake CP**. Then have your Coleman trailer be part of the fun on your next family outing. The **Chesapeake CP** shares the popular Pioneer style graphics and creature comforts. ❸ All Pioneer models feature the added convenience of a high-pressure, high efficiency outside cookstove. ❹ The new **Chesapeake CP** offers the convenience of a built-in cassette toilet and hot water. ❺ Enjoy the whole weekend at the races with the easy to tow **Chesapeake CP**.

❶ The **Avalon** includes this unique storage trunk that opens to a large 17 cu. ft. storage space. ❷ When the bed is extended, access is through hatches on either side of the trailer... ❸ ...or through a sliding door on the interior of the camper.



1 *Avalon's well-appointed and stylish interior accommodates people and pets alike.* 2 *These handy mesh pockets are great storage for sunglasses, a flashlight, books, games or other smaller items.* 3 *The exclusive and patented Coleman Swing-Level® galley is a snap to set up and use.* 4 *Mealtime, anytime is made so much easier with a well-stocked galley...talk about storage space!* 5 *Avalon features a spacious 17 cubic foot storage trunk to easily hold some of the larger items needed for you or your pets. Once you've arrived, relax in the shade of the canopy or enjoy the wide open spaces.*

Deluxe Pioneer Features

- ✓ Swing-Level® Full Storage Galley
- ✓ Two Stoves - Outside High Pressure & Inside Low Pressure
- ✓ Tent Storage Pockets
- ✓ Full View Screen Door with Removable Panels

Optional Pioneer Convenience Pack

- ✓ Spare Tire
- ✓ Tire Cover
- ✓ Gas Bottle Cover
- ✓ Bed Light
- ✓ Wardrobe Rack
- ✓ Two Sets of Privacy Curtains

Camping Checklist

Before you head out on your next camping trip, compile a checklist of all the things you take along, and indicate where the items are stored. Make photocopies of this list so that prior to each trip, you can locate items quickly and confirm that they are packed. A separate checklist for each family member is also helpful, and allows children to take part and to include favorite toys.

Use your Coleman® Folding Trailer as a "suitcase", packed and ready to go with the essentials – pots and pans, dry goods, campsite supplies, etc. This way, you can speed up the preparation process when planning a camp out.

ARCADIA®

Towing Height.....47"
 Base Vehicle Weight.....1490 lbs
 Trailer Length (open).....22'8"
 Sleeps.....7

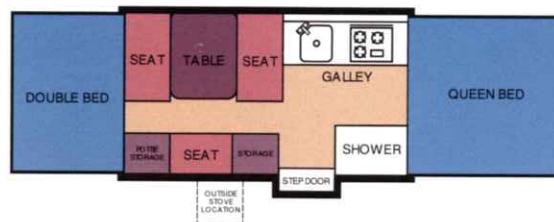

AVALON™

Towing Height.....47"
 Base Vehicle Weight.....1760 lbs
 Trailer Length (open).....22'8"
 Sleeps.....8

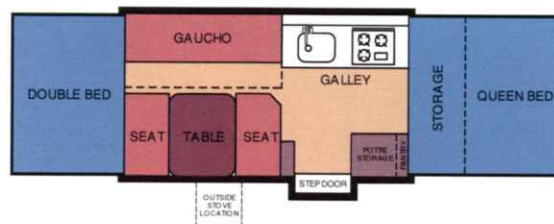

CHESAPEAKE®

Towing Height.....47"
 Base Vehicle Weight.....1445 lbs
 Trailer Length (open).....22'8"
 Sleeps.....7

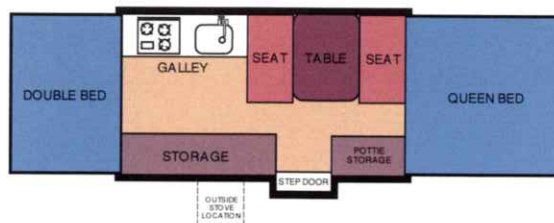

CHESAPEAKE CP™

Towing Height.....47"
 Base Vehicle Weight.....1595 lbs
 Trailer Length (open).....22'8"
 Sleeps.....7

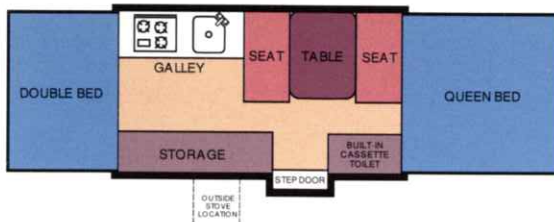

COLUMBIA®

Towing Height.....47"
 Base Vehicle Weight.....1150 lbs
 Trailer Length (open).....18'
 Sleeps.....6

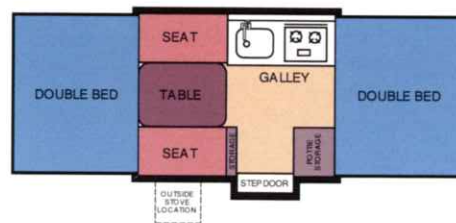

Refer to the back page for additional specifications.

New Toll-Free Number to Reserve Campsites

The U.S. Forest Service has a new toll-free number for reserving campsites at its 156 national forests and grasslands around the country.

Reservations made through the number cost \$7.50 for family sites and \$15 for group sites, plus the daily camping fee which ranges from \$6 to \$18 per night.

The reservations number is :

800-280-2267





1

1 The new **Stony Creek** provides plenty of room for everyone with extra seating and sleeping space – including two full queen beds! 2 Enjoying the great outdoors, even in the back yard as an extra room, with the new **Stony Creek**. 3 The 1995 **Stony Creek** features a large gaucho which folds out into a comfortable bed. 4 **Stony Creek's** new large table provides room for the entire family.



4



2

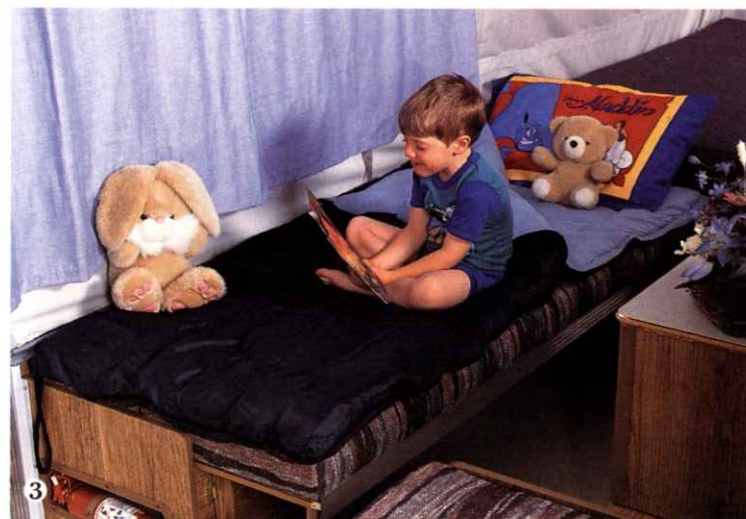

3

Pocket Stew

For each serving, place a hamburger patty in the center of a square of heavy-duty aluminum foil. Add seasoning and cover with thinly sliced potatoes, onions, carrots and peas. Top with a slice of bacon. Fold the ends of the foil under until thickened handles are formed. Lay on a bed of coals and turn as needed for 15 to 20 minutes. Slit open the package and enjoy.

●
Candle sections wrapped in cheese cloth make excellent campfire starters.

●
Always take along some square pieces of wood. They may come in handy for leveling your trailer, or as a footing for the stabilizers when setting up on soft ground.

●
An acre of forest produces enough oxygen for 18 people for 1 year.



1 The **Rio Grande** features a large 17 cu. ft. storage trunk that is accessible with the top down. 2 When the bed is extended, access is through hatches on either side of the trailer... 3 ...or through a sliding door on the interior of the camper. 4 Two large sliding pantries on either side of the storage access door are perfect for stowing jars and canned goods. 5 Enjoy great family value with the spirit of adventure in the 1995 **Rio Grande**. You can take it all with you in the easy to access front storage trunk. 6 The 1995 **Royale** interior features side dinette seating with both a double and queen bed – plenty of space to set up for that early morning or afternoon fishing excursion. 7 The Destiny portable inside/outside stove. 8 This conveniently located built-in cooler offers 57 quarts of storage. 9 The 1995 **Royale** features economical and easy towing.

Deluxe Destiny Features

- ✓ Posi-Lock Lift System
- ✓ Hands-Free Water Faucet
- ✓ Portable Dinette Table
- ✓ Full Storage Upper and Lower Galley

Optional Destiny Convenience Pack

- ✓ Spare Tire
- ✓ Tire Cover
- ✓ Gas Bottle Cover
- ✓ Step
- ✓ Two Sets of Privacy Curtains.

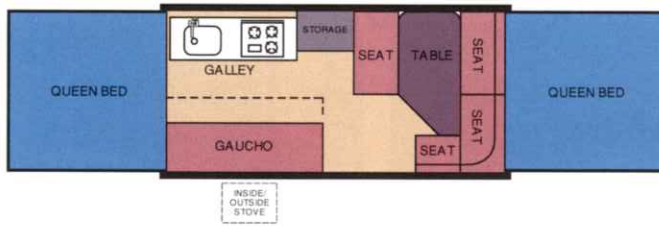

STONY CREEK™

Towing Height.....47"
 Base Vehicle Weight1595 lbs
 Trailer Length (open)25'8"
 Sleeps.....9

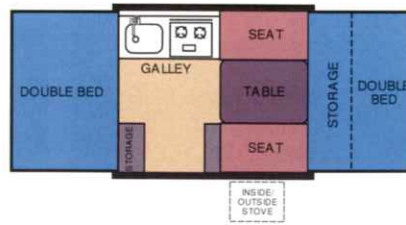

CEDAR XL™

Towing Height.....47"
 Base Vehicle Weight1255 lbs
 Trailer Length (open)17'
 Sleeps.....6

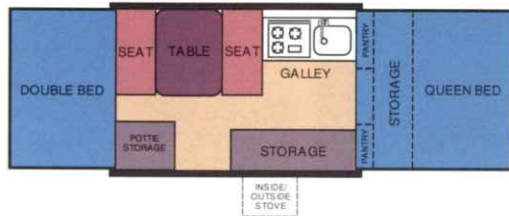

RIO GRANDE™

Towing Height.....47"
 Base Vehicle Weight1460 lbs
 Trailer Length (open)21'
 Sleeps.....7

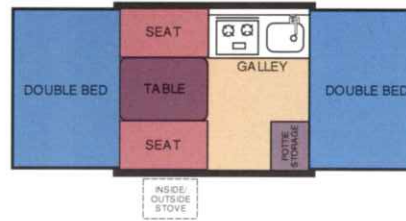

CEDAR®

Towing Height.....45"
 Base Vehicle Weight995 lbs
 Trailer Length (open)17'
 Sleeps.....6

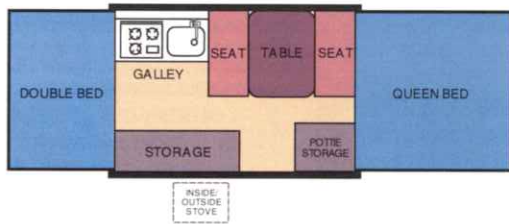

ROYALE®

Towing Height.....47"
 Base Vehicle Weight1295 lbs
 Trailer Length (open)21'
 Sleeps.....7

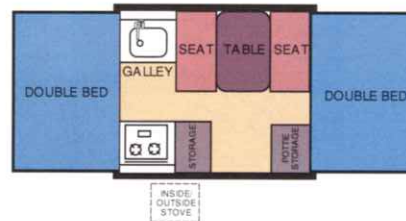

ROANOKE®

Towing Height.....45"
 Base Vehicle Weight995 lbs
 Trailer Length (open)17'
 Sleeps.....6



Easy Camp Cooking

Try this tip when making eggs at your next camp out: Halve an orange and eat the fruit, keeping the skins intact. Crack one egg into each empty, halved orange peel, drop in a pat of butter and add some salt and pepper. Place these organic pots on the fire where they'll stay upright and level. Keep an eye on them and before you know it, you'll have eggs for breakfast, and no dirty pans!

A canopy is an important multi-function addition to your camper. Not only will the canopy provide shade on a sunny day, but it will provide shelter from rain and keep the area in front of your trailer from getting muddy.



Every Coleman® Trailer Has These Standard Features

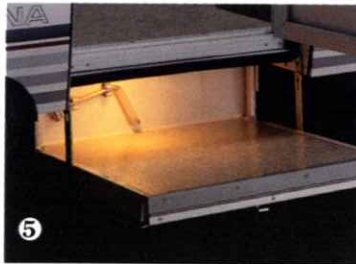
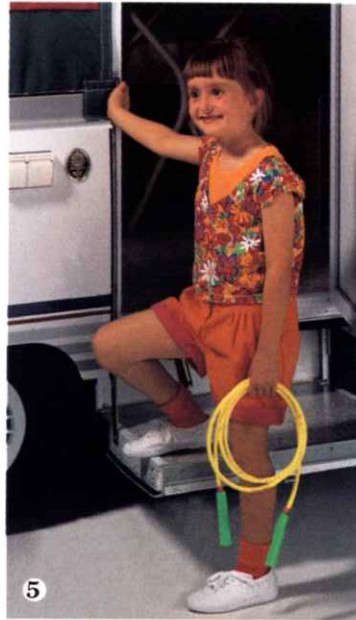

Product information and photography included in this brochure were as accurate as possible at the time of publication. Subsequent refinements may be evident in the final product. Prices and specifications are subject to change without notice. Selected decorator items shown in the photographs are not part of the product unless specified. All liquid capacities are approximate and dimensions are nominal.

1 All Coleman tables provide spacious dinette seating with the added benefit of total portability for use indoors or out. 2 All models feature Porta Potti® storage areas (except trailers with built-in cassette toilet). 3 This convenient outside electrical receptacle is handy when you want to plug in a portable radio, light, or other item. 4 For hands-free washing, this ingenious water faucet hold-down lever does the trick. 5 The exclusive, patented Coleman Stepper™ Door is lighted for nighttime safety and positioned at just the right

height for entry convenience (except on Destiny models). 6 All Coleman folding trailers offer an incredible amount of headroom above the beds for your personal comfort. 7 This tongue dolly jack easily swivels down for unhitching, and makes maneuvering your camper a snap! Swivel it back up and it automatically locks in place for towing. 8 The Coleman one-piece full view design, all-aluminum screened entry door features lightweight, and easy set-up. Plus, a zip-lock bug proof seal and automatic spring-tension return.

Not All Lifetime Warranties Are The Same

Be Sure To Read The Fine Print

Not all Lifetime Warranties are the same. Just compare our straight-forward product guarantee to that of any other manufacturer.

Fleetwood's Limited Lifetime Warranty guarantees the structural integrity of the lift system, floor & bed structure wood material, and steel frame (this includes parts, labor & freight) to the original purchaser. In addition, the roof is covered by a five-year limited warranty. Our Sunbrella® 302 acrylic tenting material carries a five-year limited warranty to the original purchaser. Other manufacturer's who claim to be equal don't include free freight or the hassle free customer service.

We Guarantee Our Quality Construction

Fleetwood's patented fail-safe lift system operates smoothly every time because the integral telescoping lifters and main cables are made of heavy gauge stainless steel to prevent binding or rusting.

Fleetwood folding trailers feature one-piece wood floors that are thicker than any competitive product. Specially manufactured for the RV industry, with exterior grade adhesive, one-piece O.S.B. provides foot comfort, insulation and quality seamless construction. All Fleetwood beds feature the same seamless one-piece quality construction.

For maximum protection from the elements, Fleetwood roof construction consists of an aluminum bonded insulated sandwich panel

with single seam design.

Fleetwood roofs are warranted for five full years for parts, labor, and freight.

State of the Art Tenting Material

Another added benefit for your camping comfort is that all Fleetwood trailers feature state-of-the-art Sunbrella® 302 acrylic tent material. Sunbrella® 302, tenting won't mildew or dry rot. The fabric's unique breathability allows humidity and cooking odors to escape, while keeping rain out. Sunbrella® 302 tenting is extremely strong and durable to stand up against tears, rips and punctures. It also resists stains and acid rain damage.

We Start With A Sturdy Foundation

A good sound foundation is as important to a folding trailer as it is to your own home. That is why Fleetwood uses high quality, high strength (ASTM A500 Grade B) tubular steel frame for the main load carrying members in the frame. The corner bulkheads are also made of steel, not wood. They are interlocked with the frame and the aluminum body rails to provide an exclusive full perimeter skeletal framework. This skeletal framework provides sound structural support for the rest of the trailer. The frame for all Fleetwood trailers offers a limited lifetime warranty to the original purchaser. Our warranty includes parts and labor coverage and even **freight to ship the parts.**

The Fleetwood Folding Trailer Warranty: The Absolute Best!

LIMITED LIFETIME WARRANTY

No other manufacturer builds uncompromising quality into their trailers like Fleetwood. And that's why we can offer a **Limited Lifetime Warranty** on many major structural components. It's the best product guarantee in the industry. The closer you look...the more quality you see. Ask your Fleetwood dealer for complete details.

(Warranty available to the original purchaser in the USA and Canada only.)

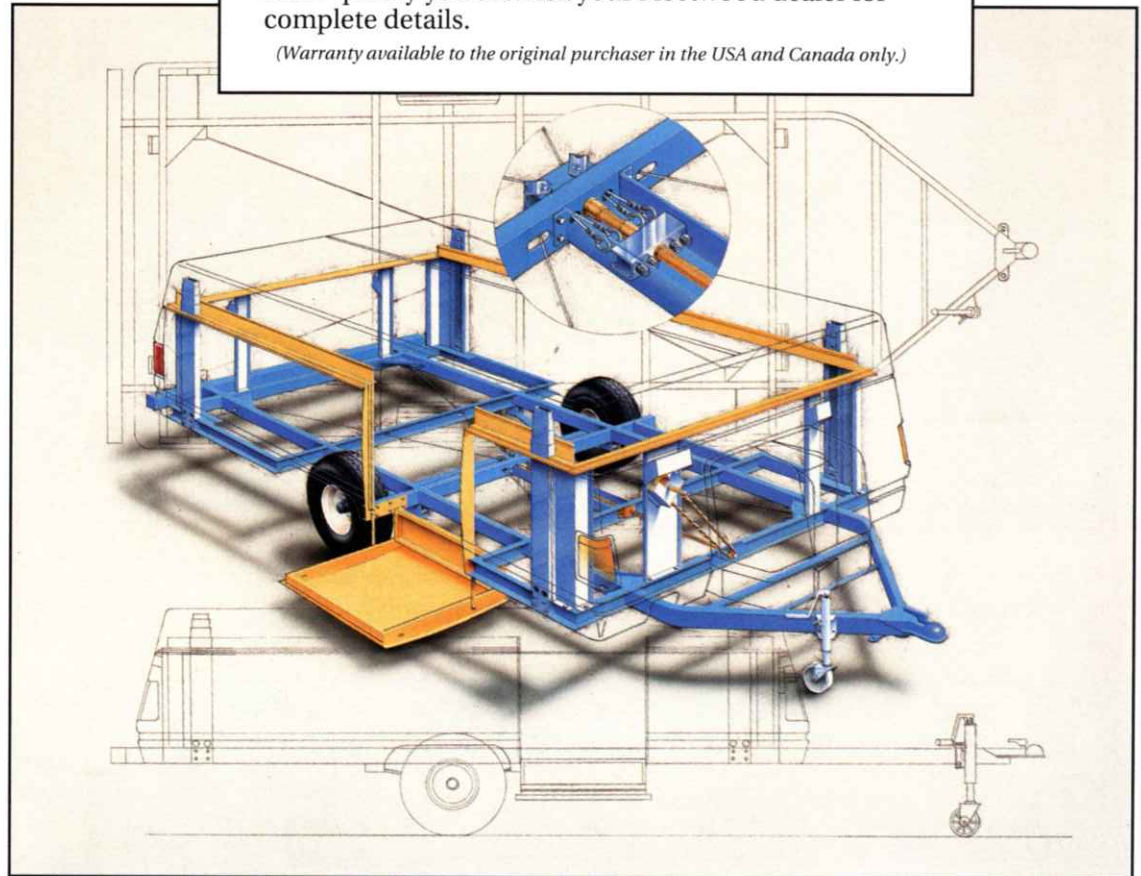

Fleetwood features an interlocking, full-perimeter skeletal framework of riveted and welded aluminum and steel that is exclusive and unique to Fleetwood folding trailers. Would you rather tow a strong, yet lightweight full perimeter frame, or a screwed and stapled soft pine wood box ...uncompromising quality provides lasting value.

Water Hold-Down Lever – allows "hands-free" constant flow of water to make mealtime preparation and clean up a snap

Headroom – a full 36" of headroom means you can sit upright in bed without hitting your head

Maximum Storage Galley – more convenient and usable storage area than in any competitive product

Bed Heights – bed height is convenient and ideal for extra seating with high density foam for maximum comfort & support

Enviro-Cure® Foam – an environmentally safe, consistently higher quality foam produced from a unique, uniform compression process; standard on all Coleman beds

Impact Resistant Front & Rear ABS Plastic Panels – protection from stones and road gravel

Krystal-Kote® Finish Side Body Panels – resists marring and scratching

Superior Side Wall Construction – aircraft/automotive-type double wall construction for durability, strength and light weight

Subfloor Construction – specially manufactured for the RV industry with exterior grade adhesive, Coleman offers one-piece O.S.B. wood flooring that is thicker than any competitive product.

Wheel Wells – seamless, polyethylene plastic wheel wells won't rust or dent

Steppertite™ – provides illumination at the doorstep entrance for nighttime safety (Americana, Pioneer and Four Seasons models)

Self-Storing Stepper Door™ – a safe, wide and sturdy step, positioned low enough for children, a Fleetwood exclusive feature! (Americana, Pioneer and Four Seasons models)

Lifter Cable – 1/8" diameter stainless steel aircraft cable; double the thickness of most competitors

Lifter Arm – heavy-gauge stainless steellift arm that won't rust or bind.

Undercarriage Perimeter – rugged quality of aircraft riveted and welded construction

Wood Cabinetry & Decorator Hardware – attractive, yet rugged and easy to maintain

Clear Vinyl Windows – allow more light inside to brighten the living area, especially important on overcast days

Roof Construction – insulated sandwich panel, single seam design for the ultimate protection from the elements

Dinette Construction – 4" thick Enviro-Cure foam, wood-backed bench seating for long-lasting durability and comfort

Lightweight Portable Dinette Table – free-standing so it can be used anywhere

Sunbrella® 302 – resists ultraviolet, mildew, rot, chlorine and atmospheric chemicals

Angled Wing Bed Design – combined with fine mesh screening allows you to keep the privacy end flaps open for cross ventilation, even in a rain storm

Full Perimeter Aluminum Bed Frames – provide consistent, dependable roll-out and roll-in of the beds without warping or binding. Coleman seamless one-piece beds are tested to 1,000 pound capacity (750 lb. on Destiny)

Permanently Attached Bed Supports – so they can't be lost or left behind at home or at the campsite

Full Perimeter Tubular Steel Chassis – for strength, durability and reliability

Construction

No One Builds Folding Trailers Like Fleetwood. The Closer You Look... The More Quality You See!

Why do you see **more** Coleman folding trailers on the road than **any** other brand? Style, built to last and innovative design have a lot to do with it. But perhaps the greatest reason of all is because the Coleman model you're considering has **enduring value!** Over the long haul, a 20-year old Coleman Folding Trailer is still worth 42% of its original retail selling price.*

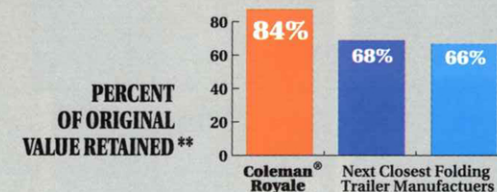

* Source: 1994 NADA January through April
** Based on suggested retail prices, new and used, as published in the January through April 1994 NADA Appraisal Guide.



Durable, Long Life Sunbrella® 302 Fabric Provides Greater Benefits

• **Long Lasting Durability** - Sunbrella® 302 is made from the same acrylic fiber as awnings, boat fabrics and convertible car tops for long lasting durability and toughness. Sunbrella® 302 resists ultraviolet, mildew, rot, chlorine and atmospheric chemicals.

• **Comfortable in All Weather** - Sunbrella® 302 has breathable freshness for greater comfort in all types of weather.

• **Easy To Clean** - Sunbrella® 302 is coated with a DuPont Teflon® soil and stain resistant finish that makes cleanup a breeze. To spot wash, just sponge briskly with a soapy solution of Ivory Liquid or Joy in lukewarm water, then sponge thoroughly with clear water and allow to air dry.



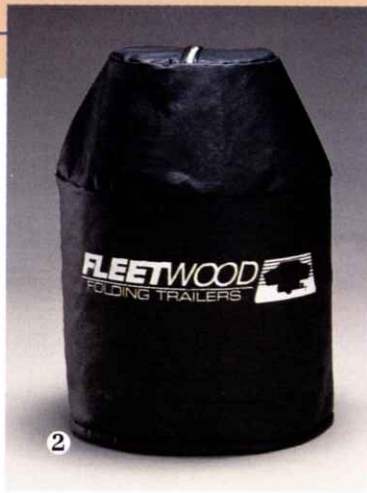

1 The large Coleman® Convertible Cooler can be used upright with slide-in food storage shelves, or pull out the shelves and use it chest-style (standard on all Americana and Four Seasons). 2 Protect your LP bottles from road grime, while adding the finishing touch to the front of your camper with a vinyl or ABS cover (depending on trailer model). 3 Nearly double the size of your camper with this canopy and screen room combination. Coleman screen rooms also feature privacy panels (see page 9 for canopy only). 4 Roof rack with genuine Yakima® bike carriers, cargo baskets and other roof top accessories. 5 You'll appreciate the convenience of this rugged, self-storing entry step on your Destiny model (Pioneer, Four Seasons and Americana models feature a Stepper® door as standard equipment). 6 Add a little extra style to your Coleman folding trailer with these sporty wheel covers (except 12" wheels). 7 Have the convenience of 12V power with this battery mount kit (battery not included). 8 On Pioneer and Destiny models, covering the spare tire protects the tire from road grime and the damaging effects of the sun's UV rays.



Accessories



Coleman  
FOLDING TRAILERS BY **FLEETWOOD**



19



1 A set of privacy curtains featuring top netting to allow unobstructed cooling and heating air flow, and a portable bed light are the perfect accessories for late night reading when you don't want to disturb your guests or the kids. **2** This handy CamperCaddie™ makes trip preparation a snap. Pack it like a suitcase. Roll it up and pop it in the camper or your trunk. When you set up camp, simply unroll it and hang it right up. **3** This 1.5 cu. ft. Dometic® three-way refrigerator operates on LP gas, 120V or 12V power supplies. **4** Keep cool with roof mounted air conditioning (see your dealer for proper sizing and cooling requirements). **5** Choose an energy efficient 12,000 or 18,000 BTU forced air furnace with thermostat control and electronic ignition for convenience and reliability. **6** Looking for a little extra space to hang some clothes? This wardrobe rack is just the ticket.

1995 SPECIFICATIONS

Americana

(Pg. 4)

Four Seasons

(Not available in Canada)
(Pg. 6)

Pioneer

(Pg. 8)

Destiny

(Pg. 11)

Williamsburg[®]

Sequoia[®]

Hatteras[™]

Yosemite[™]

Cape Cod[®]

Arcadia[®]

Avalon[™]

Chesapeake[®]

Chesapeake Cp[™]

Columbia[®]

Stony Creek[™]

Rio Grande[™]

Royale[®]

Cedar XI[™]

Cedar[®]

Roanoke[®]

CONSTRUCTION

Impact Resistant Front & Rear ABS Plastic Panels	S	S	S	S	S	S	S	S	S	S	S	S	S	S	S	S
Bumper or Storage Bumper	SB	SB	B	B	B	O	O	O	O	O	B	B	B	B	B	B
Sunbrella [®] 302 Tenting	S	S	S	S	S	S	S	S	S	S	S	S	S	S	S	S
Hydraulic Lift	S	S	S	S	-	-	-	-	-	-	-	-	-	-	-	-
EZ-Crank Down Stabilizers	S	S	S	S	O	O	O	O	O	O	-	-	-	-	-	-

TOWING

Road Height (inches)	47	47	57	57	57	47	47	47	47	47	47	47	47	45	45	45
Base Vehicle Weight (lbs.)	1795	1760	1895	1895	1795	1490	1760	1445	1595	1150	1595	1460	1295	1255	995	995
Base Hitch Weight (lbs.)	155	165	180	180	185	145	160	125	145	145	150	90	125	80	125	125
Base Axle Weight (lbs.)	1640	1595	1715	1715	1610	1345	1600	1320	1450	1005	1445	1370	1170	1175	870	870
Trailer Size (closed)	6'8" x15'7"	6'8" x15'7"	6'8" x15'	6'8" x15'	6'8" x15'	6'8" x15'2"	6'8" x16'11"	6'8" x15'2"	6'8" x15'2"	6'8" x12'7"	6'8" x16'5"	6'8" x16'5"	6'8" x13'5"	6'8" x14'2"	6'8" x11'5"	6'8" x11'5"
Electric Brakes	S	S	S	S	S	O	S	O	O	O	O	O	O	O	O	O
Tire Size (inches)	20.5x8x10	20.5x8x10	20.5x8x10	20.5x8x10	20.5x8x10	20.5x8x10	20.5x8x10	20.5x8x10	20.5x8x10	20.5x8x10	20.5x8x10	20.5x8x10	5.30x12	5.30x12	5.70x8	5.70x8
Hub Caps	S	S	O	O	O	O	O	O	O	O	O	O	-	-	O	O
Cargo Capacity (not incl. options)	505	540	605	605	505	505	440	665	515	545	515	650	580	620	690	690

LIVING

Sleeping Capacity	7	7	7	7	7	7	8	7	7	6	9	7	7	6	6	6
Trailer Length (open)	22'8"	22'8"	22'2"	22'2"	22'2"	22'8"	22'8"	22'8"	22'8"	18'	25'8"	21'	21'	17'	17'	17'
Living Area (square feet)	129	129	129	129	129	129	129	129	129	93	141	114	114	90	90	90
Interior Height (open)	6'7"	6'7"	7'1"	7'1"	7'1"	6'7"	6'7"	6'7"	6'7"	6'7"	6'7"	6'7"	6'7"	6'7"	6'7"	6'7"
Overhead Dome Lights	4	4	4	4	4	2	2	2	2	2	2	2	2	2	2	2
Built-In Ice Box (quarts)	-	-	-	-	-	-	-	-	-	-	57	57	57	57	57	57
Ice Box/Cooler (quarts)*	68	68	68	68	68	48	48	48	48	48	-	-	-	-	-	-
Outside Shower	-	S	-	-	-	-	-	-	-	-	-	-	-	-	-	-
Tub/Shower/Hot Water Heater	S	-	S	-	-	S	-	-	-	-	-	-	-	-	-	-
Hot Water w/Mixer Faucet/Demand Elec. Water Pump	S	S	S	S	-	S	-	-	S	-	-	-	-	-	-	-
Built-In Cassette Toilet	S	S	S	S	-	-	-	-	S	-	-	-	-	-	-	-
Potti Storage Cabinet (*Porta Potti incl.)	-	-	-	-	S	S*	S	S	-	S	S	S	S	S	S	S
Galley/Swing-Level [®] or Fold Over	SL	SL	SL	SL	SL	SL	SL	SL	SL	SL	FO	FO	FO	FO	FO	FO
Porcelain range w/# of Burners	3	3	3	3	3	3	3	3	3	2	3	3	3	2	2	2
Hi-pressure outside stove w/Shelf	S	S	S	S	S	S	S	S	S	S	-	-	-	-	-	-
Low-pressure inside/outside stove	-	-	-	-	-	-	-	-	-	-	S	S	S	S	S	S
Mattress size (inches)	74x72 51x72	74x72 51x72	74x72 51x72	74x72 51x72	74x72 51x72	74x72 51x72	74x72 51x72	74x72 51x72	74x72 51x72	48x72 48x72	72x72 72x72	72x72 48x72	72x72 48x72	48x72 48x72	48x72 48x72	48x72 48x72
Convertible dinette bed size (inches)	49x74	40x73	49x74	40x70	40x70	39x70	39x70	39x74	39x74	40x74	37x74	39x65	39x65	40x74	40x74	36x58
Gauche Bed Size (inches)	-	-	-	-	-	-	34x74	-	-	-	31x70	-	-	-	-	-
Mattress thickness (inches)	4	4	4	4	4	4	4	4	4	4	3	3	3	3	3	3
Dinette table size (inches)	30x48	30x39	30x48	30x39	30x39	30x39	30x39	30x39	30x39	30x39	30x51	30x36	30x36	30x39	30x39	30x36

STORAGE

Built-in water tank	UF (20 gal.)	UF (20 gal.)	UF (20 gal.)	UF (20 gal.)	10 gal.	10 gal.	-	-	-	-	-	-	-	-	-	-
Portable water tank	-	-	-	-	-	-	10 gal.	10 gal.	10 gal.	10 gal.	10 gal.	5 gal.	5 gal.	5 gal.	5 gal.	5 gal.
Outside ground fault receptacle	S	S	S	S	S	S	S	S	S	S	S	S	S	S	S	S
Cabinet storage (cubic feet)	34	30	37	36	45	38	51	41	33	31	48	55	39	49	29	28
Number of drawers	6	5	3	4	4	2	5	4	4	2	1	5	3	-	-	-
Outside storage access or Storage Trunk	OS	OS	OS	-	-	-	ST	-	-	-	-	ST	-	ST	-	-

*When ordering factory installed refrigeration, the ice chest is omitted

Your local Coleman Folding Trailer dealer is:

FOLDING TRAILER DIVISION
FLEETWOOD FOLDING TRAILERS, INC.
R.D. 2 • Somerset, PA 15501 • 814/445-9661



CORPORATE HEADQUARTERS
FLEETWOOD ENTERPRISES, INC.
P.O. Box 7638 • Riverside, CA 92513-7638

Product information and photography included in this brochure was as accurate as possible at the time of publication. Subsequent refinements may be evident in the final product. Prices and specifications are subject to change without notice. Selected decorator items shown in the photographs are not part of the product unless specified. All liquid capacities are approximate and dimensions are nominal.