

QUALITY INNOVATION SERVICE

# REVEL

**WINNEBAGO**

Treat roads more  
like suggestions.



## Get Out and Stay Out

- **SLEEP & PLAY** The power lift bed allows you to transform your living space into a 140 cu ft. garage – perfect for all toys.
- **OFF-ROAD ON-DEMAND** The 4WD capabilities are harnessed by the new Mercedes-Benz® Sprinter chassis. Performance meets safety with features including low-range electronic stability and traction control, as well as active brake assist, lane-keeping assist, adaptive cruise control, blind spot monitoring, four wheel ABS brakes, and navigation.
- **RELIABLE ROOF RACK** The all-new, durable metal roof rack easily transports all of your gear, so you'll never have to pick from just one adventure of a lifetime.
- **LASTING INTERIOR** Every surface has a purpose. The easy-to-clean, easy-to-maintain flooring, countertop-grade cabinets and ABS plastic wall coverings are built to last.
- **ALL SEASON CAPABLE** Extensive automotive grade insulation and the efficient diesel powered heating system allow you to enjoy any outing, every season\*.

**WEIGHTS | MEASURES**

Length	<b>44E</b>
	19'7"
Exterior Height <sup>1</sup>	10'
Exterior Width	64"
Awning Length	9'6"
Interior Height	6'3"
Interior Width	5'10"
Freshwater Tank Capacity <sup>2</sup> (gal.)	21
Water Heater Capacity (gal.)	Continuous
Cassette Toilet Capacity <sup>2</sup> (gal.)	5
Holding Tank Capacity - Gray <sup>2</sup> (gal.)	21
LP Capacity <sup>3</sup> (gal.)	NA
Fuel Capacity (gal.)	24.5
GCWR <sup>4</sup> (lbs.)	13,550
GVWR (lbs.)	9,050
GAWR - Front (lbs.)	4,101
GAWR - Rear (lbs.)	5,360
Wheelbase	144"

Note: Dimensions shown are for sleeping and shower space only and may vary due to styling differences.

- The height of each model is measured to the top of the tallest standard feature and is based on the curb weight of a typically equipped unit. The actual height of your vehicle may vary by several inches depending on chassis or equipment variations. Please contact your dealer for further information.
- Capacities are based on measurements prior to tank installation. Slight capacity variations can result due to installation applications.
- Capacities shown are tank manufacturer's listed water capacity (W.C.) Actual filled LP capacity is 80% of listing due to overfilling prevention device on tank.

4. Actual towing capacity is dependent upon your particular loading and towing circumstances, which includes the GVWR, GAWR and GCWR as well as adequate trailer brakes. Please refer to the Operator's Manual of your vehicle for further towing information.

\*Disclaimer: Winnebago recommends following the winter use guidelines and winterization procedures outlined in your owner's manual whenever camping in freezing conditions.

Because features, specifications, equipment, and options may vary from those highlighted in this brochure, the buyer is responsible for confirming with the dealer the features, specifications, equipment, and options included on their specific vehicle. In addition, Winnebago's program of continuous product improvement may result in changes to vehicle specifications, equipment, model availability, and price without notice.

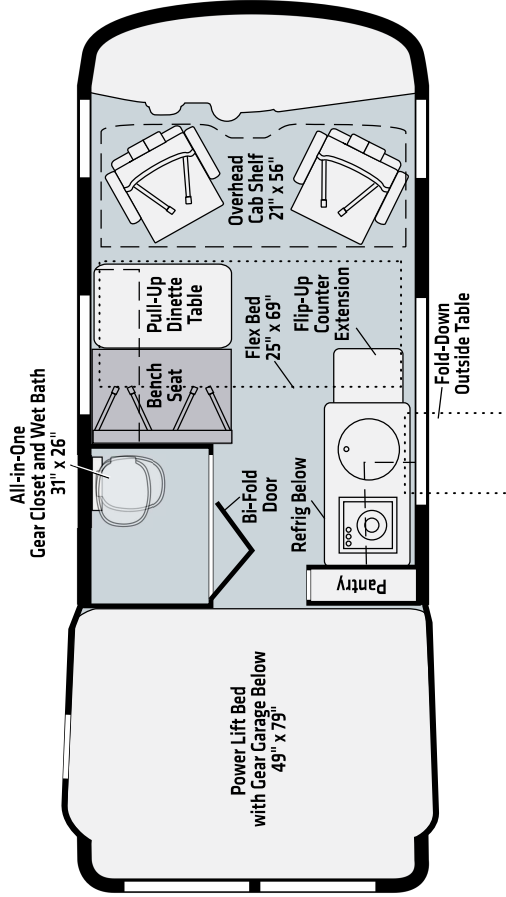

**44E**

- Ultraleather
- Vinyl

Dashed lines denote overhead storage areas. Floorplans and specifications are also available online at [Winnebago.com](http://Winnebago.com)