

# SOLEI



## Why Solei?

- Two attractive floorplans
- Radio/Rearview Monitor System with 6" color touch screen
- LED ceiling lighting
- MCD blackout shades
- Soft vinyl ceilings
- Flex Bed System with bunk beds (38R)
- Powered patio awning
- Home theater sound bar and DVD player
- Polished Corian® countertops and decorative backplash
- Powered visor shade (front windshield)

# SOLEI



Click on this icon throughout the brochure to link to more information on the web.



ON THE COVER: 34T Red Maple Full-Body Paint

34T Falling Star with Coffee-Glazed Honey Cherry Cabinetry

## DIESEL-PUSHER POWER

Kick your motorhome lifestyle into high gear with the all-new Itasca Solei.™ We've done all the hard work to give you a luxury diesel-pusher at an attractive price. The Solei shows off its muscle with a Freightliner® XCS straight-rail chassis featuring a 340-hp Cummins® diesel engine coupled with a six-speed Allison® transmission. Its softer side comes through in the

polished Corian® galley countertops, coffee-glazed cabinetry, LED ceiling lights, and upscale entertainment features. And, with Smart Storage™ as an integral part of both floorplans, you will have plenty of room to bring even more of your favorite things with you. The diesel-pusher you've always wanted is finally within reach with the Itasca Solei.



**RECOGNIZED QUALITY** The RV Dealers Association bestows its annual Quality Circle Award based on dealer ratings to manufacturers that provide exceptional products, service and support. Only one manufacturer has received this award for seventeen consecutive years: Winnebago Industries.®



## BEST IN CLASS

See how Winnebago Industries takes motorhome design and function to the next level, and why we've earned the right to be called the Most Recognized Name in Motorhomes.®



Click on this icon throughout the brochure to link to more information on the web.



The smooth-retracting **MCD Blackout Roller Shades** let you control your light and privacy – no matter the time of day.



The available **+Lounge** passenger seat with a built-in workstation reclines for comfort when you are parked.



The multi-functional **inTable™** does it all: a coffee table or counter extension, end table, or flexible dining for six.



Important gauges, switches and controls are all centrally located in the **OnePlace® Systems Center**.



Keep your clothes fresh and clean wherever you are with the **Available Washer and Dryer**.





34T Falling Star with Coffee-Glazed Honey Cherry Cabinetry

Whether you want a quiet afternoon of reading or a lively night of entertaining, the Solei lounge is a wonderfully versatile space. The soft leatherette furniture is perfect for relaxing and the optional fireplace offers an even cozier setting. The home theater sound bar system and DVD player make for great movie watching. Plus, the LED ceiling lights, soft vinyl ceiling, MCD blackout roller shades and tinted, dual-glazed, thermo-insulated coach windows all add to the luxurious comfort you'll experience.



Home Theater Sound Bar System



Available Electric Fireplace





34T Galley

Preparing delicious meals is even more enjoyable with the generous preparation space and high-end galley features. Desirable amenities include a microwave/convection oven with a range fan, a 3-burner range top, a 2-door residential refrigerator with an icemaker, and extensive storage. Elegance, as well as an



Range Top



Full-Extension Drawer Slides



Refrigerator



Pantry Storage

abundance of preparation space, can be found in the tasteful Corian® countertops, sink covers, and decorative backsplash. With your choice of attractive cabinet finishes, including Coffee-Glazed Honey Cherry or Coffee-Glazed Forest Cherry, you can customize your galley to your own style.





The 34T features an inLounge™ sofa that extends to seat eight guests. Flip up the movable inTable for instant dining. At the end of the meal, roll the inTable back into the utility cabinet with additional storage. A leatherette dinette with seating for four comes standard in the 38R.





34T Bedroom



34T Bedroom Wardrobe

Restful nights are easier in the spacious master bedroom. You'll enjoy the roomy, walk-around queen bed, HDTV, and abundant storage that allows for all your necessities. For even more comfort, take advantage of the available Ideal Rest® Nouveau digital comfort control mattress, which allows you to adjust the firmness and support to your personal preference. A convenient master bathroom equipped with an available washer and dryer completes the 38R.



HDTV



Shower



34T Bathroom





Dash

With Winnebago Industries' signature quality, the Solei cab delivers all the superior comforts one would expect from a luxury diesel-pusher. Leatherette cab seats offer stylish comfort while driving and also swivel to serve as comfortable lounge chairs when parked. Other great features include powered mirrors with sideview cameras, a powered MCD visor shade, and a color rearview camera.



Available SiriusXM™



Powered Mirrors



Cab Seats





Powered Patio and Entrance Awnings



LED Awning Lighting

The Solei makes it easy to set up so you can spend more time enjoying your destination. Features such as the powered patio and entrance awnings and exterior service center make being in the great outdoors comfortable and convenient. For those times when you want to connect your media devices, simply access the exterior entertainment compartment with its TV antenna and 3-way A/V receptacles. The spacious lighted exterior storage compartments make loading and unloading your gear easier than ever.



Exterior Service Station



**Fiberglass Roof** The crowned, one-piece fiberglass roof is backed by a 10-year parts-and-labor roof skin warranty.

**Thermo-Panel® Sidewalls** By layering fiberglass and high-density block foam insulation with welded aluminum support structures, we create some of the industry's strongest, most durable and lightweight sidewalls.

**E-Coating** An electrodeposition coating helps protect critical steel components.

**Embedded Steel** Metal substructures embedded into the sidewall provide solid attachment points to keep cabinets and appliances mounted securely in place.

**Solid Framework** Aluminum extruded in our own facility to our exacting standards creates an extremely strong and solid structural framework.

#### Laser-Cut Tubing

Precision laser cutters create precise joints in structural steel that are stronger and require less welding.



**Interlocking Joints** Specially engineered interlocking joints connect the floor, sidewalls and roof where competitors often rely on simple screws to bear the weight.



# SUPER STRUCTURE

BUILT TO LAST

Every coach—from our smallest Class C to our largest diesel-pusher model—is built to Winnebago Industries'® legendary SuperStructure® construction standards. It's a process developed and refined over more than 50 years of building some of the strongest, most durable coaches in the industry.



**TESTING** Before rolling out of our factories, every coach undergoes an extensive 113-point inspection. Each coach also passes a high-pressure water test that simulates rain at a rate of 50-inches per hour to check for leaks. During the design process, our computer simulations, physical testing center, and rigorous test track ensure each model is built to last.



**DETAILS** At Winnebago Industries, we treat the features you can't see with the same care as the ones you can. Look in the access panels of some of our competitors' coaches and you'll see loose insulation and wires haphazardly strewn about. Winnebago Industries maintains a clean fit and finish throughout so your coach will last for the long haul.



**BUILT IN-HOUSE** We extrude our own aluminum. We rotocast our own plastic components. In fact, we manufacture most of our own parts so they are designed to fit the space, rather than fitting the space to an awkward off-the-shelf component size.



**SUPER  
STRUCTURE**  
BUILT TO LAST

Visit [BetterBuiltRVs.com](http://BetterBuiltRVs.com) to gain real insight into what goes into a Winnebago Industries motorhome.

**TAKE A TOUR** We're proud of our processes, state-of-the-art facilities, and the people who make Winnebago Industries number one. We invite you to visit our complex in Forest City, Iowa, for a first-hand look at the dedication and technology behind every motorhome we build.





Dimensions shown are for sleeping space only and may vary due to styling differences. Dashed lines denote overhead storage areas. Floorplans and specifications are also available online at [Goltasca.com](http://Goltasca.com).



**NEW**  
**34T**

This dual-slideout floorplan offers an optional powered StudioLoft™ bed, the inLounge™ sofa and movable inTable™, a mid-coach bathroom, and a spacious master bedroom.

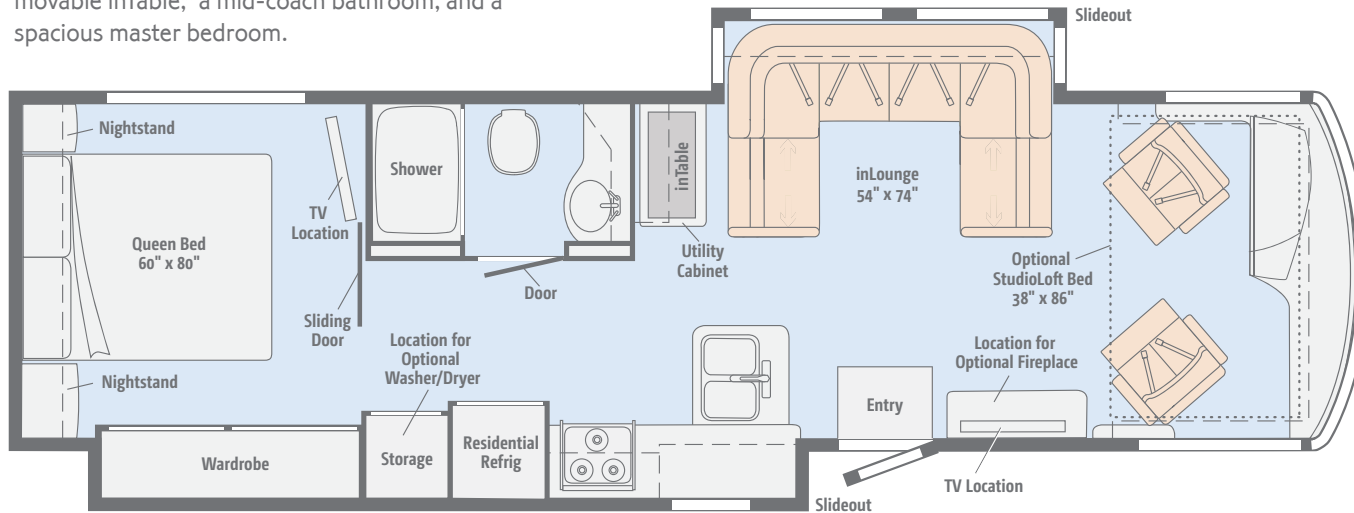



Dimensions shown are for sleeping space only and may vary due to styling differences. Dashed lines denote overhead storage areas. Floorplans and specifications are also available online at [Goltasca.com](http://Goltasca.com).



## NEW 38R

You'll enjoy the open layout of this dual-slideout with its forward galley, angled lounge cabinetry, sofa/sleeper, bunk beds, and master bedroom with a private bath.

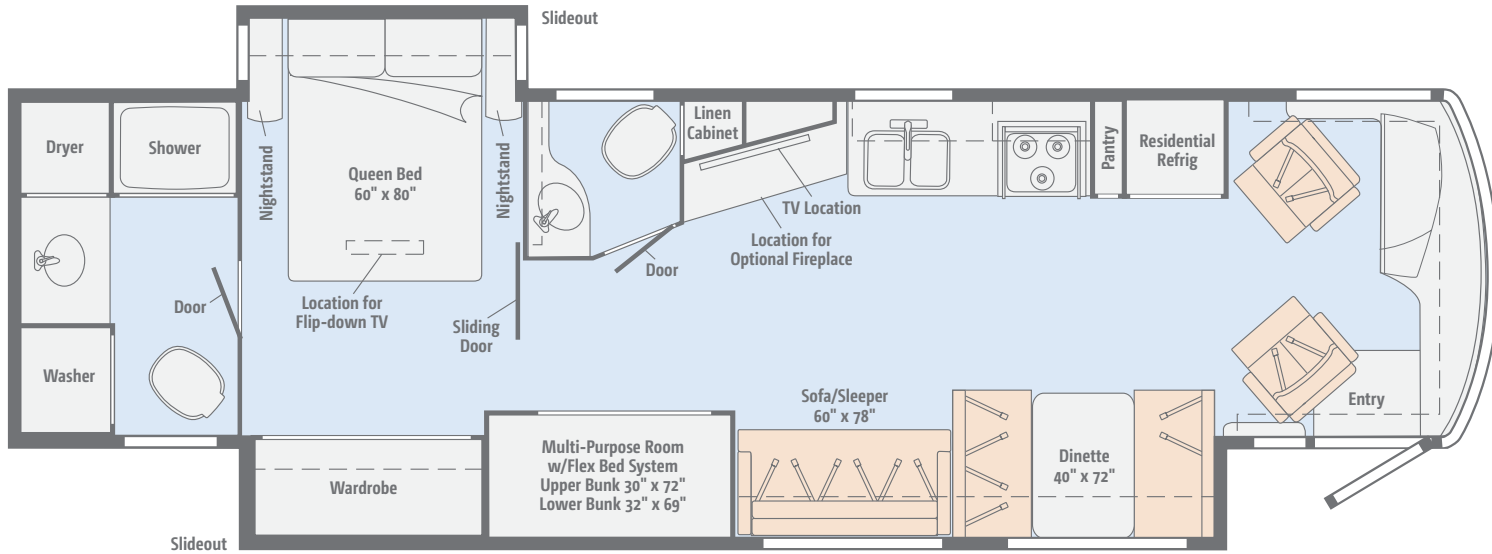



Choose from three fabric collections and two wood finishes, each with Satin Nickel hardware.

# Monument

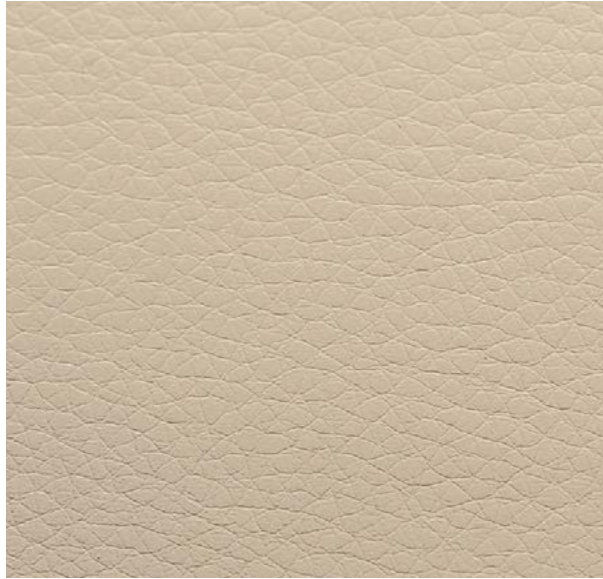

Leatherette



Accent



Bedspread



Corian Countertop



Wall Board



Vinyl Tile



Coffee-Glazed  
Honey Cherry



Coffee-Glazed  
Forest Cherry

Winnebago Industries® reserves the right to change décor materials and specifications without notice or obligation.



Choose from three fabric collections and two wood finishes, each with Satin Nickel hardware.

# Falling Star



Leatherette



Accent



Bedspread



Corian Countertop



Wall Board



Vinyl Tile



Coffee-Glazed  
Honey Cherry



Coffee-Glazed  
Forest Cherry

Winnebago Industries® reserves the right to change décor materials and specifications without notice or obligation.

Choose from three fabric collections and two wood finishes, each with Satin Nickel hardware.

# Biscotti

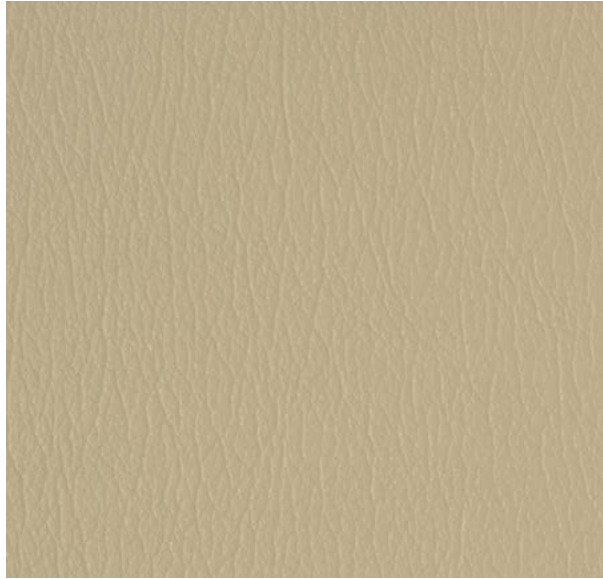

Leatherette



Accent



Bedspread



Corian Countertop



Wall Board



Vinyl Tile



Coffee-Glazed  
Honey Cherry



Coffee-Glazed  
Forest Cherry

Winnebago Industries® reserves the right to change décor materials and specifications without notice or obligation.



Choose from four stylish full-body paint options.



Red Maple  
FULL-BODY PAINT



Windveil  
FULL-BODY PAINT



Amber  
FULL-BODY PAINT



Copper  
FULL-BODY PAINT

## Weights & Measures

	34T	38R
Length	35'6"	39'10"
Exterior Height <sup>1</sup>	12'	11'10"
Exterior Width <sup>2</sup>	8'5.5"	8'5.5"
Exterior Storage <sup>3</sup> (cu. ft.)	153	228
Awning Length	17'/6'2"	20'
Interior Height	6'8"	6'8"
Interior Width	8'0.5"	8'0.5"
Freshwater Tank Capacity <sup>4</sup> (gal.)	84	84
Water Heater Capacity (gal.)	6	10
Holding Tank Capacity - Black/Gray <sup>4</sup> (gal.)	48/54	48/54
LP Capacity <sup>5</sup> (gal.)	23	23
Fuel Capacity (gal.)	90	90
GCWR <sup>6</sup> (lbs.)	30,000	33,000
GVWR (lbs.)	26,000	27,910
GAWR - Front (lbs.)	10,410	10,410
GAWR - Rear (lbs.)	17,500	17,500
Wheelbase	208"	260"

## Freightliner® XCS Chassis

- 340-hp Cummins® ISB 6.7L turbo-charged engine
- Allison® 6-speed automatic 2100 MH transmission (34T)
- Allison 6-speed automatic 2500 MH transmission (38R)
- Information display center
- Rear radiator
- NeWay® front and rear air suspension
- 160-amp. alternator
- Air brakes w/ABS
- Engine exhaust brake
- Automatic hydraulic leveling jacks
- 7-pin trailer wiring
- Trailer Hitch® 5,000-lb. drawbar/500-lb. maximum vertical tongue weight
- Stainless steel wheel liners (34T)
- Stylized aluminum wheels (38R)



Freightliner XCS Chassis

## Cab Conveniences

**Cab seats** adjustable armrests, lumbar support, and multi-adjustable recline

**6-way power driver seat & passenger seats**

**3-point seat belts**

**Radio/Rearview Monitor System** 6" LCD color touch screen, remote, iPod®/MP3 input, rear color camera

**Cruise control**

**12-volt powerpoints**

**Powered MCD blackout roller visor/shades** (front windshield)

**MCD blackout roller shades** (driver and passenger windows)

**Chassis/house battery radio power switch**

**Power mirrors w/defrost and sideview camera**

**Power steering**

**Powered stepwell cover** (38R)

**Map lights**

**C.B. wire prep**

**TRW® tilt/telescopic steering column w/foot-actuated pedal**

### *Optional Equipment*

+Lounge passenger cab seat w/flip-up workstation

SiriusXM™ (subscription not included), iPod interface connector, receiver, remote

## Interior

**46" HDTV** (34T)

**50" HDTV** (38R)

**Home theater sound bar system**

**DVD player**

**Satellite system ready**



Digital TV amplified antenna system

LED ceiling lights

Slideroom lock system (activated w/ignition key)

MCD blackout roller shades

Soft vinyl ceiling

OnePlace® systems center

Tinted, dual-glazed, thermo-insulated coach windows

Powered ventilator fan (galley, bath(s))

Washer and dryer prep

Charging station (38R)

### Optional Equipment

Washer and dryer

Electric fireplace

StudioLoft™ w/privacy curtain (34T)

Winegard® Trav'ler® automatic HDTV satellite antenna

48" HDTV (34T)

## Galley

Corian® countertops and decorative backsplash

2-door residential refrigerator/freezer w/ice maker

Microwave/convection oven w/range fan

3-burner range top w/storage below

Corian range and sink covers

## Bath

Laminate countertop

Flexible showerhead

One-piece fiberglass shower surround

Textured glass shower door

Skylight

Porcelain toilet

## Bedroom

28" HDTV (38R)

32" HDTV (34T)

Queen bed w/innerspring mattress

Bedsread and pillow shams

### Optional Equipment

Queen Ideal Rest® Nouveau digital comfort control mattress

## Exterior

Powered patio awning w/LED lighting

2nd powered patio awning w/LED lighting (34T)

Exterior compartment 110V duplex, TV antenna and 3-way A/V receptacles

KeyOne® lock system

Porch light (38R)

Powered entrance awning (38R)

Lighted storage compartments

Automatic entrance steps

Lower front protective mask

## Heating & Cooling System

Two 13,500 BTU roof-mounted air conditioners (one A/C only, one A/C w/heat pump) (34T)

Two 15,000 BTU roof-mounted air conditioners (one A/C only, one A/C w/heat pump) (38R)

35,000 BTU ducted furnace (34T)

40,000 BTU ducted furnace (38R)

## Electrical System

Service Center cable TV input, 50-amp. power cord, shoreline/generator automatic changeover switch, portable satellite hookup

2,000-watt inverter/charger w/remote panel with coach battery disconnect switch

6,000-watt Cummins Onan® Quiet Diesel™ generator

Auxiliary start circuit

AC/DC electrical distribution system

Four deep-cycle Group 31 marine/RV AGM batteries

Battery disconnect system (coach and chassis)

PowerLine® Energy Management System

Automatic dual-battery charge control

Chassis battery charger/maintainer

## Plumbing System

Service Center pressurized city water hookup w/diverter fill, fresh water drain, drainage valves, exterior wash station w/pump switch, holding-tank flushing system, 20' sewer hose

On-demand water pump

6-gallon LP water heater w/electric ignition (34T)

10-gallon LP water heater w/electric ignition (38R)

TrueLevel™ holding-tank monitoring system

Full-coach water filtration system

Permanent-mount LP tank w/gauge

Heated holding-tank compartment

## Safety

LP, smoke, and carbon monoxide detectors

10 BC fire extinguisher

Ground fault interrupter

High-mount brake lamps

Daytime running lamps

## Warranty<sup>7</sup>

12-month/15,000-mile basic limited warranty<sup>8</sup>

36-month/36,000-mile limited warranty on structure<sup>8</sup>

10-year limited parts-and-labor warranty on roof skin<sup>8</sup>

- The height of each model is measured to the top of the tallest standard feature and is based on the curb weight of a typically equipped unit. The actual height of your vehicle may vary by several inches depending on chassis or equipment variations. Please contact your dealer for further information.
- Floorplans feature a wide-body design - over 96". In making your purchase decision, you should be aware that some states restrict access on some or all state roads to 96" in body width. Before making your purchase decision, you should confirm the road usage laws in the states of interest to you.
- The load capacity of your motorhome is designated by weight, not by volume, so you cannot necessarily use all available space when loading your motorhome.
- Capacities are based on measurements prior to tank installation. Slight capacity variations can result due to installation applications.
- Capacities shown are tank manufacturer's listed water capacity (W.C.). Actual filled LP capacity is 80% of listing due to overfilling prevention device on tank.
- Actual towing capacity is dependent on your particular loading and towing circumstances which includes the GVWR, GAWR, and GCWR, as well as adequate trailer brakes. Please refer to the Operator's Manual of your vehicle for further towing information.
- See separate chassis warranty.
- See your dealer for complete warranty information.

Winnebago Industries® continuing program of product improvement makes specifications, equipment, model availability, and prices subject to change without notice. Published content reflects the most current product information at time of printing. Please consult your dealer for individual vehicle features and specifications.

GOITASCA.COM  
HAS ALL THE ANSWERS



Visit **GoItasca.com** on your computer, smartphone or tablet for the latest product information and updates.

COMMITTED TO SERVICE

 **PREFERRED CARE PROGRAM**

We back our motorhomes with best-in-class support both before and after the sale:

- 12-month/15,000-mile basic limited warranty
- 36-month/36,000-mile limited warranty on structure
- 10-year limited parts-and-labor warranty on roof skin
- Complimentary 24-hour roadside assistance program



**TRIP**Saver  
FAST TRACK PARTS

- TripSaver® Fast Track Parts guarantees that in-stock warranty parts ship directly to your dealer within 24 hours
- National dealer service network

 **Premium ROADSIDE ASSISTANCE**



**WIT CLUB**

JOIN THE CLUB, JOIN THE FUN

As an Itasca motorhome owner, you are invited to join the WIT Club. It's a great way to take full advantage of your new coach and meet fun-loving WIT Club members from across the country who make motorhome adventures a way of life.



**Members enjoy:**

- Caravans and rallies
- Newsletters
- Local and state group activities
- RV travel benefits

See more at **WITclub.com**

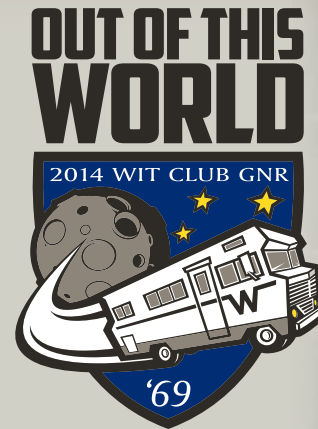

GRAND NATIONAL RALLY

In 1969, two things happened: Neil Armstrong took mankind's first steps on the moon, and Winnebago Industries' WIT Club launched its first Grand National Rally in Forest City, Iowa. Every year since then, thousands of rally-goers connect with old friends to enjoy concerts, tours, activities, and more. Blast off for an adventurous week in July to celebrate 45 years of interstate land roving at the 2014 "Out of This World" Grand National Rally. It's a mission you'll never forget!