

2005 JAY FLIGHT Travel Trailers and Fifth Wheels

**JAY FLIGHT™**  
by Jayco®

Make miles of memories.



America's Best Selling Travel Trailers and Fifth Wheels!

  
www.jayco.com

**JAY FLIGHT**  
by Jayco

Make a splash. Make a joke. Make a memory.

Childhoods speed by ever so quickly. Make the most of every moment with a Jay Flight travel trailer. You'll always be equipped with the comforts of home and ready to explore the adventures of nature. Get together. Get moving.

Make miles of memories.



**Visit Mother Nature.**

A Jay Flight puts the great outdoors at your doorstep. Take the kids hiking, swimming, or fishing, knowing that your home away from home — complete with beds, their favorite toys, and a clean bathroom — is nearby.

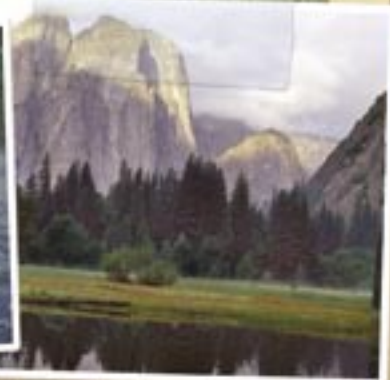

FAMILY OWNED. FAMILY FOCUSED.



**Relax and reconnect.**

Everything you need is at your fingertips, designed to be cozy and family-friendly. There's no better place for early morning pancakes, afternoon naps, or late night board games.

**Go far. Get close.**

For a week or a weekend, take off with your Jay Flight and hit the road. Every mile brings new sights to see and old stories to share.

**A** Distinctive window valances with wood appliques create the perfect frames for nature's beauty. **B** The silverware drawer features real wood, not plastic tubs. **C** Handy covers for the kitchen sink and range, included in the Customer Value Package, give you more counter space.

# JAY FLIGHT

by Jayco

Catch a butterfly. Catch a sunrise. Catch a memory.



## Wash away the day.

After the kids catch those fish and dig in the dirt, you'll appreciate this sparkling bathroom for freshening up.



## Cook up some smiles.

Outdoor adventures work up the appetite. Fix everybody's favorites in the efficiently designed, well-equipped kitchen.





A



B



C

**Retreat in comfort.**

The master bedroom surrounds you with beautiful and convenient touches.

- A** A flip-down TV shelf with cable hookup lets you enjoy shows while relaxing in the bedroom.
- B** Shirt wardrobes, part of the Customer Value Package, provide ample storage.
- C** Give your kids their own space with your choice of bunk bed configurations (see floorplans for details).
- D** Pack away the family's extra gear in the roomy exterior storage compartments.



D

**JAY FLIGHT**  
by Jayco

Build a campfire. Build a sandcastle. Build a memory.

Children build many things on vacation, from new outdoor skills to stronger family relationships. Make the most of these fun-filled adventures by vacationing in a Jayco Jay Flight fifth wheel. Explore together. Laugh together.

Make miles of memories.

Rest and rejuvenate.

You'll drift away in comfort in the inviting bedroom featuring a queen innerspring mattress and plush carpeting, both standard. Add even more beauty with the coordinated, quilted bedspread (included in the Customer Value Package).





A



B



C

**A** Day or night, the residential-style J-Steel™ convertible sofa provides cozy comfort. It folds down easily from a sofa into a twin-size bed. **B** Part of the Customer Value Package, the bathroom attic fan operates easily with the wall switch. **C** Stay cool and comfortable with the 13,500-BTU central A/C in the Customer Value Package and standard adjustable vents.

**Live it up.**



Stretch out, kick back, eat up. Whatever it's time for, you'll find the perfect spot inside a Jay Flight fifth wheel. All the furniture is designed and manufactured by Jayco, and feels as good as it looks.

**Fix a feast.**



There's plenty of room for everything in the handy kitchen, from an extra wide pantry to a built-in spice rack under the sink. The standard oak raised panel cabinet doors and refrigerator front panels will provide a feast for the eyes.



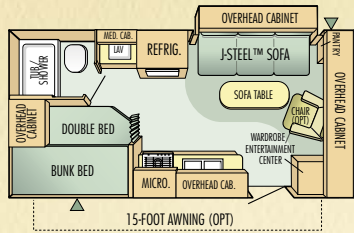

**19 RBS**

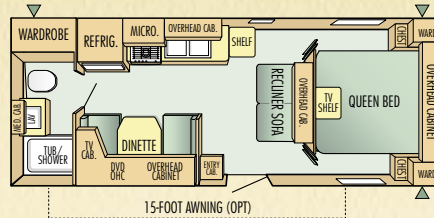

**23 FB** *New for 2005!*

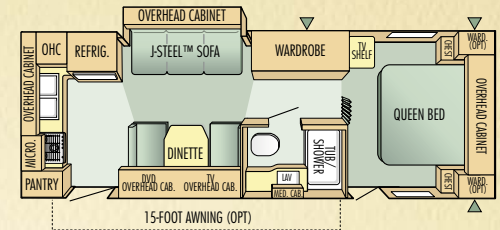

**25 RKS**

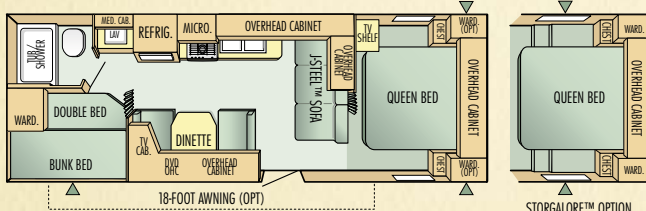

**27 BH**



STORGLORÉ™ OPTION

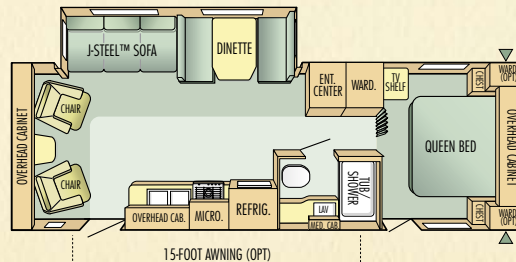

**28 RLS**

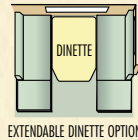

EXTENDABLE DINETTE OPTION

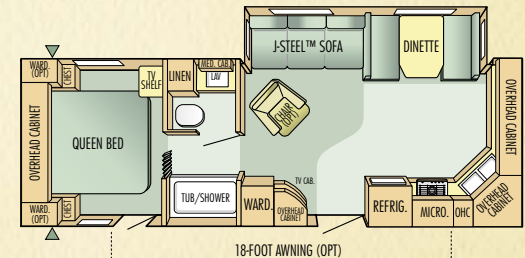

**28 FKS**



EXTENDABLE DINETTE OPTION

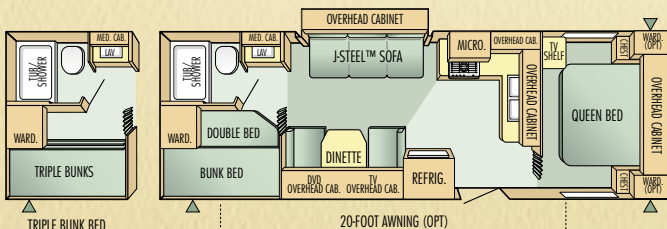

**29 BHS**

TRIPLE BUNK BED OPTION

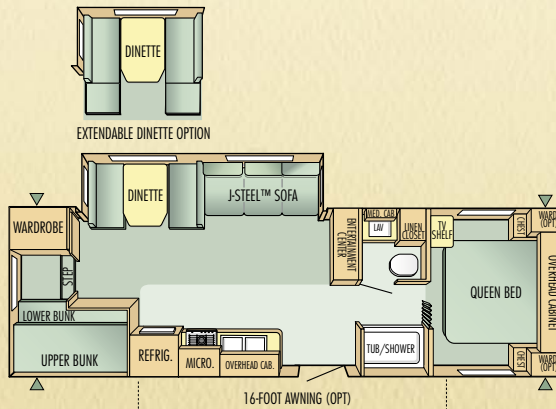

**29 FBS**



EXTENDABLE DINETTE OPTION

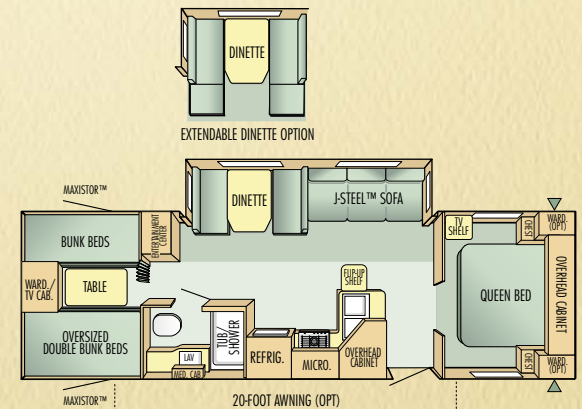

**31 BHS**



EXTENDABLE DINETTE OPTION



# Fifth Wheel Floorplans

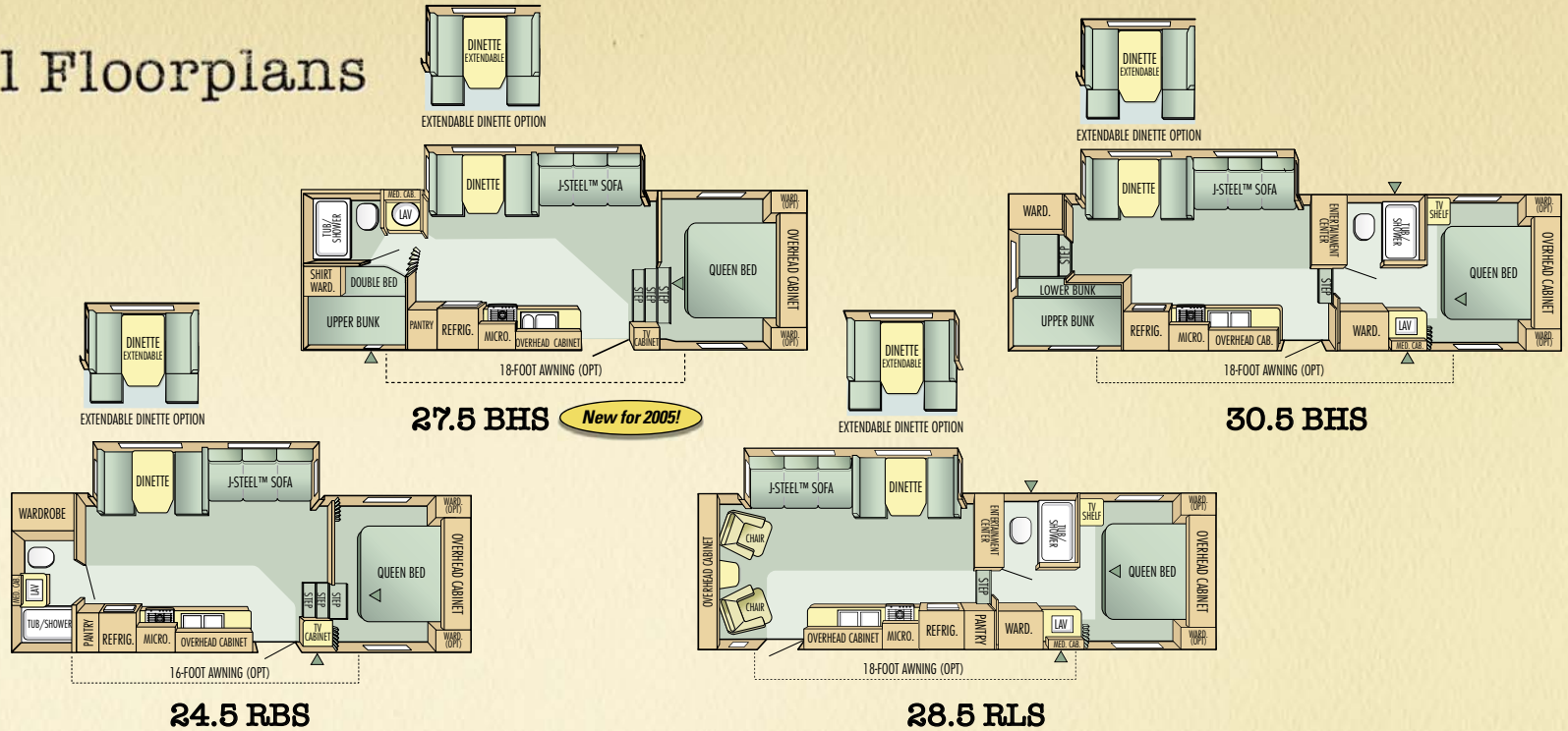

Travel Trailers	Exterior Length	Exterior Height	Bedroom Interior Height	Unloaded Vehicle Weight (lbs.)	Dry Hitch Weight (lbs.)	Gross Vehicle Weight Rating (lbs.)	Cargo Carrying Capacity (lbs.)	Fresh Water Capacity (gal.) Includes Water Heater	Gray Wastewater Capacity (gal.)	Toilet/Black Wastewater Capacity (gal.)
19 RBS	22'	127"	81"	4470	600	6000	1530	37	32	32
23 FB	26'-1"*	126"	81"	4837*	634*	7500*	2663*	37*	32*	32*
25 RKS	28'-3"	126"	81"	5315	590	7500	2185	59	32	32
27 BH	29'-1"	126"	81"	4950	585	7500	2550	37	32	32
28 RLS	30'-8"	133"	81"	6530	760	8500	1970	46	32	32
28 FKS	29'-8"	135"	81"	6555	1135	8500	1945	46	65	32
29 BHS	30'-6"	126"	81"	5600	715	7500	1900	59	32	32
29 FBS	32'-6"	134"	81"	6905	755	8500	1595	46	65	32
31 BHS	32'-6"	134"	81"	6935	960	9000	2065	46	32	32
<b>Fifth Wheels</b>										
24.5 RBS	27'-1"	139"	59"	6290	1240	8500	2210	46	32	32
27.5 BHS	29'-3"	142"	58'-3/4"	6780	1525	9500	2720	59	65	32
28.5 RLS	30'-3"*	145"*	76"*	7400*	1635*	9400*	2000*	46*	65*	32*
30.5 BHS	32'-4"	145"	77"	7665	1225	10500	2835	46	65	32

\* = Estimated Values

**Unloaded Vehicle Weight (UVW):** Sometimes referred to as "Dry Weight," UVW means the typical weight of this trailer as built at the factory. The UVW, as used in product literature and other promotional materials, does not include cargo, fresh water, LP gas, options, or dealer-installed accessories.

**Gross Vehicle Weight Rating (GVWR):** GVWR means the maximum permissible weight of the trailer, including the UVW plus passengers, personal items, all cargo, fluids, options, and dealer-installed accessories. The GVWR is equal to or greater than the sum of the UVW and the CCC.

**Cargo Carrying Capacity (CCC):** CCC means the maximum weight of all passengers, personal items, food, fresh water, LP gas, tools, other cargo, and dealer-installed accessories\* that can be carried by the trailer. CCC is equal to or less than GVWR minus UVW.

\*The addition of options will decrease the CCC.

It is important for your safety and enjoyment that your tow vehicle be adequately sized and equipped to tow and handle the GVWR of the RV you select. Review weights and rating of your tow vehicle and consult a competent advisor

for questions or advice. Whether you are new to RVing or a veteran, get a feel for the performance of your tow vehicle and the RV together before heading out on the roadways. When you tow an RV, you must drive differently than you do when driving a single vehicle. Practice hooking up, driving, backing up, and braking in a safe environment or seek out professional instruction.

See specification chart above. Jayco affixes a weight label to each RV which lists weight information for that vehicle.



# Standards and Options

## Standard Construction Features

1/2" plywood dinette, bed, and bunk platforms	<input checked="" type="checkbox"/>
.024" aluminum exterior skin	<input checked="" type="checkbox"/>
Electric-powered slideout (all slideout models)	<input checked="" type="checkbox"/>
2"x3" longitudinal floor joists on 16"-18" centers	<input checked="" type="checkbox"/>
Roof rafters, constructed of residential-style tapered 4-1/2" trusses	<input checked="" type="checkbox"/>
Wall studs on 16" centers	<input checked="" type="checkbox"/>
5/8" tongue and groove plywood main floor decking	<input checked="" type="checkbox"/>
PolyFlex™ one-piece underbelly covering	<input checked="" type="checkbox"/>
Seamless one-piece rubber roof (made of TPO)	<input checked="" type="checkbox"/>
R-7 fiberglass insulation in sidewall, roof, and floor	<input checked="" type="checkbox"/>
81" living room ceiling height	<input checked="" type="checkbox"/>

## Standard Exterior Equipment

15" radial tires	<input checked="" type="checkbox"/>
Chrome hub caps	<input checked="" type="checkbox"/>
LP gas bottle cover, made of molded ABS	<input checked="" type="checkbox"/>
Bumper w/drain hose carrier and end caps	<input checked="" type="checkbox"/>
Electric-powered front jacks	<input checked="" type="checkbox"/>
Heavy-duty grab handle for entry assistance	<input checked="" type="checkbox"/>
E-Z Lube® axles	<input checked="" type="checkbox"/>
Front window w/flush-mounted stone guard	<input checked="" type="checkbox"/>
Galvanized steel wheel wells (insulated on non-slide models)	<input checked="" type="checkbox"/>
Baggage doors are lockable and radius-cornered w/heavy-duty grab handle	<input checked="" type="checkbox"/>
Painted bottom radius skirting	<input checked="" type="checkbox"/>
Patio light w/inside switch	<input checked="" type="checkbox"/>
ABS fender skirts	<input checked="" type="checkbox"/>
Radius-cornered fiberglass entrance door w/screen door	<input checked="" type="checkbox"/>
Rain guttering, molded w/drip spouts	<input checked="" type="checkbox"/>
Double retractable entrance step (triple step on SuperSlide™ models)	<input checked="" type="checkbox"/>
Front jacks with quick release pins	<input checked="" type="checkbox"/>
Stabilizer jacks (2 pair)	<input checked="" type="checkbox"/>
Stabilizer jacks on rear (1 pair)	<input checked="" type="checkbox"/>
White, radius-cornered awning-style windows	<input checked="" type="checkbox"/>

Travel Trailers  
Fifth Wheels

## Standard Heat, Power, and Water Equipment

110V G.F.C.I. Protected exterior receptacle	<input checked="" type="checkbox"/>
30-amp power cord	<input checked="" type="checkbox"/>
6 gallon gas/electric DSI auto-ignition water heater	<input checked="" type="checkbox"/>
ABS holding tanks	<input checked="" type="checkbox"/>
Furnace w/wall thermostat, auto-ignition	<input checked="" type="checkbox"/>
Hook-up for city water	<input checked="" type="checkbox"/>
12V electrical system w/deluxe 110V 45-amp power converter	<input checked="" type="checkbox"/>
12V demand water pump	<input checked="" type="checkbox"/>
In-floor ducted heat	<input checked="" type="checkbox"/>
Outside shower	<input checked="" type="checkbox"/>
Monitor panel for all systems	<input checked="" type="checkbox"/>

## Standard Interior Equipment

Accent mirror on wall (select models)	<input checked="" type="checkbox"/>
Decorative brass lighting over sofa and dinette	<input checked="" type="checkbox"/>
Cable TV hookup w/RG6 coax cabling	<input checked="" type="checkbox"/>
Carpeting w/padding	<input checked="" type="checkbox"/>
Handsome furniture, designed and made by Jayco®	<input checked="" type="checkbox"/>
J-Steel™ convertible sofa	<input checked="" type="checkbox"/>
Raised panel oak doors on overhead cabinets	<input checked="" type="checkbox"/>
Roof-mounted antenna for radio	<input checked="" type="checkbox"/>
Swivel rocker(s) (1 or 2 on select models)	<input checked="" type="checkbox"/>
Crank-up antenna for TV w/signal booster	<input checked="" type="checkbox"/>
Fabric-covered box valances w/lambrequin legs	<input checked="" type="checkbox"/>
Wallpaper border	<input checked="" type="checkbox"/>

## Standard Bathroom Equipment

Large sink in bathroom	<input checked="" type="checkbox"/>
Marine toilet	<input checked="" type="checkbox"/>
Medicine cabinet w/mirror	<input checked="" type="checkbox"/>
Shower curtain	<input checked="" type="checkbox"/>
Toilet paper holder	<input checked="" type="checkbox"/>
Bar and towel ring	<input checked="" type="checkbox"/>
Vinyl flooring	<input checked="" type="checkbox"/>

Travel Trailers  
Fifth Wheels

## Standard Kitchen Equipment

3-burner range w/9,000-BTU SuperBurner™ and piezo igniter	<input checked="" type="checkbox"/>
Spice rack, built-in under kitchen sink (select models)	<input checked="" type="checkbox"/>
Deep-lipped overhead cabinetry	<input checked="" type="checkbox"/>
Extra large picture window at dinette	<input checked="" type="checkbox"/>
Fairfield Oak raised-paneled doors and drawers on overhead cabinetry and refrigerator	<input checked="" type="checkbox"/>
Large pedestal dinette table	<input checked="" type="checkbox"/>
Oversized oven	<input checked="" type="checkbox"/>
Range hood w/light and exhaust fan	<input checked="" type="checkbox"/>
Acrylic residential-style sink	<input checked="" type="checkbox"/>
Mixing high-rise faucet	<input checked="" type="checkbox"/>

## Standard Bedroom Equipment

Under bed storage, bed lifts easily on gas struts	<input checked="" type="checkbox"/>
Bi-fold privacy door	<input checked="" type="checkbox"/>
Carpeting w/padding	<input checked="" type="checkbox"/>
Mini-blinds	<input checked="" type="checkbox"/>
Innerspring mattress w/bed struts	<input checked="" type="checkbox"/>
TV shelf	<input checked="" type="checkbox"/>

## Customer Value Package

(all Jay Flight models are equipped with this package)

A/C (Central), 13,500 BTU or A/C (Central), 15,000 BTU	<input checked="" type="checkbox"/>
Shirt wardrobe in bedroom	<input checked="" type="checkbox"/>
Double 30-lb. LP gas bottles w/regulator	<input checked="" type="checkbox"/>
ABS tub surround	<input checked="" type="checkbox"/>
Tub/shower skylight	<input checked="" type="checkbox"/>
Powered attic fan in bathroom	<input checked="" type="checkbox"/>
Carefree® patio awning	<input checked="" type="checkbox"/>
Quilted bedspread	<input checked="" type="checkbox"/>
Sink cover/cutting board (1)	<input checked="" type="checkbox"/>
Microwave oven w/carousel	<input checked="" type="checkbox"/>
Bi-fold cover for range	<input checked="" type="checkbox"/>
Water heater bypass system	<input checked="" type="checkbox"/>
Home theater system, Dolby® Digital 5.1 Surround Sound w/DVD	<input checked="" type="checkbox"/>

Travel Trailers  
Fifth Wheels

## Standard Safety Equipment

LP/gas leak detector	<input checked="" type="checkbox"/>
Break-away switch	<input checked="" type="checkbox"/>
Dead-bolt lock on entrance door	<input checked="" type="checkbox"/>
Dual hitch safety chains	<input checked="" type="checkbox"/>
Smoke detector	<input checked="" type="checkbox"/>
Multiple egress windows	<input checked="" type="checkbox"/>
Fire extinguisher	<input checked="" type="checkbox"/>
Safety glass windows	<input checked="" type="checkbox"/>

## Optional Equipment

Extendable dinette (SuperSlide™ models only)	<input checked="" type="checkbox"/>
Diamond-plated panel on front	<input checked="" type="checkbox"/>
Enclosed, insulated, and heated underbelly	<input checked="" type="checkbox"/>
Linoleum floor in living area (standard in 27BH and 31 BHS)	<input checked="" type="checkbox"/>
Portable, outside gas RVQ® grill w/carrying case	<input checked="" type="checkbox"/>
Roof ladder	<input checked="" type="checkbox"/>
Spare tire and tire carrier w/vinyl tire cover	<input checked="" type="checkbox"/>
StorGalore™ storage (27BH, 28RLS)	<input checked="" type="checkbox"/>
Swivel rocker (1) (19RBS, 28FKS)	<input checked="" type="checkbox"/>
Third bunk added (29BHS)	<input checked="" type="checkbox"/>
Water purification system	<input checked="" type="checkbox"/>

Travel Trailers  
Fifth Wheels



Enjoy the Jay Flight's home theater system with Dolby® Digital 5.1 Surround Sound and DVD/CD player for the ultimate family movie and music experience.

## Popular Features



**Extended**

With Superslide™ models, you have the option of Jayco's exclusive extendable dinette to make more room for family meals and games.



The outside shower gives you a convenient place to rinse off after outdoor activities and is standard on all models.



Jay Flight provides both electric-powered front jacks and snap jacks as standard equipment.



Jayco's V-Tec™ flush-floor slideout system expands your living space with the simple push of a button.



Jay Flight's E-Z Lube® axles with removable caps help simplify maintenance.



The RVQ®, our optional portable gas barbecue grill, makes your holiday cooking easy and fun. It also comes with a handy carrying case.



The optional front diamond plate and rugged ABS gas bottle cover protect the Jay Flight's exterior against road debris.



Jay Flight travel trailers and fifth wheels feature solid Fairfield Oak cabinet doors with mortise and tenon construction.

## Interior Colors



**Clearwater**



**Paprika**



**Spearmint**

## 2005 JAY FLIGHT™ Travel Trailers and Fifth Wheels

### We Build It To Last.

Like every Jayco recreational vehicle, the Jay Flight features rugged designs, high quality materials, and expert construction methods. At the heart of it all is Jayco's I-Class structural steel chassis frame, which is stronger and more durable than the welded I-Beam frame used by many competitors. When you choose the Jay Flight, you'll enjoy the quality both today and down the road.



**(Left)** End view of Jayco's I-Class™ structural steel chassis frame.

**(Right)** End view of the welded I-beam frame used by many competitors which is subject to warping.

### A Legacy of Craftsmanship.

*Jayco has been blessed with some of America's finest craftsmen who make Middlebury, Indiana and the Jayco plant their home and workplace. Generation after generation, a legacy of tried-and-true construction methods is passed down, continuing the tradition of quality and durability that has helped Jayco grow into a true industry leader.*



### Your Jayco Dealer

---

### We Back What We Build.

The Jayco 2+3 Warranty is a manufacturer's limited warranty. It doesn't come from your dealer and it's not an extended warranty! It comes from the people who build Jayco recreational vehicles to the people who buy them. Each Jayco is warranted to the original purchaser for twenty-four (24) months from the date of purchase against defects in materials and workmanship. The Jayco warranty includes a limited three-year (3) structural guarantee and, in addition, our limited warranty may be transferred one time within the first two (2) years. Go ahead and compare the Jayco warranty with other manufacturers' warranties. You'll find it's the best in the business!



For a copy of the limited warranty with full terms and conditions, ask your local Jayco dealer or visit our web site @ [www.jayco.com](http://www.jayco.com).



FAMILY OWNED. FAMILY FOCUSED.

See above dealer for further information and prices.

As a Jayco owner, you can be part of the Jayco Jafari International Travel Club. Ask your dealer about the Jafari "flight" in your area, write Jayco, or visit our web site.



**Please Note:** All information in this brochure is the latest available at the time of publication approval. Jayco reserves the right to make changes and to discontinue models without notice or obligation. Photos in this brochure may show optional equipment. RVs built for sale in Canada may differ to conform to Canadian codes.

©2005 Jayco, Inc. 0501004.2005 0604-100M Printed in U.S.A.

