



Open Range



Serial #: 58TBM0BU7T1A23060  
Model: 338BHS OPEN RANGE TT

Model Year: 2026 Dealer Name: LEO'S VACATION CENTER, INC  
729 ROUTE 3 NORTH  
GAMBRILLS, MD 21054  
USA

Standard Equipment

THE FOLLOWING ITEMS ARE STANDARD ON THIS MODEL

STANDARD EXTERIOR EQUIPMENT

100" wide body frame  
A frame flip up storage tray  
2-30 lb. LP bottles  
4" tube storage bumper  
50 amp service  
ACCU-SLIDE™ slide system (42" deep 4-corner compression)  
Battery disconnect switch  
Brass hanger bushings with wet bolts  
Equa-Flex® axle suspension  
Exterior grill/griddle quick connect port  
Frameless windows  
Norco™ 5.1 stabilizer system with BAL™ lock arms  
PVC roofing membrane (limited lifetime warranty)  
Rear roof access ladder  
Self-adjusting electric brakes  
Spare tire  
TuffShell™ - vacuum bonded laminated construction, reinforced with heavy-duty fiberglass and welded aluminum frames  
Xtend Solar I Package (1-200 watt solar panel with 30 amp controller)

FOUR SEASON PACKAGE

Double insulated baggage doors  
Ducted heat to underbelly with cold air return  
Enclosed cable operated gate valves  
Enclosed exterior docking station with black tank flush  
Heated and enclosed underbelly  
High performance furnace  
R-38 reflective foil insulation in ceiling and underbelly  
R-11 block foam insulation in sidewalls

STANDARD INTERIOR EQUIPMENT

9" 3 Layer firm/soft option residential mattress  
21 cu. ft. 110v residential refrigerator  
Residential king bed with storage below  
75 lb. ball bearing drawer guides  
Cable and satellite prep  
Flip down night stands on bed slide out fascia  
Flush floor slides with residential vinyl flooring  
Glass shower door  
Hardwood slideout fascia  
Large oven and 3-burner range with flush mount glass cover  
LED interior lighting  
Observation camera prep  
Pet/child screen guard on screen door  
Raised panel hardwood doors  
Residential microwave  
Roller blackout night shades  
Screen Shot (automatic screen door closer)  
USB ports in bedroom

EXECUTIVE PACKAGE

15,000 BTU A/C with quiet residential return air-bedroom  
15,000 BTU A/C with quiet residential return air-main living  
60K BTU on demand hot water heater  
Cutting board and sink strainer  
Dome style digital TV antenna with Wi-Fi prep  
Interior convenience center light  
Keyed-Alike® entry and baggage doors  
Painted fiberglass front cap with LED lighting  
Power awning with LED lighting  
Power tongue jack  
Quick release fresh water drain  
Residential high-rise faucet with pull-down sprayer  
Single basin stainless steel under-mount kitchen sink  
Smart entertainment HDTV with Bluetooth®, Soundbar and built in stereo  
Solid swing-down entry steps  
Solid-surface kitchen countertops  
Stainless steel appliances  
TravelINK® - Smart RV system that allows for Bluetooth® control of awnings, lighting, slideouts, heating, cooling and more  
USB/12V charging port

Optional Equipment

OPTIONAL EQUIPMENT INSTALLED ON THIS VEHICLE  
BY MANUFACTURER

Base price	79,874.00
USA STANDARDS	n/c
EXECUTIVE PACKAGE	6,000.00
FOUR SEASONS PROTECTION PACKAGE	750.00
NO HEAT PUMP	n/c
POWER FAN VENT WALL CONTROL BATHROOM	375.00
21 CU. FT. 110 VOLT REFRIGERATOR	n/c
32" BEDROOM TV	488.00
WINDOWS STANDARD	n/c
7.3 AUTO LEVEL	1,943.00
MEGA LOUNGES	n/c

UNIT TOTAL 89,430.00

DEALER INSTALLED OPTIONS

Manufacturer's Suggested Retail Price \$89,430.00

TOTAL AMOUNT DOES NOT INCLUDE STATE AND LOCAL TAXES OR LICENSE FEES. THE PRICE SHOWN ABOVE MAY OR MAY NOT BE REPRESENTATIVE OF THE ACTUAL SELLING PRICE OF SIMILAR RECREATIONAL VEHICLES IN YOUR AREA.

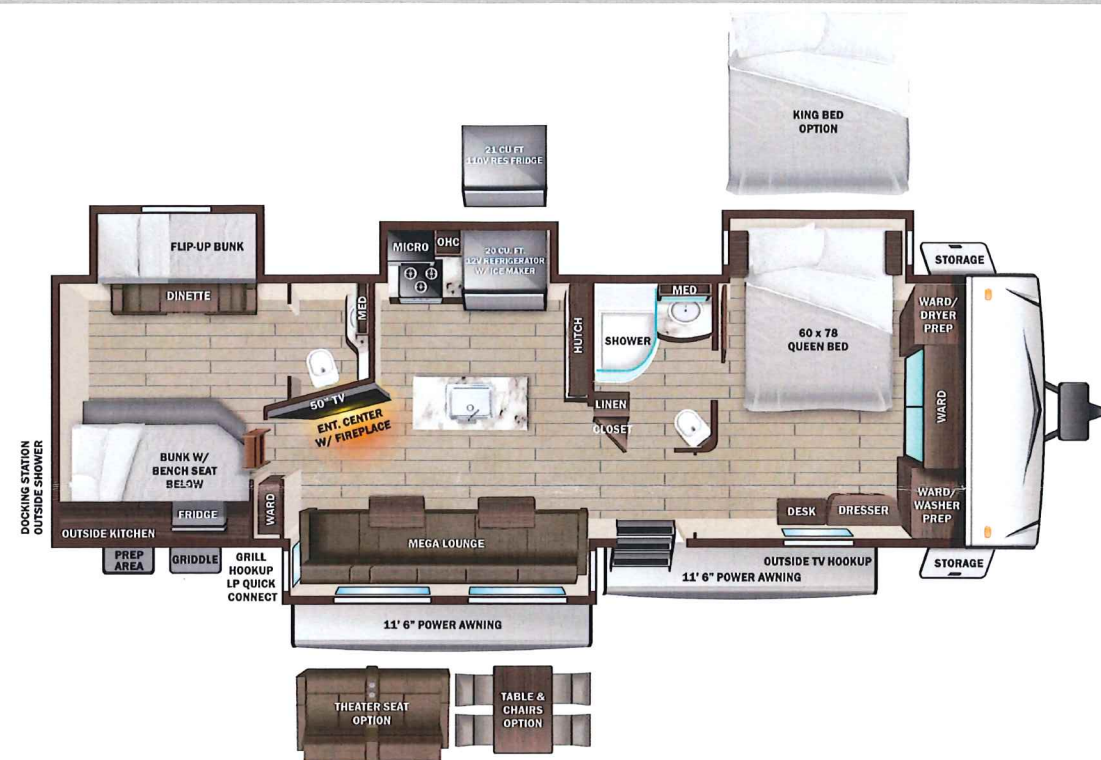

UVW  
10517 lbs



Sleeps



Length  
39' 6.13"

DIMENSIONS

Exterior height:.....141.13"  
Exterior width:.....100.25"

WEIGHTS

GVWR:.....12200  
GAWR (front):.....6000  
GAWR (rear):.....6000  
Approx. Gross Cargo Carrying Capacity(GCCC):.....1683

TIRES

Tire size (front):.....ST235/80R16E  
Tire size (mid):.....  
Tire size (rear):.....ST235/80R16E

CAPACITIES

Fresh water tank (gals.):...43.00  
Gray water tank (gals.):....66.00  
Black water/toilet tank (gals.):.....66.00  
Propane (lbs.):.....60  
Propane (gals.):.....14  
Water heater (gals.):.....0.25

SEATING & SLEEPING

\*\*\*Some dimensions may be rounded and may vary from the actual dimensions\*\*\*

\*\*\*Weights may be estimated calculations and may vary from the actual weight

- refer to the vehicle weight labels for actual weights\*\*\*

Floorplans, features and specifications are subject to change without notice.

