



# Open Range 3X



Serial #: 58TCM0BS3S3B53066  
 Model: 287RLS OPEN RANGE 3X FW

Model Year: 2025 Dealer Name: LEO'S VACATION CENTER, INC  
 729 ROUTE 3 NORTH  
 GAMBRILLS, MD 21054  
 USA

**Manufacturer's Suggested Retail Price \$107,281.00**

TOTAL AMOUNT DOES NOT INCLUDE STATE AND LOCAL TAXES OR LICENSE FEES. THE PRICE SHOWN ABOVE MAY OR MAY NOT BE REPRESENTATIVE OF THE ACTUAL SELLING PRICE OF SIMILAR RECREATIONAL VEHICLES IN YOUR AREA.

## Standard Equipment

THE FOLLOWING ITEMS ARE STANDARD ON THIS MODEL

- EXTERIOR**
  - 102" wide body frame
  - 16 gal. gas/electric water heater
  - 2" receiver hitch
  - 2-40 lb. LP bottles
  - 4000 MorRyde Suspension
  - 50 amp service
  - ACCU-SLIDE™ slide system (42" deep 4-corner compression)
  - Battery disconnect switch
  - Brass hanger bushings with wet bolts
  - Equa-Flex® axle suspension
  - Exterior grill/griddle quick connect port
  - H rated steel belted radial tires
  - Intergrated aluminum hub rims
  - Laminated block foam floor
  - LevelLoc™ - 4 or 6 point automatic leveling with JT's Strong Arms®
  - PVC roofing membrane (limited lifetime warranty)
  - Rear roof access ladder
  - Self-adjusting electric brakes
  - Spare tire
  - Square frameless windows
  - TuffShell™ -vacuum bonded laminated construction, reinforced with heavy-duty fiberglass and welded aluminum frames
  - Xtend Solar I Package (1-200 watt solar panel with 30 amp controller)
- EXECUTIVE PACKAGE (Mandatory)**
  - 3-15,000 BTU A/C with quiet residential return air
  - Cutting board and sink strainer
  - Dome style digital TV antenna with Wi-Fi prep
  - Interior convenience center light
  - Keyed-Alike® entry and baggage doors
  - Main bedroom TV - 32"
  - Motion sensor lighting in bedroom and hallway
  - Painted fiberglass front cap with LED lighting
  - Power awning with LED lighting
  - Quick recovery gas/electric water heater
  - Quick release fresh water drain
  - Residential high-rise faucet with pull-down sprayer
  - Security camera prep above entrance door
  - Single basin stainless steel under-mount kitchen sink
  - Smart Entertainment HDTV with Bluetooth®, Soundbar and Built in Stereo
  - Solid swing-down entry steps
  - Solid-surface kitchen countertops
  - Stainless steel appliances
  - TravelLINK® - Smart RV system that allows for Bluetooth® control of awnings, lighting, slideouts, heating, cooling and more
  - USB/12V charging port

- INTERIOR**
  - 72" x 78" residential king bed with power base
  - 75 lb. ball bearing drawer guides
  - 9" 3 layer firm/soft option residential mattress
  - Cable and satellite prep
  - Central Vacuum
  - Ceramic subway tile backsplash
  - Fiberglass shower Base
  - Flexible reading lights with USB chargers
  - Flush floor slides with residential vinyl flooring
  - GE 21 cu. ft. residential refrigerator
  - GE 3.75 cu. ft. freestanding oven and 4-burner range
  - GE 30" OTR residential microwave
  - Glass shower door
  - Hardwood ceiling soffit
  - Hardwood slideout fascia
  - Large hidden pantry
  - LED interior lighting
  - Main bedroom TV - 32"
  - Pet/Child Screen Guard on Screen Door
  - Porcelain lavatory bowl with single lever faucet
  - Rainfall kitchen sink with Produce and Glass Rinser
  - Raised panel hardwood cabinet doors
  - Solid surface lavatory top
  - Solid surface waterfall island
  - Square windows with intergrated blinds
  - Table and 4 chairs
  - Theater seating with power recline
  - VoiceLINK™ voice command system- controls lighting, heating and cooling along with TravelLINK®
  - Wall controlled power vent (kitchen/living room area)
  - Washer/dryer prep
- FOUR SEASON PACKAGE (Mandatory)**
  - 3" sidewall, 50% thicker wall with 3/4" vapor barrier between the interior and the aluminum tubes
  - 40K BTU high performance furnace
  - 5K BTU electric fireplace
  - Double insulated baggage doors
  - Ducted heat to underbelly with cold air return
  - Enclosed cable operated gate valves
  - Enclosed exterior docking station with black tank flush
  - Heated and enclosed underbelly
  - R-17 block foam insulation in sidewalls with 3/4" vapor barrier
  - R-38 reflective foil insulation in ceiling and underbelly

## Optional Equipment

OPTIONAL EQUIPMENT INSTALLED ON THIS VEHICLE BY MANUFACTURER

|                                      |           |
|--------------------------------------|-----------|
| Base price                           | 98,250.00 |
| USA STANDARDS                        | n/c       |
| EXECUTIVE PACKAGE                    | 6,000.00  |
| FOUR SEASONS PROTECTION PACKAGE      | 750.00    |
| NO HEAT PUMP                         | n/c       |
| POWER FAN VENT WALL CONTROL BATHROOM | 375.00    |
| 21 CU. FT. 110 VOLT REFRIGERATOR     | n/c       |
| DISHWASHER                           | 1,013.00  |
| 16 GAL GAS ELECTRIC WATER HEATER     | n/c       |
| GENERATOR PREP - LP                  | 893.00    |
| WINDOWS STANDARD                     | n/c       |
| NO PIN BOX                           | n/c       |

UNIT TOTAL **107,281.00**

DEALER INSTALLED OPTIONS

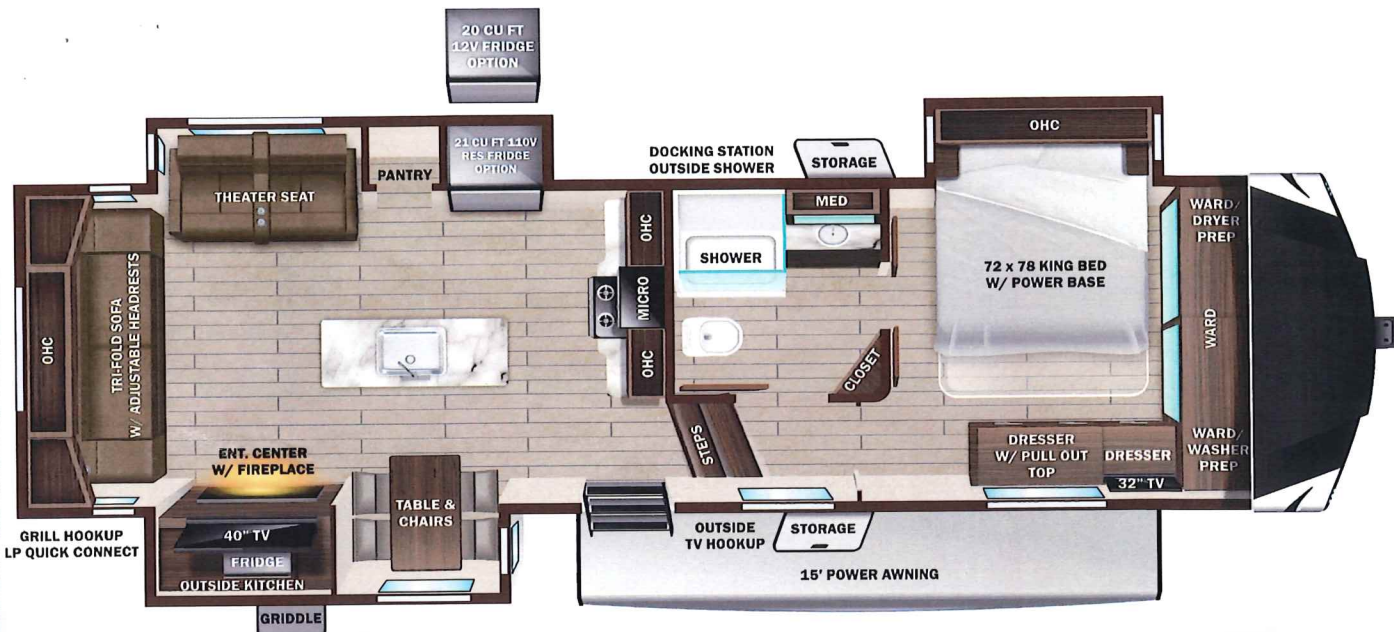

**UWV**  
12060 lbs

**Sleeps**

**Length**  
35' 4"

### DIMENSIONS

Exterior height:.....157.63"

Exterior width:.....101.25"

### WEIGHTS

GVWR:.....13900

GAWR (front):.....6000

GAWR (rear):.....6000

Approx. Gross Cargo Carrying Capacity(GCCC):.....1840

### TIRES

Tire size (front):.....ST235/80R16H

Tire size (mid):.....

Tire size (rear):.....ST235/80R16H

### CAPACITIES

Fresh water tank (gals.):...75.00

Gray water tank (gals.):...80.00

Black water/toilet tank (gals.):.....57.00

Propane (lbs.):.....80

Propane (gals.):.....18

Water heater (gals.):.....10.00

### SEATING & SLEEPING

\*\*\*Some dimensions may be rounded and may vary from the actual dimensions\*\*\*  
 \*\*\*Weights may be estimated calculations and may vary from the actual weight - refer to the vehicle weight labels for actual weights\*\*\*  
 Floorplans, features and specifications are subject to change without notice.

