



# Open Range



Serial #: 58TBM0BU4S3A23066  
 Model: 338BHS OPEN RANGE TT

Model Year: 2025 Dealer Name: LEO'S VACATION CENTER, INC  
 729 ROUTE 3 NORTH  
 GAMBRILLS, MD 21054  
 USA

## Manufacturer's Suggested Retail Price

11243066  
 \$86,716.00

TOTAL AMOUNT DOES NOT INCLUDE STATE AND LOCAL TAXES OR LICENSE FEES. THE PRICE SHOWN ABOVE MAY OR MAY NOT BE REPRESENTATIVE OF THE ACTUAL SELLING PRICE OF SIMILAR RECREATIONAL VEHICLES IN YOUR AREA.

### Standard Equipment

THE FOLLOWING ITEMS ARE STANDARD ON THIS MODEL AT NO EXTRA CHARGE

- EXTERIOR**
- 100" wide body frame
  - A frame flip up storage tray
  - 2-30 lb. LP bottles
  - 4" tube storage bumper
  - 50 amp service
  - ACCU-SLIDE™ slide system (42" deep 4-corner compression)
  - Battery disconnect switch
  - Brass hanger bushings with wet bolts
  - Equa-Flex® axle suspension
  - Exterior grill/griddle quick connect port
  - Frameless windows
  - Norco™ 5.1 stabilizer system with BAL™ lock arms
  - PVC roofing membrane (limited lifetime warranty)
  - Rear roof access ladder
  - Self-adjusting electric brakes
  - Spare tire
  - TuffShell™ - vacuum bonded laminated construction, reinforced with heavy-duty fiberglass and welded aluminum frames
  - Xtend Solar I Package (1-200 watt solar panel with 30 amp controller)
- FOUR SEASON PACKAGE (Mandatory)**
- Double insulated baggage doors
  - Ducted heat to underbelly with cold air return
  - Enclosed cable operated gate valves
  - Enclosed exterior docking station with black tank flush
  - Heated and enclosed underbelly
  - High performance furnace
  - R-38 reflective foil insulation in ceiling and underbelly
  - R-9 block foam insulation in sidewalls

- INTERIOR**
- 9" 3 layer firm/soft option residential mattress
  - 17 cu. ft. 12V refrigerator
  - 60" x 78" residential queen bed with storage below
  - 75 lb. ball bearing drawer guides
  - Cable and satellite prep
  - Flush floor slides with residential vinyl flooring
  - Glass shower door
  - Hardwood slideout fascia
  - Large oven and 3-burner range with flush mount glass cover
  - LED interior lighting
  - Observation camera prep
  - Pet/Child Screen Guard on Screen Door
  - Raised panel hardwood doors
  - Residential microwave
  - Roller blackout night shades
  - USB ports in bedroom
- EXECUTIVE PACKAGE (Mandatory)**
- 15,000 BTU A/C with quiet residential return air-bedroom
  - 15,000 BTU A/C with quiet residential return air-main living
  - Cutting board and sink strainer
  - Dome style digital TV antenna with Wi-Fi prep
  - Interior convenience center light
  - Keyed-Alike® entry and baggage doors
  - Painted fiberglass front cap with LED lighting
  - Power awning with LED lighting
  - Power tongue jack
  - Quick recovery gas/electric water heater
  - Quick release fresh water drain
  - Residential high-rise faucet with pull-down sprayer
  - Single basin stainless steel under-mount kitchen sink
  - Smart Entertainment HDTV with bluetooth®, Soundbar and Built in Stereo
  - Solid swing-down entry steps
  - Solid-surface kitchen countertops
  - Stainless steel appliances
  - TravelLINK® - Smart RV system that allows for Bluetooth® control of awnings, lighting, slideouts, heating, cooling and more
  - USB/12V charging port

### Optional Equipment

OPTIONAL EQUIPMENT INSTALLED ON THIS VEHICLE BY MANUFACTURER

Base price	74,999.00
USA STANDARDS	n/c
EXECUTIVE PACKAGE	6,000.00
FOUR SEASONS PROTECTION PACKAGE	750.00
NO HEAT PUMP	n/c
POWER FAN VENT WALL CONTROL BATHROOM	375.00
21 CU. FT. 110 VOLT REFRIGERATOR	1,238.00
ON DEMAND HOT WATER HEATER	293.00
NO BEDROOM TV	n/c
WINDOWS STANDARD	n/c
7.3 AUTO LEVEL	1,943.00
THEATER SEATS WITH TABLE&CHAIRS	593.00
KING BED	525.00

UNIT TOTAL **86,716.00**

DEALER INSTALLED OPTIONS

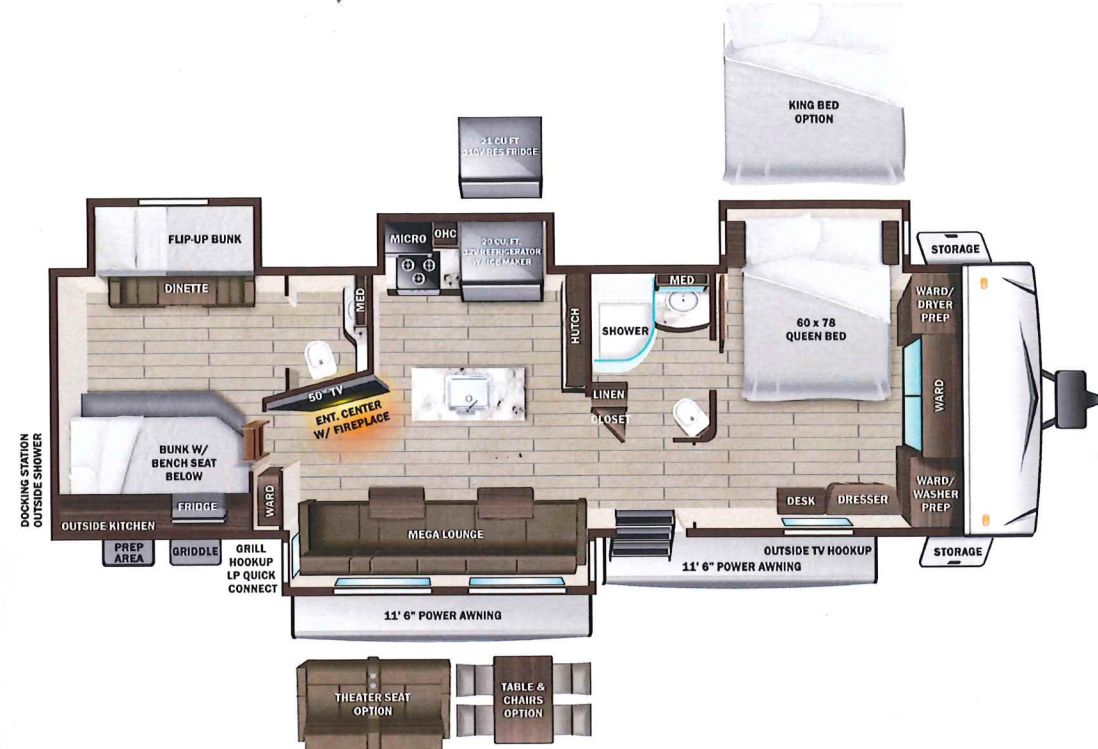

**UVW**  
 10599 lbs

**Sleeps**

**Length**  
 39' 6.13"

#### DIMENSIONS

Exterior height:.....141.50"  
 Exterior width:.....100.13"  
**WEIGHTS**  
 GVWR:.....12200  
 GAWR (front):.....6000  
 GAWR (rear):.....6000  
 Approx. Gross Cargo Carrying Capacity(GCCC):.....1601

#### CAPACITIES

Fresh water tank (gals.):...43.00  
 Gray water tank (gals.):...66.00  
 Black water/toilet tank (gals.):.....66.00  
 Propane (lbs.):.....60  
 Propane (gals.):.....14  
 Water heater (gals.):.....0.25

#### SEATING & SLEEPING

#### TIRES

Tire size (front):.....ST235/80R16E  
 Tire size (mid):.....  
 Tire size (rear):.....ST235/80R16E

\*\*\*Some dimensions may be rounded and may vary from the actual dimensions\*\*\*  
 \*\*\*Weights may be estimated calculations and may vary from the actual weight - refer to the vehicle weight labels for actual weights\*\*\*  
 Floorplans, features and specifications are subject to change without notice.

