

Highland RIDGE RV

Open Range 3X



Serial #: 58TCM0BV5R3B63084
Model: 390TBS OPEN RANGE 3X FW

Model Year: 2024 Dealer Name: LEO'S VACATION CENTER, INC
729 ROUTE 3 NORTH
GAMBRILLS, MD 21054
USA

Manufacturer's Suggested Retail Price **\$133,584.00**

00240084

TOTAL AMOUNT DOES NOT INCLUDE STATE AND LOCAL TAXES OR LICENSE FEES. THE PRICE SHOWN ABOVE MAY OR MAY NOT BE REPRESENTATIVE OF THE ACTUAL SELLING PRICE OF SIMILAR RECREATIONAL VEHICLES IN YOUR AREA.

Standard Equipment

Optional Equipment

THE FOLLOWING ITEMS ARE STANDARD ON THIS MODEL AT NO EXTRA CHARGE

OPTIONAL EQUIPMENT INSTALLED ON THIS VEHICLE BY MANUFACTURER

TERIOR

- 00" wide body frame
- " receiver hitch
- 20 lb. LP bottles
- 0 amp service
- CCU-SLIDE™ slide system (42" deep 4-corner 1pression)
- attery disconnect switch
- ass hanger bushings with wet bolts
- qua-Flex® axle suspension
- terior grill/griddle quick connect port
- ameless windows
- aminated block foam floor
- evelLoc™ - 4 or 6 point automatic leveling with JT's ong Arms®
- VC roofing membrane (limited lifetime warranty)
- ear roof access ladder
- elf-adjusting electric brakes
- pare tire
- uffShell™ -vacuum bonded laminated construction, rforced with heavy-duty fiberglass and welded minum frames
- tend Solar I Package (1-200 watt solar panel with amp controller)

UR SEASON PACKAGE

- ouble insulated baggage doors
- ucted heat to underbelly with cold air return
- nclosed cable operated gate valves
- nclosed exterior docking station with black tank h
- eated and enclosed underbelly
- igh performance furnace
- 38 reflective foil insulation in ceiling and lerbelly
- 9 block foam insulation in sidewalls

INTERIOR

- 20 cu. ft. 12V refrigerator
- 60" x 80" residential queen bed with storage below
- 75 lb. ball bearing drawer guides
- Cable and satellite prep
- Ceramic subway tile backsplash
- Flush floor slides with residential vinyl flooring
- Glass shower door
- Hardwood ceiling soffit
- Hardwood slideout fascia
- Large freestanding oven and 3-burner range
- LED interior lighting
- One-piece fiberglass shower
- Raised panel hardwood cabinet doors
- Residential convection microwave
- Roller day and night shades
- Table and 4 chairs
- Theater seating with power recline
- USB ports in bedrooms
- VoiceLINK™ voice command system- controls lighting, heating and cooling along with TravellINK®
- Wall controlled power vent (kitchen/living room area)
- Washer/dryer prep

EXECUTIVE PACKAGE

- 15,000 BTU A/C with quiet residential return air-bedroom
- 15,000 BTU A/C with quiet residential return air-main living
- Bluetooth® ceiling speaker
- Bluetooth® exterior speakers
- Cutting board and sink strainer
- Dome style digital TV antenna with Wi-Fi prep
- Interior convenience center light
- Keyed-Alike® entry and baggage doors
- Motion sensor lighting in bedroom and hallway
- Painted fiberglass front cap with LED lighting
- Power awning with LED lighting
- Quick recovery gas/electric water heater
- Quick release fresh water drain
- Residential high-rise faucet with pull-down sprayer
- Single basin stainless steel under-mount kitchen sink
- Smart HDTV
- Solid swing-down entry steps
- Solid-surface kitchen countertops
- Stainless steel appliances
- TravelLINK® - Smart RV system that allows for Bluetooth® control of awnings, lighting, slideouts, heating, cooling and more
- USB/12V charging port

Base price 123,750.00
 USA STANDARDS n/c
 EXECUTIVE PACKAGE 6,000.00
 FOUR SEASONS PROTECTION PACKAGE 750.00
 NO HEAT PUMP n/c
 POWER FAN VENT WALL CONTROL BATHROOM 375.00
 21 CU. FT. 110 VOLT REFRIGERATOR n/c
 NO DISHWASHER n/c
 TRUMA INSTANT WATER HEATER 1,613.00
 GENERATOR PREP - LP 893.00
 WINDOWS STANDARD n/c
 BBQ GRILL 203.00
 NO PIN BOX n/c

UNIT TOTAL **133,584.00**

DEALER INSTALLED OPTIONS

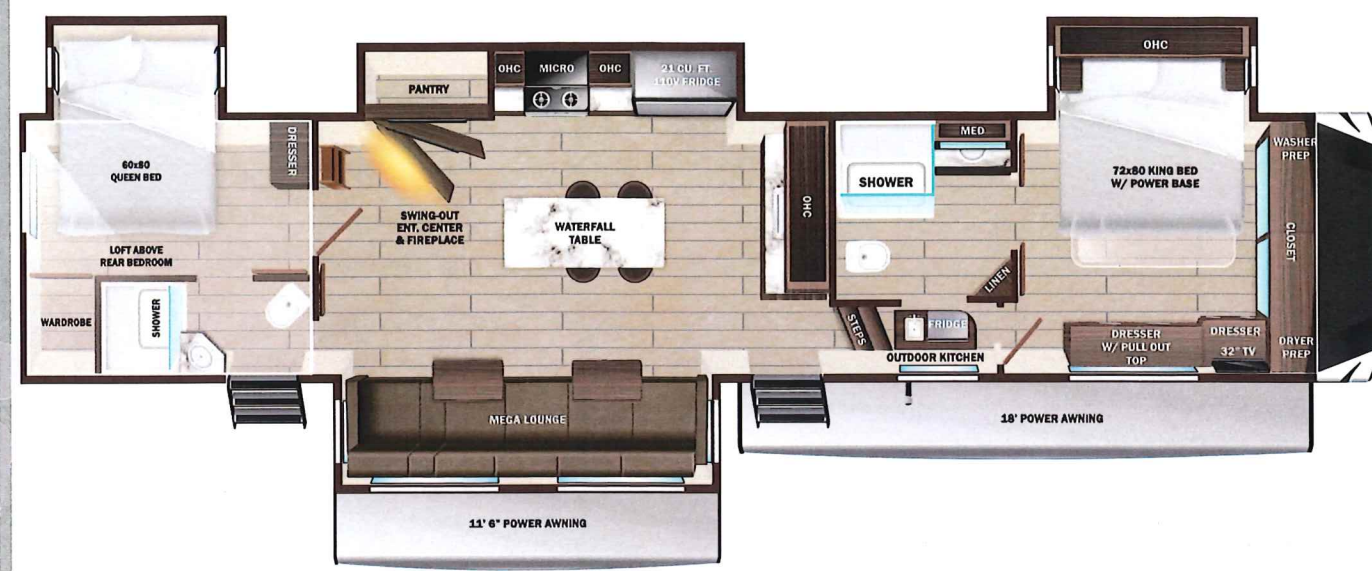

UVW
14832 lbs

Sleeps

Length
43' 7.25"

DIMENSIONS

Exterior height:.....156.25"
 Exterior width:.....101.25"
WEIGHTS
 GVWR:.....16995
 GAWR (front):.....7000
 GAWR (rear):.....7000
 Approx. Gross Cargo Carrying Capacity (GCCC):.....2163

CAPACITIES

Fresh water tank (gals.):...75.00
 Gray water tank (gals.):...97.00
 Black water/toilet tank (gals.):.....80.00
 Propane (lbs.):.....80
 Propane (gals.):.....18
 Water heater (gals.):.....0.35

TIRES

Tire size (front):.....ST235/85R16G
 Tire size (mid):.....
 Tire size (rear):.....ST235/85R16G

SEATING & SLEEPING

Some dimensions may be rounded and may vary from the actual dimensions
 Weights may be estimated calculations and may vary from the actual weight - refer to the vehicle weight labels for actual weights
 Floorplans, features and specifications are subject to change without notice.

